

MS # 648

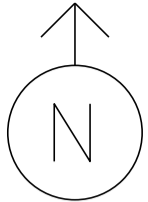

VT 14 NORTH

US 2 WEST

US 2 EAST

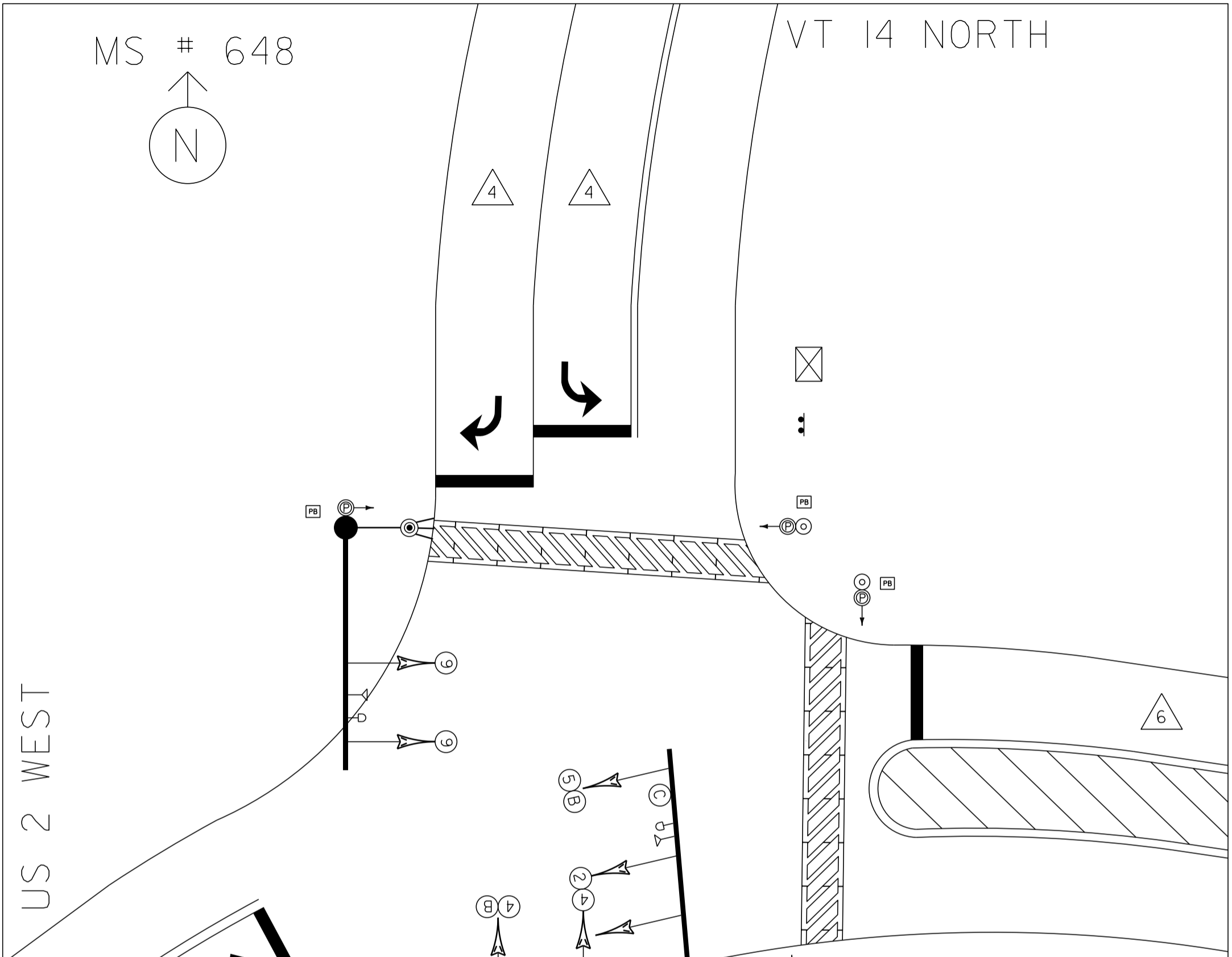

- ⊙ PEDESTAL POST
- ⊙→ PEDESTRIAN SIGNAL
- ⚡ PREEMPTION STROBE
- ▽ VIDEO CAMERA
- ⊠ CONTROL BOX
- MAST ARM
- ▭ VIDEO DETECTION
- ⊠ PB PULL BOX
- ⊙ LUMINAIRE
- ⋮ STANCHION
- ⊙ = 
- ⊙ = 

NOT TO SCALE

MS # 648

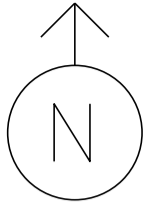

12'

11'

12'

VT 14 NORTH

LANE LINE 105'



STOP BAR 11'

STOP BAR 12'

CROSSWALK 56'

US 2 WEST

STOP BAR 24'

CROSSWALK 48'

11'

11'

US 2 EAST

11'

11'

12'

LANE LINE 85'



STOP BAR 24'

NOT TO SCALE

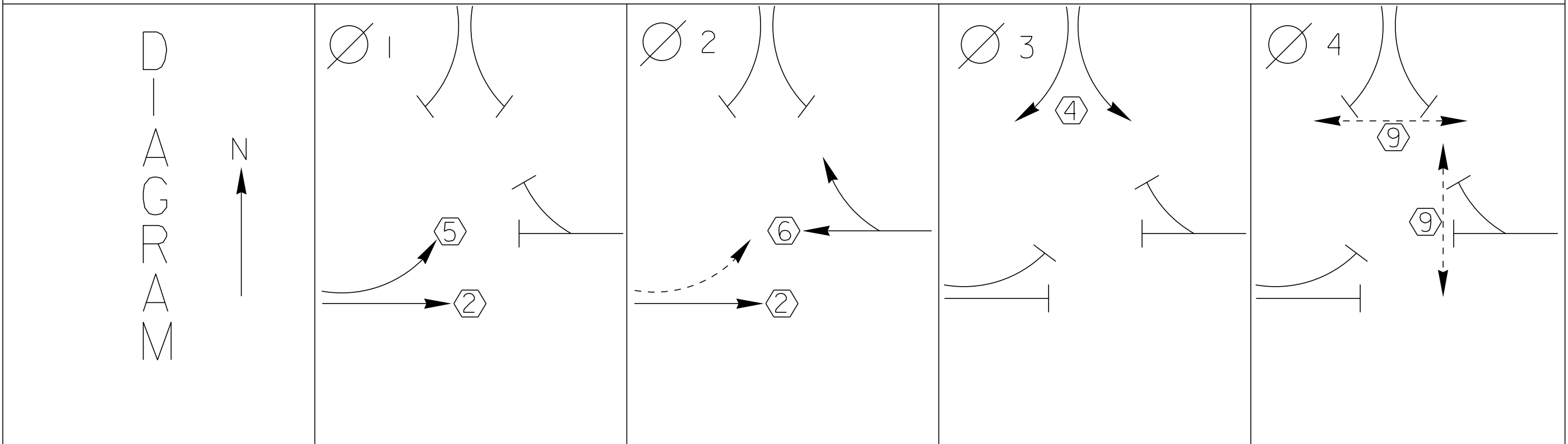

TIMING	$G =$ $Y =$	$G =$ $Y =$	$G =$ $Y =$	$G =$ $Y =$
--------	----------------	----------------	----------------	----------------

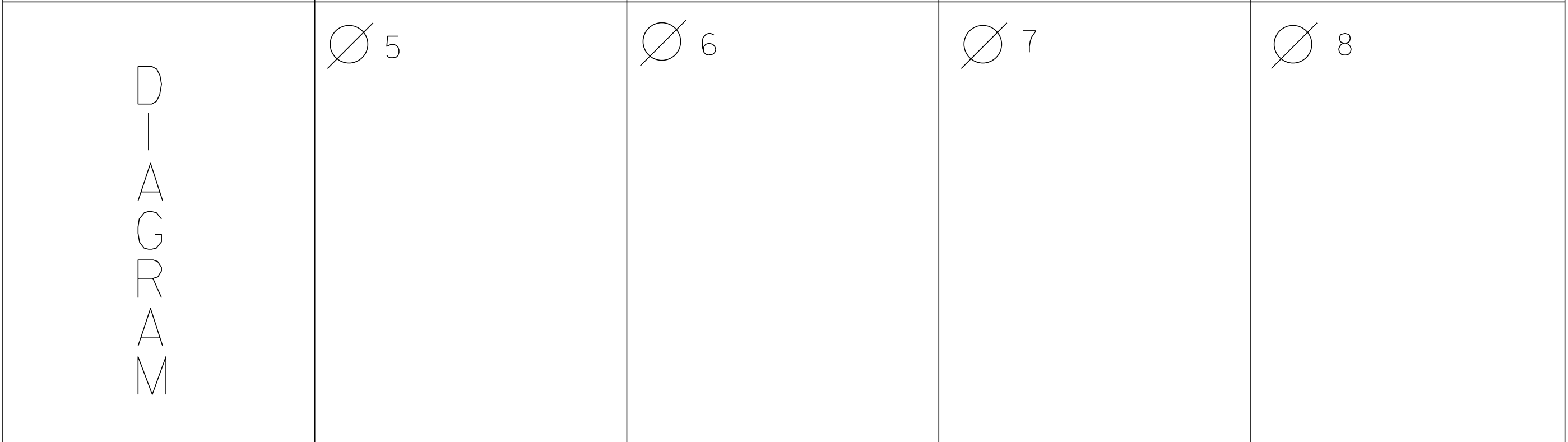

TIMING	$G =$ $Y =$	$G =$ $Y =$	$G =$ $Y =$	$G =$ $Y =$
--------	----------------	----------------	----------------	----------------

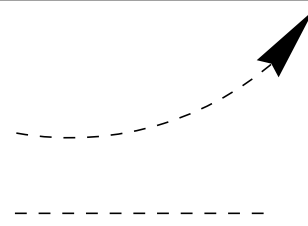
 PROTECTED TURNS	 PERMITTED TURNS PEDESTRIAN	CYCLE LENGTH, C= _____ S
---	---	--------------------------



PROPERTY OF
VT AGENCY OF TRANS
MAINTENANCE DIV
IN EMERGENCY CALL
800-TRANSPROTECT
RIGHTS & REMEDIES
INTERSECTION NO. 105

PROPERTY OF:
**VT. AGENCY OF TRANS.
MAINTENANCE DIV.**

IN EMERGENCY CALL:
DIST. TRANS. OFFICE

828-2691

NIGHTS & WEEKENDS: 250-0163

INTERSECTION NO. MS-648

DANGER

115 VOLTS A.C.

WARNING

DO NOT OPERATE
CABINET WITHOUT
CMU / MMU

CABINET WIRED TO 208V 120/240V OR 120V

SIGNALS OPERATIONAL 1-5-2011

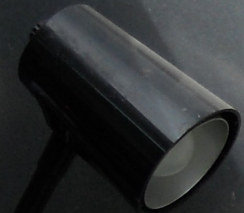

Control panel with various switches and indicators:

- COUP ON / OFF
- FLASH
- COORD
- FREE
- MAIN ON / OFF
- STOP TIME AUTO OFF / ON

ECONOLITE
MODEL: 1000
DATE: 04/11/08

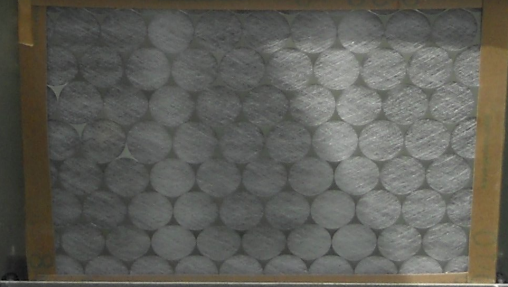
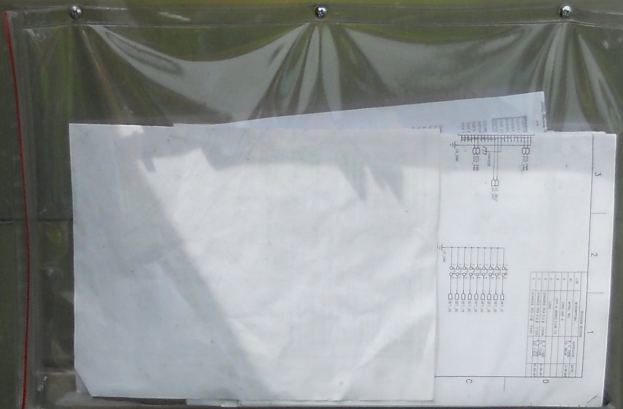

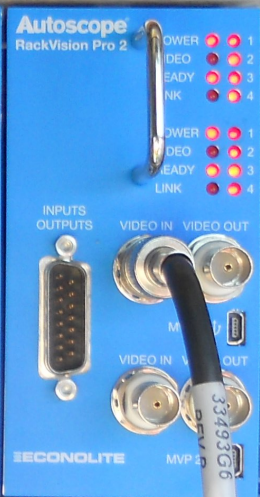
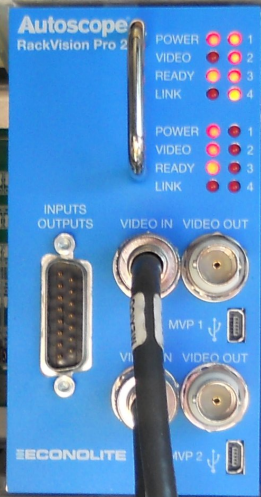
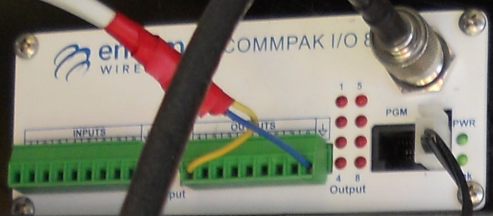

B.I.U. L3 L7 L5 L11 L12 RACK VISION PRO 2 PREEMPTOR EVP# 3 EVP# 4 PREEMPTOR EVP# 5 EVP# 6 DETECTOR SWITCH MODULE



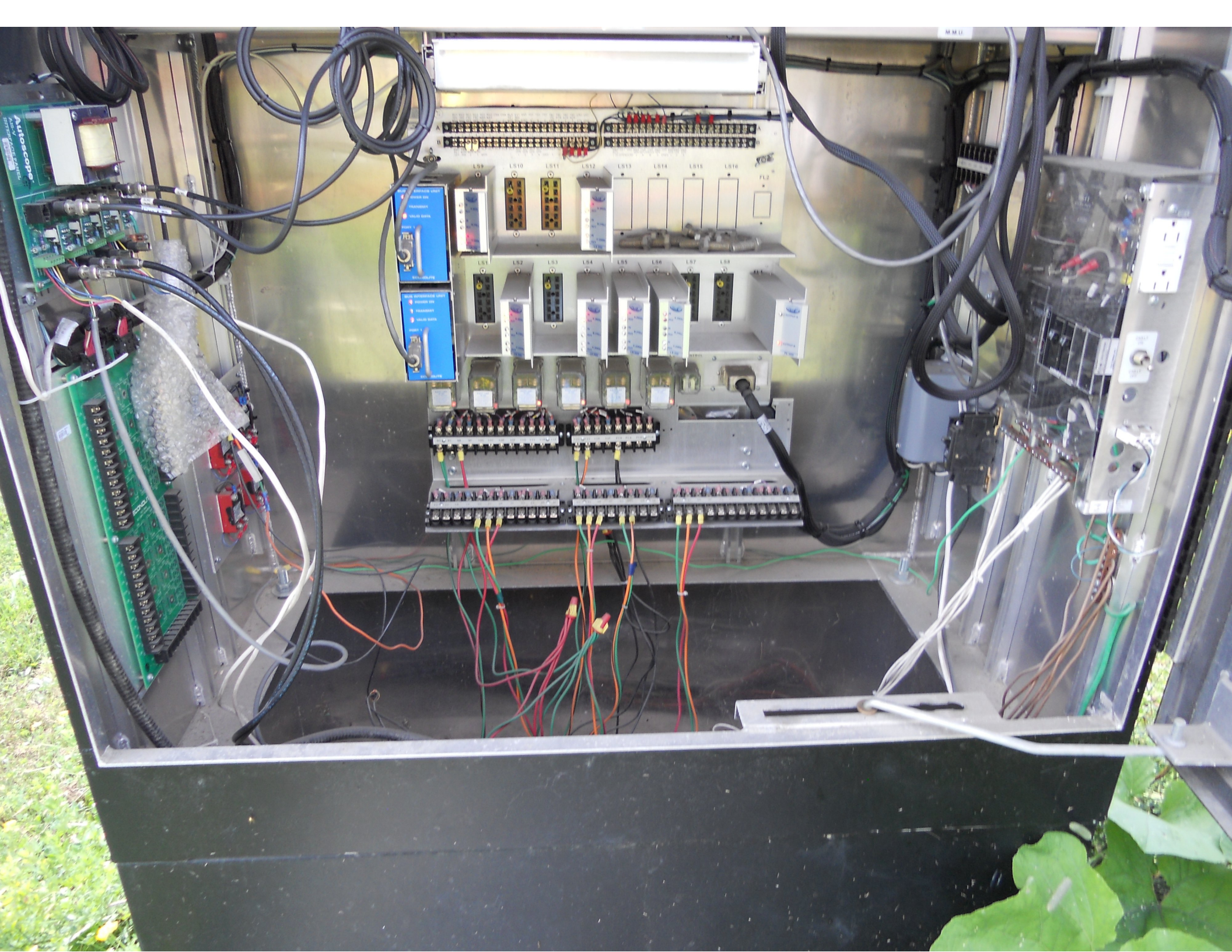

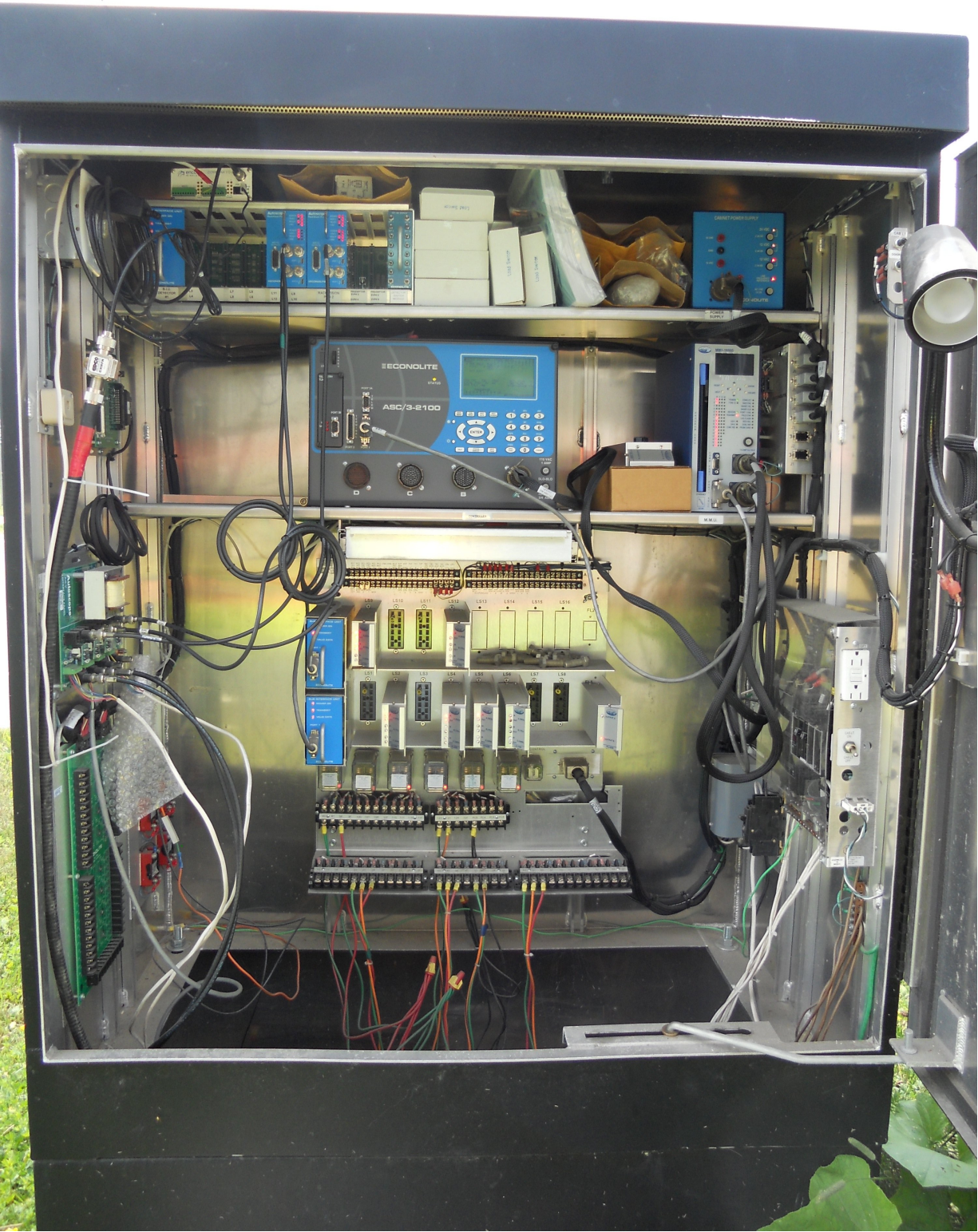

QUANTITY	
2	
1	
5	
2	
1	
3	
7	
3	

PHASE	1	2	3	4	5	6	7	8	9
TRAFFIC MOVEMENT	→	↓	↖	←					
MINIMUM GREEN	8	8	5	8					
MAXIMUM 1 GREEN	35	13	10	19					
MAXIMUM 2 GREEN	34	14	8	20					
MAXIMUM 3 GREEN	37	11	15	16					
YELLOW CLEARANCE	4	4	4	4					
ALL RED CLEARANCE	2	2	2	2					
VEH. EXTENSION	2	2	2	2					
WALK (MAN)									7
PED CLEAR (HAND)									14

CONTROLLER TO OPERATE MAXIMUM 2 GREEN TIMINGS FROM 6:00AM-9:00AM
 CONTROLLER TO OPERATE MAXIMUM 1 GREEN TIMINGS FROM 9:00AM-3:00PM & 6:00PM-6:00AM
 CONTROLLER TO OPERATE MAXIMUM 3 GREEN TIMINGS FROM 3:00PM-6:00PM

SIGNAL SYSTEM, INTERSECTION

678.25 PULL BOX, STANDARD

STA 14+040.00 RT PB1
 STA 14+040.00 LT PB2
 STA 4+808.53 RT PB3

678.30 ELECTRICAL CONDUIT SLEEVE (200MM) (PVC) (SCH 80)

STA 14+040.00 LT - 14+040.00 RT
 STA 4+810.31 LT - 4+808.56 RT

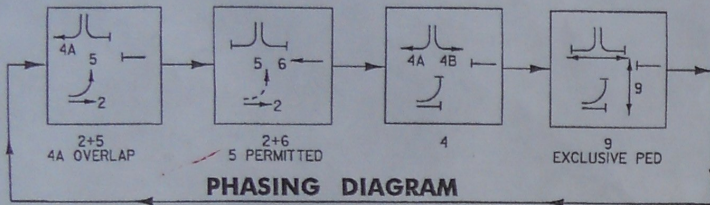

678.23 - WIRED CONDUIT	CONDUIT SIZE	DESCRIPTION
POWER TO STANCHION	50mm	
STANCHION TO CONTROLLER	17.0M	*POWER
CONTROLLER TO PB1	5.1M	POWER
PB1 TO PB2	19.2M (2x9.6M)	POWER/VIDEO
MA1 TO PB2	45.0M (2x22.5M)	POWER/VIDEO
PED1 TO PB1	9.4M (2x4.7M)	POWER/VIDEO
PED2 TO PB1	4.1M	POWER
PB3 TO PB1	6.9M	POWER
PED3 TO PB3	47.6M (2x23.8M)	POWER/VIDEO
MA2 TO PB3	3.9M	POWER
SUBTOTALS	13.2M (2x6.6M)	POWER/VIDEO
ROUNDING		171.4 M
TOTALS		3.6 M
		175.0 M

*-CONDUIT QUANTITY INCLUDES PVC RUN ON UTILITY POLE

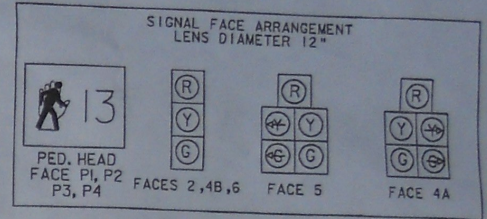

ALL HEADS TO BE LED'S

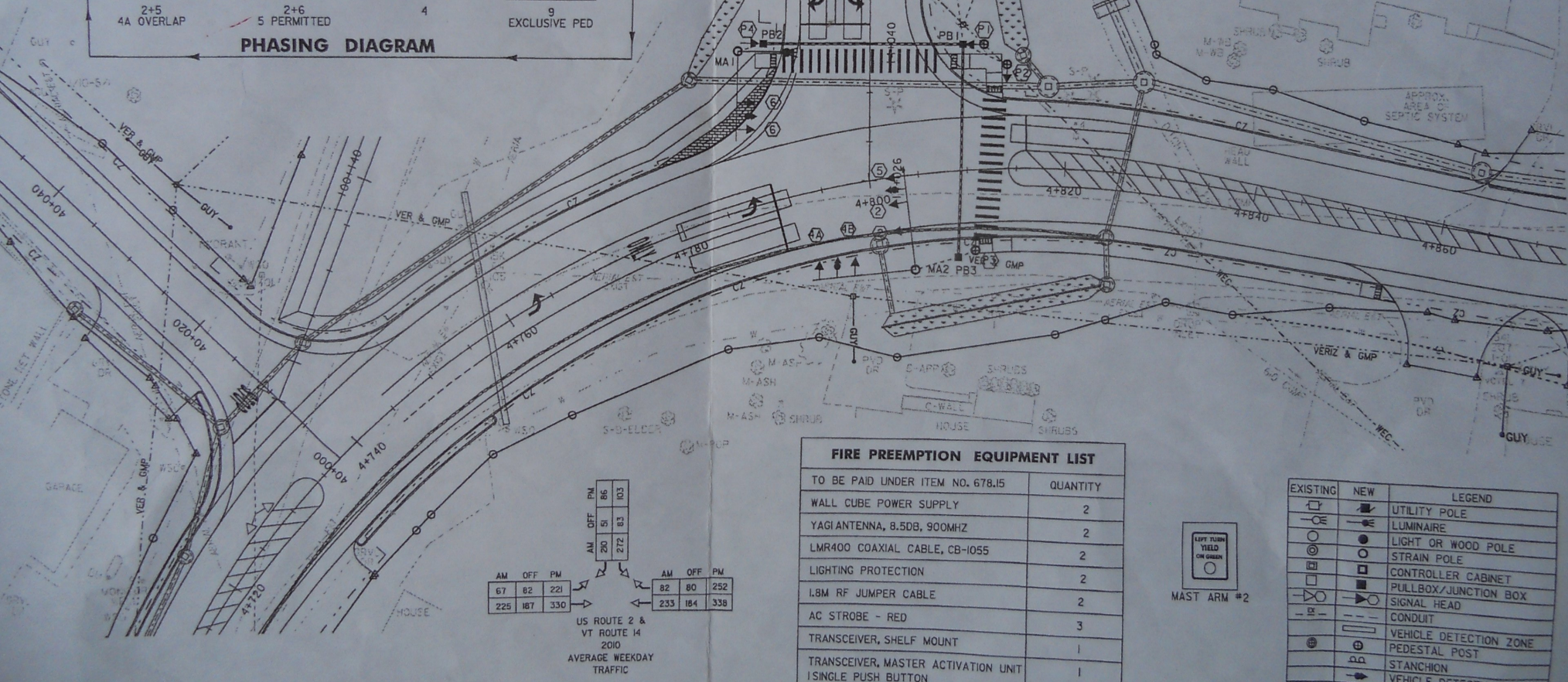

AM	OFF	PM
67	82	221
225	187	330

AM	OFF	PM
200	151	86
272	183	103

AM	OFF	PM
82	80	252
233	164	338

US ROUTE 2 & VT ROUTE 14
 2010
 AVERAGE WEEKDAY TRAFFIC

FIRE PREEMPTION EQUIPMENT LIST	
TO BE PAID UNDER ITEM NO. 678.15	QUANTITY
WALL CUBE POWER SUPPLY	2
YAGI ANTENNA, 8.5DB, 900MHZ	2
LMR400 COAXIAL CABLE, CB-1055	2
LIGHTING PROTECTION	2
LBM RF JUMPER CABLE	2
AC STROBE - RED	3
TRANSCEIVER, SHELF MOUNT	1
TRANSCEIVER, MASTER ACTIVATION UNIT	1
SINGLE PUSH BUTTON	



EXISTING	NEW	LEGEND
○	○	UTILITY POLE
—	—	LUMINAIRE
○	○	LIGHT OR WOOD POLE
○	○	STRAIN POLE
□	□	CONTROLLER CABINET
□	□	PULLBOX/JUNCTION BOX
○	○	SIGNAL HEAD
—	—	CONDUIT
○	○	VEHICLE DETECTION ZONE
○	○	PEDESTAL POST
○	○	STANCHION
○	○	VEHICLE DETECTION CAMERA



MILBANK
TYPE 3R ENCLOSURE



MILBANK MFG. CO.
TYPE 3R ENCLOSURE
TO RESET BREAKER
PULL UP ON THIS HANDLE
UNTIL IT IS FULLY OPEN
AND HOLD IT OPEN FOR
SEVERAL MINUTES
BEFORE CLOSING IT
AGAIN

SERVICE DISCONNECT



SIGNAL

LUMINAIR

⚡ DANGER / PELIGRO
HAZARD OF ELECTRICAL SHOCK OR BURN
SERVICES BY UTILITY AUTHORIZED PERSONNEL ONLY
DO NOT PULL COVER OR REMOVE THIS LABEL
PELIGRO DE DESCARGA ELÉCTRICA O QUEMADURA
SOLAMENTE PERSONAL AUTORIZADO DE LA COMPAÑIA
ELÉCTRICA PUEDE MANTENER
NO PULSE CUBRILLO NI QUITAR ETIQUETA

EAST

WEST

SOUTH

2

2

VERMONT
14

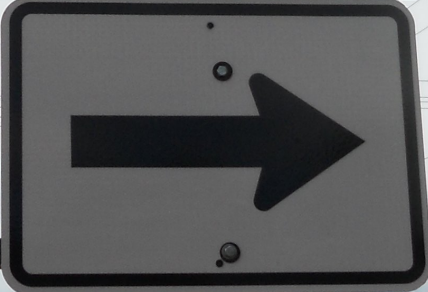
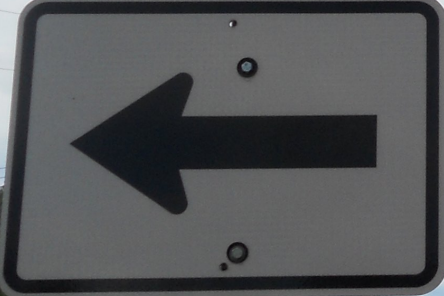



ONLY ONLY

ONLY

ONLY

















ONLY







LEFT TURN
YIELD
ON GREEN



LEFT TURN
YIELD
ON GREEN



U.M.C.

POLE: 3E-15.00" X 22'0"

ARM: 3E-12.00" X 39'0"

ARM" 7E-11.00" X 35'0"

55 K.S.I

12/2010



WEST	SOUTH	NORTH
VERMONT	VERMONT	VERMONT
2	14	14
↑	↑	→

















U.M.C.
POLE: 7E-12.25" X 36'0"
ARM: 7E-8.50" X 30'0"
55 K.S.I
12/2010

Date: 08/10/2012

Timing Data:

Phase	1	2	3	4	5	6	7	8	9
Phases in use									
Min Green	5	25	5	5	5	25	5	5	5
Walk	0	0	0	0	0	0	0	0	7
Ped Clr	0	0	0	0	0	0	0	0	14
Veh Ext	2	10	0	2	2	10	2	2	5
MAX 1	35	45	35	8	10	45	35	35	35
MAX 2	40	34	40	14	8	20	40	40	40
MAX 3	0	37	0	11	15	16	0	0	0
Yellow	3	4	3	4	4	4	3	3	0
All Red	1	2	1	2	2	2	1	1	0
Recall to Max	0	0	0	0	0	0	0	0	0

Coordination Patterns: ACS3/Naztec

Pattern 1									
Cycle Length	Offset		COS						
Splits	Ph 1		Ph 2		Ph 3		Ph 4		
	Ph 5		Ph 6		Ph 7		Ph 8		
	Ph 9		Ph 10		Ph 11		Ph 12		
Pattern 2(21)									
Cycle Length	Offset		COS						
Splits	Ph 1		Ph 2		Ph 3		Ph 4		
	Ph 5		Ph 6		Ph 7		Ph 8		
	Ph 9		Ph 10		Ph 11		Ph 12		
Pattern 3									
Cycle Length	Offset		COS						
Splits	Ph 1		Ph 2		Ph 3		Ph 4		
	Ph 5		Ph 6		Ph 7		Ph 8		
	Ph 9		Ph 10		Ph 11		Ph 12		

Day Plan [1]

Event	Action Plan	Step Begins
1	1	0600
2	3	0900
3	2	1500
4	3	1800

Day Plan [2]

Event	Action Plan	Step Begins

Day Plan [3]

Event	Action Plan	Step Begins

Action Plan

Action Plan	Pattern
1	1
2	2
3	3