

MS # 579

VT 2A NORTH

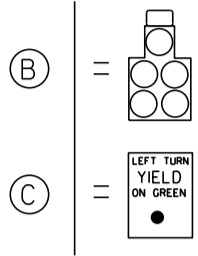
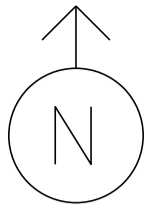

- ⊙ PEDESTAL POST
- ⊙→ PEDESTRIAN SIGNAL
- ⊠ CONTROL BOX
- MAST ARM
- ⊥ COORDINATION
- ⋯ LOOP DETECTION
- ⊠ JB JUNCTION BOX
- ⊙— LUMINAIRE
- STANCHION

BLAIR PARK

ZEPHYR LANE

VT 2A SOUTH

NOT TO SCALE

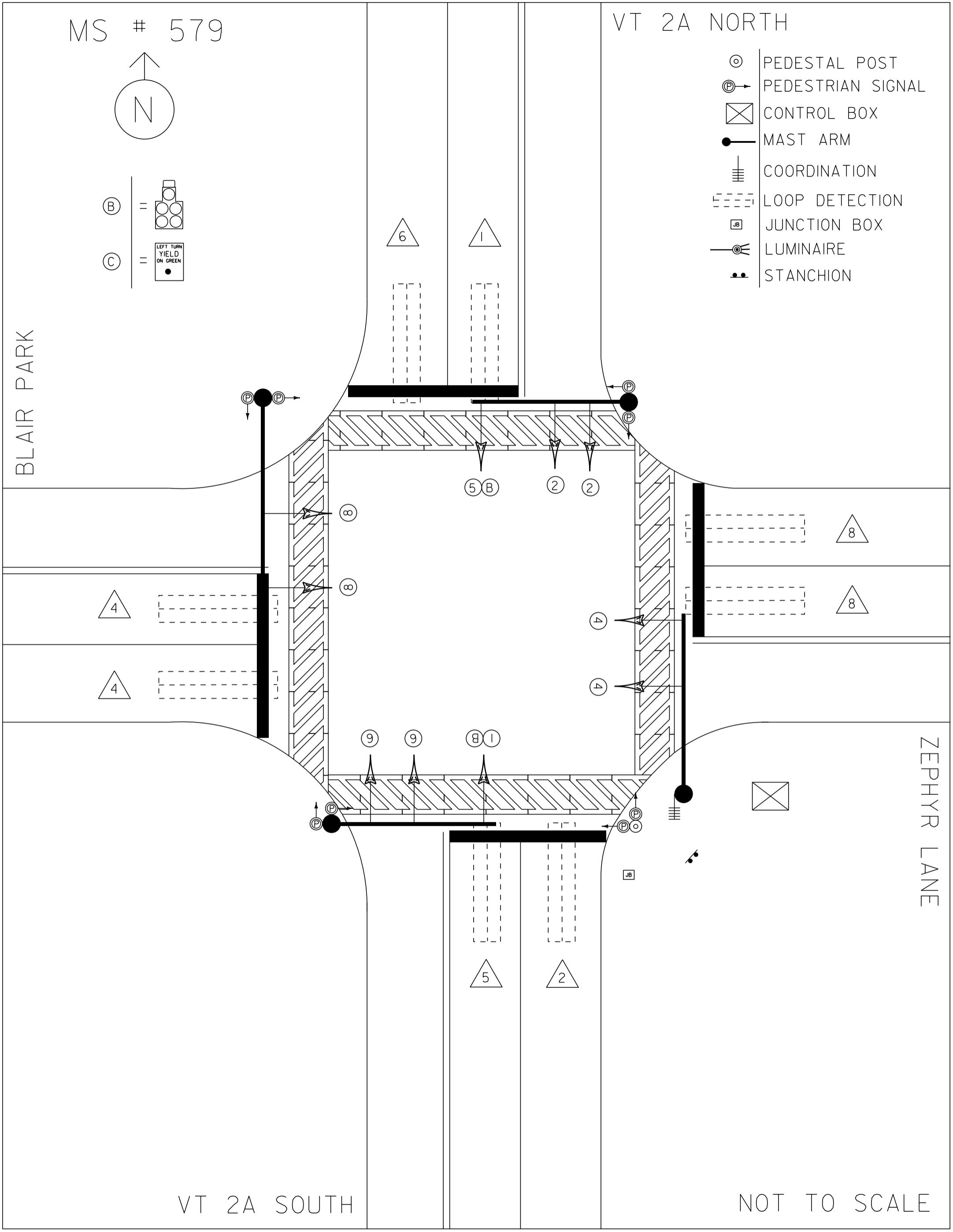

MS # 579

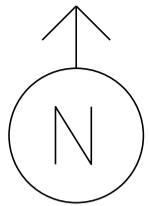

12'

10'

11'

VT 2A NORTH

LANE LINE 155'

STOP BAR 34'

BLAIR PARK

CROSSWALK 70'

14'

STOP BAR 16'

10'

LANE LINE 40'

12'

STOP BAR 12'

11'

LANE LINE 75'

STOP BAR 12'

CROSSWALK 75'

10'

STOP BAR 12'

15'

CROSSWALK 75'

ZEPHYR LANE

STOP BAR 24'

LANE LINE 180'

VT 2A SOUTH

12'

10'

12'

NOT TO SCALE

<p style="text-align: center;">D I A G R A M</p> <p style="text-align: center;">N ↑</p>				
<p style="text-align: center;">T I M I N G</p>	<p>G = Y =</p>	<p>G = Y =</p>	<p>G = Y =</p>	<p>G = Y =</p>
<p style="text-align: center;">D I A G R A M</p>				
<p style="text-align: center;">T I M I N G</p>	<p>G = Y =</p>	<p>G = Y =</p>	<p>G = Y =</p>	<p>G = Y =</p>

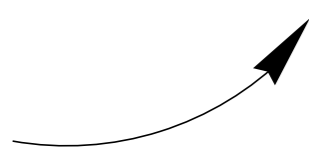

PROTECTED
TURNS

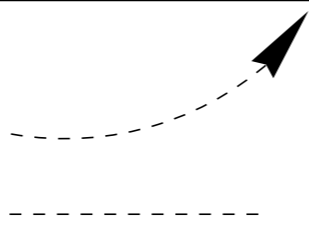

PERMITTED
TURNS
PEDESTRIAN

CYCLE LENGTH, C = _____ S



PROPERTY OF :
VT. AGENCY OF TRANS.
MAINTENANCE DIV.
IN EMERGENCY CALL :
DIST. TRANS. OFFICE
655 - 1580 COLCHESTER
NIGHTS & WEEKENDS : 878-7111
INTERSECTION NO. MS-579

DANGER
115 VOLTS A.C.

WARNING
DO NOT OPERATE
CABINET WITHOUT
CMU / MMU

1441162

CONTROL EQUIP. ON

CONTROL EQUIP. OFF

AUTO

FLASH

STOP TUNING AUTO

STOP TUNING ON

ECONOLITE

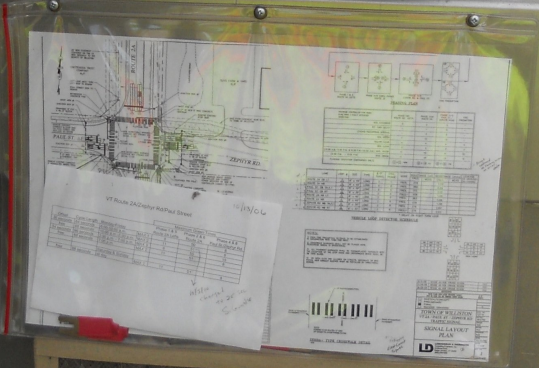

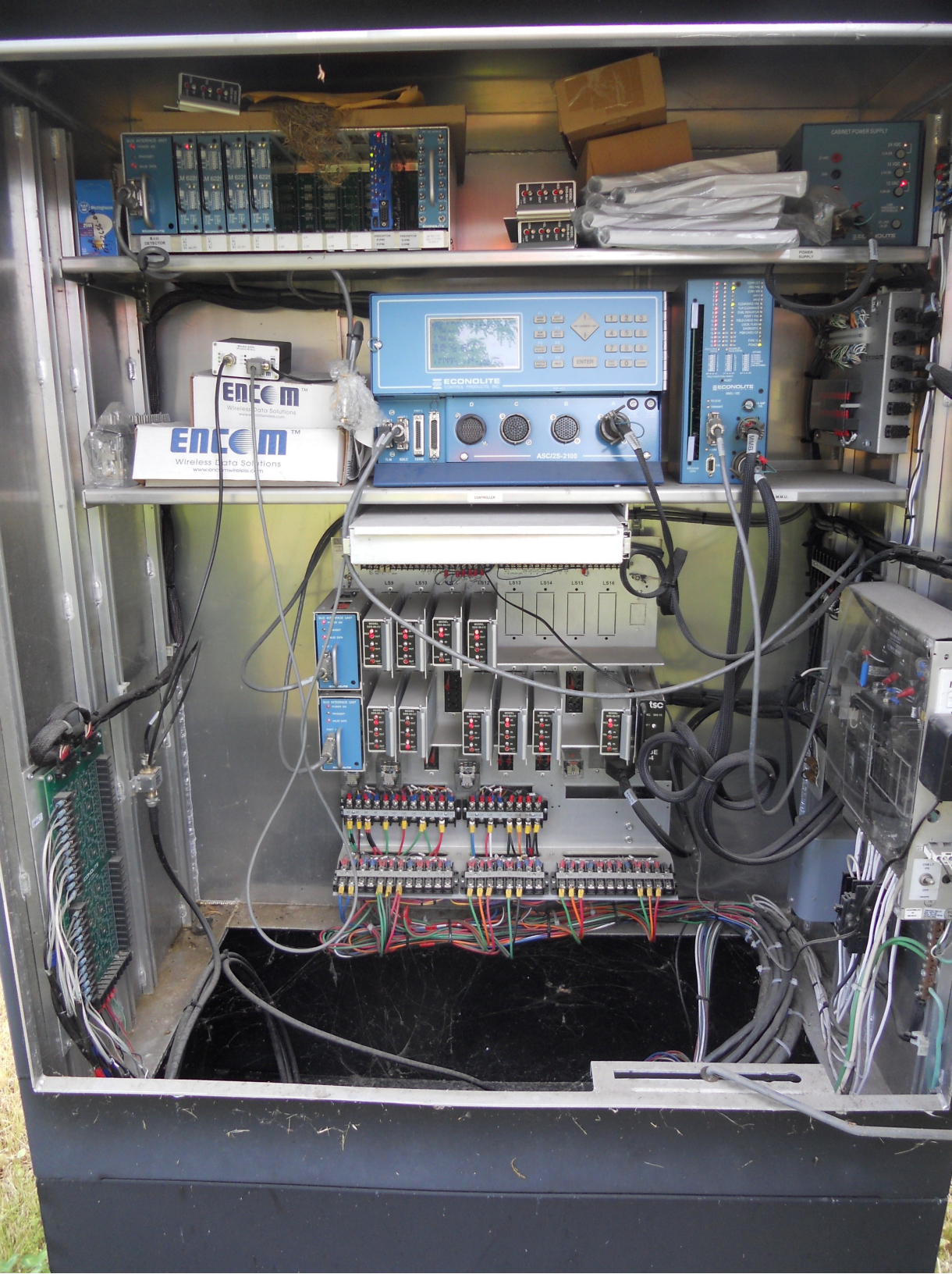

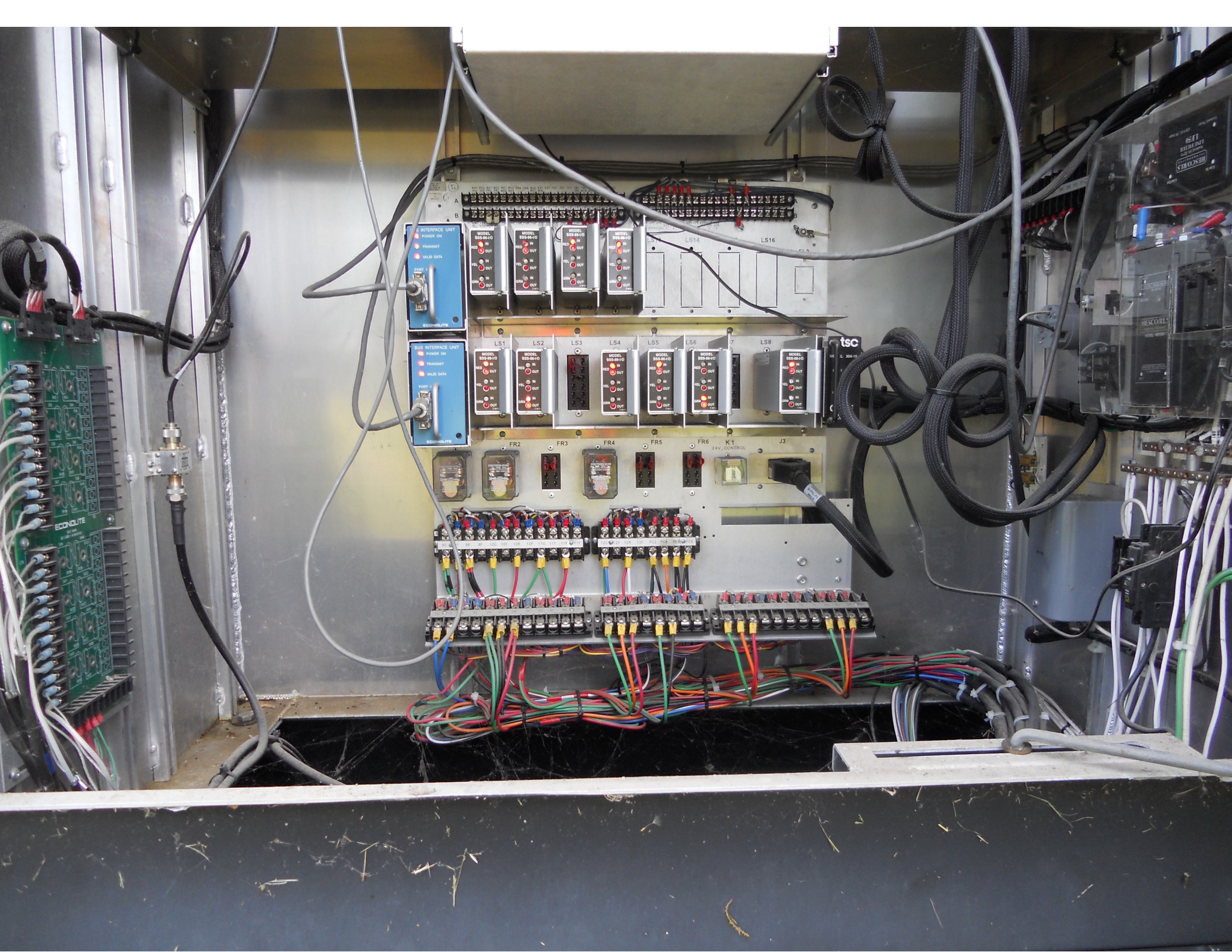









SPEED LIMIT
25

LEGAL LOAD
LIMIT
24000
POUNDS

Paul St

John
Lester

Paul St

ES-889



Paul St

Paul St





B
U
S

TO OPERATE
PUSH BUTTON

- WHEELCHAIR ACCESSIBLE
- VISUALLY IMPAIRED
- HEARING IMPAIRED







100' HA
BENTLEY FORST
QUAD 14' HA
30' HUR
20'



GUY'S
A TOWN AND VILLAGE
WALKING DISTANCE

Blair
Park

ONLY

ONLY



LEFT LANE
MUST
TURN LEFT

LANE

Pond St

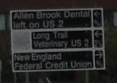











PLANTIA
SOCIETÀ ITALIANA
SOCIETÀ ITALIANA
BY LOMB
10A

















LEFT LANE
MUST
TURN LEFT

ONLY

Zephyr Rd

Bus

LEFT TURN
YIELD
ON GREEN











PLATE WITH ENGRAVED TEXT ON A BLACK POST



Coordination Patterns

 Pattern 1

Cycle Length . . . 84 COS 111
 Offset 36
 Vehicle Permissive . . [1] 0 [2] 0
 Vehicle Perm 2 Displacement 0 Phase Reservice. . NO
 Splits: Phase 1- 14 2- 56 3- 0 4- 14
 Phase 5- 14 6- 56 7- 0 8- 14
 Phase 9- 14 10- 14 11- 14 12- 14 Split Sum: 0
 Split Extension/Ring [1] 0 [2] 0
 Split Demand Pattern [1] 0 [2] 0
 XRT Pattern. . . 0
 Phase Number: 1 2 3 4 5 6 7 8 9 10 11 12
 Coord Phases . . . X . . . X
 Veh Recall
 Veh Max Recall . . X . . . X
 Ped Recall
 Veh Omit
 Alt Sequence . . A: . B: . C: . D: . E: . F: .

Pattern 3

Cycle Length . . . 96 COS 311
 Offset 34
 Vehicle Permissive . . [1] 0 [2] 0
 Vehicle Perm 2 Displacement 0 Phase Reservice. . NO
 Splits: Phase 1- 14 2- 61 3- 0 4- 21
 Phase 5- 14 6- 61 7- 0 8- 21
 Phase 9- 14 10- 14 11- 14 12- 14 Split Sum: 0
 Split Extension/Ring [1] 0 [2] 0
 Split Demand Pattern [1] 0 [2] 0
 XRT Pattern. . . 0
 Phase Number: 1 2 3 4 5 6 7 8 9 10 11 12
 Coord Phases . . . X . . . X
 Veh Recall
 Veh Max Recall . . X . . . X
 Ped Recall
 Veh Omit
 Alt Sequence . . A: . B: . C: . D: . E: . F: .

NIC Program Steps

Step	Program	Step Begins	Pattern	Override
1	1	0600	1	NO
2	1	1000	2	NO
3	1	1430	3	NO
4	1	1900	2	NO
5	2	0000	2	NO
6	3	0000	2	NO

TOD Program Steps

 Step 3 Program 1 Step Begins 1430

Flash. Dimming Enable.
 Red Rest Alt Veh Extension
 Spare 5. Det Log Enable.
 Spare 3. Spare 4
 Type 0 Dly Enable. . . Spare 2
 Det Diag Plan. . . . 0

Phase Number

	1	2	3	4	5	6	7	8	9	10	11	12
Max 2 Enable
Max 3 Enable	X	X	.	X	X	X	.	X	X	X	X	X
Veh Recall
Veh Max Recall
Ped Recall
Cond Service Inhibit.
Phase Omit
Special Function

A B C D E F

Alt Sequence

Step 4 Program 1 Step Begins 1900

Flash. Dimming Enable.
 Red Rest Alt Veh Extension
 Spare 5. Det Log Enable.
 Spare 3. Spare 4
 Type 0 Dly Enable. . . Spare 2
 Det Diag Plan. . . . 0

Phase Number

	1	2	3	4	5	6	7	8	9	10	11	12
Max 2 Enable	X	X	.	X	X	X	.	X	X	X	X	X
Max 3 Enable
Veh Recall
Veh Max Recall
Ped Recall
Cond Service Inhibit.
Phase Omit
Special Function

A B C D E F

Alt Sequence

TOD Program Steps

 Step 5 Program 2 Step Begins 0000

Flash. Dimming Enable.
 Red Rest Alt Veh Extension
 Spare 5. Det Log Enable.
 Spare 3. Spare 4
 Type 0 Dly Enable. . . Spare 2
 Det Diag Plan. . . . 0

Phase Number

	1	2	3	4	5	6	7	8	9	10	11	12
Max 2 Enable	X	X	.	X	X	X	.	X	X	X	X	X
Max 3 Enable
Veh Recall
Veh Max Recall
Ped Recall
Cond Service Inhibit.
Phase Omit
Special Function

Alt Sequence A B C D E F

Step 6 Program 3 Step Begins 0000

Flash. Dimming Enable.
 Red Rest Alt Veh Extension
 Spare 5. Det Log Enable.
 Spare 3. Spare 4
 Type 0 Dly Enable. . . Spare 2
 Det Diag Plan. . . . 0

Phase Number

	1	2	3	4	5	6	7	8	9	10	11	12
Max 2 Enable	X	X	.	X	X	X	.	X	X	X	X	X
Max 3 Enable
Veh Recall
Veh Max Recall
Ped Recall
Cond Service Inhibit.
Phase Omit
Special Function

Alt Sequence A B C D E F
