

**LIGHTING ITEMS**

**ITEM 678.26 - JUNCTION BOX**

383+13, 37' RT (L-30)  
 384+28, 48' LT (L-31)  
 384+35, 45' RT (L-32)

**SIGNAL ITEMS**

**ITEM 678.27 - PULLBOX - DOUBLE**

383+16, 34' RT (S-9)  
 384+12, 48' LT (S-10A)

**ITEM 678.27 (MOD.) - PULLBOX - DOUBLE**

384+27, 38' RT (S-10)

**SLEEVE LOCATIONS**

383+24, 34.2' RT. - 384+09, 37.0' RT.  
 384+12, 44.2' LT. - 384+21, 34.7' RT.

**383+38, 54' LT - 383+75, 54' LT**

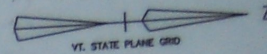

FROM	TO	ITEM 678.20 (MOD.) INTERCONNECT CONDUIT	ITEM 678.21 ELECTRICAL CONDUIT	ITEM 678.23 WIRED CONDUIT		ITEM 678.30 ELECTRICAL CONDUIT SLEEVE		DESCRIPTION
				2"	2 1/2"	6"	12"	
CANTILEVER #2	PB S-9			27				SIGNAL
LOOP #1	PB S-9			2				LOOP #1
PB S-9	PB S-10			110				INTERCONNECT
PB S-9	CONTROLLER	110						SIGNAL
PB S-9	PB S-10			110				SPARE
PB S-9	PB S-10						85	SOUTH BURLINGTON LIGHTING
PB S-9	PB S-10							VAOT LIGHTING
JB L-30	JB L-32			127				SIGNAL
CANTILEVER #1	PB S-10A			93				LOOP #4 / PRE-EMPTION
CANTILEVER #1	PB S-10A			93			37	SIGNAL
CANTILEVER #1	LOOP #4			20				LOOP #4
CANTILEVER #1	PB S-10			38				VAOT LIGHTING
CANTILEVER #3	PB S-10			38				SIGNAL
CANTILEVER #3	PB S-10A			17				SIGNAL
PED POLE	PB S-10A			3				LOOP #5
LOOP #5	PB S-10A			117				SOUTH BURLINGTON LIGHTING
JB L-31	JB L-32			87				LOOP #4, #5 / PRE-EMPTION
PB S-10A	PB S-10			87				VAOT LIGHTING
PB S-10A	PB S-10			87				VAOT LIGHTING
PB S-10A	PB S-10			87				SIGNAL
PB S-10A	PB S-10			87			82	SPARE
CANTILEVER #4	PB S-10			13				PRE-EMPTION
CANTILEVER #4	PB S-10			13				VAOT LIGHTING
CANTILEVER #4	PB S-10			13				SIGNAL
PB S-10	CONTROLLER			23				LOOP #1, #4 & #5 / PRE-EMPTION
PB S-10	CONTROLLER			23				SIGNAL
PB S-10	LIGHT POLE V1			50				VAOT LIGHTING
LOOP #A & B	CONTROLLER			33				LOOP #A & B
STANCHION	PB S-10			21				VAOT LIGHTING
STANCHION	JB L-33			6				SOUTH BURLINGTON LIGHTING
STANCHION	CONTROLLER			25				SIGNAL
POWER SOURCE	STANCHION			40				SOUTH BURLINGTON LIGHTING
POWER SOURCE	STANCHION			40				SIGNAL / VAOT LIGHTING
CONTROLLER	JB L-30	74						INTERCONNECT
<b>TOTAL</b>		<b>164</b>	<b>197</b>	<b>1278</b>	<b>80</b>		<b>204</b>	

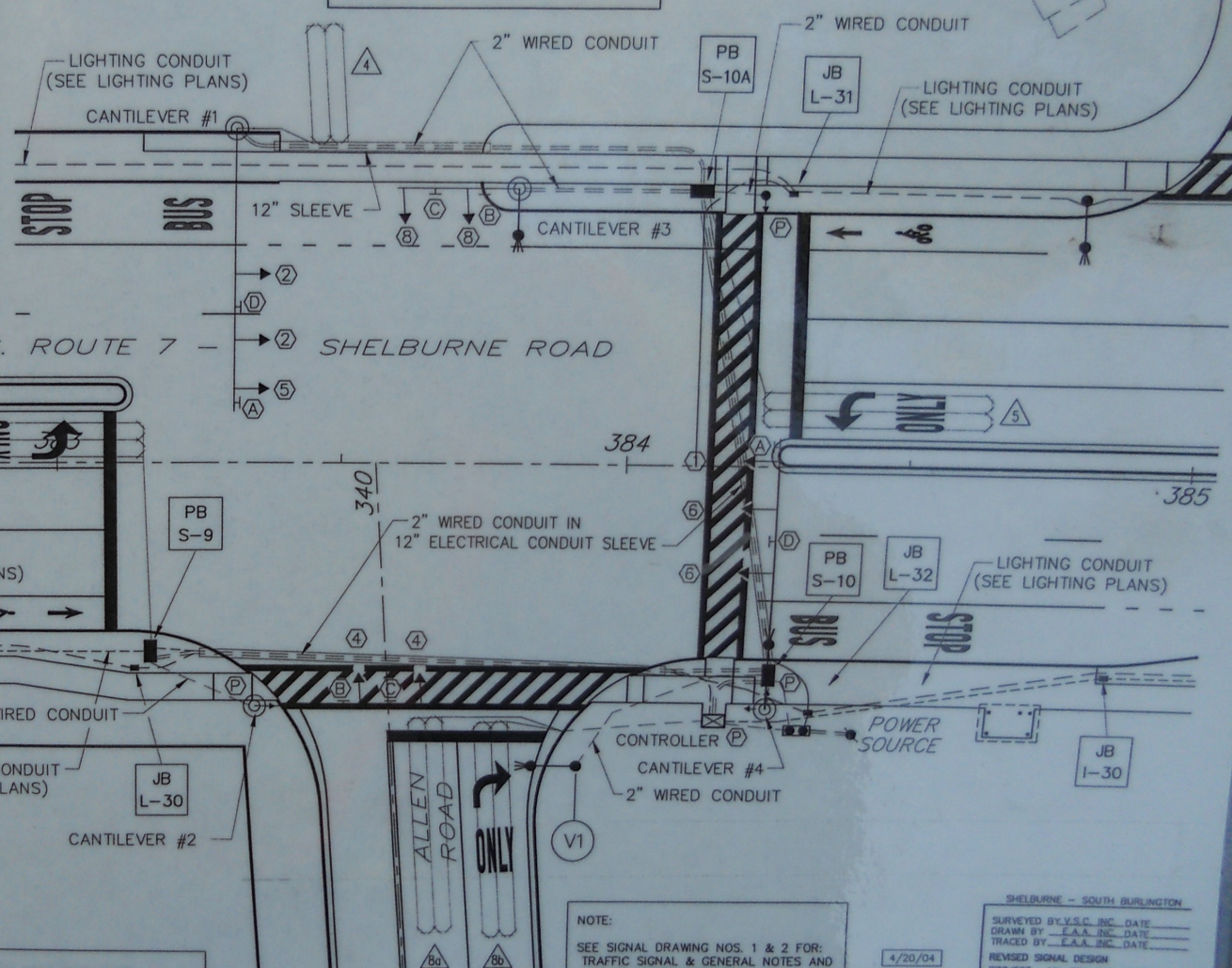

DATUM VERTICAL: NVD 1929  
 HORIZONTAL: NAD 1927

**INTERSECTION NO. MS-515 (US 7 - ALLEN ROAD)**

**NOTE:**  
 SEE SIGNAL DRAWING NOS. 1 & 2 FOR: TRAFFIC SIGNAL & GENERAL NOTES AND LIST OF MAJOR EQUIPMENT.

4/20/04  
 SCALE IN FEET  
 0 10 20

SHELburne - SOUTH BURLINGTON  
 SURVEYED BY: V.S.C. INC. DATE  
 DRAWN BY: E.A.A. INC. DATE  
 TRACED BY: E.A.A. INC. DATE  
 REVISED SIGNAL DESIGN  
 PROJECT: NH-ECC-019-4(28)  
 SIGNAL DRAWING NO. 3  
 SHEET NO. 128A OF 283