

MS # 312

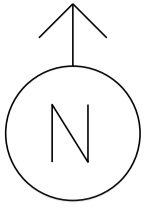

US 4 WEST

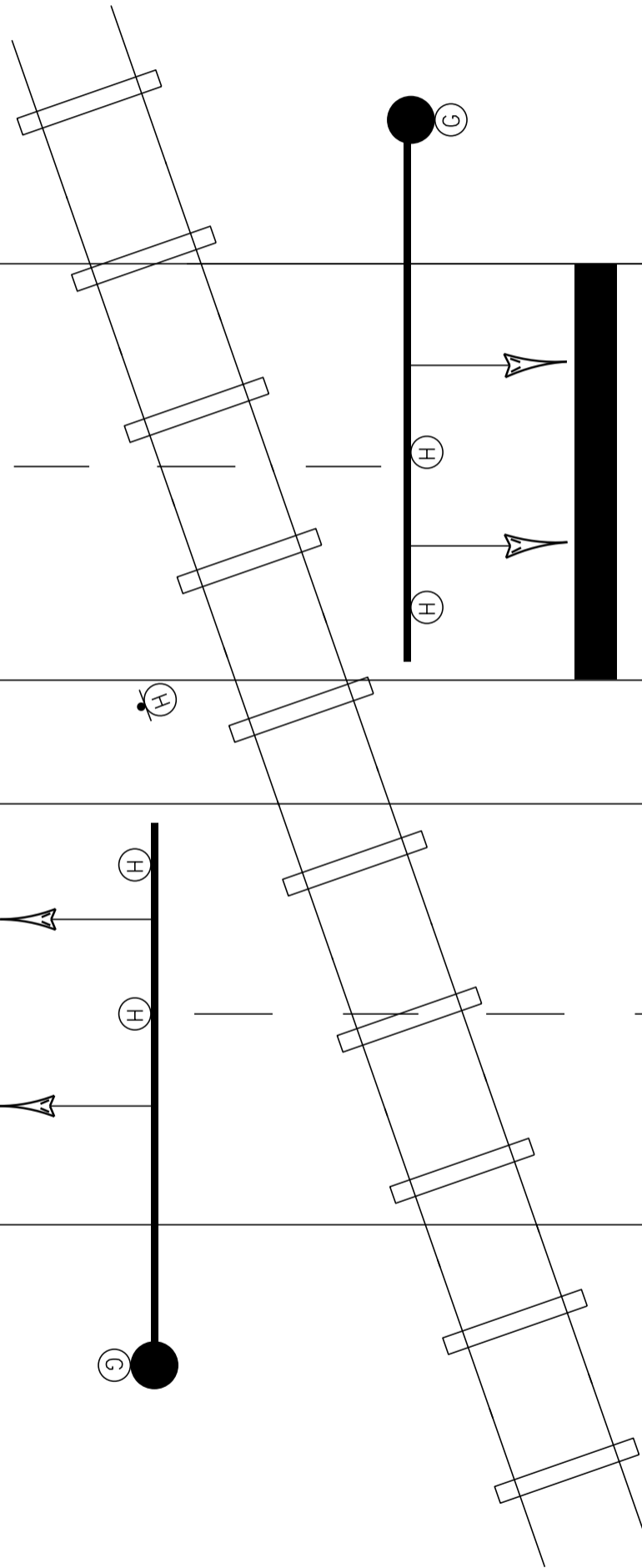

CONTROL BOX

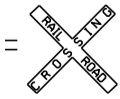

US 4 EAST

NOT TO SCALE

MS # 312

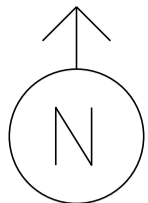

US 4 WEST

12'

12'

12'

12'

STOP BAR 24'

12'

12'

12'

12'

STOP BAR 24'

US 4 EAST

NOT TO SCALE

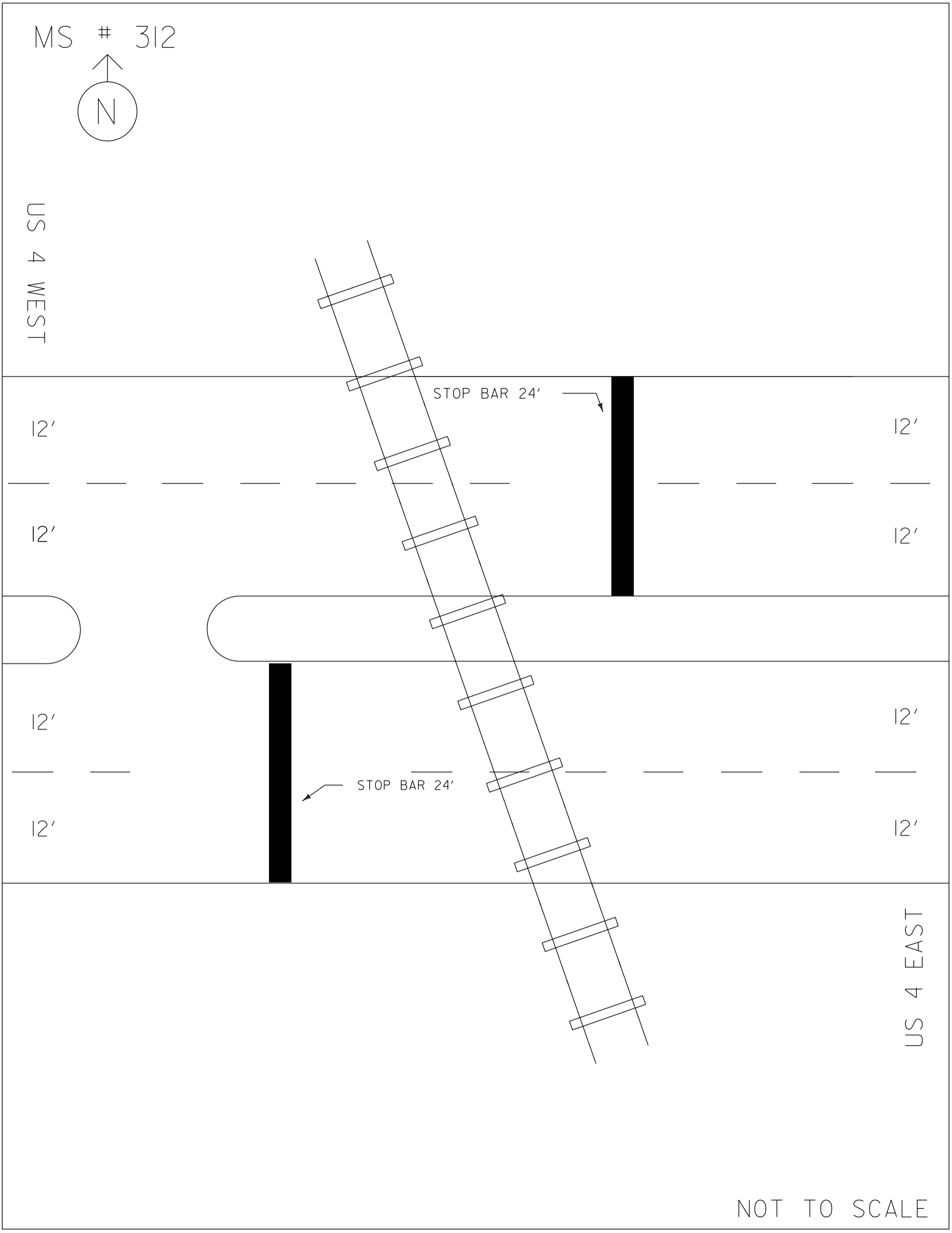

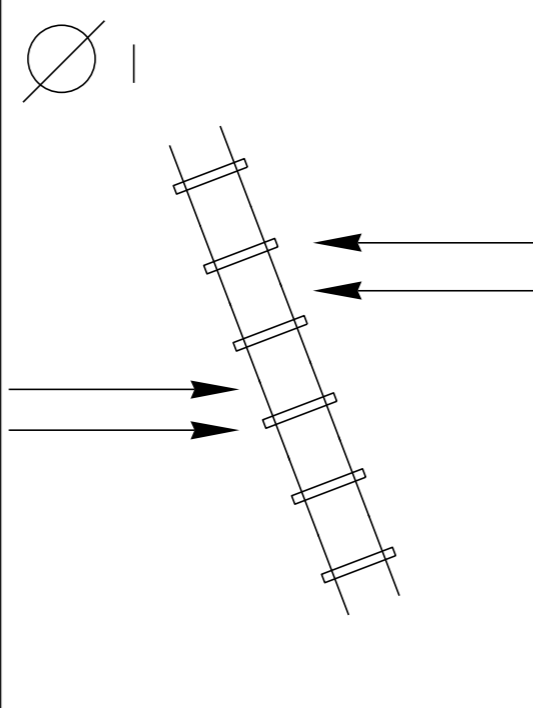
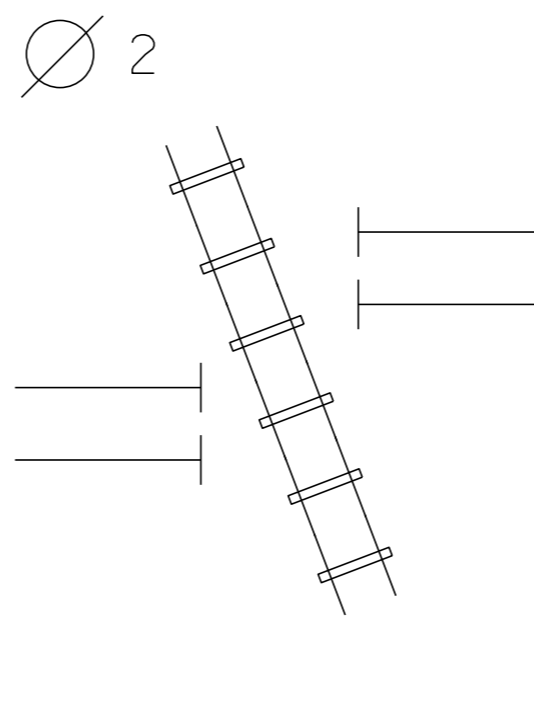
<p style="text-align: center;">D I A G R A M</p> 	<p>∅ 1</p> 	<p>∅ 2</p> 	<p>∅ 3</p>	<p>∅ 4</p>
<p>TIMING</p>	<p>G = Y =</p>	<p>G = Y =</p>	<p>G = Y =</p>	<p>G = Y =</p>
<p style="text-align: center;">D I A G R A M</p>	<p>∅ 5</p>	<p>∅ 6</p>	<p>∅ 7</p>	<p>∅ 8</p>
<p>TIMING</p>	<p>G = Y =</p>	<p>G = Y =</p>	<p>G = Y =</p>	<p>G = Y =</p>

 PROTECTED
TURNS

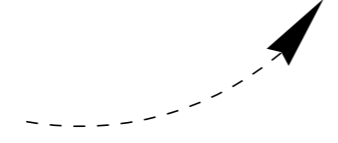
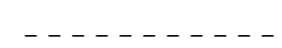

 PERMITTED
TURNS
PEDESTRIAN

CYCLE LENGTH, C= _____ S



 **ECONOLITE**
ANAHEIM, CALIFORNIA





WARNING
DO NOT OPERATE
CABINET WITHOUT
CONFLICT MONITOR UNIT

DA
115 V

100% AMP
700
140
70
115
ON TEMP
NO. F
ECONOLITE
44229

1
2
3
4
5
6

POWER

24V NO.1
24V NO.2
CONTROLLER
VOLTAGE
MONITOR
POWER
INTERRUPT
CONFLICT
RED FAILURE

RESET

POWER-UP
FLASH TIME

ED I
NOM-6L

PROG 1411 A.Z. 1002 1988 6407

KMC-6000

PHASE STATUS
1 2 3 4
STOP ● ● ● ●
NO CALL ● ● ● ●
NO CALL ● ● ● ●

RING STATUS
● RING 1
● RING 2
● RING 3
● RING 4
● RING 5
● RING 6
● RING 7
● RING 8
● RING 9
● RING 10

PHASE
RING 1 RING 2 RING 3

MODE SETTINGS
MODE 1
MODE 2
MODE 3
MODE 4
MODE 5
MODE 6
MODE 7
MODE 8
MODE 9
MODE 10

CAUTION
BEFORE ADJUSTING POWER TO
COMPUTERS, CHECK THAT ALL SIGNALS
ARE ON EITHER COMPUTER BATTERIES
OR THE POWER MONITOR BATTERY.
BOTH SIGNALS BE FLICKER INDICATED
ENTER OVER

ED I
NOM-6L

ECONOLITE
CONTROL PRODUCTS, INC.
HOUSTON, TX

TEST
PASS
FAIL

100% AMP
700
140
70
115
ON TEMP
NO. F

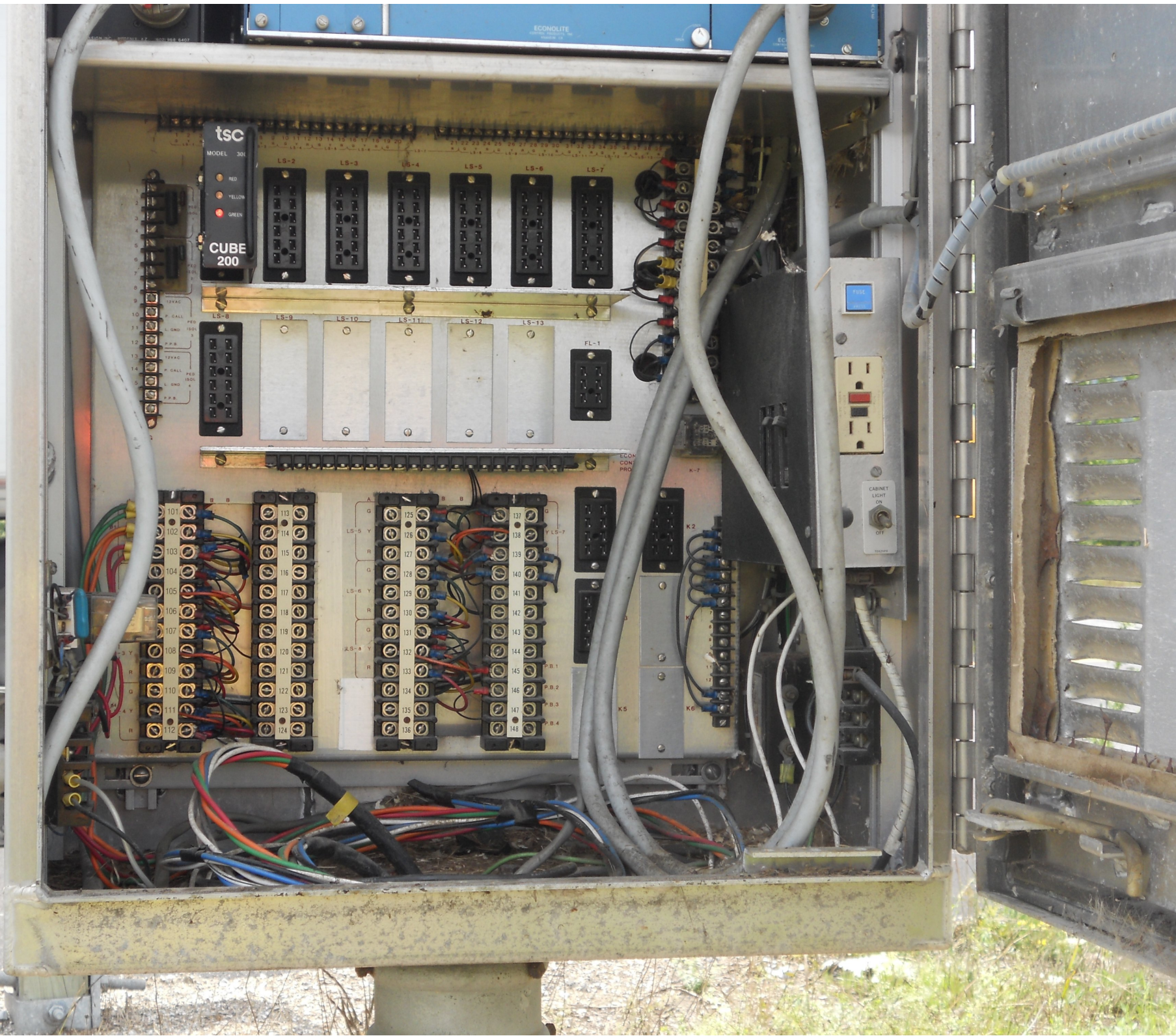

tsc

MODEL 301

- RED
- YELLOW
- GREEN

CUBE 200

LS-2

LS-3

LS-4

LS-5

LS-6

LS-7

LS-8

LS-9

LS-10

LS-11

LS-12

LS-13

FL-1

101

102

103

104

105

106

107

108

109

110

111

112

113

114

115

116

117

118

119

120

121

122

123

124

125

126

127

128

129

130

131

132

133

134

135

136

137

138

139

140

141

142

143

144

145

146

147

148

A

B

G

R

Y

A

B

G

R

Y

A

B

G

R

Y

A

B

G

R

Y

A

B

G

R

Y

P.B.1

P.B.2

P.B.3

P.B.4

ECOM

CON

PRO

K-7

K2

K5

K6

ECOMLITE

PASS

CABINET LIGHT ON

OFF





RAILROAD
CROSSING



RAILROAD
CROSSING



RAILROAD
CROSSING





RAILROAD CROSSING
CROSSROAD

RAILROAD CROSSING
CROSSROAD







RAILROAD
CROSSING



RAILROAD
CROSSING



65
40





RAILROAD
CROSSING

RAILROAD
CROSSING



65

40

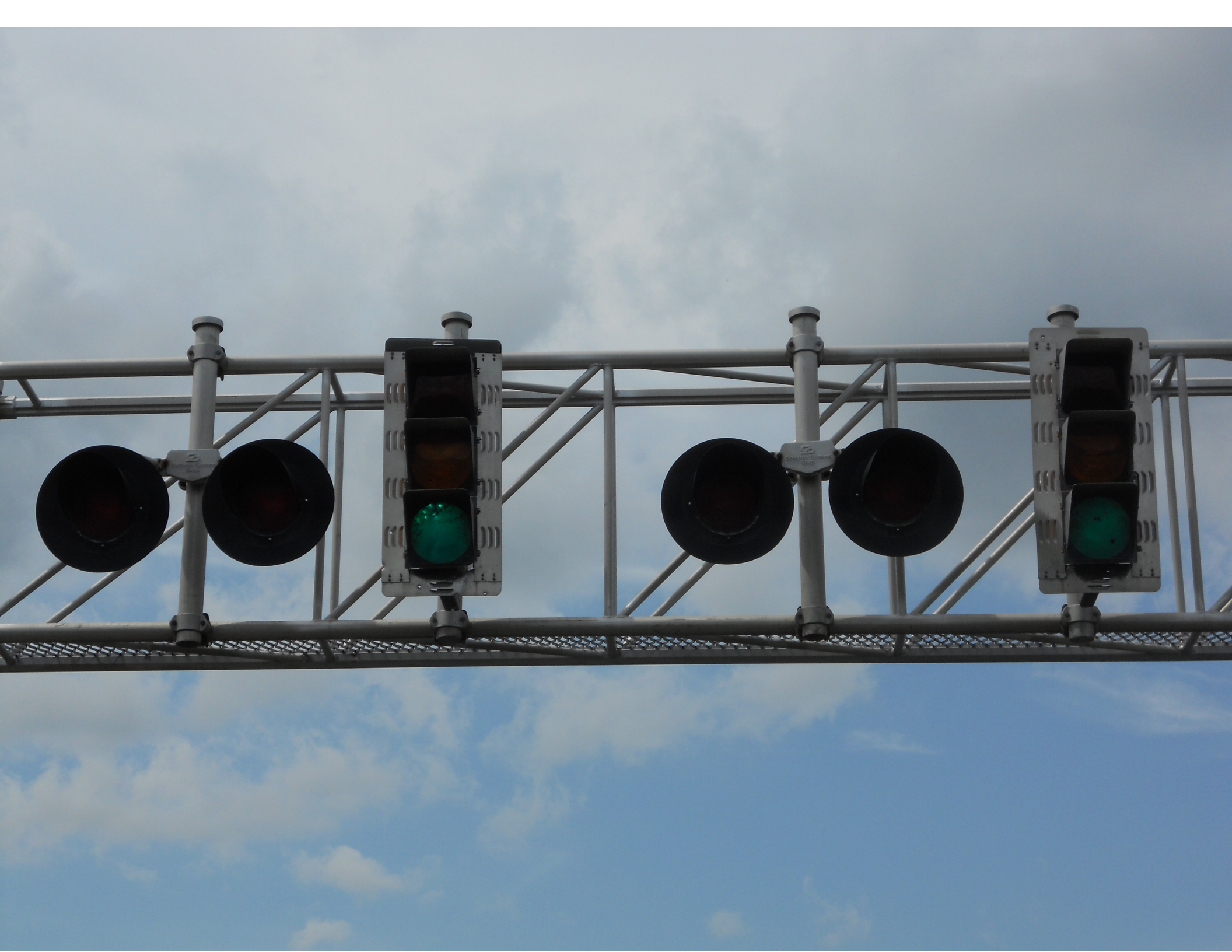

RAILROAD
CROSSING





RAILROAD
CROSSING
CROSS ROAD

RAILROAD
CROSSING
CROSS ROAD

65
40

NO U-TURN



