

NOTE: A TELEPHONE DROP IS TO BE INSTALLED IN CONTROLLER CABINET.

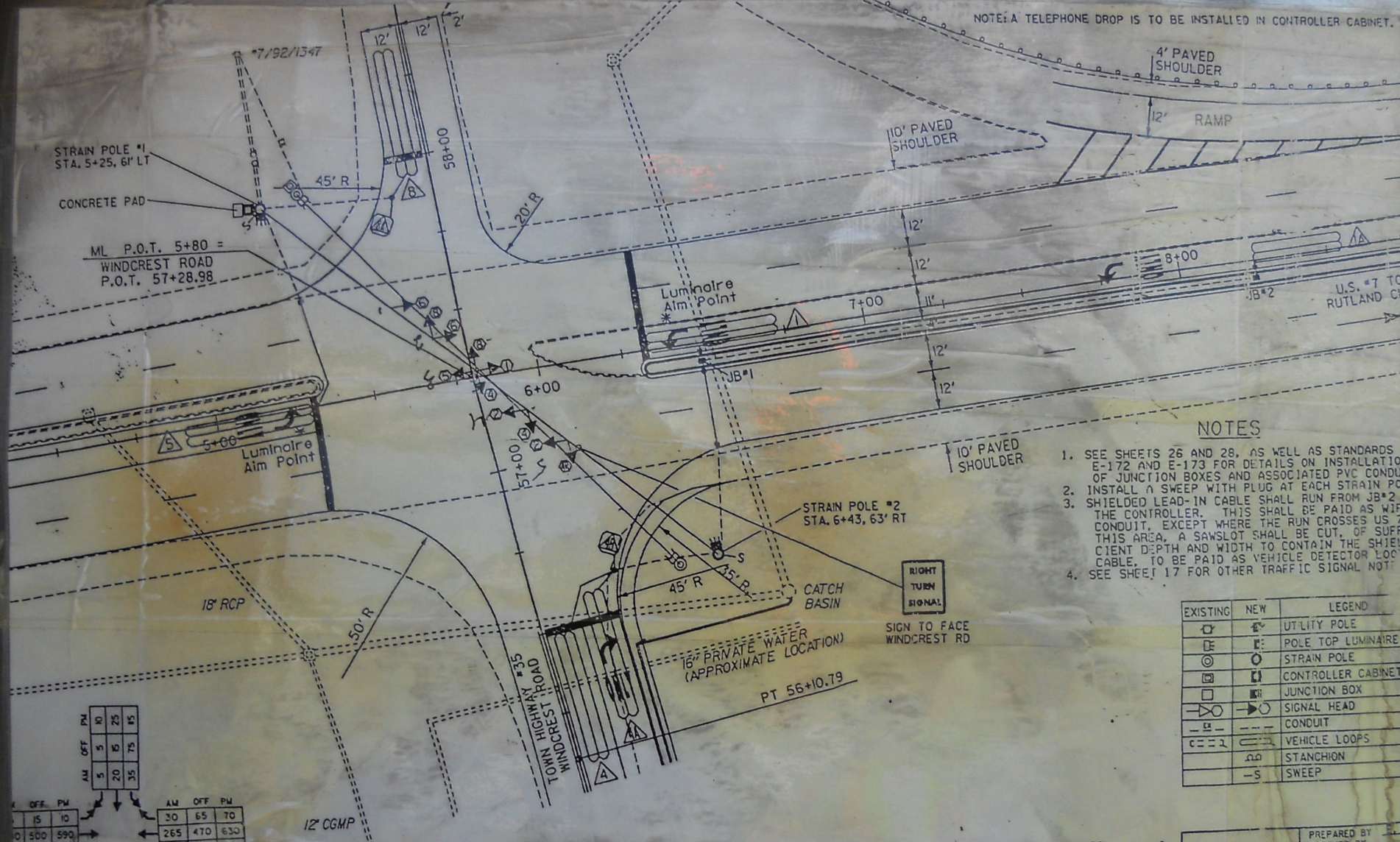

**NOTES**

1. SEE SHEETS 26 AND 28, AS WELL AS STANDARDS E-172 AND E-173 FOR DETAILS ON INSTALLATION OF JUNCTION BOXES AND ASSOCIATED PVC CONDUIT
2. INSTALL A SWEEP WITH PLUG AT EACH STRAIN POLE
3. SHIELDED LEAD-IN CABLE SHALL RUN FROM JB#2 TO THE CONTROLLER. THIS SHALL BE PAID AS WIRE CONDUIT, EXCEPT WHERE THE RUN CROSSES US 7. THIS AREA, A SAWSLOT SHALL BE CUT, OF SUFFICIENT DEPTH AND WIDTH TO CONTAIN THE SHIELDED CABLE, TO BE PAID AS VEHICLE DETECTOR LOOP
4. SEE SHEET 17 FOR OTHER TRAFFIC SIGNAL NOTES

EXISTING	NEW	LEGEND
		UTILITY POLE
		POLE TOP LUMINAIRE
		STRAIN POLE
		CONTROLLER CABINET
		JUNCTION BOX
		SIGNAL HEAD
		CONDUIT
		VEHICLE LOOPS
		STANCHION
		SWEEP

1994 AVERAGE WEEKDAY TRAFFIC

AM	OFF	PM	AM	OFF	PM
5	5	10	30	65	70
10	500	590	265	470	630
5	30	50	270	65	195

AM	OFF	PM	AM	OFF	PM
40	25	120	40	25	230
5	5	10	5	5	10
60			60		

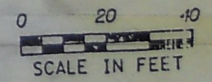

7/traf/91b22t/1b22tbd...  
 7b2210y-1  
 plotted: 29-DEC-1994

**TRAFFIC SIGNAL LAYOUT**

PREPARED BY: [Signature]  
 CHECKER BY: [Signature]  
 DESIGN SUPERVISOR: [Signature]  
 PROJ. NO. [Signature]  
 TRAFFIC SHEET NO. [Signature]  
 SHEET 14 OF [Signature]