

VEHICLE LOOP DETECTORS

170+70.3	LT	(6X6)	LOOP 6C
170+70.3	RT	(6X6)	LOOP 6A
172+55.8	LT	(6X6)	LOOP 6D
172+55.8	RT	(6X6)	LOOP 6B
175+45.3	LT	(6X40)	LOOP 1
176+13.0	LT	(6X40)	LOOP 4 (SQUIRE RD)
176+36.0	RT	(6X40)	LOOP 8 (VT103)
176+99.0	LT	(6X40)	LOOP 5
179+33.0	LT	(6X6)	LOOP 2B
179+33.0	LT	(6X6)	LOOP 2D
181+09.0	LT	(6X6)	LOOP 2A
181+09.0	LT	(6X6)	LOOP 2C

PULL BOXES)

170+81.3	RT	(PB*8)
172+56.3	RT	(PB*7)
175+66.0	LT	(PB*6)
176+88.5	LT	(PB*3)
176+88.5	LT	(PB*2)
176+88.5	LT	(PB*1)
179+31.0	LT	(PB*4)
181+07.0	LT	(PB*5)

REMOVE EXISTING STRAIN POLES AND HARDWARE

175+87.7	LT
176+65.0	RT

GROUND MOUNTED CABINET
176+76.5 RT (42')

UNDERGROUND POWER
FROM POLE 703-5-1 (177+64 RT)
TO STANCHION (176+84 RT)

POWER STANCHION
176+83.5 RT (53')

SIGNAL BRIDGE W/MAST ARM
175+66 LT (SB LANES) (MA2)
176+81 LT-RT (NB LANES) (MA1)

US 7 170+00 Northbound
Cold Plane & Paving Limit
Begin Left Lane Taper

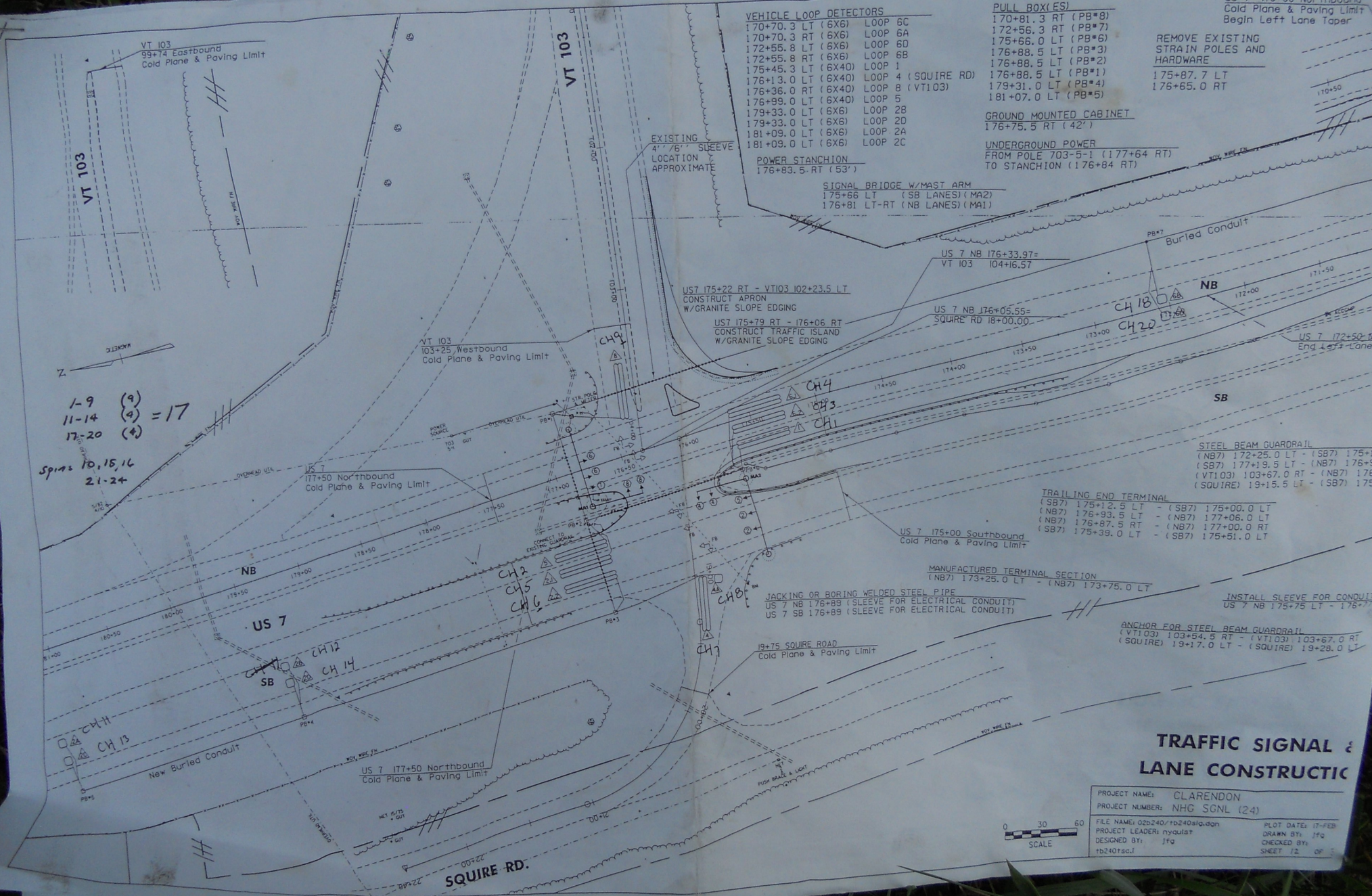

1-9 (9)
11-14 (9) = 17
17-20 (4)
Spins 10, 15, 16
21-24

STEEL BEAM GUARDRAIL
(NB7) 172+25.0 LT - (SB7) 175+12.0
(SB7) 177+93.5 LT - (NB7) 176+93.0
(VT103) 103+67.0 RT - (NB7) 176+50.0
(SQUIRE) 19+15.5 LT - (SB7) 175+50.0

TRAILING END TERMINAL
(SB7) 175+12.5 LT - (SB7) 175+00.0 LT
(NB7) 176+93.5 LT - (NB7) 177+06.0 LT
(NB7) 176+87.5 RT - (NB7) 177+00.0 RT
(SB7) 175+39.0 LT - (SB7) 175+51.0 LT

MANUFACTURED TERMINAL SECTION
(NB7) 173+25.0 LT - (NB7) 173+75.0 LT

JACKING OR BORING WELDED STEEL PIPE
US 7 NB 176+89 (SLEEVE FOR ELECTRICAL CONDUIT)
US 7 SB 176+89 (SLEEVE FOR ELECTRICAL CONDUIT)

INSTALL SLEEVE FOR CONDUIT
US 7 NB 175+75 LT - 175+75

ANCHOR FOR STEEL BEAM GUARDRAIL
(VT103) 103+54.5 RT - (VT103) 103+67.0 RT
(SQUIRE) 19+17.0 LT - (SQUIRE) 19+28.0 LT

TRAFFIC SIGNAL & LANE CONSTRUCTIC

PROJECT NAME: CLARENDON
PROJECT NUMBER: NHG SGNL (24)

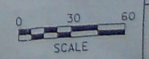

FILE NAME: 029240\1b240sig.dgn
PROJECT LEADER: nyquist
DESIGNED BY: Jfg
1b2401sc.f

PLOT DATE: 17-FEB
DRAWN BY: Jfg
CHECKED BY:
SHEET 12 OF 15