

MS # 301

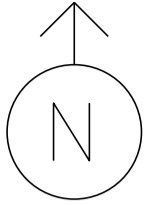

US 7 NORTH



- PEDESTAL POST
- PEDESTRIAN SIGNAL
- PREEMPTION STROBE
- CONTROL BOX
- LOOP DETECTION
- JUNCTION BOX
- =

VT 140 WEST

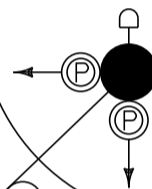
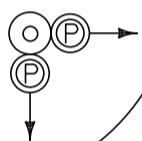

JB

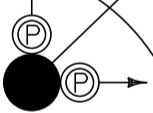
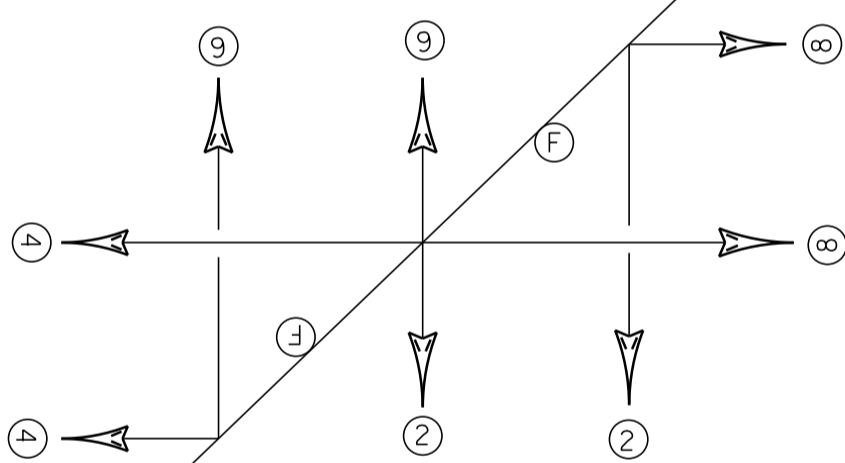

VT 140 EAST



US 7 SOUTH

NOT TO SCALE

MS # 301

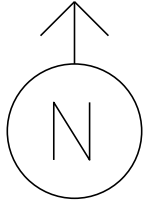

US 7 NORTH

VT 140 WEST

11'

11'

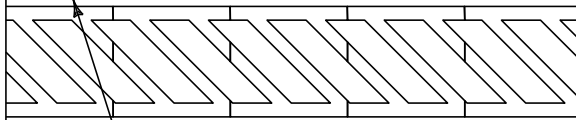

CROSSWALK 34'
STOP BAR 11'

STOP BAR 11'

11'

11'

CROSSWALK 30'

CROSSWALK 30'

STOP BAR 11'

11'

11'

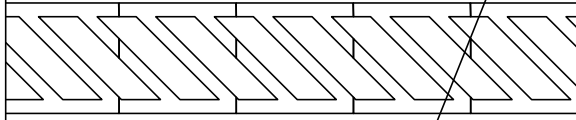

CROSSWALK 31'
STOP BAR 11'









11'

11'

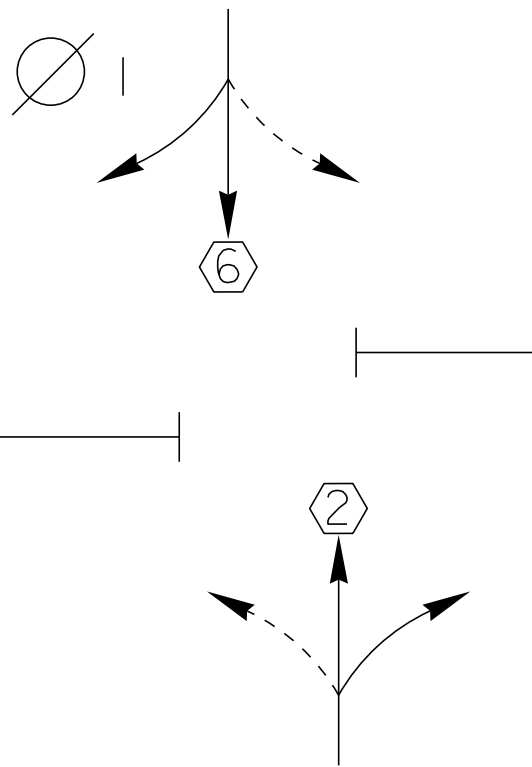
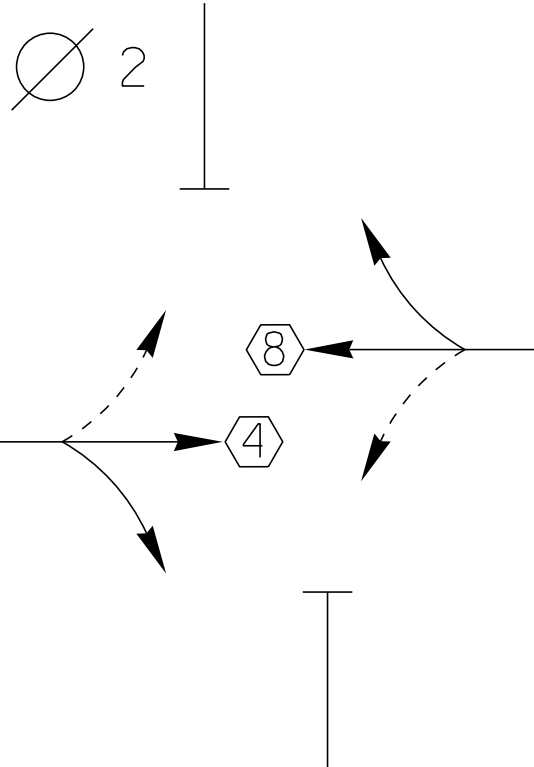
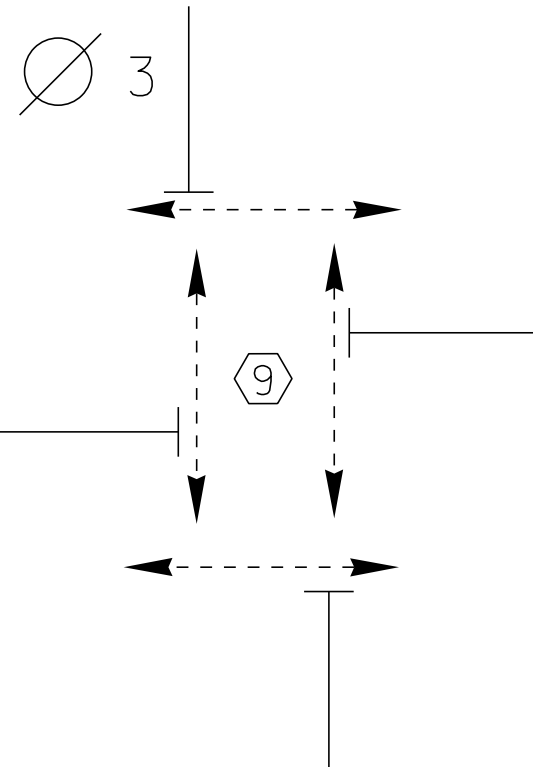
VT 140 EAST

US 7 SOUTH

NOT TO SCALE

<p style="writing-mode: vertical-rl; transform: rotate(180deg);">D I A G R A M</p> 				
<p>TIMING</p>	<p>G = Y =</p>	<p>G = Y =</p>	<p>G = Y =</p>	<p>G = Y =</p>
<p style="writing-mode: vertical-rl; transform: rotate(180deg);">D I A G R A M</p>				
<p>TIMING</p>	<p>G = Y =</p>	<p>G = Y =</p>	<p>G = Y =</p>	<p>G = Y =</p>

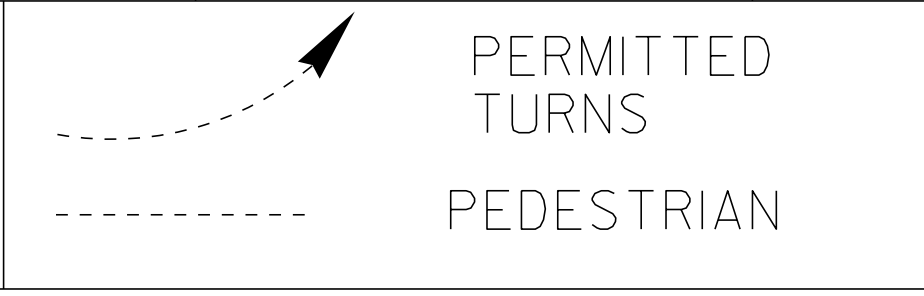
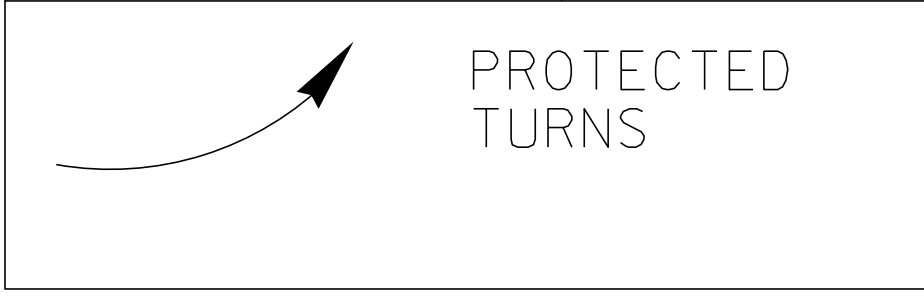

CYCLE LENGTH, C= _____ S



PROPERTY OF
VT. AGENCY OF TRANS.
MAINTENANCE DIV.

IN EMERGENCY CALL:
DIST. TRANS. OFFICE

786 5826

NIGHT & WEEKENDS:

773 9101

INTERSECTION NO.

MS 301

CONTROL
ED. ON
CONTROL
ED. OFF

AUTO
FLASH
STOP TRAINS
AUTO
STOP TRAINS



DANGER
115 VOLTS AC

WARNING
DO NOT OPERATE
CABINET WITHOUT
CMU / MMU

TURNED ON
6-5-03

ECONOLITE

Technical drawing and data table. The drawing on the left shows a complex network of lines and nodes, likely representing a signal or power distribution system. The table on the right contains columns for various parameters and checkboxes.

NO.	DESCRIPTION	STATUS
1	...	<input type="checkbox"/>
2	...	<input type="checkbox"/>
3	...	<input type="checkbox"/>
4	...	<input type="checkbox"/>
5	...	<input type="checkbox"/>
6	...	<input type="checkbox"/>
7	...	<input type="checkbox"/>
8	...	<input type="checkbox"/>
9	...	<input type="checkbox"/>
10	...	<input type="checkbox"/>



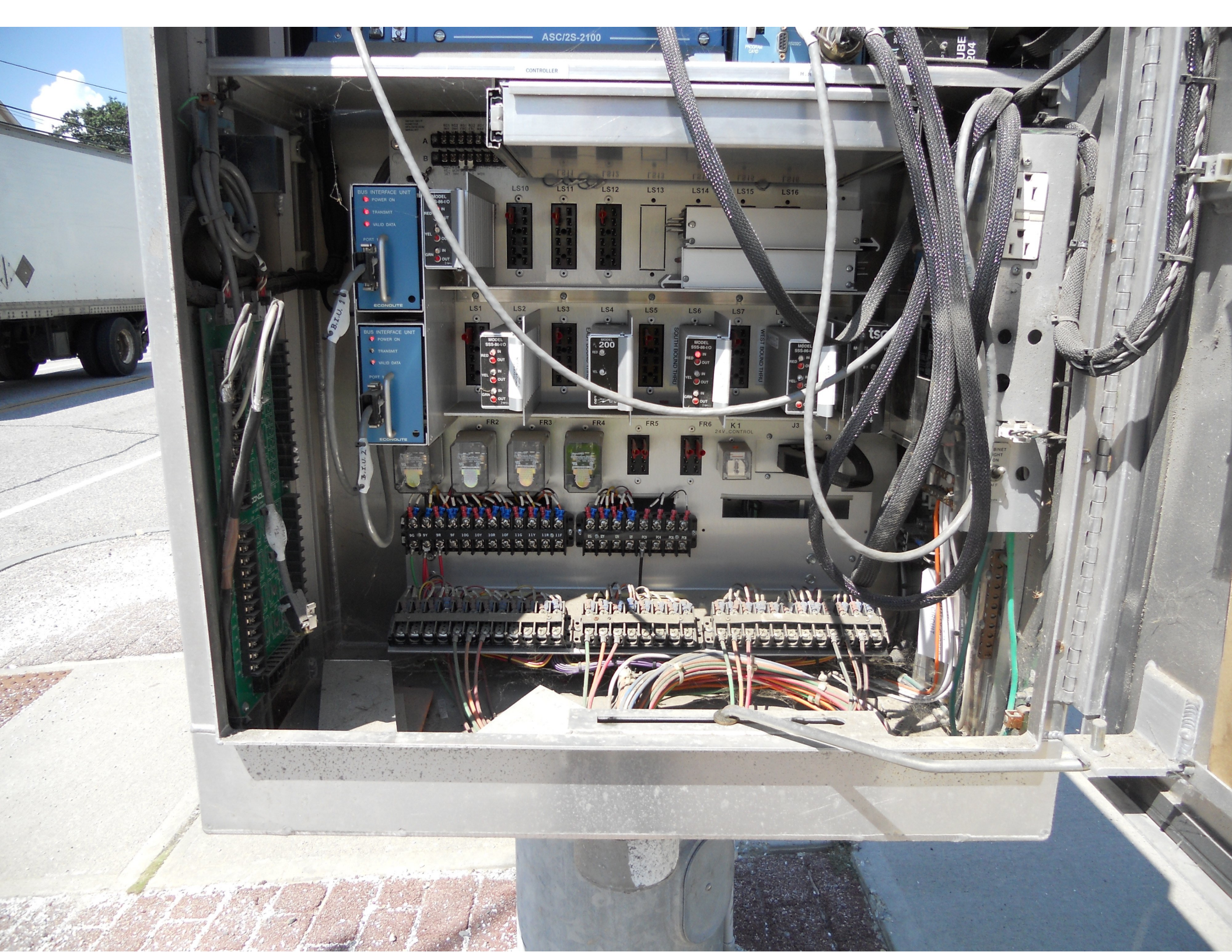

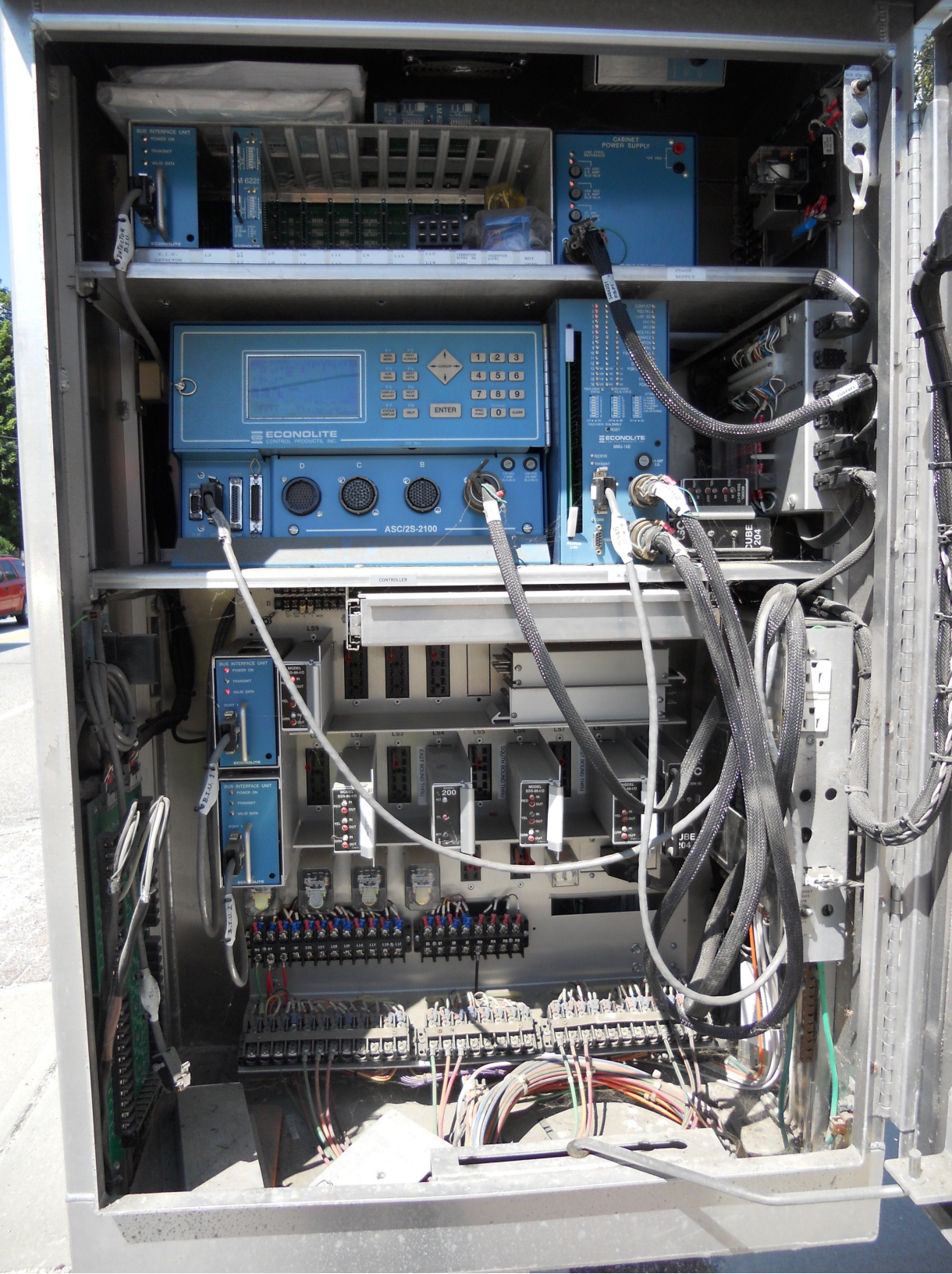

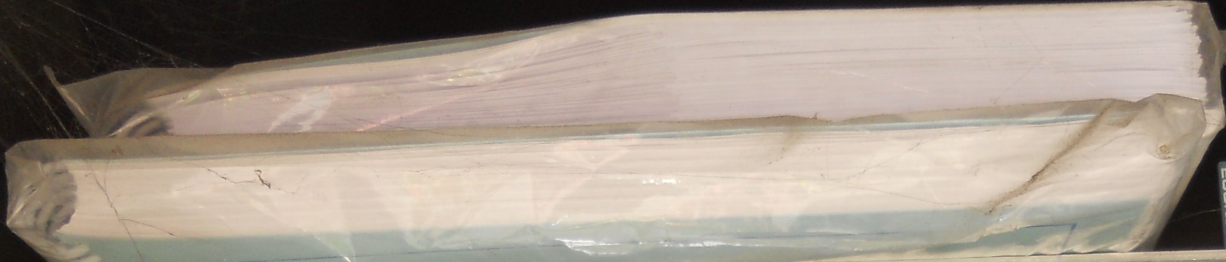

BUS INTERFACE UNIT

- POWER ON
- TRANSMIT
- VALID DATA

PORT

ECONOLITE

LM 622t

DET FLT

1 2 3 4 5 6 7 8
PR LG 1 2

0 0 0 0 0 0 0 0 0 0 0 0 0 0 0 0 0 0 0 0

SENS FREQ
15-HI 3-LO
10-NORM 2-M-LO
5-LO 1-M-HI
0-OFF 0-HI

ECONOLITE

DETECTOR
B.I.U.

B.I.U.
DETECTOR
#1

L3
L4

L1
04
L2
08

L7
L8

L5
L6

L11
L12

L9
L10

L15
L16

L13
L14

PREEMPTOR
EVPH3 04
EVPH4

STATUS DISPLAY

PHASE 1 2 3 4 5 6 7 8 9 0 1 2

2 MGRN 25 T/N T

MGRN MAXI 26 VEH PED

F1 MAIN MENU

F2 NEXT SCREEN

F3 SUB MENU

F4 NEXT DATA

CURSOR

1

4



NO
TURN
ON RED

DEPOT ST

SOUTH
7

EAST WEST

140

140



NO
TURN
ON RED

SOUTH

7

↑

EAST WEST

140 140

← →

MAPLE VALLEY
CROSSING
MONDAY
AND TUESDAY
ARE OPEN

NO
TURN
ON RED







YARD SALE
1.1.1.1.1.1 Sun 2
1.1.1.1.1.1 Sat 11
9.000.000
↓







DEPOT ST





NO
TURN
ON RED

EAST
VERMONT

NORTH STREET

72





NO
TURN
ON RED



NO
TURN
ON RED





NO
TURN
ON RED

SOUTH
7
↑

EAST
VERMONT
140
←

MAPLE VALLEY
GRANGE
BINGO
WEDNESDAY
AUG 1 6 PM
DOORS OPEN 4











NORTH

7



WEST

140



EAST

VERMONT
140



Hands for
Hope
Thrift Store

RESTAURANT
Sals
SEAFOOD



NO
TURN
ON RED

DEPT ST

NO
PARKING

NO
TURN
ON RED











FOR SALE
BY OWNER

RESTAURANT
Sal's
PIZZERIA

Sal's

WOLFGANG
PASTOR

WOLFGANG
PASTOR

SCHOOL ST





W
140



SOUTH NORTH

7 7



NO
TURN
ON RED



TURN ON RED

THE PUB

NO
TURN
ON RED

NO
TURN
ON RED





NO
TURN
ON RED

UTILITY BOX

PETER P.









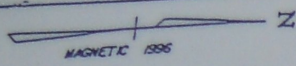

STA. 1+055.000
LIMIT OF WORK

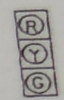

SIGNAL NO. 2,4,6,8 PEDESTRIAN
SIGNAL FACE ARRANGEMENT

PP-1 TO PP-2
PP-2 TO JB-1
JB-1 TO SP-1/CO
SP-1/CONTROLLE

STA. 0+118.000
BEGIN PROJECT NHG(26)S
BEGIN PROJECT ADAS(2)

EXIST. UTILITY POLE &
POWER SERVICE
STA. 0+141.93,
7.73 m LT.

PP-3
STA. 0+157.91
NEW 200mm SLEEVE
W/2-50mm CONDUITS

STA. 0+176.000
END PROJECT NHG(26)S
END PROJECT ADAS(2)

U.S. ROUTE 7
SOUTH

0+180 U.S. ROUTE 7 NORTH

PP-1
STA. 0+137.28

PP-2
STA. 1+091.5

NEW STRAIN POLE
W/CONTROLLER
STA. 0+157.04, 7.53 M RT.

NEW 150mm SLEEVE
W/1-50mm CONDUIT

STA. 1+105.000
LIMIT OF WORK

EXISTING	NEW	LEGEND
		UTILITY POLE

LOOP NO.	
1	A
2	
3	
4	
5	
6	
7	
8	
9	
10	

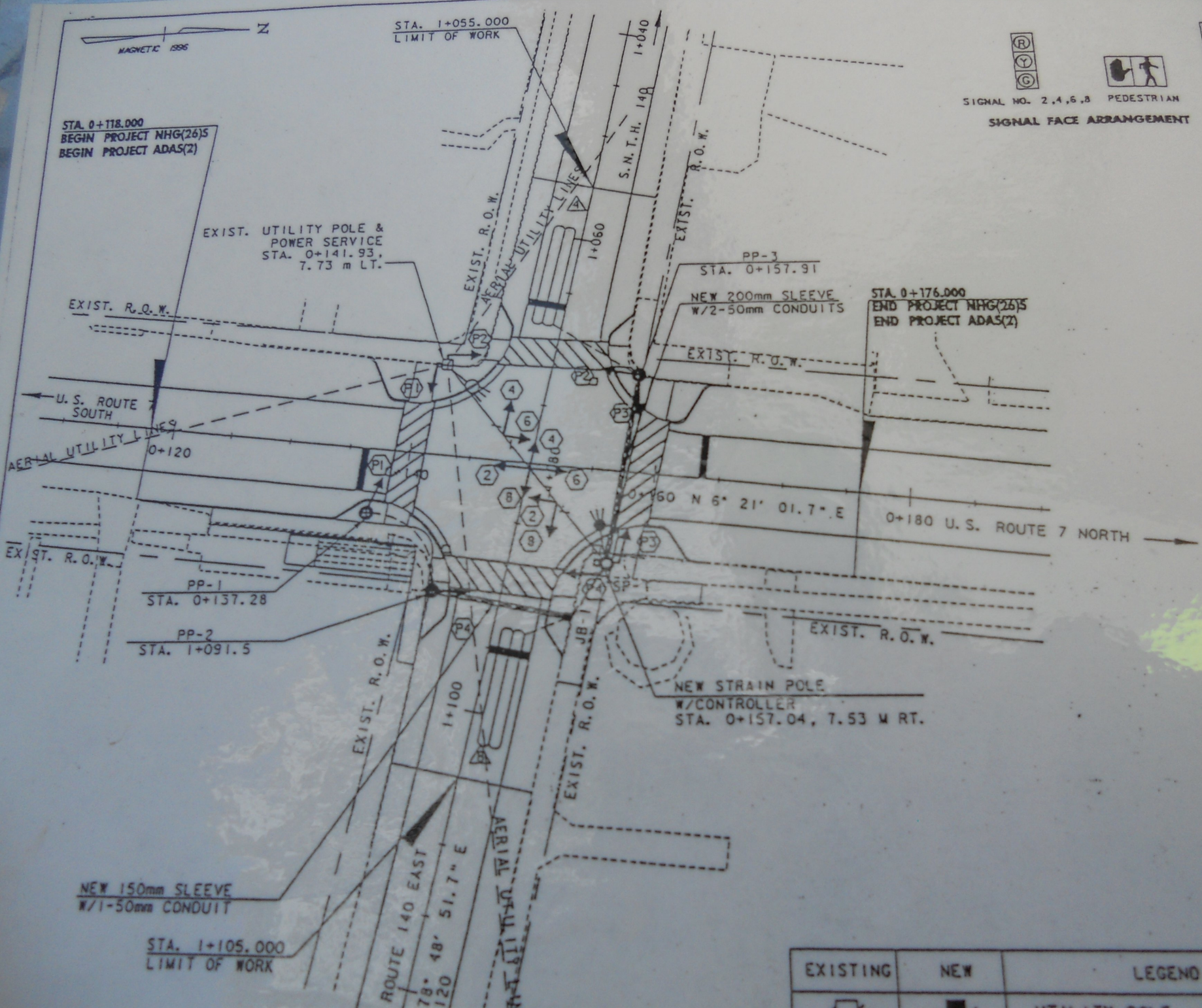

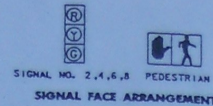
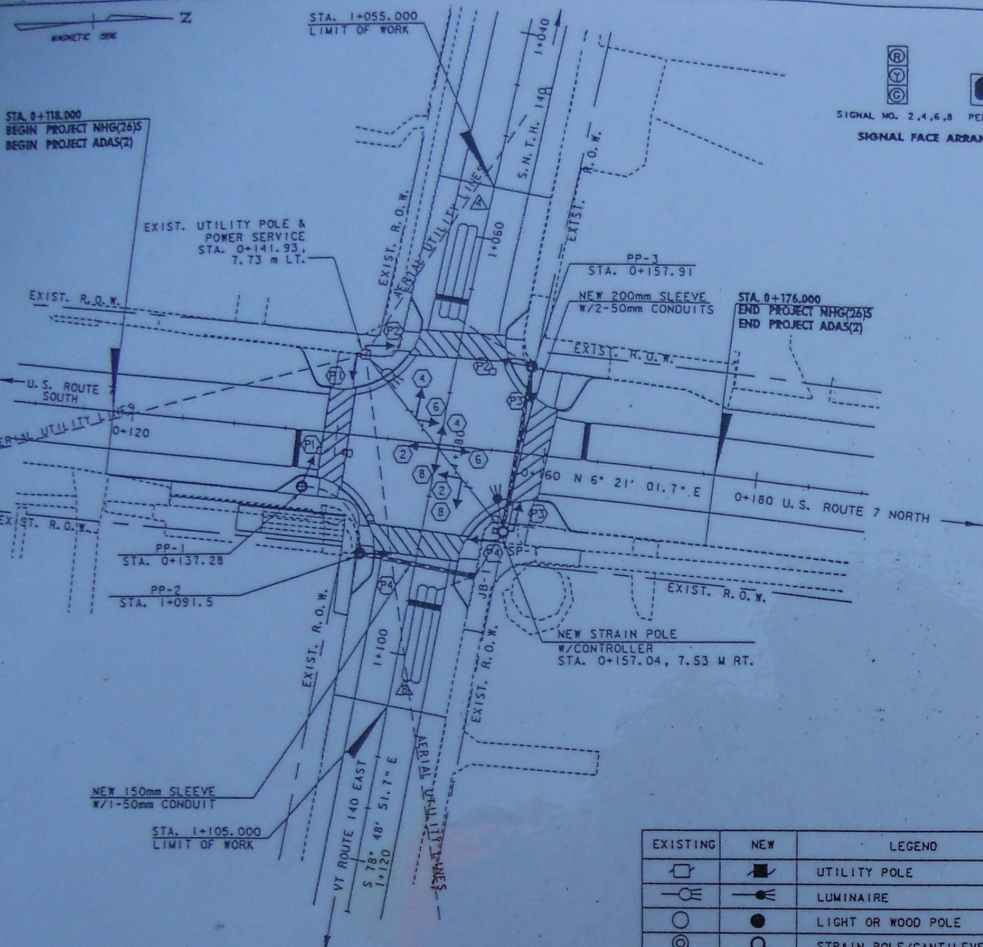

WIRED CONDUIT (PVC)			
NO.	DIAM.	REMARKS	
PP-1 TO PP-2	1 50 mm	SIGNAL	
PP-2 TO JB-1	1 50 mm	SIGNALS	
JB-1 TO SP-1/CONTROLLER	2 50 mm	SIGNALS AND LOOPS	
SP-1/CONTROLLER TO PP-3	2 50 mm	SIGNALS AND LOOPS	

ELECTRICAL CONDUIT SLEEVE	
LOCATION	DIAM.
US RTE. 7 0+157.05 - 6.57M RT.	150 mm
0+157.34 - 7.48M LT.	120 mm
VT RTE. 140 1+091.5 - 5.12M LT.	150 mm
5.12M RT.	150 mm

Metric

JUNCTION BOX

LOCATION AND DESCRIPTION

1+091.5, 5.6 m LT. JB - 1

VEHICLE DETECTOR LOOPS												
LOOP NO.	LANE	CALL #	SIZE (M)	TYPE & NO. TURNS	DELAY OR PRESENCE	INDUCTANCE		RESISTANCE		LEAKAGE TO GROUND	LOCKING MEMORY	EST. QUANT. (M)
						CALC.	ACT.	CALC.	ACT.			
A	S. N. T. H. EASTBOUND	140 4 + 8	1.8x9.0	QUAD - 2	PRESENCE	281		0.771			NO	
A	VT RTE. WESTBOUND	140 4 + 8	1.8x9.0	QUAD - 2	PRESENCE	266		0.580			NO	

CALCULATIONS ARE BASED ON LOOPS DESIGNED IN PARALLEL
ALL CALCULATED VALUES ARE AT THE CONTROLLER.
MEASURED VALUES MUST BE FILLED IN PRIOR TO TEST PERIOD.

SEQ. 11+P	PHASE 2+6 (DWELL)				PHASE 4+8				PHASE PED.			
	CLEAR TO:				CLEAR TO:				CLEAR TO:			
	B	W	0 4+8	0 PED	B	W	0 2+6	0 PED	B	W	0 2+6	0 PED
VEH EXT	-	-	-	-	2	-	-	-	-	-	-	-
MINIMUM	-	-	-	-	8	-	-	-	-	-	-	-
MAX 1	27	4	2	-	21	4	2	-	-	-	-	-
PED	27	4	2	4	21	4	2	4	2	5	2	7
VEH EXT	-	-	-	-	2	-	-	-	-	-	-	-
MINIMUM	-	-	-	-	8	-	-	-	-	-	-	-
MAX 2	33	4	2	-	15	4	2	-	-	-	-	-
PED	33	4	2	4	15	4	2	4	2	5	2	7
VEH EXT	-	-	-	-	2	-	-	-	-	-	-	-
MINIMUM	-	-	-	-	8	-	-	-	-	-	-	-
MAX 3	29	4	2	-	19	4	2	-	-	-	-	-
PED	29	4	2	4	19	4	2	4	2	5	2	7
FACE 2	G	Y	R	Y	R	R	R	R	R	R	R	R
FACE 4	R	R	R	R	R	G	Y	R	Y	R	R	R
FACE 6	G	Y	R	Y	R	R	R	R	R	R	R	R
FACE 8	R	R	R	R	R	G	Y	R	Y	R	R	R
PED	DW	DWDW	DWDW	DWDW	DW	DWDW	DWDW	DWDW	DWDW	W	DWDW	

NOTES:

PRIOR TO COLD PLANNING, ANY EXISTING VEHICLE DETECTOR LOOPS SHALL BE DISCONNECTED IN THE CONTROLLER CABINET AND CUT AT THE CURB.

ONCE A LOOP IS DISCONNECTED, THE SIGNAL PHASE THAT IT WAS CALLING SHALL BE PUT ON MAX RECALL OR THE SIGNAL PUT ON FLASH AND TRAFFIC CONTROLLED BY A UNIFORMED TRAFFIC OFFICER.

ALL BITUMINOUS AREAS TO RECEIVE NEW VEHICLE DETECTOR LOOPS SHALL BE LEVELED WITH TYPE IV BITUMINOUS CONCRETE PAVEMENT AS DIRECTED BY THE RESIDENT ENGINEER PRIOR TO THE INSTALLATION OF THE NEW DETECTOR LOOPS. LOOPS SHALL BE INSTALLED PRIOR TO THE PLACEMENT OF THE WEARING COURSE.

IF WATER VALVES, DROP INLETS OR OTHER OBSTRUCTIONS ARE ENCOUNTERED WITHIN THE AREA OF A PROPOSED LOOP, THE CONTRACTOR SHALL TAKE SPECIAL CARE TO AVOID THE OBSTRUCTION DURING LOOP INSTALLATION. IF LOOP SIZES OR SHAPES ARE TO BE MODIFIED DUE TO OBSTRUCTIONS THE RESIDENT ENGINEER MUST APPROVE LAYOUT PRIOR TO INSTALLATION.

AFTER THE NEW LOOPS ARE INSTALLED, THE INDUCTANCE, RESISTANCE AND LEAKAGE TO GROUND SHALL BE TESTED USING PROPERLY CALIBRATED EQUIPMENT. THE TEST RESULTS SHALL BE COMPARED WITH THE CALCULATED VALUES AND RECORDED ON THE PLANS. ALL LOAD TESTING SHALL BE PERFORMED AS PER VTrans STANDARD E-172M.

CALCULATED VALUES AT CONTROLLER ARE BASED ON DIRECT CONDUIT ROUTING TO THE NEAREST SIGNAL POLE AND CROSSING THE SPAN WIRE OR EXISTING CONDUIT AS NECESSARY TO THE EXISTING CONTROLLER LOCATION. ANY SIGNAL MODIFICATION AND OR CONTROLLER RELOCATION PRIOR TO LOOP CONNECTION WILL REQUIRE RECALCULATION OF THESE VALUES.

AFTER ACCEPTANCE OF THE LOOP INSTALLATION BY THE RESIDENT ENGINEER, RETURN THE SIGNAL TO NORMAL OPERATION.

AN EMERGENCY VEHICLE PREEMPTION SYSTEM IS TO BE INSTALLED AT THIS INTERSECTION. SEE SHEET 16 FOR NOTES AND DETAILS CONCERNING THIS SYSTEM.

FOR ADDITIONAL DETAILS, SEE VTrans STANDARDS E-172M AND E-172M.

EXISTING	NEW	LEGEND
		UTILITY POLE
		LUMINAIRE
		LIGHT OR WOOD POLE
		STRAIN POLE/CANTILEVER
		CONTROLLER CABINET
		PULLBOX/JUNCTION BOX
		SIGNAL HEAD
		CONDUIT
		VEHICLE LOOPS
		PEDESTAL POST

2003 "AVERAGE WEEKDAY" HOURLY VOLUMES

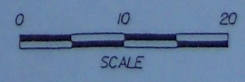
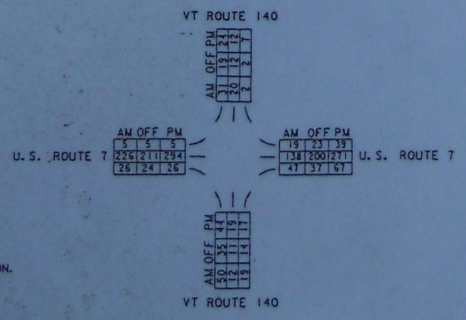

DH
Dutrasne-Henry

PROJECT NAME: WALLINGFORD
PROJECT NUMBER: NHG SGNL(26)S/STP ADAS(2)

FILE NAME: ic294frm.dgn
PROJECT LEADER: GAS
DESIGNED BY: RAW/JCO
TRAFFIC SIGNAL DETAIL PLAN

PLOT DATE: 01/28/02
DRAWN BY: WBL
CHECKED BY: GAS
SHEET 13 OF 25



CONTAINS FCC ID: Q2C-RX284
CONTAINS FCC ID: Q6J2081
SERIAL # 14 809 983

elster
TYPE RZSD
Zigbee

6029463

1 NC 006029463
CL200, 240V, 3W, 60Hz FM 2S Walhour Meter Kh 1.0 TA 30

LAN ID 027-0007553342

ZFCWMAB0000-14
R4 1-1209

TRAFFIC LITES



STREET LIGHTS

SERVICE
DISCONNECT

⚠ DANGER
Hazardous Voltage
Will cause death, serious
injury or substantial
property damage.
Turn off power supplying this
equipment before working inside.



⚠ PELIGRO
Voltaje peligroso. Causará la
muerte, lesiones graves o daño
substantial a la propiedad.
Desconecte el suministro de
energía a este equipo antes de
trabajar en su interior.



NIC Program Steps

Step	Program	Step Begins	Pattern	Override
------	---------	-------------	---------	----------

TOD Program Steps

Step 1 Program 1 Step Begins 0600

Flash. Dimming Enable.
Red Rest Alt Veh Extension
Spare 5. Det Log Enable.
Spare 3. Spare 4
Type 0 Dly Enable. . . Spare 2
Det Diag Plan. . . . 0

Table with 12 columns (Phase Number 1-12) and rows for Max 2 Enable, Max 3 Enable, Veh Recall, Veh Max Recall, Ped Recall, Cond Service Inhibit, Phase Omit, and Special Function.

Alt Sequence A B C D E F

Step 2 Program 1 Step Begins 0900

Flash. Dimming Enable.
Red Rest Alt Veh Extension
Spare 5. Det Log Enable.
Spare 3. Spare 4
Type 0 Dly Enable. . . Spare 2
Det Diag Plan. . . . 0

Table with 12 columns (Phase Number 1-12) and rows for Max 2 Enable, Max 3 Enable, Veh Recall, Veh Max Recall, Ped Recall, Cond Service Inhibit, Phase Omit, and Special Function.

Alt Sequence A B C D E F

TOD Program Steps

Step 3 Program 1 Step Begins 1530

Flash. Dimming Enable.
Red Rest Alt Veh Extension
Spare 5. Det Log Enable.
Spare 3. Spare 4
Type 0 Dly Enable. . . Spare 2
Det Diag Plan. . . . 0

Table with 12 columns (Phase Number 1-12) and rows for Max 2 Enable, Max 3 Enable, Veh Recall, Veh Max Recall, Ped Recall, Cond Service Inhibit, Phase Omit, and Special Function.

Alt Sequence A B C D E F

Step 4 Program 1 Step Begins 1800

Flash. Dimming Enable.
Red Rest Alt Veh Extension
Spare 5. Det Log Enable.
Spare 3. Spare 4
Type 0 Dly Enable. . . Spare 2
Det Diag Plan. . . . 0

Table with 12 columns (Phase Number 1-12) and rows for Max 2 Enable, Max 3 Enable, Veh Recall, Veh Max Recall, Ped Recall, Cond Service Inhibit, Phase Omit, and Special Function.

Alt Sequence A B C D E F