

**NORTHERN ARCHITECTS**  
 207 KING STREET  
 SUITE 3  
 BURLINGTON, VERMONT  
 05401-4502  
 802-658-1953

**CONSULTANTS**  
**CIVIL**  
 KREPS & LANSING  
 161 Main Street, Suite 201  
 Colchester, VT 05446  
 (802) 878-0979  
**LANDSCAPE ARCHITECT**  
**OHKW**  
 OFFICE OF HELEN WAGNER  
 11 Maple Avenue  
 Putney, VT 05490  
 (802) 864-0010  
**STRUCTURAL**  
 RICHARD H. DOWNEY, P.E.  
 117 SWANEY HALL STREET  
 BURLINGTON, VT 05401  
 802-660-9222  
**MECHANICAL/ELECTRICAL**  
 DUFFRESNE-HENRY, INC.  
 24 ROUTE 106, PRESCOTT PARK  
 NORTH SPRINGFIELD, VT 05690  
 802-886-2261

**REVISIONS**

**PROJECT**  
**DERBY WELCOME CENTER**  
 PROJECT #10 091-3(8)  
**NEW FACILITY**  
 DERBY VERMONT

DATE: 01/07/02  
 SCALE: 1" = 20'  
 CHECKED:  
 PROJECT NO:

**SITE PLAN**

**SC-6**  
 00137 - sc-siteplan.dwg  
 xref = derby2001.dwg

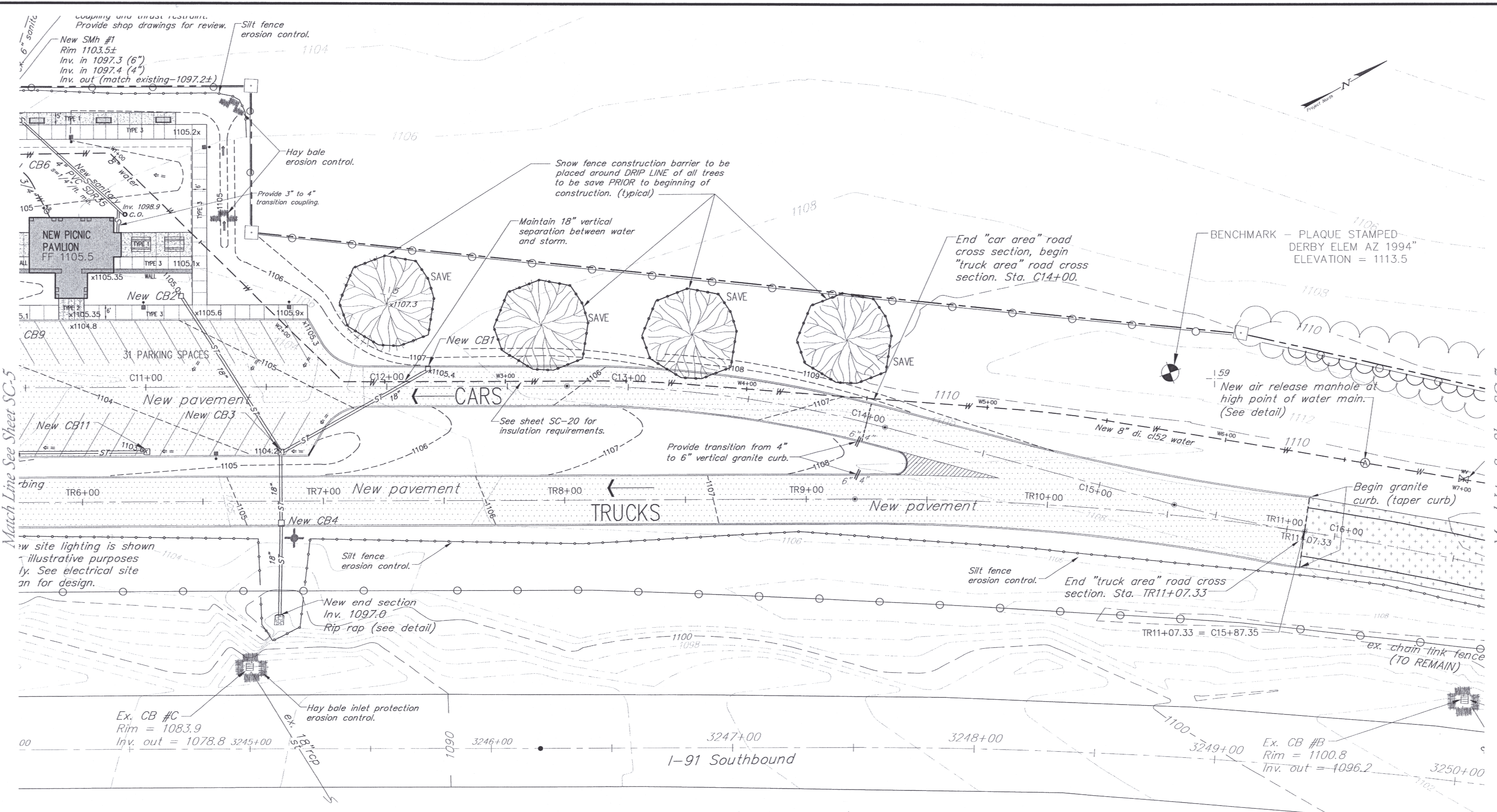

**Catch Basin Schedule** (For sheet SC-6)

<b>New CB 1</b> Rim 1105.4 Inv. 1099.4	<b>New CB 2</b> Rim 1105.0 Inv. 1099.0
<b>New CB 3</b> Rim 1104.2 Inv. 1098.0	<b>New CB 4</b> Rim 1105.2 Inv. 1097.7
<b>New CB 11</b> Rim 1103.6 Inv. 1098.0	

**Curbing Schedule** (For sheet SC-6)

Alignment	Station to Station	Curbing Type
"C" Line	C7+00 lt. to C14+25 lt.	Vertical granite
"C" Line	C14+25 lt. to C15+87 lt.	Sloped granite
"C" Line	C7+30 rt. to C14+25 rt.	Vertical granite
"TR" Line	TR4+53 lt. to TR9+45 lt.	Vertical granite
"TR" Line	TR 0+00 rt. to TR11+07 rt.	Sloped granite

(See site plan for areas of tapered and recessed curb.)  
 (See Sta. C14+00 rt. for section of 4" reveal vertical curb.)

**Concrete Sidewalk Surface Treatment Legend**

<b>TYPE 1</b>	Type 1 Exposed aggregate
<b>TYPE 2</b>	Type 2 Patterned concrete with color (See Architects drawings and specifications)
<b>TYPE 3</b>	Type 3 Broom finish / Trowel joint

(See details and specification for more detail)

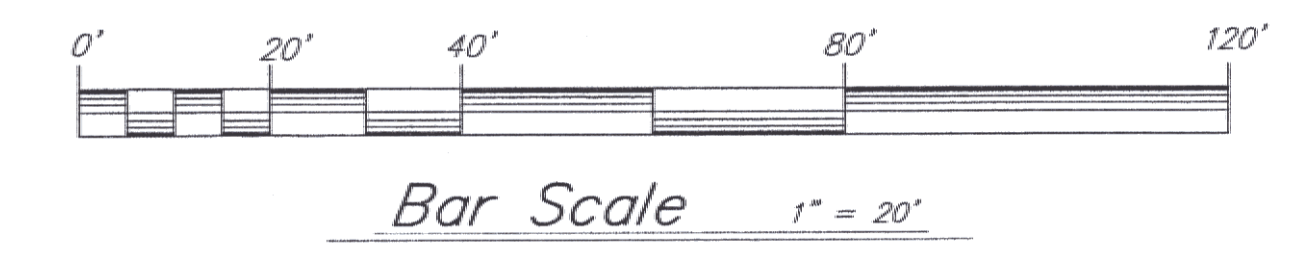

See Notes Sheet SC-4.  
 See Legend Sheet SC-4.