

TEST PITS

TEST PIT #	HORIZON	DEPTHS	SOIL, MOTTLES, WATER, & COMMENTS
TEST PIT #1	A	0-12"	Dark brown topsoil
	B	12-45"	Fine sand/silt loam; mottles @ 18", saturated @ 32"; monitor installed
TEST PIT #2	A	0-12"	Dark brown topsoil
	B	12-46"	Fine sandy loam w/some silt; mottles @ 18", saturated @ 35"; monitor installed
TEST PIT #3	A	0-12"	Dark brown topsoil
	B	12-42"	Silty loam; mottles @ 23-24", saturated @ 32"
TEST PIT #4	A	0-12"	Dark brown topsoil
	B	12-36"	Fine sandy loam; no apparent mottles
TEST PIT #5	A	0-12"	Dark brown topsoil
	B	12-40"	Fine sandy loam; no apparent mottles one of best holes
TEST PIT #6	A	0-12"	Dark brown topsoil
	B	12-45"	Fine sandy loam; mottles @ 30"
TEST PIT #7	A	0-12"	Dark brown topsoil
	B	12-43"	Fine sandy loam w/small stones; no apparent mottles; good hole
TEST PIT #8	A	0-12"	Dark brown topsoil
	B	12-42"	Fine sandy loam; distinct mottles @ 32"
TEST PIT #9	A	0-12"	Dark brown topsoil
	B	12-46"	Fine sandy loam w/many pcs. of small shale; no apparent mottles
TEST PIT #10	A	0-12"	Dark brown topsoil
	B	12-42"	Silty & fine sandy loam w/some pcs. of fractured shale

PERCOLATION TEST

TEST #1: Percolation rate - 15 minutes/inch
 TEST #2: Percolation rate - 19 minutes/inch

MONITORING WELLS

Monitoring wells #1 and #2 were checked once each week beginning March 1, 1995. As of April 28, 1995, well #1 has been dry to depth 45". Highest water level observed in well #2 was 41" on March 24, 1995. Both holes were dry on June 23, 1995.

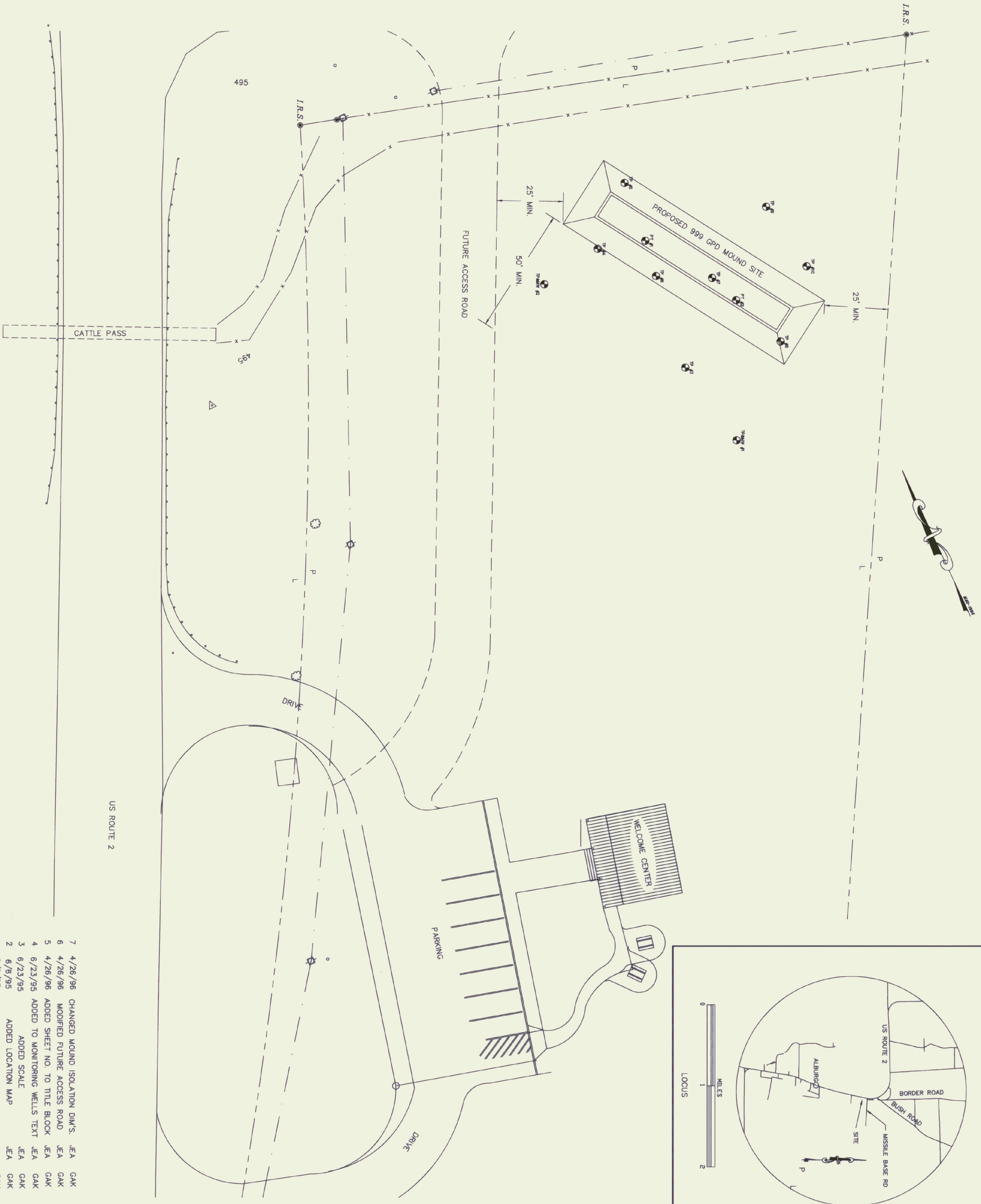

LEGEND

- I.R.S.
- IRON ROD SET
- PROPERTY LINE
- POWER LINE
- PROPERTY LINE & FENCE
- CATTLE FENCE
- UTILITY POLE

GRAPHIC SCALE

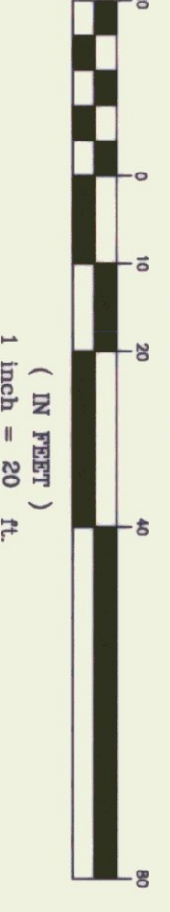

Jon E. Allen

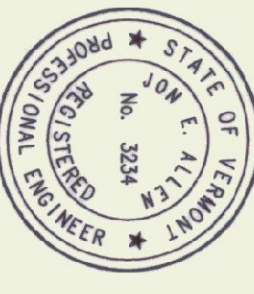

ALBURG WELCOME CENTER
 ALBURG, VERMONT

SEWAGE DISPOSAL SYSTEM
 SITE & SOILS INVESTIGATION
 NH028-1(17)5

REV.	DATE	DESCRIPTION	MADE BY	CHECKED BY	APPROVED BY
7	4/26/96	CHANGED MOUND ISOLATION DIMS.	JEA	GAK	
6	4/26/96	MODIFIED FUTURE ACCESS ROAD	JEA	GAK	
5	4/26/96	ADDED SHEET NO. TO TITLE BLOCK	JEA	GAK	
4	6/23/95	ADDED TO MONITORING WELLS TEXT	JEA	GAK	
3	6/23/95	ADDED SCALE	JEA	GAK	
2	6/6/95	ADDED LOCATION MAP	JEA	GAK	
1	6/6/95	ADDED LEGEND	JEA	GAK	

DRAWN	CHECKED	DATE	PROJECT NO.
JEA	JEA	5/17/95	11295

SCALE 1" = 20.00'

DESIGNED	DATE	DRAWING NO.	SHEET NO.
JON E. ALLEN	5/17/95	1/5	14/21