

FROM 1-83

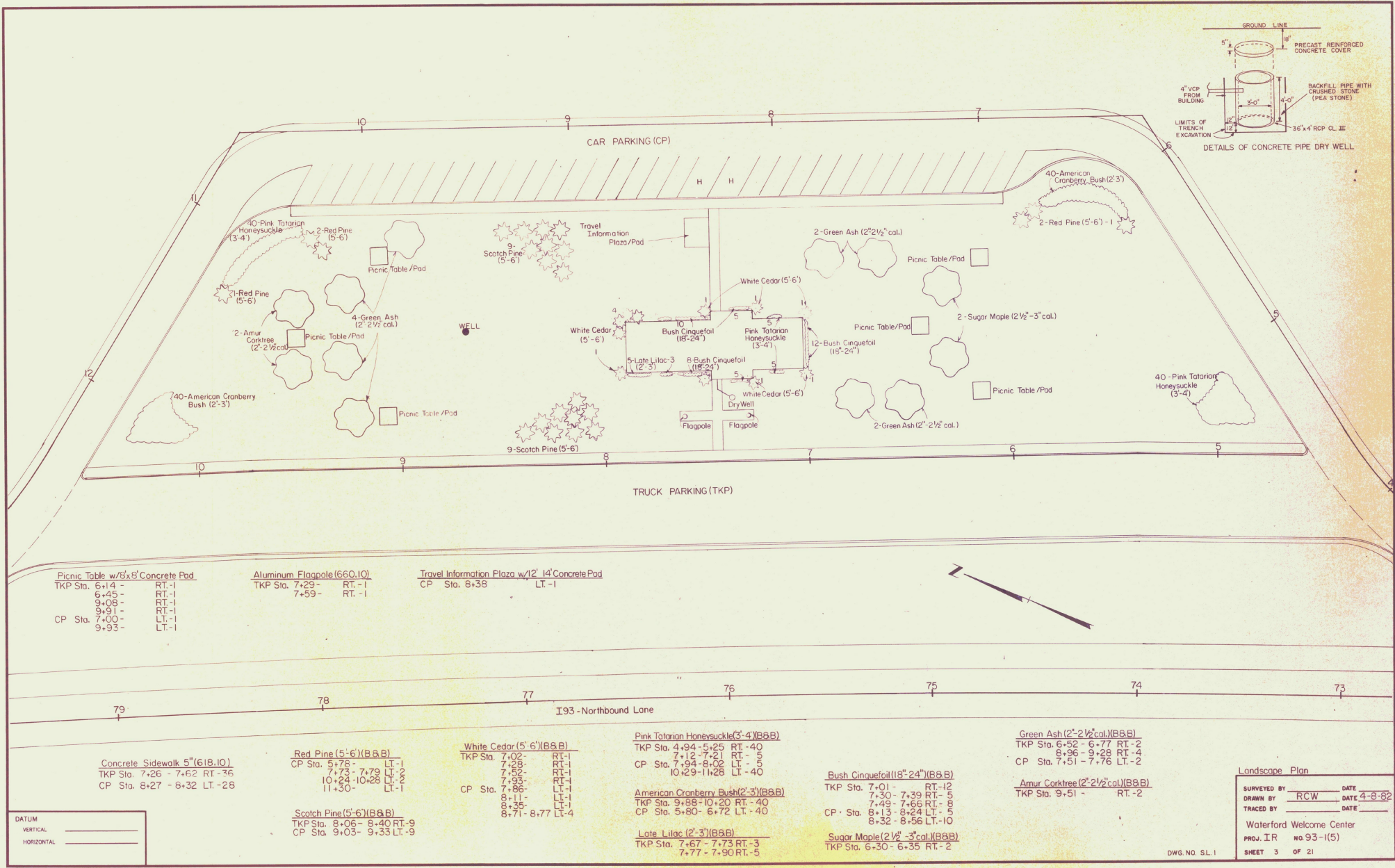



**Picnic Table w/8x8 Concrete Pad**  
 TKP Sta. 6+14 - RT-1  
 6+45 - RT-1  
 9+08 - RT-1  
 9+91 - RT-1  
 CP Sta. 7+00 - LT-1  
 9+93 - LT-1

**Aluminum Flagpole (66Q.10)**  
 TKP Sta. 7+29 - RT-1  
 7+59 - RT-1

**Travel Information Plaza w/12' 14" Concrete Pad**  
 CP Sta. 8+38 LT-1

**Concrete Sidewalk 5" (618.10)**  
 TKP Sta. 7+26 - 7+62 RT-36  
 CP Sta. 8+27 - 8+32 LT-28

**Red Pine (5'-6") (B&B)**  
 CP Sta. 5+78 - LT-1  
 7+73 - 7+79 LT-2  
 10+24 - 10+28 LT-2  
 11+30 - LT-1

**Scotch Pine (5'-6") (B&B)**  
 TKP Sta. 8+06 - 8+40 RT-9  
 CP Sta. 9+03 - 9+33 LT-9

**White Cedar (5'-6") (B&B)**  
 TKP Sta. 7+02 - RT-1  
 7+28 - RT-1  
 7+52 - RT-1  
 7+93 - RT-1  
 CP Sta. 7+86 - LT-1  
 8+11 - LT-1  
 8+35 - LT-1  
 8+71 - 8+77 LT-4

**Pink Tatarian Honeysuckle (3'-4") (B&B)**  
 TKP Sta. 4+94 - 5+25 RT-40  
 7+12 - 7+21 RT-5  
 CP Sta. 7+94 - 8+02 LT-5  
 10+29 - 11+28 LT-40

**American Cranberry Bush (2'-3") (B&B)**  
 TKP Sta. 9+88 - 10+20 RT-40  
 CP Sta. 5+80 - 6+72 LT-40

**Late Lilac (2'-3") (B&B)**  
 TKP Sta. 7+67 - 7+73 RT-3  
 7+77 - 7+90 RT-5

**Bush Cinquefoil (18'-24") (B&B)**  
 TKP Sta. 7+01 - RT-12  
 7+30 - 7+39 RT-5  
 7+49 - 7+66 RT-8  
 CP Sta. 8+13 - 8+24 LT-5  
 8+32 - 8+56 LT-10

**Sugar Maple (2 1/2'-3" cal.) (B&B)**  
 TKP Sta. 6+30 - 6+35 RT-2

**Green Ash (2'-2 1/2' cal.) (B&B)**  
 TKP Sta. 6+52 - 6+77 RT-2  
 8+36 - 9+28 RT-4  
 CP Sta. 7+51 - 7+76 LT-2

**Amur Corktree (2'-2 1/2' cal.) (B&B)**  
 TKP Sta. 9+51 - RT-2

DATUM

VERTICAL	_____
HORIZONTAL	_____

Landscape Plan

SURVEYED BY	DATE
DRAWN BY	RCW DATE 4-8-82
TRACED BY	DATE
Waterford Welcome Center	
PROJ. I.R.	NO. 93-1(5)
SHEET	3 OF 21

DWG. NO. SL.1