

ROOF PLAN
SCALE: 1/8"=1'-0"

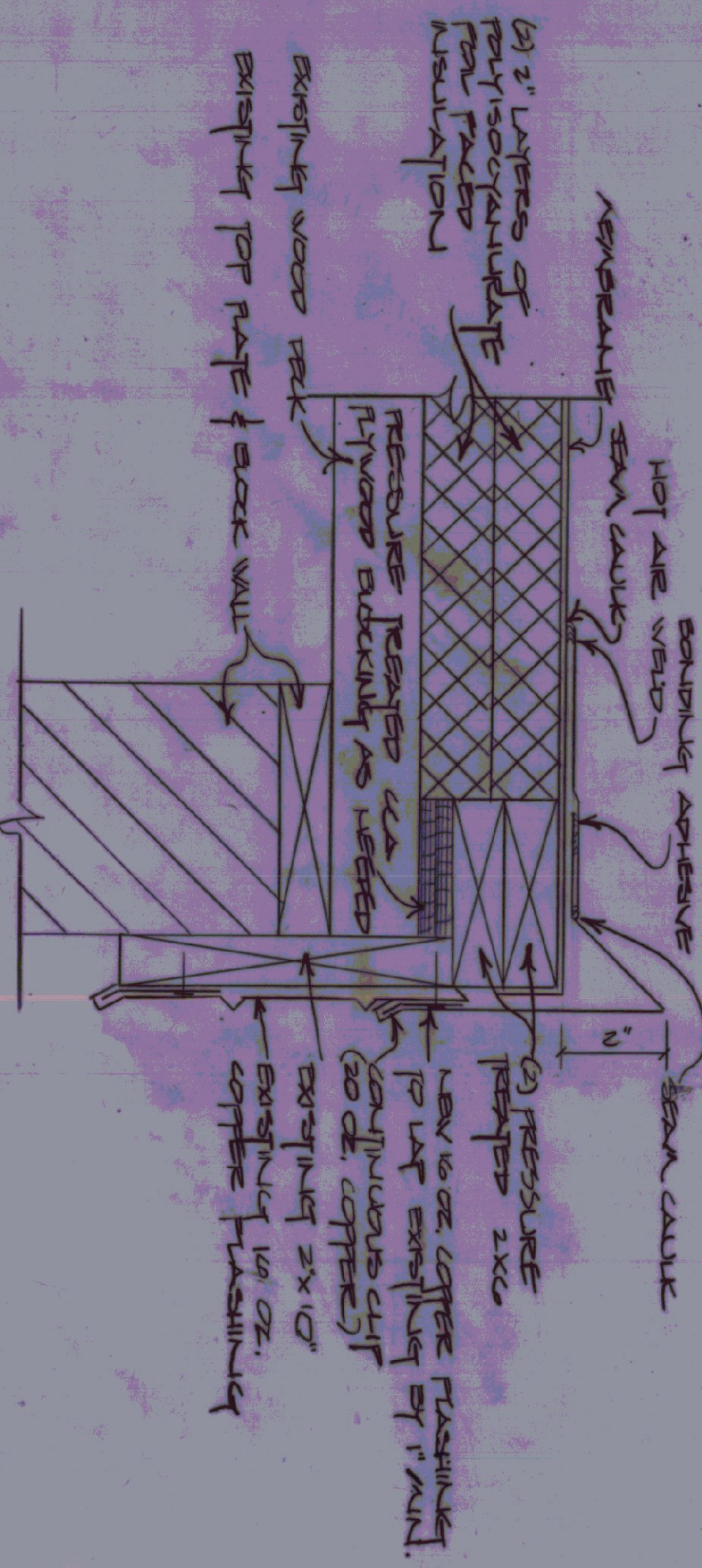

SECTION A-A - ROOF RAISE EDGE
SCALE: 3/4"=1'-0"

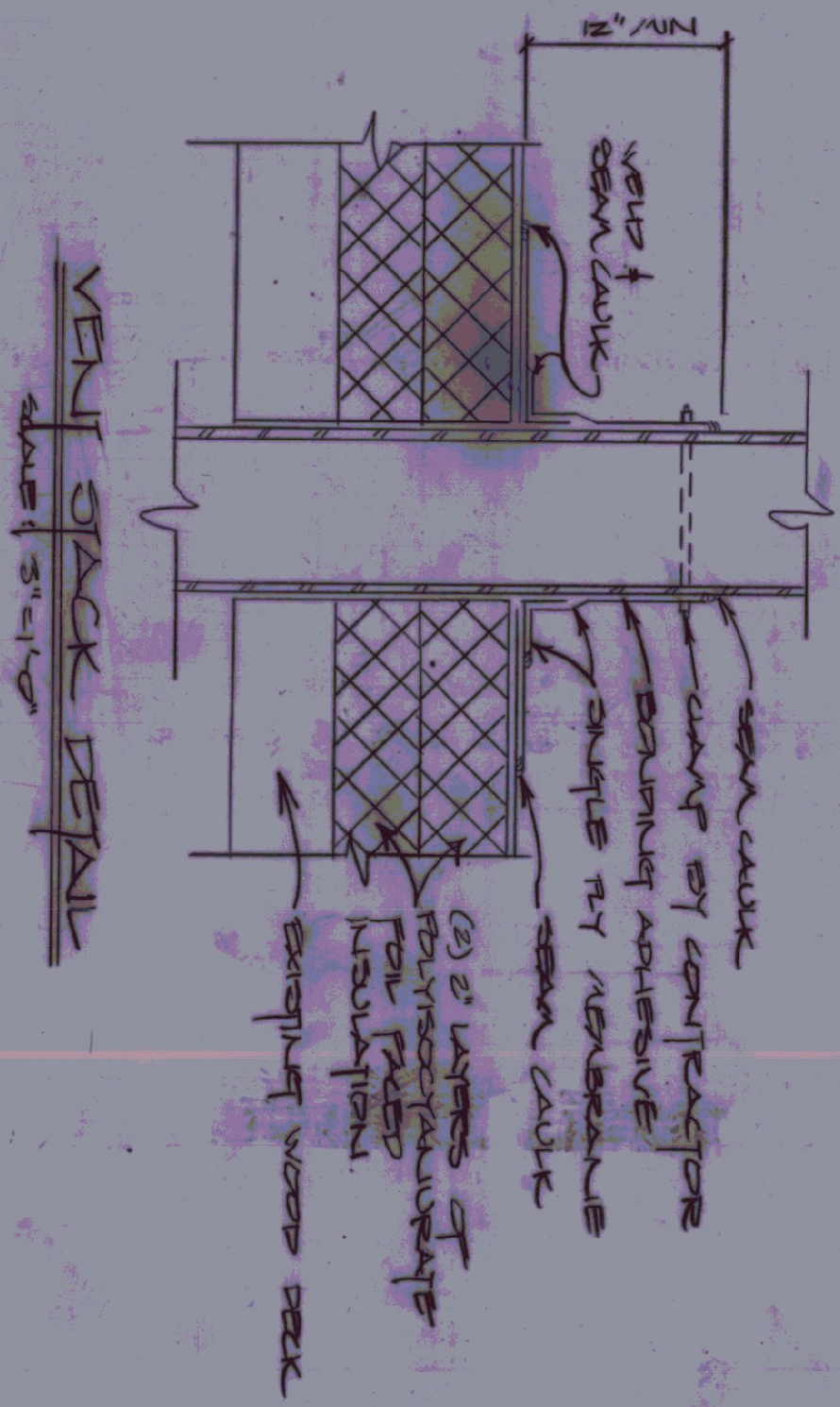

VENT STACK DETAIL
SCALE: 3/4"=1'-0"

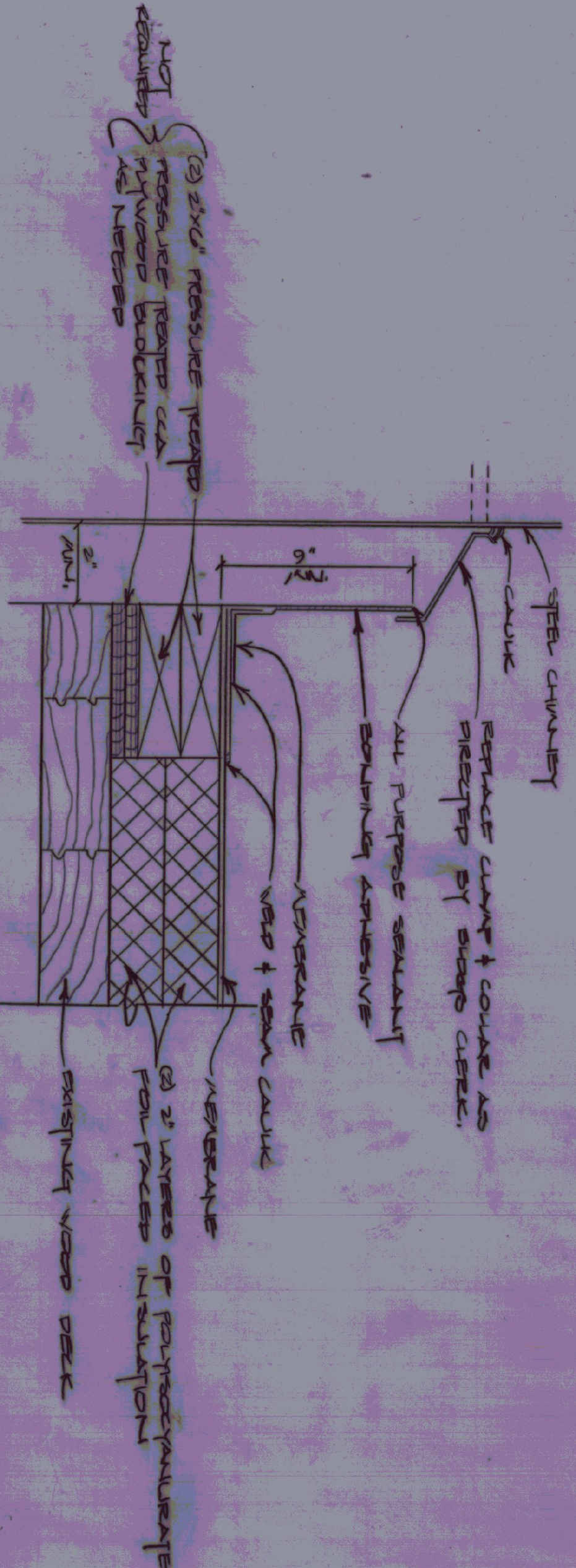

STEEL CHIMNEY DETAIL
SCALE: 3/4"=1'-0"

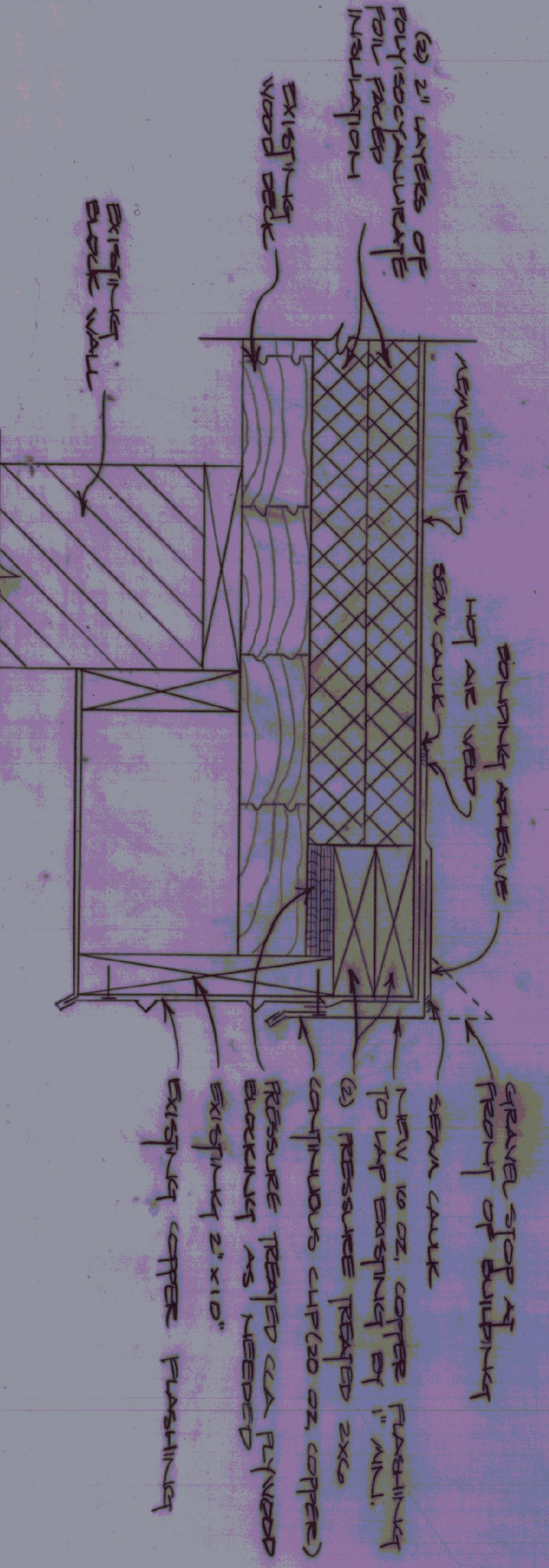

SECTION B-B - ROOF PEJ EDGE
SCALE: 3/4"=1'-0"

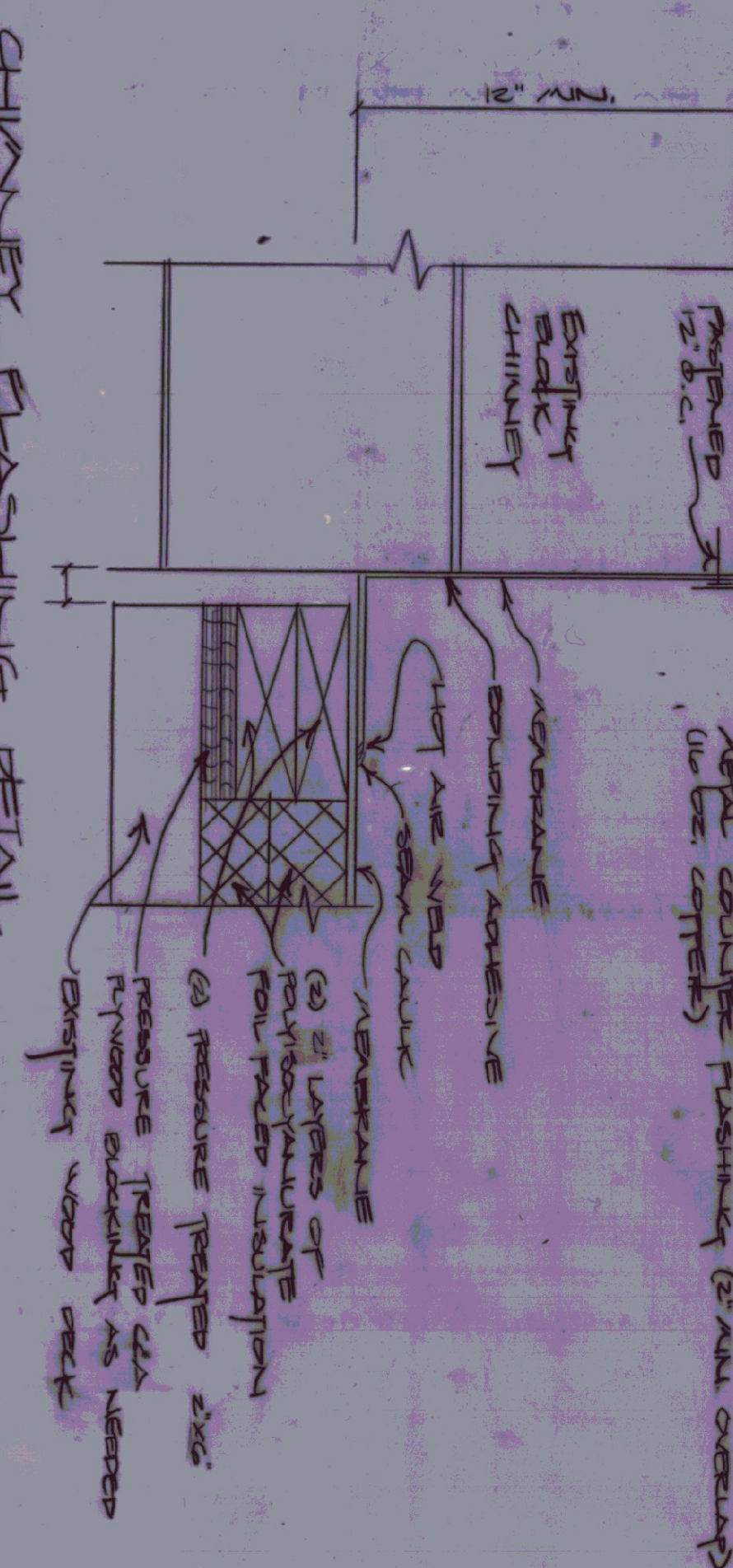

CHIMNEY FLASHING DETAIL
SCALE: 3/4"=1'-0"



LOCATION MAP

- NOTES**
- 1) REMOVE EXISTING EXTERIOR MATERIAL ABOVE WOOD RAISING STRUCTURE OF HOT SAUNDED STUDS FOR ADVISORY ROOFING SYSTEM.
 - 2) NO WOOD DECK DEGRADATION WAS OBSERVED AND THE WOOD DECK IS EXPOSED. ALL AREAS SHOWING DEGRADATION SHOULD BE REPAIRED AS REQUIRED BY SUBMITTAL REQUIREMENTS.
 - 3) REMOVE FROM SCOPES

STATE OF VERMONT		DEPARTMENT OF TRANSPORTATION	
DEPARTMENT OF STATE BUILDINGS		AGENCY OF STATE BUILDINGS	
AGENCY OF ADMINISTRATION		MONTPELIER, VERMONT	
DATE: August 26, 1987	SCALE: As Shown	REVISIONS:	WJG NO. 1
DRAWN BY: M. HANSEN	APPROVED BY: F. RAY		