

ALL CONDUIT / ELECTRICAL WIRE TO MEET STATE & LOCAL CODES INCLUDING PULL BOXES IF NECESSARY

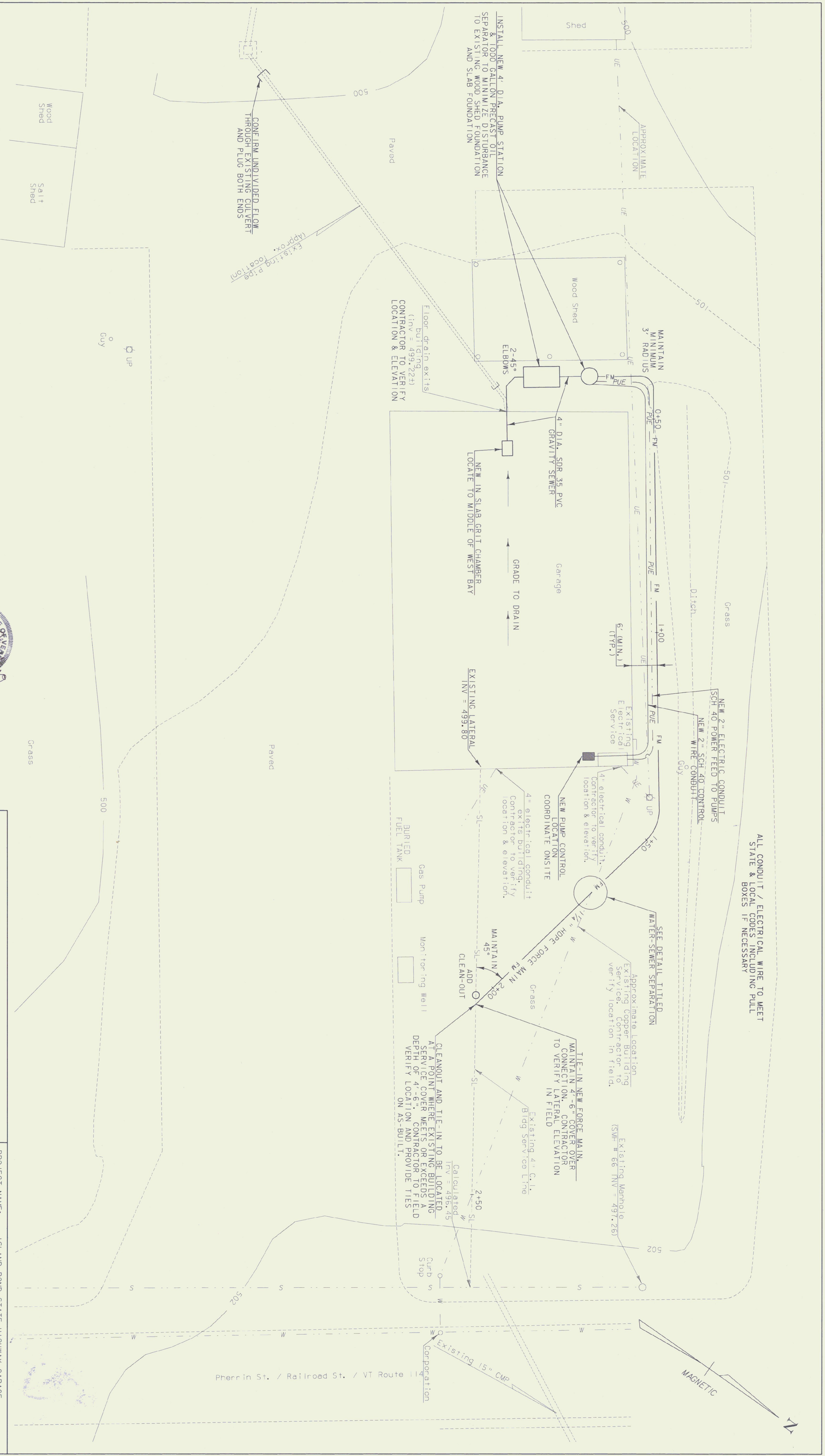

INSTALL NEW 4" DIA. PUMP STATION & 1000 GALLON PRECAST STORAGE TANK TO SEPARATE WOOD SHED DISTANCE TO EXISTING CONDUIT AND SLAB FOUNDATION

MAINTAIN MINIMUM 3' RADIUS

4" DIA. SDR-35 PVC GRAVITY SEWER

NEW 2" ELECTRIC CONDUIT SCH 40 POWER FEED TO PUMPS  
NEW 2" SCH 40 CONTROL WIRE CONDUIT

NEW PUMP CONTROL COORDINATE ON-SITE

SEE DETAIL TITLED WATER-SEWER SEPARATION

TIE-IN NEW FORCE MAIN. MAINTAIN 4'-6" COVER OVER CONNECTION. CONTRACTOR TO VERIFY LATERAL ELEVATION IN FIELD

CLEANOUT AND TIE-IN TO BE LOCATED AT A POINT WHERE EXISTING BUILDING SERVICE COVER MEETS OR EXCEEDS A DEPTH OF 4'-6". CONTRACTOR TO VERIFY LOCATION AND PROVIDE TIES ON AS-BUILT.

CONCRETE UNIDIVIDED FLOW THROUGH EXISTING CULVERT AND FLUG BOTH ENDS

Existing Pipe (Approx. Location)

DATUM  
VERTICAL N/A  
HORIZONTAL N/A

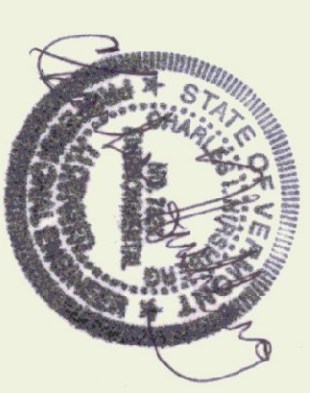

SCALE IN FEET  
10 0 10



The Gault House  
200 North Main Street  
Windsor, VT 05095  
(802) 549-1154 • Fax: (802) 549-1159  
email: cde@cdengineering.com • www.cdengineering.com  
Maine • New Hampshire • Vermont

PROJECT NAME: ISLAND POND STATE HIGHWAY GARAGE  
PROJECT NUMBER: 01-0120  
FILE NAME: 01-01201bdr.dgn  
PROJECT LEADER: CIH  
DESIGNED BY: JMS  
CLD REFERENCE NO.: 01-0120  
PLOT DATE: 01/21/2002  
DRAWN BY: PCJ  
CHECKED BY: JMS  
SHEET 2 OF 4

Pherrin St. / Railroad St. / VT Route 114