



SITE ENGINEER:



**CIVIL ENGINEERING ASSOCIATES, INC.**  
 P.O. BOX 468 SHELBURNE, VT 05482  
 802-485-2323 FAX: 802-485-2271 WWW.CEA-INC.COM

OWNER:

**STATE OF VERMONT**  
 DEPARTMENT OF BUILDINGS AND GENERAL SERVICES  
 MONTPELIER, VERMONT

PROJECT:

**MONTGOMERY GARAGE and SALT SHED**  
 VT ROUTE 118  
 MONTGOMERY, VERMONT

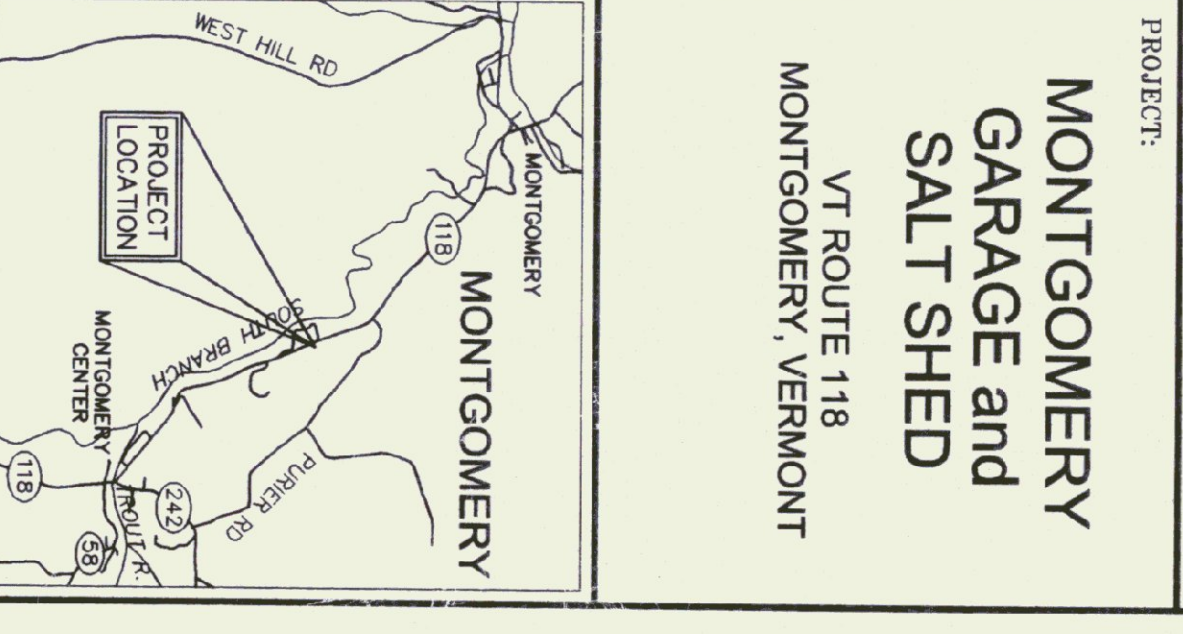

DATE	CHECKED	REVISION

**EXISTING CONDITIONS PLAN**

DATE: JAN., 2003  
 SCALE: 1" = 30'  
 PROJ. NO.: 01309.02

DRAWING NUMBER: **C1**

NOTE:  
 Underground utilities shown hereon are based on utility evidence visible at ground surface and are subject to field verification by excavation. Utilities shown do not purport to constitute or represent all utilities located upon or adjacent to the surveyed premises. All discrepancies shall be reported to the Engineer. The Contractor shall contact Dig Safe (800-225-4377) prior to any construction.

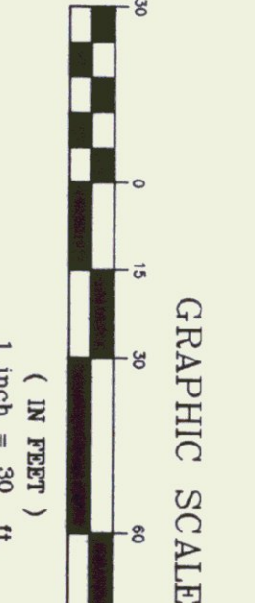
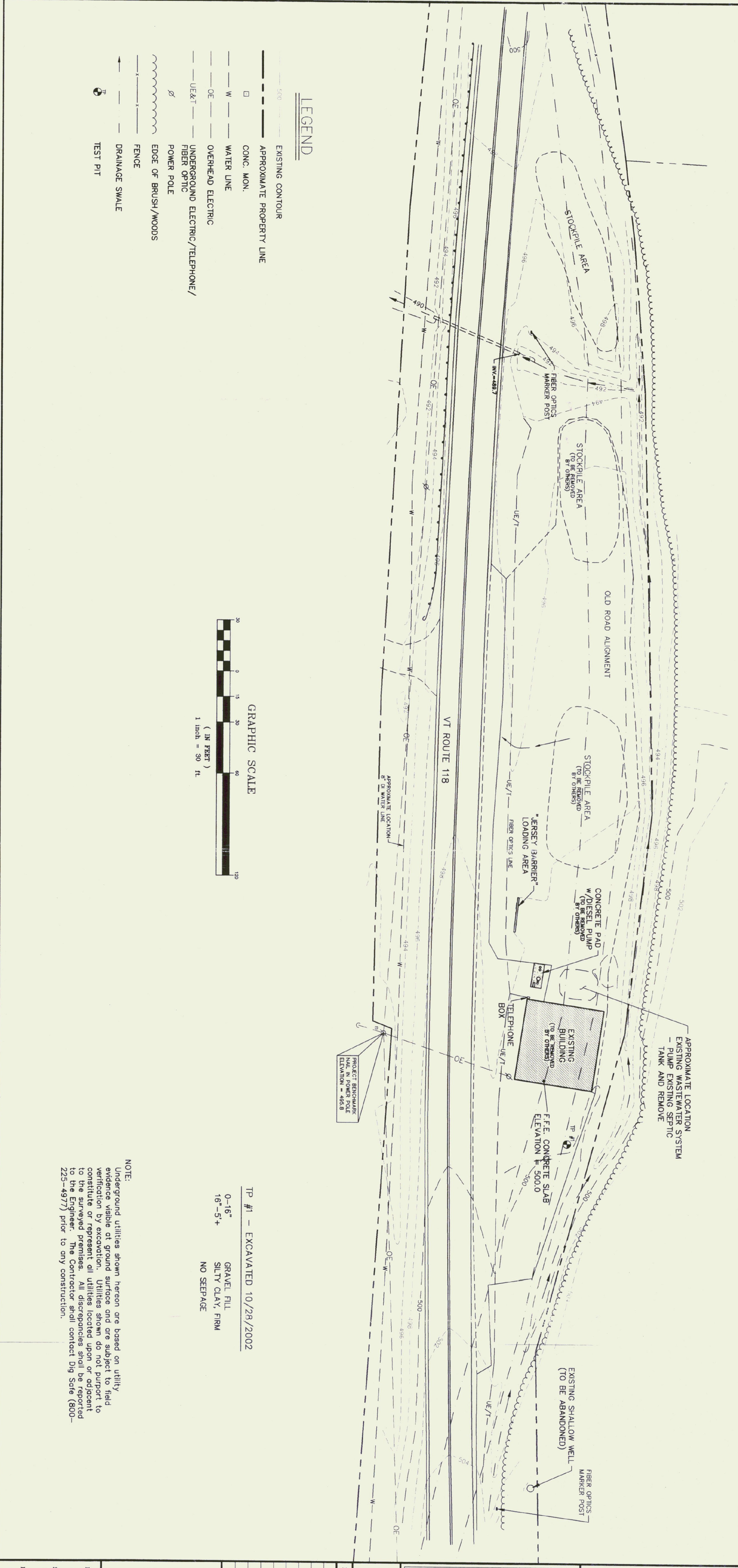

TP #1 - EXCAVATED 10/28/2002

0'-16" GRAVEL FILL  
 16"-5'+ SILTY CLAY, FIRM  
 NO SEEPAGE

**LEGEND**

--- EXISTING CONTOUR  
 --- APPROXIMATE PROPERTY LINE  
 □ CONC. MON.  
 --- WATER LINE  
 --- OVERHEAD ELECTRIC  
 --- UNDERGROUND ELECTRIC/TELEPHONE/  
 FIBER OPTIC  
 ⚡ POWER POLE  
 --- EDGE OF BRUSH/WOODS  
 --- FENCE  
 --- DRAINAGE SWALE  
 ⚓ TEST PIT