

FRANKLIN COUNTY
STATE AIRPORT

SITE PLAN

SCALE 1" = 40'

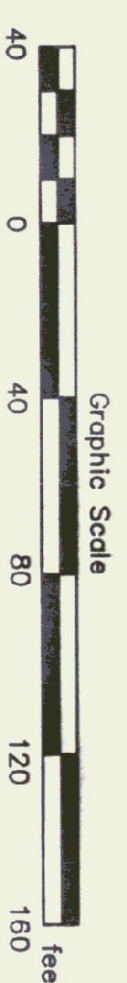

INTEGRATION BASIN #1
SEE DETAIL SHEET C-5

LEGEND

- EXISTING
- GAUARDRAIL
- TREE LINE
- VILLAGE OF SWANTON UTILITY POLE
- PROPOSED
- 10' HIGH CHAIN LINK FENCE
- LIMIT OF CLEARING
- DRILLED WELL
- TEST PIT LOCATION

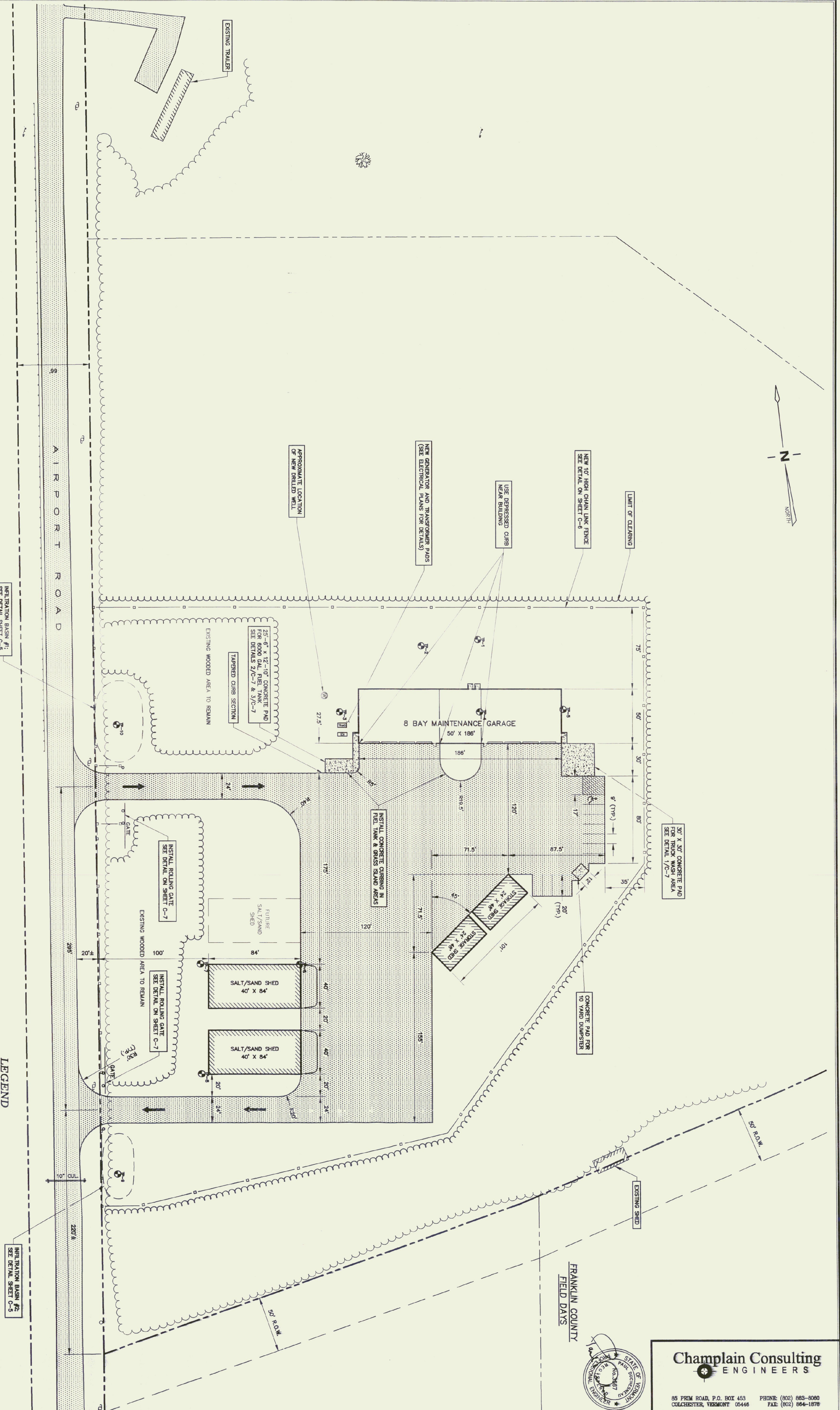

Approved By: *[Signature]*
Permit #: *WV-6-0534*
DATE: *5/16/01*

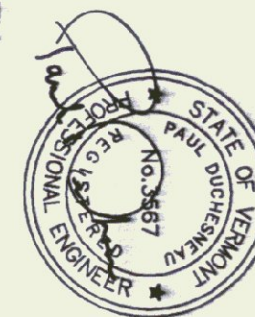
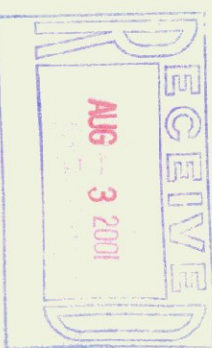

Champlain Consulting ENGINEERS
85 FROM ROAD, P.O. BOX 453 COLCHESTER, VERMONT 05446
PHONE: (802) 863-9080 FAX: (802) 864-1878

D&W DORE AND WHITTIER, INC.
1400 HANCOCK STREET QUINCY, MA 01906
PHONE: (617) 471-2897 FAX: (617) 471-2516

SCALE: 1" = 40'
DATE: 08/03/01
DRAWN BY: CCE
APPR. BY: PD

HIGHGATE MAINTENANCE GARAGE

AGENCY OF TRANSPORTATION
HIGHGATE MAINTENANCE FACILITY
HIGHGATE VERMONT



STATE OF VERMONT
DEPARTMENT OF BUILDINGS AND GENERAL SERVICES
AGENCY OF ADMINISTRATION
MONTPELIER, VERMONT

