

Champlain Consulting ENGINEERS
 85 PRM ROAD, P.O. BOX 453 COLCHESTER, VERMONT 05448
 PHONE: (802) 663-8060 FAX: (802) 664-1878

D&W
 DORE AND WHITTIER, INC.
 Architects • Project Managers
 1400 HANCOCK STREET COLUNY, MA 02169
 Phone: (617) 471-2897 Fax: (617) 471-2516

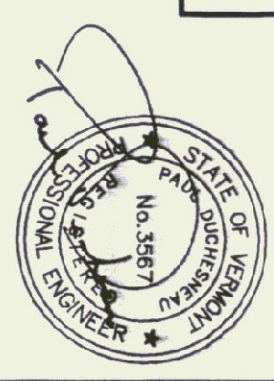

DESIGN SUMMARY:
 1. PROJECT DESCRIPTION:
 NEW VERMONT AGENCY OF TRANSPORTATION DISTRICT #8 MAINTENANCE FACILITY.
 2. CONTACTS:
 OWNER - STATE OF VERMONT
 VT. DEPT. OF BUILDINGS & GENERAL SERVICES
 MAINTENANCE DIVISION, ROOM 33
 100 STATE STREET, SUITE 300
 COLCHESTER, VERMONT 05448
 CONTACT: WESLEY MILLER - PROJECT MANAGER
 (802) 629-5889
 USER - AGENCY OF TRANSPORTATION, DISTRICT #8
 STATE OF VERMONT
 ST. JEAN, VT 05478-0317
 CONTACT: DE. NEWMARY, DISTRICT ADMINISTRATOR
 (802) 524-5928
 PROJECT ARCHITECT - DORE & WHITTIER
 1795 WILLETTON RD., STE 5
 S. BURLINGTON, VERMONT 05403
 CONTACT: ALAN BROWN
 (802) 663-8060

PROJECT ENGINEER - CHAMPLAIN CONSULTING ENGINEERS (CME)
 85 PRM ROAD, P.O. BOX 453
 COLCHESTER, VERMONT 05448
 CONTACT: (802) 663-8060
W.V. ENGINEERING ASSOCIATES (MECHANICAL)
 P.O. BOX 719
 KEENE, NH 03431 & WARREN
 CONTACT: (603) 352-7007
ENGINEERING VENTURES, INC. (STRUCTURAL)
 BURLINGTON, VT 05401
 CONTACT: KEVIN WOODEN
 (802) 863-8223

GENERAL NOTES:
 (1) This plan is for topographic purposes only and is not to be construed as a property boundary survey. Property lines are shown for reference only.
 (2) The existing field conditions are shown. The project engineer shall be notified immediately where discrepancies exist between the project drawings and actual field conditions.
 (3) The General Contractor shall contact the STATE at the location of all underground utilities to be located on the project site.
 (4) Where dimensions on the project drawings are underlined, contact the Project Engineer immediately for clarification.
 (5) It is the General Contractor's responsibility to ensure that the project drawings reflect the latest revisions.

JOB SITE SAFETY NOTES:
 (1) PROVIDE ADEQUATE SAFETY FOR ALL WORKERS AND THE GENERAL PUBLIC ON AND NEAR THE JOB SITE AT ALL TIMES.
 (2) FOLLOW THE SAFETY PROCEDURES SET FORTH BY THE VERMONT OCCUPATIONAL SAFETY AND HEALTH ADMINISTRATION (VOSH) AT ALL TIMES.
 (3) ALL EXCAVATION AND HOLE SHALL BE FULLY COVERED OR BARREDED AT THE END OF EACH WORKING DAY.
 (4) AT THE END OF EACH WORKING DAY, ALL UNFINISHED WORK SHALL BE PROTECTED BY BARRICADING AND LIGHTING TO PREVENT ACCIDENTS FROM ENTERING OR USING THE UNFINISHED AREA.

Approved By: *[Signature]*
 Permit #: *WV-6-0534*
 DATE: *8/16/01*
 Environmental Conservation Department

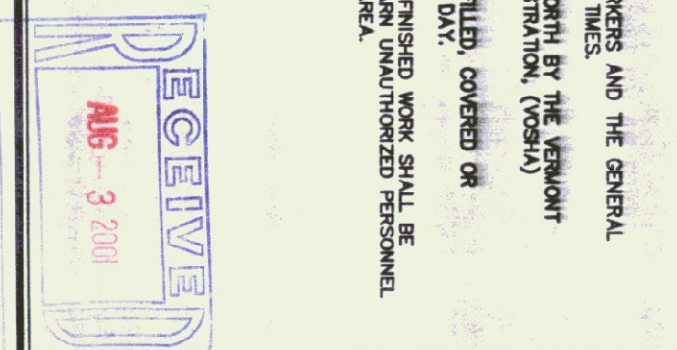

1 OF 7
 C-1
 MAINTENANCE GARAGE
 EXISTING CONDITIONS

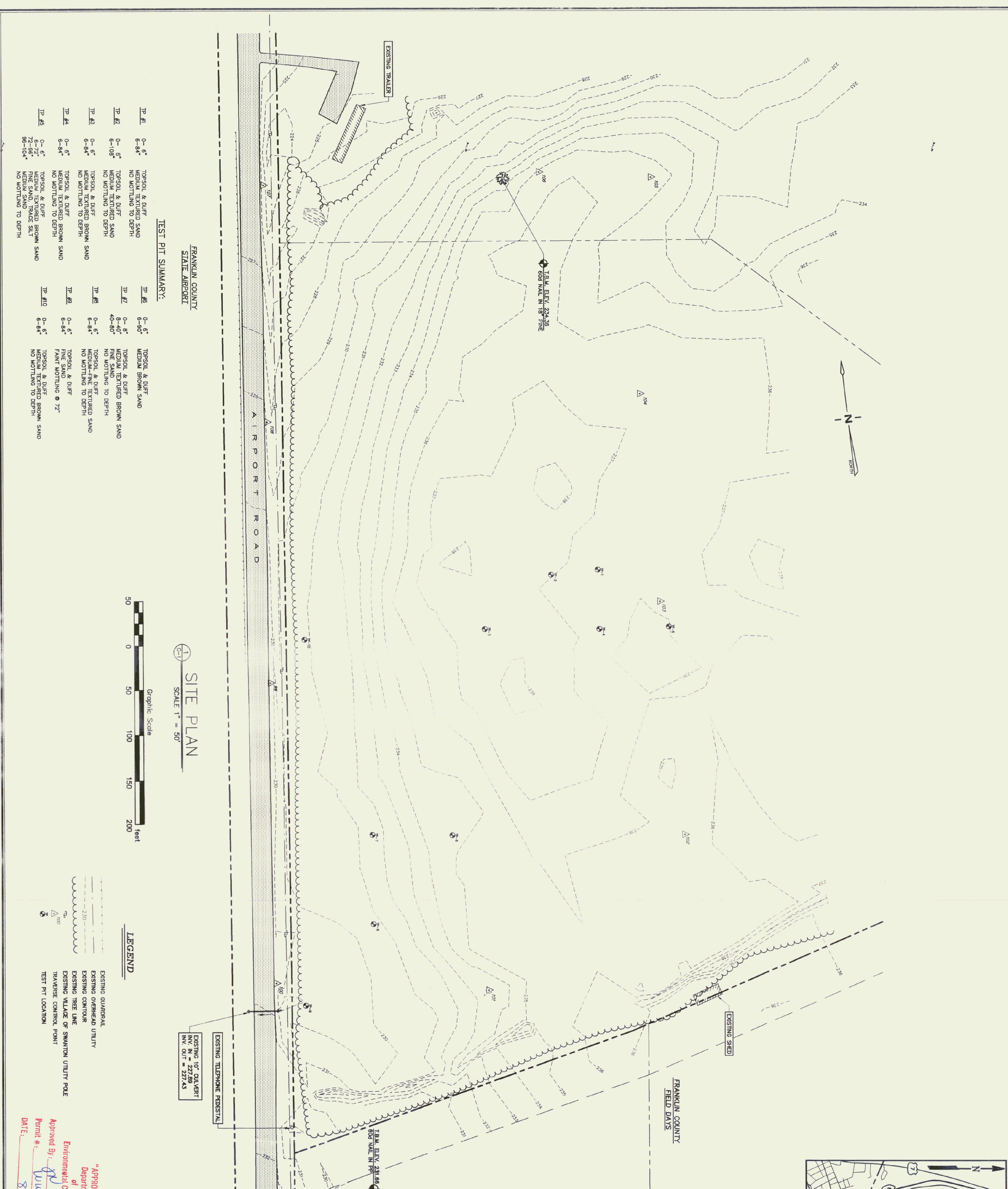

TEST PIT SUMMARY:

| TEST # | DEPTH | SOIL TYPE | TEST # | DEPTH | SOIL TYPE |
|--------|-------|-------------------|--------|-------|-------------------|
| TP #1 | 0-6" | TOPSOIL & DUFF | TP #6 | 0-6" | TOPSOIL & DUFF |
| TP #2 | 6-84" | MEDIUM BROWN SAND | TP #7 | 0-6" | MEDIUM BROWN SAND |
| TP #3 | 0-6" | TOPSOIL & DUFF | TP #8 | 0-6" | TOPSOIL & DUFF |
| TP #4 | 0-6" | TOPSOIL & DUFF | TP #9 | 0-6" | TOPSOIL & DUFF |
| TP #5 | 0-6" | TOPSOIL & DUFF | TP #10 | 0-6" | TOPSOIL & DUFF |

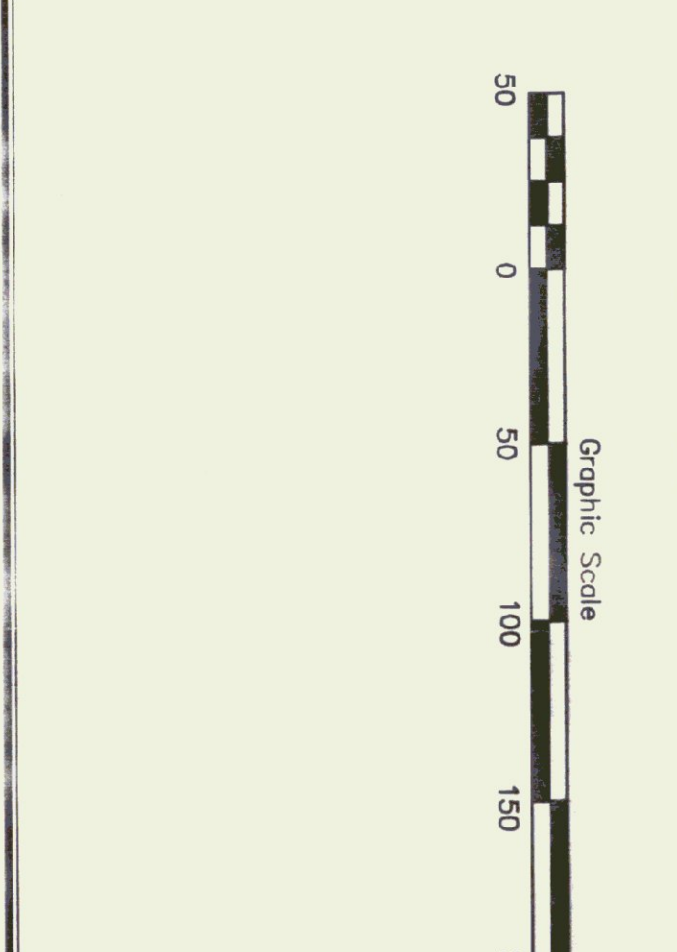

LEGEND:

- EXISTING QUARRIAL
- EXISTING OVERHEAD UTILITY
- EXISTING TREE CONTOUR
- EXISTING VILLAGE OF SWANTON UTILITY POLE
- TRAVERSE CONTROL POINT
- TEST PIT LOCATION

AGENCY OF TRANSPORTATION
 HIGHGATE MAINTENANCE FACILITY
 HIGHGATE VERMONT

STATE OF VERMONT
 DEPARTMENT OF BUILDINGS AND GENERAL SERVICES
 AGENCY OF ADMINISTRATION
 MONTPELIER, VERMONT