

- LUMBER NOTES**
- ALL LUMBER NOT INDICATED AS SUPPLIED BY OWNER IS THE RESPONSIBILITY OF THE CONTRACTOR
 - FRAMING MEMBERS TO BE KILN DRIED CONSTRUCTION GRADE SPOKE S4S 19%
 - PLATES AND WALLERS IN CONTACT WITH CONCRETE TO BE CCA #40 TREATED
 - BOARD AND BATTEN SIDING TO BE NATIVE ROUGH SAWN WHITE PINE. BOARDS TO BE RANDOM WIDTH 10'-12" BATTEN WIDTH 4"
 - BOARD SIDING AND BATTEN STRIPS TO BE FULL LENGTH WITH NO HORIZONTAL JOINTS
 - ALL NAILS TO BE GALVANIZED
- FINISH NOTES**
- GLE BEARDS AND BATTENS TO BE STAINED WITH ONE COAT OF TRANSPARENT STAIN TO RECEIVE ONE ADDITIONAL COAT OF STAIN
 - STAIN TO BE OLIVYAC OIL BASE SEMI TRANSPARENT OXFORD BROWN # 713

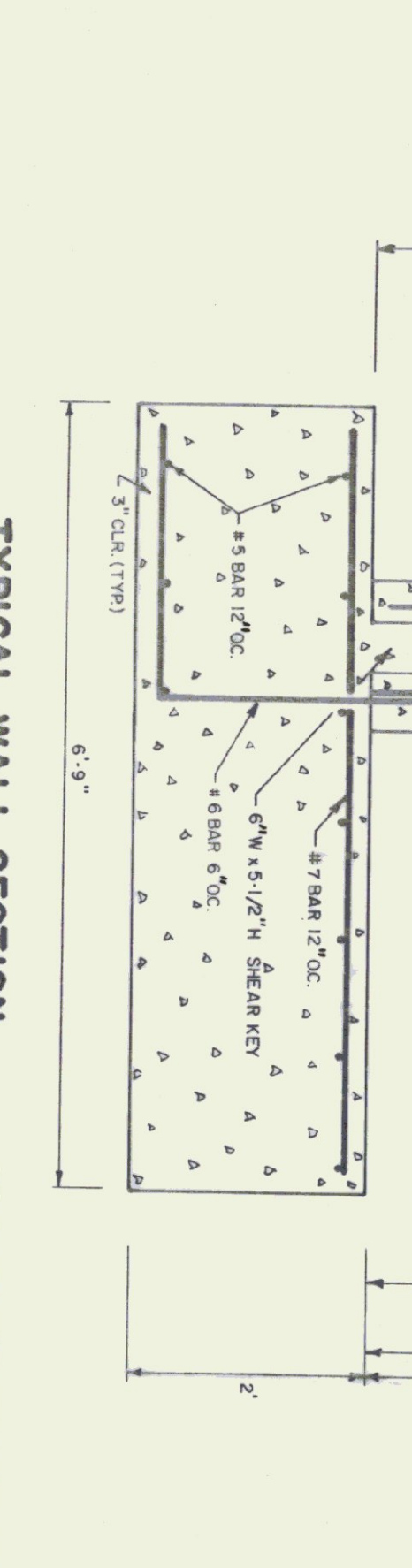

- TRUSS NOTES**
- TRUSS MANUFACTURER TO PROVIDE THE DEPT. OF STATE BUILDINGS ENGINEER A SET OF ENGINEERED & STAMPED DRAWINGS FOR APPROVAL. PRIOR TO TRUSS MANUFACTURE
 - TRUSS MANUFACTURER TO PROVIDE THE CONTRACTOR WITH ALL NECESSARY INSTRUCTIONS FOR PROPER TRUSS INSTALLATION, ANCHORAGE, BRACING, LIFTING, ETC.
 - TRUSS DESIGN LOADS IN ACCORDANCE WITH THE 1987 SDC FOR VERMONT
 - LIVE - PER 1987 SDC FOR VT (LOOR MIN.)
 - DEAD - AS CALCULATED FROM TRUSS & ROOF MATERIALS
 - WIND - 25 P.S.F.
 - DIAGONAL WIND BRACING PER TRUSS MANUFACTURER

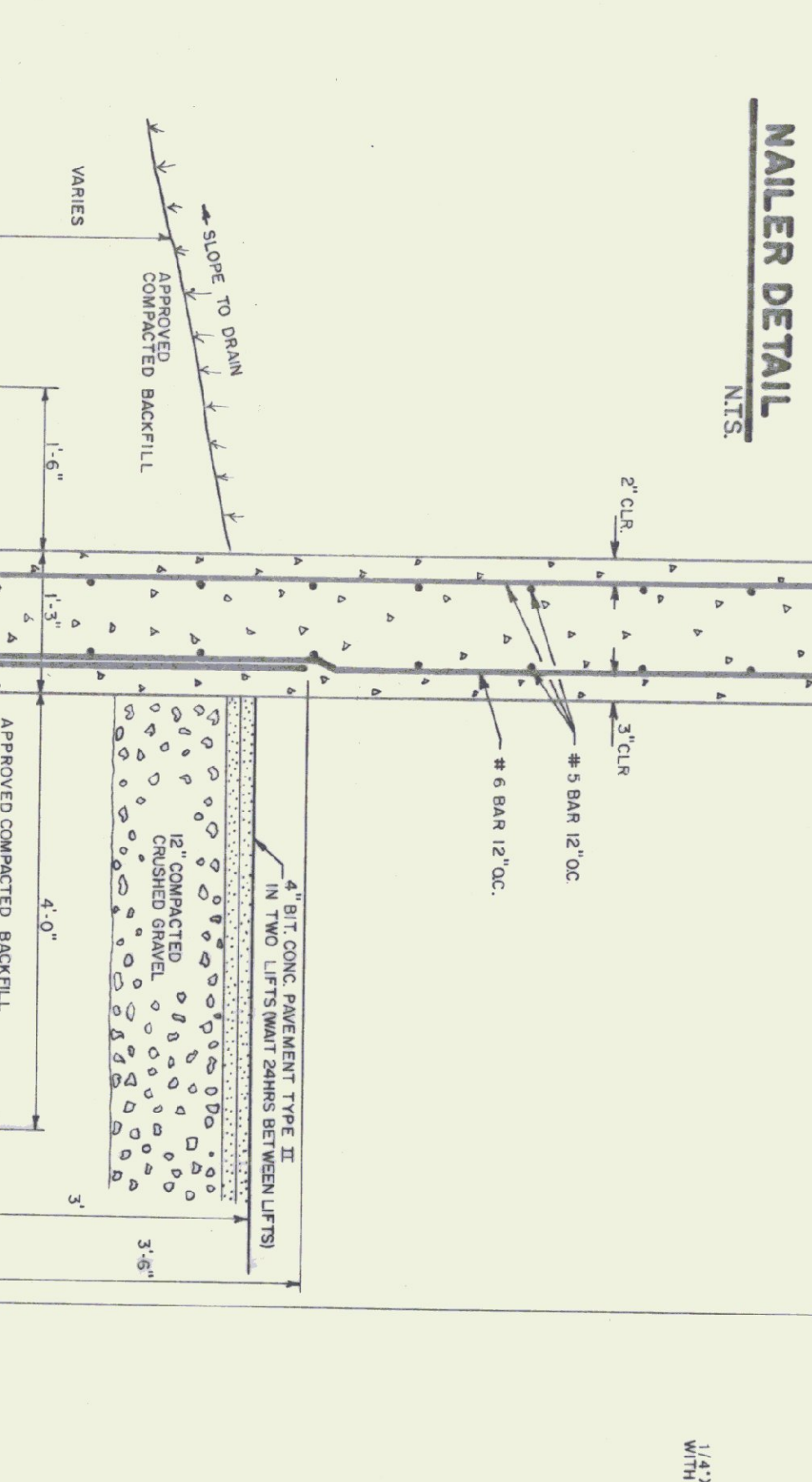
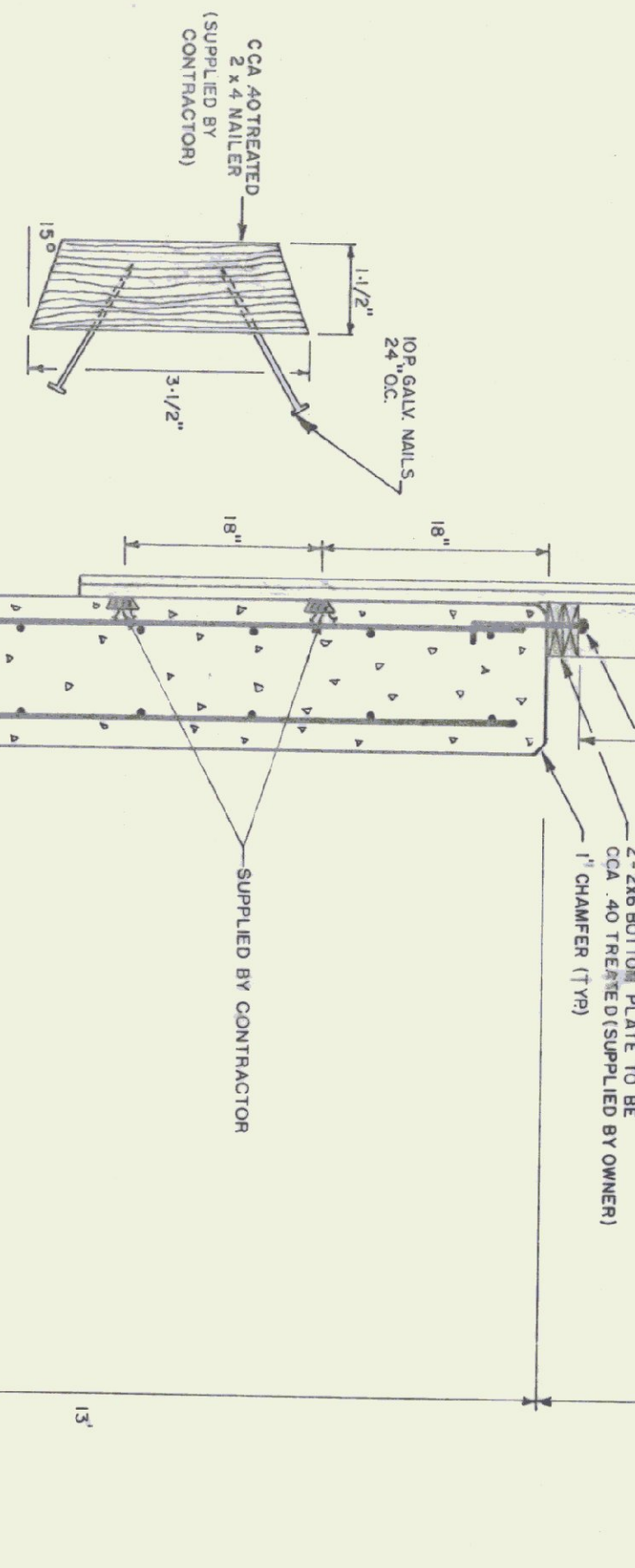
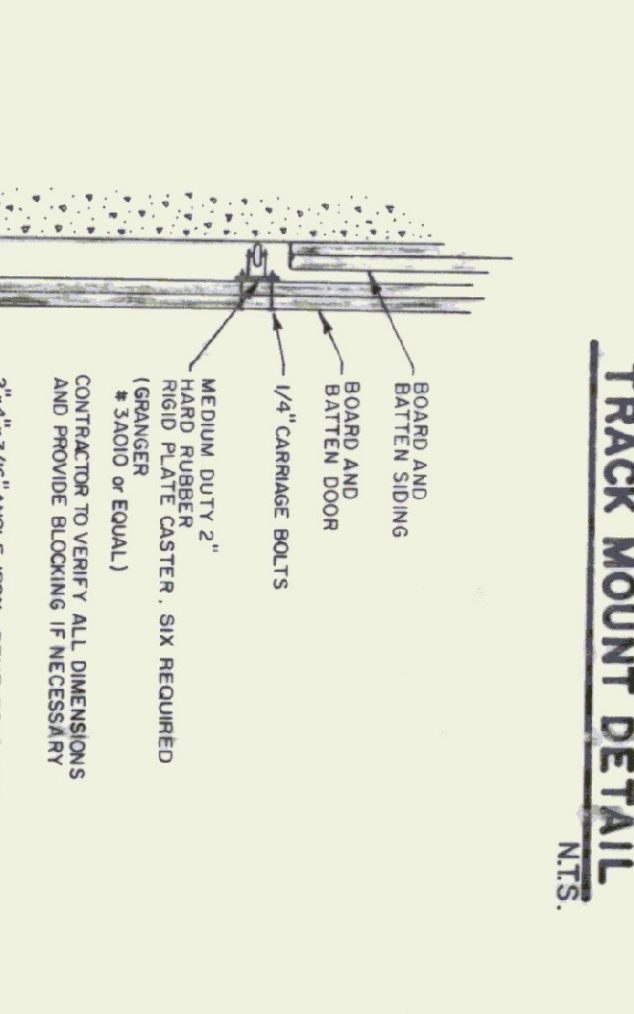
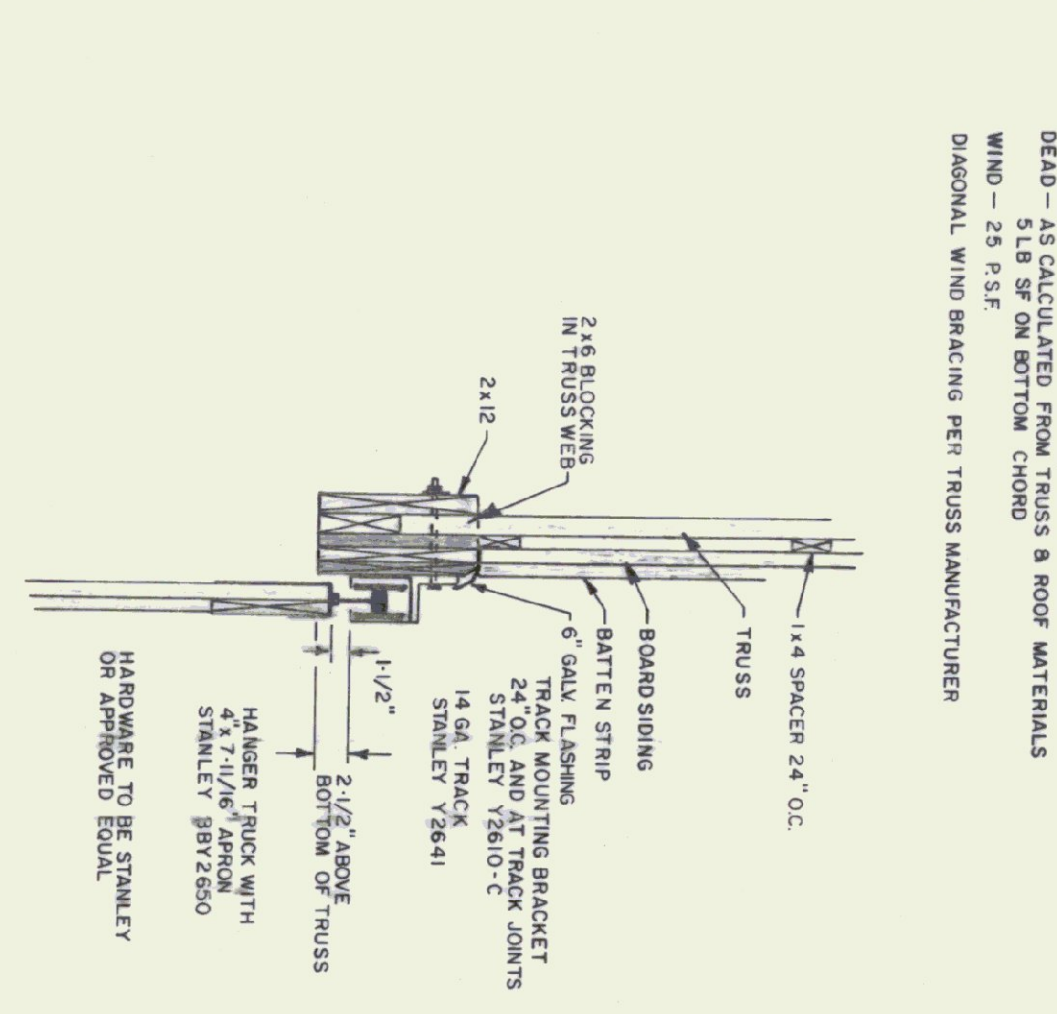

- CONCRETE NOTES**
- ALL CONCRETE TO BE 3500 PSI AT 28 DAYS WITH MAXIMUM SLUMP OF 4"
 - EXPOSED WALLS TO BE DRESS FINISHED.
 - 1/2" V-JOINTS IN EXPOSED FACE OF CONST. JOINTS.
 - 3/4" CHAMFER ON EACH FACE OF EXPANSION JOINTS
 - L-IRON CAST INTO WALL CORNERS AT DOOR OPENINGS.
 - RE BAR TO BE CONTINUOUS THROUGH CONST. JOINTS.
 - NO HORIZONTAL CONST. JOINTS IN WALLS, CONTINUOUS POUR
 - NO CONST. ON EXP. JOINTS REQUIRED IN FOOTINGS.
 - ALL RE BAR TO BE GRADE 60.
 - CONTRACTOR TO LEAVE NO METAL WITHIN 1" OF SURFACE. USE 1" DEEP PLASTIC CONES AT ALL TIES AND PLUG ALL THE HOLES WITH APPROVED NON SHRINK GROUT.
 - RE BAR TO BE STOKED ON BLOCKING 4" MIN ABOVE GROUND
 - CONCRETE SUPPLIER TO PROVIDE TEST CYLINDERS FOR TESTING BY OWNER
 - CONCRETE SUPPLIER TO CONDUCT ON SITE AIR TESTS

- NOTE:**
- ALL 2X6 AND 2X8 FRAMING LUMBER AND BOARD AND BATTEN SIDING WILL BE ROUGH SAWN AND SUPPLIED BY OWNER. (STATE OF VERMONT) CONTRACTOR TO SUPPLY ALL OTHER MATERIAL INCLUDING BOARD AND BATTEN FOR DOORS

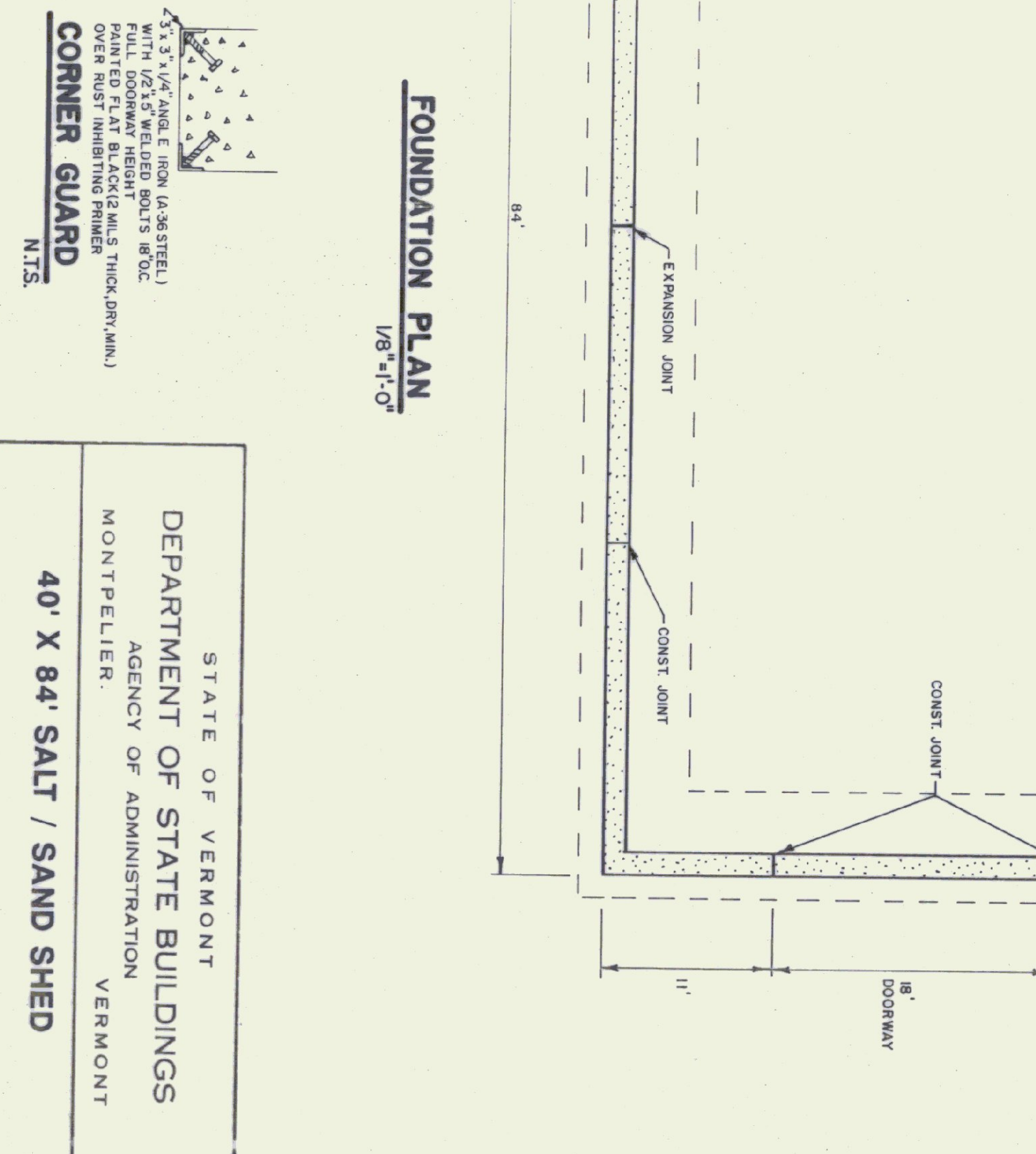
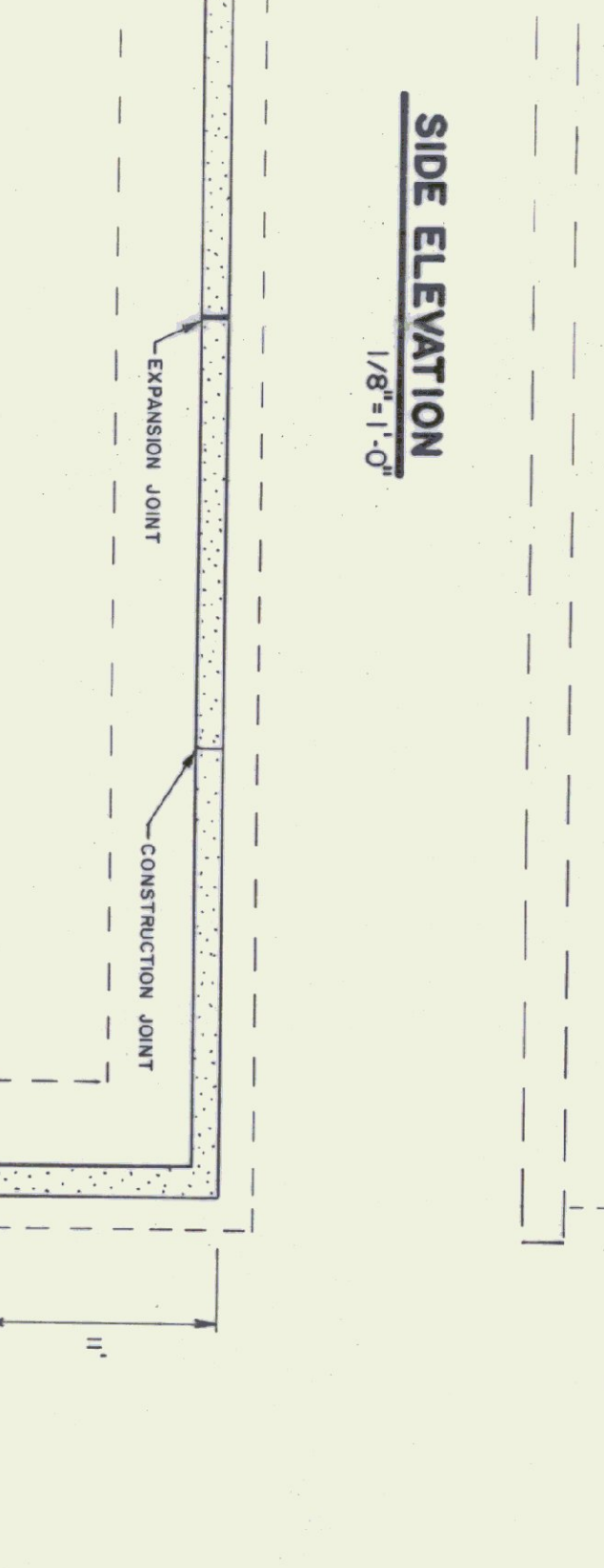
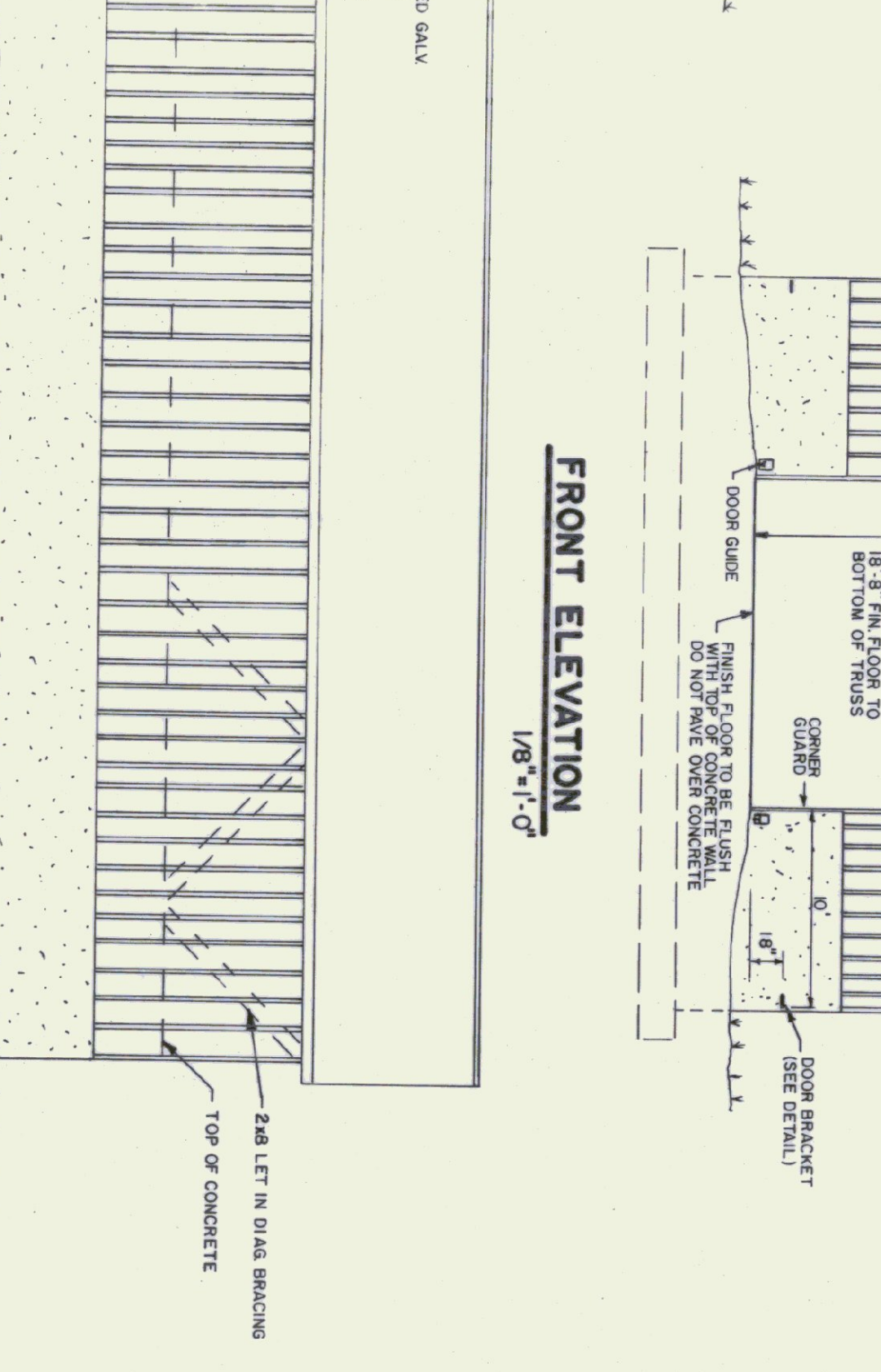
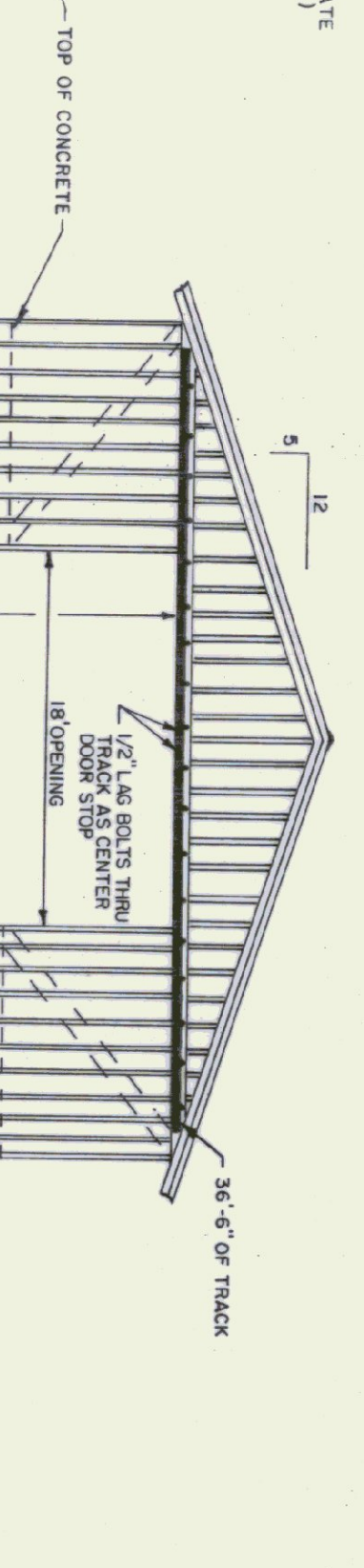
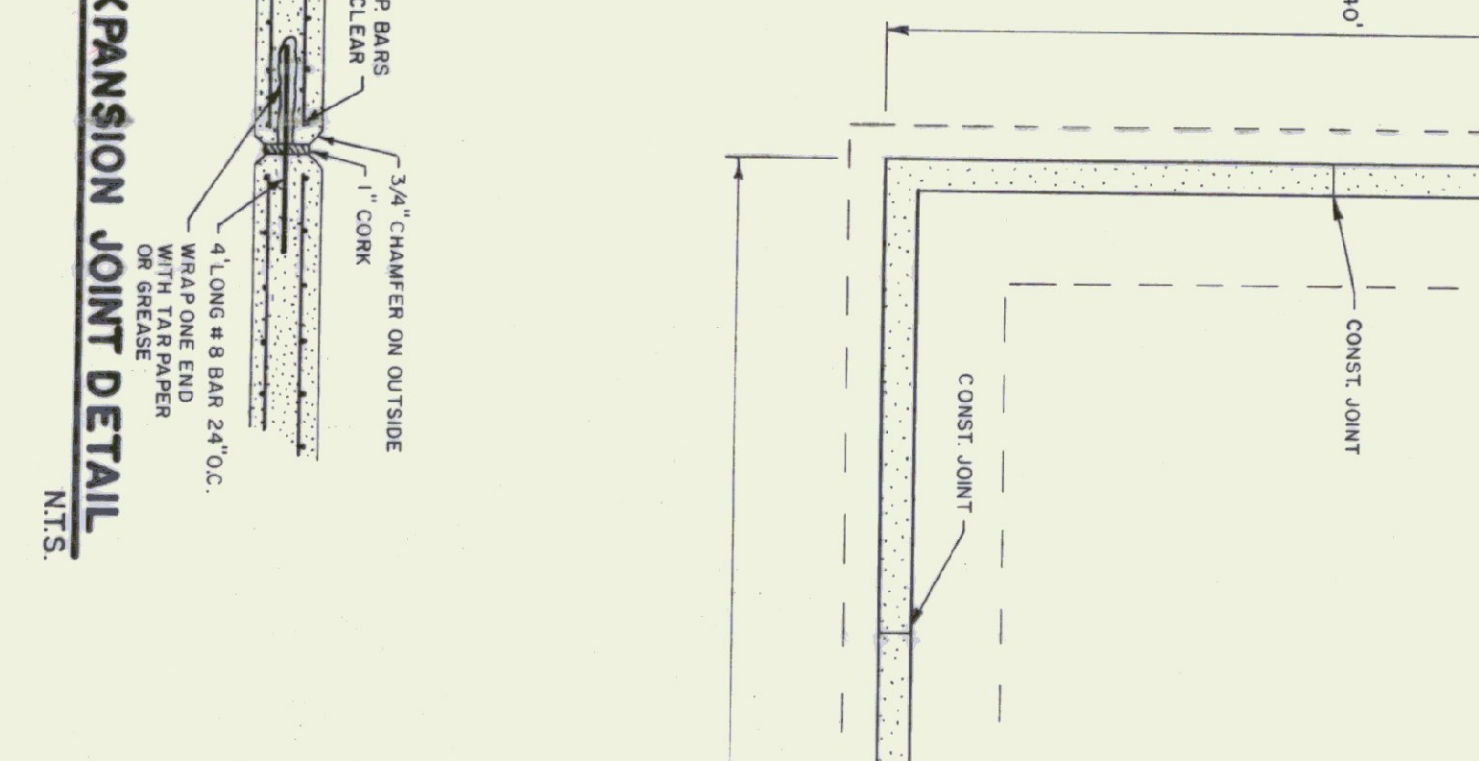
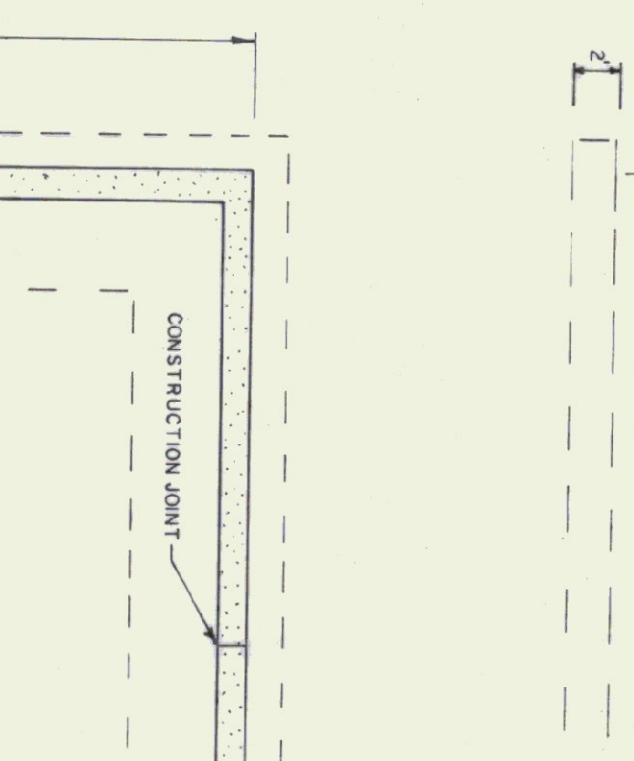
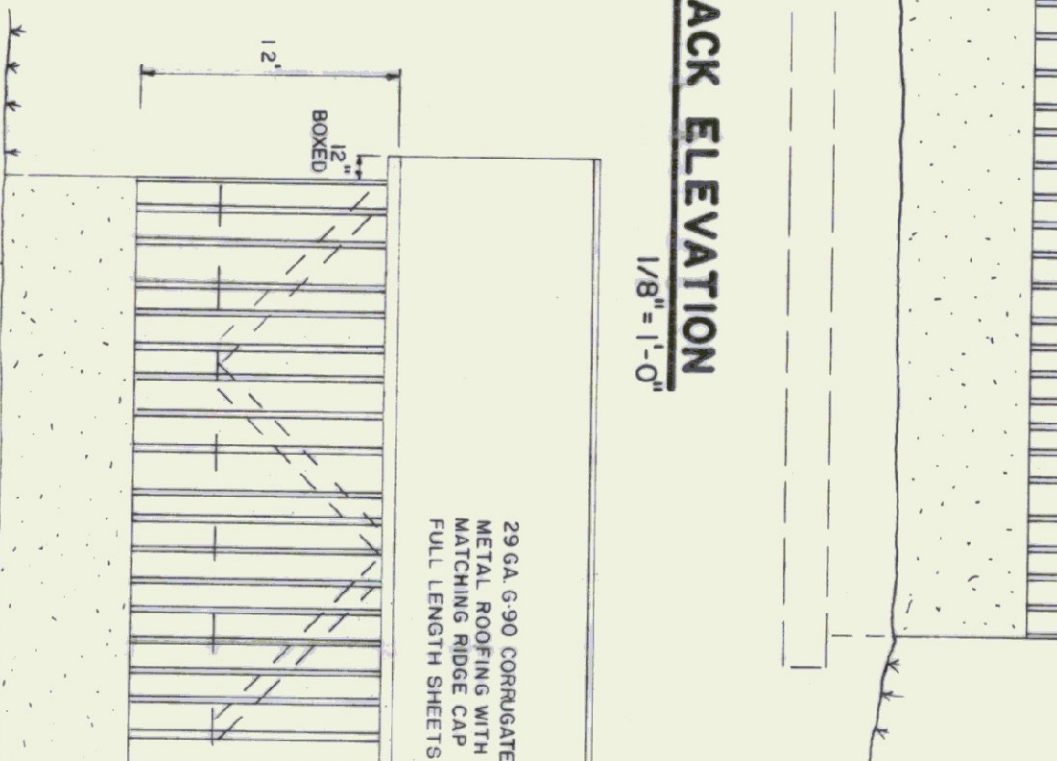
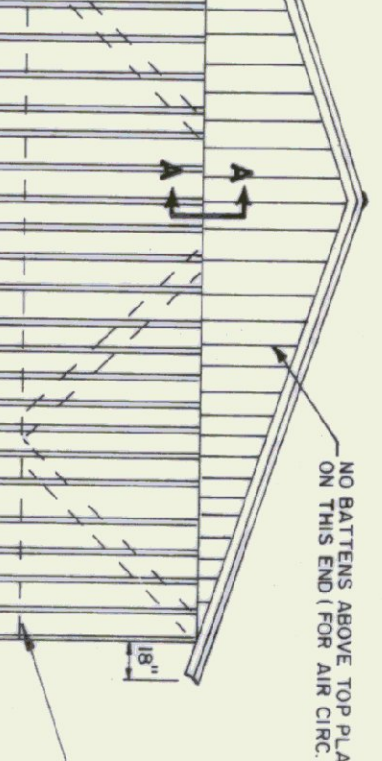
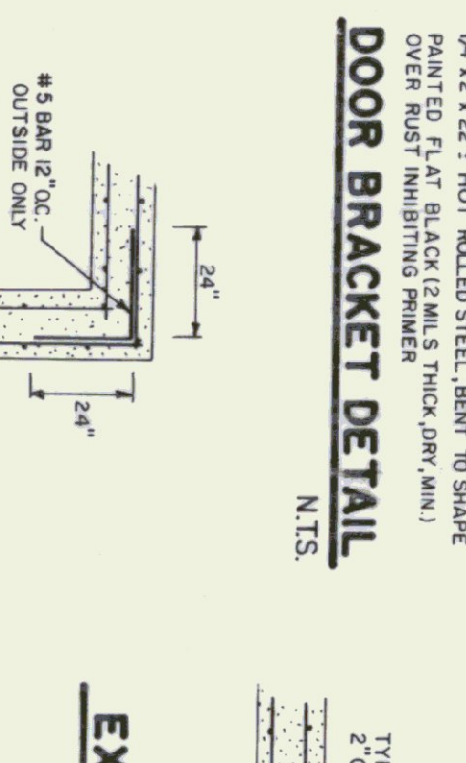
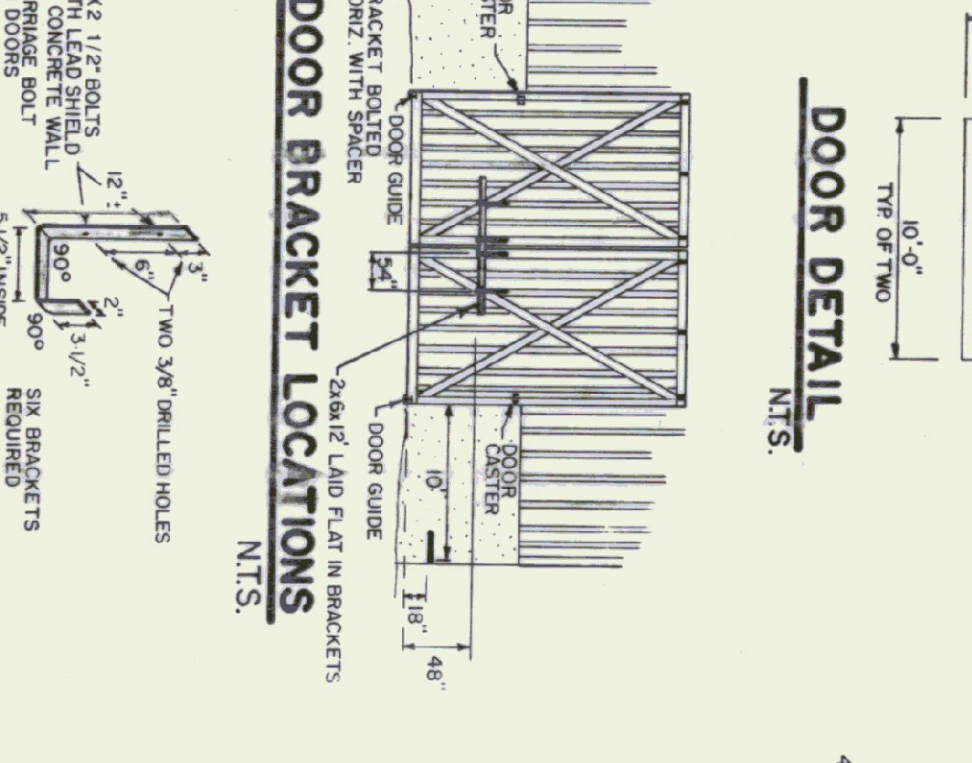
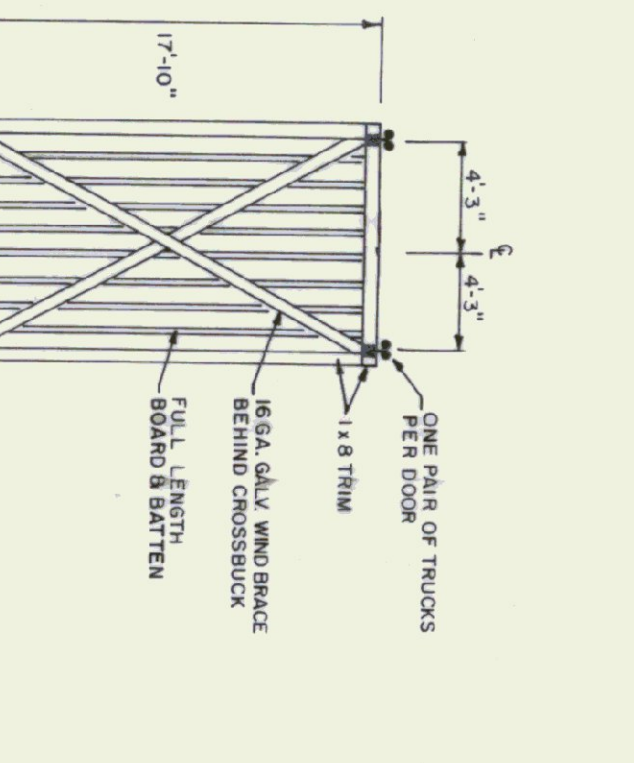
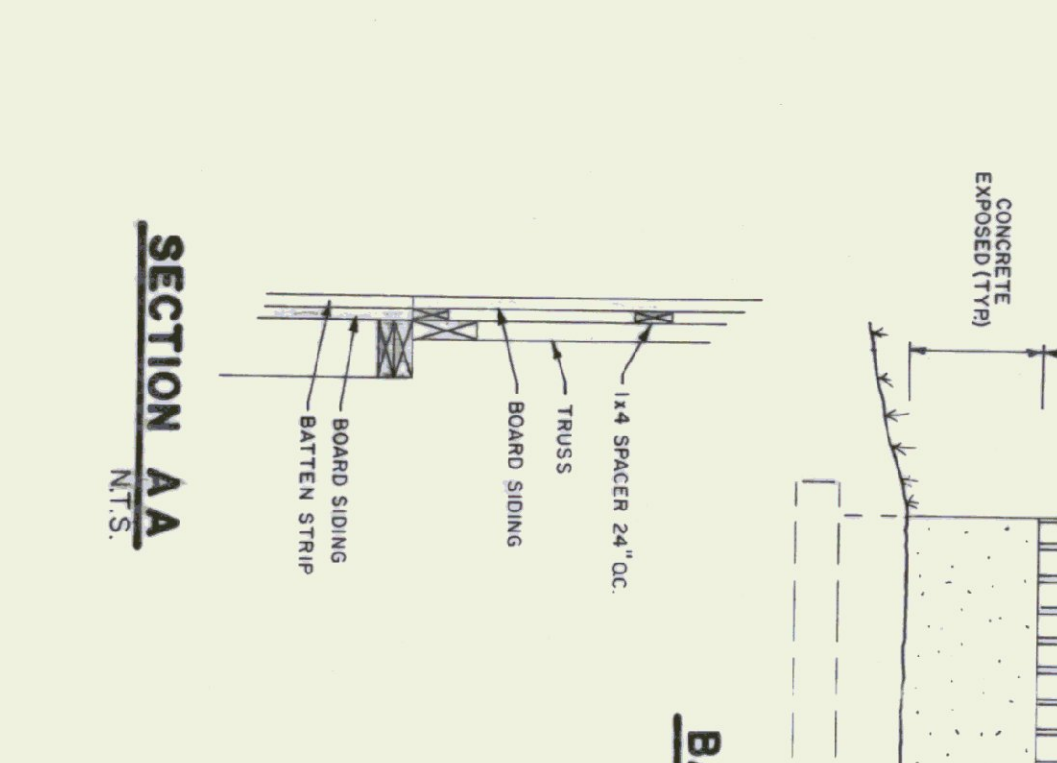
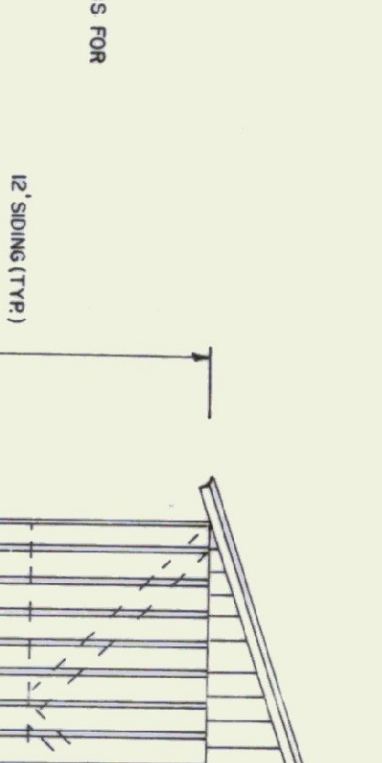

STATE OF VERMONT
DEPARTMENT OF STATE BUILDINGS
AGENCY OF ADMINISTRATION
VERMONT

40' X 84' SAND SHED

ST. JOHNSBURY
DATE: APRIL 1994
SCALE: AS NOTED
DRAWN BY: [Signature]

REVISIONS:
3-24-94 V.B.
2

VERMONT
DWG NO. 2
2 OF 2