

**GENERAL NOTES**

ALL CONCRETE SHALL BE 3000 PSI AT 28 DAYS/MAX. SLUMP OF 4". ALL EXPOSED CONCRETE WALLS SHALL BE RUBBED. ALL CONSTRUCTION JOINTS FOR WALLS TO HAVE "V" JOINT IN EXPOSED FACE. ALL CONCRETE TO BE CURED, 5/8" TO BE COVERED WITH SISALKRAFT 2400 EXPANSION JOINTS TO HAVE TOOLED EDGES.

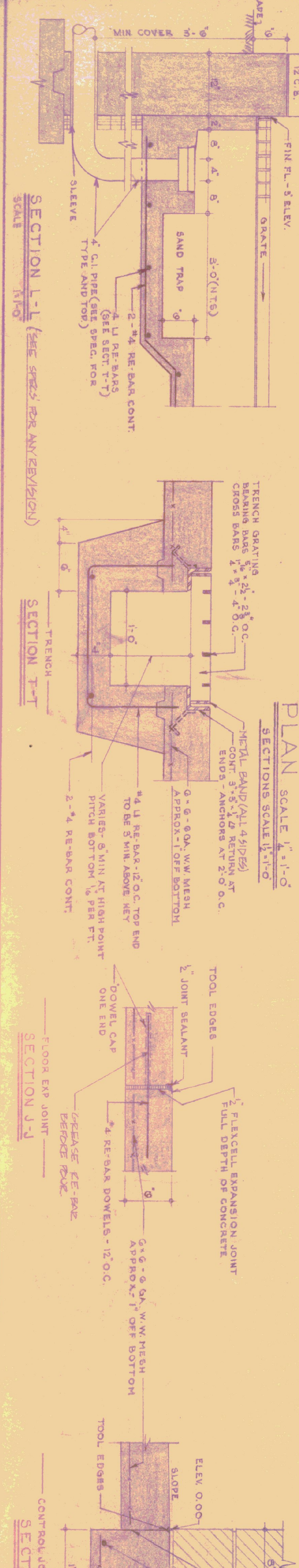
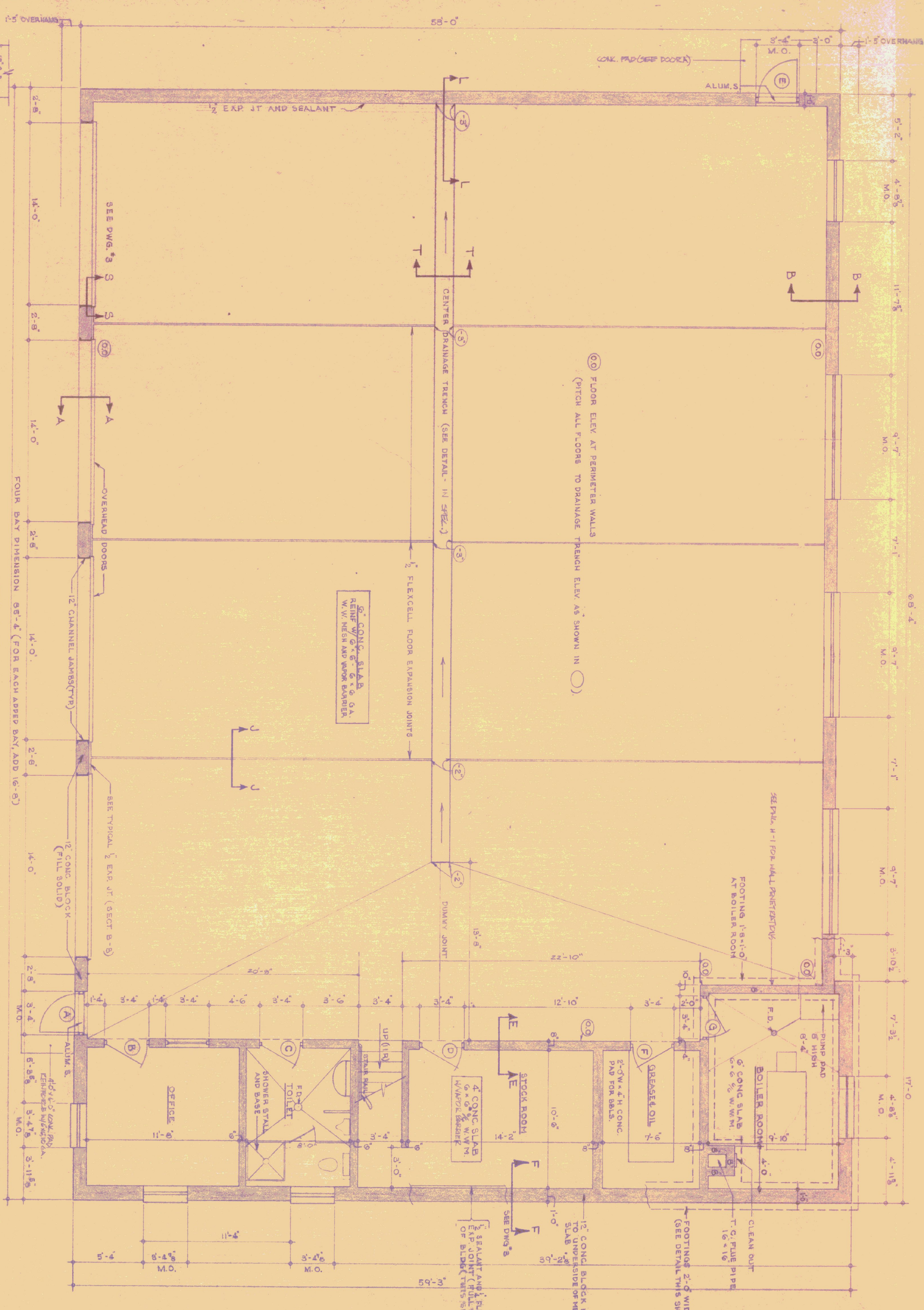

**PLAN SCALE 1/4" = 1'-0"**  
**SECTIONS SCALE 1/2" = 1'-0"**

FOUR BAY DIMENSION 95'-4" (FOR EACH APPROX BAY, ADD 16"-8")

**SECTION L-L (SEE SPEC FOR ANY REVISION)**  
 SCALE 1/4" = 1'-0"

**SECTION T-T**

**SECTION J-J**

**SECTION E-E**

**SECTION A-A**

**SECTION B-B**

**STATE OF VERMONT**  
**DIVISION OF STATE BUILDINGS**  
 AGENCY OF ADMINISTRATION  
**MONTPELIER, VERMONT**

**Standard Four Bay Highway Garage Bldg.**  
**FLOOR, PLAN & FOUNDATION DETAILS**

SCALE: As noted

DATE: 10/18/74  
 DRAWN BY: [Signature]  
 DESIGNED BY: [Signature]  
 APPROVED BY: [Signature]  
 STUDY NO. 1140

DWG. NO. **A11**