

INDEX OF SHEETS

1	TITLE SHEET
2	QUANTITY SHEET
SD-1	GENERAL NOTES & DETAILS
SD-2	SITE PLAN
SD-3	CROSS SECTIONS
A-1	BUILDING DETAILS - 40' X 84' SAND-SALT SHEDS

STANDARDS

B-5	SLOPE GRADING, EMBANKMENTS, MUCK	06/01/94
B-11	METHODS OF SLOPE STABILIZATION	06/01/94
D-3	TREATED GUTTERS	06/01/94
D-11	CAST IRON COVER	06/01/94
T-1	TEMPORARY EROSION CONTROL DETAILS	06/01/94
T-2	TEMPORARY EROSION CONTROL DETAILS	06/01/94

STATE OF VERMONT
 AGENCY OF TRANSPORTATION

 PROPOSED IMPROVEMENT
 CONSTRUCTION OF NEW
 SAND-SALT SHEDS
 TOWN OF NORTH MONTPELIER
 COUNTY OF WASHINGTON

WORK TO BE PERFORMED UNDER THIS CONTRACT INCLUDES
 CONSTRUCTION OF A NEW SAND-SALT SHEDS, SITE WORK,
 PAVING, DRAINAGE, LANDSCAPING, AND INCIDENTAL ITEMS.

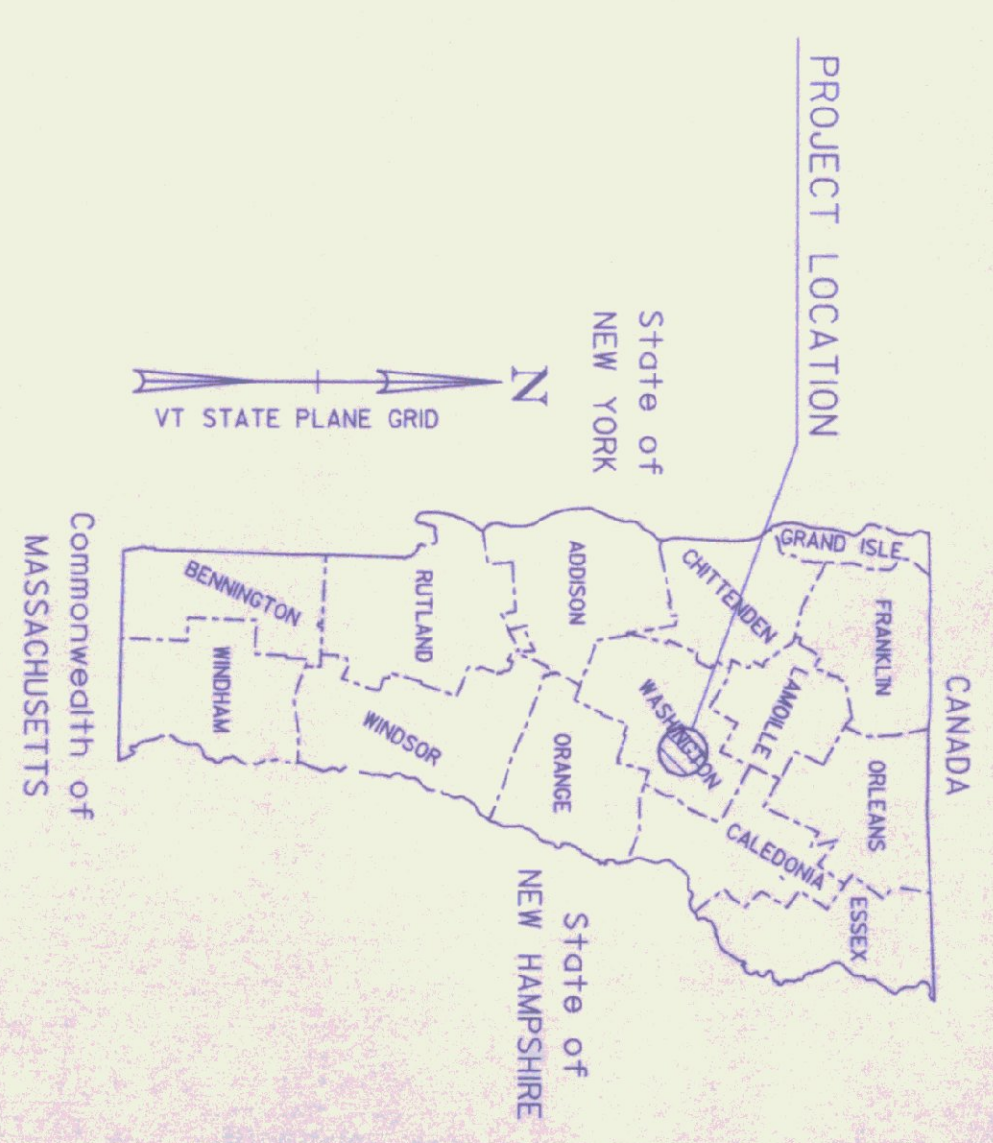
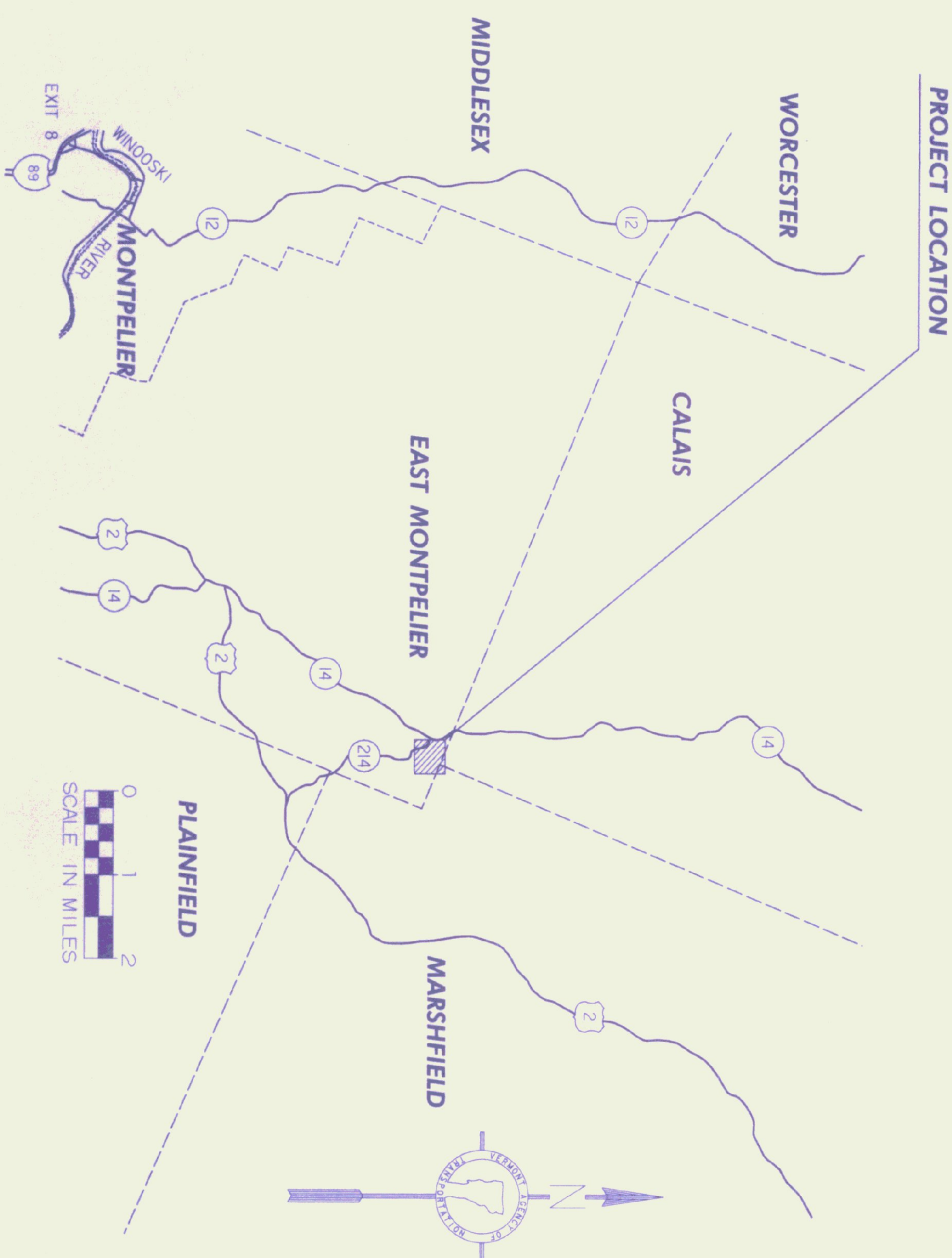

THESE PLANS ARE SUBJECT TO SUCH ENGINEERING
 CHANGES AS MAY BE REQUIRED BY THE CHIEF ENGINEER.
 CONSTRUCTION IS TO BE CARRIED ON IN ACCORDANCE
 WITH THESE PLANS AND THE STANDARD SPECIFICATIONS
 FOR CONSTRUCTION DATED 1990, AS APPROVED BY THE
 FEDERAL HIGHWAY ADMINISTRATION ON MARCH 15, 1990
 FOR USE ON THIS PROJECT, INCLUDING ALL SUBSEQUENT
 REVISIONS AND SUCH REVISED SPECIFICATIONS AND
 SPECIAL PROVISIONS AS ARE INCORPORATED IN THESE
 PLANS.

*Contract Plans
 Rev'd Sept, 1999
 9/29/99
 on file
 east*

DATUM
 VERTICAL _____
 HORIZONTAL _____



540 COMMERCIAL ST.
 WORCESTER, VT 05091
 TEL: 802/866-8800 FAX: 802/866-8802
 E-MAIL: CDE@CDEENGINEERS.COM

APPROVED _____	DIRECTOR OF MAINTENANCE	DATE _____
PROJECT NORTH MONTPELIER STP SALTSD	SHEET 1 OF 6	SHEETS

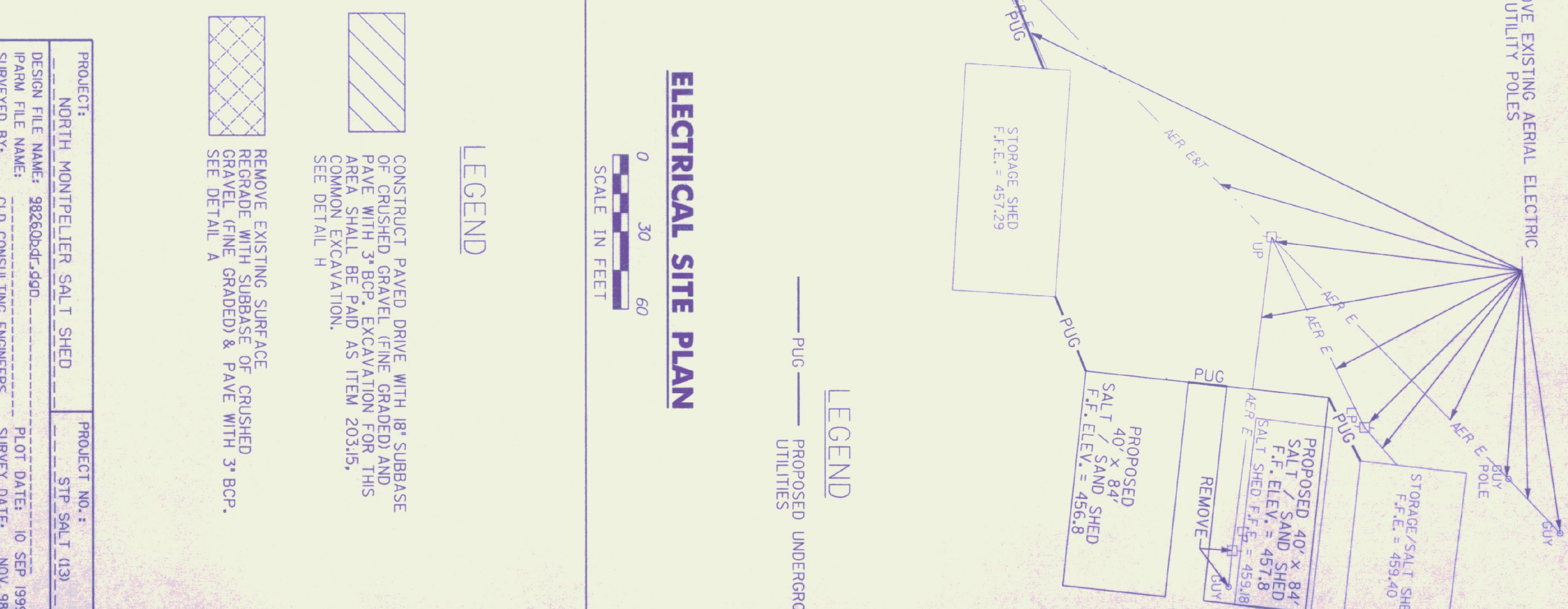
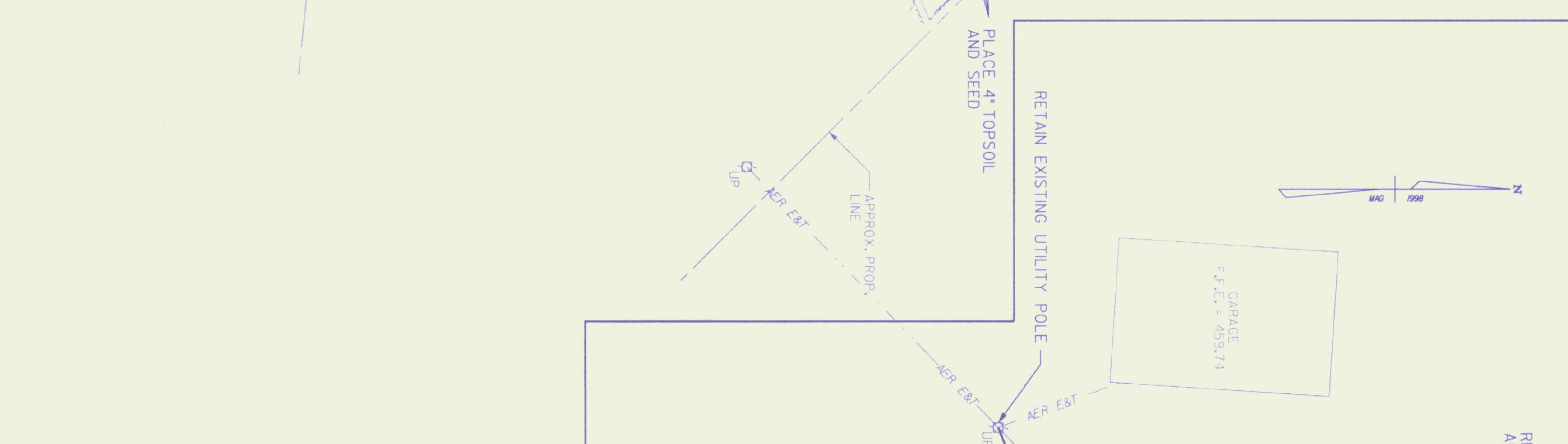

ELECTRICAL SITE PLAN

0 30 60
SCALE IN FEET

PROPERTY LINES
PROPERTY LINE INFORMATION WAS OBTAINED FROM AN UNDATED PLAN TITLED "NORTH MONTPELIER PROPOSED NEW SHED LOCATIONS" AS PROVIDED BY THE VERMONT AGENCY OF TRANSPORTATION. PROPERTY LINE INFORMATION IS SHOWN FOR GRAPHICAL PURPOSES ONLY AND SHOULD BE CONSIDERED APPROXIMATE.

LEGEND

REMOVE EXISTING AERIAL ELECTRIC AND UTILITY POLES

RETAIN EXISTING UTILITY POLE

PROPOSED UNDERGROUND UTILITIES

CONSTRUCT PAVED DRIVE WITH 18" SUBBASE OF CRUSHED GRAVEL (FINE GRADED) AND PAVE WITH 3" BCP. EXCAVATION FOR THIS AREA SHALL BE PAID AS ITEM 203.15, COMMON EXCAVATION. SEE DETAIL H

REMOVE EXISTING SURFACE REGRADE WITH SUBBASE OF CRUSHED GRAVEL (FINE GRADED) & PAVE WITH 3" BCP. SEE DETAIL A

PROJECT: NORTH MONTPELIER SALT SHED PROJECT NO.: STP-SALT (13)

DESIGN FILE NAME: 982600dr.dgn PLOT DATE: 10 SEP 1999

IPARM FILE NAME: CUD CONSULTING ENGINEERS SURVEY DATE: NOV 98

SURVEYED BY: L. WARNER DRAWN BY: E. HOLT

SOUND LEADER: SHEET: SD-2

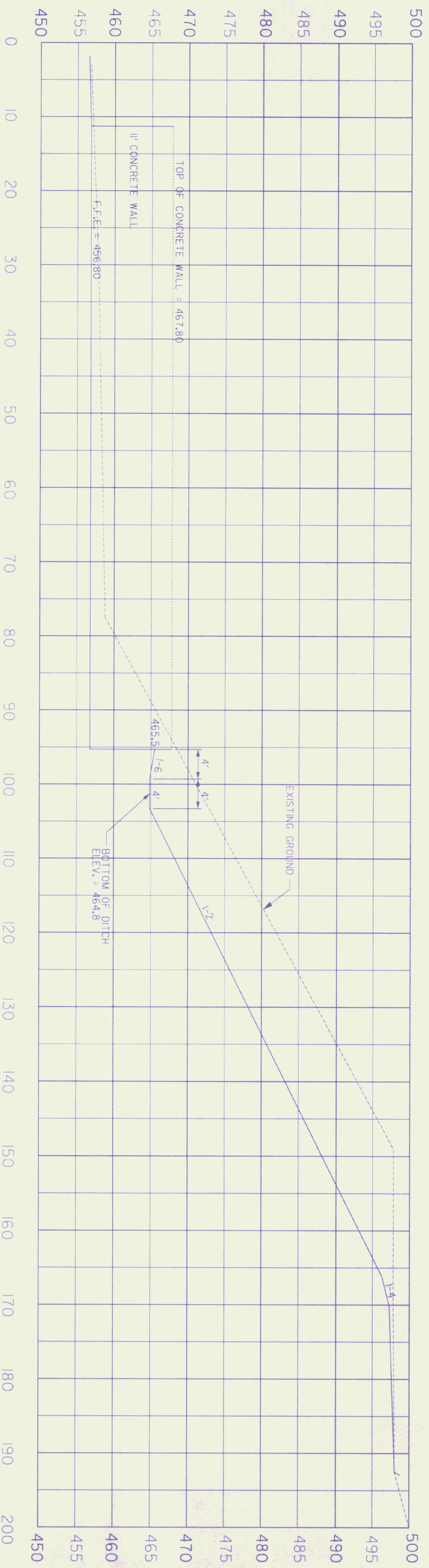

SECTION A-A

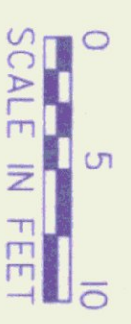

PROJECT:	NORTH MONTPELLIER SALT SHED	PROJECT NO.:	STP SAL 1113
DESIGN FILE NAME:	xsact-bdr.dgn	PLOT DATE:	10 SEP 1999
IPARM FILE NAME:	CLD_CONSULTING_ENGINEERS	SURVEY DATE:	
SURVEYED BY:	J. WARNER	DRAWN BY:	SMC
SQUAD LEADER:		SHEET:	SD-3