

CENTRAL GARAGE ELECTRICAL PLAN

SCALE=1/8"=1'-0"

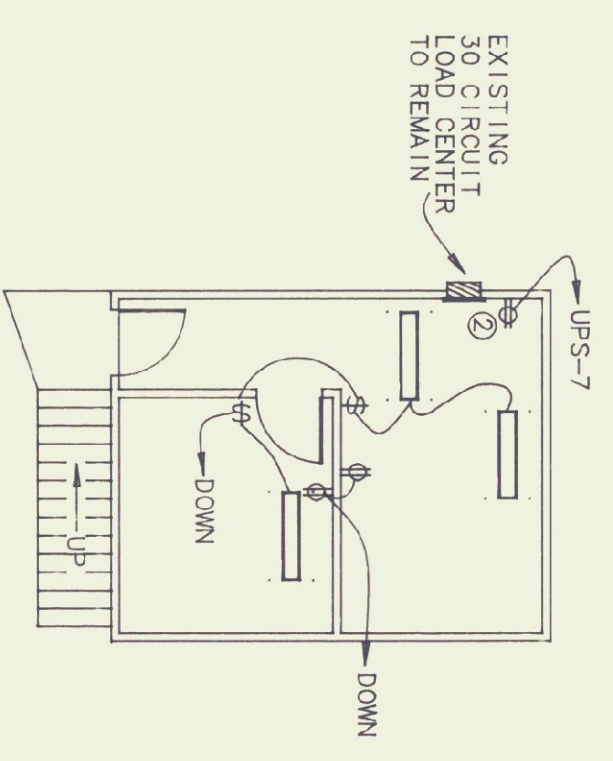

SECOND FLOOR OFFICE

SCALE=1/8"=1'-0"

KEYED NOTES

- ① EXISTING DEVICE - PROVIDE NEW BRANCH CIRCUIT
- ② PROVIDE NEW DEVICE AND NEW BRANCH CIRCUIT
- ③ NIGHT LIGHT CIRCUIT LIGHT FIXTURE IS NOT SWITCHED.
- ④ PROVIDE NEW JUNCTION BOX AND BRANCH CIRCUITS FOR DIESEL PUMP, GAS PUMP, KEROSENE PUMP AND FUEL ISLAND LIGHTS REMOVE EXISTING BRANCH CIRCUITS FOR THESE ITEMS FROM PANEL P-1.
- ⑤ PROVIDE NEW JUNCTION BOX AND BRANCH CIRCUIT FOR OVERHEAD DOORS. REMOVE EXISTING BRANCH CIRCUIT FROM PANEL.
- ⑥ PROVIDE NEW JUNCTION BOX AND BRANCH CIRCUIT FOR HEATER UNITS. REMOVE EXISTING BRANCH CIRCUIT FROM PANEL.
- ⑦ PROVIDE SURFACE METAL RACEWAY 3/4" AFF WITH DIVIDER WIREBOLD G-4000
- ⑧ PROVIDE TELE-POWER POLE.
- ⑨ 2 COMPARTMENT (POWER & COMMUNICATIONS) 1-20A-120V- SPEC GRADE RECEPTACLE & 1-20A-120V- SPEC GRADE ISOLATED GROUND RECEPTACLE. WIREBOLD SMDP-40
- ⑩ REMOVE EXISTING PANEL P-7. PROVIDE NEW PANELS P-7 & EP. EXISTING FEEDER TO P-7 TO REMAIN.
- ⑪ INSTALL NEW 150 AMP TRANSFER SWITCH. SEE ONE LINE DIAGRAM.
- ⑫ RELOCATE EXISTING CONDUIT. WIRE TERMINATIONS AND CONTROLS FOR BOILER #2 TO RIGHT SIDE OF PANEL P-7. TO PROVIDE WALL SPACE FOR PANEL EP & TRANSFER SWITCH.
- ⑬ PROVIDE UNINTERRUPTIBLE POWER SUPPLY AND UPS PANEL. SEE ONE LINE DIAGRAM
- ⑭ EXISTING 2P/15A CIRC BRKR. FOR ELECTRIC GATE TO BE REMOVED. NEW CIRCUIT FOR GATE - 36" AFF.
- ⑮ PROVIDE NEW DEVICE ON COLUMN - 36" AFF.
- ⑯ PROVIDE CEILING EXHAUST FAN. 200CFM @ 110F/SP. BROWN CAT #362 CONTROL WITH LINE VOLTAGE T-STAT. HONEYWELL TCS1A1018. FIRE DAMPER AT WALL PENETRATION. DISCHARGE GRILLE.
- ⑰ PROVIDE SWITCHING FOR EXISTING OFFICE LIGHTING.

GENERAL NOTES

1. ALL LIGHT FIXTURES SHOWN ARE EXISTING. PROVIDE NEW BRANCH CIRCUIT & WIRE AS NECESSARY TO PROVIDE POWER TO INDICATED LIGHT FIXTURES FROM NEW POWER PANEL EP.
2. ALL CONVENIENCE OUTLETS ON UPS BRANCH CIRCUIT ARE TO BE SPECIFICATION GRADE. ISOLATED GROUND. GRAY COLOR. HUBBELL IG 5362 GRAY OR EQUAL.
3. ALL WIRING TO COMPLY WITH ARTICLE 511 NEC.

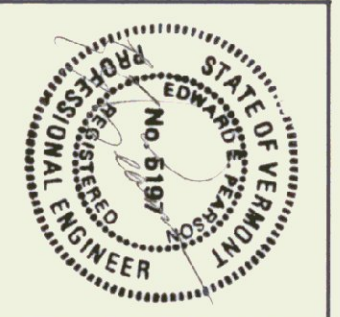

Pearson & Associates
 MECHANICAL & ELECTRICAL ENGINEERS
 P.O. BOX 610 STOWE, VERMONT 05672
 TEL. (802) 253-9607 FAX (802) 253-9290

STATE OF VERMONT	
MONTPELIER, VERMONT 05602	
AGENCY OF TRANSPORTATION	
CENTRAL GARAGE ELECTRICAL PLAN	
DATE: 05/20/91	SCALE: 1/8" = 1'-0"
DRAWN BY: B.W.M.	APPROVED BY: [Signature]
REVISIONS: 6/7/91 SKD	DWG NO. E-1
	1 OF 4