

**GENERAL NOTES:**

1. ALL VALVES & FITTINGS SHALL BE FULL PIPE SIZE, THREADED
2. ALL VALVES SHALL BE GATE VALVES, BRONZE FITTED, W.O.G., 125 PSI RATED
3. ALL BALANCING VALVES SHALL BE BRONZE FITTED, 125 PSI RATED
4. ALL ANCHORS AND PIPE SUPPORTS SHALL BE OF SAME MATERIAL AS PIPE
5. INSTALLATION OF PIPING SHALL BE DONE ONLY UNDER DIRECT SUPERVISION OF DIVISION OF STATE BUILDINGS ENGINEER
6. 12" BED FOR 1" POLYETHYLENE PIPE TO BE SCREENED SAND

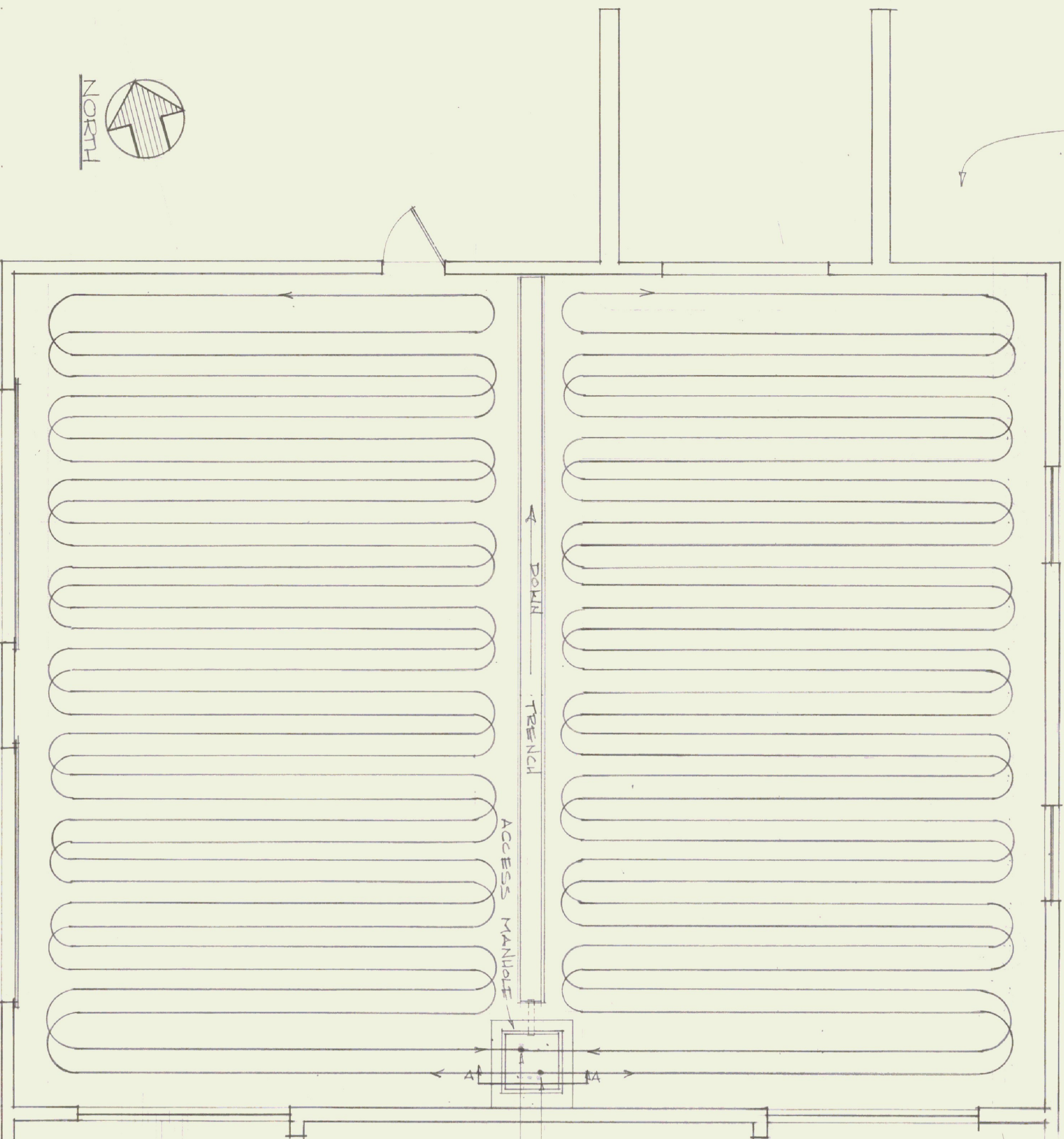

PLAN  
1/4" = 1'-0"

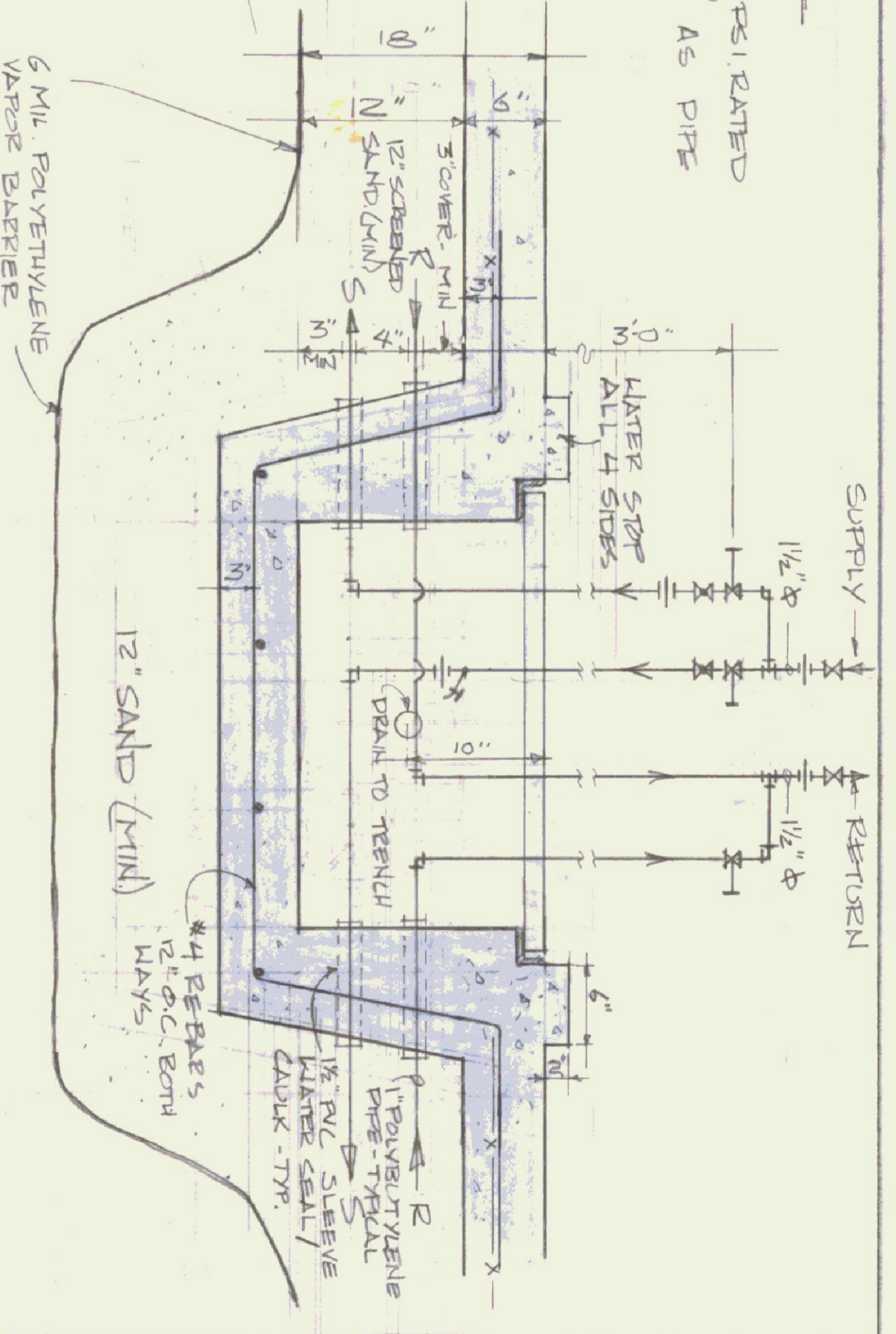

SECTION A-A: ACCESS MANHOLE

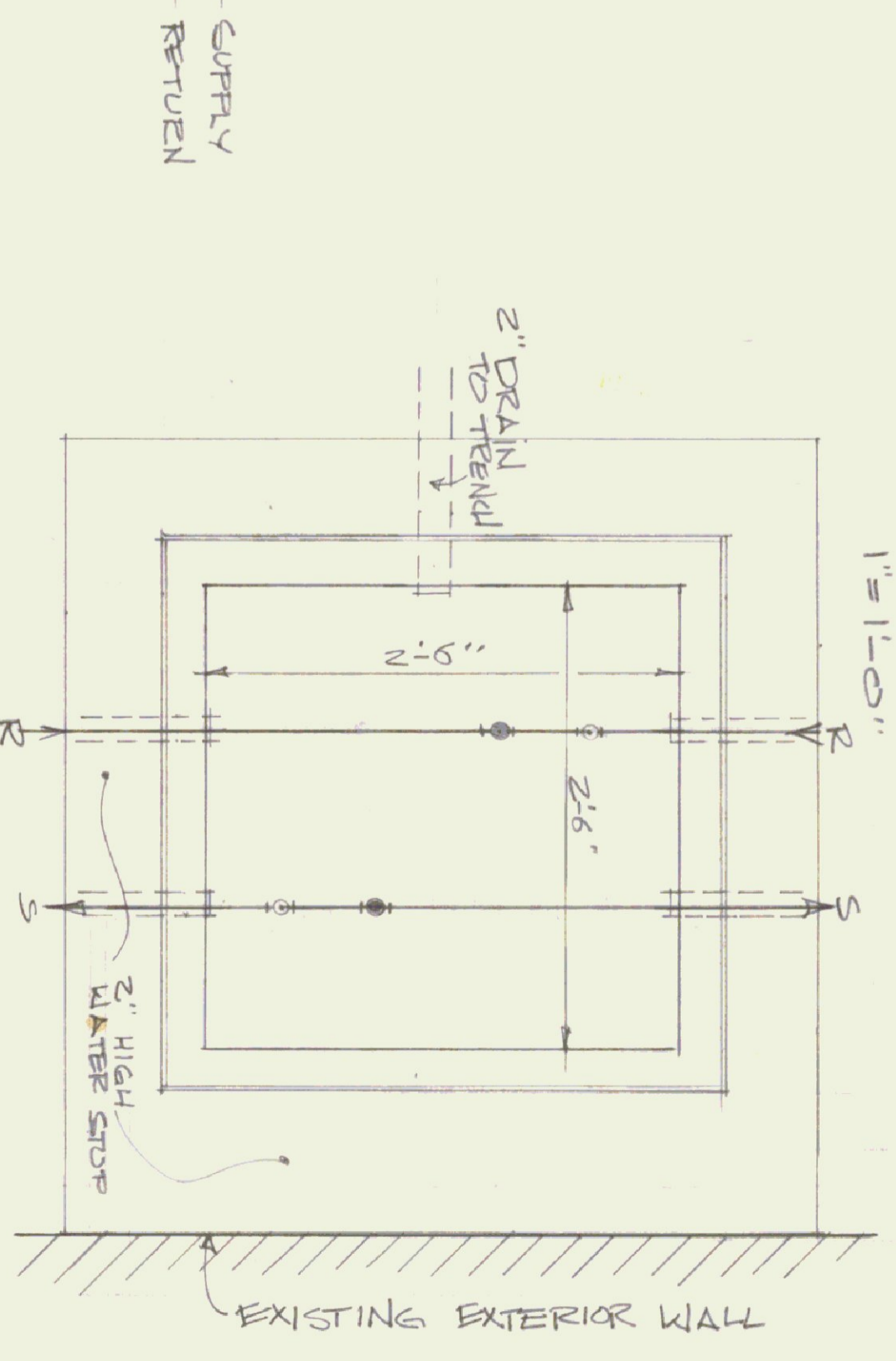

PLAN OF ACCESS MANHOLE  
1"=1'-0"

**\*INSTALLATION PROCEDURE FOR POLYETHYLENE PIPE**

1. COMPACT MIN. 3" LEVEL SAND BED
2. FILL PIPELINE WITH WATER PRIOR TO INSTALLATION. INSTALL AS SHOWN.
3. BACKFILL SUPPLY LINE WITH MIN. 2" COVER - GRADE TO ACCESS MANHOLE WITH MIN. 4" COVER.
4. COMPLETE BACKFILL OF LINES WITH MIN. 3" COVER, GRADE & COMPACT PRIOR TO PLACEMENT OF 6" CONC. SLAB.

\*SEE ALSO SECTION B-B DRAWING N/A-2 3 OF 6

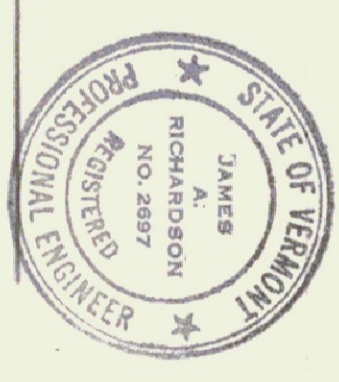

STATE OF VERMONT  
DIVISION OF STATE BUILDINGS  
AGENCY OF ADMINISTRATION  
MONTPELIER, VERMONT

PROPOSED ADDITION TO THE  
TRAFFIC SHOP  
BERLIN, VERMONT  
- HEATING -

DATE:	SCALE:	REVISIONS:	DWG. NO.
JUNE 22, 1982	AS NOTED		H-1
DRAWN BY:	APPROVED BY:		
SKEMMICK	F. RATT		
			6 OF 6