

REULAKIN FALLS BROOK

WINDOOSKI RIVER

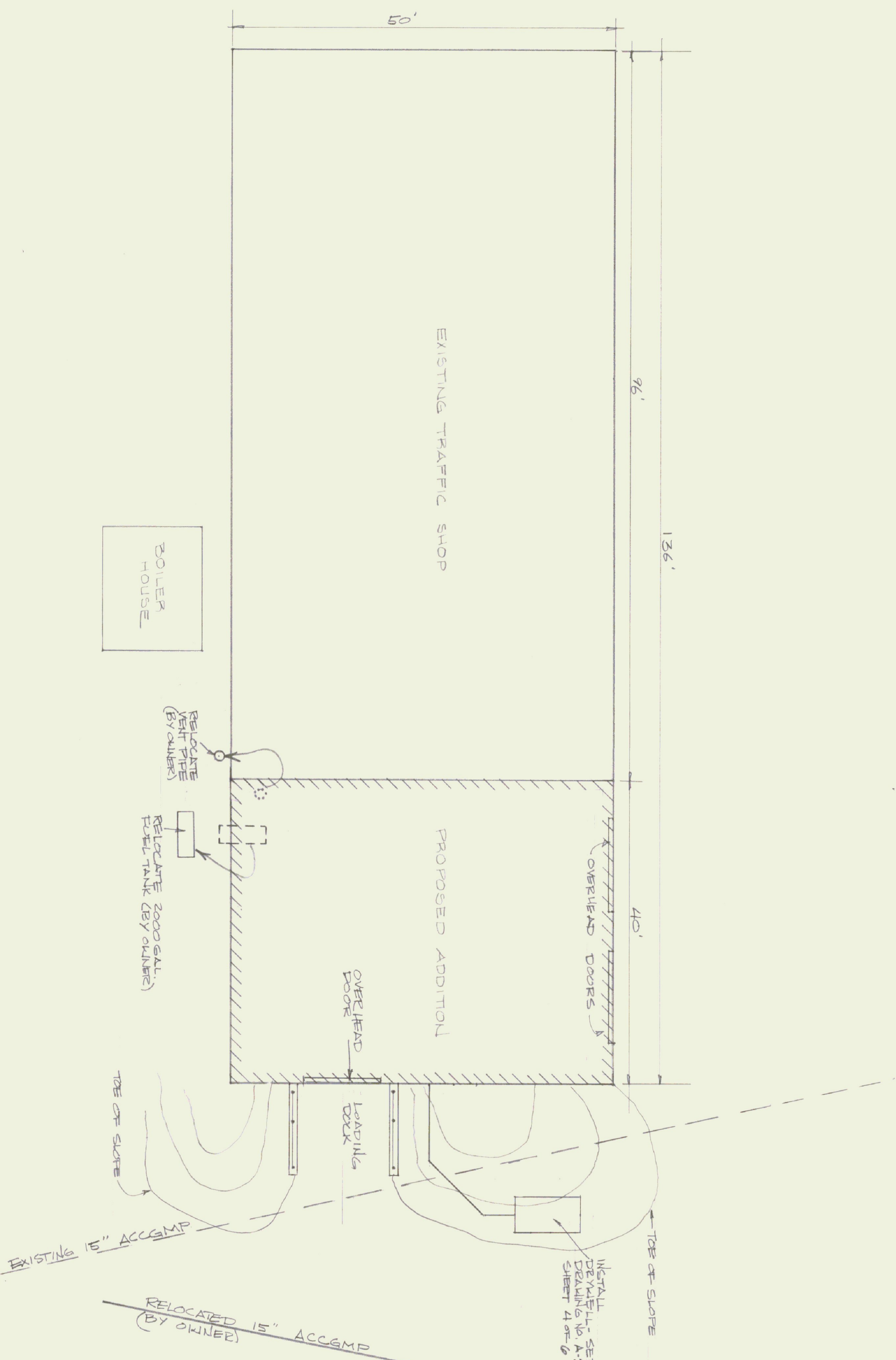

STATE OF VERMONT DIVISION OF STATE BUILDINGS MONTPELIER, VERMONT			
PROPOSED ADDITION BERLIN TRAFFIC SHOP BERLIN, VERMONT			
SITE PLAN			
DATE: MAY 82	SCALE: 1" = 10'	REVISIONS: 6/17/82 SAK	DWG. NO. 5-1
DRAWN BY: HSG	APPROVED BY: F. PEARL		1 OF 6