

WINDOW SCHEDULE

NO.	TYPE	MANUFACTURER	UNIT NO.	R. O. SIZE (W. X H.)	FINISH	DETAILS	REMARKS
H	SLIDING GLASS, WOOD FRAME	KNAPE AND VOIGT	P992 ZC	36" X 48"	WHITE ENAMEL	12/A2	TEMPERED GLASS (BOTH PANEES)

DOOR SCHEDULE

NO.	TYPE	SIZE (W. X H. X T.)	EXISTING	FINISH	FRAME	DETAILS	HOUR	SET	FLIRE RIG.	REMARKS
6	RE-USE EXIST.									
14	FLUSH STEEL	3'-0" X 7'-0" X 1 1/4"	PAINT	FACTORY	H-M	14/A2 5/M	7		45 MIN.	EXIST. DOOR, NEW FRAME
15	FLUSH WOOD	3'-0" X 7'-0" X 1 1/4"		FACTORY	H-M	14/A2	5		80 MIN.	WITH INTEGRAL SIDELITE FRAME
16	FLUSH WOOD	3'-0" X 7'-0" X 1 1/4"		FACTORY	H-M	9/10,13,14/A2	4			WITH INTEGRAL SIDELITE FRAME
17	FLUSH WOOD	3'-0" X 7'-0" X 1 1/4"		FACTORY	H-M	14/A2	4			WITH INTEGRAL SIDELITE FRAME
18	FLUSH WOOD	3'-0" X 7'-0" X 1 1/4"		FACTORY	H-M	14/A2	4			WITH INTEGRAL SIDELITE FRAME
19	FLUSH WOOD	3'-0" X 7'-0" X 1 1/4"		FACTORY	H-M	9/10,13,14/A2	3			WITH INTEGRAL SIDELITE FRAME
20	FLUSH WOOD SLIDING	5'-4" X 7'-0" X 3/4"		FACTORY	H-M	9/10,13,14/A2	1			WITH INTEGRAL SIDELITE FRAME
21	FLUSH WOOD SLIDING	5'-4" X 7'-0" X 3/4"		FACTORY	H-M	14/A2	6			WITH INTEGRAL SIDELITE FRAME
22	FLUSH WOOD	3'-0" X 7'-0" X 1 1/4"		FACTORY	H-M	14/A2	2			WITH INTEGRAL SIDELITE FRAME
23	FLUSH WOOD	3'-0" X 7'-0" X 1 1/4"		FACTORY	H-M	14/A2	2			WITH INTEGRAL SIDELITE FRAME
24	FLUSH WOOD	3'-0" X 7'-0" X 1 1/4"		FACTORY	H-M	9/10,13,14/A2	1			WITH INTEGRAL SIDELITE FRAME
25	FLUSH WOOD	3'-0" X 7'-0" X 1 1/4"		FACTORY	H-M	9/10,13,14/A2	1			WITH INTEGRAL SIDELITE FRAME
26	FLUSH WOOD	4'-8" X 7'-0" X 1 1/4"		FACTORY	H-M	14/A2	6			WITH INTEGRAL SIDELITE FRAME
27	FLUSH WOOD SLIDING	3'-0" X 7'-0" X 3/4"		FACTORY	H-M	14/A2	3			WITH INTEGRAL SIDELITE FRAME
28	FLUSH WOOD	3'-0" X 7'-0" X 1 1/4"		FACTORY	H-M	14/A2	3			WITH INTEGRAL SIDELITE FRAME
29	FLUSH STEEL	4'-0" X 6'-8" X 1 1/4"		PAINT	NOTE #2	14/A2 5/M	4		45 MIN.	

NOTES:
 1. PROVIDE TEMPERED GLASS FOR ALL DOOR AND SIDELITE UNITS.
 2. FRAME TO BE 2" H.M. FACE FRAME AND RATED TO MATCH DOOR WHERE NOTED.
 3. DOORS 7 THRU 12 ARE NOT IN THIS CONTRACT.

PARTITION TYPES

- 5/8" TYPE X GYPSUM BOARD BOTH SIDES OF STEEL STUDS (3 5/8" 24" O.C. UNLESS NOTED OTHERWISE). EXTEND PARTITION TO UNDERSIDE OF ROOF DECK AT CORRIDOR WALLS.
- SAME AS TYPE 1, WITH 3" ACOUSTIC BATT INSULATION, EXTEND PARTITION TO UNDERSIDE OF ROOF DECK.
- 5/8" TYPE X GYPSUM BOARD ON METAL FRAMING CHANNELS BOTH SIDES OF EXIST. CAUL WALL. EXTEND PARTITION TO UNDERSIDE OF ROOF DECK.
- EXISTING FRAMING AND ONE SIDE FINISH PROVIDE RESISTANT CHANNELS WITH "U" TYPE WAPOR BARRIER AND 1 LAYER 5/8" TYPE X GYP. BO. ON INDICATED SIDE.
- 5/8" TYPE X GYPSUM BOARD EXH. SPS. 5/8" THE REINFORCED TREATED FLOOR UNDER STUDS (3 5/8" 24" O.C. UNLESS NOTED OTHERWISE). EXISTING WALL NO WORK REQUIRED.

GENERAL NOTES

- ALL DIMENSIONS ARE FROM FACE OF STUD UNLESS INDICATED OTHERWISE.
- DO NOT SCALE DIMENSIONS FROM DRAWINGS. VERIFY CRITICAL DIMENSIONS. IN THE CASE OF MISSING OR CONFLICTING DIMENSIONS, CONTACT THE ARCHITECT.
- PROVIDE BLOCKING IN WALLS TO ACCEPT GRAB BARS, HANDRAILS, CLOSET RODS, ETC.
- ALL WORK SHALL BE PERFORMED IN ACCORDANCE WITH STATE AND LOCAL CODES AND ORDINANCES.
- THE GENERAL CONTRACTOR SHALL THOROUGHLY CLEAN THE PREMISES AT COMPLETION OF WORK AND LEGALLY DISPOSE OF ANY EXCESS MATERIAL OFF-SITE.
- EXISTING FLOOR SLAB TO BE PATCHED, FLETED, AND GROUND SMOOTH OR OTHERWISE PREPARED TO ACCOMMODATE FLOOR FINISHES AS REQUIRED TO MEET FLOOR FINISH INSTALLATION SPECIFICATION.
- ALL EXPOSED STEEL MEMBERS ARE TO BE SCAFFOLD PROTECTED, PAINTED & PAINTED.

ROOM FINISH SCHEDULE

NO.	ROOM NAME	FLOOR FINISH	BASE	WALLS	CEILING	REMARKS
105	FILE STORAGE	V.C.T.	RUBBER	PAINT	AC. TILE	N/A
106	CONFERENCE	V.C.T.	RUBBER	PAINT	AC. TILE	N/A
107	PLAN STORAGE	V.C.T.	RUBBER	PAINT	AC. TILE	N/A
108	OFFICE	V.C.T.	RUBBER	PAINT	AC. TILE	N/A
109	CORRIDOR	V.C.T.	RUBBER	PAINT	AC. TILE	N/A
110	CLOSET	V.C.T.	RUBBER	PAINT	AC. TILE	N/A
111	CORRIDOR	V.C.T.	RUBBER	PAINT	AC. TILE	N/A
112	OFFICE	V.C.T.	RUBBER	PAINT	AC. TILE	N/A
113	OFFICE	V.C.T.	RUBBER	PAINT	AC. TILE	N/A
114	OFFICE	V.C.T.	RUBBER	PAINT	AC. TILE	N/A
115	WOMEN	V.C.T.	RUBBER	PAINT	AC. TILE	N/A
116	OFFICE	V.C.T.	RUBBER	PAINT	AC. TILE	N/A
117	CLOSET	V.C.T.	RUBBER	PAINT	AC. TILE	N/A
118	OFFICE	V.C.T.	RUBBER	PAINT	AC. TILE	N/A
119	MECHANICAL	V.C.T.	RUBBER	PAINT	AC. TILE	N/A
120	VESTIBULE	V.C.T.	RUBBER	PAINT	AC. TILE	N/A
121	OPEN OFFICE	V.C.T.	RUBBER	PAINT	AC. TILE	N/A
122	WORK AREA	V.C.T.	RUBBER	PAINT	AC. TILE	N/A
123	OFFICE	V.C.T.	RUBBER	PAINT	AC. TILE	N/A
124	SWITCHING ROOM	SEALED CONC.	RUBBER	PAINT	AC. TILE	N/A

FINISH NOTES:
 1. PROVIDE TWO WALL-TO-WALL FLOOR MATS THIS ROOM (SEE SPECIFICATIONS.)
 2. SEE FLOOR PLAN FOR CARPET AND V.C.T. COLOR AND YOU MATERIALS.
 NUMBERS INDICATE DIFFERENT COLORS, NOT DIFFERENT MATERIALS.

CONSTRUCTION OF CEILING OVER SWITCHING ROOM TO BE 6" METAL STUDS, 3" GYPSUM BOARD, 2" DEEP STEEL TRACES AT 16" O.C. WITH 1" DEEP STEEL BRACES AT 11'2" X 11'2" X 3/16" STEEL AND CONTINUOUS AROUND PERIMETER OF PL. WOOD. HEIGHT OF CEILING FRAMING TO BE 8'-0" AFF. TO BOTTOM.

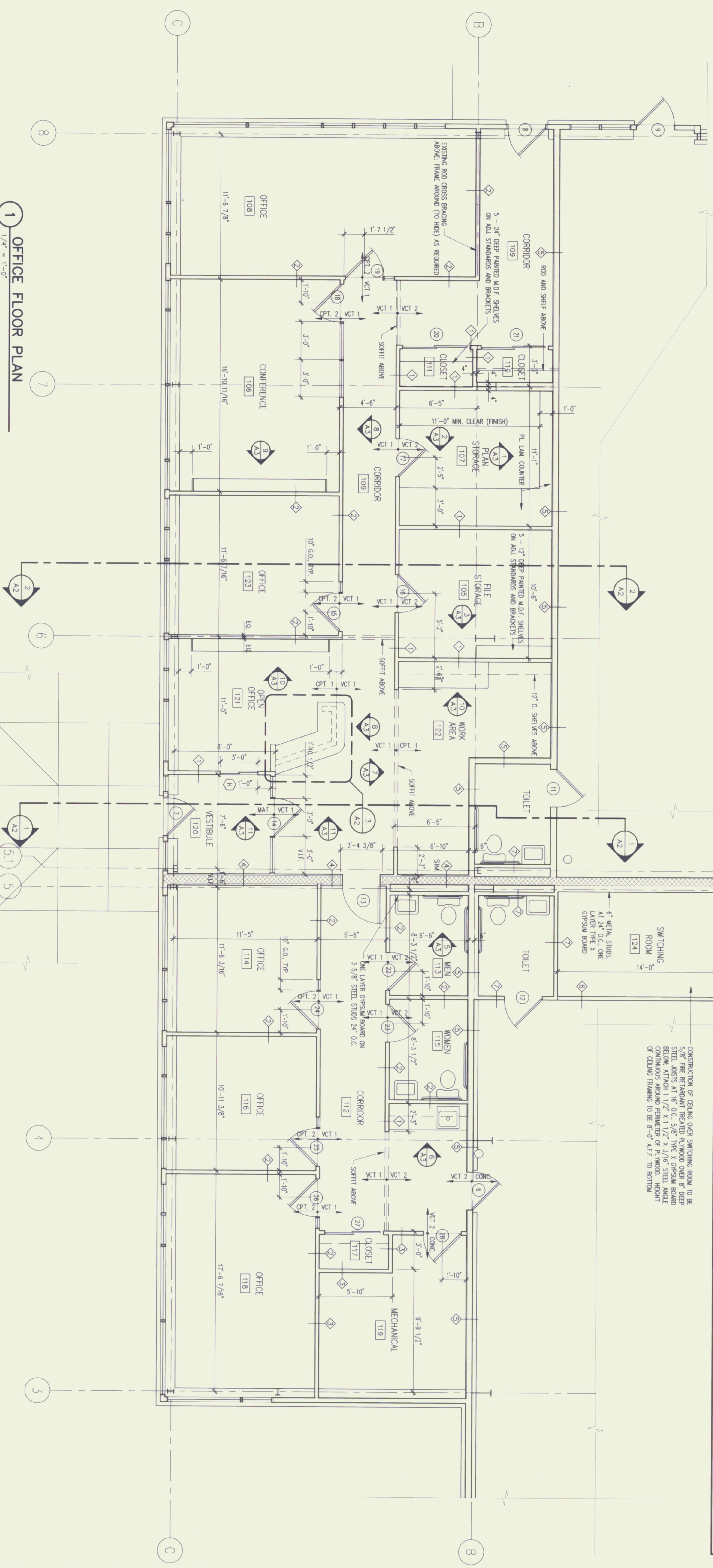

1 OFFICE FLOOR PLAN
 1/4" = 1'-0"

Project Title:
Agency of Transportation HUNTINGTON HANGAR OFFICES
 Berlin, Vermont

Job Number: 9605
 File Name: 9505fp
 Drawn By: TMB
 Checked By: GS
 Scale: As Shown
 Date: November, 1996

Revisions:

Sheet Number: **A1**
 Sheet Title: **Floor Plan and Schedules**

Gossens Bachman, Inc.
 10057 229-1664

Gossens Bachman, Inc.
 Architecture and Interior Design
 10057 229-1664

VERMONT REGISTERED ARCHITECT
 STATE OF VERMONT
 1997

NORTH