

N/F  
NICOM INC.

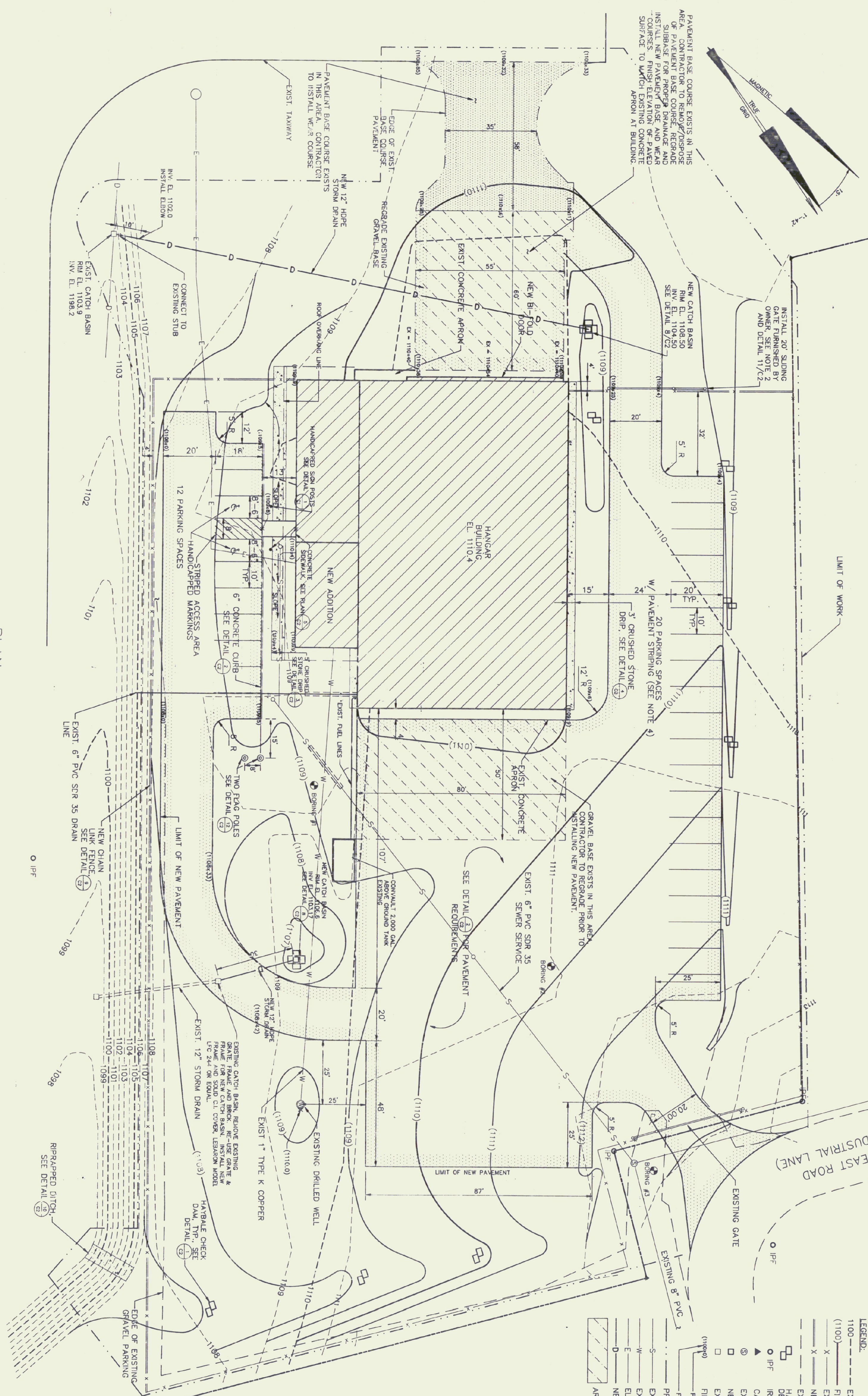

PAVEMENT BASE COURSE EXISTS IN THIS AREA. CONTRACTOR TO REMOVE EXISTING SUBBASE FOR PROPER DRAINAGE AND INSTALL NEW PAVEMENT BASE AND WEAR COURSE TO FINISH ELEVATION OF PAVED SURFACE TO MATCH ELEVATION OF APRON AT BUILDING.

INSTALL 20' SLIDING GATE FINISHED BY OWNER. SEE NOTE 2 AND DETAIL 17/02.

NEW CATCH BASIN FINV. EL. 1108.30 SEE DETAIL 8/02.

HANGAR BUILDING EL. 1110.4

12 PARKING SPACES  
HAND STRIPED MARKINGS

PLAN  
SCALE: 1" = 20'

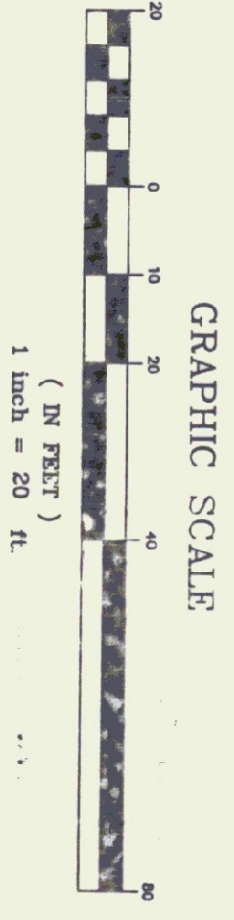

EAST ROAD (INDUSTRIAL LANE)

- LEGEND:
- EXISTING GROUND CONTOUR LINE
  - (1100) FINISHED GRADE CONTOUR LINE
  - X EXISTING SECURITY FENCE
  - X NEW CHAIN LINK FENCE
  - EXIST. GRAVEL ROAD/PARKING
  - HAY BALE CHECK DAM, SEE DETAIL 17/02
  - IRON PIN FOUND
  - ▲ CALCULATED POINT
  - ▲ EXISTING SEWER MANHOLE
  - NEW CATCH BASIN
  - EXISTING CATCH BASIN
  - FINISH GRADE SPOT ELEVATION
  - POINT OF ELEVATION
  - FINISH ELEVATION
  - PROJECT LIMIT
  - S EXISTING SEWER
  - W EXISTING WATER
  - E ELECTRICAL CONDUIT
  - D NEW STORM DRAIN
  - ▨ AREA OF EXISTING GRAVEL BASE

- NOTES:
- 1) EXISTING GROUND CONTOURS ARE APPROXIMATE AND MAY VARY FROM THOSE SHOWN.
  - 2) CONTRACTOR TO REVIEW EXISTING SLIDING GATE TO BE FINISHED BY OWNER, LOCATED ON SITE ACCESSORIES REQUIRED FOR A COMPLETE INSTALLATION.
  - 3) CONTRACTOR TO CONTACT DIG SAFE (1-800) 225-4877 FROM TO START OF ANY EXCAVATION WORK.
  - 4) PAVEMENT MARKINGS SHALL BE THERMOPLASTIC CONFORMING TO SECTIONS 708.10 AND 646 OF THE VERMONT A.O.T. STANDARD SPECIFICATIONS FOR CONSTRUCTION.

DETAIL  
SCALE: NONE

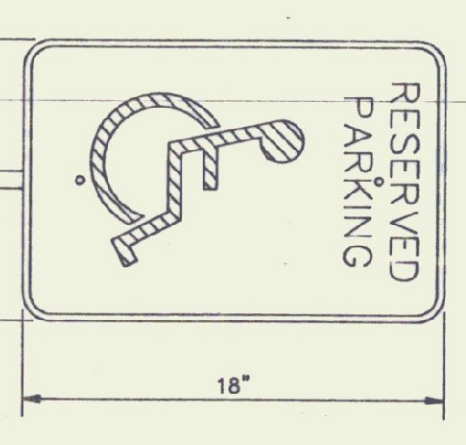

SIGN TO BE MOUNTED ON STEEL SIGN POST IN ACCORDANCE WITH VERMONT A.O.T. STANDARD DETAIL SHEET E-160. A.D.A. APPROVED SIGN

NO.	DATE	REVISION	ENCLDNG

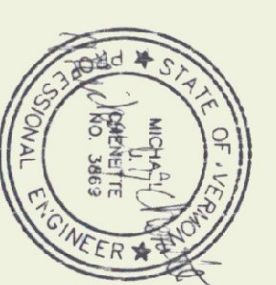

**Provan & Lorber, Inc.**  
ENGINEERS AND PLANNERS  
Home Office: PO Box 388, Colchester, NH 03232 (603) 746-2820  
Northwestern NH Office: PO Box 187, Littleton, NH 03761 (603) 444-0501  
Vermont Office: Main St., Montpelier, VT 05602 (802) 229-1442

**HUNTINGTON HANGAR**  
VERMONT AGENCY OF TRANSPORTATION  
KNAPP AIRPORT  
BERLIN, VERMONT

DATE	PROJ. NO.
SEPT. 1996	987.01
ENG. BY MJC	DRWN. BY JLS
CHKD. BY MJC	DRWG. NO. C1

SHEET 1 OF 3