

ROOF FRAMING PLAN
SCALE: 3/8" = 1'-0"

- GENERAL NOTES:
1. THE CONTRACTOR IS TO FURNISH SHOP DRAWINGS FOR APPROVAL BEFORE RELEASE FOR FABRICATION.
 2. THE CONTRACTOR SHALL FURNISH MANUFACTURERS ENGINEERS CERTIFICATE FOR COMPLIANCE WITH DESIGN LOADS.
 3. ALL EXPOSED PREFABRICATED DOUBLE TEE SLABS AND WEBS ARE NOT TO BE PAINTED, AND RUBBERED.
 4. ALL UTILITY PIPING ATTACHMENTS AND ANCHORS TO DOUBLE TEES ARE TO BE PLACED NOT LESS THAN 12" FROM BOTTOM OF WEB. THE CONTRACTOR SHALL NOT DRILL ANY HOLES THRU WEBS AT ANY TIME.
 5. ALL PRECAST DOUBLE TEES ARE TO BE WELDED IN PLACE DURING INSTALLATION.
 6. CONCRETE: 5000 P.S.I. @ 28 DAYS (MIN.)

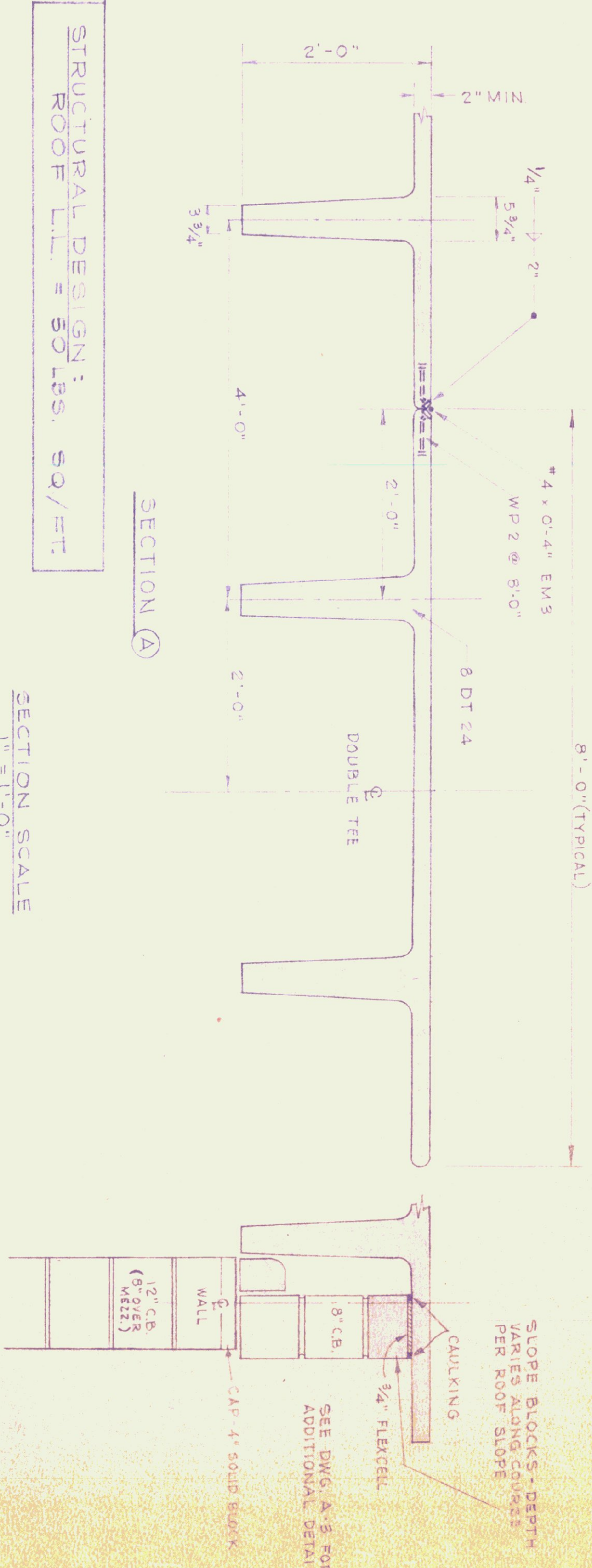

STRUCTURAL DESIGN:
ROOF L.L. = 50 LBS. SQ./FT.

SECTION SCALE
1" = 1'-0"

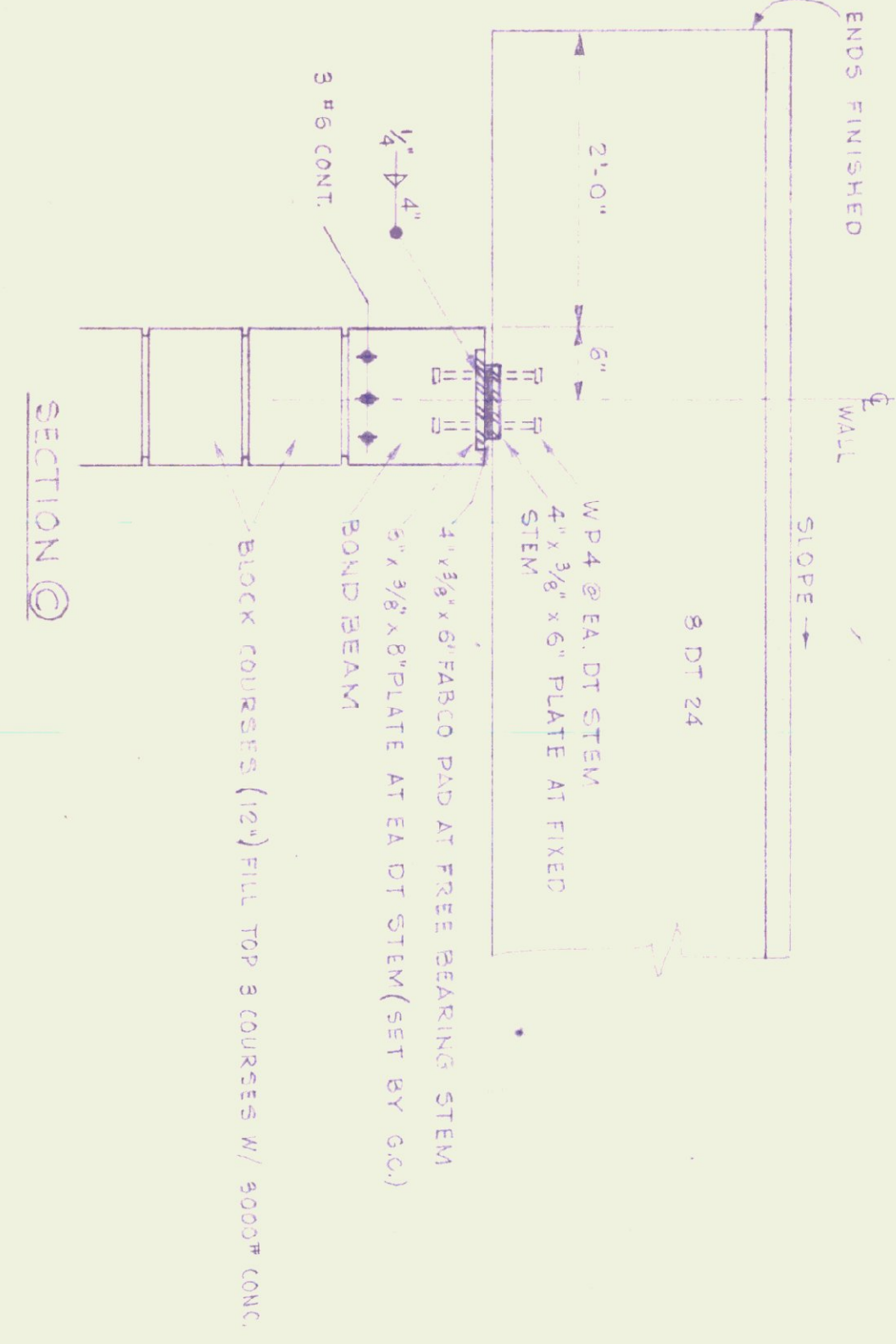

NOTE: FOR BEARING WALL
DETAILS SEE DWG. A-3.

REV.	DATE	REVISION

STATE OF VERMONT
DIVISION OF STATE BUILDINGS
AGENCY OF ADMINISTRATION
MONTPELIER, VERMONT

STANDARD
3 BAY HIGHWAY GARAGE BUILDING
ROOF FRAMING PLAN
& DETAILS

DATE: AUG 4, '75	DESIGNED BY: T.J.S.	DWG. NO. A-5
DRAWN BY: S.H. MILLER	APPROVED BY: <i>S.H. Miller</i>	5 OF 5