

ELECTRICAL FLOOR PLAN  
SCALE 3/16" = 1'-0" (REVERSE)

- NOTES:
- 1. SWITCHES: 120V, 3-400 (MOUNT ON BOT OF JOLTS)
  - 2. SWITCHES: 1-100V R3 STRIP 5 STIMOR (MOUNT ON BOT OF JOLTS)
  - 3. SWITCHES: 120V, 3-400 (SURFACE MOUNT TO CEILING)
  - 4. THERMOSTAT - CONNECT TO CIRCUIT 12
  - 5. THERMOSTAT 5-6 OFF FLOOR
  - 6. 100 AMP WELDER CUTLET
- 1 RUN 1" CONDUIT FROM MAIN PANEL THRU MOTOR STARTER TO WALL AT AIR COMPRESSOR. ALL CONDUIT TO BE RUN IN ROOMWORK FOR IDENTIFICATION. ALL SYMBOLS TO BE PAINTED.

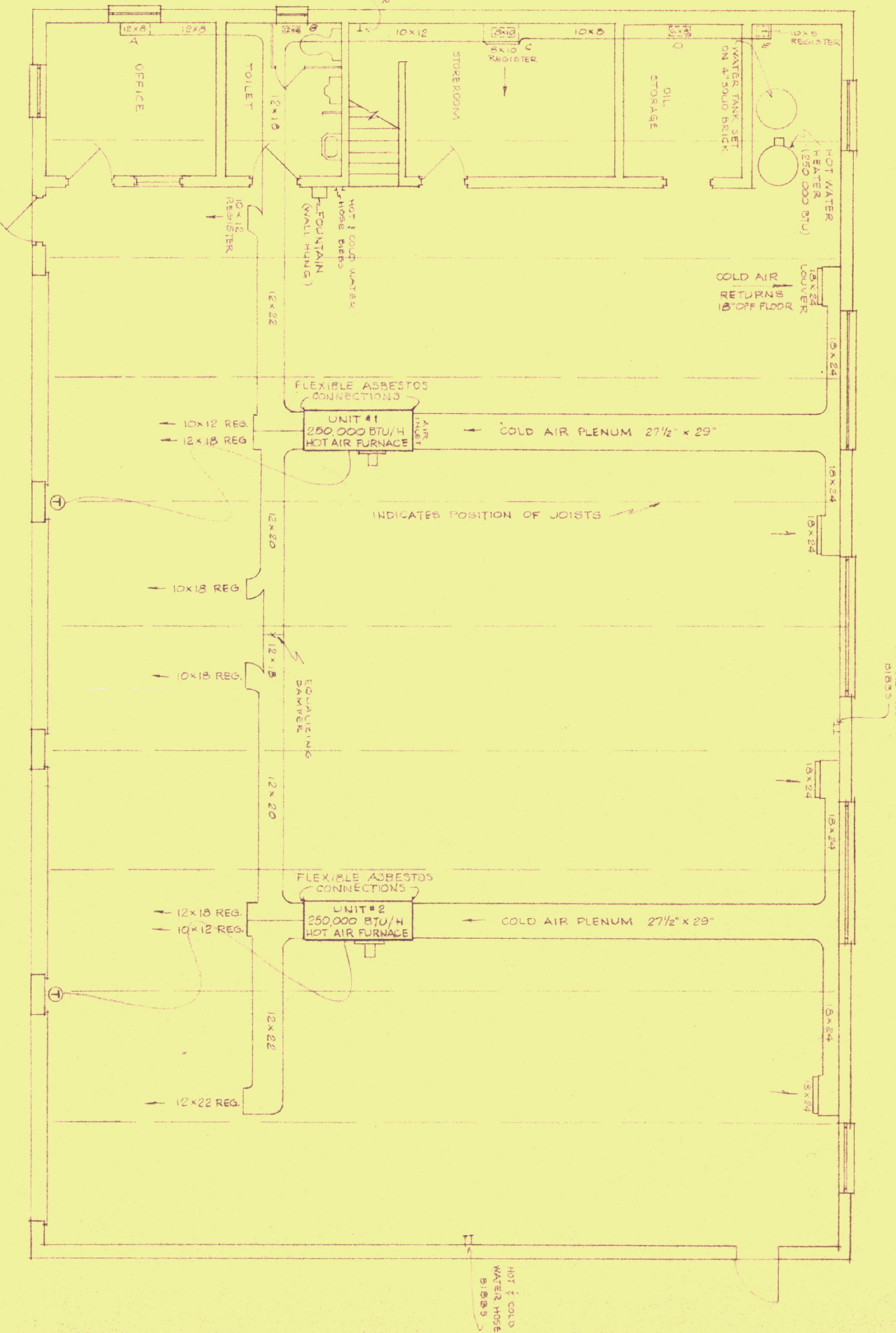

MECHANICAL FLOOR PLAN  
SCALE 3/16" = 1'-0" (REVERSE)

- GENERAL NOTES:
1. A, B, C, D, E INDICATE AIR SUPPLY DUCTS TO 4 ROOMS & MECH. AREA. INDICATED REGISTER.
  2. INDICATES THERMOSTAT w/ MERCURY ACTIVATION RANGE 50°F - 60°F.
  3. OVER EACH HEATING UNIT ASBESTOS BOARD 4"x8"x1/2"
  4. EACH DUCT FACING DOWN TO HAVE AN ARROW DOWNWARD AND REGISTER.
  5. CAULK CONTROL JOINTS AT WALLS BEFORE INSTALLATION OF WALL DUCTS.
  6. ALL DUCTWORK IS TO BE PAINTED (2) COATS.
  7. HOT & COLD WATER PIPING TO BE 3/4" COPPER.
  8. ALL HOT & COLD WATER PIPING TO BE INSULATED & PAINTED.

DATE	REVISIONS
8/1/58	REVISION 1

STANDARD GARAGE BUILDING  
VERMONT DEPARTMENT OF HIGHWAYS  
[FOUR TRUCK BAYS]

STATE BUILDINGS DIVISION  
AGENCY OF ADMINISTRATION  
VERMONT

DATE: MAY 21 1958  
DRAWN BY: 2-4