

ELECTRICAL FLOOR PLAN
SCALE 3/16" = 1'-0" (REVERSE)

- NOTES:
- 1. SWITCHES (TYPE 30, TYP. 3-406) (MOUNT ON BOT. OF JOIST) (MOUNT ON BOT. OF JOIST) (MOUNT ON BOT. OF JOIST)
 - 2. SWITCHES (TYPE 30, TYP. 3-406) (MOUNT ON BOT. OF JOIST) (MOUNT ON BOT. OF JOIST) (MOUNT ON BOT. OF JOIST)
 - 3. SWITCHES (TYPE 30, TYP. 3-406) (MOUNT ON BOT. OF JOIST) (MOUNT ON BOT. OF JOIST) (MOUNT ON BOT. OF JOIST)
 - 4. SWITCHES (TYPE 30, TYP. 3-406) (MOUNT ON BOT. OF JOIST) (MOUNT ON BOT. OF JOIST) (MOUNT ON BOT. OF JOIST)
 - 5. SWITCHES (TYPE 30, TYP. 3-406) (MOUNT ON BOT. OF JOIST) (MOUNT ON BOT. OF JOIST) (MOUNT ON BOT. OF JOIST)
 - 6. SWITCHES (TYPE 30, TYP. 3-406) (MOUNT ON BOT. OF JOIST) (MOUNT ON BOT. OF JOIST) (MOUNT ON BOT. OF JOIST)
 - 7. SWITCHES (TYPE 30, TYP. 3-406) (MOUNT ON BOT. OF JOIST) (MOUNT ON BOT. OF JOIST) (MOUNT ON BOT. OF JOIST)
 - 8. SWITCHES (TYPE 30, TYP. 3-406) (MOUNT ON BOT. OF JOIST) (MOUNT ON BOT. OF JOIST) (MOUNT ON BOT. OF JOIST)

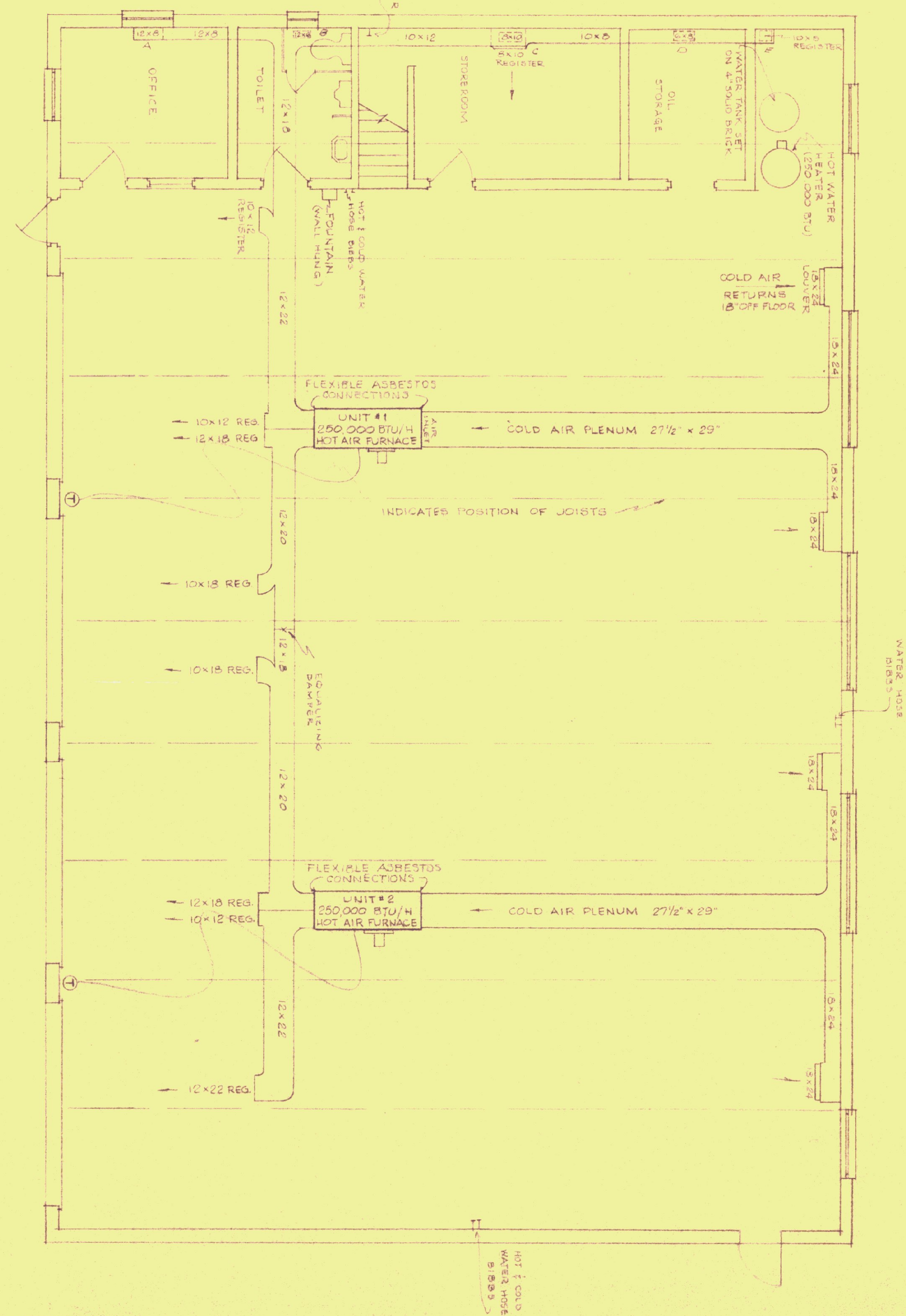

MECHANICAL FLOOR PLAN
SCALE 3/16" = 1'-0" (REVERSE)

- GENERAL NOTES:
1. A, B, C, D, E INDICATE AIR SUPPLY DUCTS TO 4 ROOMS & MECH. AREA. INDICATED REGISTER.
 2. INDICATES THERMOSTAT w/ MERCURY ACTIVATION RANGE 50°F - 60°F.
 3. OVER EACH HEATING UNIT ASBESTOS BOARD 4"x8"x1/2"
 4. EACH DUCT FACING DOWN TO HAVE 45° BLOW DOWNWARD AND REGISTER.
 5. CAULK CONTROL JOINTS AT WALLS BEFORE INSTALLATION OF WALL DUCTS.
 6. ALL DUCTWORK IS TO BE PAINTED (2) COATS.
 7. HOT & COLD WATER PIPING TO BE 3/4" COPPER.
 8. ALL HOT & COLD WATER PIPING TO BE INSULATED & PAINTED.

DATE	REVISIONS
5/1/55	REVISION 1

STANDARD GARAGE BUILDING
VERMONT DEPARTMENT OF HIGHWAYS
[FOUR TRUCK BAYS]

STATE BUILDINGS DIVISION
AGENCY OF ADMINISTRATION
VERMONT

DATE: MAY 21 1955
DRAWN BY: 2-4