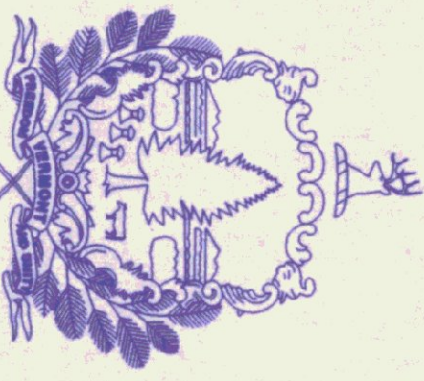
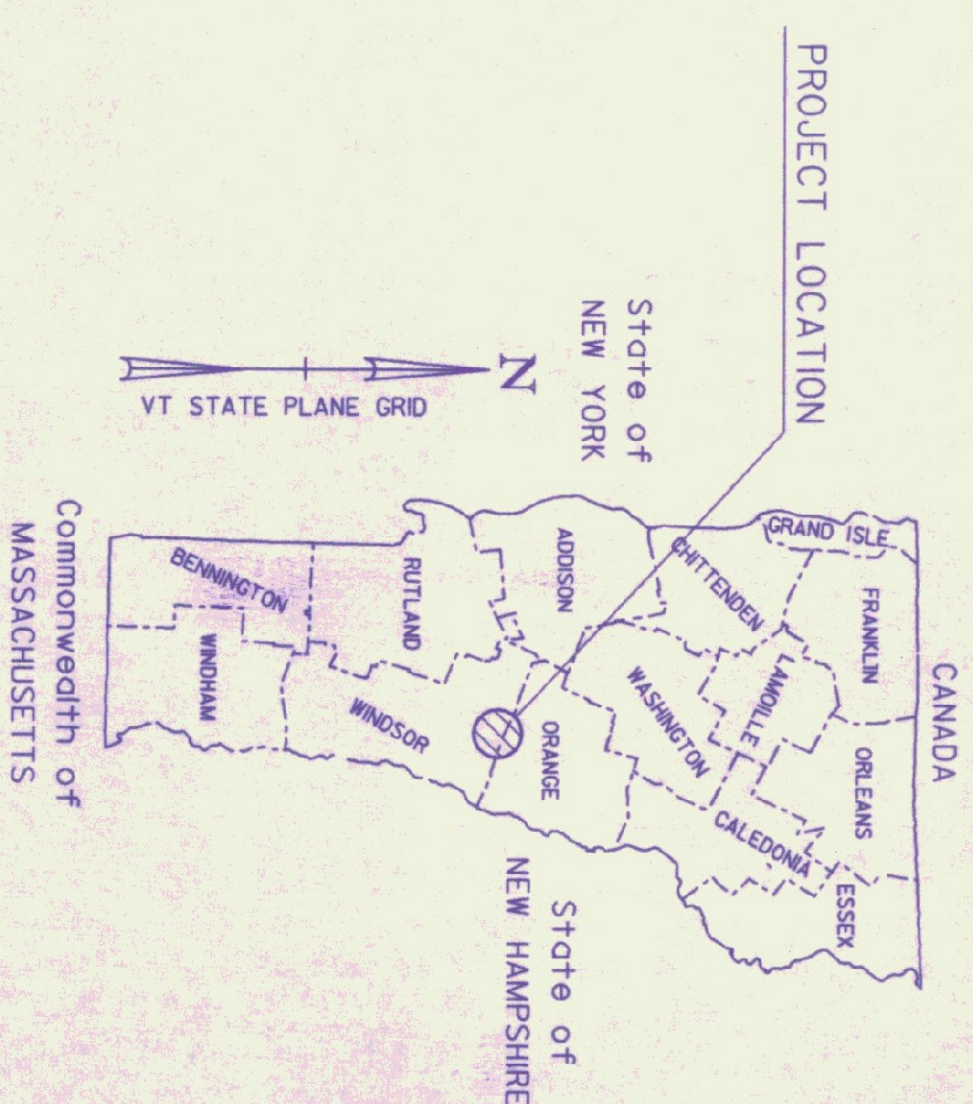

INDEX OF SHEETS

1	TITLE SHEET	
2	QUANTITY SHEET	
SD-1	GENERAL NOTES & DETAILS	
SD-2	CROSS SECTIONS	
SD-3	BUILDING DETAILS - 40' X 84' SAND-SALT SHEDS	
A-1		
STANDARDS		
B-5	SLOPE GRADING, EMBANKMENTS, MUCK	06/01/94
B-11	METHODS OF SLOPE STABILIZATION	06/01/94
D-3	TREATED GUTTERS	06/01/94
T-1	TEMPORARY EROSION CONTROL DETAILS	06/01/94
T-1	TEMPORARY EROSION CONTROL DETAILS	06/01/94
T-2	TEMPORARY EROSION CONTROL DETAILS	06/01/94

STATE OF VERMONT
 AGENCY OF TRANSPORTATION

 PROPOSED IMPROVEMENT
 CONSTRUCTION OF NEW
 SAND-SALT SHEDS
 TOWN OF ROYALTON
 COUNTY OF WINDSOR

WORK TO BE PERFORMED UNDER THIS CONTRACT INCLUDES
 CONSTRUCTION OF A NEW SAND-SALT SHEDS, SITE WORK,
 PAVING, DRAINAGE, LANDSCAPING, AND INCIDENTAL ITEMS.



THESE PLANS ARE SUBJECT TO SUCH ENGINEERING
 CHANGES AS MAY BE REQUIRED BY THE CHIEF ENGINEER.
 CONSTRUCTION IS TO BE CARRIED ON IN ACCORDANCE
 WITH THESE PLANS AND THE STANDARD SPECIFICATIONS
 FOR CONSTRUCTION DATED 1990, AS APPROVED BY THE
 FEDERAL HIGHWAY ADMINISTRATION ON MARCH 15, 1990
 FOR USE ON THIS PROJECT, INCLUDING ALL SUBSEQUENT
 REVISIONS AND SUCH REVISED SPECIFICATIONS AND
 SPECIAL PROVISIONS AS ARE INCORPORATED IN THESE
 PLANS.

DATUM
 VERTICAL _____
 HORIZONTAL _____

CED
 CONSULTING
 ENGINEERS
 510 COMMERCE ST.
 MANCHESTER, NH 03101
 PH: (603) 666-8223
 FAX: (603) 666-8802
 E-MAIL: CED@CEDENGINEERS.COM

APPROVED _____ DATE 3/10/99
 DIRECTOR OF MAINTENANCE

PROJECT ROYALTON STP SALT(18)
 SHEET 1 OF 6 SHEETS

NOTES:

1. ALL PROPOSED PAVEMENT SHALL HAVE A 1/4" THICK TYPE III WEARING COURSE AND A 3/4" THICK TYPE II BINDER COURSE, ITEM 406.25 BITUMINOUS CONCRETE PAVEMENT, UNLESS OTHERWISE DIRECTED BY THE RESIDENT ENGINEER. ALL LIQUID ASPHALT USED IN BITUMINOUS CONCRETE PAVEMENT SHALL BE PG 58-28.
2. TACK COAT ITEM 404.65, EMULSIFIED ASPHALT IS TO BE APPLIED ON ALL EXISTING PAVEMENT SURFACES, ON COLD PLANE SURFACES AND BETWEEN ALL COURSES OF PAVEMENT AT THE RATE OF 0.06 GAL/SY OR AS DIRECTED BY THE RESIDENT ENGINEER.
3. AREAS NOTED ON THE PLANS TO HAVE EXISTING SURFACES REMOVED (PAID AS ITEM 203.28, EXCAVATION OF SURFACES AND PAVEMENTS, UNLESS OTHERWISE NOTED), SHALL HAVE CLEAN CUT EDGES ALONG JOINTS, TAKING CARE TO NOT DISTURB REMAINING PAVEMENT AND/OR SUBBASE. THE EXCAVATED MATERIAL SHALL BE REMOVED FROM THE PROJECT, AS DIRECTED BY THE RESIDENT ENGINEER. EXISTING SUBBASE MATERIAL DEEMED UNSUITABLE BY THE ENGINEER SHALL BE EXCAVATED TO A DEPTH OF 3'+/- OR AS DIRECTED BY THE ENGINEER. EXCAVATED MATERIAL SHALL BE USED AS BORROW OR REMOVED FROM THE PROJECT, AS DIRECTED BY THE RESIDENT ENGINEER. EXCAVATION WILL BE PAID FOR AS ITEM 203.28 EXCAVATION OF SURFACES AND PAVEMENTS, UNLESS OTHERWISE NOTED. MATERIAL REMOVED SHALL BE REPLACED WITH ITEM 301.28, SUBBASE OF CRUSHED GRAVEL (FINE GRADED).

4. UPON COMPLETION OF THE GRADING OPERATIONS FOR EARTH SLOPE AREAS, THE CONTRACTOR SHALL IMMEDIATELY ESTABLISH VEGETATION IN ACCORDANCE WITH THE SEEDING REQUIREMENTS ON THIS SHEET.

5. SEE VAOT STANDARD DRAWINGS T-1 AND T-2 FOR TEMPORARY EROSION CONTROL DETAILS.

6. ALL EXISTING MATERIAL STORED ON SITE (SAND, COLD PLANE GRINDINGS, BRUSH, ECT.) SHALL BE REMOVED BY VAOT PRIOR TO CONSTRUCTION.

7. UTILITIES SHOWN ON THESE PLANS ARE APPROXIMATE. THE CONTRACTOR SHALL WORK WITH THE VAOT IN DETERMINING ACTUAL LOCATION OF UTILITIES.

8. CONTRACTOR SHALL SUPPLY UNDERGROUND POWER TO NEW SHEDS, AND SHALL CONTACT THE LOCAL POWER COMPANY(S) CONCERNING THIS WORK. ANY EXISTING CIRCUITS MAY BE USED IF APPLICABLE. CONTRACTOR SHOULD FIELD VERIFY EXISTING CIRCUITS. GENERAL WIRING SHALL BE PVC CONDUIT WITH WIRE SUITABLE FOR UNDERGROUND OR WET LOCATION WITH NOT MORE THAN 3% VOLTAGE DROP FROM SOURCE TO END OF CIRCUIT, AND SHALL MEET ALL LOCAL AND NEC REQUIREMENTS. CONTRACTOR SHALL SUPPLY RESIDENT ENGINEER WITH A SKETCH SIGNED BY A MASTER ELECTRICIAN, SHOWING ROUTING AND METHOD OF LAYING CONDUIT/SUPPLY WIRING; AND COPIES OF ALL ELECTRICAL PERMITS.

CIRCUITS AND WIRING SHALL HAVE ENOUGH CAPACITY TO ALLOW FUTURE EXTENSION (BY OTHERS) TO ACCOMMODATE A CHLORIDE PUMP AND AN OVERHEAD LIGHT (BY OTHERS). ASSUME THE CHLORIDE TANK INSTALLATION (BY OTHERS) WILL BE WITHIN 50' OF THE SALT/SAND SHED THAT IS FURTHEST FROM THE POWER SOURCE. CHECK WITH DISTRICT ON PUMP POWER REQUIREMENTS.

ALL COSTS ASSOCIATED WITH THIS WORK (EXTENSION OF EXISTING POWER SUPPLY TO PROPOSED STRUCTURE(S) INCLUDING ALL TOOLS, EQUIPMENT, MATERIALS, LABOR AND INCIDENTALS NECESSARY TO PROVIDE A FULL FUNCTIONAL ELECTRICAL SYSTEM/SUPPLY, AND ALL ELECTRICAL PERMITS) WILL NOT BE PAID FOR DIRECTLY BUT WILL BE CONSIDERED SUBSIDIARY TO ITEM 658.15 - ROADSIDE REST FACILITY (MODIFIED).

ALL COSTS ASSOCIATED WITH REMOVAL OF EXISTING UTILITY POLES AND OVERHEAD AERIAL LINES WILL NOT BE PAID FOR DIRECTLY BUT WILL BE CONSIDERED SUBSIDIARY TO ITEM 202.10 - DEMOLITION AND DISPOSAL OF BUILDING.

SEEDING FORMULA RURAL AREAS			
% WT.	LBS./A.	NAME	PUR. %
37.5	22.5	CREeping RED FESCUE	98
37.5	22.5	TALL FESCUE	95
5.0	3.0	RED TOP	95
15.0	9.0	BIRDFOOT TREFOLI	98
5.0	3.0	ANNUAL RYE GRASS	95
100.0	60.0		

SEEDING FORMULA URBAN AREAS			
% WT.	LBS./A.	NAME	PUR. %
42.5	34.0	CREeping RED FESCUE	98
10.0	8.0	PERENNIAL RYE GRASS	95
42.5	34.0	KENTUCKY BLUE GRASS	85
5.0	4.0	ANNUAL RYE GRASS	95
100.0	80.0		

SEED MIXTURE SHALL NOT HAVE A WEED CONTENT EXCEEDING 0.40% BY WEIGHT AND SHALL BE FREE OF ALL NOXIOUS SEED.

SEEDS TO BE APPLIED PER SEEDING FORMULA OR AS DIRECTED BY THE ENGINEER.

FERTILIZER FORMULA 10-20-10 TO BE USED WITH SEED, APPLIED AT THE RATE OF 500 LBS./ACRE (HYDRO SEEDERS MAY USE 19-9-19 FORMULA).

AGRICULTURAL LIMESTONE TO BE APPLIED AT THE RATE OF 2 TONS/ACRE, OR AS DIRECTED BY THE ENGINEER.

HAY MULCH TO BE PLACED ON EARTH SLOPES AT THE RATE OF 2 TONS/ACRE, OR AS DIRECTED BY THE ENGINEER.

TOPSOIL TO BE USED WITH SEED AS INDICATED ON THE PLANS, OR AS DIRECTED BY THE ENGINEER.

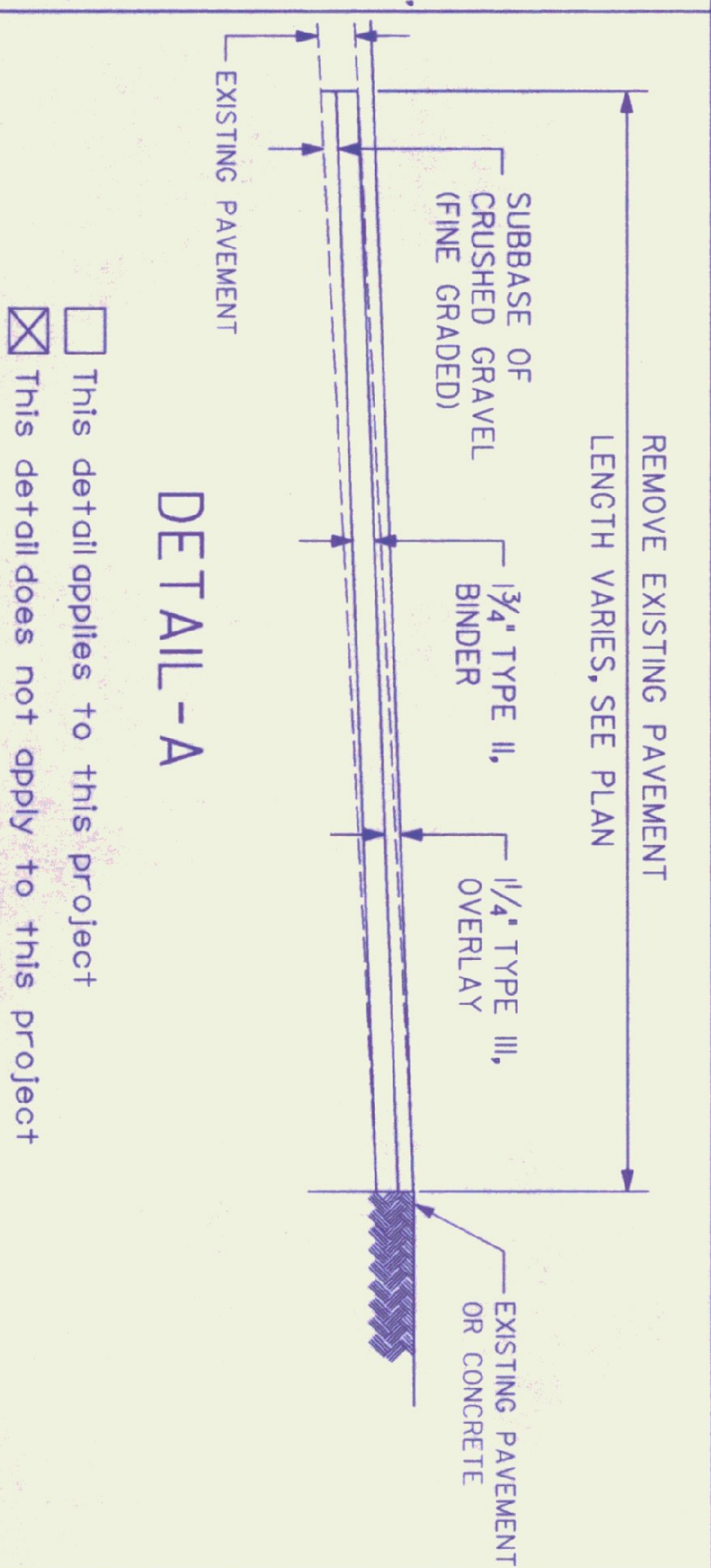

- This detail applies to this project
- This detail does not apply to this project

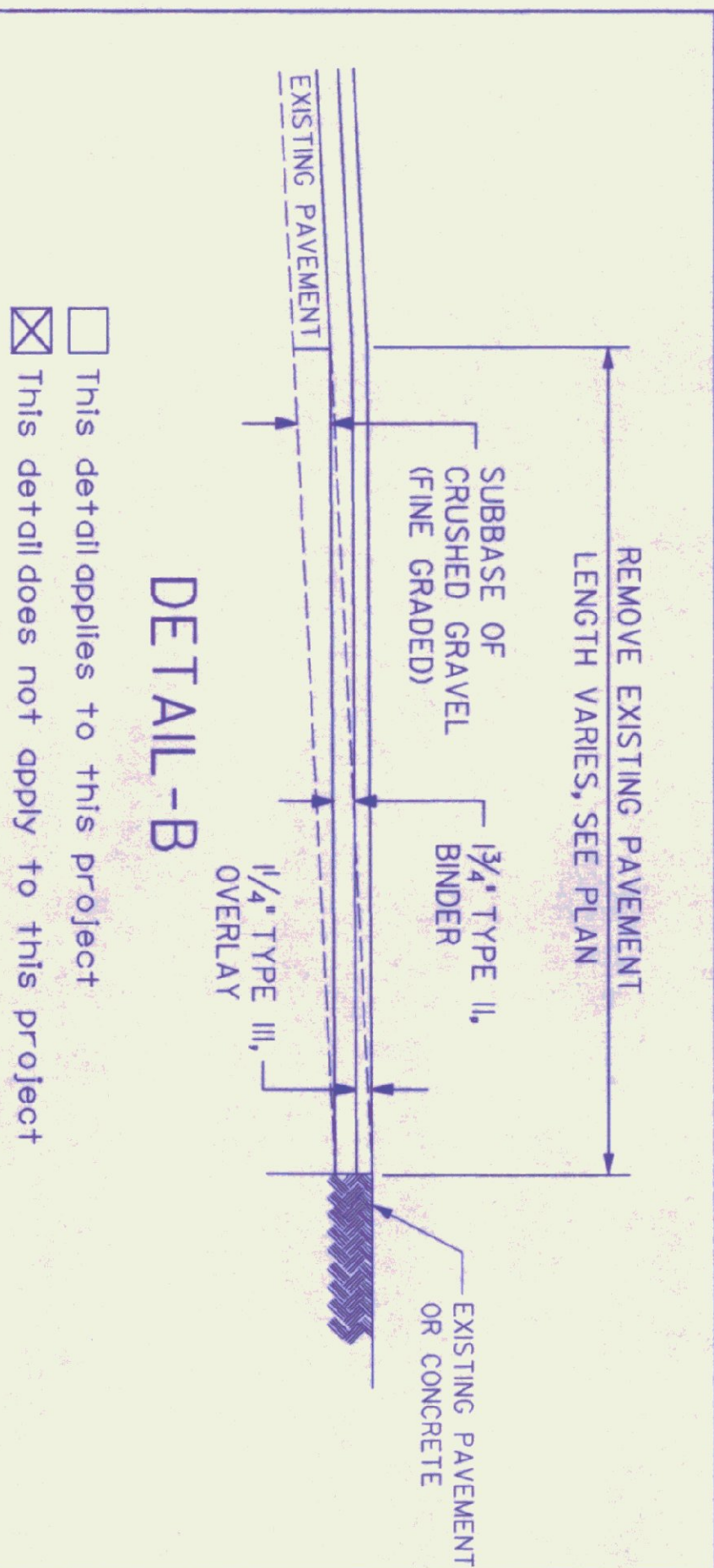

- This detail applies to this project
- This detail does not apply to this project

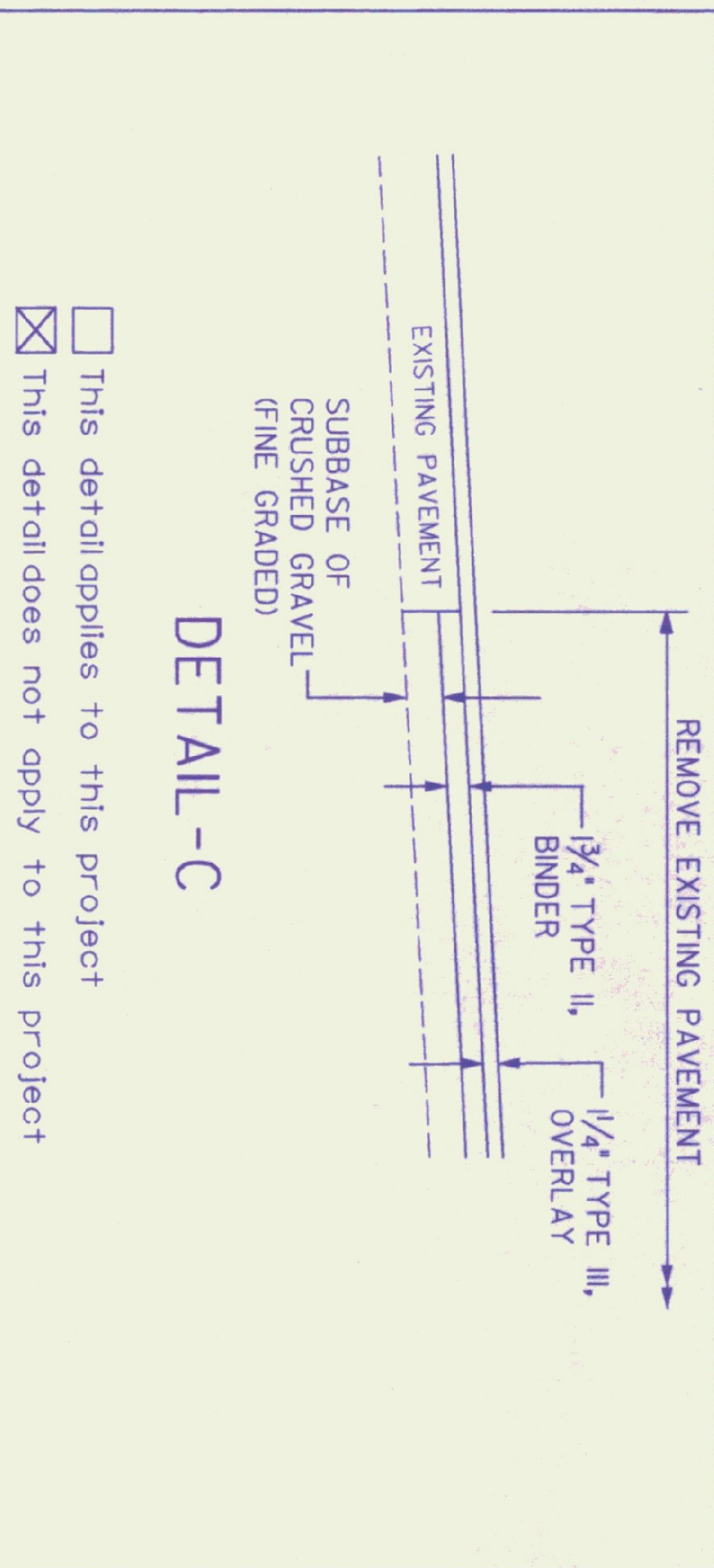

- This detail applies to this project
- This detail does not apply to this project

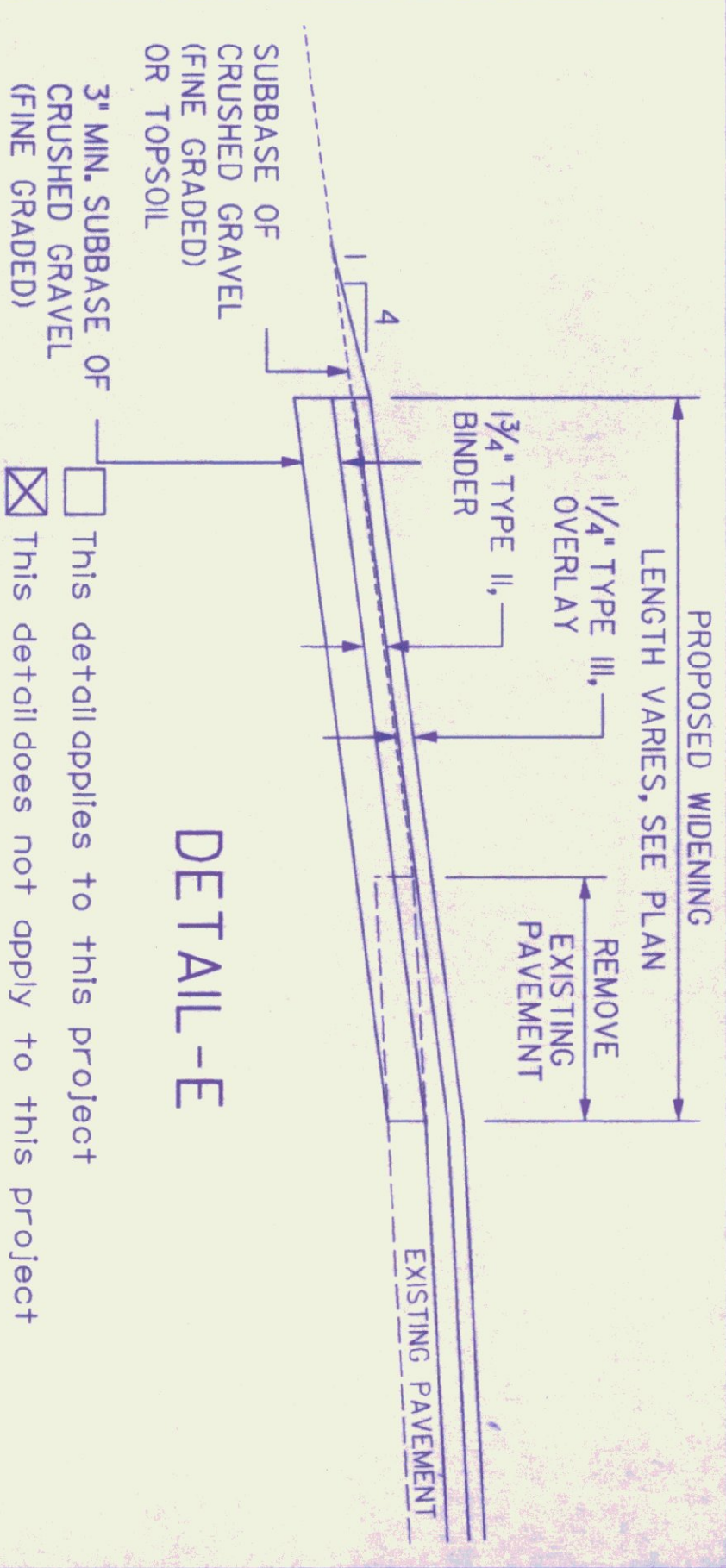

- This detail applies to this project
- This detail does not apply to this project

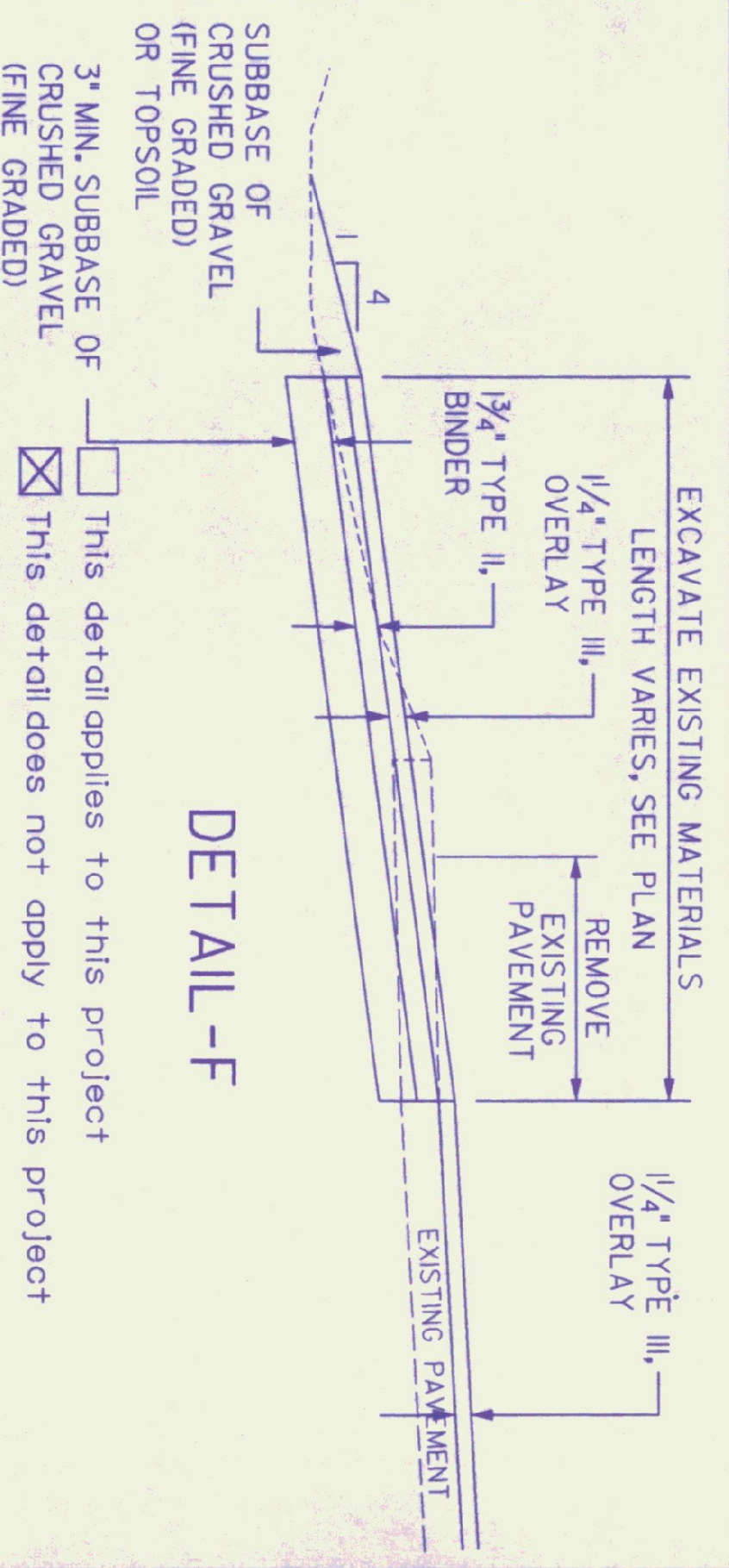

- This detail applies to this project
- This detail does not apply to this project

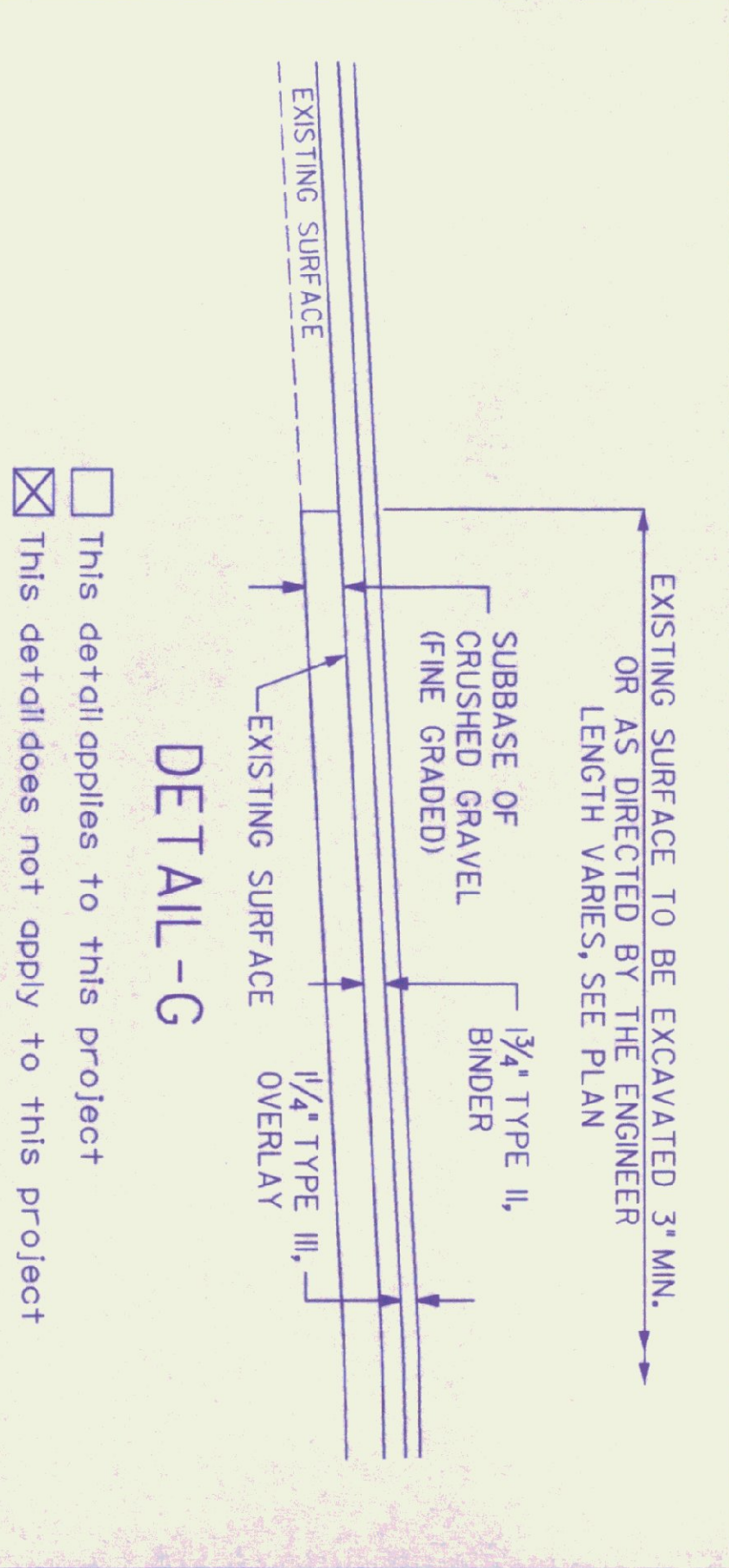

- This detail applies to this project
- This detail does not apply to this project

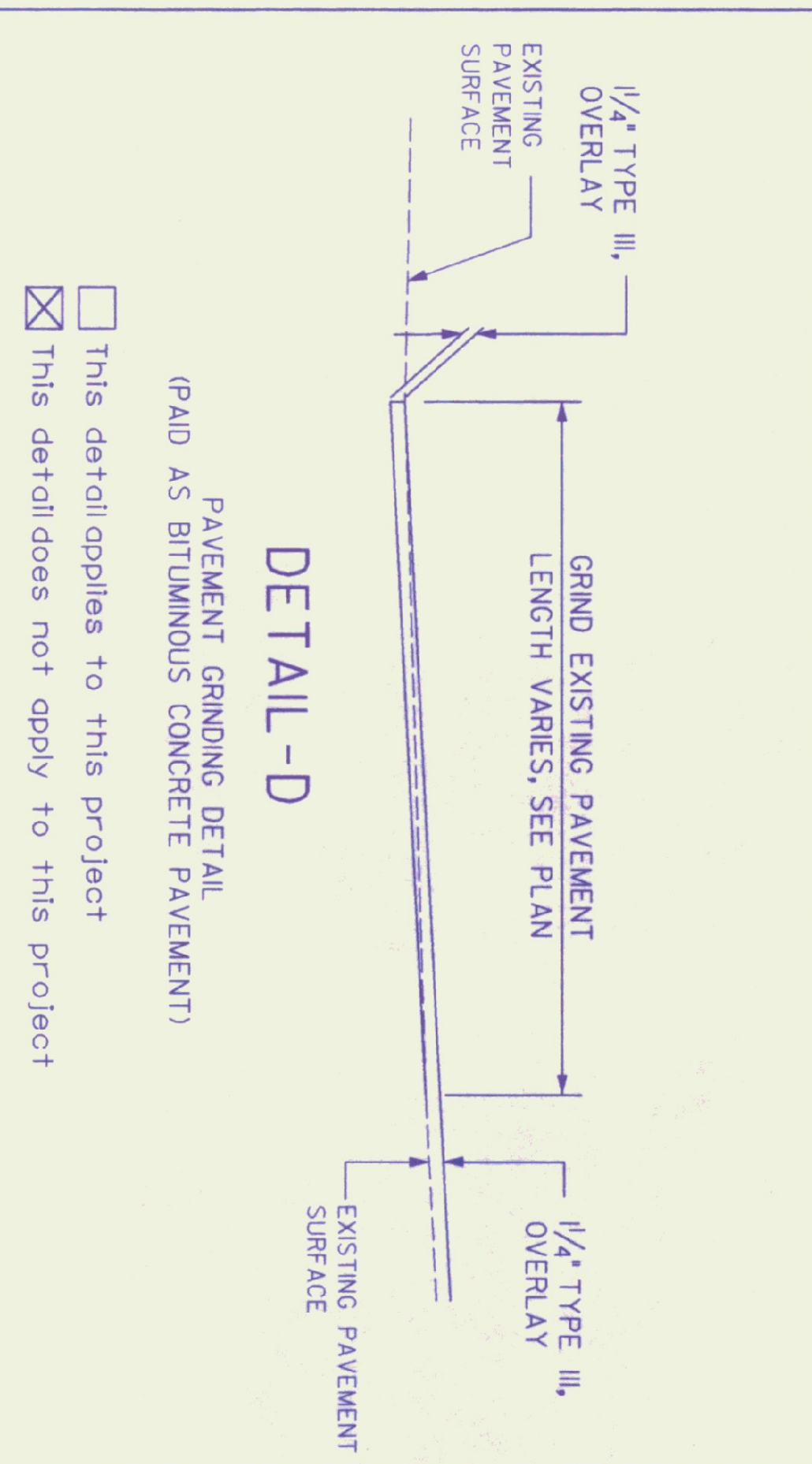

- This detail applies to this project
- This detail does not apply to this project

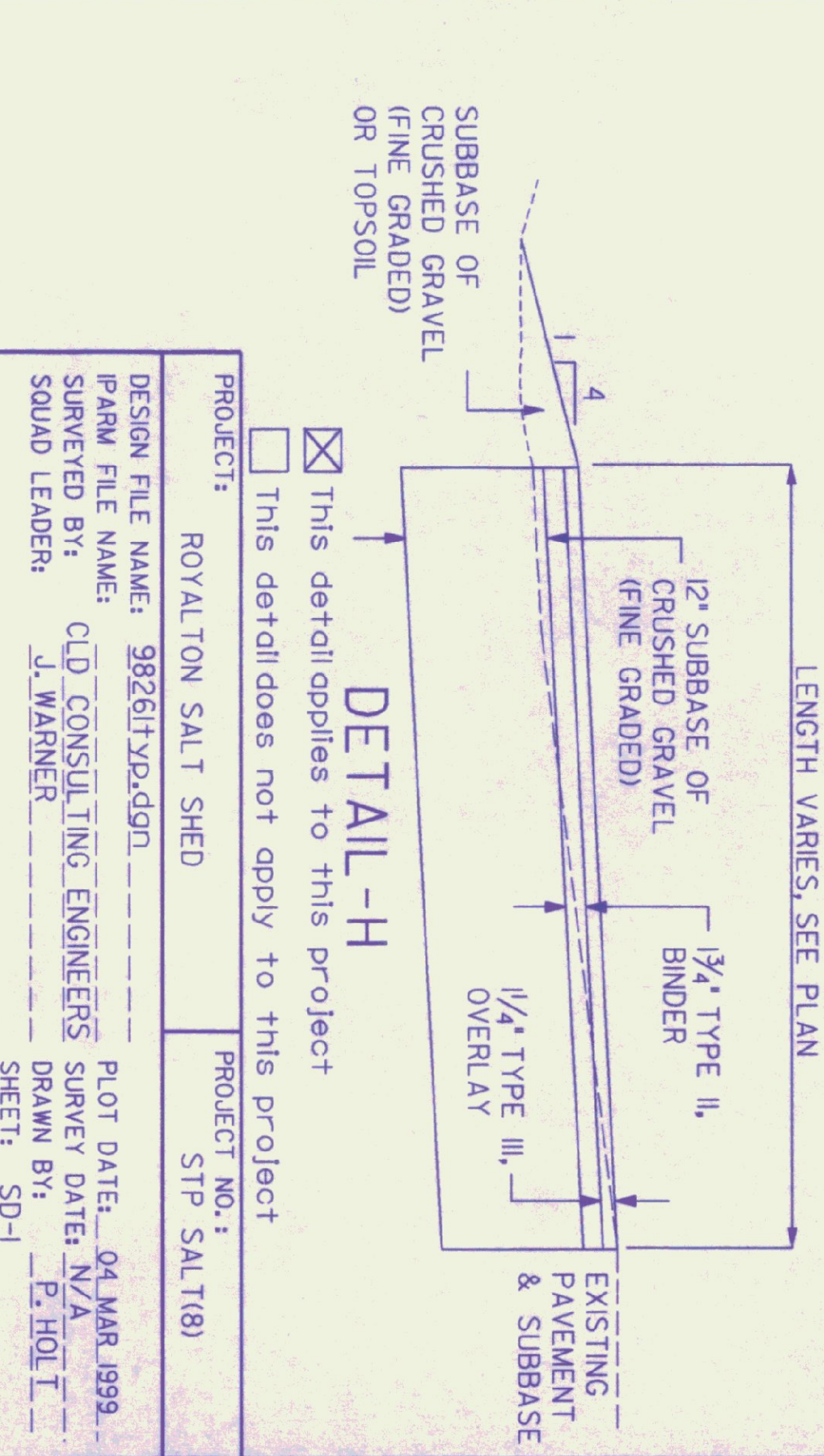

- This detail applies to this project
- This detail does not apply to this project

DATUM
VERTICAL _____
HORIZONTAL _____



PROJECT: ROYALTON SALT SHED
PROJECT NO.: STP SALT(8)

DESIGN FILE NAME: 98261ty.dgn
PLM FILE NAME: CJD CONSULTING ENGINEERS
SURVEYED BY: J. WARNER
SQUAD LEADER: P. HOLI
PLOT DATE: 04 MAR 1999
SURVEY DATE: N/A
DRAWN BY: P. HOLI
SHEET: SD-1

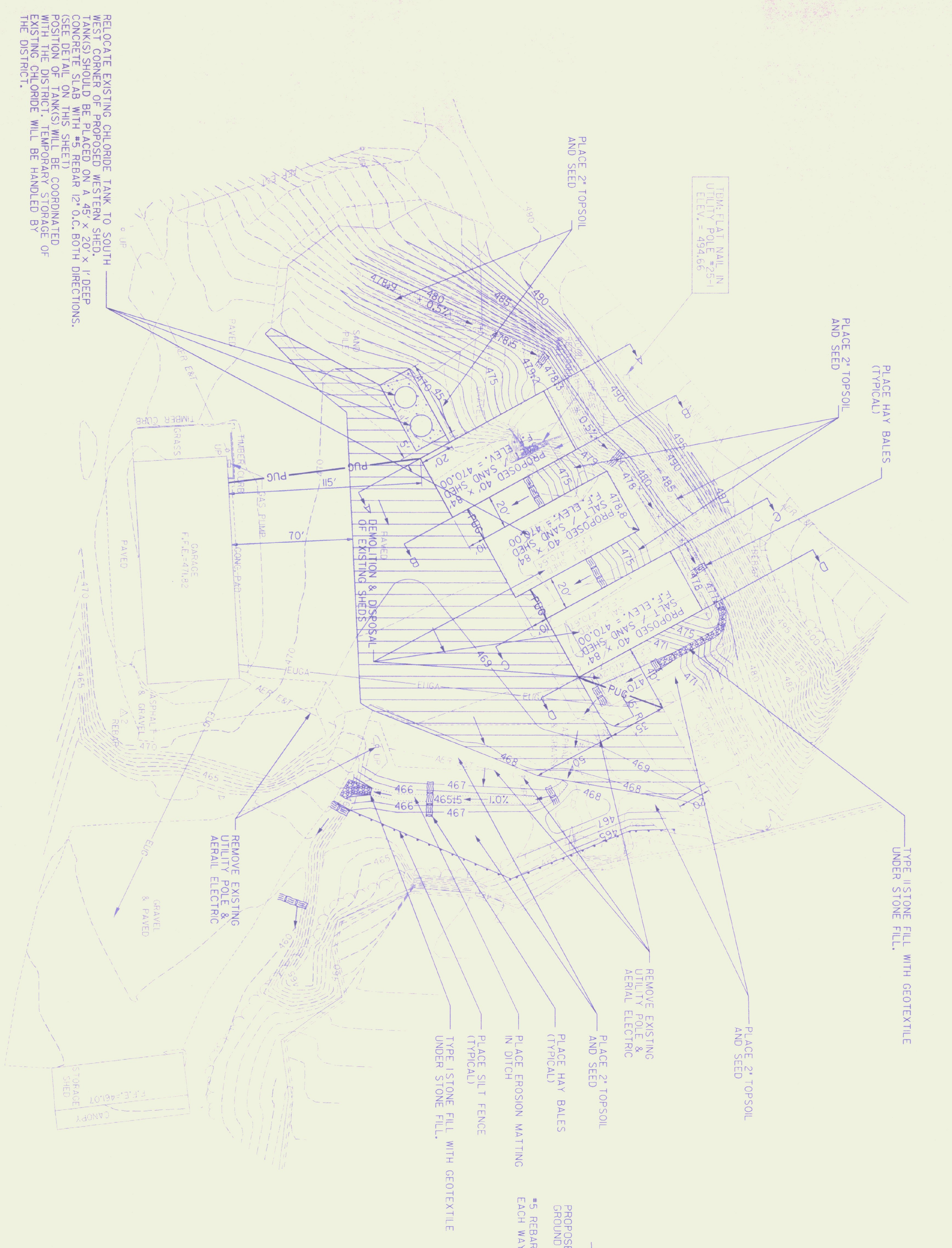

RELOCATE EXISTING CHLORIDE TANK TO SOUTH WEST CORNER OF PROPOSED WESTERN SHED. TANK(S) SHOULD BE PLACED ON A 45' x 20' x 1' DEEP CONCRETE SLAB WITH #5 REBAR 12" O.C. BOTH DIRECTIONS. (SEE DETAIL ON THIS SHEET) POSITION OF TANK(S) WILL BE COORDINATED WITH THE DISTRICT. TEMPORARY STORAGE OF EXISTING CHLORIDE WILL BE HANDLED BY THE DISTRICT.

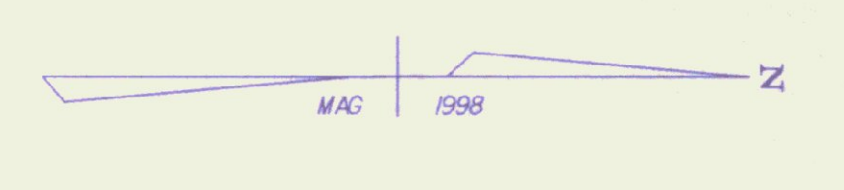
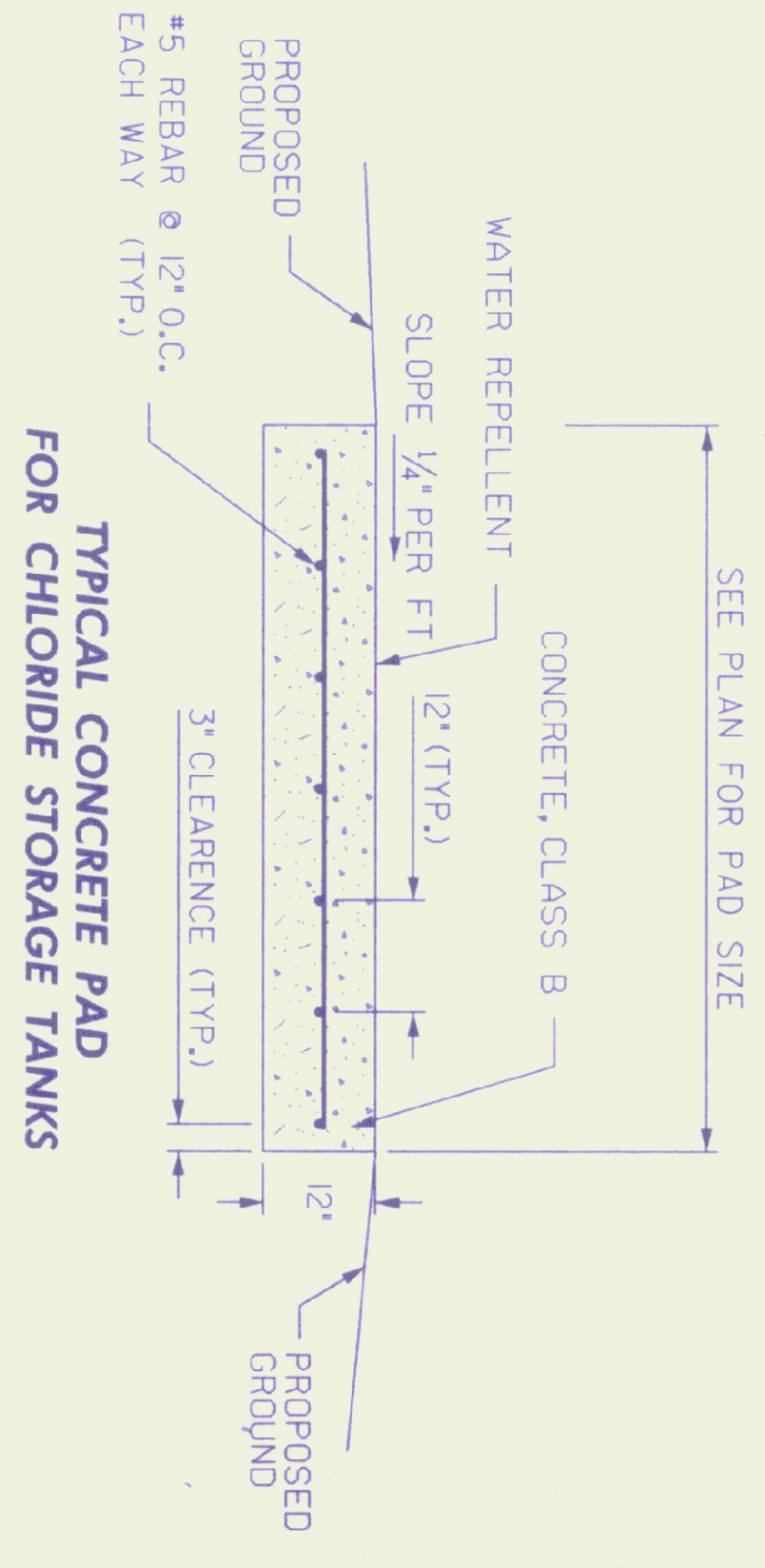
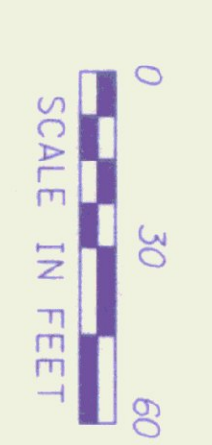

LEGEND

- PUG — PROPOSED UNDERGROUND UTILITIES
- EUGA — EXISTING UNDERGROUND UTILITIES (ABANDONED)
- EUG — EXISTING UNDERGROUND UTILITIES
- EXISTING SURFACES REQUIRING EARTH BORROW SHALL BE SCARIFIED, PAID AS ITEM 212.20, SCARIFYING PAVEMENT, PRIOR TO PLACING BORROW.
- CONSTRUCT PAVED DRIVE WITH 12" SUBBASE OF CRUSHED GRAVEL (FINE GRADED) AND PAVE WITH 3" BGP. EXCAVATION FOR THIS AREA SHALL BE PAID AS ITEM 203.15, COMMON EXCAVATION. SEE DETAIL H

PROJECT:	ROYAL TON SALT SHED	PROJECT NO.:	STP SALT(8)
DESIGN FILE NAME:	9828dtdr.dgn	PLOT DATE:	05 MAR 1999
IPARW FILE NAME:		SURVEY DATE:	OCT 98
SURVEYED BY:	C.D. CONSULTING ENGINEERS	DRAWN BY:	P. HOLT
SQUAD LEADER:	L. WARNER	SHEET:	SD-2

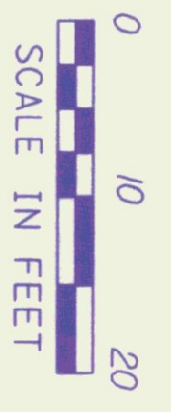
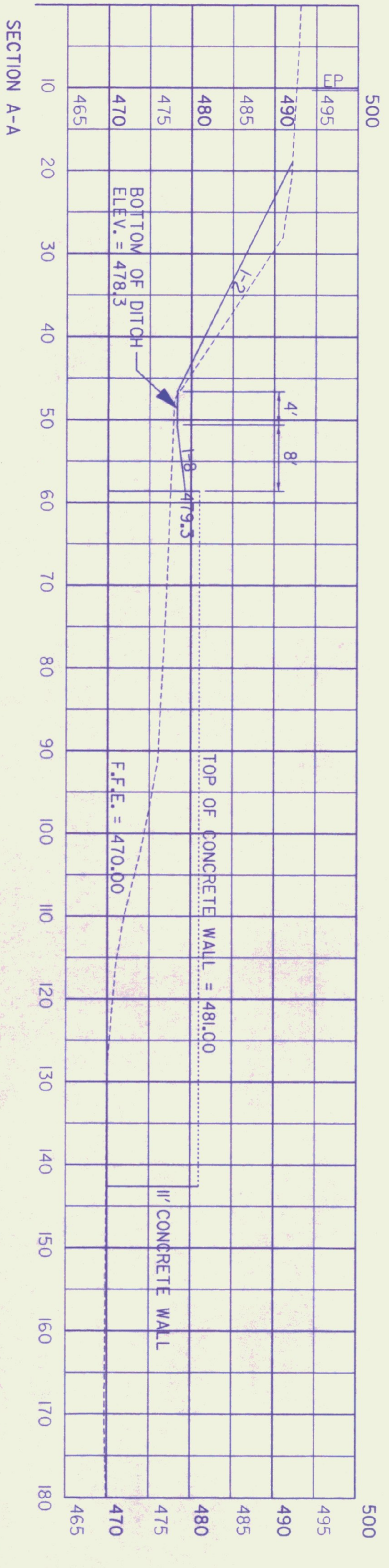
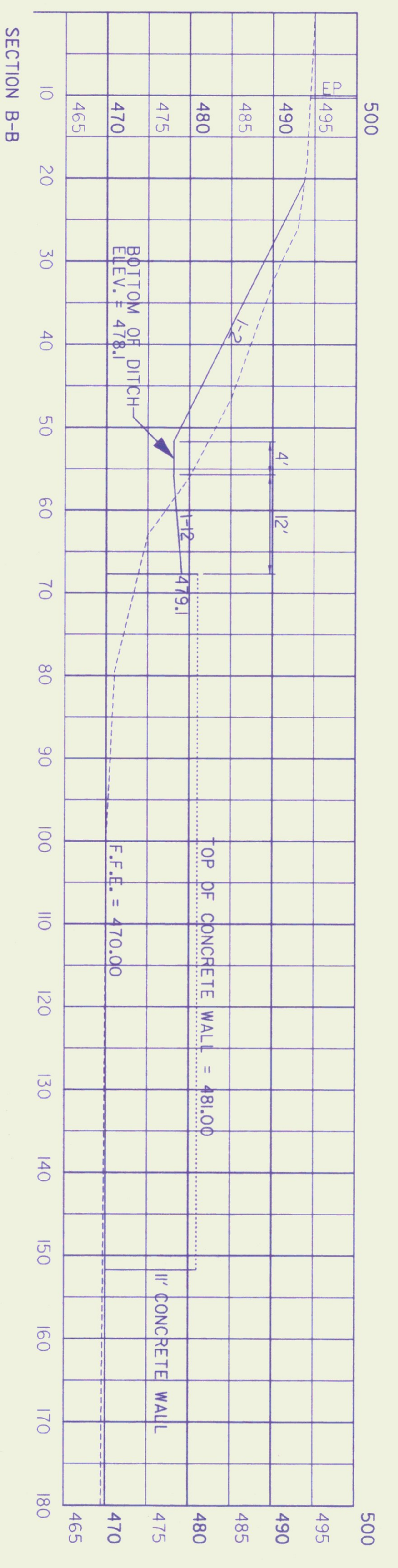
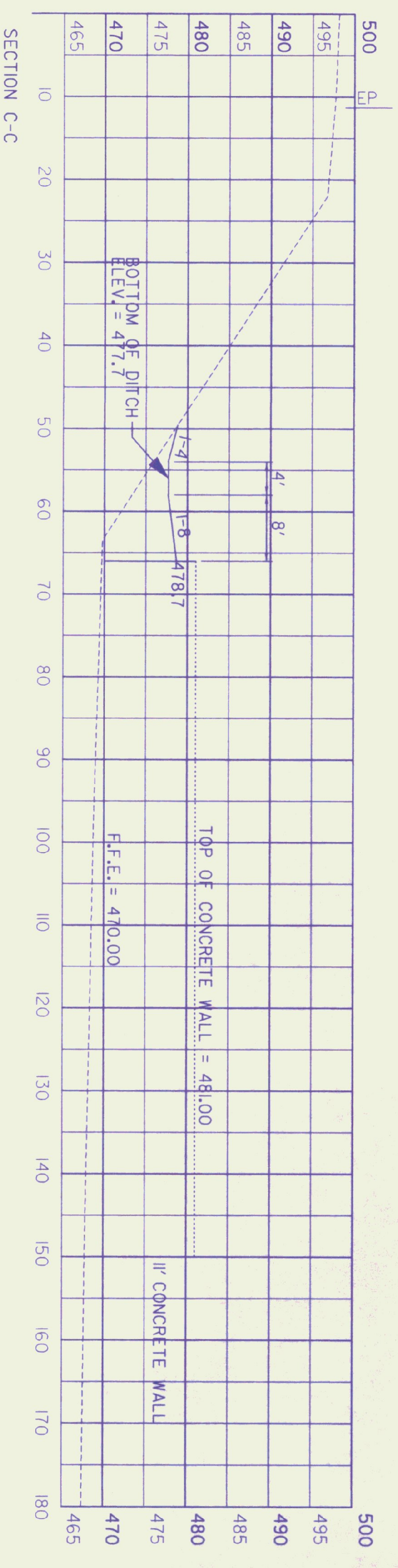
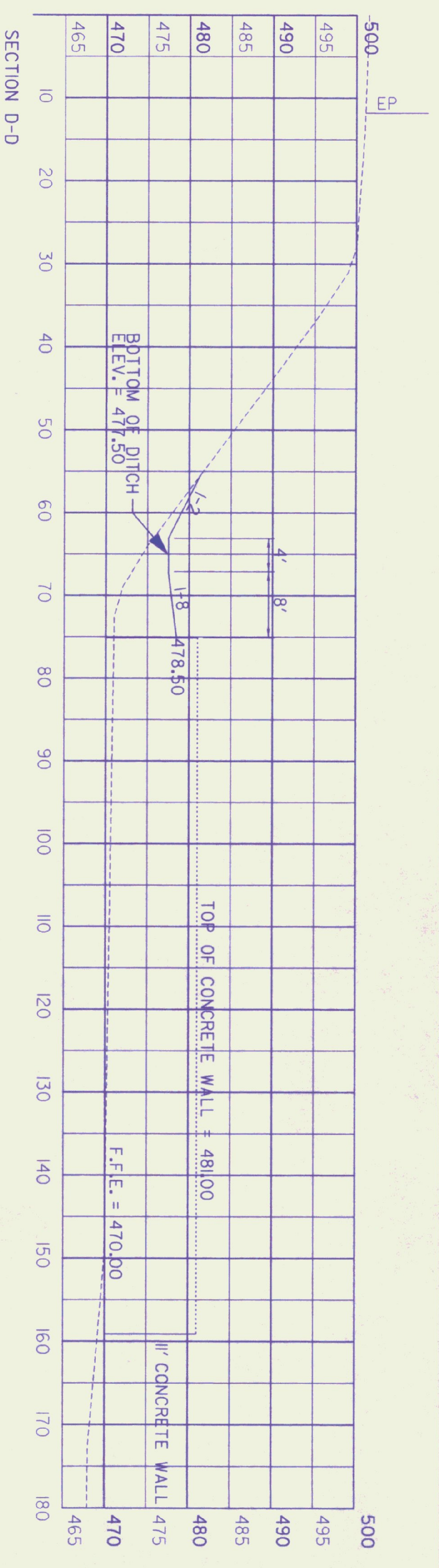

PROJECT: ROYALTON SALT SHED PROJECT NO.: STP SALT(8)

DESIGN FILE NAME: xsoc1-bdc-d90

PARM FILE NAME: CLO CONSULTING ENGINEERS

SURVEYED BY: J. WÄGNER SURVEY DATE: 04 MAR 1999

SQUAD LEADER: J. WÄGNER DRAWN BY: P. HOLL

SHEET: SD-3

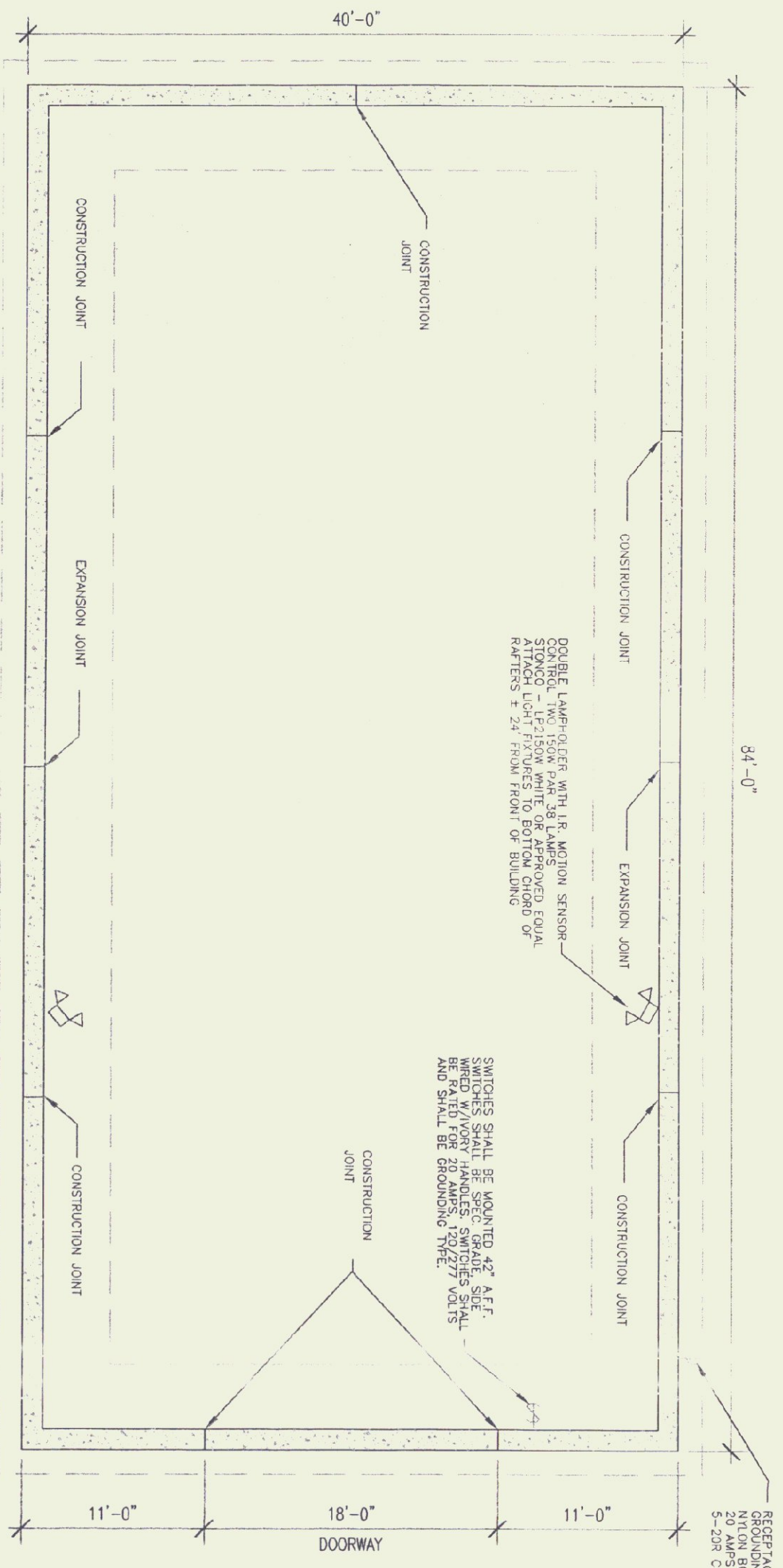

FOUNDATION PLAN
SCALE: 1/8" = 1'-0"

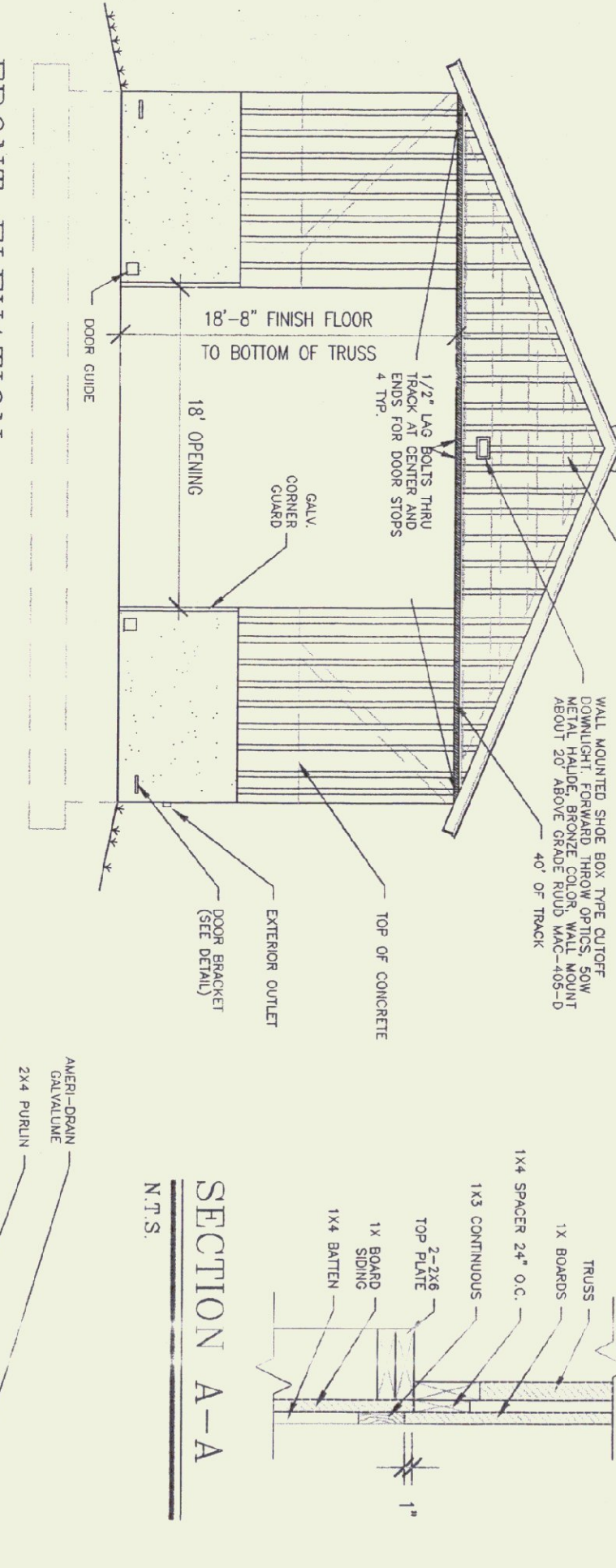

FRONT ELEVATION
SCALE: 1/8" = 1'-0"

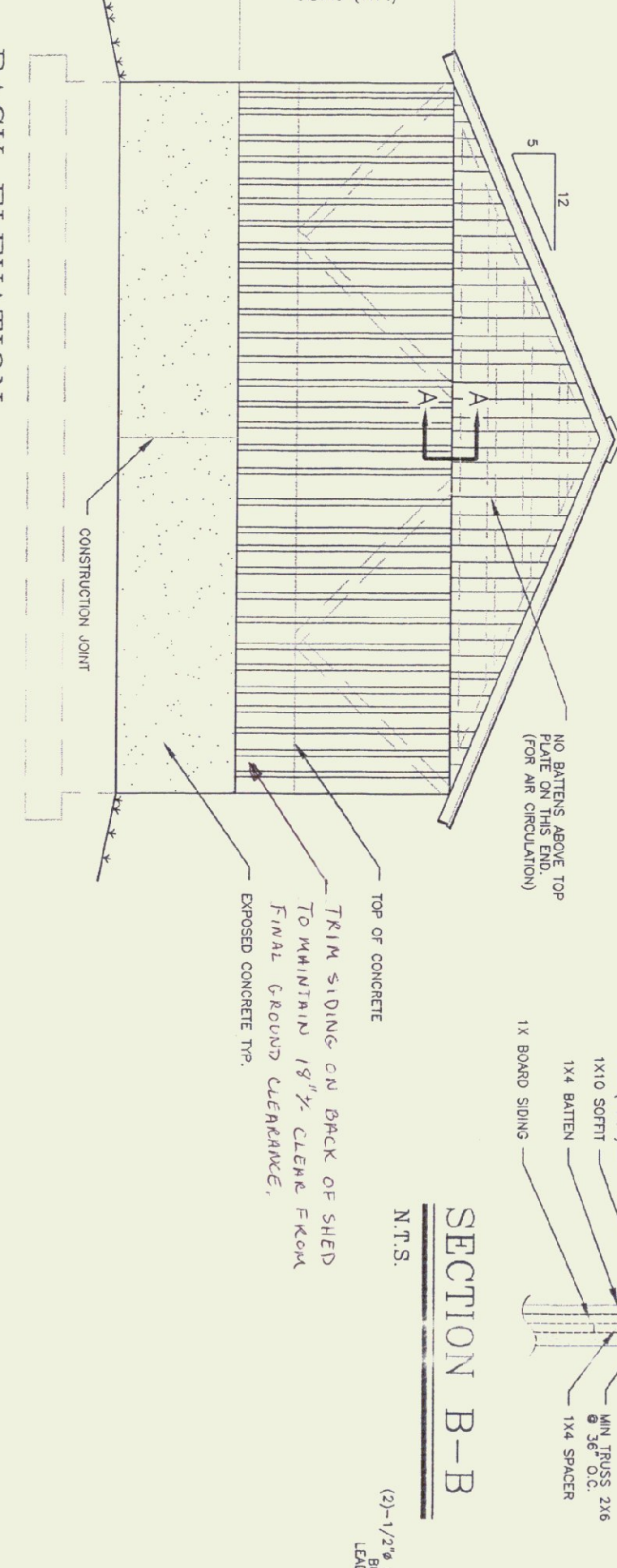

BACK ELEVATION
SCALE: 1/8" = 1'-0"

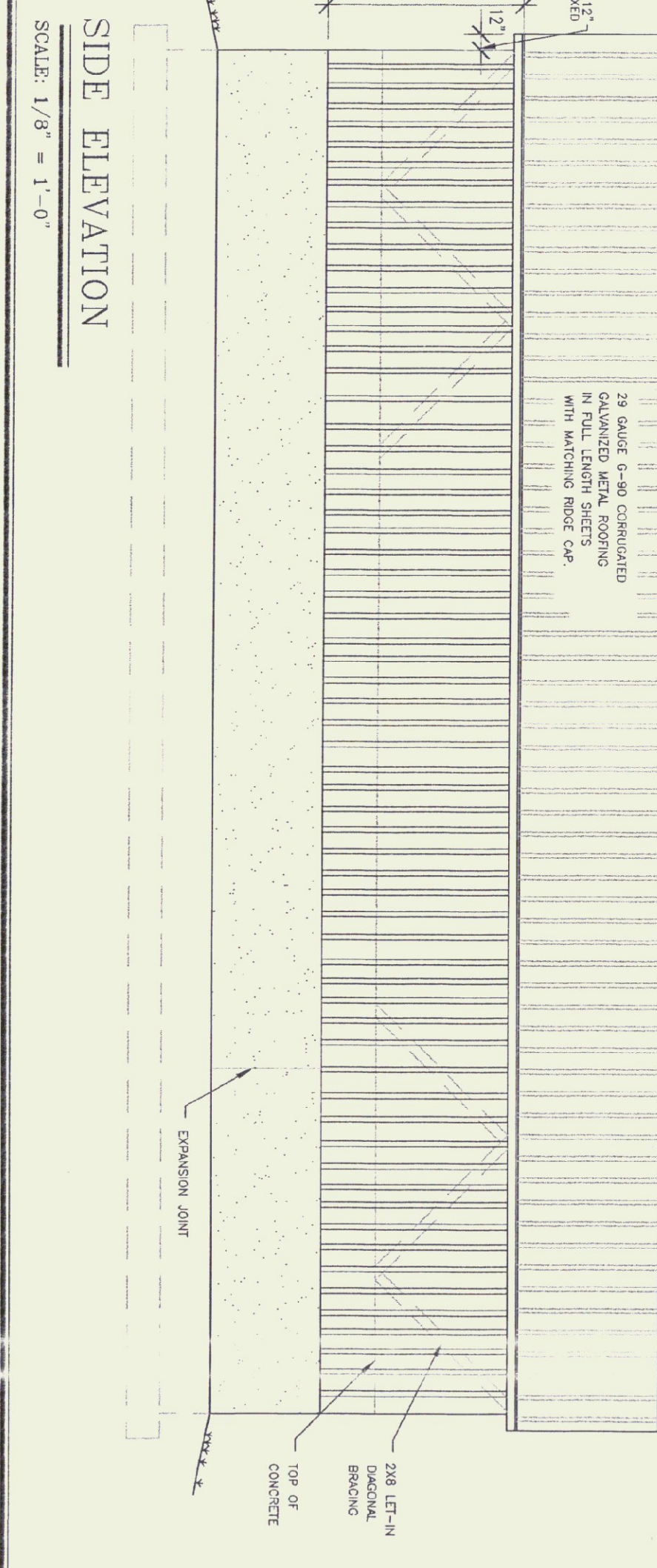

SIDE ELEVATION
SCALE: 1/8" = 1'-0"

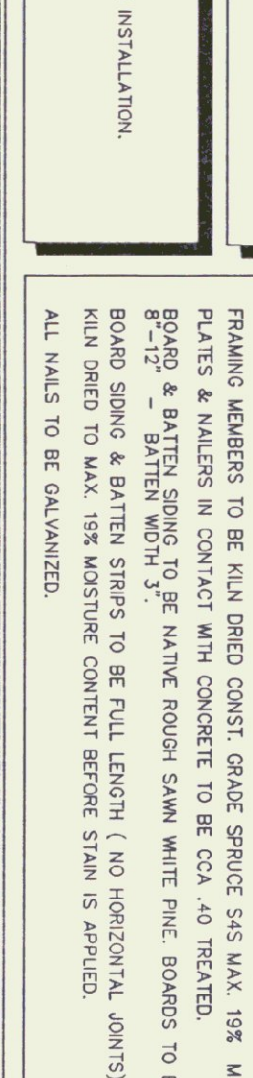
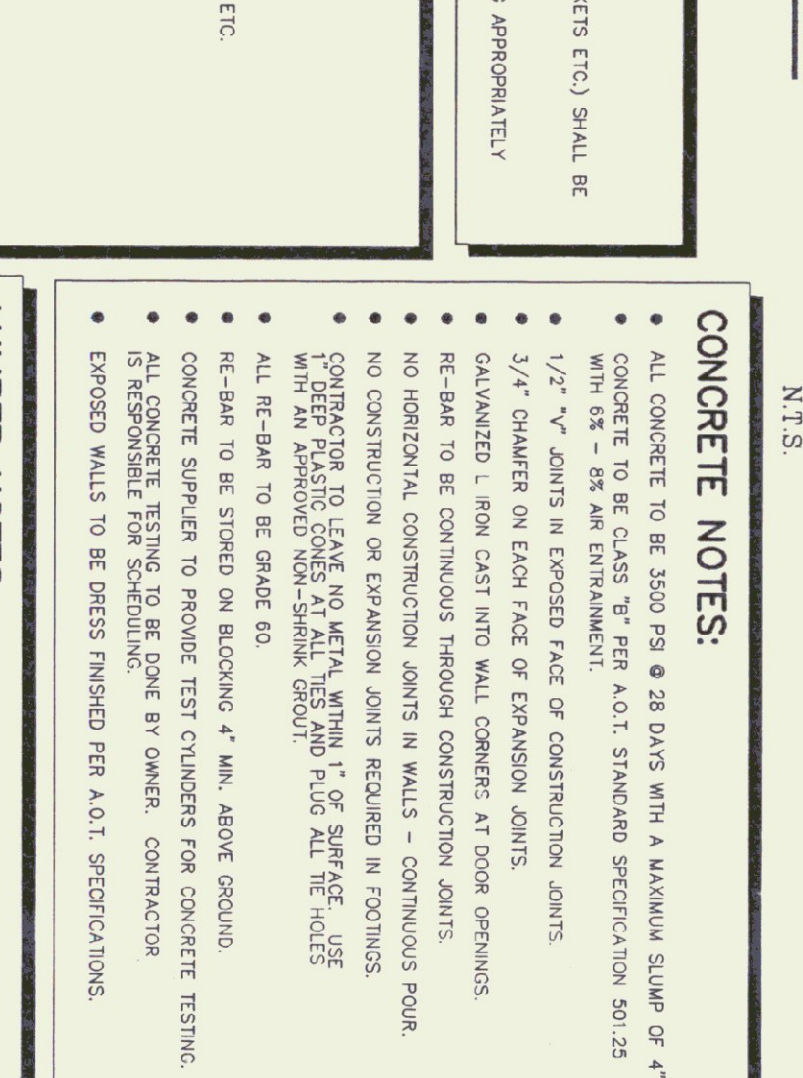
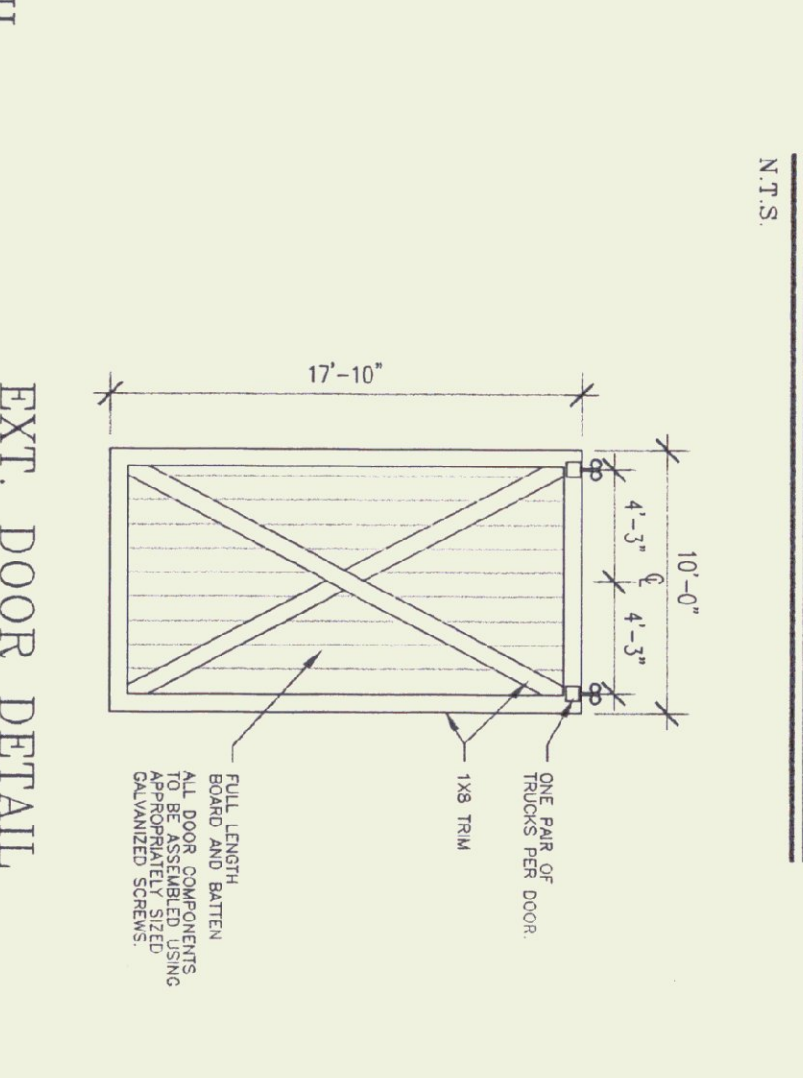
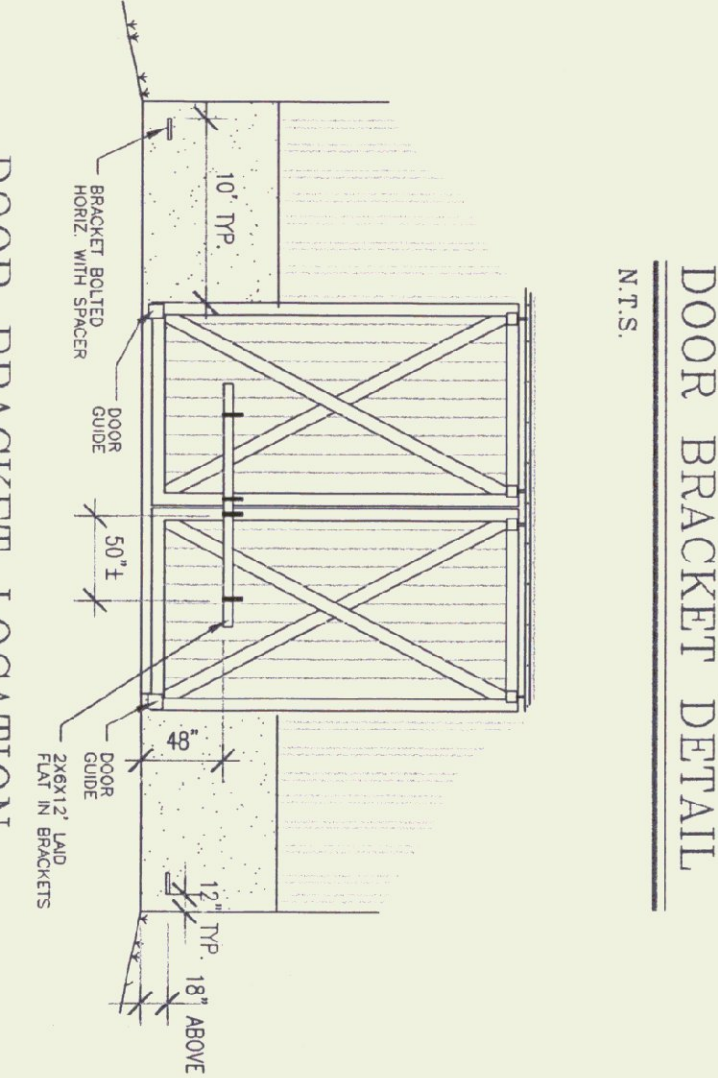
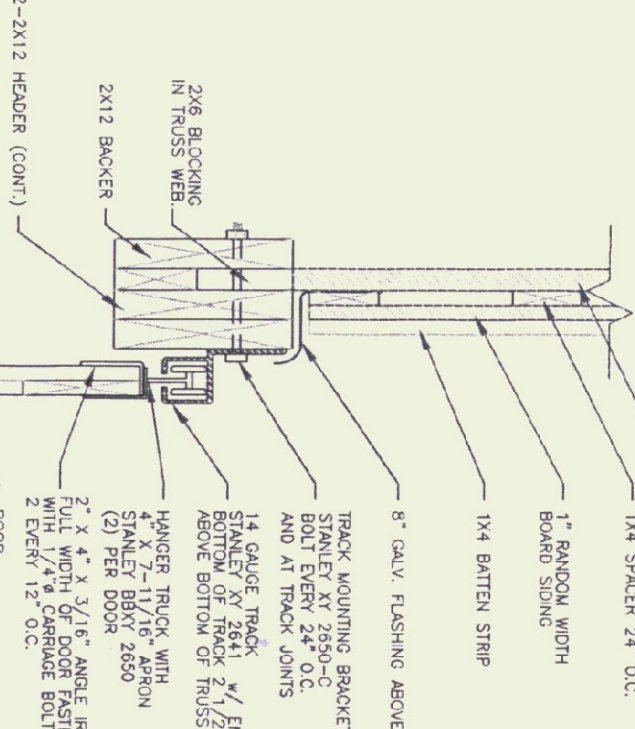
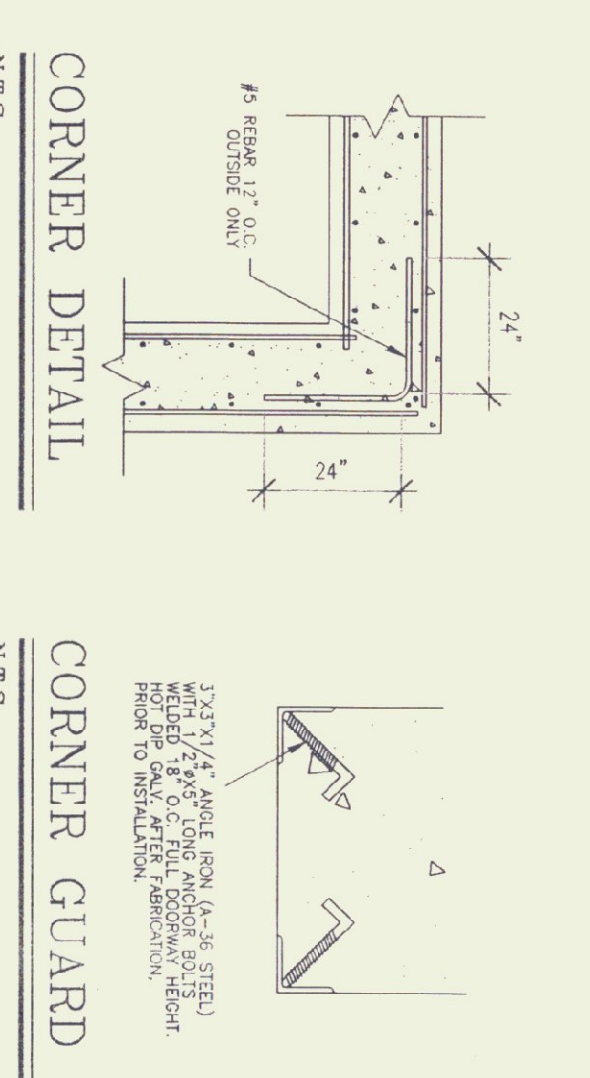
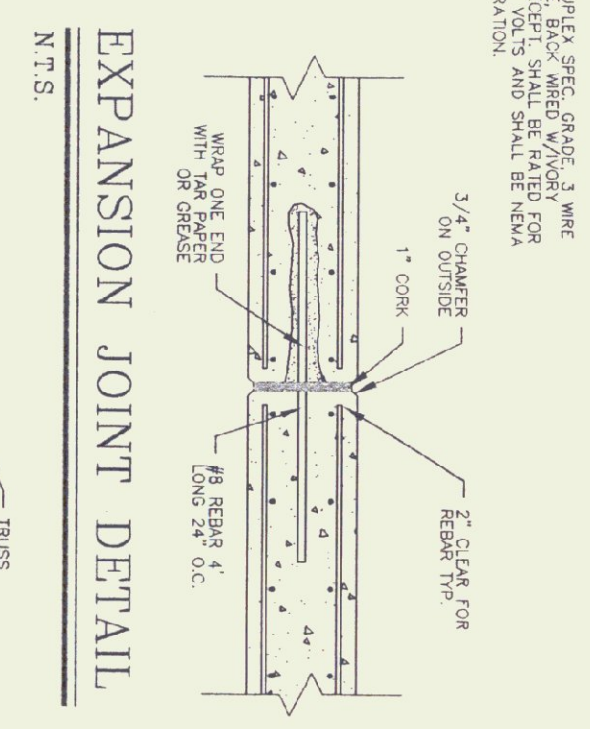

GENERAL NOTES:
 ALL MATERIAL TO BE FURNISHED BY CONTRACTOR.
 ALL EXPOSED METAL, EXCEPT GALVANIZED (CORNER ANGLES, DOOR GUIDES, BRACKETS ETC) SHALL BE PAINTED FLAT BLACK (2 MILS THICK, 100% MIN) OVER ROUGH HERRING IRON.
 ALL ELECTRICAL WORK SHALL COMPLY WITH N.E.C.
 STEEL FASTENERS AND ACCORDING TO INDUSTRY STANDARDS.

TRUSS NOTES:
 TRUSS MANUFACTURER TO SEND SUBMISSIONS TO THE RESIDENT ENGINEER.
 TRUSS MANUFACTURER TO PROVIDE THE CONTRACTOR WITH ALL THE NECESSARY INSTRUCTIONS FOR PROPER TRUSS INSTALLATION, ANCHORAGE, BRACKET LIFTING, ETC.
 TRUSS DESIGN IN ACCORDANCE WITH THE 1987 B.O.C. FOR VERMONT.
 MINIMUM LOADS
 LIVE - 60 P.S.F. - PER 1994 VERMONT FIRE PROTECTION CODE.
 DEAD - AS CALCULATED FROM TRUSS AND ROOF MATERIALS AND IN ADDITION WIND - 25 P.S.F.
 DIAGONAL BRACING PER TRUSS MANUFACTURER AND PER MINIMUM TRUSS BRACING DETAIL IN SPECIFICATIONS.

FINISH NOTES:
 ALL BOARDS & BATTENS TO BE STAINED WITH ONE COAT. ALL SURFACES PRIOR TO INSTALLATION AFTER INSTALLATION EXTERIOR SIDING TO RECEIVE (1) ADDITIONAL COAT OF STAIN. SEMI-TRANSPARENT & THE SECOND COAT WILL BE HIGH PIGMENT STAIN.

CONCRETE NOTES:
 ALL CONCRETE TO BE 3500 P.S.I. @ 28 DAYS WITH A MAXIMUM SLUMP OF 4".
 CONCRETE TO BE CLASS "B" PER A.O.T. STANDARD SPECIFICATION 80.125 WITH 6% - 8% AIR ENTRAINMENT.
 1/2" "V" CHAMBERS IN EXPOSED FACE OF CONSTRUCTION JOINTS.
 3/4" CHAMBERS ON EACH FACE OF EXPANSION JOINTS.
 GALVANIZED L-IRON CAST INTO WALL CORNERS AT DOOR OPENINGS.
 RE-BAR TO BE CONTINUOUS THROUGH CONSTRUCTION JOINTS.
 NO HORIZONTAL CONSTRUCTION JOINTS IN WALLS - CONTINUOUS POUR.
 CONSTRUCTION TO LEAVE NO HORIZONTAL CONSTRUCTION JOINTS IN FLOORS.
 DEEP PLASTIC CONE AT ALL REBAR AND PILE ALL THE HOLES WITH AN APPROVED NON-SHANK GROUT.
 ALL RE-BAR TO BE GRADE 60.
 RE-BAR TO BE STICED ON BLOCKING 4" MIN. ABOVE GROUND.
 CONCRETE SUPPLIER TO PROVIDE TEST CYLINDERS FOR CONCRETE TESTING.
 ALL CONCRETE TESTING TO BE DONE BY OWNER. CONTRACTOR IS RESPONSIBLE FOR SCHEDULING.
 EXPOSED WALLS TO BE DRESS FINISHED PER A.O.T. SPECIFICATIONS.

LUMBER NOTES:
 FRAMING MEMBERS TO BE FULL GRADE SOUTHWEST SPRUCE 5/4 X 108. MOISTURE CONTENT. 15% MAX.
 FLOOR & WALLS IN CONTACT WITH CONCRETE TO BE COX. 40 INCHES.
 BOARDING TO BE FULL GRADE SOUTHWEST SPRUCE 5/4 X 108. MOISTURE CONTENT. 15% MAX.
 BOARDING TO BE FULL LENGTH (NO HORIZONTAL JOINTS). SIDING TO BE FULL DRESSED TO MAX. 15% MOISTURE CONTENT BEFORE STAIN IS APPLIED.
 ALL WALLS TO BE GALVANIZED.

SCALE: AS NOTED DATE: JAN 1997 DRAWN BY: G. D. NORWOOD APPR. BY:	REVISIONS 12-29-91 GDN 7-5-95 BTT 2-10-99 BTT	LOCATION & BUILDING 40' X 84' SALT SHED	
	TOWN:		