

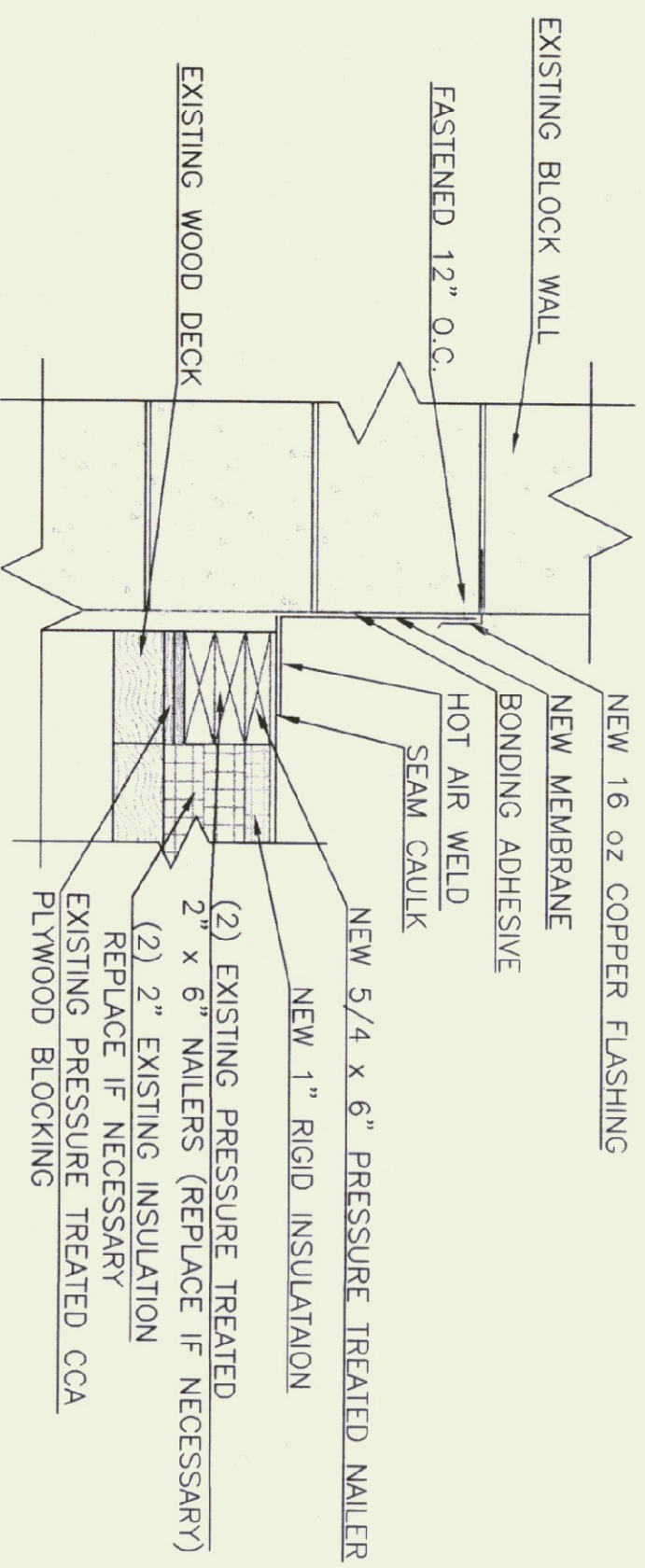

ROOF PLAN  
SCALE: 1/8" = 1'-0"

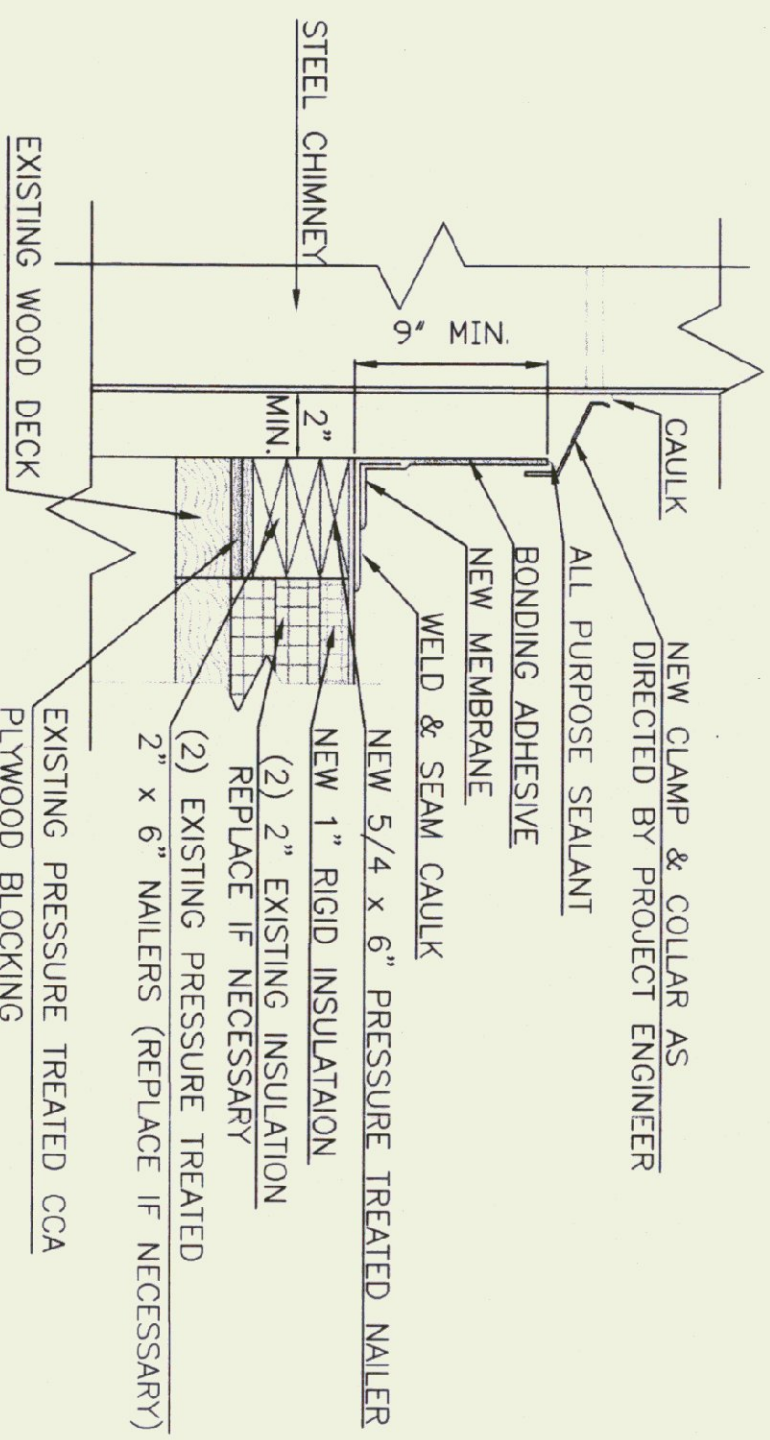

CHIMNEY FLASHING DETAIL  
SCALE: 1-1/2" = 1'-0"



STEEL CHIMNEY DETAIL  
SCALE: 1-1/2" = 1'-0"

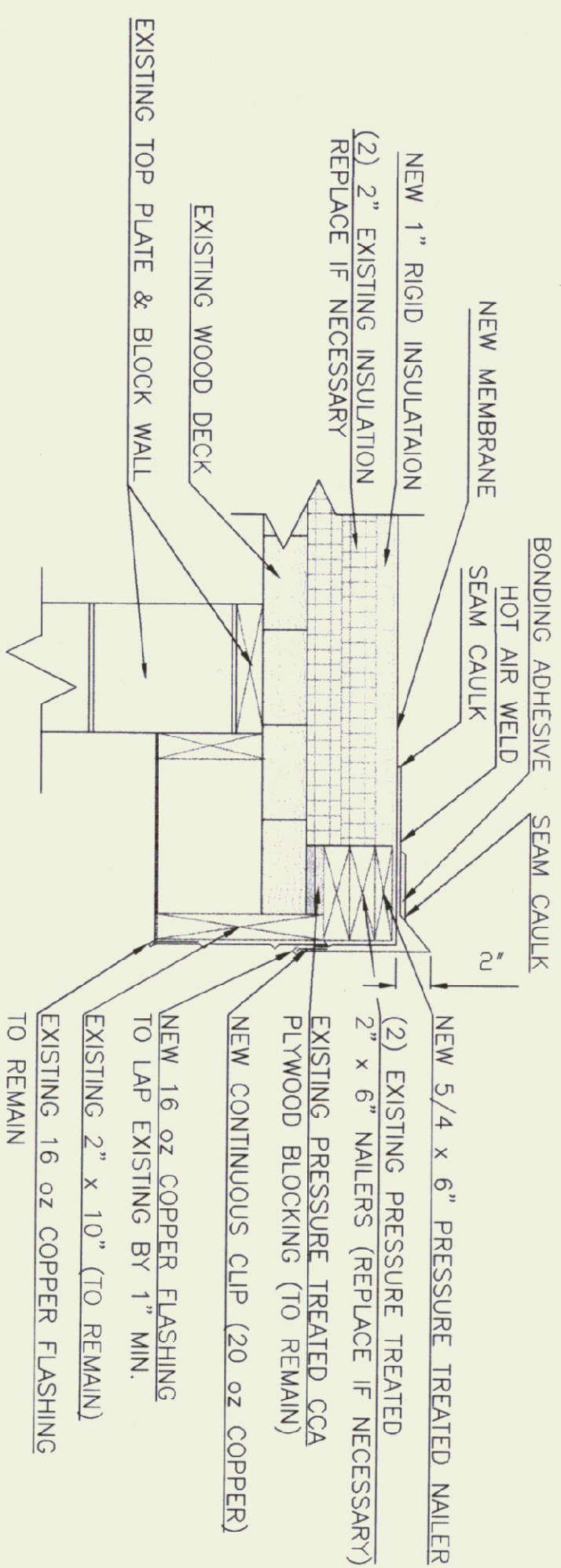

SECTION B-B ROOF DRIP EDGE  
SCALE: 1-1/2" = 1'-0"

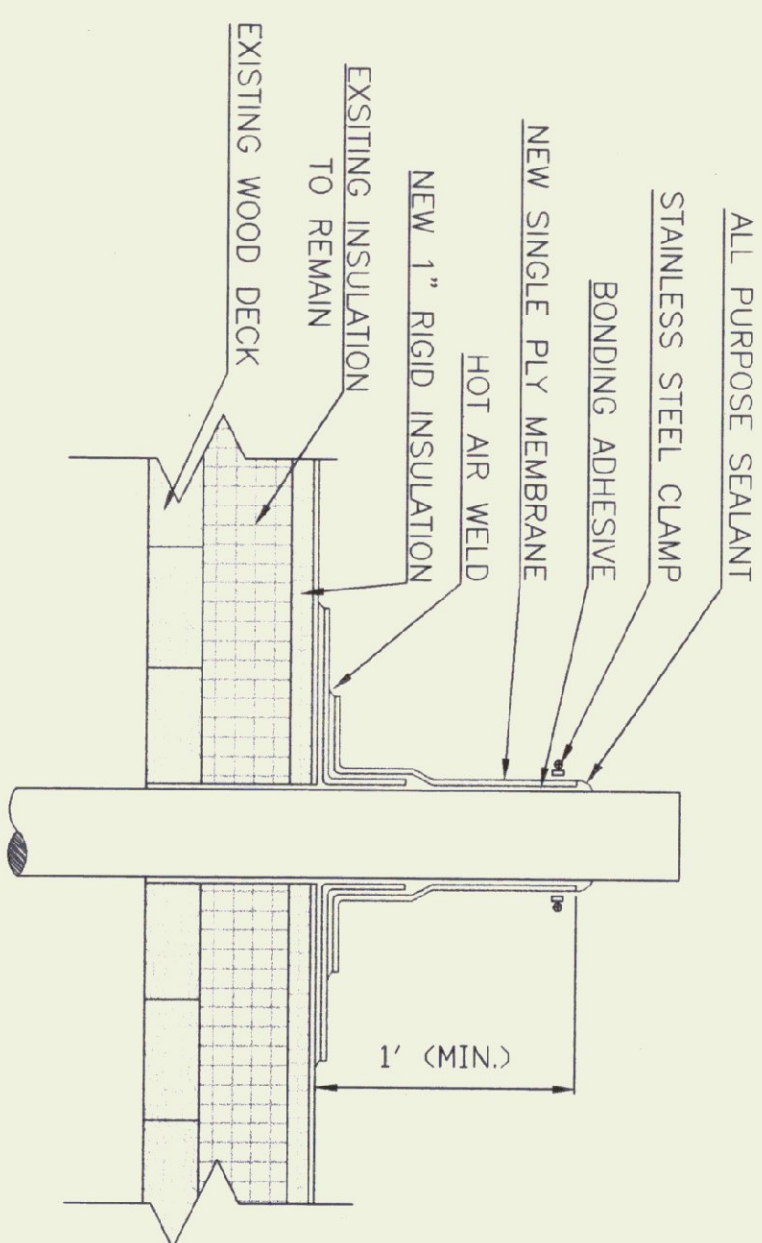

TYPICAL VENT DETAIL  
SCALE: 1-1/2" = 1'-0"

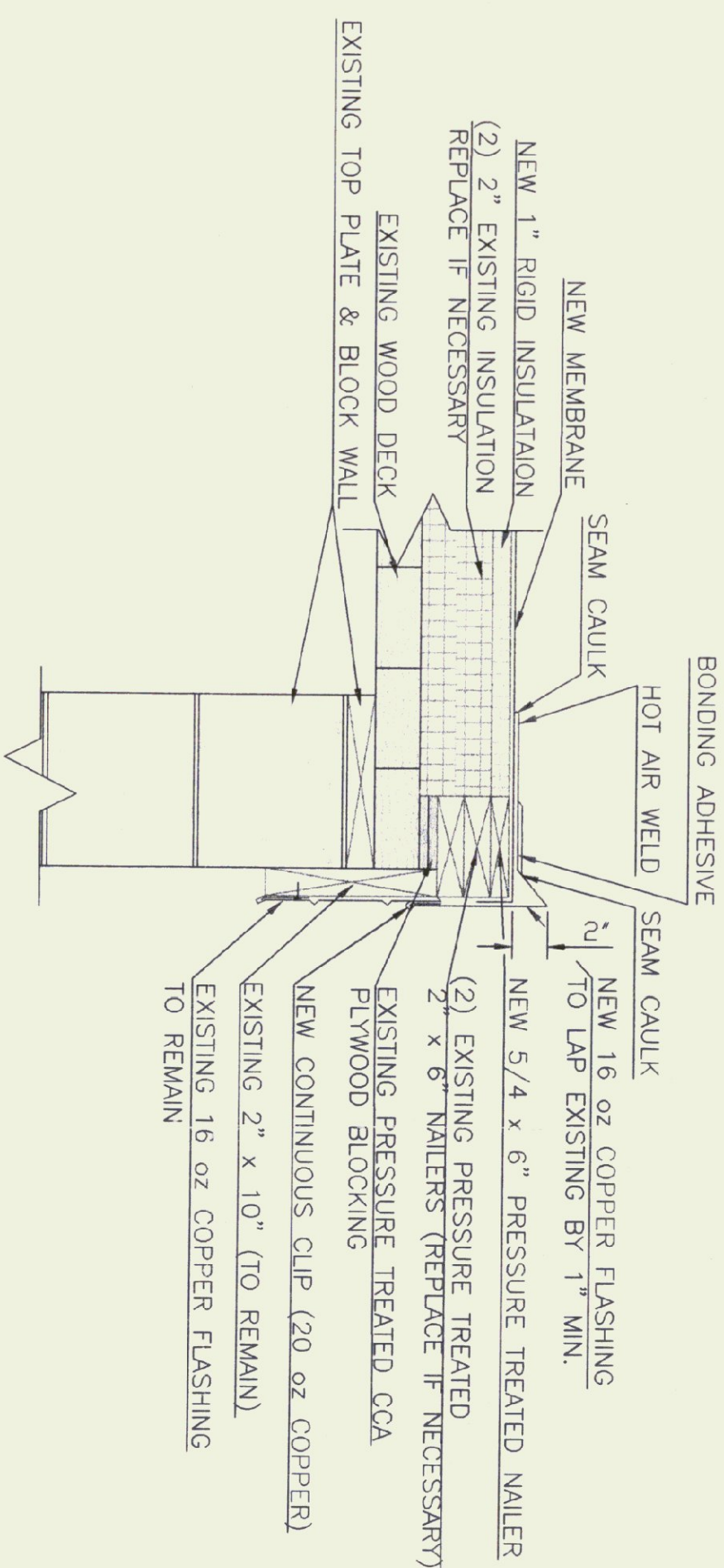

SECTION A-A ROOF RAKE EDGE  
SCALE: 1-1/2" = 1'-0"

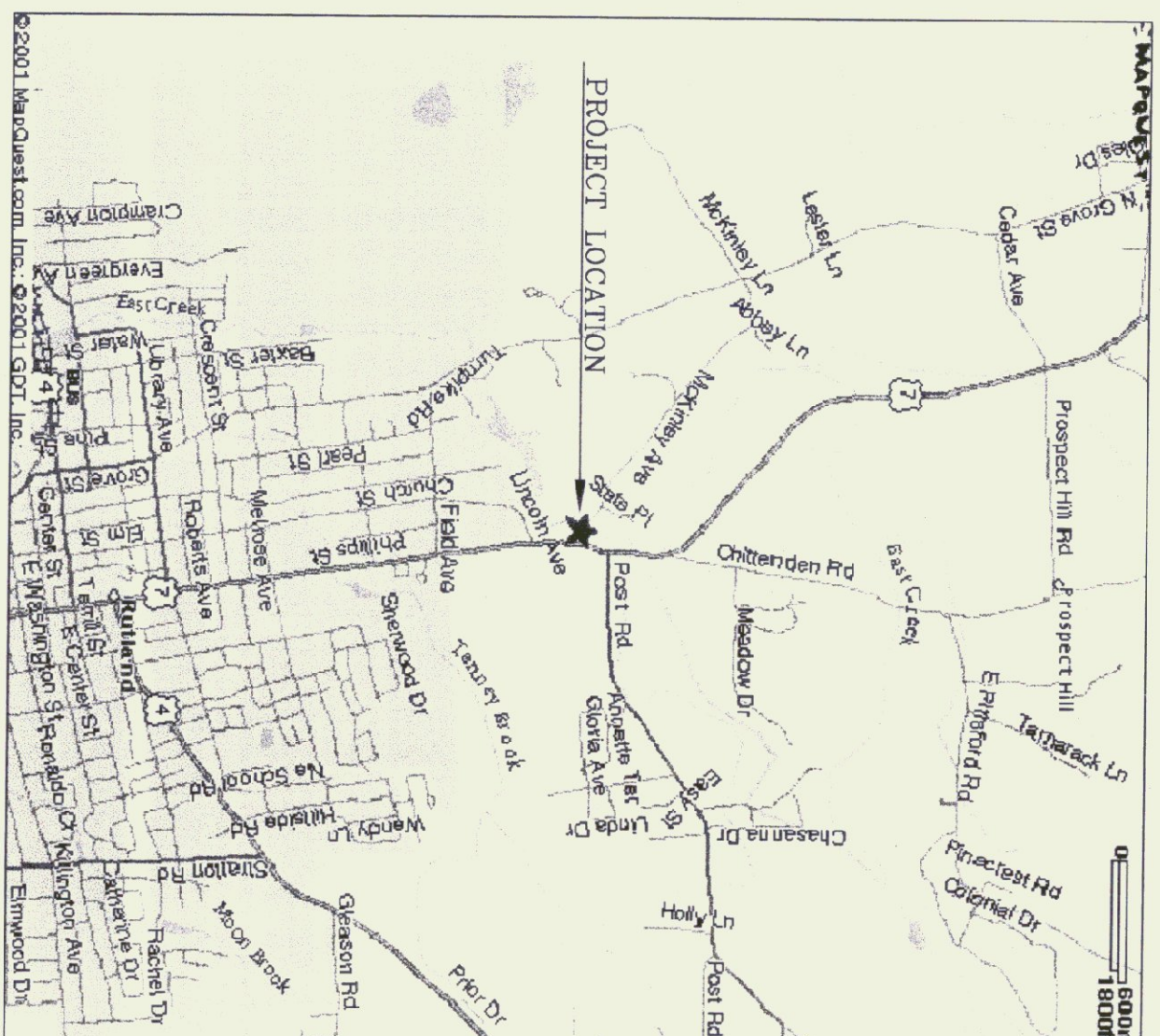

GENERAL NOTES:

- 1.) REMOVE AND REPLACE SOME OF THE 2" INSULATION THAT IS WET. THIS WILL BE DONE BY TIME AND MATERIALS.
- 2.) HOURLY RATES APPLIED TO THESE COSTS WILL BE IN ACCORDANCE WITH THE HOURLY RATE SCHEDULE SUBMITTED AT TIME OF BID, SUBJECT TO VERIFICATION BY THE OWNER OR THE OWNER'S REPRESENTATIVE.
- 3.) EXISTING MEMBRANE AND FLASHING TO BE REMOVED AND DISPOSED OF. EXISTING INSULATION TO BE PROTECTED AND REMAIN IN PLACE. 1" NEW RIGID INSULATION AND NEW .060 EPDM MEMBRANE ROOFING SYSTEM WITH METAL FLASHING.
- 4.) ALL BLOCKING, CANT STRIPS, & LUMBER TO BE PRESSURE TREATED AND REPLACED AS REQUIRED.
- 5.) DETAILS ARE EXAMPLES ONLY. ACTUAL INSTALLATION TO BE DONE IN ACCORDANCE WITH MANUFACTURERS' RECOMMENDATIONS.
- 6.) ALL MATERIAL REMOVED SHALL BE PROPERLY AND LEGALLY DISPOSED OF.
- 7.) FIELD VERIFY ALL DIMENSIONS AND EXISTING CONDITIONS.
- 8.) NEW INSULATION TO BE LOOSE LAID TO COMPLY WITH ROOFING MANUF. RECOMMENDATIONS.
- 9.) NEW EPDM .060 REINFORCED MEMBRANE TO BE MECHANICALLY FASTENED TO COMPLY WITH ROOFING MANUF. RECOMMENDATIONS.
- 10.) NEW EPDM .060 REINFORCED MEMBRANE SHALL BE COLOR: WHITE
- 11.) CONTRACTOR TO PROVIDE A 15 YEAR TOTAL ROOFING SYSTEM WARRANTY INCLUDING: INSULATION, MEMBRANE, FLASHING, ADHESIVES, FASTENERS, ETC. WARRANTY TO BE PROVIDED BY PRIMARY MANUFACTURER.

AGENCY OF TRANSPORTATION  
RUTLAND 5 BAY GARAGE  
REROOF PLAN & DETAILS



STATE OF VERMONT  
Department of Buildings  
and General Services  
Agency of Administration  
Montpelier, Vermont



REVISIONS

SCALE: AS SHOWN  
DATE: JULY, 2001  
DRAWN BY: N. HERSEY  
APPR. BY: R. BARRY

AOT GARAGE

RUTLAND  
5 BAY GARAGE

REROOF DETAILS

R-1

1 OF 1