

STATE OF VERMONT  
AGENCY OF TRANSPORTATION  
**SALT AND SAND SHED**  
MENDON, VERMONT

MAY 8, 1995

AGENCY OF ADMINISTRATION  
DEPARTMENT OF STATE BUILDINGS  
2 GOVERNOR AIKEN AVENUE  
MONTPELIER, VERMONT 05602  
JOHN J. ZAMPIERI, COMMISSIONER

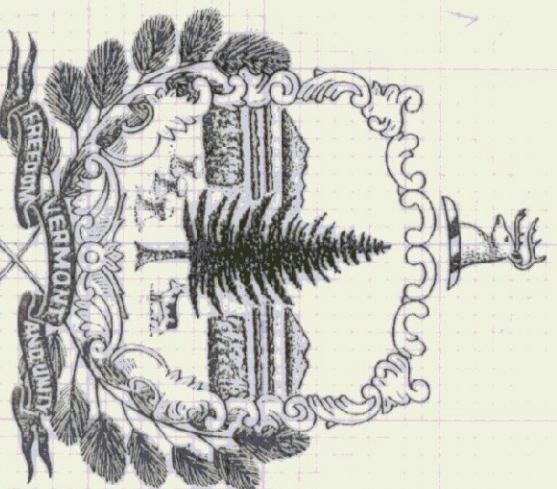

GOVERNOR HOWARD DEAN

AGENCY OF TRANSPORTATION  
133 STATE STREET  
MONTPELIER, VERMONT 05602  
PATRICK J. GARAHAN, SECRETARY

INDEX OF DRAWINGS:  
S-1 SITE PLAN  
A-1 PLANS, ELEVATIONS,  
SECTIONS & DETAILS

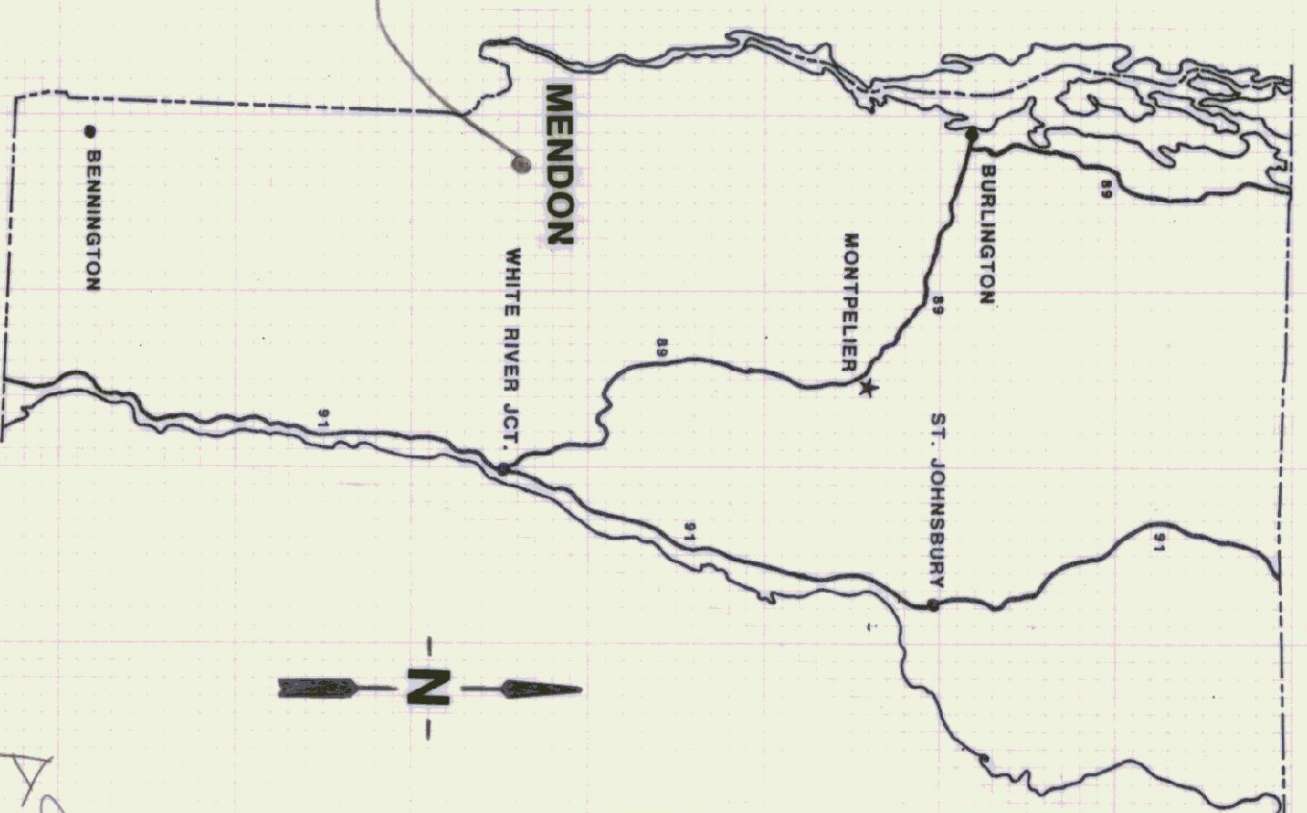
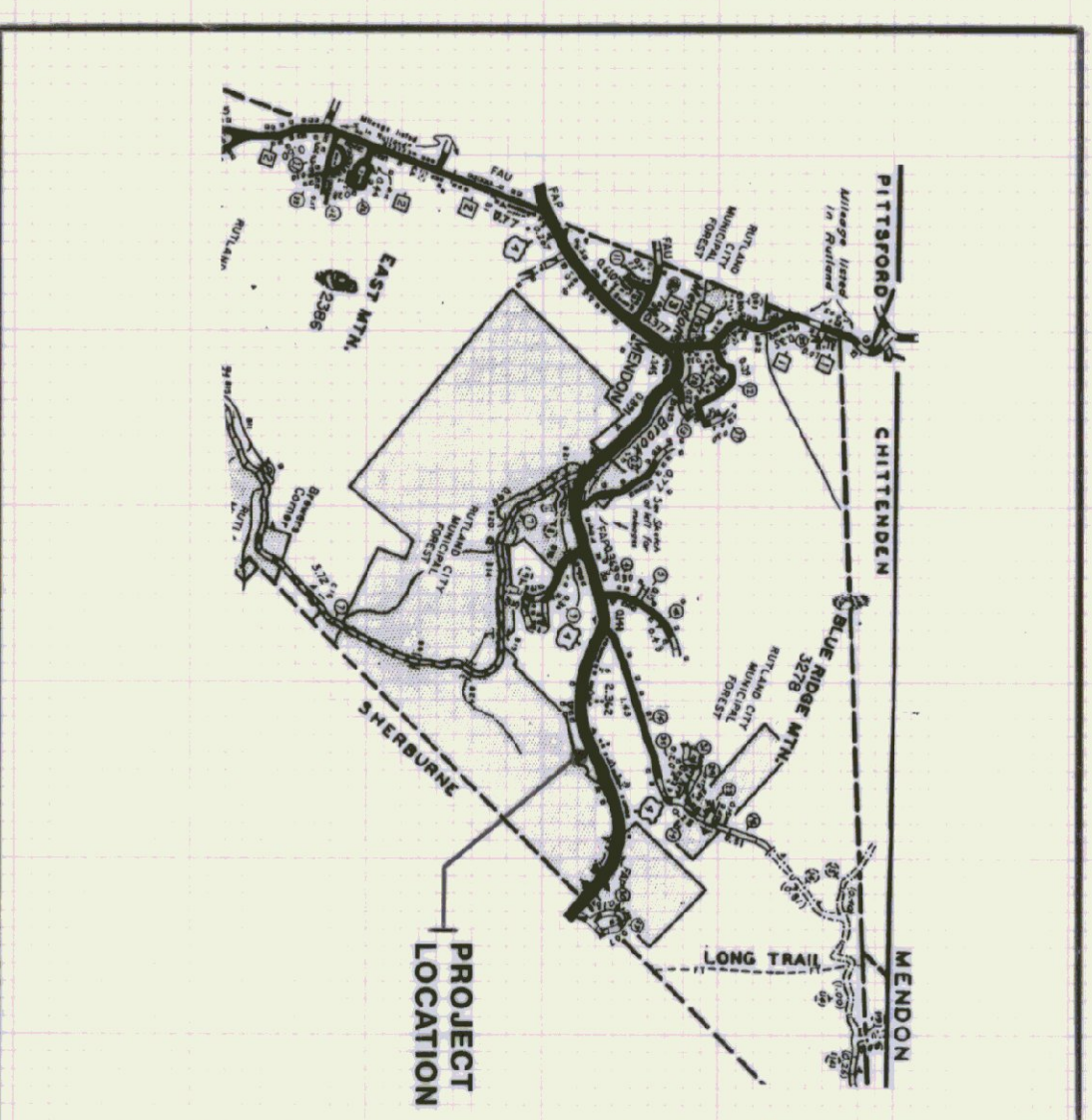

AS BUILT



NOTES:  
 1) SITE WORK WILL BE PREPARED BY  
 MONT PELIER TO SCHEDULE WORK.  
 2) SEE NOTE ON SHEET A-1 FOR EROUND  
 & BASTEN FOUND.

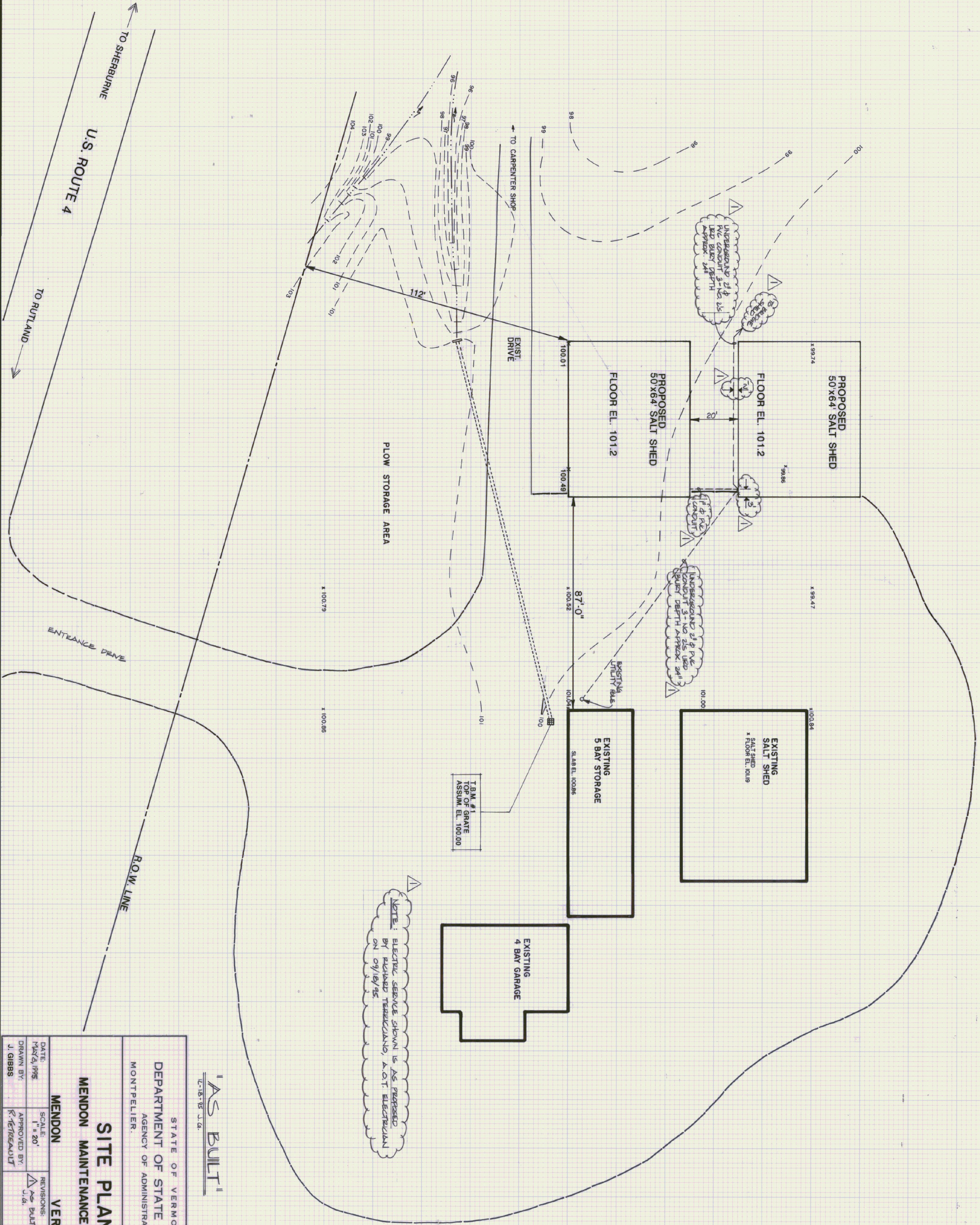

NOTE: ELECTRICAL SERVICE SHOWN IS AS PROPOSED BY RICHARD TERRELLANO, A.O.T. ELECTRICIAN ON 09/16/75

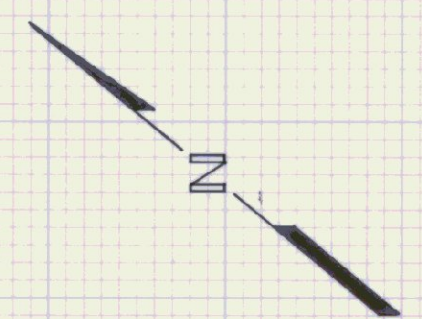

"AS BUILT"

STATE OF VERMONT  
 DEPARTMENT OF STATE BUILDINGS  
 AGENCY OF ADMINISTRATION  
 MONTPELIER, VERMONT

**SITE PLAN**  
**MENDON MAINTENANCE FACILITY**

DATE May 2, 1975	SCALE 1" = 20'	REVISIONS AS BUILT 4/1/75	DWG. NO. S-1
DRAWN BY J. GIBBS	APPROVED BY K. TERRELLANO		1 OF 2



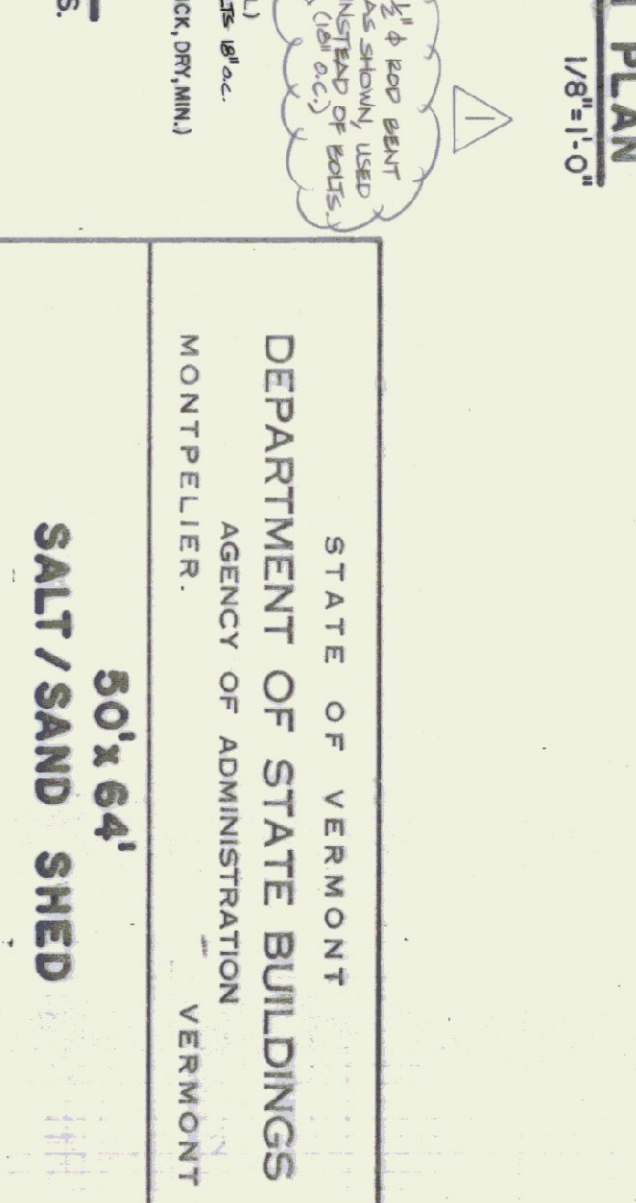
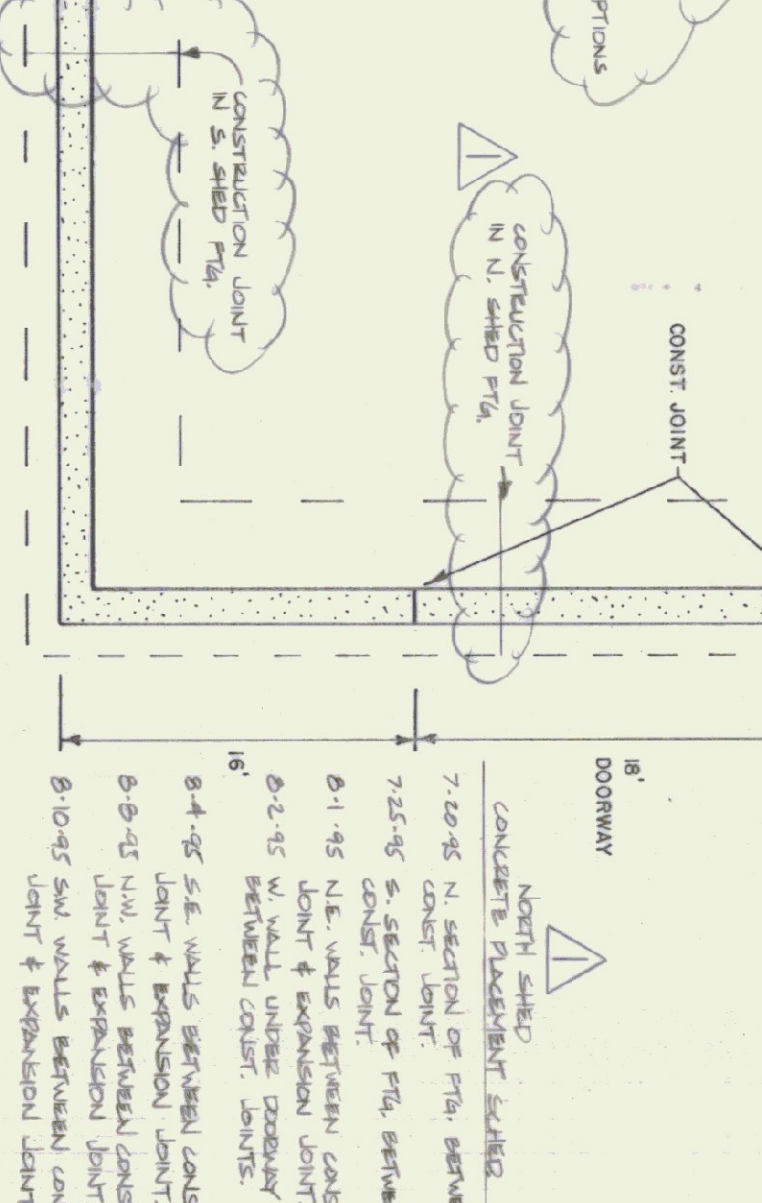
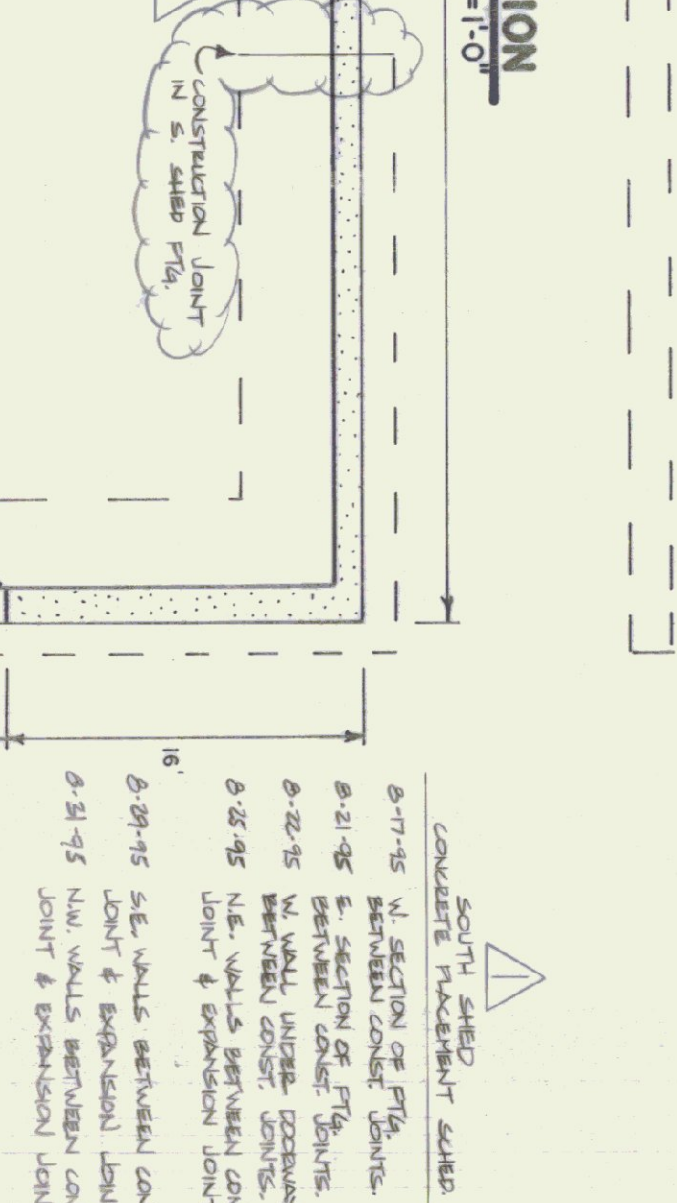
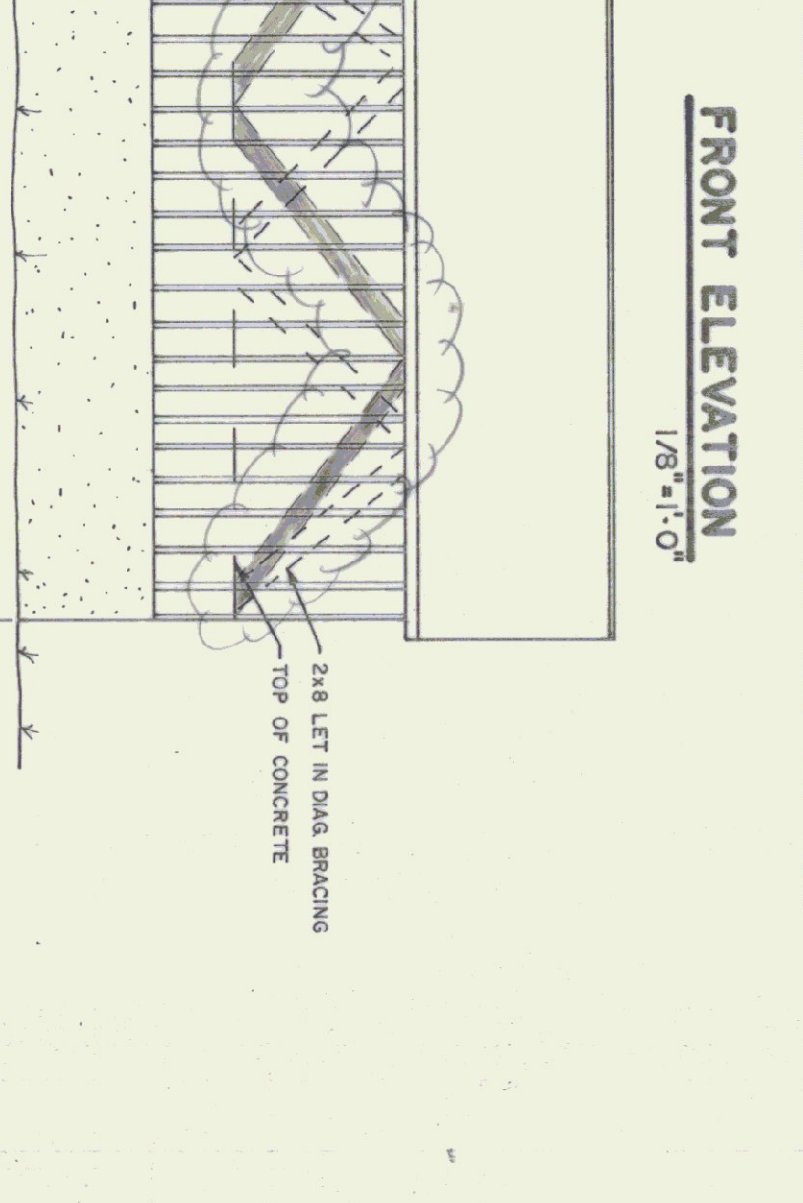
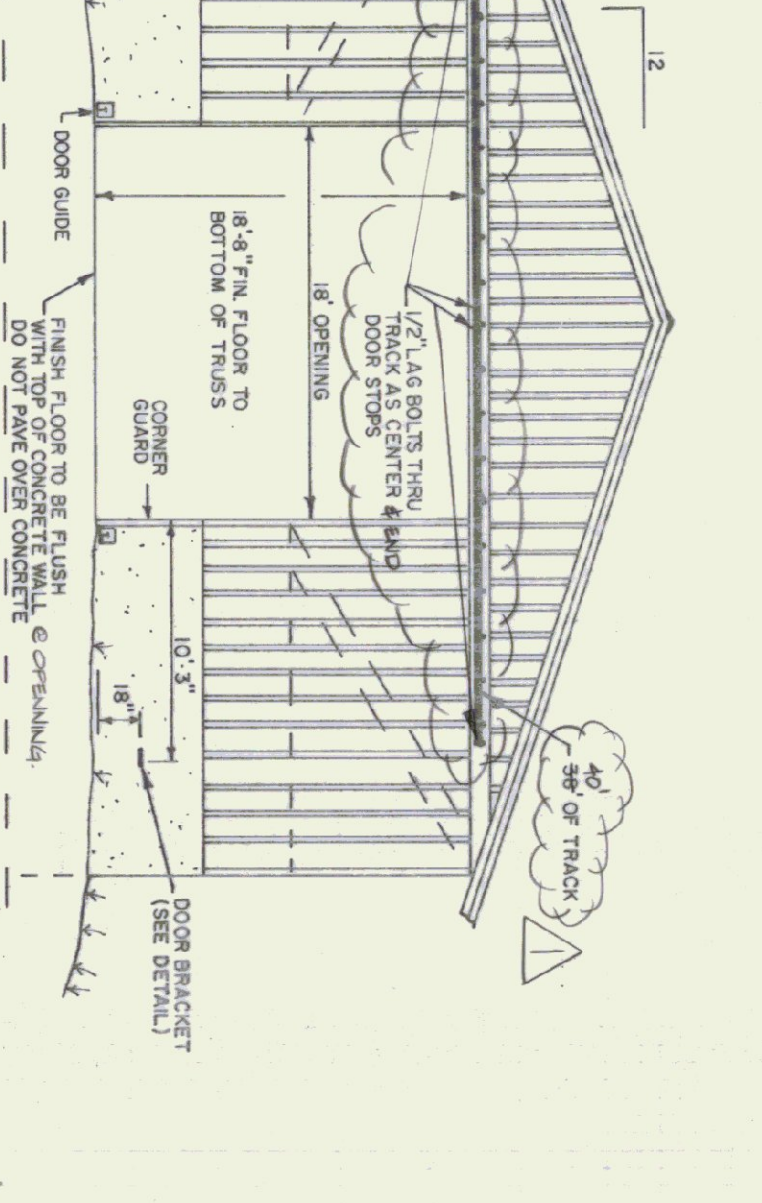
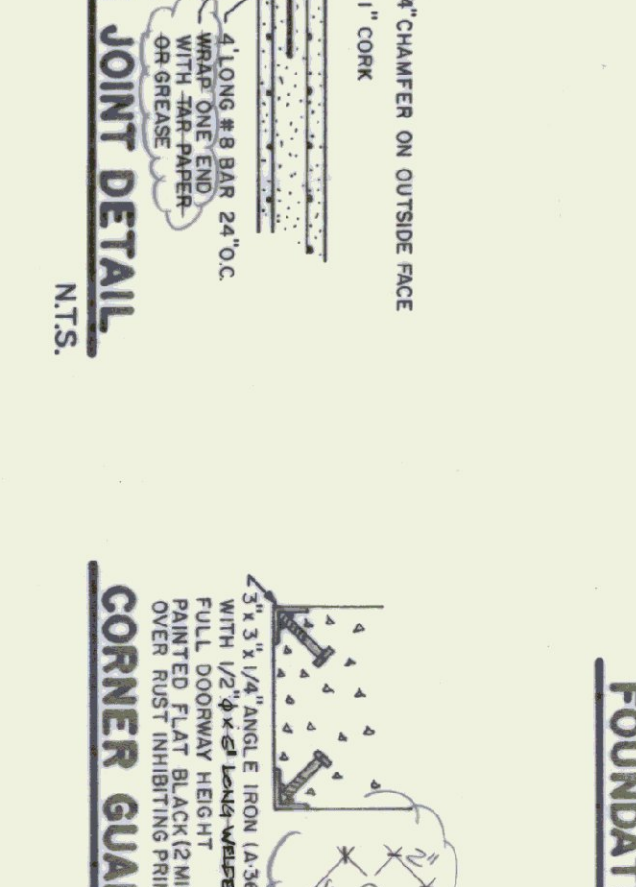
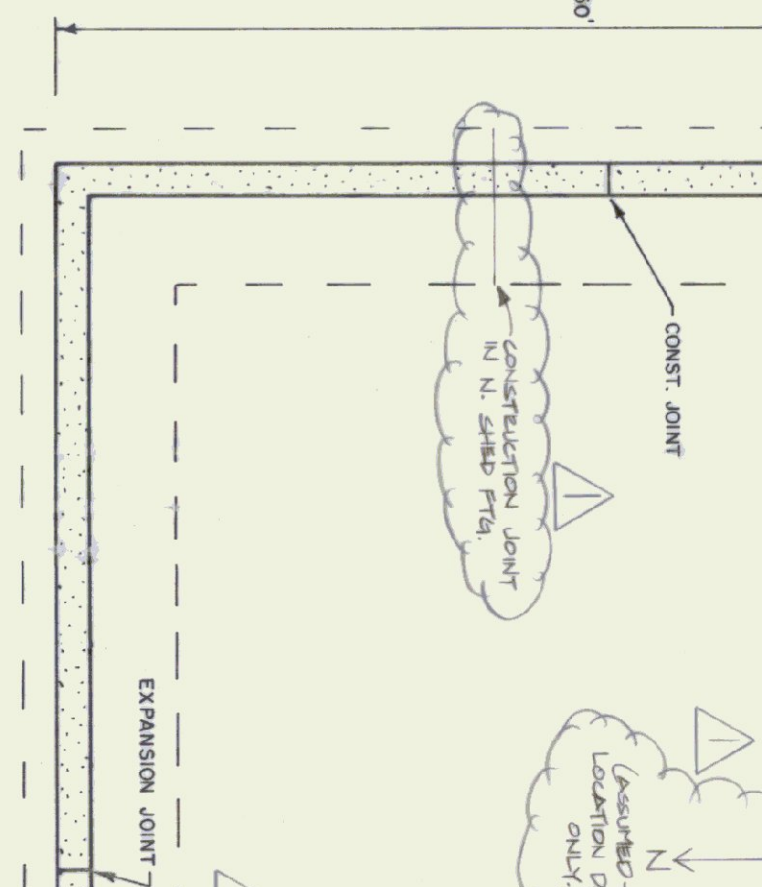
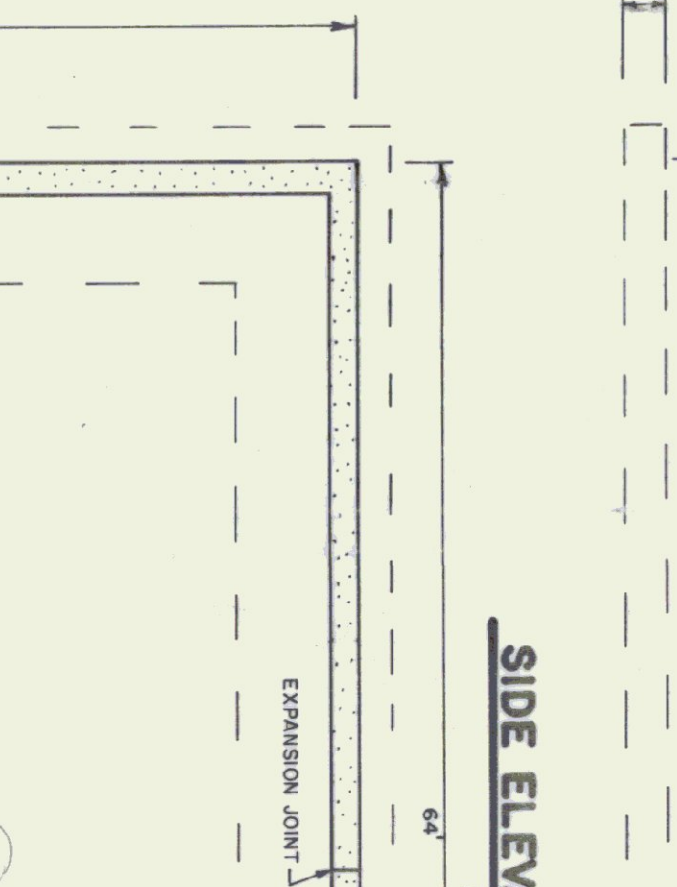
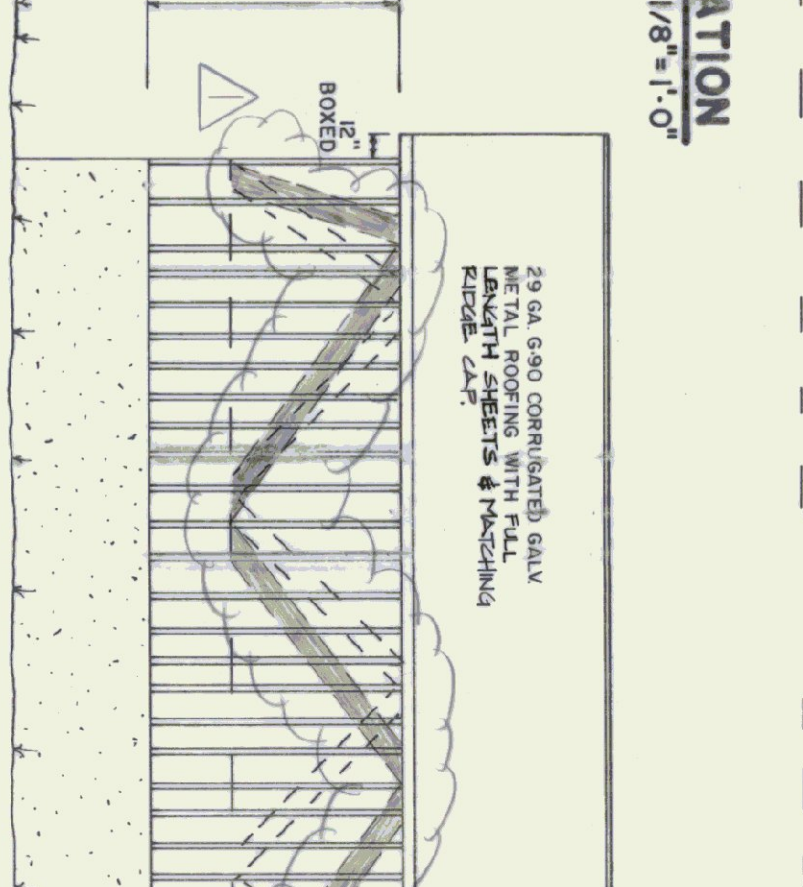
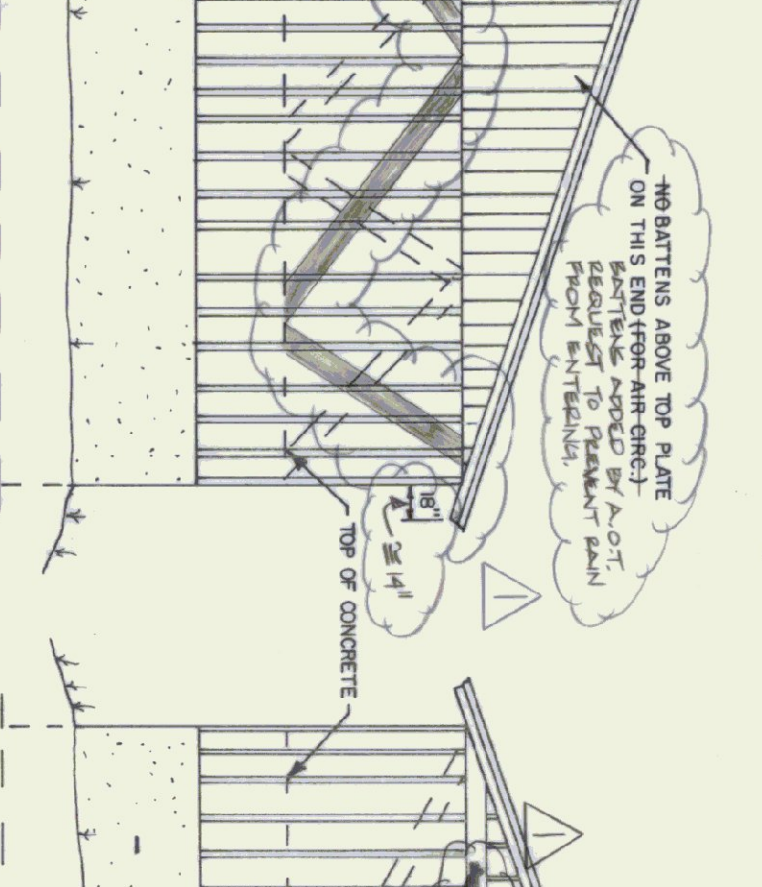
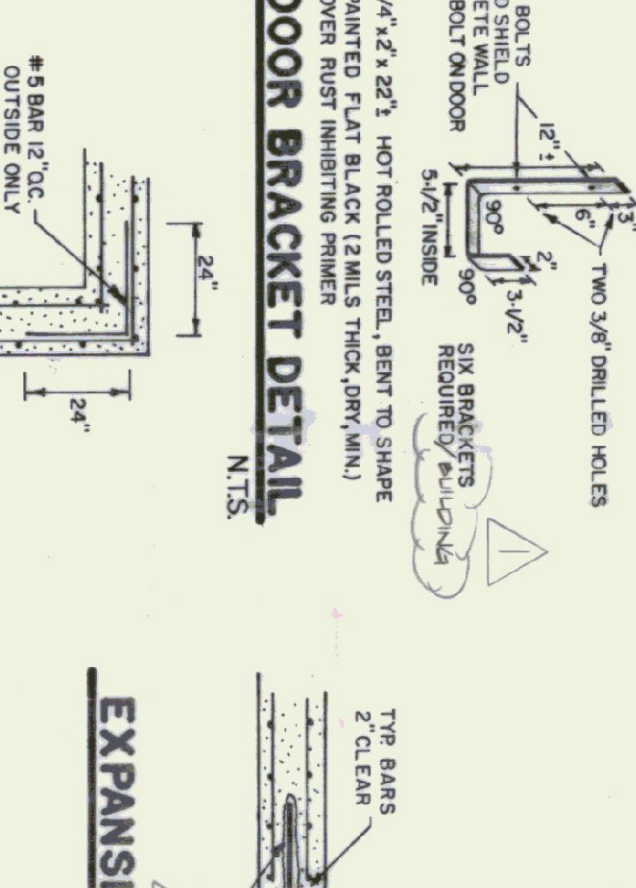
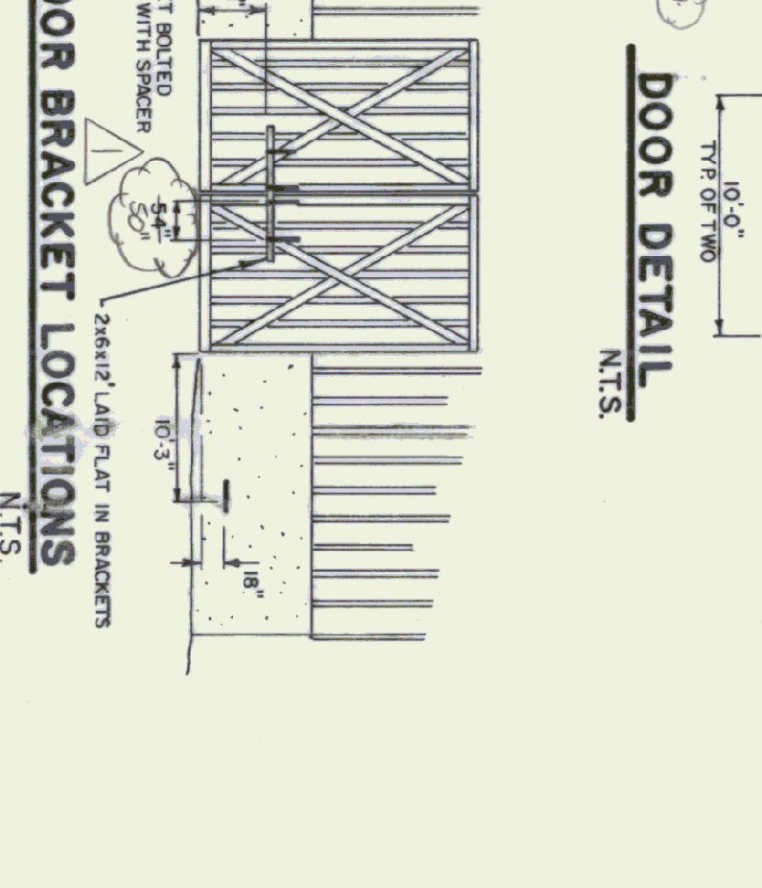
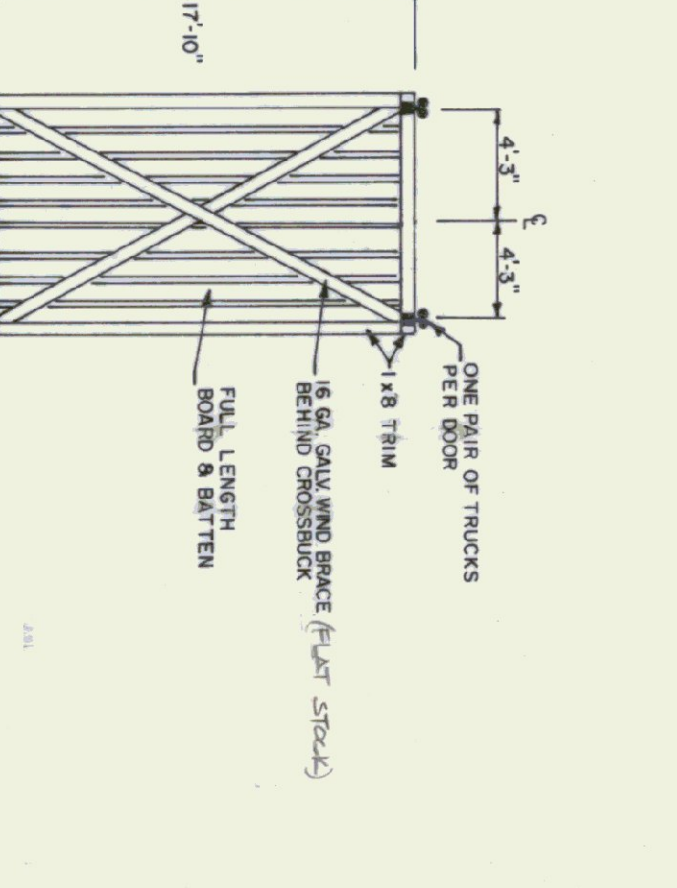
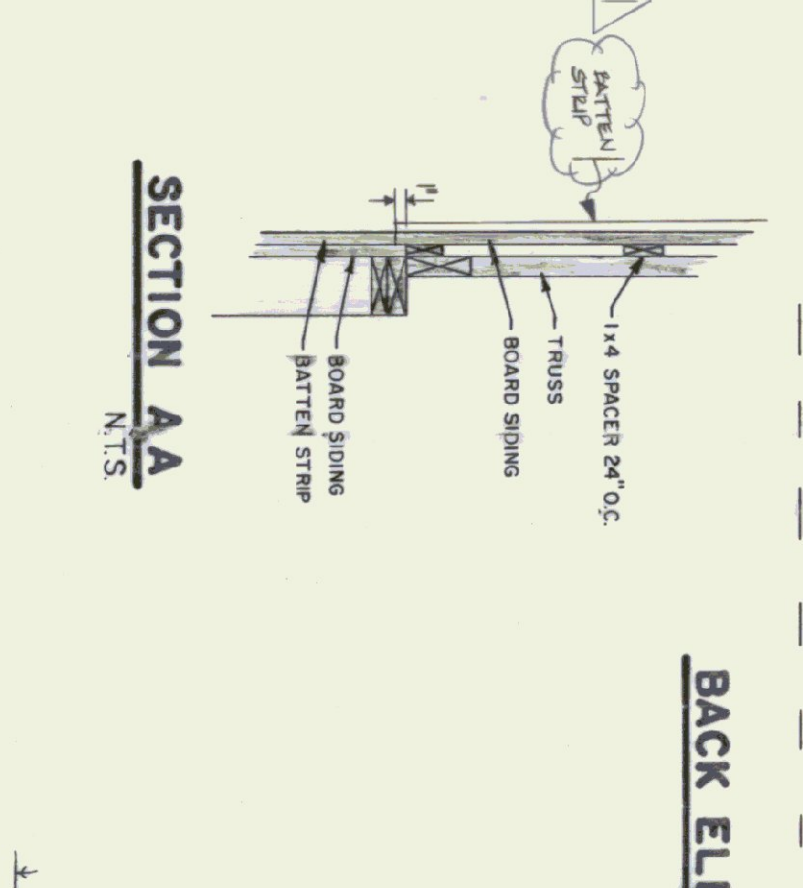
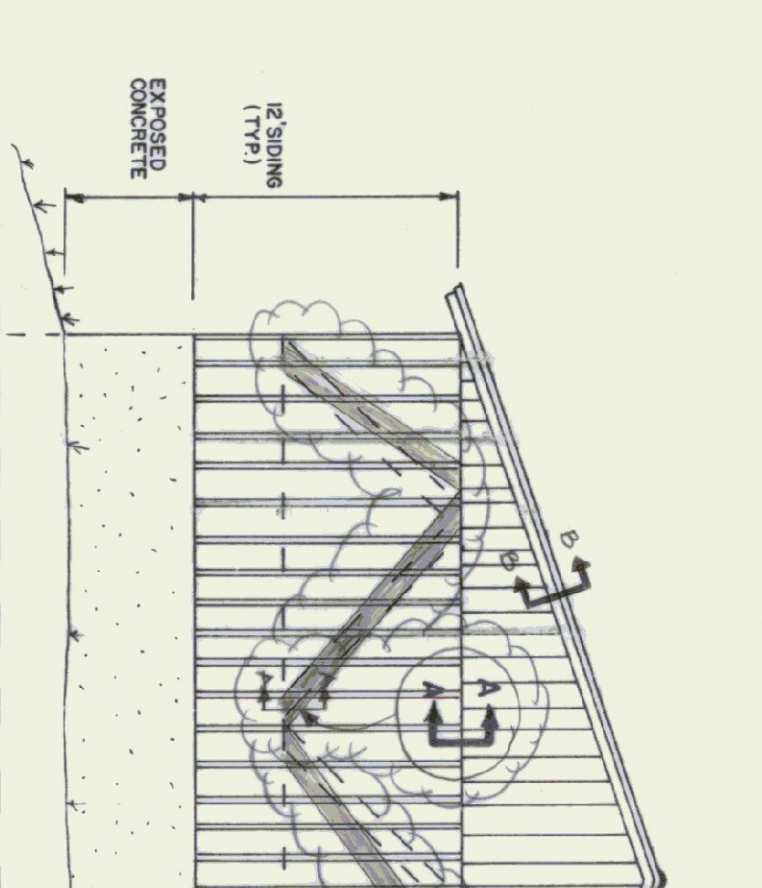
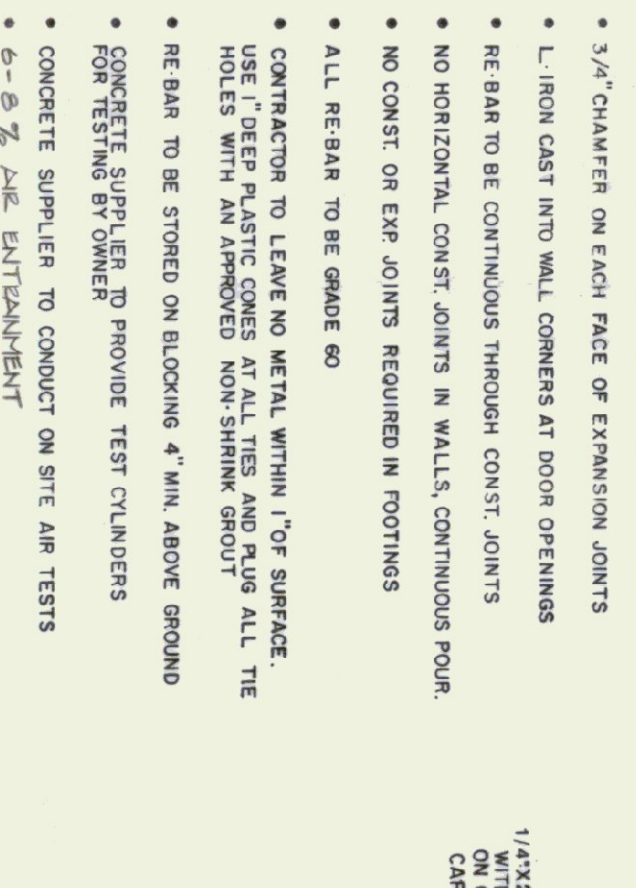
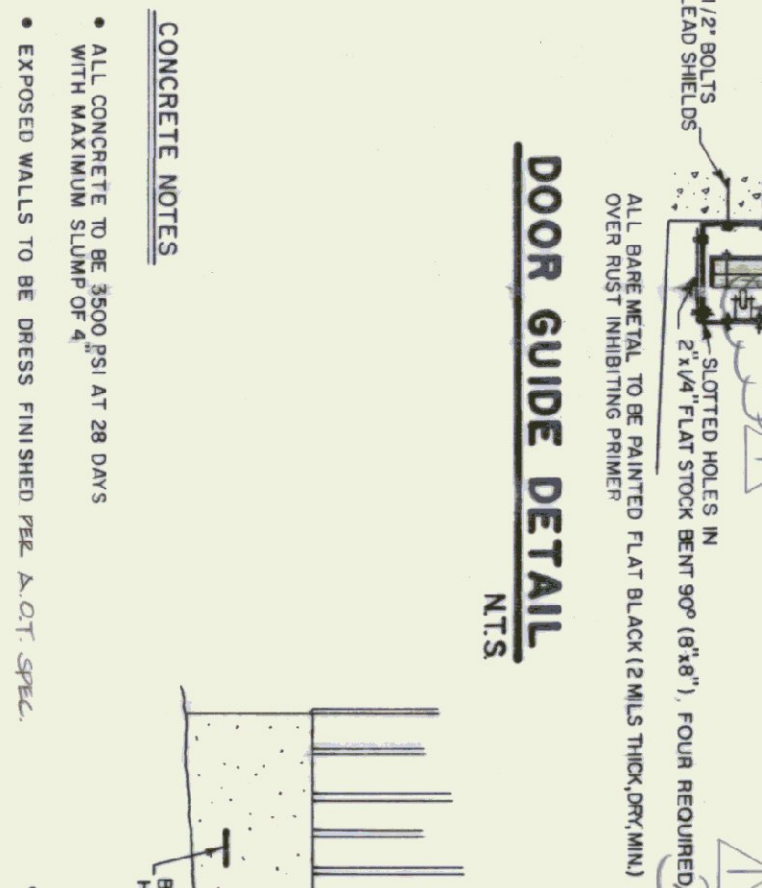
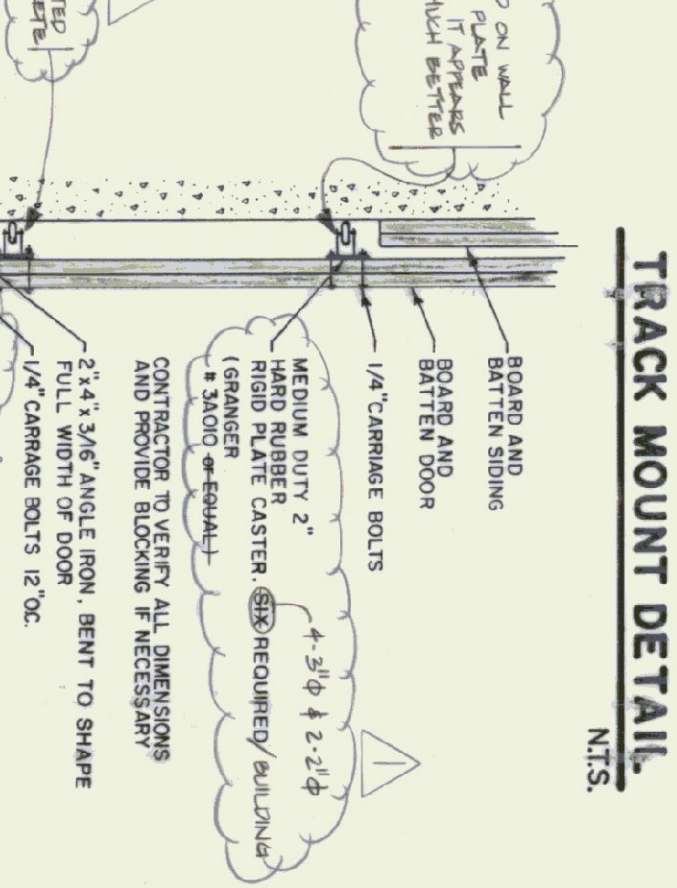
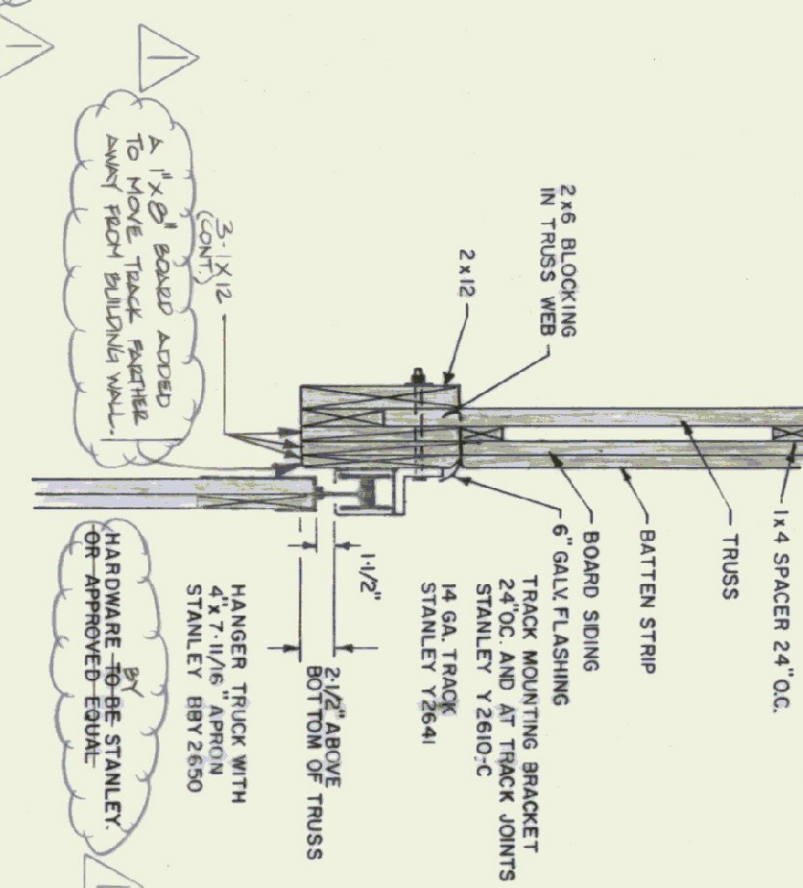
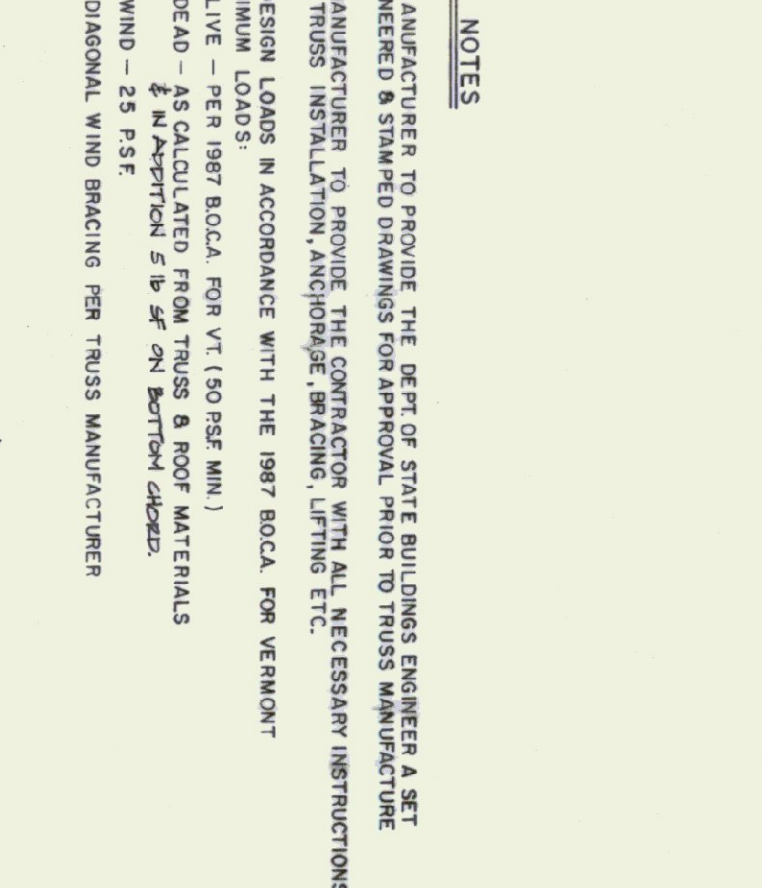
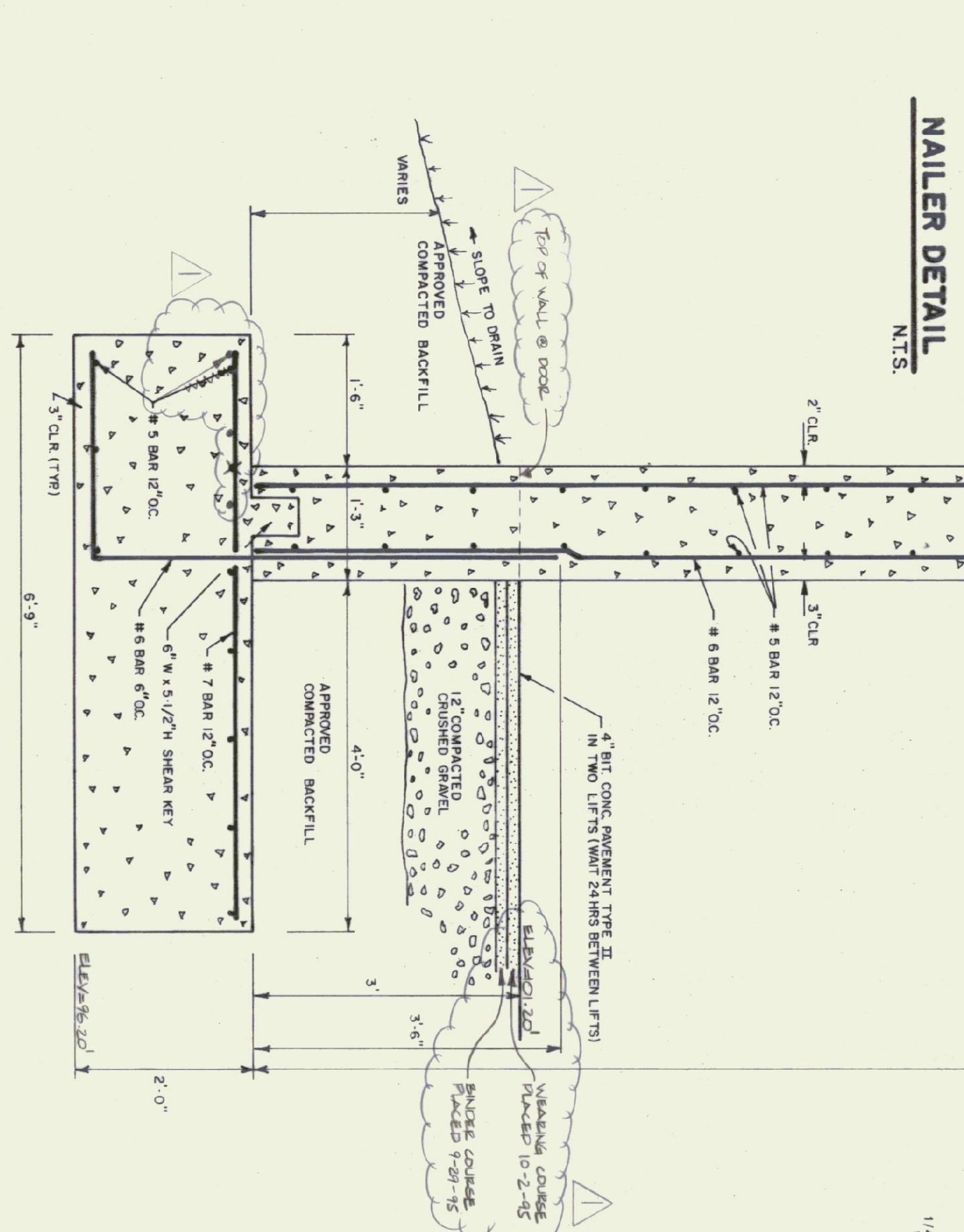
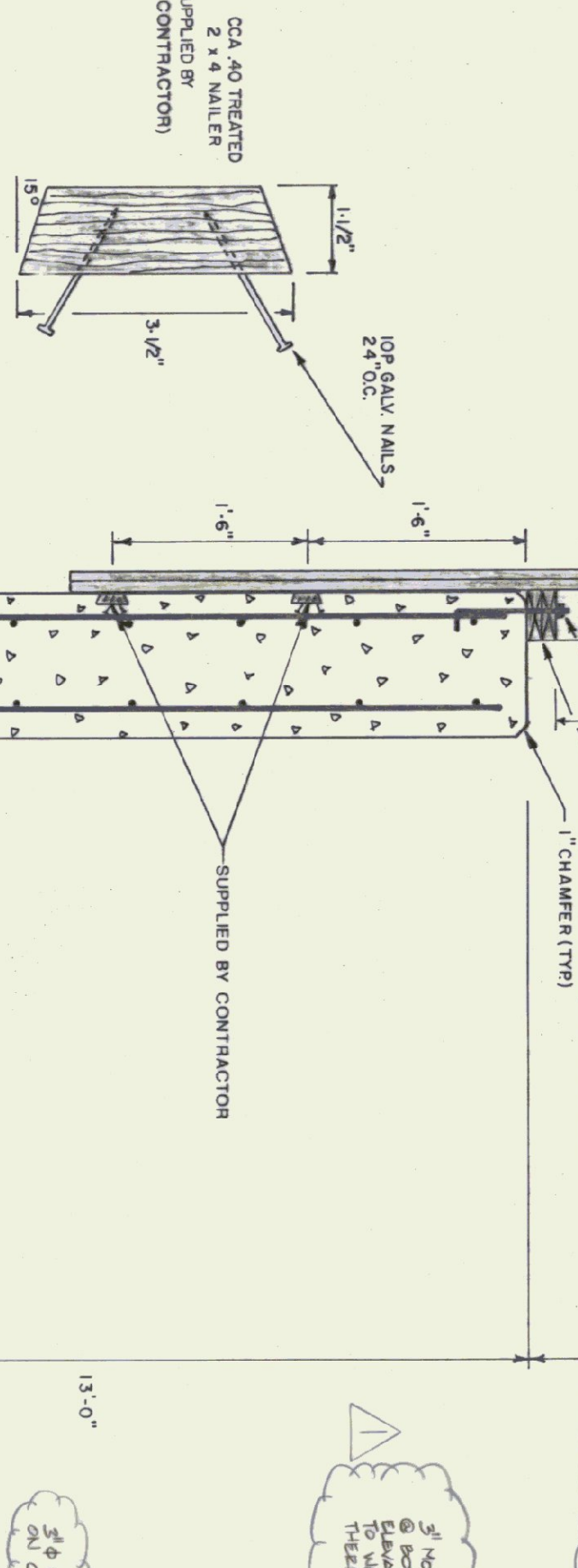
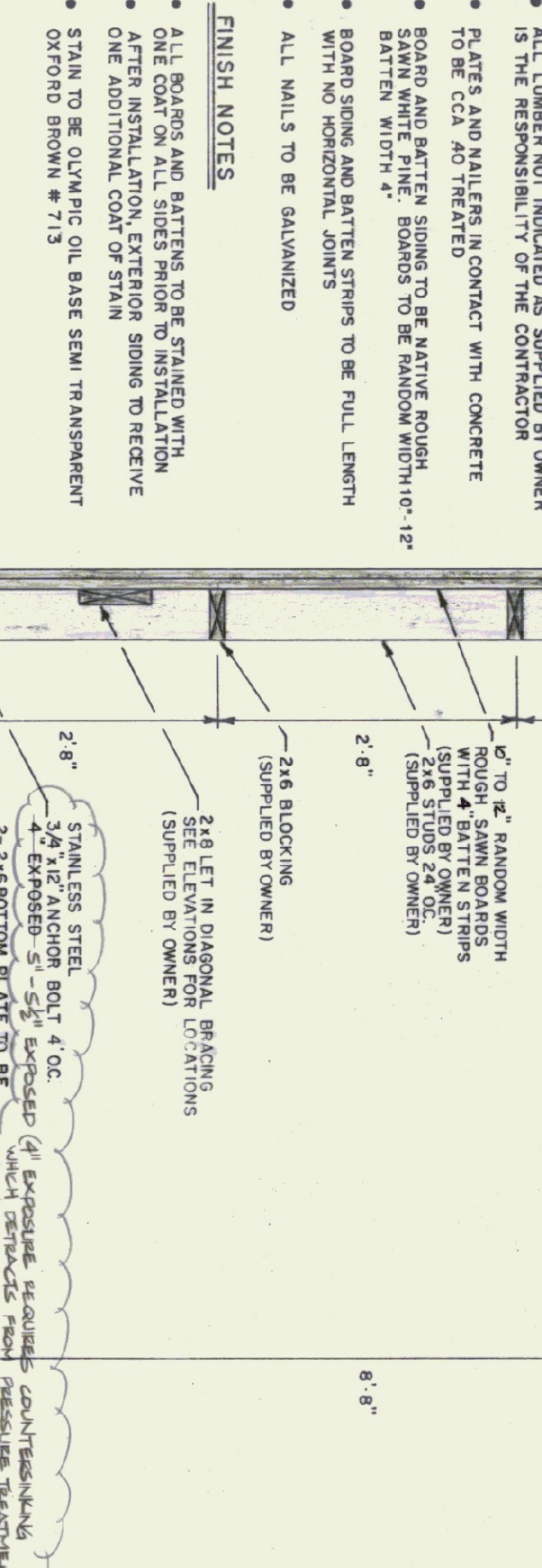
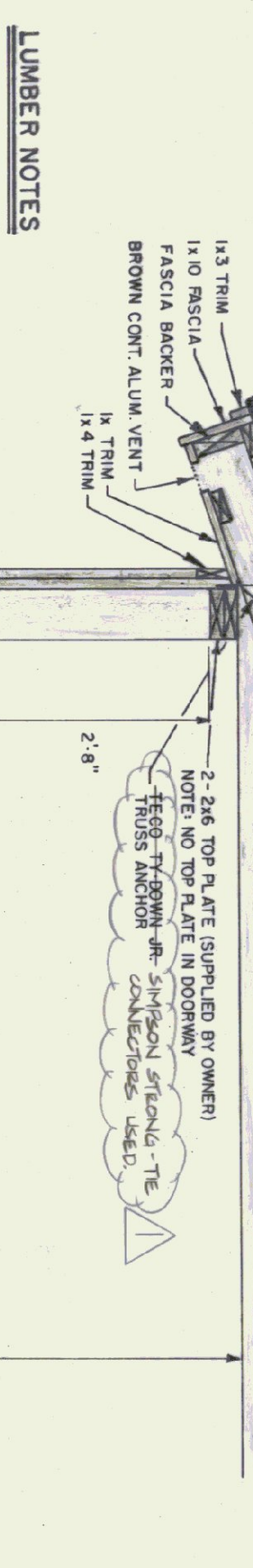
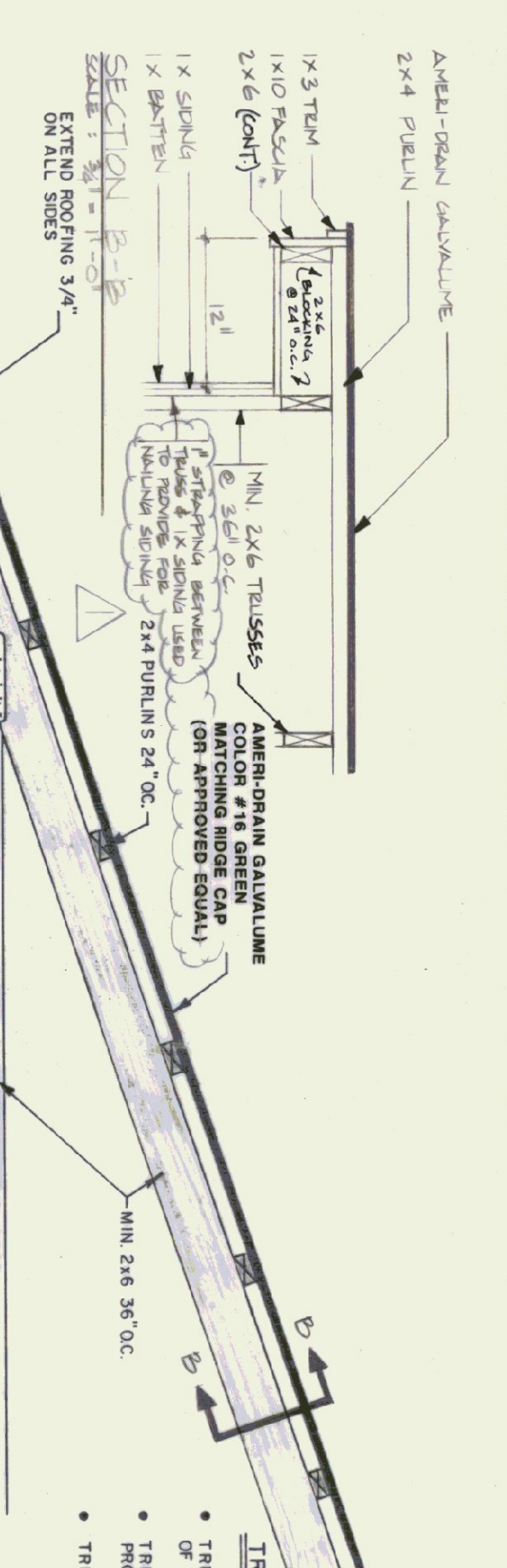

STATE OF VERMONT  
DEPARTMENT OF STATE BUILDINGS  
AGENCY OF ADMINISTRATION  
VERMONT

50' x 64'  
SALT/SAND SHED

DATE: 11/21/95  
SCALE: AS NOTED  
DRAWN BY: J. CARRE  
APPROVED BY: J. CARRE

REVISIONS:  
3-24-94 V.B.  
12-08-95 J.C.A.

MEMPHIS  
VERMONT  
DWG. NO. A-1  
2 OF 2