

5 Spacing @ 16' 8" = 83'-4"

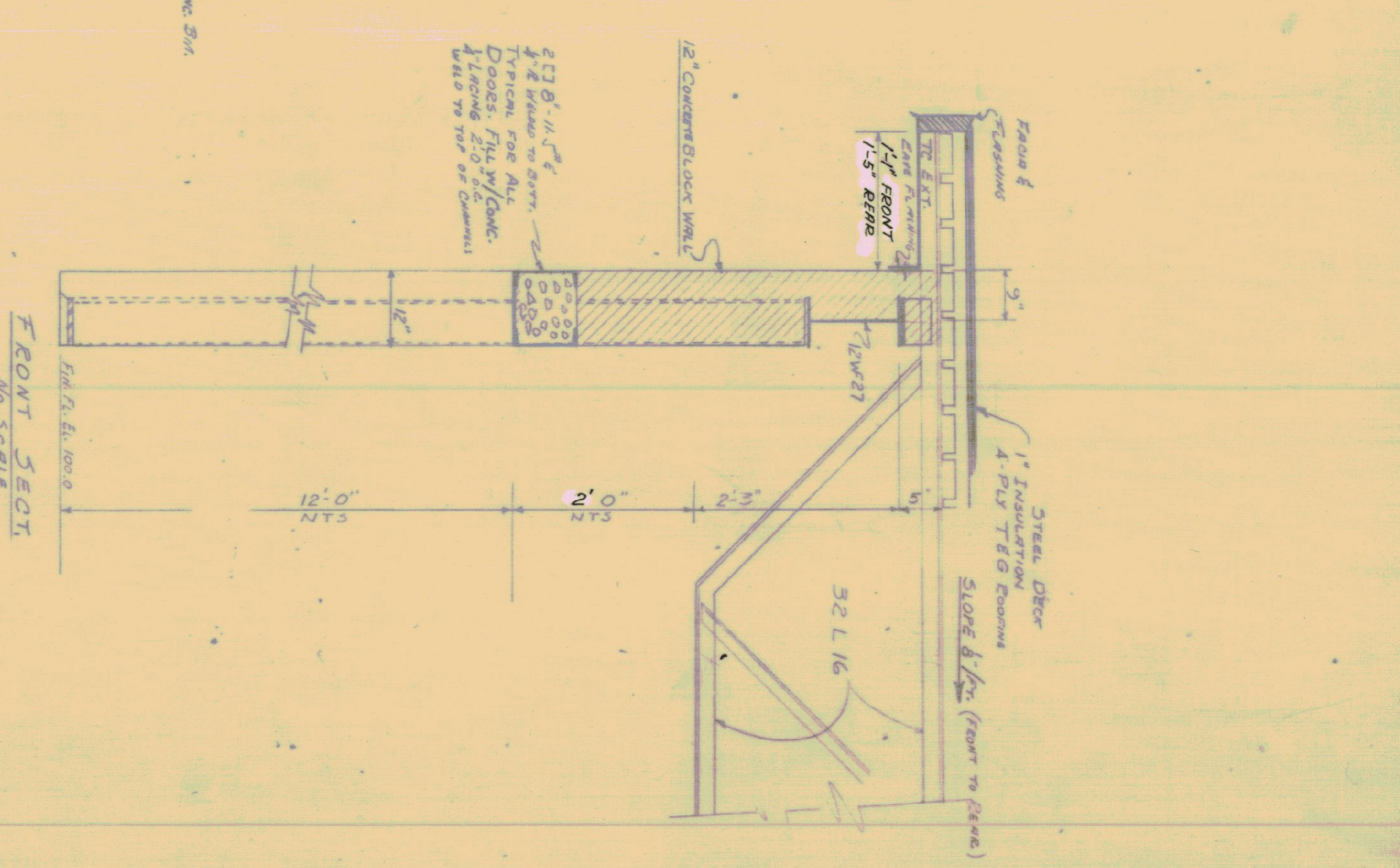
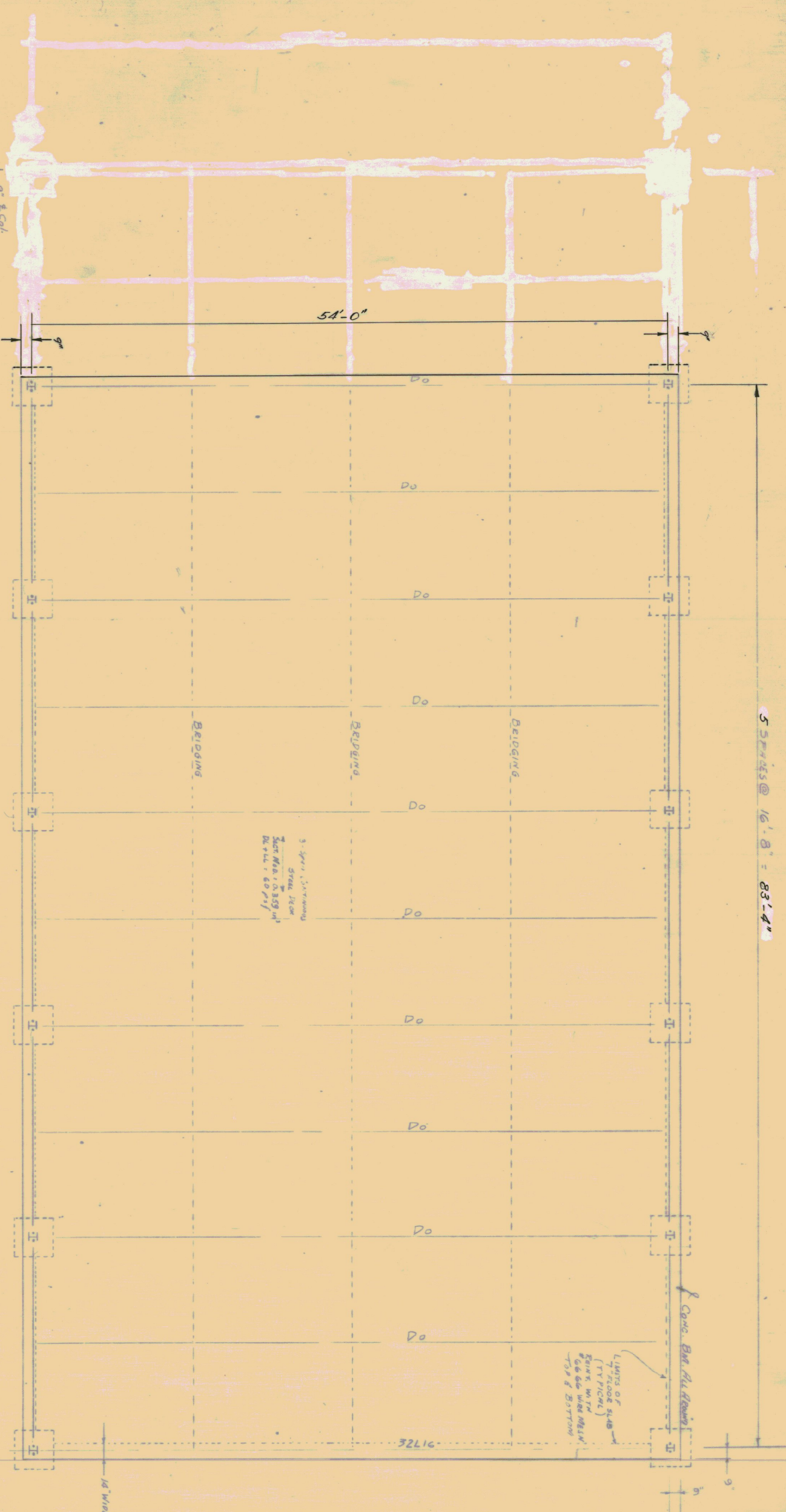

FRONT SECT
1/8" SCALE

FIN. FLOOR ASSUMED EL. 100.0
PLAN
SCALE 1/8" = 1'-0"

TYPICAL FRONT
SCALE 1/4" = 1'-0"

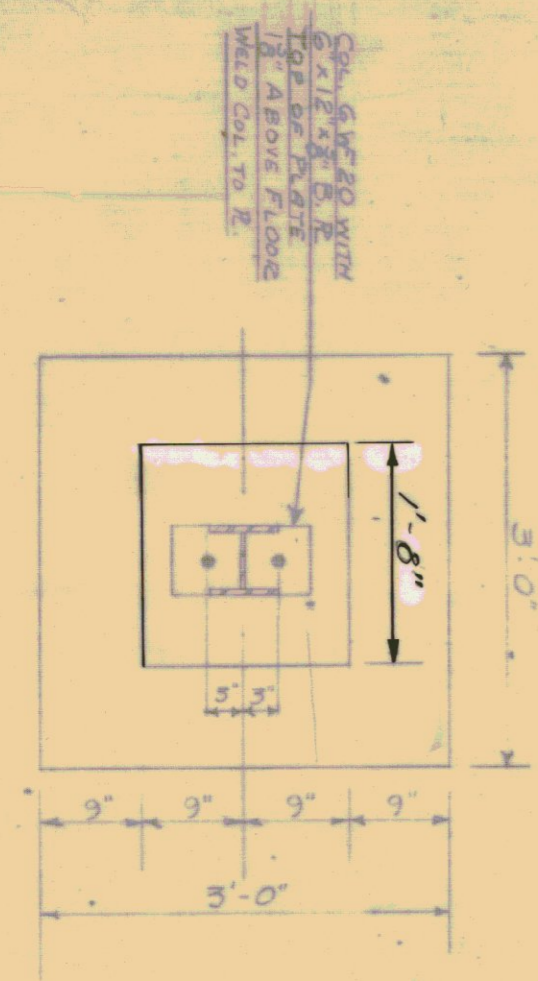

- REINFORCING STEEL
- 4 #7 @ 5'-0" END BM.
 - 6 #6 @ 5'-0" END BM.
 - 4 #7 @ 25'-0" END BM.
 - 6 #7 @ 25'-0" END BM.
 - 16 #7 @ 21'-0" END BM.
 - 24 #6 @ 21'-0" END BM.
 - 4 #7 @ 24'-0" END BM.
 - 6 #6 @ 24'-0" END BM.
- SIDE BMS 2" x 24" x 21'-8"
- ALL LAPS 2'-0"

TYPICAL FOOTING
SCALE 3/4" = 1'-0"

STRUCTURAL SHOP DRAWINGS ARE TO BE APPROVED BY THE ENGINEER BEFORE FABRICATION IS BEGUN

STATE OF VERMONT
HIGHWAY DEPARTMENT
GARAGE FOR DISTRICTS NOS. 3 & 6
CASTLETON
MORRISVILLE
DESIGN BY: FENASSO
OCTOBER 1958
REV. MAY 20, 1964
G.H. PORCE

Rev. Jan. 10, 1959