

STATE OF VERMONT
AGENCY OF TRANSPORTATION
SALT AND SAND SHEDS
ROCKINGHAM, VERMONT

JUNE 8, 1992

AGENCY OF ADMINISTRATION
DEPARTMENT OF STATE BUILDINGS
2 GOVERNOR AIKEN AVENUE
MONTPELIER, VERMONT 05602
JOHN J. ZAMPIERI, COMMISSIONER

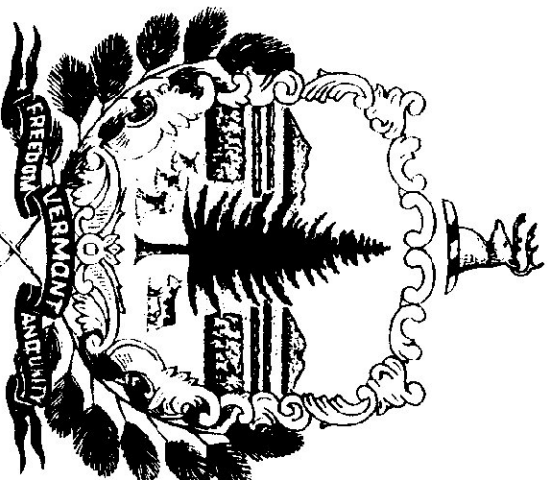

GOVERNOR HOWARD DEAN

AGENCY OF TRANSPORTATION
133 STATE STREET
MONTPELIER, VERMONT 05602
PATRICK J. GARAHAN, SECRETARY

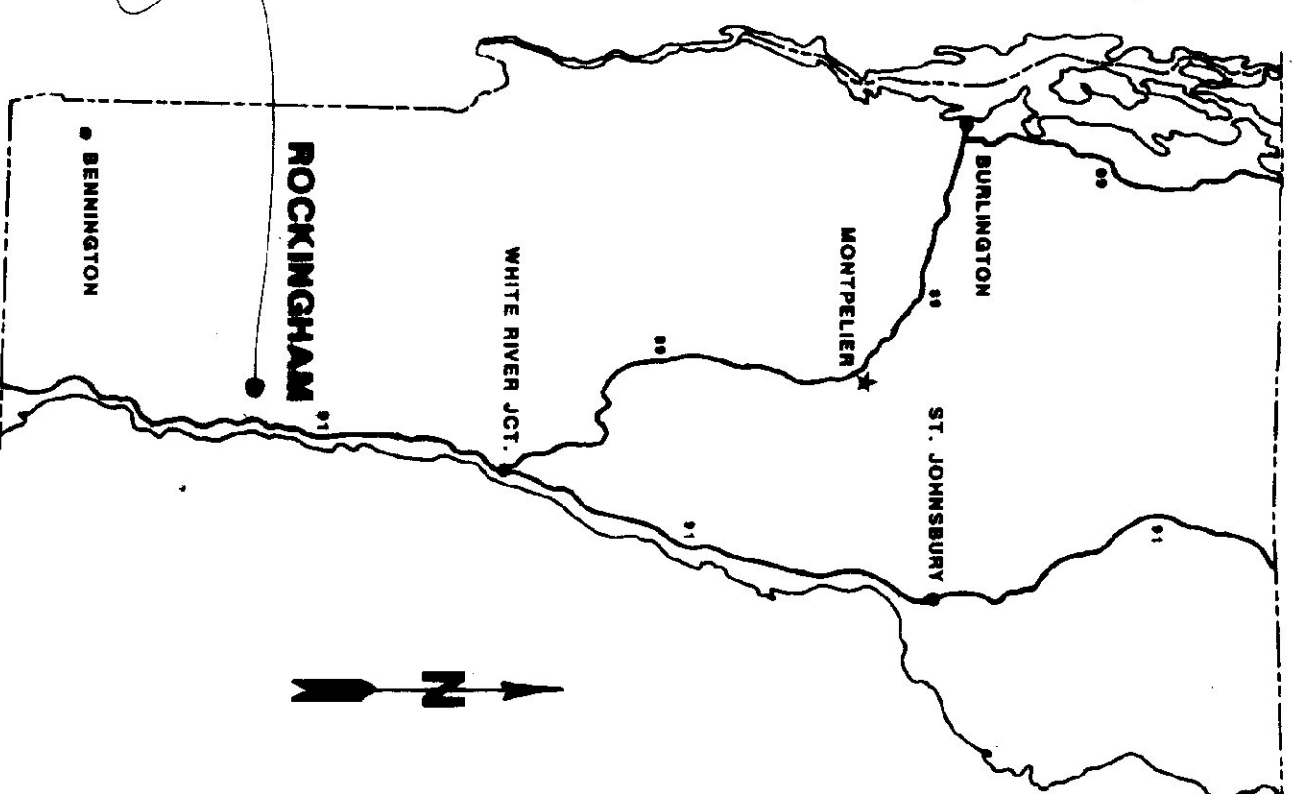
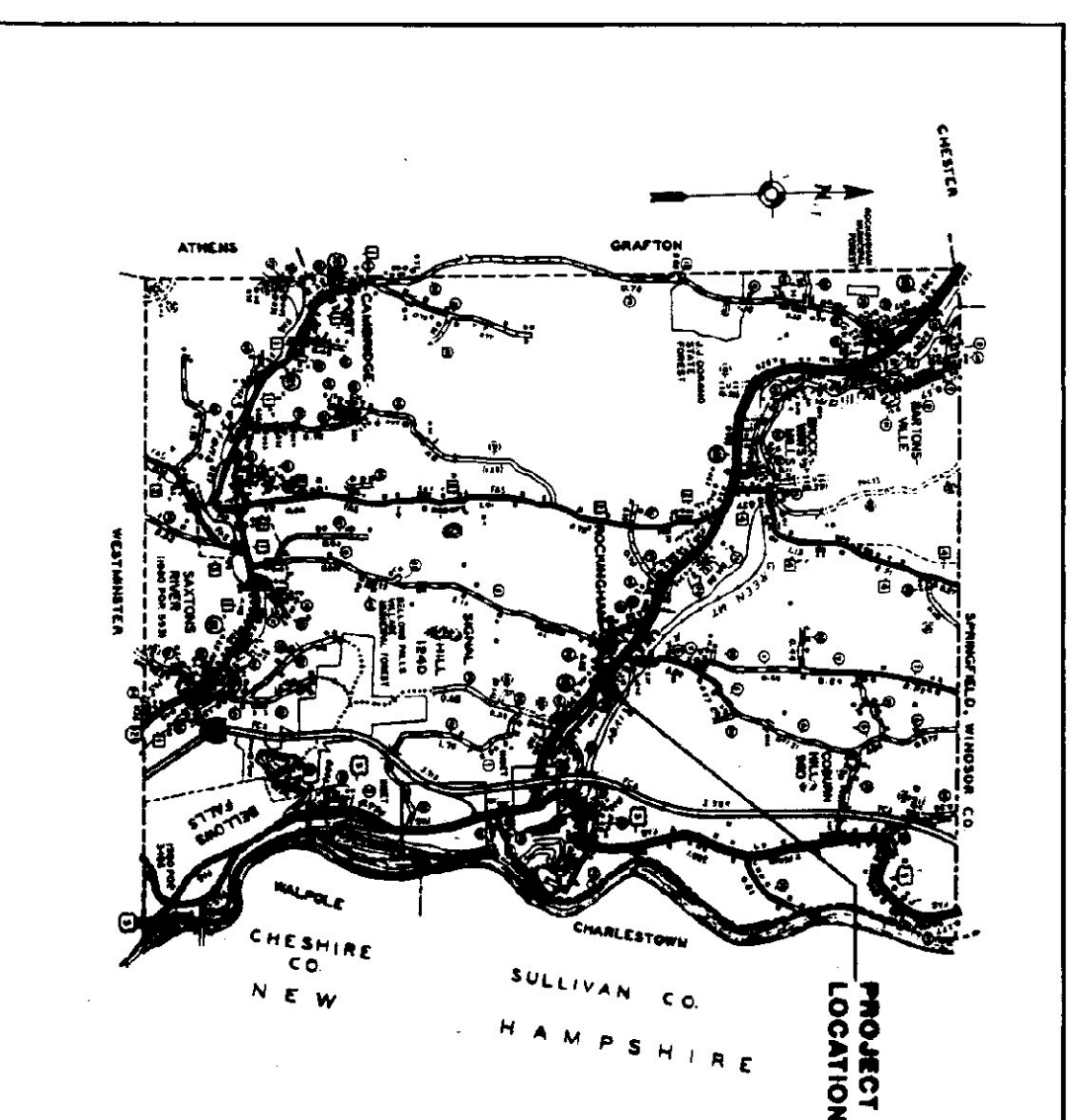

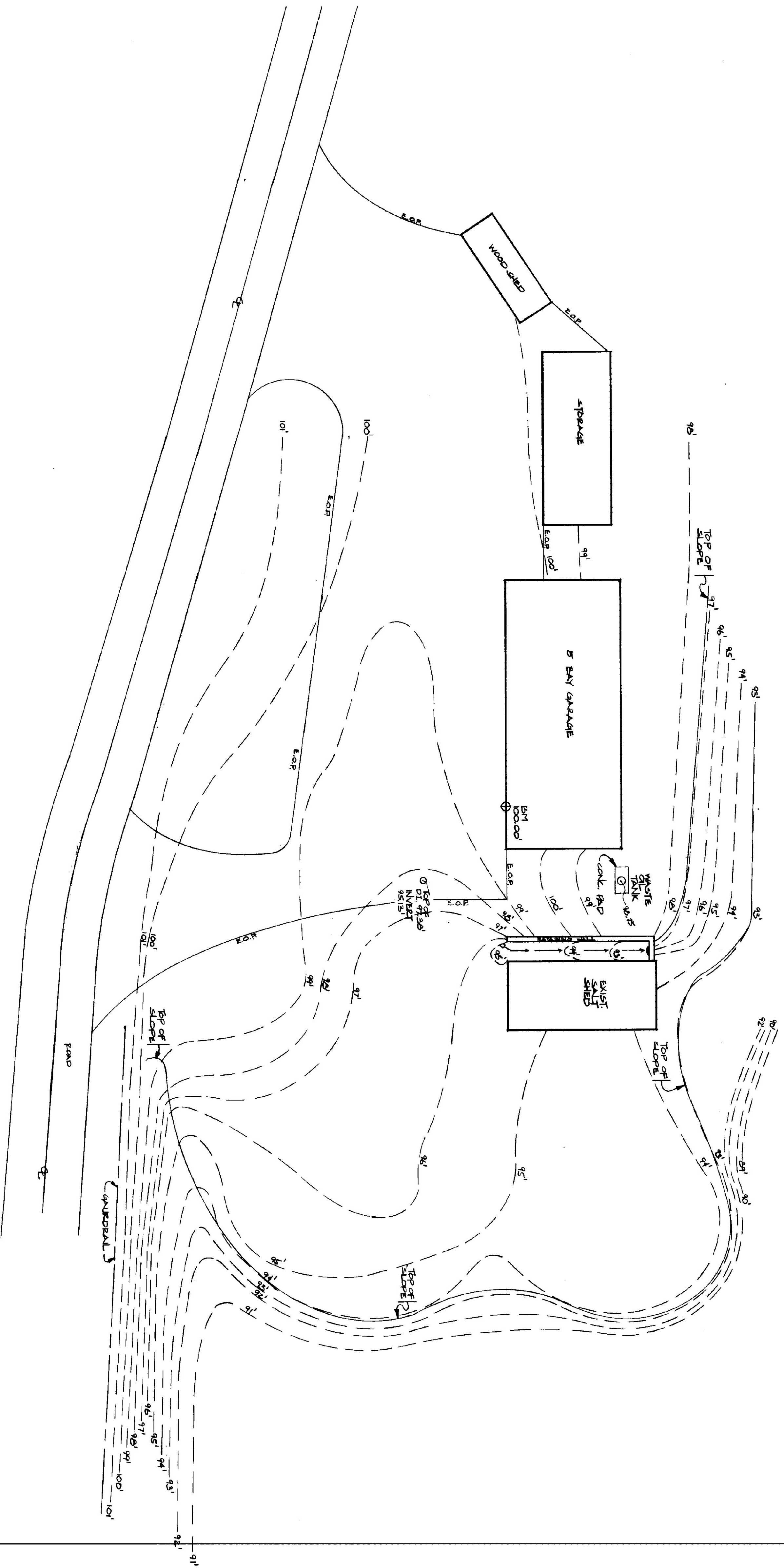
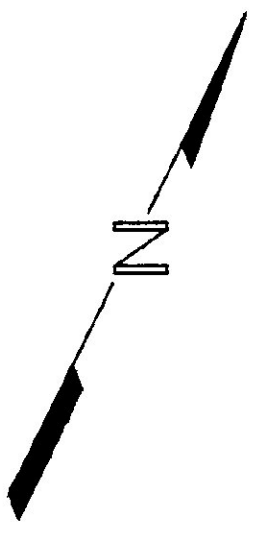

STATE OF VERMONT
DEPARTMENT OF STATE BUILDINGS
AGENCY OF ADMINISTRATION
MONTPELIER, VERMONT

ROCKINGHAM
HIGHWAY GARAGE
SITE PLAN

DATE	SCALE	REVISIONS	DWG. NO.
MARCH 1992	1" = 20' - 0"		S-1
DRAWN BY: J. CARROLL	APPROVED BY:		1 OF 1

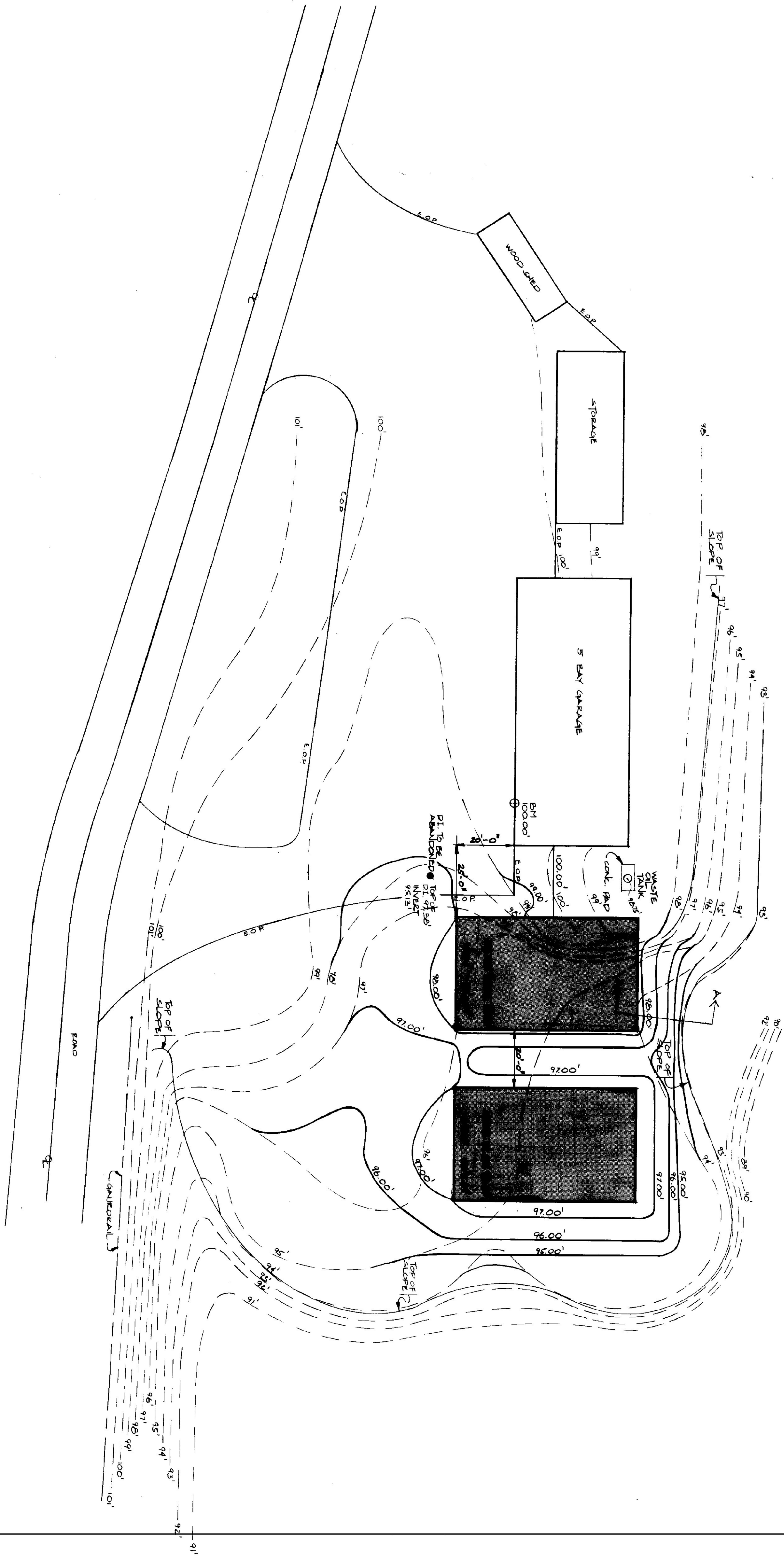
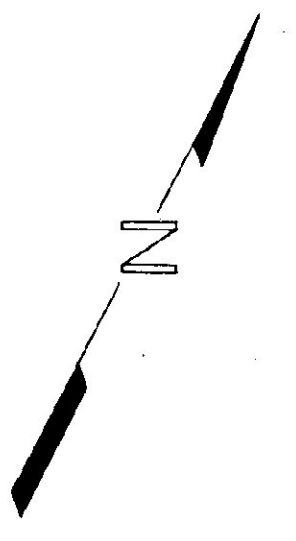

STATE OF VERMONT		VERMONT	
DEPARTMENT OF STATE BUILDINGS			
AGENCY OF ADMINISTRATION			
MONTPELLIER, VERMONT			
AGENCY OF TRANSPORTATION			
SAND/SALT SHEDS			
(2) 40' X 64'			
ROCKMORAN,	SCALE: 1" = 20'-0"	REVISIONS:	DWG. NO. S-1
DATE: 1992	DRAWN BY: J. GIBBS	APPROVED BY: [Signature]	1 OF 2

