

FOUNDATION PLAN
SCALE: 1/4" = 1'-0"

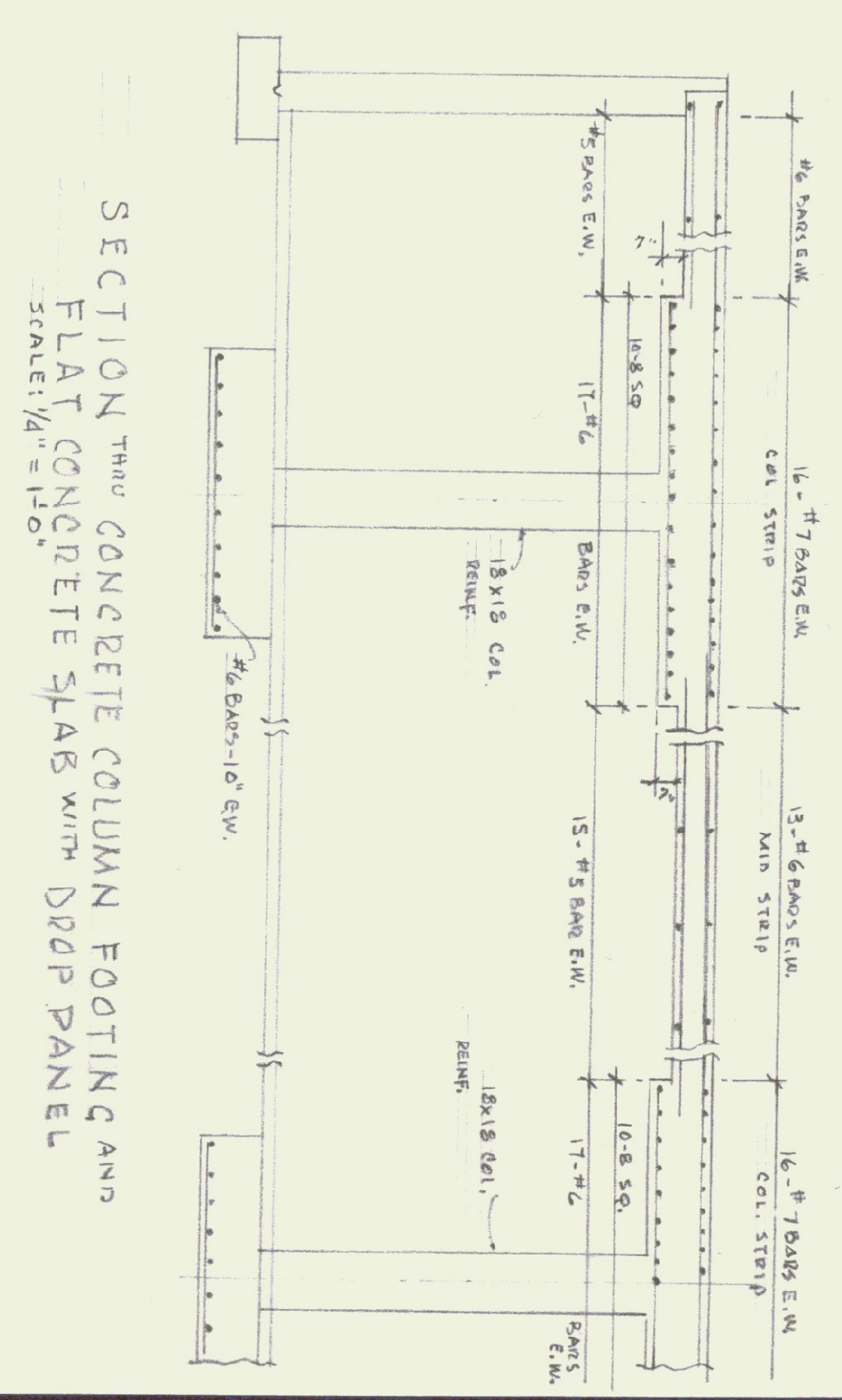
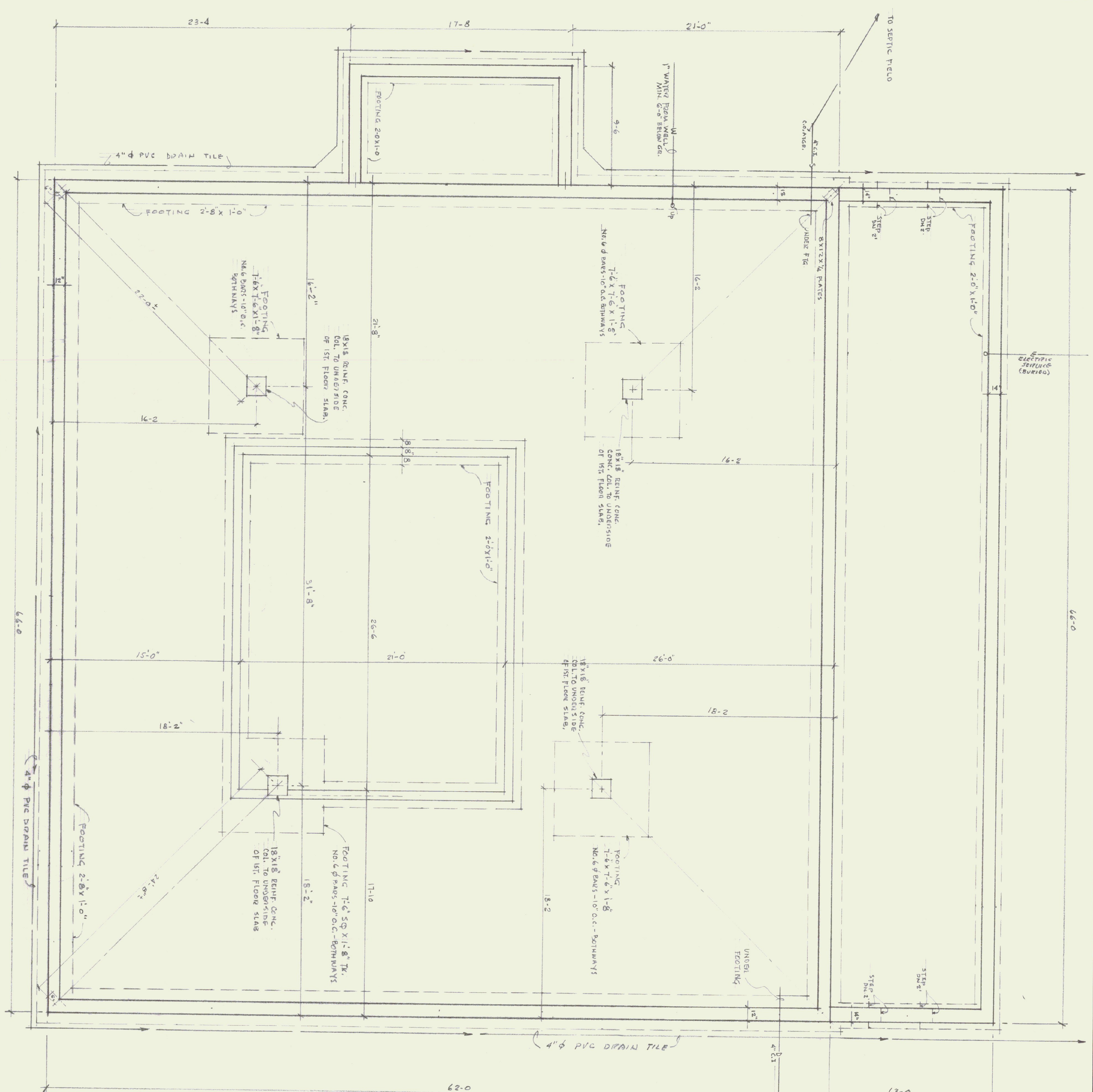

SECTION THROUGH CONCRETE COLUMN FOOTING AND FLAT CONCRETE SLAB WITH DROP PANEL
SCALE: 1/4" = 1'-0"

NOTES:
ALL DIMENSIONS TO BE VERIFIED AT THE SITE BY THE CONTRACTOR. ANY ERROR OR POINTS IN QUESTION MUST BE REFERRED TO THE ARCHITECT FOR A DECISION BEFORE PROCEEDING WITH THE WORK.

CONCRETE:
FOUNDATION WALLS - 3000 P.S.I.
FOOTINGS - 3000 P.S.I.
LOWER LEVEL SLAB - 3000 P.S.I.
FIRST FLOOR SLAB - 3000 P.S.I.

NOT FINISHED

AGENCY OF TRANSPORTATION - NEW OFFICE
STATE OF VERMONT-DEPT. OF STATE BUILDINGS
DUMMERSTON, VERMONT
GORDON G. WOODS ASSOC., ARCHITECTS, BURLINGTON, VERMONT

REVISIONS	BY

DATE: MAR. 29, 1985
SCALE: 1/4" = 1'-0"
JOB NO.: S4-20
SHEET: 1

DRAWN: JIN/BSW
CHECKED: [Signature]

SI
Arch.
SHEETS