

DETAIL  
TYPICAL BASEBOARD RADIATION  
VENT TO BE PROVIDED AT EACH HIGH POINT  
N.T.S.

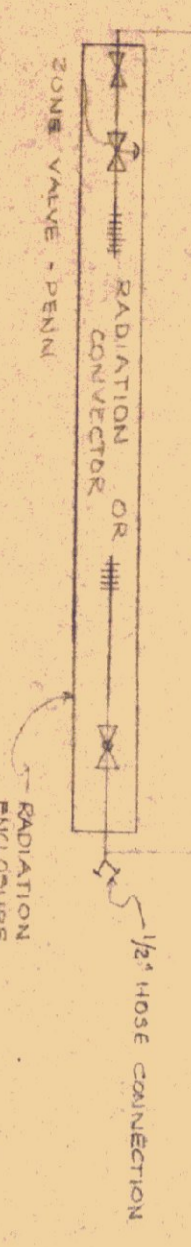

NOTE: PROVIDE BALANCING VALVES TO MAIN LINE STOP  
LINE FROM EACH TAKE OFF FOR UNID. RAD. (TYPICAL)

PLAN VIEW  
SCALE 1/8" = 1 FT.

- TANK NOTES:**
1. TANK SHALL BE INSULATED & INSTALLED BY OTHERS.
  2. HEATING & PUMPS CONTRACTORS SHALL PIPING TANK FILL, VENT, SUPPLY & RETURN LINE, SAVERS, ETC., FOR CONTRACTOR INSTALLATION.
  3. HEATING & PUMPS CONTRACTORS SHALL PROVIDE GAUGES WITH 4" FLUSH & FILL WATERIGHT FILL BOX, WATERED OFF UTILITIES TYPE "W".
  4. PROVIDE 4" ELBOW SWIVELS IN ALL FILL & VENT LINES AT TANK.
  5. PROVIDE CONTINUOUS COPPER LINES RUN IN 2" PVC FOR FUEL OIL SUPPLY & RETURN.
  6. GAUGE CAPILLARY TO RUN IN PVC BETWEEN TANK & BUILDING - ALSO WITHIN BUILDING TO GAUGE CAPILLARY TO BE FULLY PROTECTED FROM PHYSICAL ABUSE.

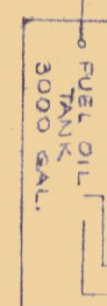
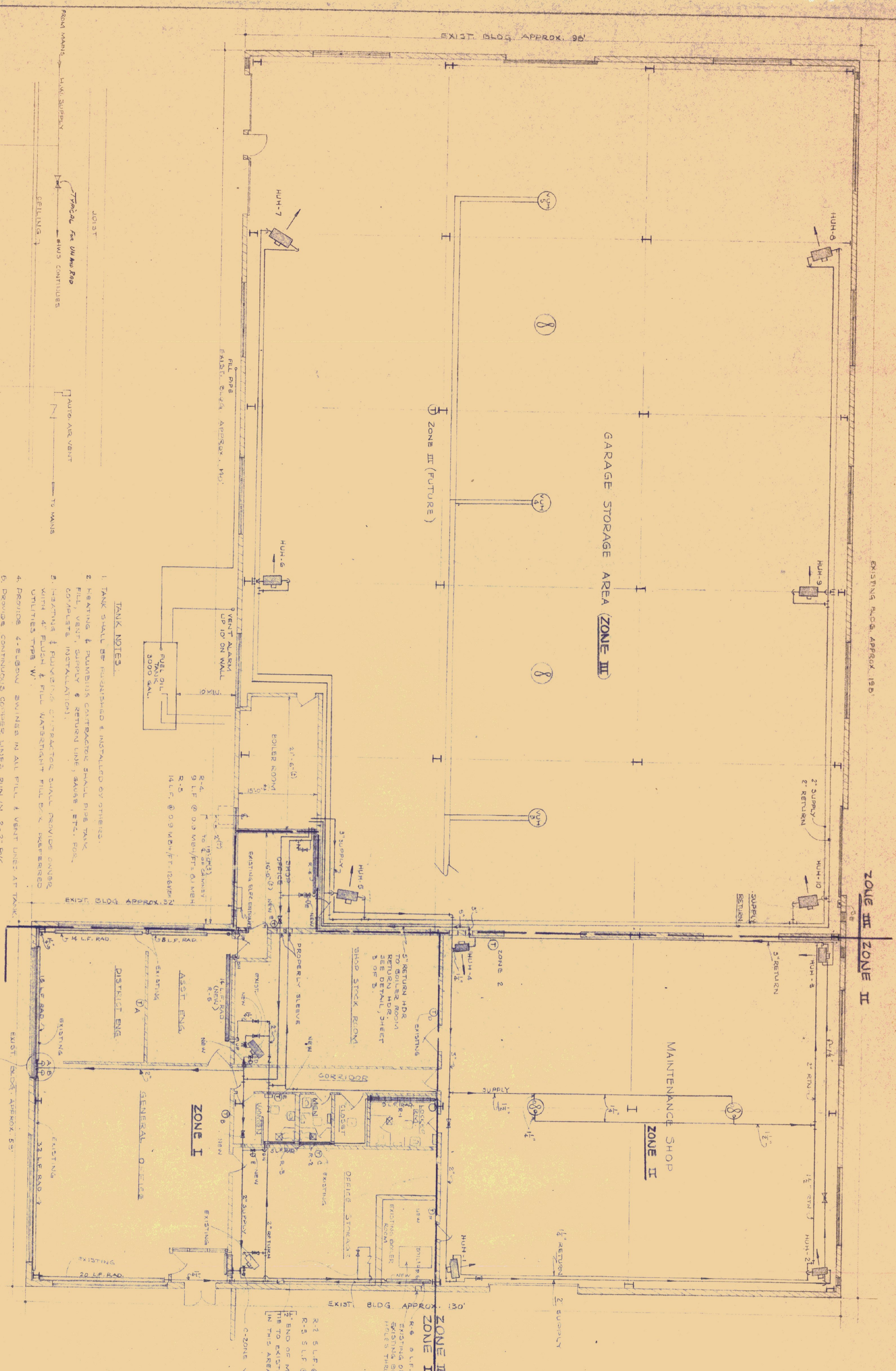

**ZONE II**  
R-2 5 L.F. @ 900 MBH/FT. = 4.5 MBH  
R-3 5 L.F. @ 900 MBH/FT. = 4.5 MBH  
END OF MAIN BY PASS  
TO EXISTING MAINS  
IN THIS AREA.

**ZONE I**  
R-4 9 L.F. @ 0.9 MBH/FT. = 7.2 MBH  
EXISTING OPENING TO BE DOUBLED UP.  
EXISTING BOILER, ETC. TO BE REMOVED.  
EXISTING TANK WANTS TO BE PIPED TO MAINS

SIGNATURE: *Calvin...* DATE: 7/1/76  
STATE OF VERMONT  
DESIGNED BY: *Calvin...*  
DRAWN BY: *...*

DATE: 6-1-76	DESIGNED BY: <i>Calvin...</i>	DWG. NO.:
DRAWN BY: <i>...</i>	APPROVED BY: <i>...</i>	OF 2
STATE OF VERMONT STATE BUILDINGS DIVISION DEPARTMENT OF ADMINISTRATION MONTPELIER, VERMONT HEATING SYSTEM RENOVATIONS GARAGE AND OFFICE BUILDING VERMONT DEPARTMENT OF HIGHWAYS BENNINGTON, VERMONT - DIST. # 1		