

- SCALE: 1/8"=1'-0"
1. SLAB-ON-GRADE TO BE 6" THICK REINFORCED WITH #4 @ 12" E.W.
 2. ELEVATION TOP OF FOOTING = 96'-0" UNLESS NOTED OTHERWISE

FOUNDATION PLAN

MARK		SIZE	FOOTING SCHEDULE	REMARKS
F1		6'-0" X 6'-0" X 1'-0" DEEP	#5'S @ 12" O/C E.A. WAY (BOTTOM)	
F2		5'-0" X 5'-0" X 1'-0" DEEP	#5'S @ 12" O/C E.A. WAY (BOTTOM)	

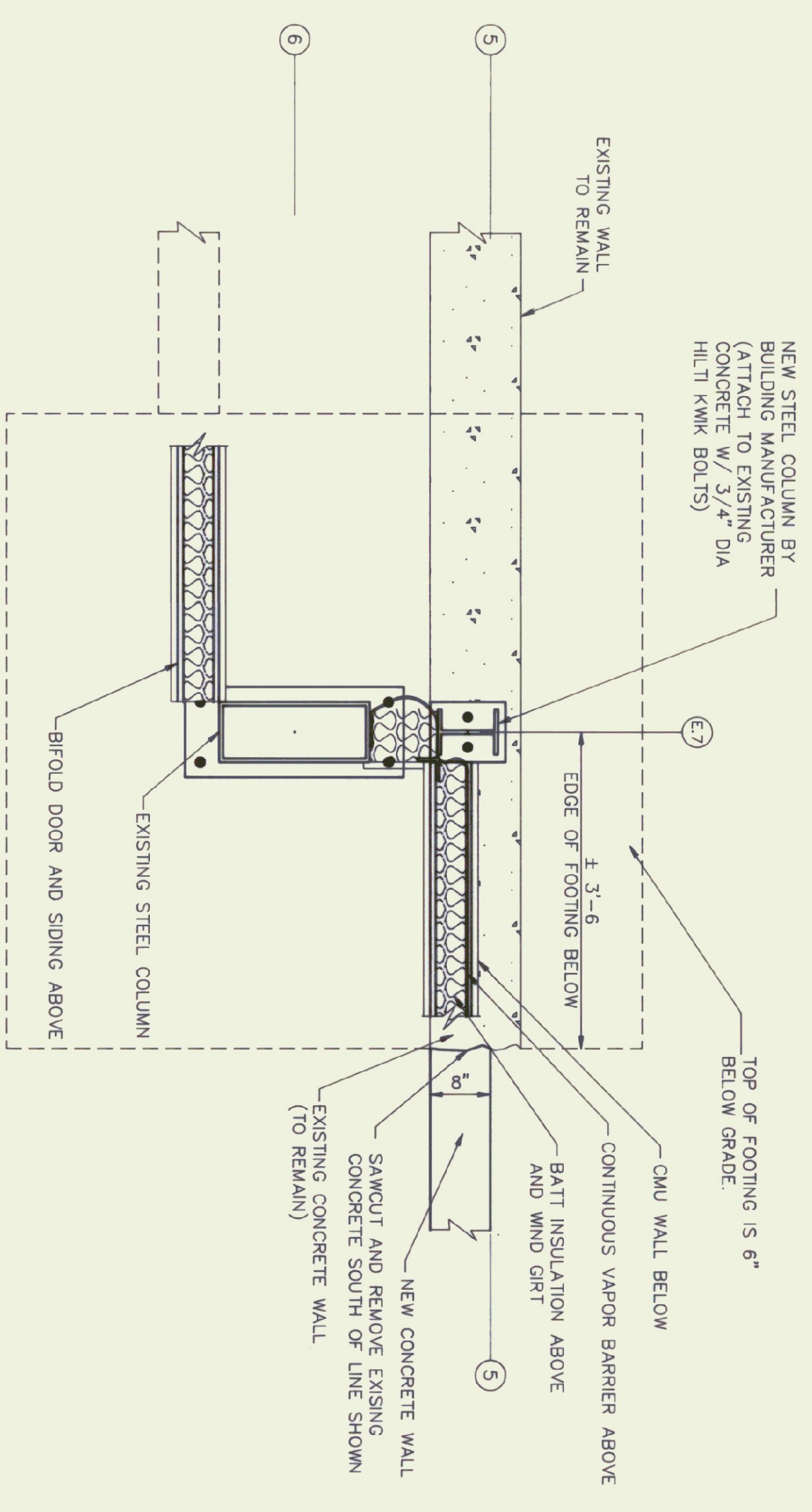

DETAIL

SCALE: 3/4"=1'-0"

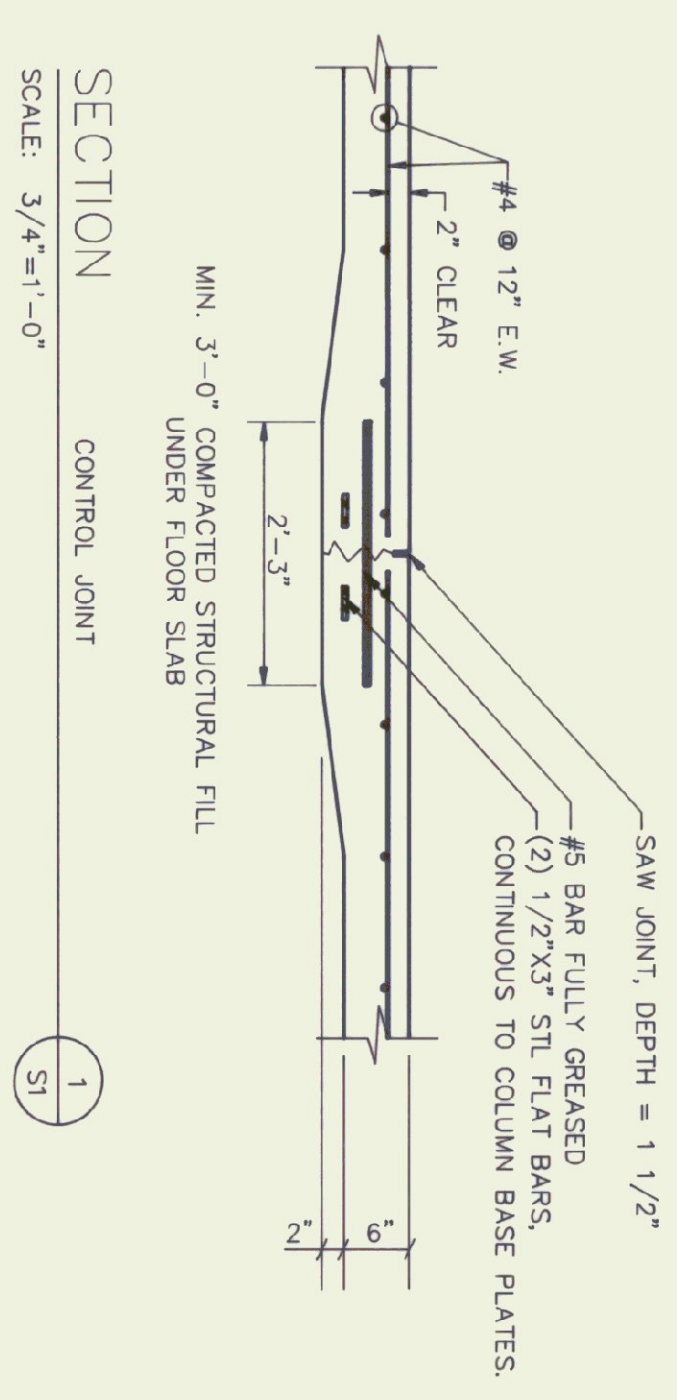

SECTION

SCALE: 3/4"=1'-0"

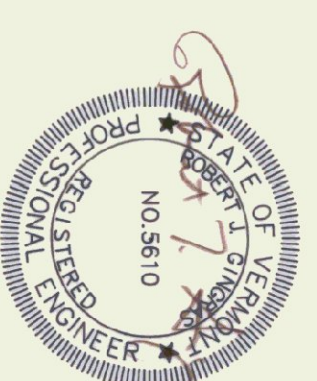

**NEW AIRPORT HANGAR
FRANKLIN COUNTY AIRPORT
FOUNDATION PLAN AND DETAILS
PROJECT NO. AIR 03 2014**

No.	Date	Description	Made by	Checked by	App'd by

Scale AS NOTED

Des. By: **RJC**
 Dwn. By: **DDH**
 Chk. By: **RJC**
 Date: **MAY 1992**
 Dwg. No.: **22-002-4**

CHENNETTE ENGINEERING, INC.
 50 STATE STREET
 MONTPELIER, VERMONT 05602

S1