

**RUNWAY 2**

APPROACH TYPE	APPROACH SLOPE	INNER WIDTH	SPLAY	LENGTH
TERPS SURFACES	STRAIGHT-IN	20:1	800	0.138:1 10,000
APPROACH TYPE	APPROACH SLOPE	INNER WIDTH	OUTER WIDTH	LENGTH
THRESHOLD SITING	INSTRUMENT	20:1	800	3800 10,000

**NOTES:**

1. TERPS SURFACE INFORMATION TAKEN FROM FAA ORDER 8260.3B CHG 18, SECTION 5.
2. RUNWAY 2 THRESHOLD SITING REQUIREMENTS TAKEN FROM FAA ADVISORY CIRCULAR AC 150/5300-13 CHG 6, APPENDIX 2, CATEGORY E, APPROACH END OF RUNWAYS EXPECTED TO SUPPORT INSTRUMENT STRAIGHT-IN NIGHT OPERATIONS.
3. RIGHT AND LEFT EDGE GROUND PROFILES FOLLOW THE RIGHT AND LEFT EDGE OF THE TERPS VISUAL AREA APPROACH SURFACE.
4. TOPOGRAPHIC INFORMATION ORIGINATED FROM AERIAL SURVEY AND WAS PROVIDED BY VAOT. TREE TOP ELEVATIONS TAKEN FROM FIELD SURVEY CONDUCTED BY DUBOIS & KING.

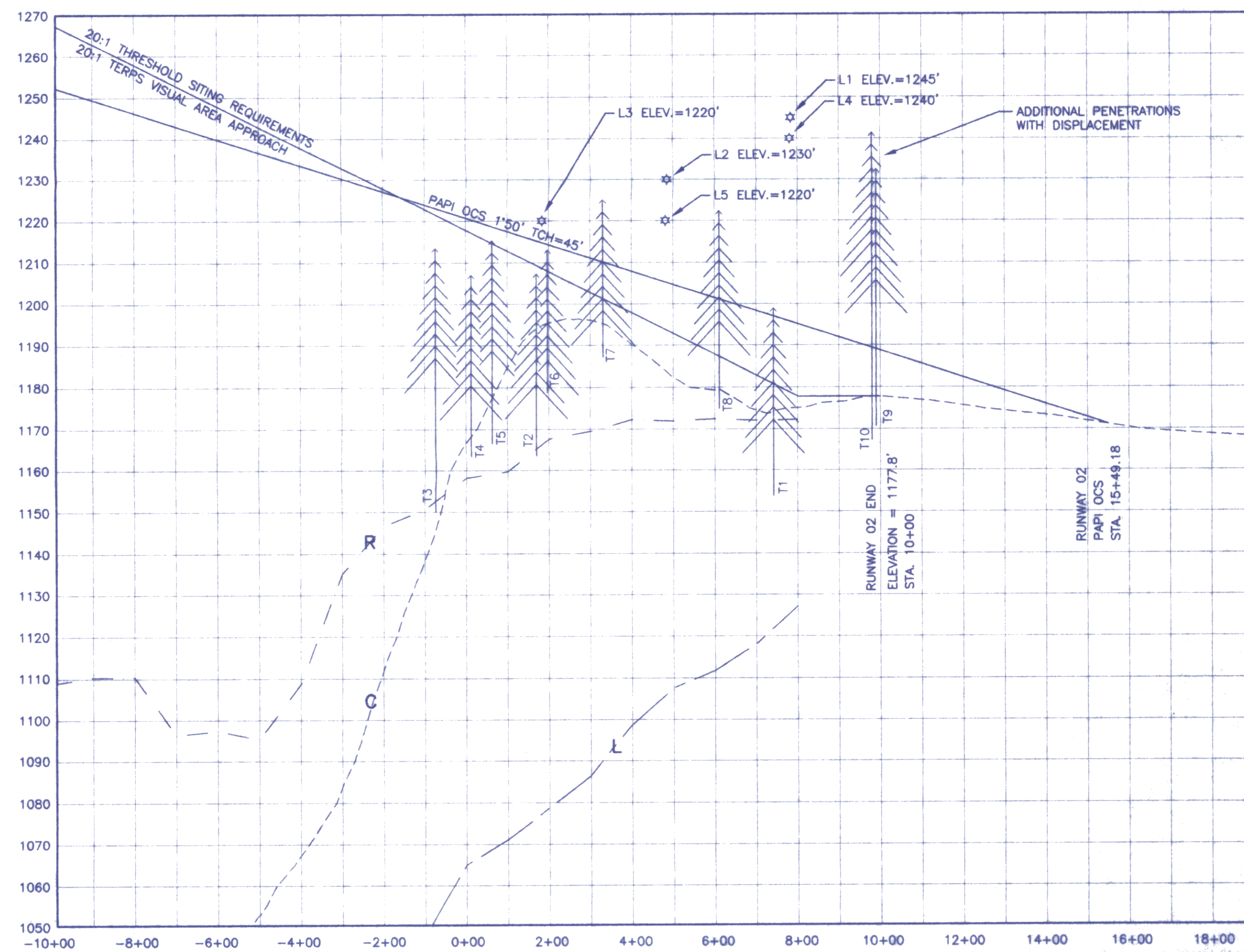

**LEGEND**

---	PROPERTY LINE
---	CENTER OF EXISTING GROUND PROFILE
---	LEFT EDGE OF EXISTING GROUND PROFILE
---	RIGHT EDGE OF EXISTING GROUND PROFILE

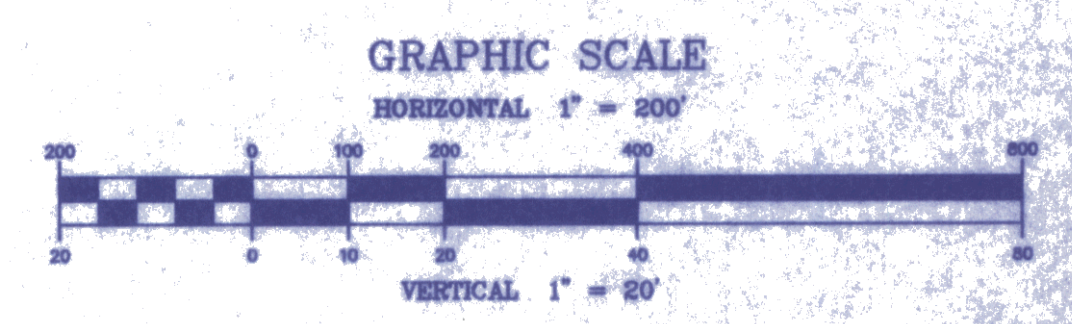

NO.	DATE	REVISIONS	BY	CK'D

**DuBois & King**  
 engineering planning management development

STATE OF VERMONT  
 AGENCY OF TRANSPORTATION  
 CALEDONIA COUNTY STATE AIRPORT  
 APPROACH PLAN  
 RUNWAY 2

DRAWN BY MDL	DATE JULY 2001
CHECKED BY N17151	PROJ. NO. N17151
PROJ. ENG.	DRAW. NO.
SHEET 14 OF 15	

I:\017151\Map\017151-0018.dwg P1 Jan 18 02:13:35 2002

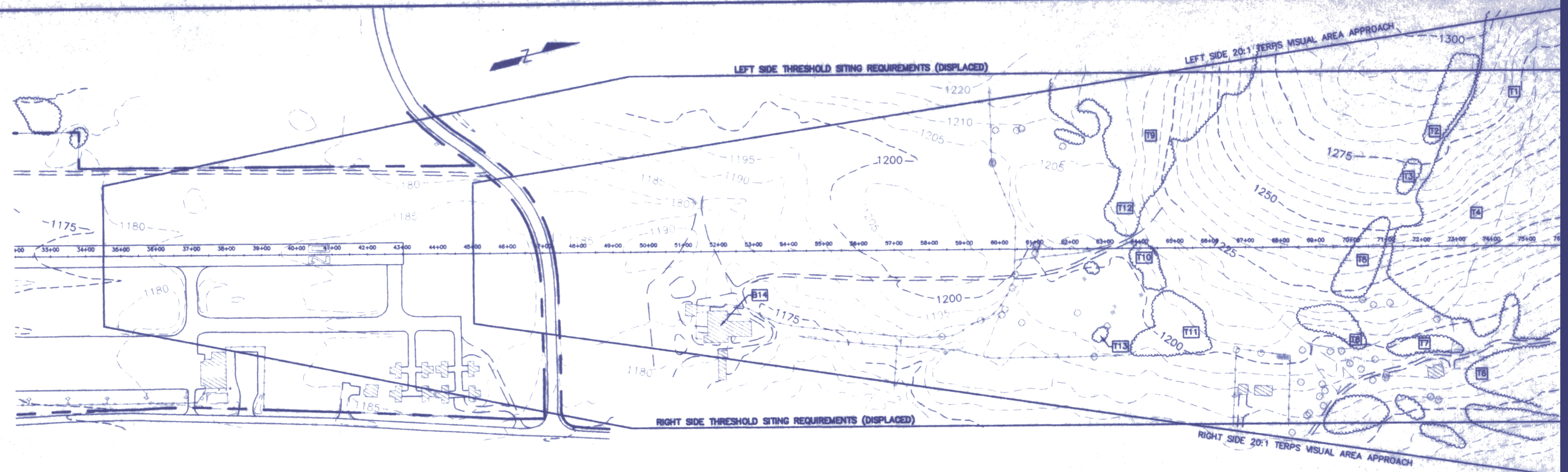

### RUNWAY 20

	APPROACH TYPE	APPROACH SLOPE	INNER WIDTH	SPRAY	LENGTH
TERPS SURFACE	VISUAL	20:1	400	0.150:1	10,000
THRESHOLD SITING	VISUAL	20:1	400	1000	10,000

#### NOTES:

1. TERPS SURFACE INFORMATION TAKEN FROM FAA ORDER B260.3B CHG. 1B, SECTION 5.
2. RUNWAY 20 DISPLACED THRESHOLD SITING REQUIREMENTS TAKEN FROM FAA ADVISORY CIRCULAR AC 150/5300-13 CHG 6, APPENDIX 2, CATEGORY C; APPROACH END OF RUNWAYS EXPECTED TO SERVE LARGE AIRPLANES, OR INSTRUMENT MINIMUMS GREATER THAN ONE STATUTE MILE, DAY ONLY.
3. RIGHT AND LEFT EDGE GROUND PROFILES FOLLOW THE RIGHT AND LEFT EDGE OF THE TERPS VISUAL AREA APPROACH SURFACE.
4. TOPOGRAPHIC INFORMATION ORIGINATED FROM AERIAL SURVEY AND WAS PROVIDED BY VAOT. TREE TOP ELEVATIONS TAKEN FROM DUFRESNE-HENRY REPORT TITLED "ANALYSIS OF RUNWAY 2-20 RELOCATION" DATED AUGUST, 2000.

#### LEGEND

- PROPERTY LINE
- CENTER OF EXISTING GROUND PROFILE
- LEFT EDGE OF EXISTING GROUND PROFILE
- RIGHT EDGE OF EXISTING GROUND PROFILE

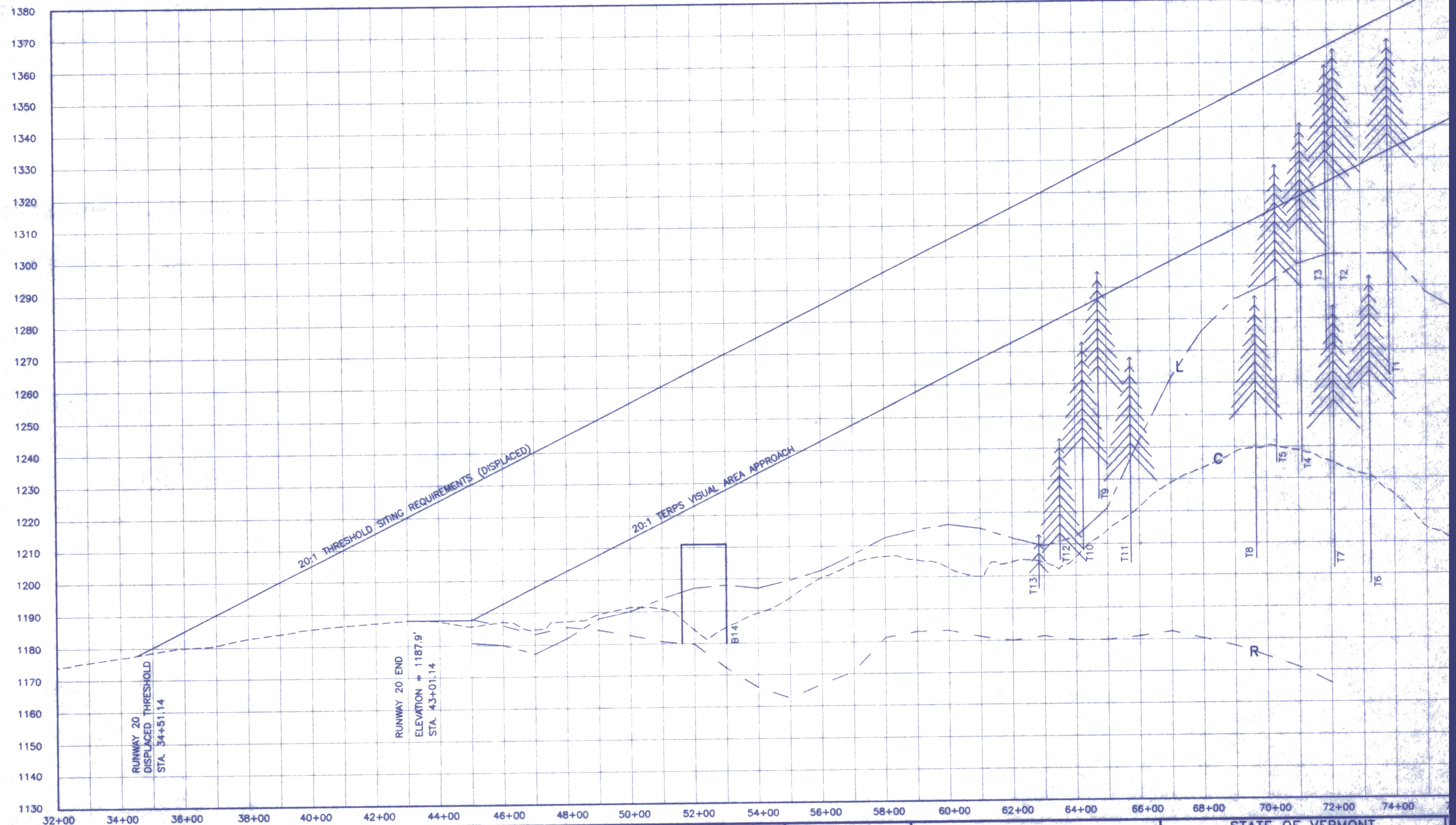

#### GRAPHIC SCALE

HORIZONTAL 1" = 200'

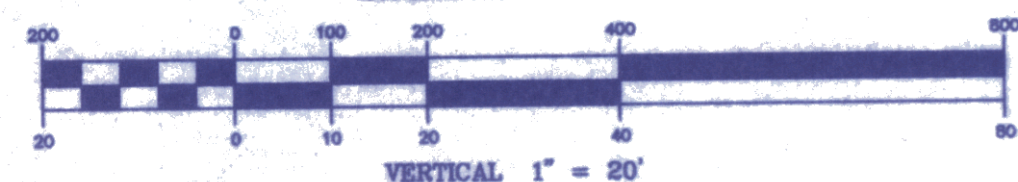

NO.	DATE	REVISIONS	BY	CK'D

**DuBois & King INC.**  
 engineering    planning    management    development

STATE OF VERMONT  
 AGENCY OF TRANSPORTATION  
 CALEDONIA COUNTY STATE AIRPORT  
 APPROACH PLAN  
 RUNWAY 20