

1 2 3

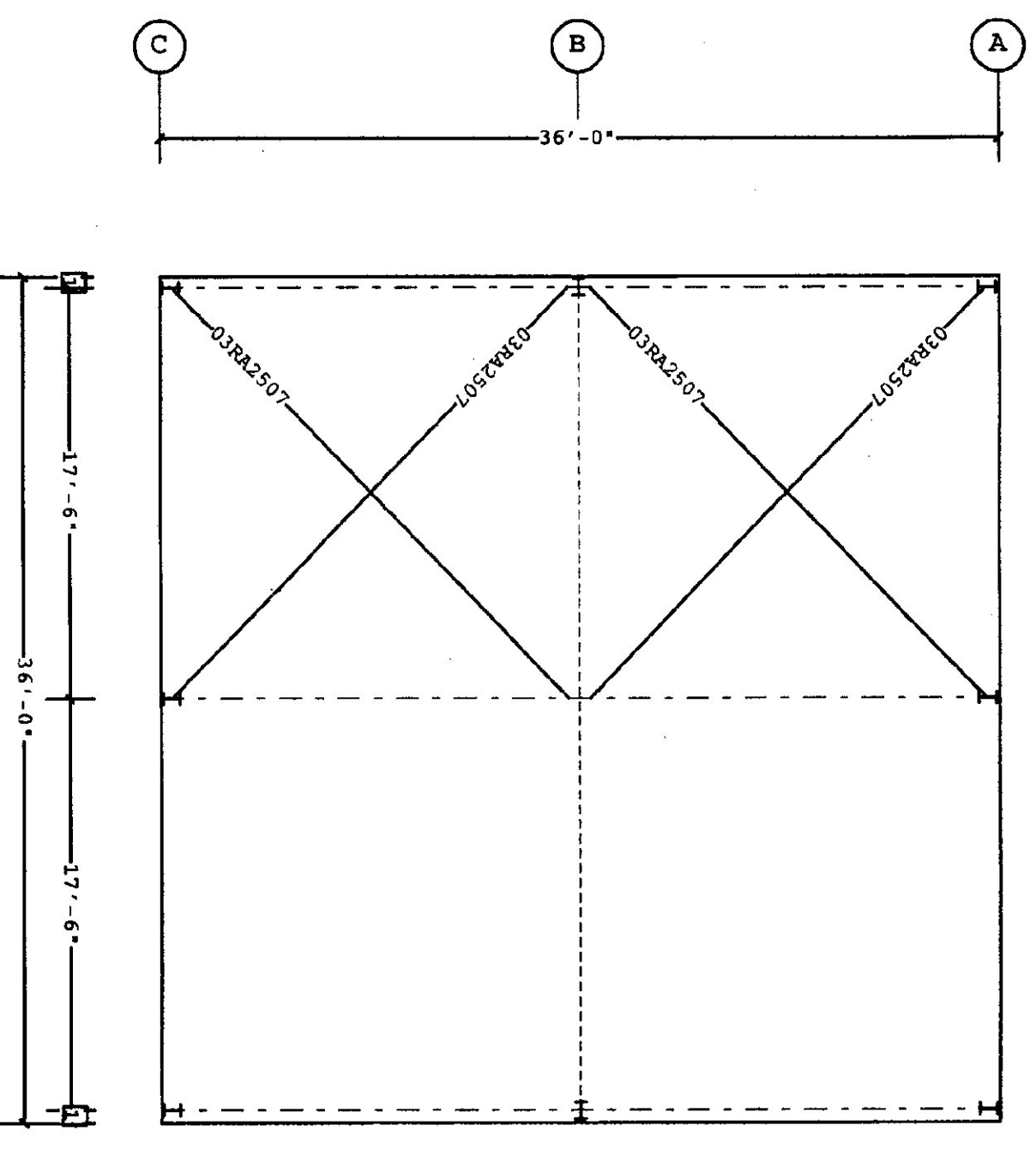

Dimension Key
 (1) 6"
 Denoted with rectangle

PRIMARY AND ROOF BRACING PLAN

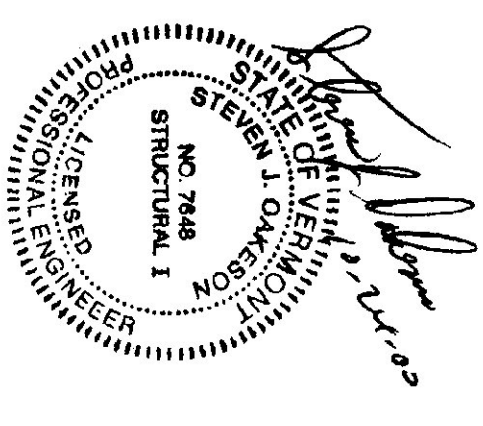

10/23/2000

1. USE 1/2 DIA. A325 BOLTS FOR PURLIN TO FRAME, GIRT TO FRAME, AND GIRT TO CLIP CONNECTIONS UNLESS NOTED OTHERWISE. SEE JOB DETAILS FOR BOLT SIZES.	
THE VP BUILDINGS 2 BLDG. AND USE OF THIS DRAWING AND SPECIFICATIONS IS LIMITED TO THE PROJECT AND SITE SPECIFICALLY IDENTIFIED HEREIN. ANY OTHER PROJECT OR SITE WITHOUT THE WRITTEN CONSENT OF VP BUILDINGS IS STRICTLY PROHIBITED. THE USER OF THIS DRAWING AGREES TO HOLD VP BUILDINGS HARMLESS FROM ANY AND ALL CLAIMS, DAMAGES, LOSSES AND EXPENSES, INCLUDING REASONABLE ATTORNEY'S FEES, THAT MAY BE ASSERTED AGAINST VP BUILDINGS BY ANY OTHER PARTY AS A RESULT OF THE USER'S NEGLIGENCE OR MISUSE OF THIS DRAWING OR SPECIFICATIONS.	VP BUILDINGS, INC. 1200 PLYMOUTH CLUB CIRCLE MEMPHIS TN 38125
Building Code: 9803CA Live Load: (Inc. Reducible) 20.00 psf Wind Speed: 90 mph Wind Exposure: C Roof Snow: 49.00 psf Snow Exposure Category: 3 Seismic Hazard Group: Group 1 Building Use/Standard Occupancy Structures	VP Bldg Name: 8000000 Project Name: 8000000 Project No: 8000000 Project Date: 10/23/2000 Project Location: 1015146
FOR CONSTRUCTION	PRIMARY AND ROOF BRACING PLAN
Date: 10/23/2000 By: [Signature] Title: [Title]	Date: 10/23/2000 By: [Signature] Title: [Title]
VP BUILDINGS 1200 PLYMOUTH CLUB CIRCLE MEMPHIS, TN 38125 TEL: 901-591-1000 FAX: 901-591-1001 WWW.VPBUILDINGS.COM	VP BUILDINGS 1200 PLYMOUTH CLUB CIRCLE MEMPHIS, TN 38125 TEL: 901-591-1000 FAX: 901-591-1001 WWW.VPBUILDINGS.COM