

STATE OF VERMONT AGENCY OF TRANSPORTATION

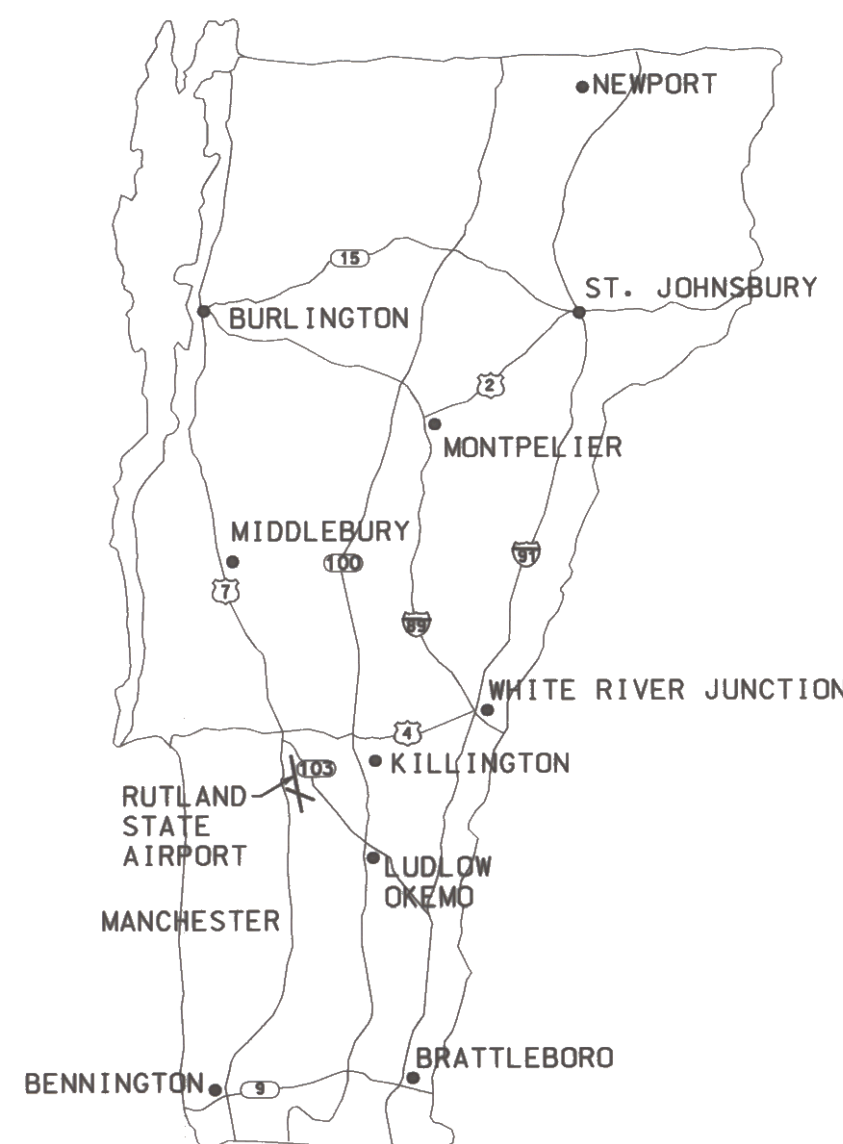

PARTIAL AIRPORT MASTER PLAN UPDATE RUTLAND STATE AIRPORT CLARENDON, VERMONT



LOCATION MAP
NTS

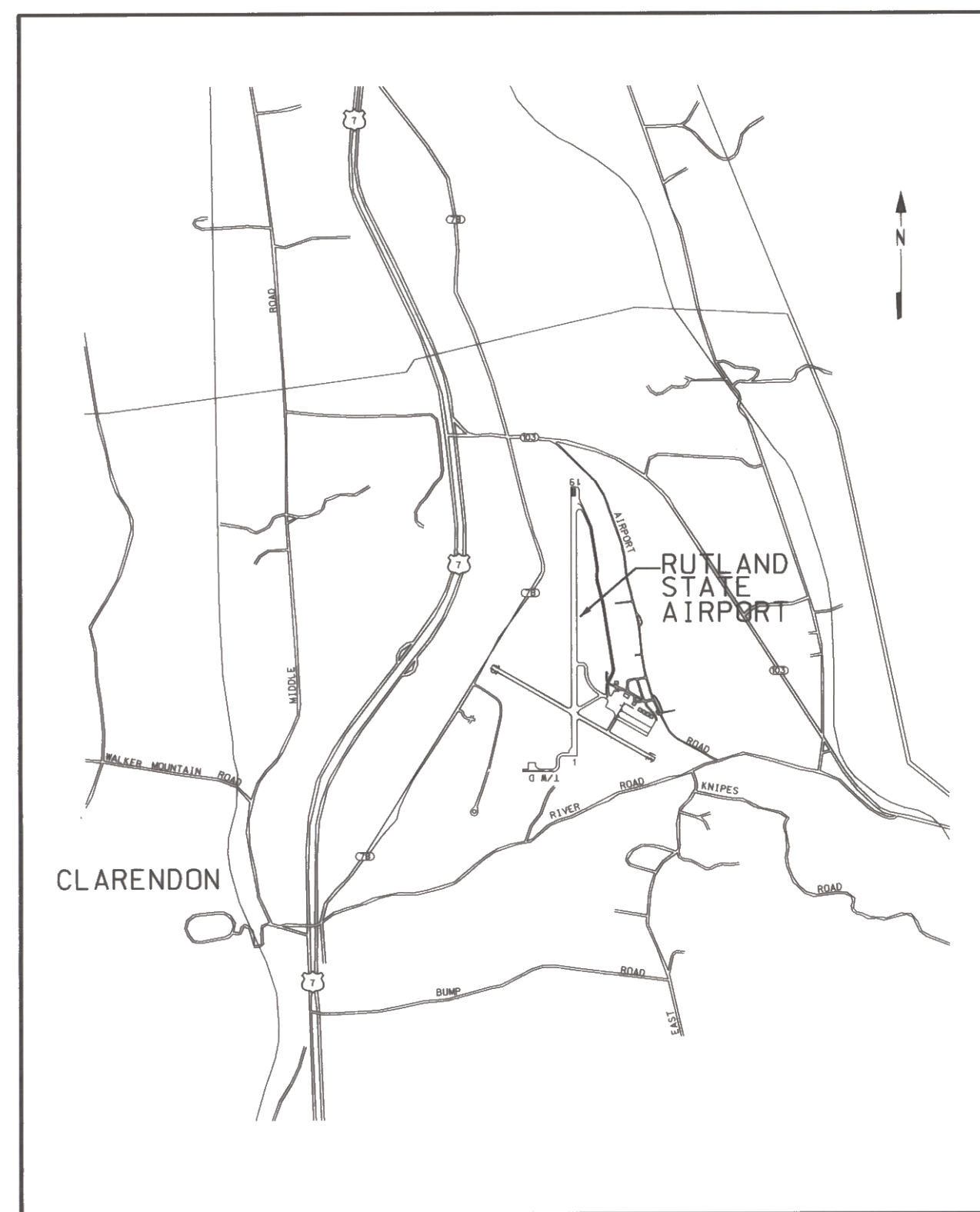

LOCATION MAP
NTS

INDEX OF SHEETS

- 1 TITLE SHEET
- 2 EXISTING AIRPORT LAYOUT
- 3 AIRPORT LAYOUT PLAN (ALP)
- 4 APPROACH AND OBSTRUCTION PLAN & PROFILE 1-19
- 5 APPROACH AND OBSTRUCTION PLAN & PROFILE 13-31
- 6 TERMINAL SUPPORT AREA PLAN "A"
- 7 TERMINAL SUPPORT AREA PLAN "B"
- 8 OFF AIRPORT LAND USE PLAN
- 9 IMAGINARY SURFACE PLAN
- 10 EXHIBIT "A" PROPERTY MAP

PREPARED FOR:
VERMONT AGENCY OF TRANSPORTATION
VERMONT AGENCY OF TRANSPORTATION PROJECT No. AIR 04-3121
FEDERAL AVIATION ADMINISTRATION PROJECT No. 3-50-0015-12
JANUARY, 2001

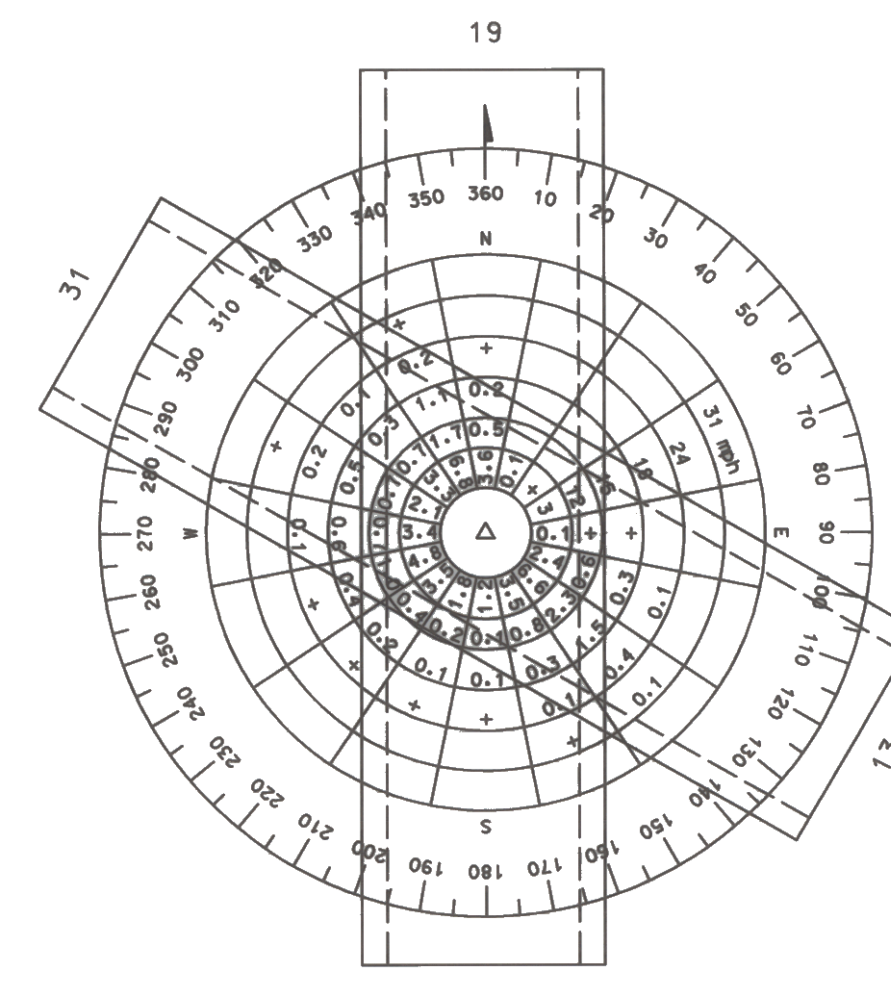

ALL WEATHER WIND ROSE

LOCATION: Rutland State Airport
Clarendon, Vermont

SOURCE: NOAA Environment Data Service
National Climate Center
Asheville, North Carolina

PERIOD: January 1, 1971 - December 31, 1975

ANNUAL OCCURANCE: 100%

TOTAL IFR OBSERVATION 8170
+ = Less than 0.1%

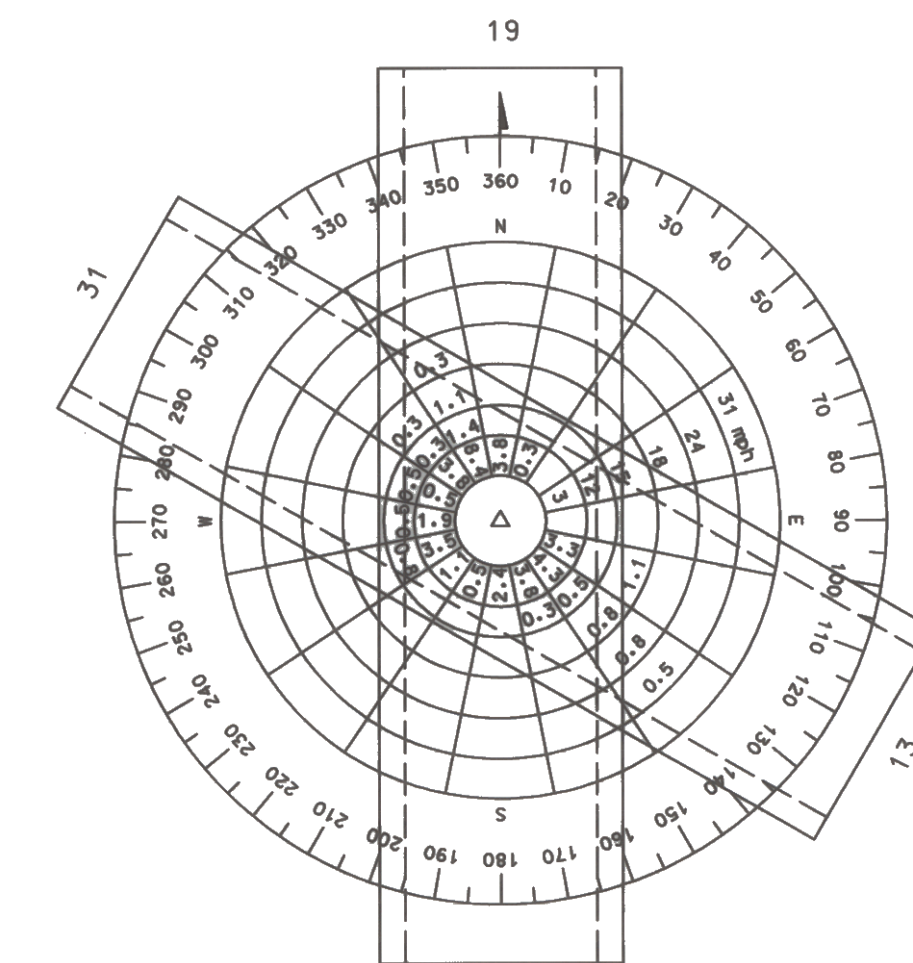

IFR WEATHER WIND ROSE

<1000' &/or 3 miles but ≥ 400' & 1 mile

LOCATION: Rutland State Airport
Clarendon, Vermont

SOURCE: NOAA Environment Data Service
National Climate Center
Asheville, North Carolina

PERIOD: January 1, 1971 - December 31, 1975

ANNUAL OCCURANCE: 4.5%

TOTAL IFR OBSERVATION 369

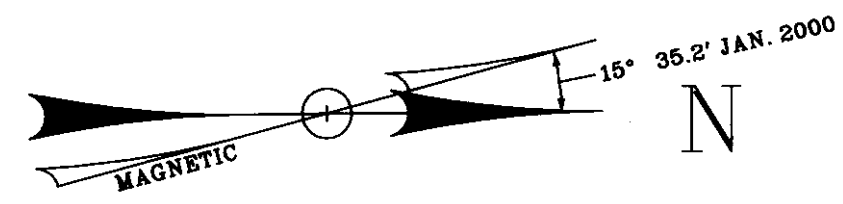

ITEM	EXISTING
AIRPORT PROPERTY LINE	---
MISCELLANEOUS PROPERTY LINE	---
CONTOURS (USGS 7.5' DATUM)	---
AIRPORT REFERENCE POINT (A.R.P.)	⊕
AIRPORT ROTATING BEACON	⊕
BUILDING RESTRICTION LINE (B.R.L.)	---
EASMENT	---
PROPERTY ACQUISITION	---
RUNWAYS/TAXIWAYS/APRON	---
WATER COURSE	---
TREELINE/BRUSH	---
SAFETY AREA	---
MISC. BUILDINGS/FACILITIES	---
AIRPORT BUILDINGS	---
AUTO PARKING	AS SHOWN
TIEDOMS	AS SHOWN
RUNWAY SAFETY AREA LIMITS	---
AIRPLANE PARKING LIMITS	---
PERIMETER FENCING	---

RUNWAY DATA				
RUNWAY	1	19	13	31
RUNWAY LENGTH	5000'		3170'	
WIDTH	100'		75'	
SAFETY AREA WIDTH	400'		150'	
TAXIWAY WIDTH	35'		35'	
SURFACE	BIT. CONCRETE		BIT. CONCRETE	
PAVEMENT STRENGTH	68,000 * DV		12,500 * SW	
RUNWAY LIGHTING	MIRLS		MIRLS	
RUNWAY MARKING	VISUAL		NON PRECISION	
EFFECTIVE GRADIENT	NONE		NONE	
NAV-AIDS	NONE		LOC, NOB, DME	CESNA CITATION IV
CRITICAL AIRCRAFT	GULFSTREAM III		PAPI	
AIRPLANE REFERENCE CODE	G-11		B-11	
VISUAL AIDS (EXISTING)	NONE		VAST. ODALS, REILS	
VISUAL AIDS	NONE		NONE	
RUNWAY END COORDINATES	43° 31' 29.55" N 72° 56' 58.16" W	43° 31' 18.92" N 72° 56' 59.98" W	43° 31' 44.6" N 72° 57' 18.4" W	43° 31' 29.6" N 72° 57' 40.9" W

AIRPORT DATA	
DESCRIPTION	EXISTING
AIRPORT ELEVATION	787'
MEAN MAXIMUM TEMP. (HOTTEST MONTH)	80°
COMBINED WIND COVERAGE (12 MPH)	99%
MAGNETIC VARIATION	15.09° W
AIRCRAFT DESIGN GROUP	I
AIRCRAFT APPROACH SPEED	C
CRITICAL AIRCRAFT	GULFSTREAM III
AIRPORT REFERENCE POINT	LAT. 43° 31' 48" N LONG. 72° 56' 59" W

AIRPORT BUILDINGS	
IDENTIFIER	DESCRIPTION
1	FIRE STATION
2	STATE STORAGE HANGAR
3	TERMINAL
4	STORAGE HANGAR
5	FBO OFFICE & MAINTENANCE HANGAR
6	STORAGE AND T-HANGARS
7	T-HANGARS
8	FUEL FARM
9	STORAGE HANGAR
10	FBO MAINTENANCE HANGAR
11	CIVIL AIR PATROL
12	DISTRICT TRANSPORTATION GARAGE

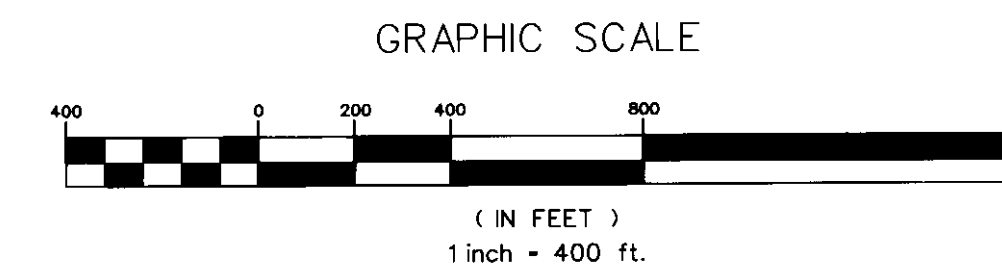

RUTLAND STATE AIRPORT
CLARENDON, VERMONT

AIRPORT MASTER PLAN UPDATE
EXISTING AIRPORT LAYOUT

File No. RUT_EA1.DGN
Job No. F20000179.00

1 NORTHWAY LN.
LATHAM, NEW YORK

Designed by: G.W.D.
Drawn by: AL BEY
Checked by: M.L.C.
Approved by: G.W.D.

Scale: 1"=400'
Date: JAN. 2000
Sheet 2 of 10
Sheet No. 2

LEGEND		
ITEM	EXISTING	ULTIMATE
AIRPORT PROPERTY LINE	---	---
MISCELLANEOUS PROPERTY LINE	---	---
CONTOURS (USGS-MSL DATUM)	700	700
AIRPORT REFERENCE POINT (A.R.P.)	⊙	⊙
AIRPORT ROTATING BEACON	⊙	⊙
BUILDING RESTRICTION LINE (B.R.L.)	⊙	⊙
EASEMENT	---	---
RUNWAYS/TAXIWAYS/APRON	---	---
WATER COURSE	---	---
TREELINE/BRUSH	---	---
SAFETY AREA	---	---
AIRPORT PAVEMENTS	---	---
AIRPORT BUILDINGS	---	---
AUTO PARKING	AS SHOWN	AS SHOWN
TIEDOWNS	AS SHOWN	AS SHOWN
RUNWAY SAFETY AREA LIMITS	---	---
AIRPLANE PARKING LIMITS	---	---
NEW PERIMETER FENCING	---	---
PROPERTY TO BE ACQUIRED	---	---
PROPERTY TO BE TRANSFERRED	---	---

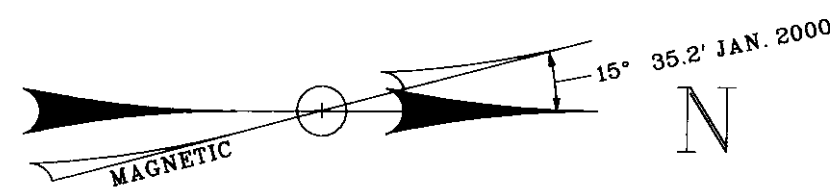

RUNWAY DATA (ULTIMATE)				
RUNWAY	1	19	13	31
RUNWAY LENGTH	5000'			3170'
WIDTH	100'			75'
SAFETY AREA WIDTH	100'			150'
SAFETY AREA LENGTH (BEYOND THRESHOLD)	450'	550'	300'	300'
TAXIWAY WIDTH	35'			35'
SURFACE	BIT CONCRETE			BIT CONCRETE
PAVEMENT STRENGTH	68,000 • DW			12,500 • SW
RUNWAY LIGHTING	MIRLS (EXISTING) MIRLS ULTIMATE			MIRLS
RUNWAY MARKING	NON PRECISION (EXISTING) PRECISION ULTIMATE			PRECISION ULTIMATE
EFFECTIVE GRADIENT	0.25%			0.2%
NAV-AIDS	NONE	GULFSTREAM III	LOC, NDB, DME	NONE
CRITICAL AIRCRAFT AIRPLANE REFERENCE CODE		C-II		C
VISUAL AIDS (EXISTING)	NONE	VASI/ODALS/REILS	PAPI	PAPI
VISUAL AIDS (ULTIMATE)				
RUNWAY END COORDINATES	43° 31' 28.55" N 72° 56' 58.16" W	43° 31' 18.92" N 72° 56' 58.90" W	43° 31' 44.6" N 72° 57' 18.4" W	43° 31' 28.6" N 72° 57' 40.8" W

AIRPORT BUILDINGS	
IDENTIFIER	DESCRIPTION
1	FIRE STATION
2	STATE STORAGE HANGAR
3	TERMINAL
4	STORAGE HANGAR
5	FBO OFFICE & MAINTENANCE HANGAR
6	STORAGE AND T-HANGARS
7	T-HANGARS
8	FUEL FARM
9	STORAGE HANGAR
10	FBO MAINTENANCE HANGAR
11	CIVIL AIR PATROL
12	DISTRICT TRANSPORTATION GARAGE

AIRPORT DATA		
DESCRIPTION	EXISTING	ULTIMATE
AIRPORT ELEVATION	787	787
MEAN MAXIMUM TEMP (HOTTEST MONTH)	80°	80°
COMBINED WIND COVERAGE (12 MPH)	99%	99%
MAGNETIC VARIATION	15.09° W	
AIRCRAFT DESIGN GROUP	II	II
AIRCRAFT APPROACH SPEED	C	C
CRITICAL AIRCRAFT	GULFSTREAM III	GULFSTREAM III
AIRPORT REFERENCE POINT	LAT. 43° 31' 48" N LONG. 72° 56' 59" W	LAT. 43° 31' 48" N LONG. 72° 56' 59" W

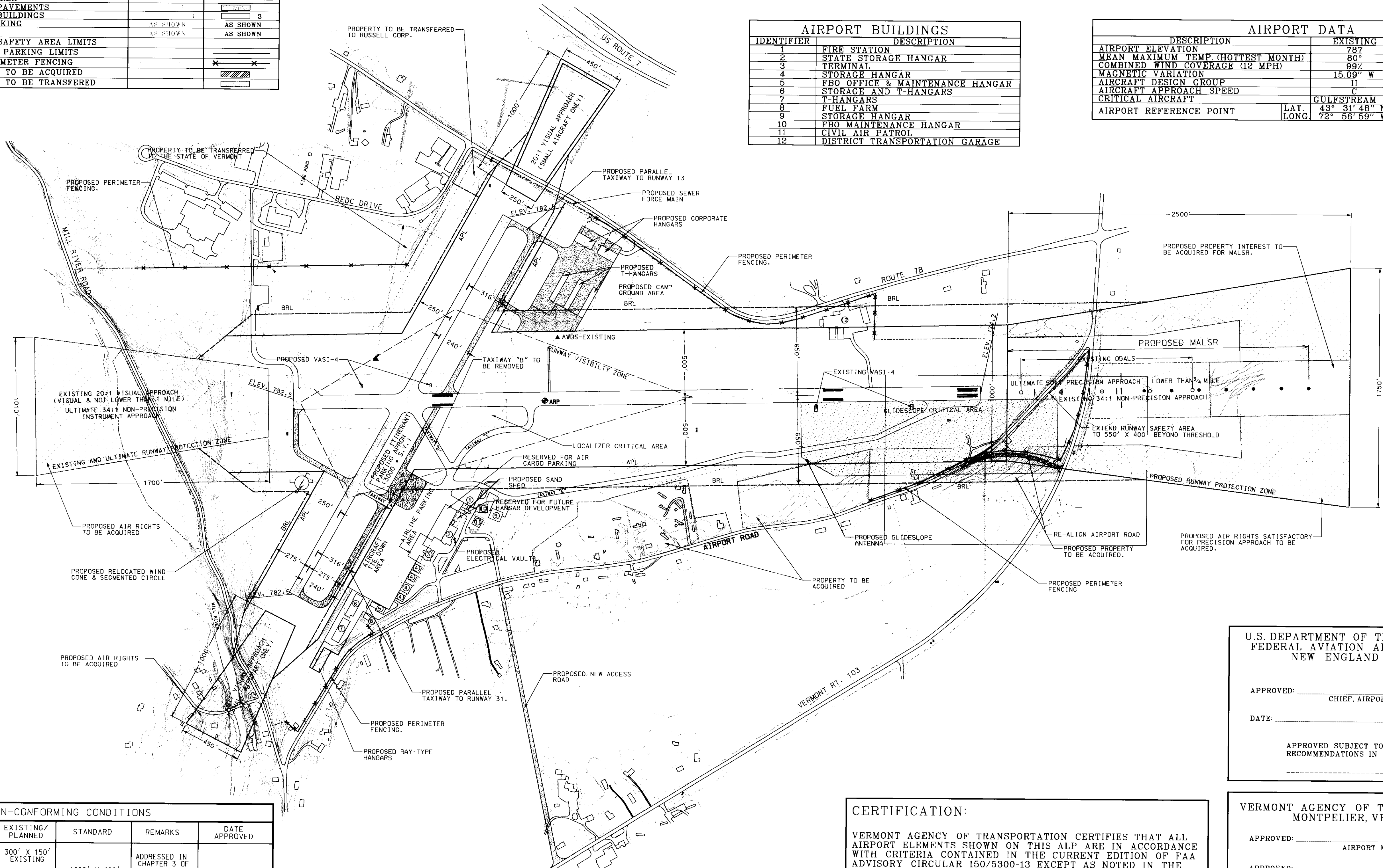

NON-CONFORMING CONDITIONS				
DESCRIPTION	EXISTING/PLANNED	STANDARD	REMARKS	DATE APPROVED
R/W 19 SAFETY AREA	300' X 150' EXISTING 550' X 400' PLANNED	1000' X 400'	ADDRESSED IN CHAPTER 3 OF MASTER PLAN UPDATED JAN. 2001	
R/W 1 SAFETY AREA	450' X 400' EXISTING & PLANNED	1000' X 400'	ADDRESSED IN CHAPTER 3 OF MASTER PLAN	

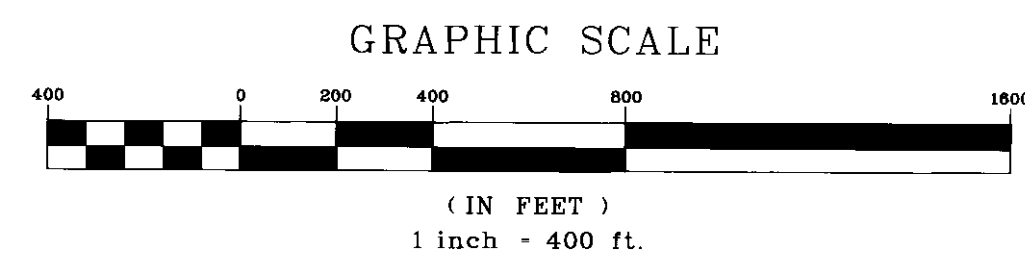

CERTIFICATION:

VERMONT AGENCY OF TRANSPORTATION CERTIFIES THAT ALL AIRPORT ELEMENTS SHOWN ON THIS ALP ARE IN ACCORDANCE WITH CRITERIA CONTAINED IN THE CURRENT EDITION OF FAA ADVISORY CIRCULAR 150/5300-13 EXCEPT AS NOTED IN THE TABLE ENTITLED "NON-CONFORMING CONDITIONS."

NAME: _____ DATE: _____

U.S. DEPARTMENT OF TRANSPORTATION
FEDERAL AVIATION ADMINISTRATION
NEW ENGLAND REGION

APPROVED: _____
CHIEF, AIRPORT DIVISION, FAA

DATE: _____

APPROVED SUBJECT TO COMMENTS AND RECOMMENDATIONS IN LETTER DATED: _____

VERMONT AGENCY OF TRANSPORTATION
MONTPELIER, VERMONT

APPROVED: _____
AIRPORT MANAGER

APPROVED: _____
AVIATION PROGRAM MANAGER

APPROVED: _____
DIRECTOR OF MAINTENANCE AND AVIATION DIVISION

DATE: _____

URS Greiner
1 NORTHWAY LN.
LATHAM, NEW YORK

RUTLAND STATE AIRPORT
CLARENDON, VERMONT

AIRPORT MASTER PLAN UPDATE
AIRPORT LAYOUT PLAN

7/2001	REVISE APPROVAL/CERTIFICATION BLOCK	DATE	DESCRIPTION
1/2001	UPGRADE RUNWAY 1 TO MP APPROACH		
1/2001	REVISED TO REFLECT APRON DESIGN		

Job No. F20000179.00 File No. RUT_ALP.DGN

Designed by: G.W.D.
Drawn by: AL BEY
Checked by: M.L.C.
Approved by: G.W.D.

Scale: 1"=400'
Date: JAN. 2001
Sheet 3 of 10
Sheet No. 3

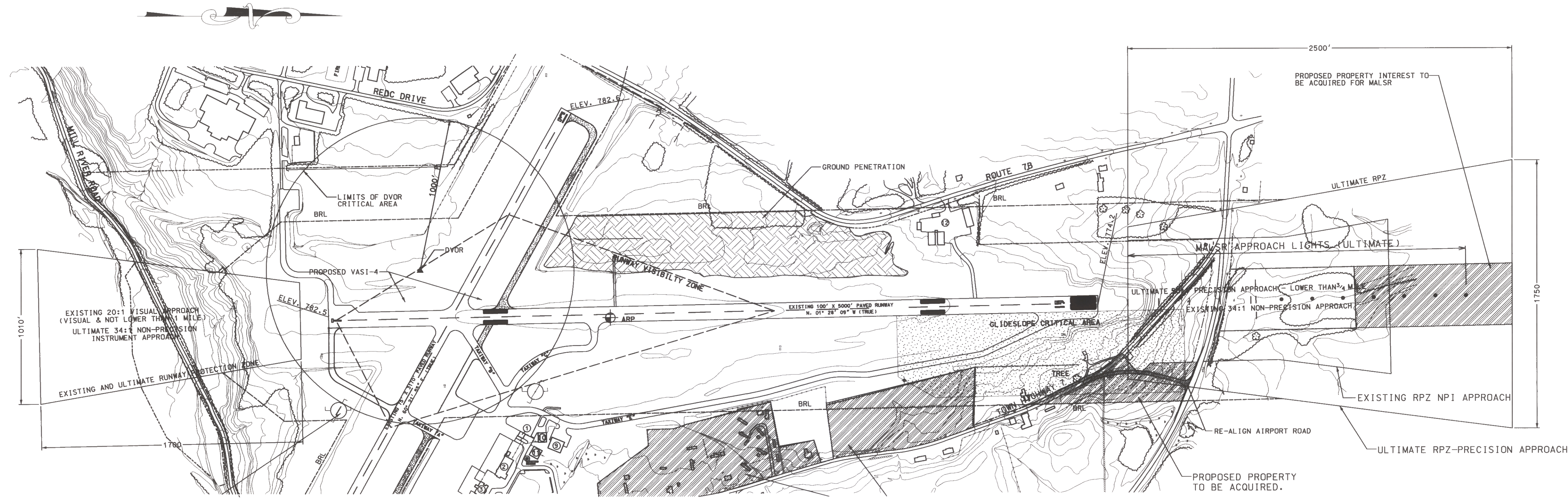

NOTES:

1. EXISTING GROUND PROFILE AND CONTOURS WITHIN PLAN VIEW ARE BASED ON AERIAL PHOTOGRAMMETRY, TAKEN IN APRIL, 1998, AUGMENTED BY THE USGS MAPPING.
2. TREE TOP ELEVATIONS BASED ON AIRPORT OBSTRUCTION CHART DATA. (OC-968) PUBLISHED BY NOAA, FEB. 1998.

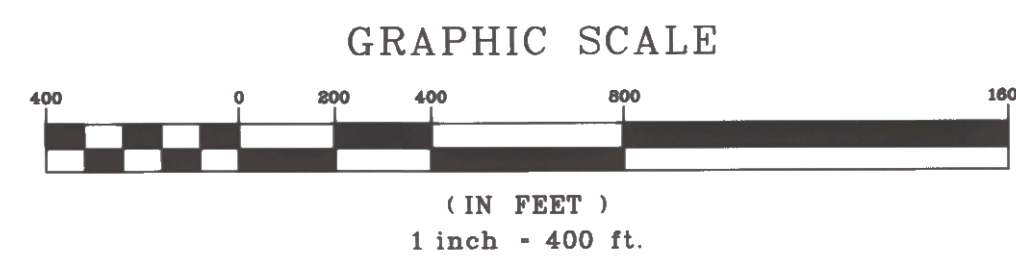

RUNWAY 1-19 PLAN
1" = 400'

LEGEND	
	GROUND PENETRATIONS
	TREES

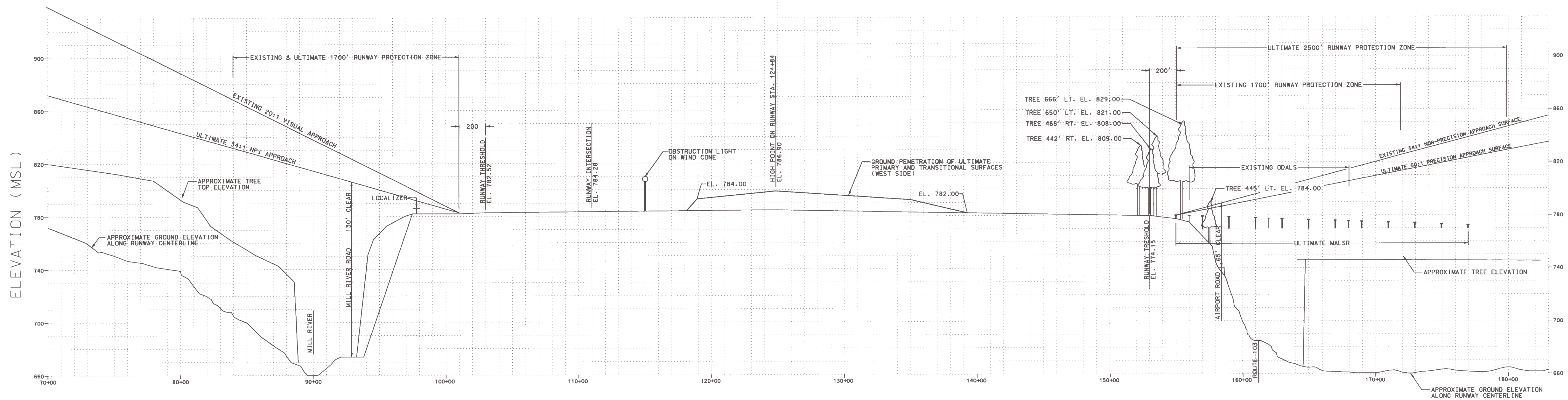

RUNWAY 1-19 PROFILE
HORIZONTAL 1" = 400'
VERTICAL 1" = 40'

RUTLAND STATE AIRPORT CLARENDON, VERMONT	
AIRPORT MASTER PLAN UPDATE RUNWAY 1-19 PLAN PROFILE	URS Greiner 1 NORTHWAY LN. LATHAM, NEW YORK
Job No. F200001719.00 File No.	Designed by: G.W.D. Drawn by: AL BEY Checked by: M.L.C. Approved by: G.W.D.
1/2001 UPGRADE RUNWAY 1 TO NP1 APPROACH REV. DATE DESCRIPTION	Scale: AS SHOWN Date: JAN. 2001 Sheet 40f 10 Drawing No. 4

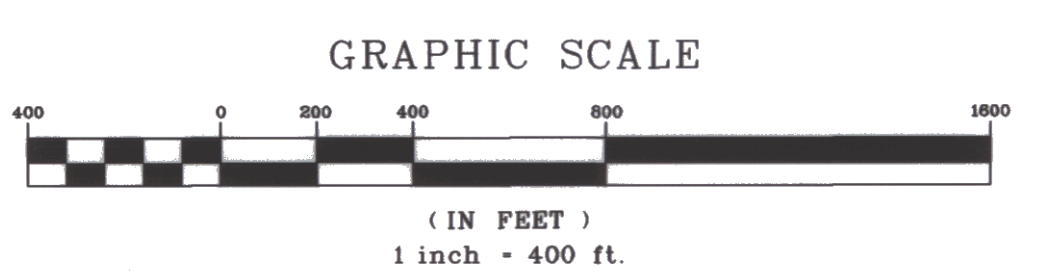
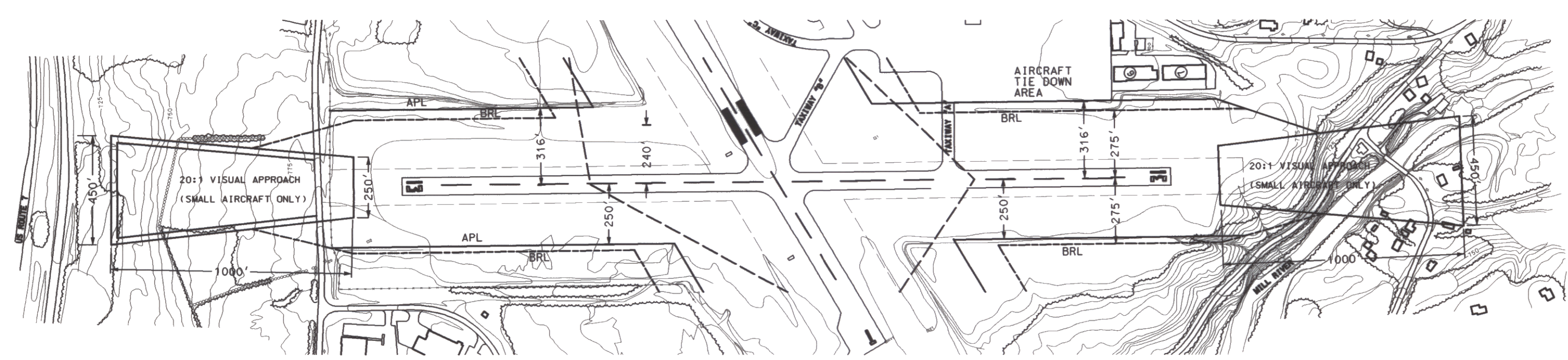
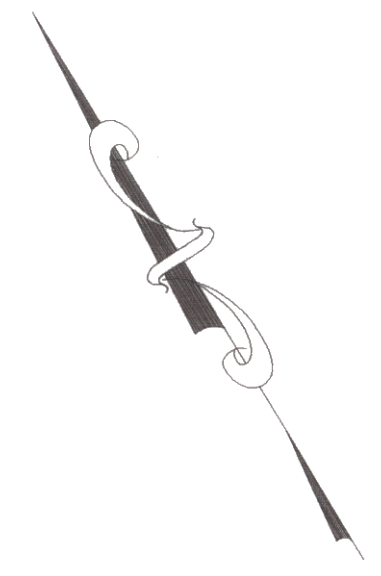

RUNWAY 13-31 PLAN
1" = 400'

NOTES:

1. EXISTING GROUND PROFILE AND CONTOURS WITHIN PLAN VIEW ARE BASED ON AERIAL PHOTOGRAMMETRY, TAKEN IN APRIL 1998, AUGMENTED BY USGS MAPPING.
2. TREE TOP ELEVATIONS BASED ON AIRPORT OBSTRUCTION CHART DATA, (OC-968) PUBLISHED BY NOAA, FEB. 1998.

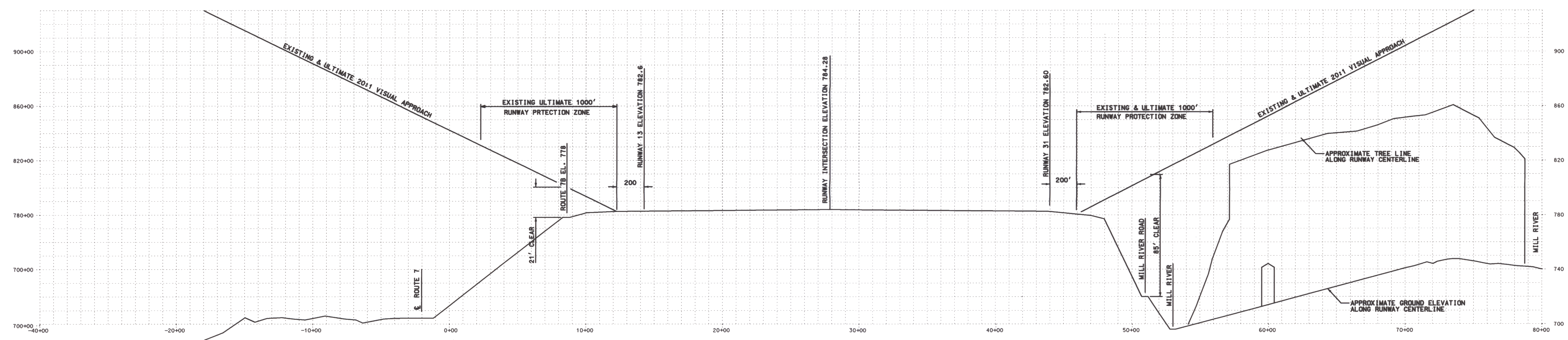

RUNWAY 13-31 PROFILE
HORIZONTAL 1" = 400'
VERTICAL 1" = 40'

RUTLAND STATE AIRPORT CLARENDON, VERMONT							
AIRPORT MASTER PLAN UPDATE RUNWAY 13-31 PLAN PROFILE	Job No. F200001719.00 File No. P19-13-31.DGN						
	<table border="1" style="width: 100%; border-collapse: collapse;"> <thead> <tr> <th style="width: 80%;">REV.</th> <th style="width: 20%;">DATE</th> <th style="width: 100%;">DESCRIPTION</th> </tr> </thead> <tbody> <tr> <td> </td> <td> </td> <td> </td> </tr> </tbody> </table>	REV.	DATE	DESCRIPTION			
REV.	DATE	DESCRIPTION					
<p align="center">1 NORTHWAY LN. LATHAM, NEW YORK</p>							
Designed by: G.W.D.	Approved by: G.W.D.						
Drawn by: AL BEY	Checked by: M.L.C.						
Scale: AS SHOWN							
Date: MARCH, 2002							
Sheet 5 Of 10							
Drawing No							
5							

LEGEND		
ITEM	EXISTING	ULTIMATE
AIRPORT PROPERTY LINE	---	---
MISCELLANEOUS PROPERTY LINE	---	---
CONTOURS (USGS-MSL) DATUM	~700	~700
AIRPORT REFERENCE POINT (A.R.P.)	⊕	⊕
AIRPORT ROTATING BEACON	⊕	⊕
BUILDING RESTRICTION LINE (B.R.L.)	---	---
EASEMENT	---	---
RUNWAYS/TAXIWAYS/APRON	---	---
WATER COURSE	---	---
TREELINE/BRUSH	---	---
SAFETY AREA	---	---
AIRPORT PAVEMENTS	---	---
AIRPORT BUILDINGS	---	---
AUTO PARKING	AS SHOWN	AS SHOWN
TIEDOWNS	AS SHOWN	AS SHOWN
RUNWAY SAFETY AREA LIMITS	---	---
AIRPLANE PARKING LIMITS	---	---
NEW PERIMETER FENCING	---	---
PROPERTY TO BE ACQUIRED	---	---
PROPERTY TO BE TRANSFERRED	---	---

LIGHTING LEGEND	
⊕	EXISTING PARKING LOT LUMINARES
⊕	PROPOSED APRON LIGHTING LUMINARES

AIRPORT BUILDINGS		
IDENTIFIER	DESCRIPTION	
1	FIRE STATION	
2	STATE STORAGE HANGAR	
3	TERMINAL	
4	STORAGE HANGAR	
5	FBO OFFICE & MAINTENANCE HANGAR	
6	STORAGE AND T-HANGARS	
7	T-HANGARS	
8	FUEL FARM	
9	STORAGE HANGAR	
10	FBO MAINTENANCE HANGAR	
11	CIVIL AIR PATROL	

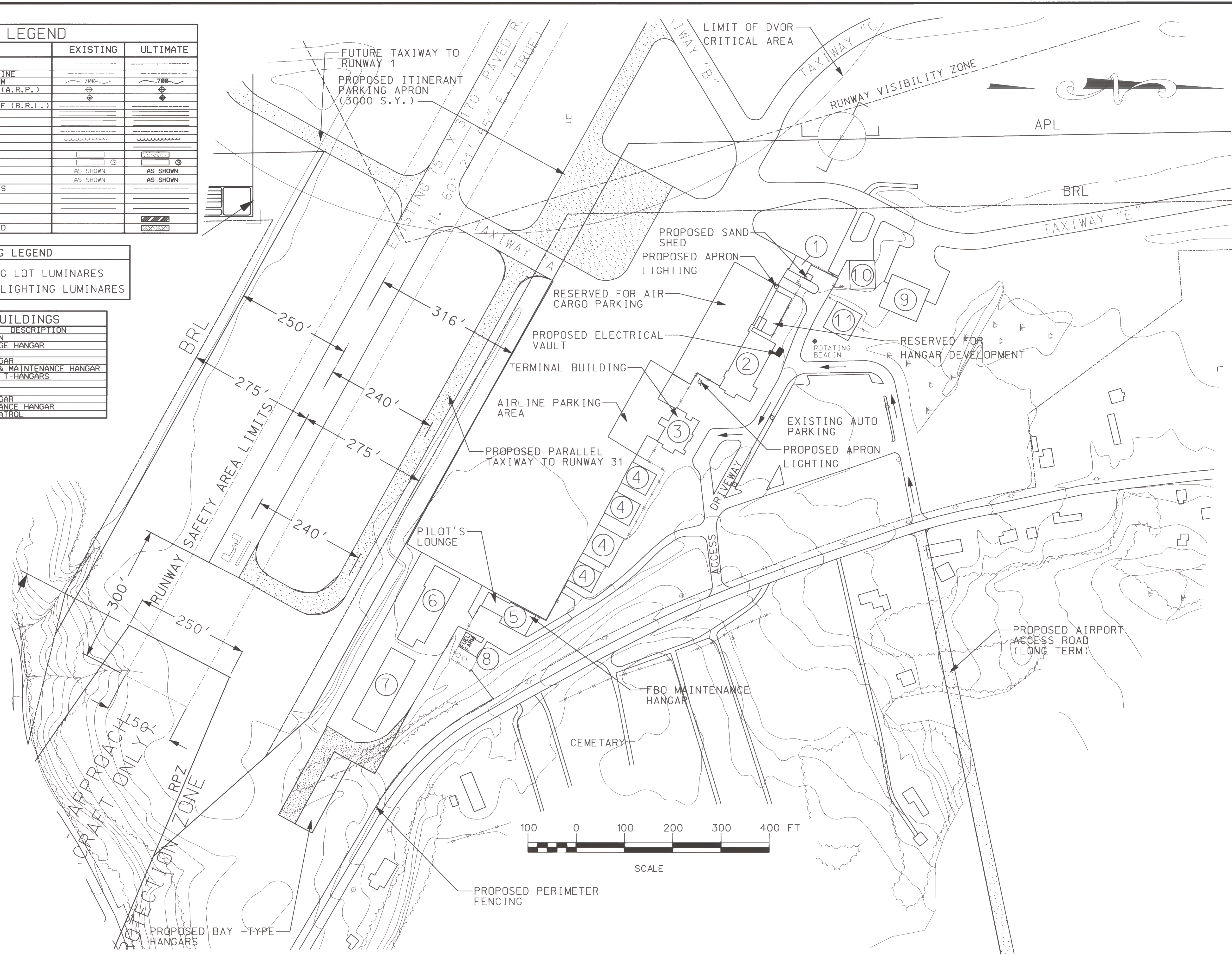

RUTLAND STATE AIRPORT CLARENDON, VERMONT	
1/2001	REV. DATE
EXTEND PARALLEL TAXIWAY	
DESCRIPTION	
AIRPORT MASTER PLAN UPDATE	
TERMINAL & SUPPORT AREA PLAN "A"	
File No.	
Job No. F20000719.00	
URS Greiner 1 NORTHWAY LN. LATHAM, NEW YORK	
Designed by: G.W.D.	Drawn by: AL BEY
Checked by: M.L.C.	Approved by: G.W.D.
Scale: 1" = 100'	
Date: JAN. 2001	
Sheet 80f 10	
Drawing No.	
6	

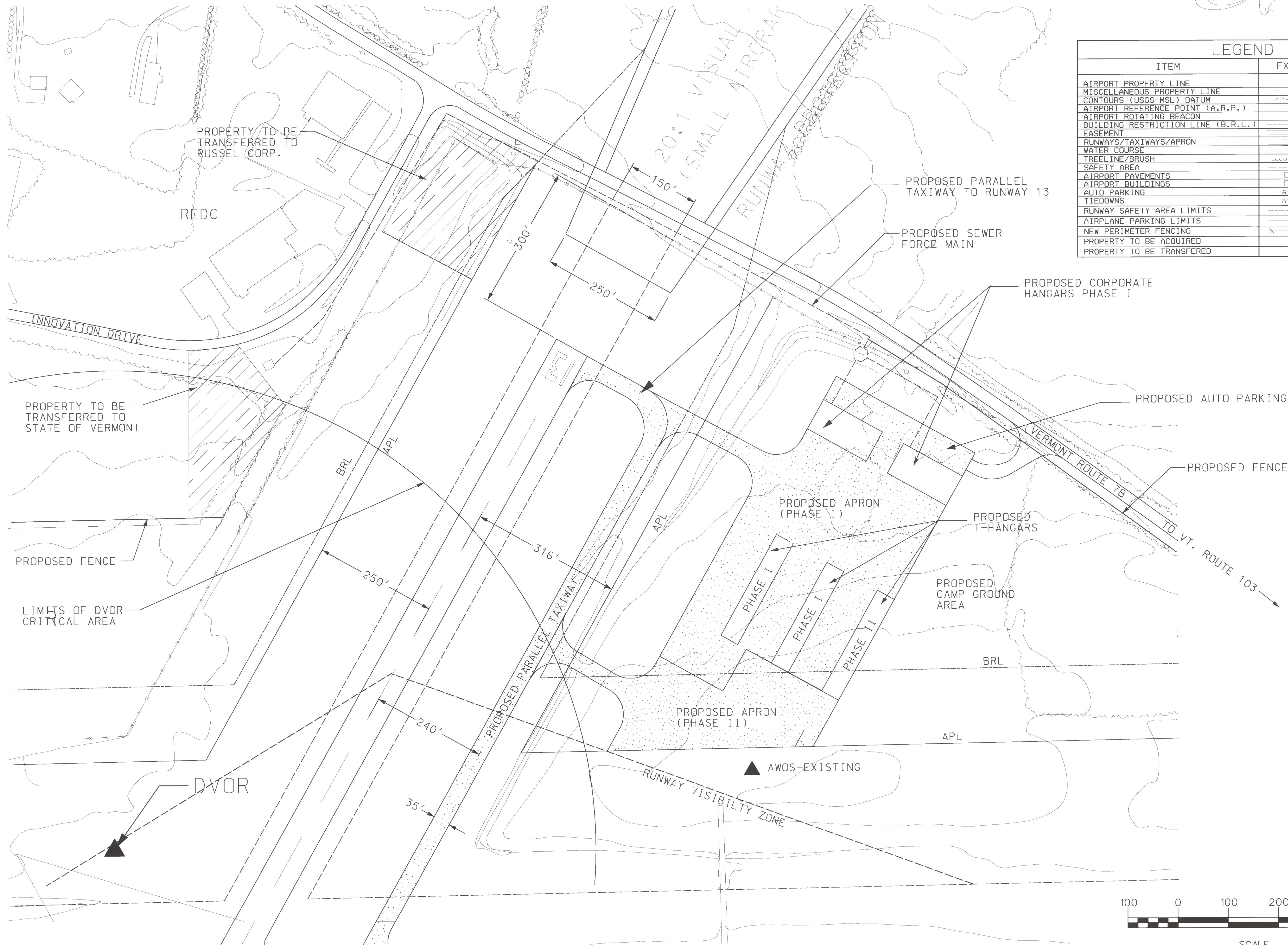

LEGEND		
ITEM	EXISTING	ULTIMATE
AIRPORT PROPERTY LINE	---	---
MISCELLANEOUS PROPERTY LINE	---	---
CONTOURS (USGS-MSL) DATUM	~700~	~700~
AIRPORT REFERENCE POINT (A.R.P.)	⊕	⊕
AIRPORT ROTATING BEACON	⊕	⊕
BUILDING RESTRICTION LINE (B.R.L.)	---	---
EASEMENT	---	---
RUNWAYS/TAXIWAYS/APRON	---	---
WATER COURSE	---	---
TREELINE/BRUSH	---	---
SAFETY AREA	---	---
AIRPORT PAVEMENTS	---	---
AIRPORT BUILDINGS	---	---
AUTO PARKING	AS SHOWN	AS SHOWN
TIEDOWNS	AS SHOWN	AS SHOWN
RUNWAY SAFETY AREA LIMITS	---	---
AIRPLANE PARKING LIMITS	---	---
NEW PERIMETER FENCING	✕---	✕---
PROPERTY TO BE ACQUIRED	---	---
PROPERTY TO BE TRANSFERRED	---	---

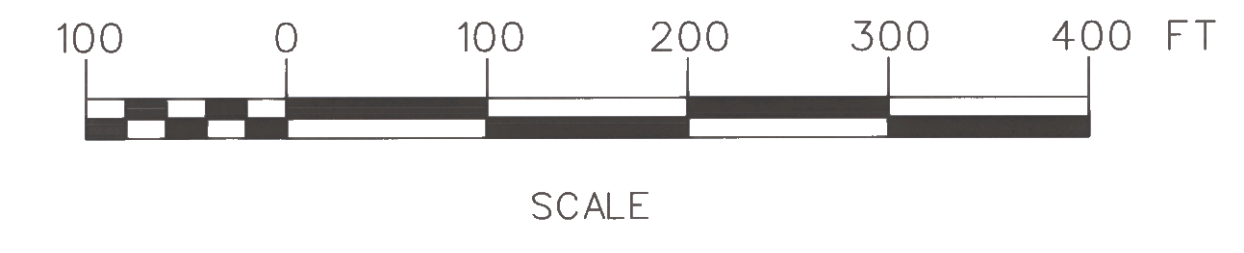

REV.	DATE	DESCRIPTION	File No.
A	1/2001	REVISED TO REFLECT APRON DESIGN	F200001719.00

RUTLAND STATE AIRPORT
CLARENDON, VERMONT

AIRPORT MASTER PLAN UPDATE
TERMINAL & SUPPORT AREA PLAN "B"

URS Greiner
1 NORTHWAY LN.
LATHAM, NEW YORK

Designed by: G.W.D.
Drawn by: AL BEY
Checked by: M.L.C.
Approved by: G.W.D.

Scale: 1" = 100'

Date: JAN. 2001

Sheet 7 of 10

Drawing No.
7

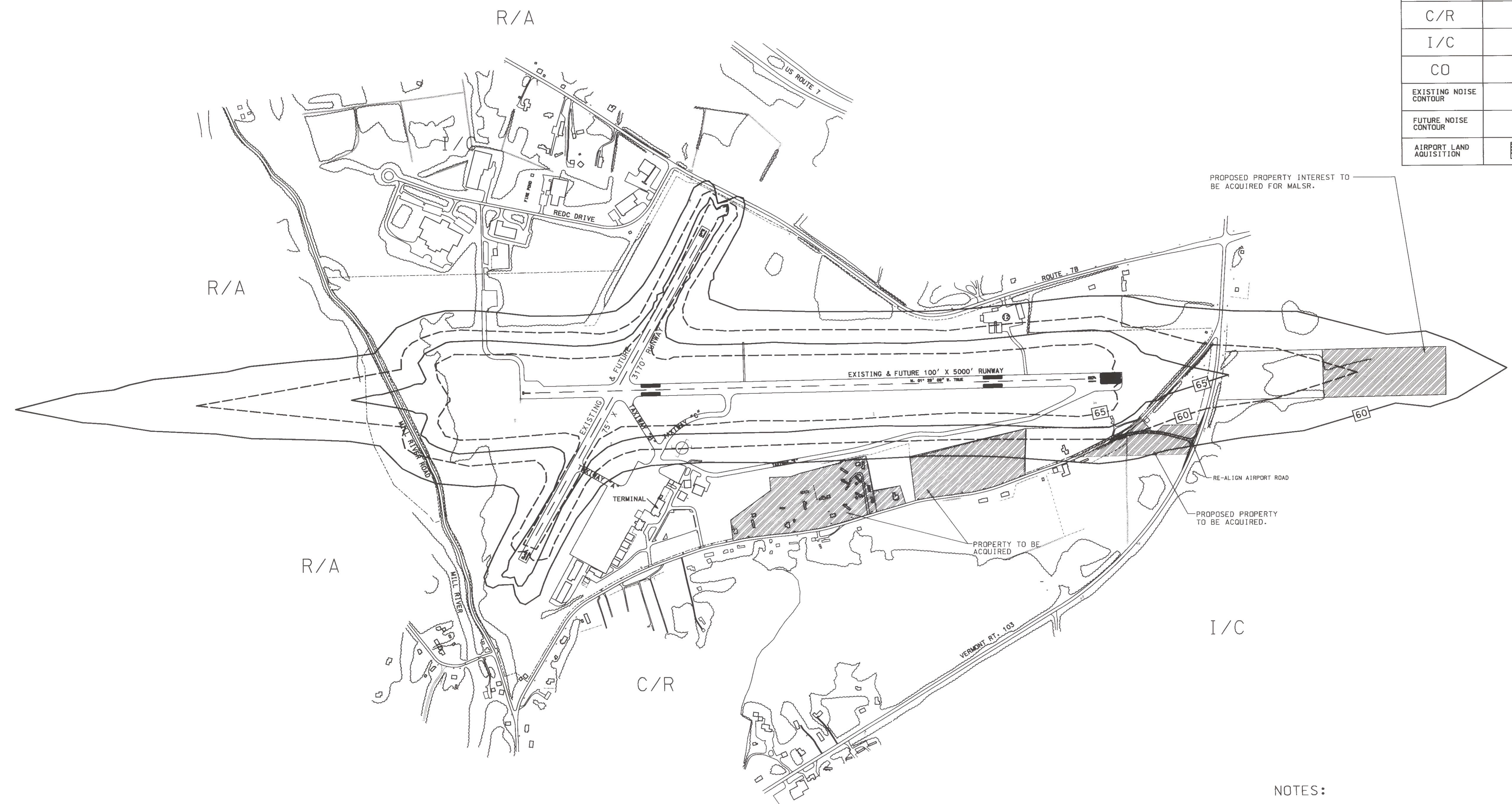
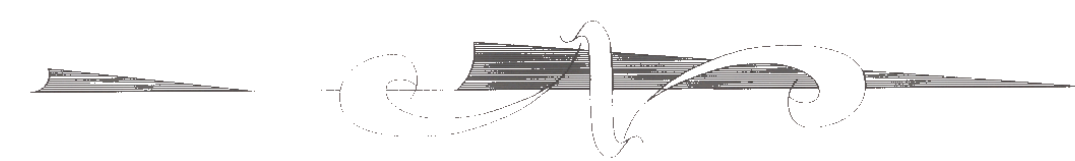

LEGEND	
AIRPORT PROPERTY LINE	-----
GENERALIZED	LAND USE
R/A	RESIDENTIAL AGRICULTURAL
C/R	COMMERCIAL RESIDENTIAL
I/C	INDUSTRIAL COMMERCIAL
CO	CONSERVATION
EXISTING NOISE CONTOUR	---60---
FUTURE NOISE CONTOUR	---65---
AIRPORT LAND ACQUISITION	

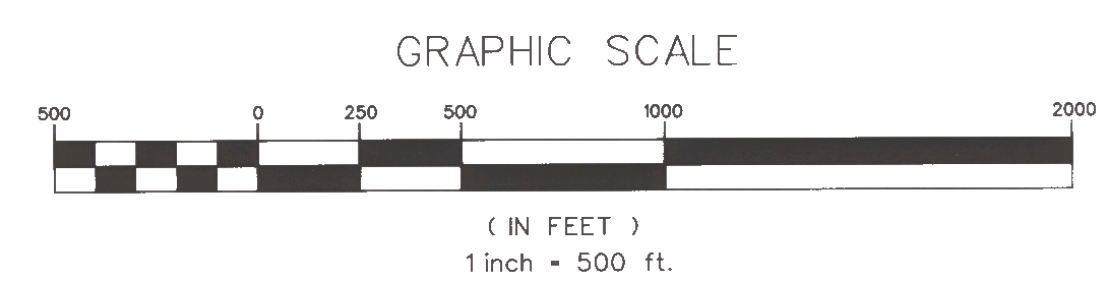

- NOTES:
1. ADJACENT LAND USES BASED ON CLARENDON ZONING MAP AND GENERALIZED LAND USE PLAN FROM CLARENDON TOWN MASTER PLAN BY HTA.
 2. EXISTING AND FUTURE NOISE CONTOURS FROM 1989 AIRPORT MASTER PLAN BY HTA.
 3. REFER TO APPENDIX 5-1, IN AIRPORT MASTER PLAN REPORT FOR DISCUSSION OF NOISE ANALYSIS.

REV.	DATE	DESCRIPTION	FILE NO.

RUTLAND STATE AIRPORT
CLARENDON, VERMONT

AIRPORT MASTER PLAN UPDATE
OFF-AIRPORT LAND USE PLAN

URS Greiner
1 NORTHWAY LN.
LATHAM, NEW YORK

Designed by: G.W.D.
Drawn by: AL BEY
Checked by: M.L.C.
Approved by: G.W.D.

Scale: 1"=500'

Date: JAN. 2000

Sheet 8 of 10

Sheet No
8

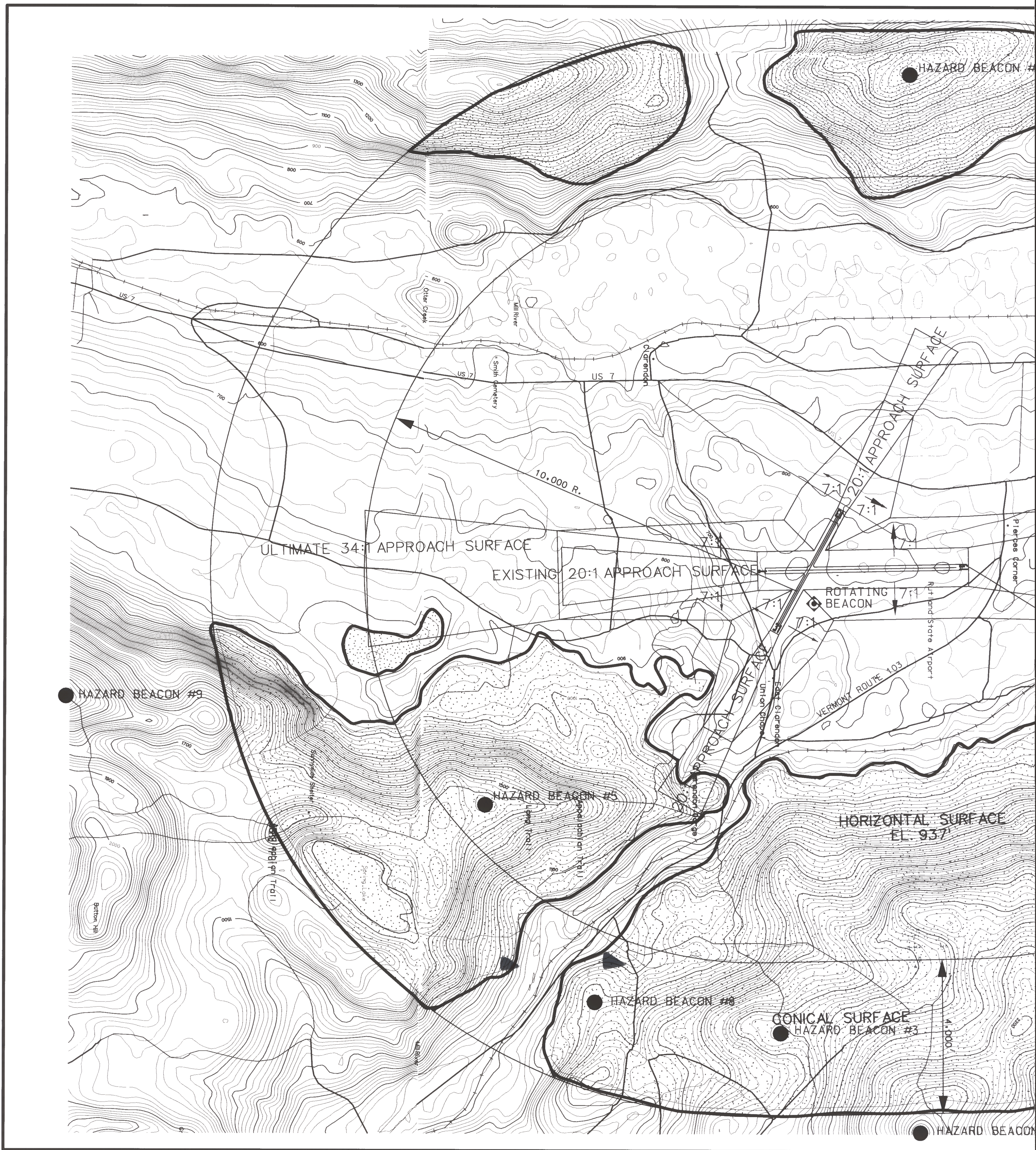

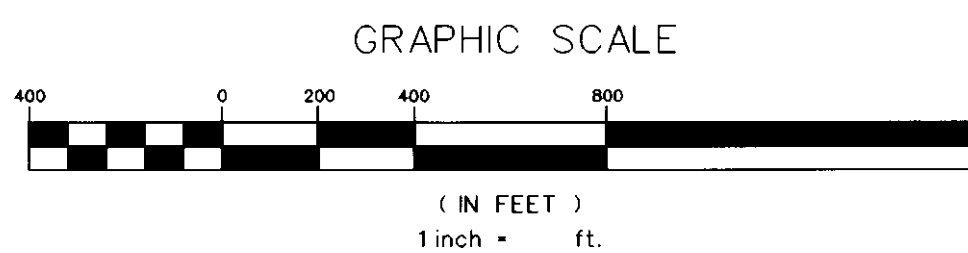
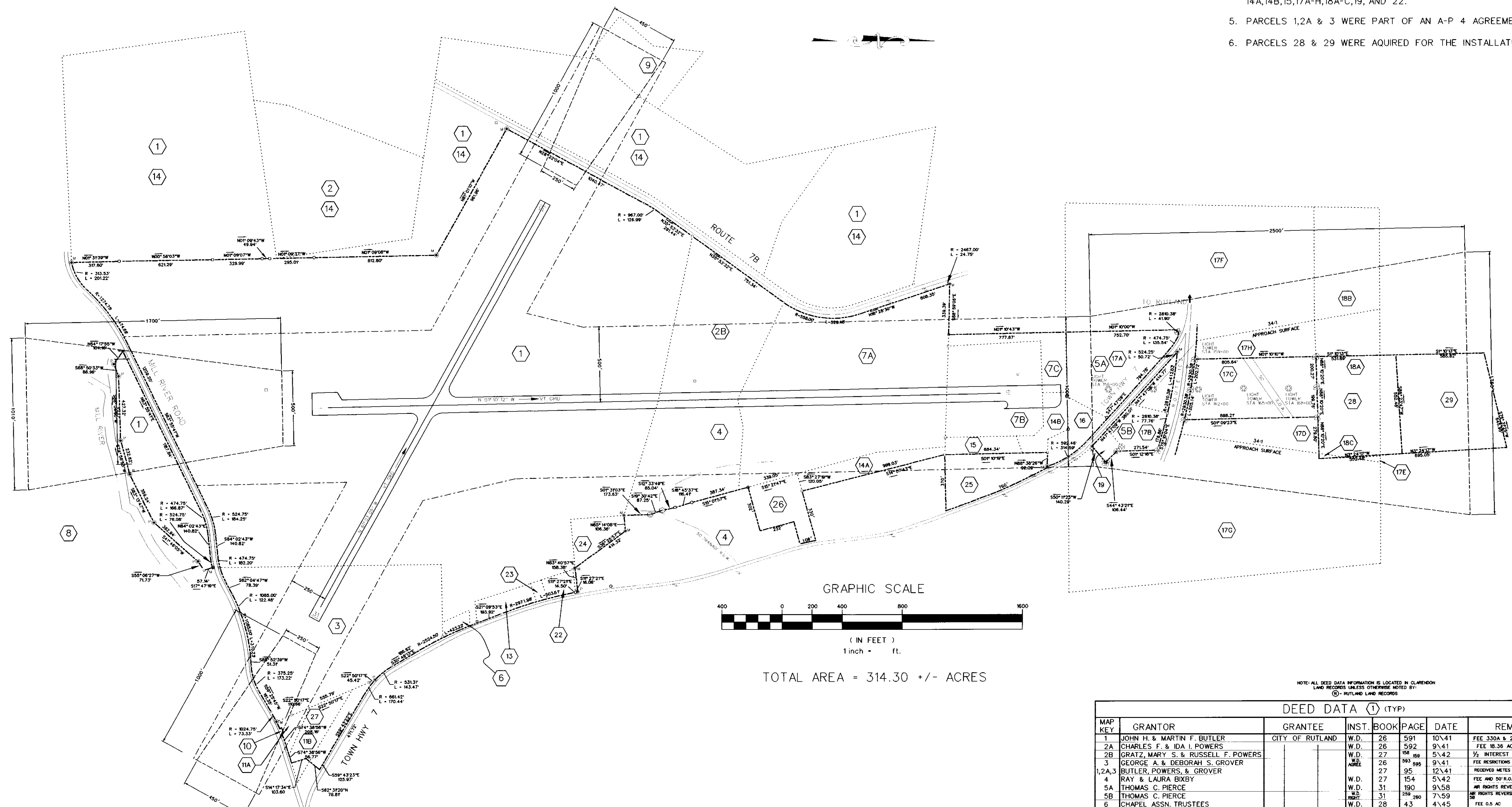

TOTAL AREA = 314.30 +/- ACRES

NOTES

1. BEARINGS REFERENCE STATE PLANE GRID NORTH
2. PROPERTY IS SUBJECT TO EXISTING EASEMENTS AND RIGHTS-OF-WAY OF RECORD
3. THIS PLAN IS AN UPDATE OF A PREVIOUS SURVEY AND EXHIBIT "A" PREPARED BY BRUNO ASSOC., WOODSTOCK, VT DATED 8/8/94
4. PARCELS AND AVIATION EASEMENTS ACQUIRED WITH FEDERAL FUNDS AS A PART OF ADAP PROJECT 6-50-0015-07 ARE... 14A,14B,15,17A-H,18A-C,19, AND 22.
5. PARCELS 1,2A & 3 WERE PART OF AN A-P 4 AGREEMENT
6. PARCELS 28 & 29 WERE ACQUIRED FOR THE INSTALLATION OF THE MALSR.

LEGEND

- EXISTING IRON PIN FOUND
- EXISTING MONUMENT FOUND
- ⊙ EXISTING HWY DISK FOUND
- BOUNDARY POINT
- ⊙ IRON PIN SET
- ⊙ TRESS
- STREAM/ EDGE OF WATER
- BOUNDARY LINE
- PARCEL REFERENCE LINE
- OUT CONVEYANCE
- ① DEED DATA
- ⊙ CONCRETE MONUMENT SET
- ⊙ AVIATION EASEMENT
- BUILDING RESTRICTION LINE
- RUNWAY PROTECTION ZONE

TABLE A
ADDITIONAL REMARKS FROM DEED DATA

ITD	3.66 AC EASEMENT
ITC	0.30 AC EASEMENT
ITF	22.30 AC EASEMENT
ITG	22.30 AC EASEMENT
ITN	3.34 AC EASEMENT
ITM	7.62 AC EASEMENT
ITC	0.08 AC EASEMENT

BEACON ELEVATION LOCATION

NO. 1 AVIATION BEACON	2200	SHRUBS OF EAST MOUNTAIN
NO. 2 AVIATION BEACON	1900	COLD RIVER ROAD OVERBROW
NO. 3 AVIATION BEACON	1740	SHRUBS ON SHREWSBURY
NO. 4 AVIATION BEACON	1600	SHRUBS ON SHREWSBURY
NO. 5 AVIATION BEACON	1500	SHRUBS ON SHREWSBURY
NO. 6 AVIATION BEACON	1300	SHRUBS ON SHREWSBURY
NO. 7 AVIATION BEACON	1200	SHRUBS ON SHREWSBURY
NO. 8 AVIATION BEACON	1100	SHRUBS ON SHREWSBURY
NO. 9 AVIATION BEACON	1000	SHRUBS ON SHREWSBURY
NO. 10 AVIATION BEACON	900	SHRUBS ON SHREWSBURY
NO. 11 AVIATION BEACON	800	SHRUBS ON SHREWSBURY
NO. 12 AVIATION BEACON	700	SHRUBS ON SHREWSBURY
NO. 13 AVIATION BEACON	600	SHRUBS ON SHREWSBURY
NO. 14 AVIATION BEACON	500	SHRUBS ON SHREWSBURY
NO. 15 AVIATION BEACON	400	SHRUBS ON SHREWSBURY
NO. 16 AVIATION BEACON	300	SHRUBS ON SHREWSBURY
NO. 17 AVIATION BEACON	200	SHRUBS ON SHREWSBURY
NO. 18 AVIATION BEACON	100	SHRUBS ON SHREWSBURY
NO. 19 AVIATION BEACON	0	SHRUBS ON SHREWSBURY
NO. 20 AVIATION BEACON	-100	SHRUBS ON SHREWSBURY
NO. 21 AVIATION BEACON	-200	SHRUBS ON SHREWSBURY
NO. 22 AVIATION BEACON	-300	SHRUBS ON SHREWSBURY
NO. 23 AVIATION BEACON	-400	SHRUBS ON SHREWSBURY
NO. 24 AVIATION BEACON	-500	SHRUBS ON SHREWSBURY
NO. 25 AVIATION BEACON	-600	SHRUBS ON SHREWSBURY
NO. 26 AVIATION BEACON	-700	SHRUBS ON SHREWSBURY
NO. 27 AVIATION BEACON	-800	SHRUBS ON SHREWSBURY
NO. 28 AVIATION BEACON	-900	SHRUBS ON SHREWSBURY
NO. 29 AVIATION BEACON	-1000	SHRUBS ON SHREWSBURY

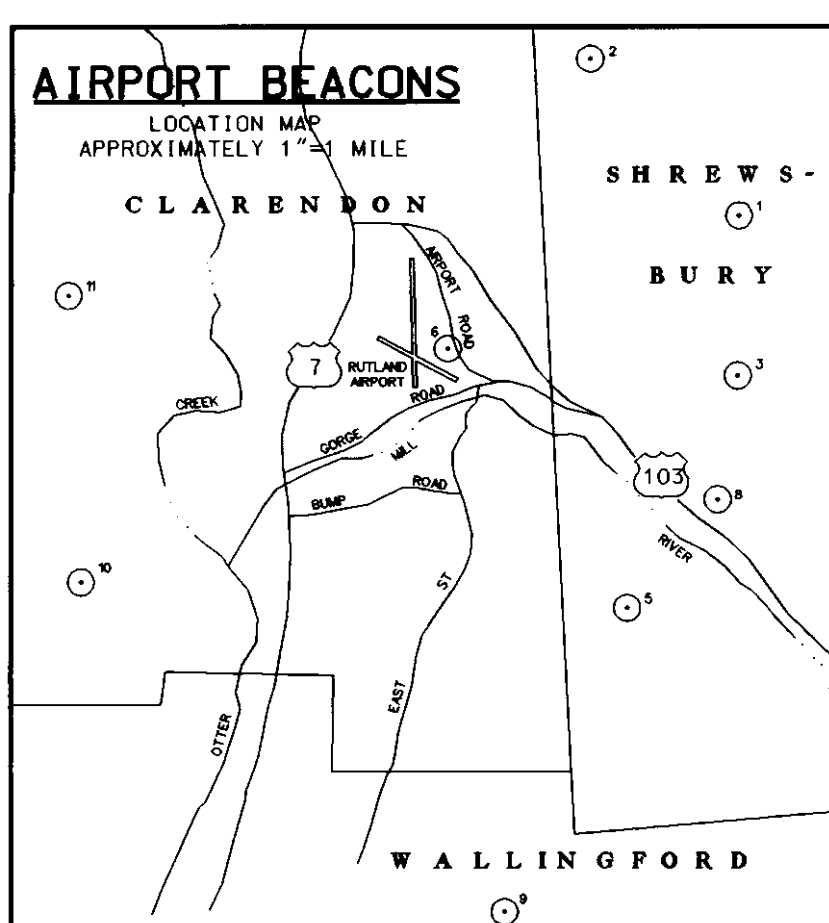

DEED DATA (TYP)

MAP KEY	GRANTOR	GRANTEE	INST.	BOOK	PAGE	DATE	REMARKS
1	JOHN H. & MARTIN F. BUTLER	CITY OF RUTLAND	W.D.	26	591	10/41	FEE 330A & 27A
2A	CHARLES F. & IDA I. POWERS		W.D.	26	592	9/41	FEE 18.36 AC.
2B	GRATZ, MARY S. & RUSSELL F. POWERS		W.D.	27	108	5/42	1/2 INTEREST
3	GEORGE A. & DEBORAH S. GROVER		W.D.	26	593	9/41	FEE RESTRICTIONS ON ADJOINING LAND TO READ
1,2A,3	BUTLER, POWERS, & GROVER		W.D.	27	95	12/41	RECEIVED METES & BOUNDS DESC. DA & AC
4	RAY & LAURA BIXBY		W.D.	27	154	5/42	FEE AND 50' R.O.W. FOR DRAINAGE 0.1/5 AC
5A	THOMAS C. PIERCE		W.D.	31	150	9/58	AP RIGHTS REVERSION CLAUSE
5B	THOMAS C. PIERCE		W.D.	31	258	7/59	AP RIGHTS REVERSION CLAUSE RIGHT TO CUT TREES ON
6	CHAPEL ASSN. TRUSTEES		W.D.	28	43	4/45	FEE 0.5 AC
7A	AMHERST B. & RACHEL C. WEEKS		W.D.	27	156	5/42	FEE 31-1/2 AC. F&M GRANT 5802
7B&C	AMHERST B. & RACHEL C. WEEKS		COND.	31	179	8/58	FENCE MAINTENANCE TO AP RIGHTS F&M GRANT 5802
8	WILLIAM D. & JOYCE C. LIND		RIGHT	31	261	8/59	RIGHT TO CUT TREES
9	VIRGINIA K. FRANTZ		W.D.	31	414	8/61	AP RIGHTS REVERSION CLAUSE 4.2 AC F&M GRANT 5803
10	CLIFFORD H. & IRENE C. HILL		W.D.	32	1	8/61	AP RIGHTS REVERSION CLAUSE RIGHTS TO CUT TREES
11A&B	ARTHUR S. & IRENE C. HILL		W.D.	32	1	8/61	AP RIGHTS REVERSION CLAUSE F&M GRANT 5803
12	EUGENE A. & JUNE FREDETTE	STATE OF VERMONT	COND.	53	428	5/13/85	REVISIONS AP 3-30-008-08
14	CITY OF RUTLAND	STATE OF VERMONT	COND.	53	428	5/13/85	FEE RESTRICTIONS ON ADJOINING LAND TO READ
14A	WILLIAM A. & DORIS H. WEEKS	STATE OF VERMONT	COND.	53	428	5/13/85	F&M APPROVED RELEASE 5/8/81
14B	WILLIAM A. & DORIS H. WEEKS						2.5 AC FEE ADAP 6-50-0015-07 0.08 AC EASEMENT
15	THOMAS S. WILLIAM A. & DORIS H. WEEKS						ADAP 6-50-0015-07 0.03 AC FEE
16	CARROLL C. WEEKS						ADAP 6-50-0015-07 1.32 AC FEE
17A	GILBERT A. ET UX PIERCE						EXISTING PLANTINGS 1.70 AC FEE & 0.3 AC FEE
17B	GILBERT A. ET UX PIERCE						ADAP 6-50-0015-07 2.10 AC FEE
17C	GILBERT A. ET UX PIERCE						ADAP 6-50-0015-07 2.10 AC FEE
17D-H	GILBERT A. ET UX PIERCE						ADAP 6-50-0015-07 2.10 AC FEE
18A	HENRY & ILSE VERGI						AP RIGHTS ADAP 6-50-0015-07 0.08 AC EASEMENT
18B&C	HENRY & ILSE VERGI						AP RIGHTS 7.15 PLANE ADAP 6-50-0015-07 0.08 AC EASEMENT
19	STEVEN H. & DENISE M. SEYFRIED		WARR	85	472	8/28/89	7.15 PLANE ADAP 6-50-0015-07 0.08 AC EASEMENT
19	STEVEN H. & DENISE M. SEYFRIED		WARR	85	472	8/28/89	AP 3-30-008-08 0.02 AC FEE
20	C.V.P.S.						UTILITY
21	NEW ENGLAND TEL.						UTILITY
22	CARL S. & RITA K. START ESTATE	STATE OF VERMONT	W.D.	82	72	8/30/84	ADAP 07
23	GEORGE L. JR. & NALDA B. MERRILL		W.D.	55	399	1/23/86	APPROVED 0.33 AC FEE
24	CITY OF RUTLAND	BUTLER BROTHERS	LOC	26	588	10/41	27A DEEDED IN BUTLER BROTHERS
25	VT AERONAUTICS BD		W.D.	34	264	8/69	ALL OF AIRPORT & RIGHTS
26	DYER ESTATE	STATE OF VERMONT	T.D.	24	584	2/77	RESERVES FIRST REFUSAL BEACON SITE
27	C.V.P.S.	STATE OF VERMONT	LEASE	76	249	10/75	
28	JAYNE M. CONANT	STATE OF VERMONT	WARR	76	249	5/11/93	1.89 AC FEE
29	T.S. & M.A. WEEKS	STATE OF VERMONT	WARR	81	79	6/15/94	4.6 AC FEE
29	H.N. & L.M. STREETER	STATE OF VERMONT	WARR	83	179	1/25/95	3.1 AC FEE
29	DONALD A. HILL	STATE OF VERMONT	WARR	93	545	12/5/98	1.8 AC FEE W/ 04-3/41
29	HENRY VERGI	STATE OF VERMONT	WARR	103	534	11/15/01	8.3 AC FEE
29	LEO & KATHLEEN BRAUN (ESTATE OF AALANQUETTE)	STATE OF VERMONT	WARR	104	51	11/6/01	8.3 AC FEE

URS Greiner
1 NORTHWAY LN.
LATHAM, NEW YORK

Designed by: G.W.D.
Drawn by: AL BEY
Checked by: M.L.C.
Approved by: G.W.D.

Scale: 1" = 400'

Date: MARCH, 2002

Sheet 10 Of 10

Sheet No 10

RUTLAND STATE AIRPORT
CLARENDON, VERMONT

AIRPORT MASTER PLAN UPDATE
EXHIBIT "A"

REV.	DATE	DESCRIPTION
3/02		ADDED PARCELS 28 & 29

Job No. F200001719.00 File No.