

LEGEND		
ITEM	EXISTING	ULTIMATE
AIRPORT PROPERTY LINE	---	---
MISCELLANEOUS PROPERTY LINE	---	---
CONTOURS (USGS-MSL DATUM)	700	700
AIRPORT REFERENCE POINT (A.R.P.)	⊙	⊙
AIRPORT ROTATING BEACON	⊙	⊙
BUILDING RESTRICTION LINE (B.R.L.)	⊙	⊙
EASEMENT	---	---
RUNWAYS/TAXIWAYS/APRON	---	---
WATER COURSE	---	---
TREELINE/BRUSH	---	---
SAFETY AREA	---	---
AIRPORT PAVEMENTS	---	---
AIRPORT BUILDINGS	---	---
AUTO PARKING	AS SHOWN	AS SHOWN
TIEDOWNS	AS SHOWN	AS SHOWN
RUNWAY SAFETY AREA LIMITS	---	---
AIRPLANE PARKING LIMITS	---	---
NEW PERIMETER FENCING	---	---
PROPERTY TO BE ACQUIRED	---	---
PROPERTY TO BE TRANSFERRED	---	---

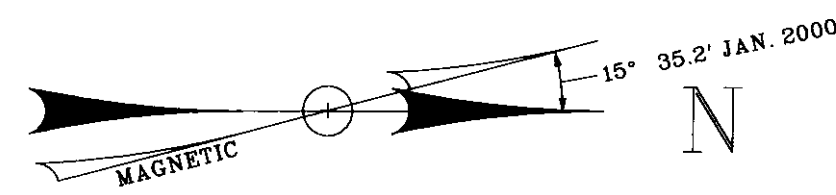

RUNWAY DATA (ULTIMATE)				
RUNWAY	1	19	13	31
RUNWAY LENGTH	5000'			3170'
WIDTH	100'			75'
SAFETY AREA WIDTH	100'			150'
SAFETY AREA LENGTH (BEYOND THRESHOLD)	450'	550'	300'	300'
TAXIWAY WIDTH	35'			35'
SURFACE	BIT CONCRETE			BIT CONCRETE
PAVEMENT STRENGTH	68,000 • DW			12,500 • SW
RUNWAY LIGHTING	MIRLS (EXISTING) MIRLS ULTIMATE			MIRLS
RUNWAY MARKING	NON PRECISION (EXISTING) PRECISION ULTIMATE			PRECISION ULTIMATE
EFFECTIVE GRADIENT	0.25%			0.2%
NAV-AIDS	NONE	GULFSTREAM III	LOC, NDB, DME	NONE
CRITICAL AIRCRAFT AIRPLANE REFERENCE CODE		C-II		
VISUAL AIDS (EXISTING)	NONE	VASI/ODALS/REILS	PAPI	CSSNA CITATION VII
VISUAL AIDS (ULTIMATE)	YASI	VASI/ODALS/REILS	PAPI	B II
RUNWAY END COORDINATES	43° 31' 28.55" N 72° 56' 58.16" W	43° 31' 18.92" N 72° 56' 58.90" W	43° 31' 44.6" N 72° 57' 18.4" W	43° 31' 28.6" N 72° 57' 40.8" W

AIRPORT BUILDINGS	
IDENTIFIER	DESCRIPTION
1	FIRE STATION
2	STATE STORAGE HANGAR
3	TERMINAL
4	STORAGE HANGAR
5	FBO OFFICE & MAINTENANCE HANGAR
6	STORAGE AND T-HANGARS
7	T-HANGARS
8	FUEL FARM
9	STORAGE HANGAR
10	FBO MAINTENANCE HANGAR
11	CIVIL AIR PATROL
12	DISTRICT TRANSPORTATION GARAGE

AIRPORT DATA		
DESCRIPTION	EXISTING	ULTIMATE
AIRPORT ELEVATION	787	787
MEAN MAXIMUM TEMP (HOTTEST MONTH)	80°	80°
COMBINED WIND COVERAGE (12 MPH)	99%	99%
MAGNETIC VARIATION	15.09" W	
AIRCRAFT DESIGN GROUP	II	II
AIRCRAFT APPROACH SPEED	C	C
CRITICAL AIRCRAFT	GULFSTREAM III	GULFSTREAM III
AIRPORT REFERENCE POINT	LAT. 43° 31' 48" N LONG. 72° 56' 59" W	LAT. 43° 31' 48" N LONG. 72° 56' 59" W

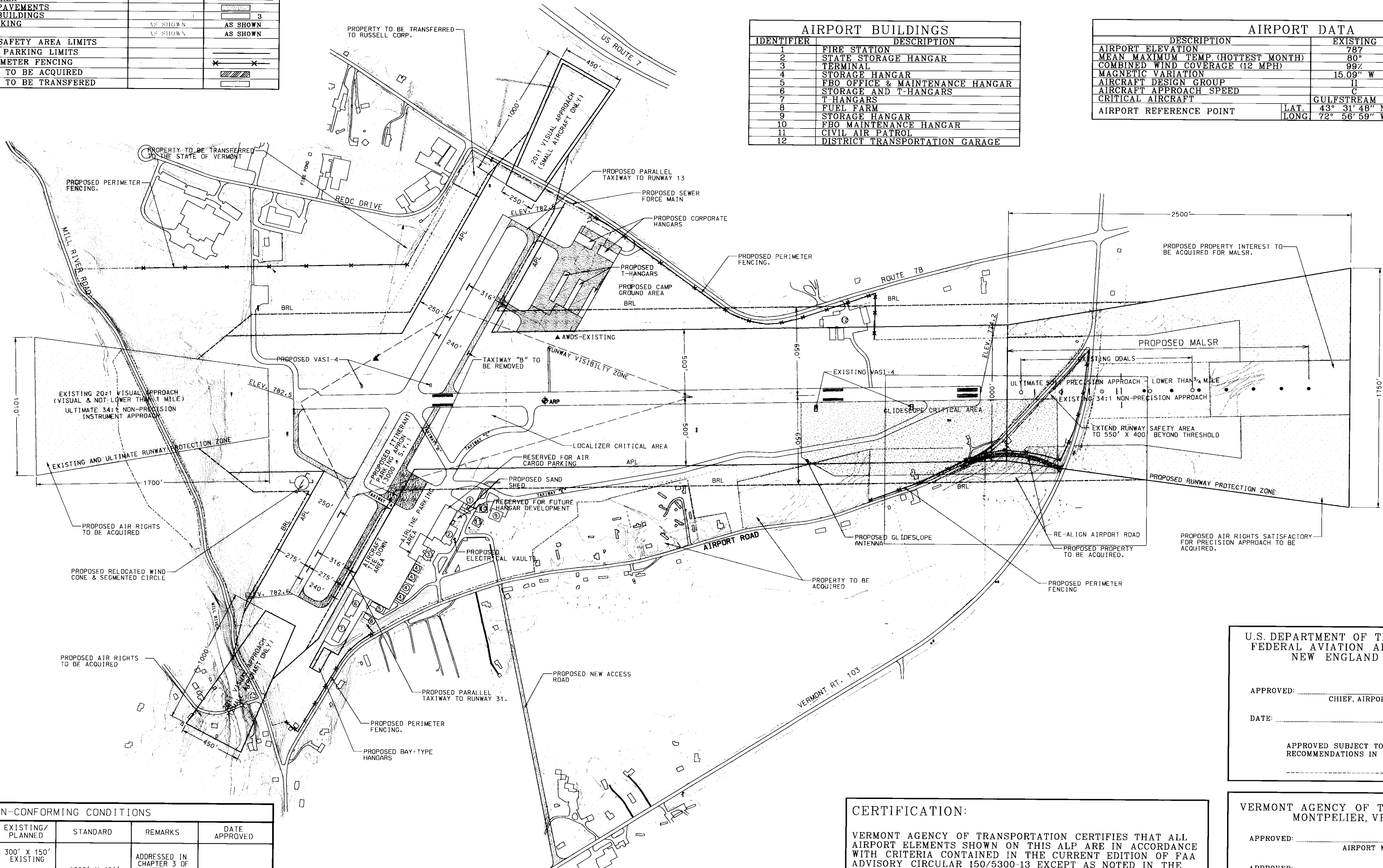

NON-CONFORMING CONDITIONS				
DESCRIPTION	EXISTING/PLANNED	STANDARD	REMARKS	DATE APPROVED
R/W 19 SAFETY AREA	300' X 150' EXISTING 550' X 400' PLANNED	1000' X 400'	ADDRESSED IN CHAPTER 3 OF MASTER PLAN UPDATED JAN. 2001	
R/W 1 SAFETY AREA	450' X 400' EXISTING & PLANNED	1000' X 400'	ADDRESSED IN CHAPTER 3 OF MASTER PLAN	

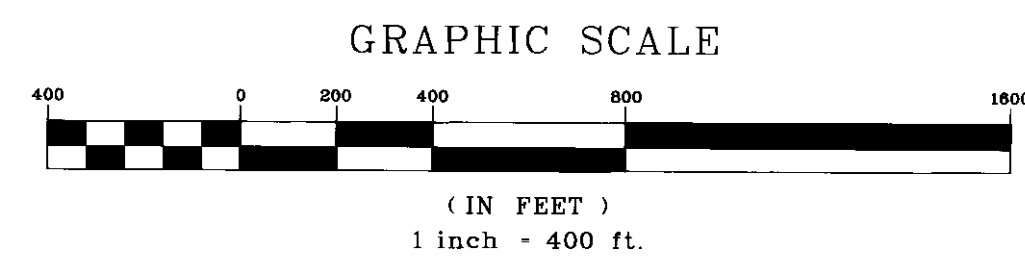

CERTIFICATION:

VERMONT AGENCY OF TRANSPORTATION CERTIFIES THAT ALL AIRPORT ELEMENTS SHOWN ON THIS ALP ARE IN ACCORDANCE WITH CRITERIA CONTAINED IN THE CURRENT EDITION OF FAA ADVISORY CIRCULAR 150/5300-13 EXCEPT AS NOTED IN THE TABLE ENTITLED "NON-CONFORMING CONDITIONS."

NAME: _____ DATE: _____

U.S. DEPARTMENT OF TRANSPORTATION
FEDERAL AVIATION ADMINISTRATION
NEW ENGLAND REGION

APPROVED: _____
CHIEF, AIRPORT DIVISION, FAA

DATE: _____

APPROVED SUBJECT TO COMMENTS AND RECOMMENDATIONS IN LETTER DATED: _____

VERMONT AGENCY OF TRANSPORTATION
MONTPELIER, VERMONT

APPROVED: _____
AIRPORT MANAGER

APPROVED: _____
AVIATION PROGRAM MANAGER

APPROVED: _____
DIRECTOR OF MAINTENANCE AND AVIATION DIVISION

DATE: _____

URS Greiner
1 NORTHWAY LN.
LATHAM, NEW YORK

RUTLAND STATE AIRPORT
CLARENDON, VERMONT

AIRPORT MASTER PLAN UPDATE
AIRPORT LAYOUT PLAN

7/2001	REVISE APPROVAL/CERTIFICATION BLOCK	DATE	DESCRIPTION
1/2001	UPGRADE RUNWAY 1 TO MP APPROACH		
1/2001	REVISED TO REFLECT APRON DESIGN		

Job No. F20000179.00 File No. RUT_ALP.DGN

Designed by: G.W.D.
Drawn by: AL BEY
Checked by: M.L.C.
Approved by: G.W.D.

Scale: 1"=400'
Date: JAN. 2001
Sheet 3 of 10
Sheet No. 3