

NOTES:

- Underground utilities shown hereon are based on utility evidence visible at ground surface and are subject to field verification by excavation. Utilities shown do not purport to constitute or represent all utilities located upon or adjacent to the surveyed premises. All discrepancies shall be reported to the Engineer. The Contractor shall contact Dig Safe (800-225-4977) prior to any construction.
- The Contractor shall maintain as-built plans (with ties) for all underground utilities. Those plans shall be submitted to the Owner at the completion of the project.
- The Contractor shall repair/restore all disturbed areas (on or off the site) as a direct or indirect result of the construction.
- All grassed areas shall be maintained until full vegetation is established.
- Maintain all trees outside of construction limits.
- The Contractor shall be responsible for all work necessary for complete and operable facilities and utilities.
- The Contractor shall submit shop drawings for all items and materials incorporated into the site work. Work shall not begin on any item until shop drawing approval is granted.

- In addition to the requirements set in these plans and specifications, the Contractor shall complete the work in accordance with all permit conditions and any local Public Works Standards.
- The tolerance for finish grades for all pavement, walkways and lawn areas shall be 0.1 feet.
- Any dewatering necessary for the completion of the sitework shall be considered as part of the contract and shall be the Contractor's responsibility.
- Existing pavement and tree stumps to be removed shall be disposed of at an approved off-site location. All pavement cuts shall be made with a pavement saw.
- If there are any conflicts or inconsistencies with the plans or specifications, the Contractor shall contact the Engineer for verification before work continues on the item in question.
- Locations of tank equipment, hose reel, card reader & electrical conduits shall be coordinated with actual tank layout plan from Fuel Tech Inc.

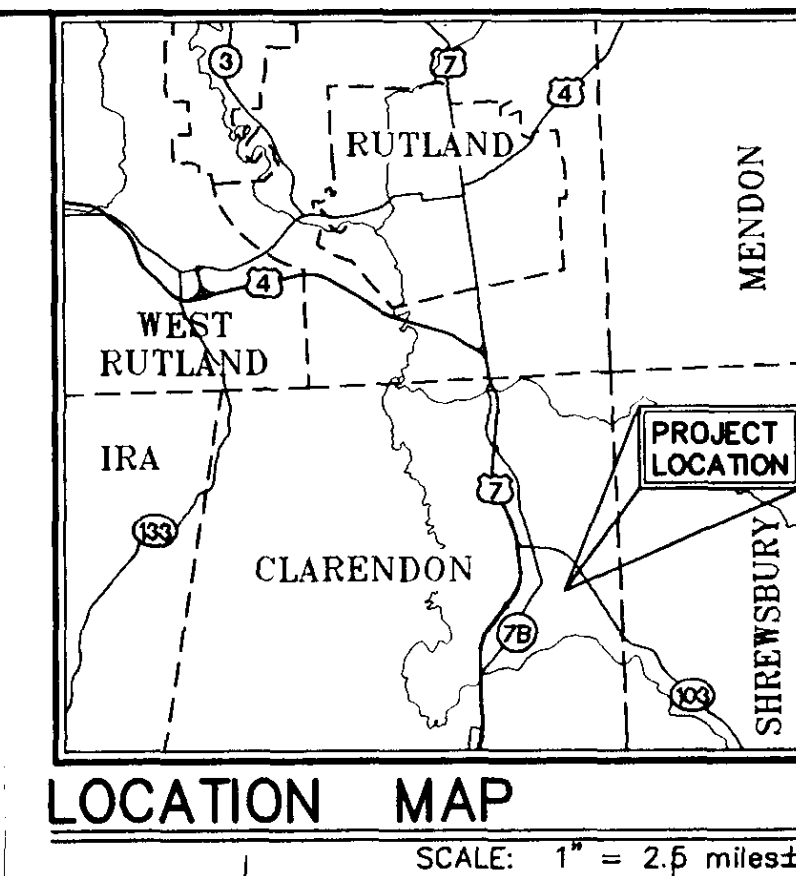

SITE ENGINEER:

 CIVIL ENGINEERING ASSOCIATES, INC.
 P.O. BOX 485 SHELBURNE, VT 05482
 802-985-2323 FAX: 802-985-2271 web: www.cea-vt.com
 COPYRIGHT © 2002 - ALL RIGHTS RESERVED

DRAWN: PJM
 CHECKED: BCE
 APPROVED: BCE

OWNER:

STATE OF VERMONT
 DEPARTMENT OF BUILDINGS AND GENERAL SERVICES
 MONTPELIER, VERMONT

PROJECT:
RUTLAND AIRPORT TANK FARM
 RUTLAND, VERMONT

DATE	CHECKED	REVISION

PROPOSED CONDITIONS PLAN

DATE: MAY, 2004
 SCALE: 1" = 30'
 PROJ. NO.: 04128.03
 DRAWING NUMBER: **C1**

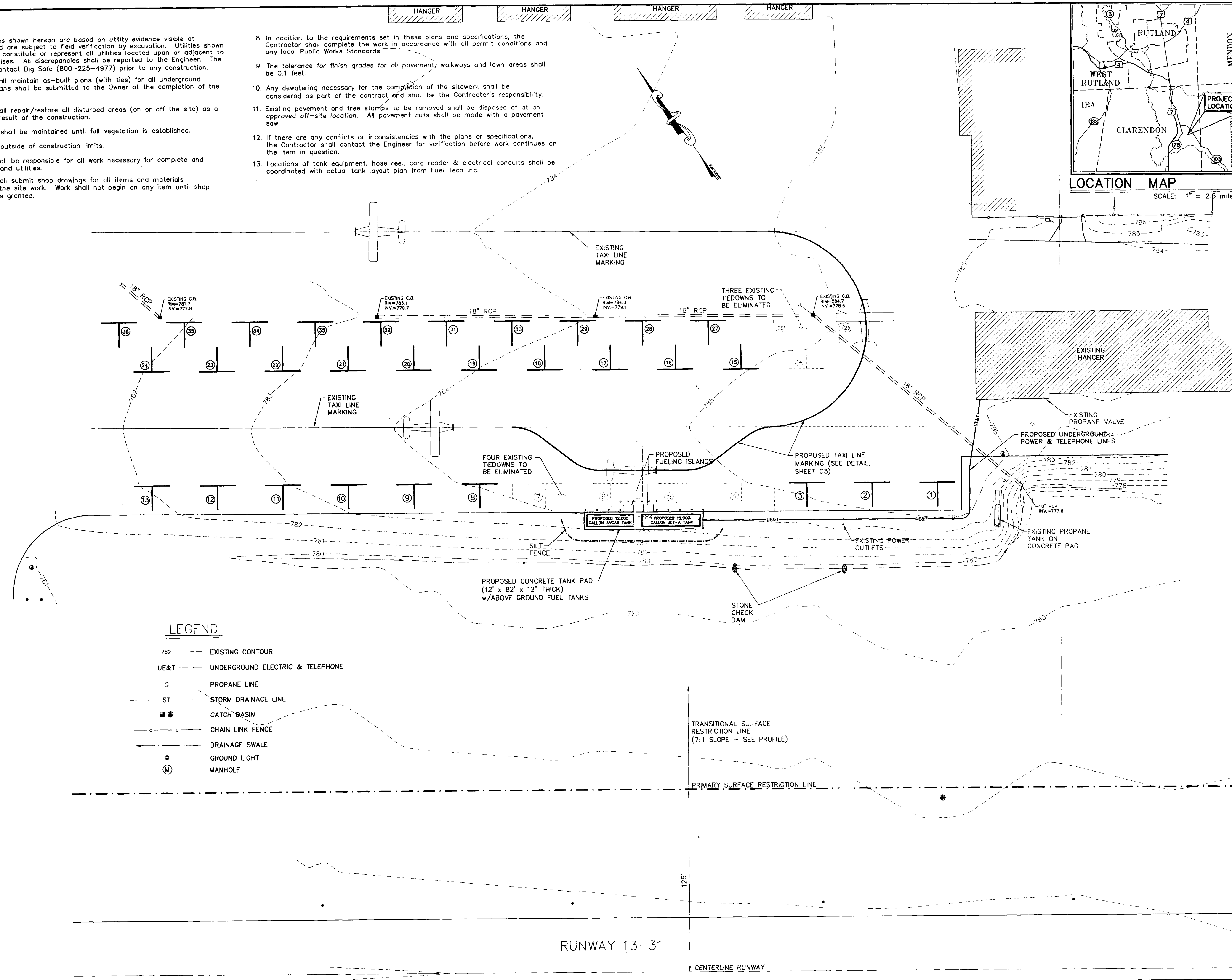

LEGEND

--- 782 ---	EXISTING CONTOUR
--- UE&T ---	UNDERGROUND ELECTRIC & TELEPHONE
G	PROPANE LINE
--- ST ---	STORM DRAINAGE LINE
■ ●	CATCH BASIN
--- ○ ---	CHAIN LINK FENCE
--- ○ ---	DRAINAGE SWALE
●	GROUND LIGHT
Ⓜ	MANHOLE