

AIRPORT LAYOUT PLAN UPDATE

HARTNESS STATE AIRPORT SPRINGFIELD, VERMONT

MAY 2000

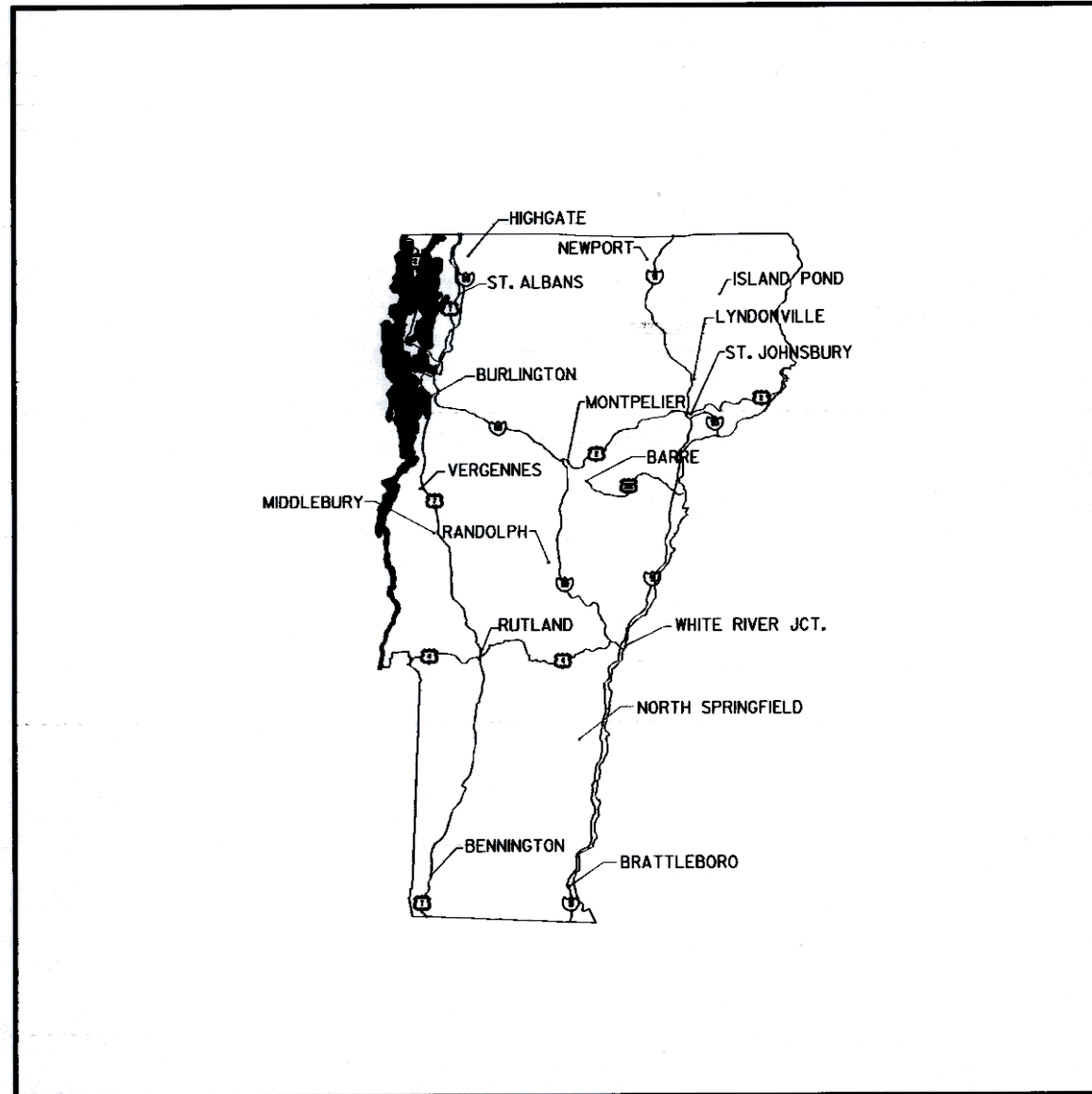

LOCATION MAP

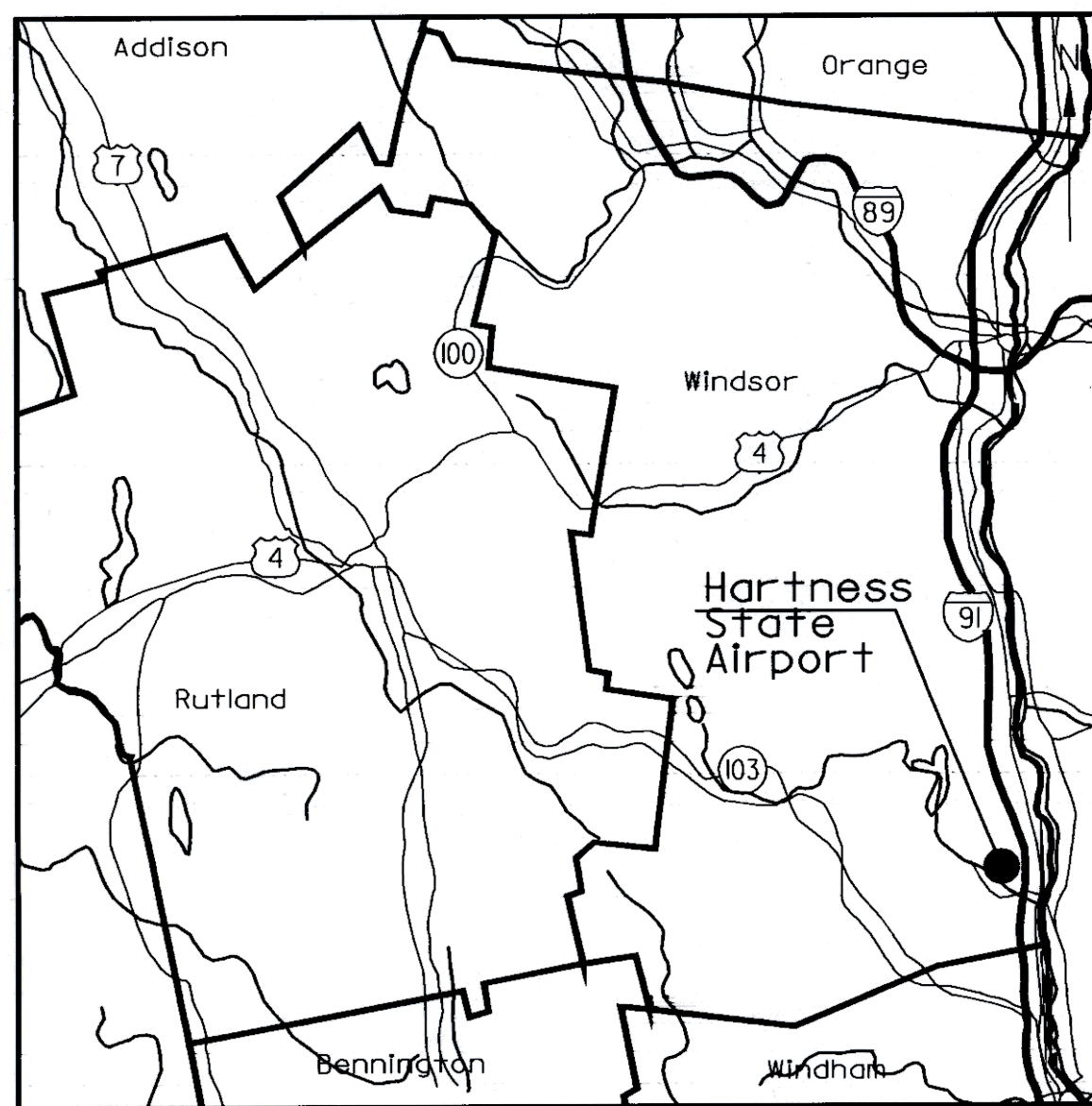

VICINITY MAP

SHEET	TITLE
1	COVERSHEET
2	EXISTING ALP
3	ULTIMATE ALP
4	TERMINAL AREA PLAN
5	PLAN & PROFILE
6	FAR PART 77
7	LAND USE PLAN

INDEX OF SHEETS

OFFICES:
 No. Springfield, Vermont
 Montpelier, Vermont
 Manchester, New Hampshire
 Portland, Maine
 Westford, Massachusetts
 Greenfield, Massachusetts
 Boston, Massachusetts
 Sarasota, Florida
 Naples, Florida
 Saratoga Springs, New York
 Webster-Martin division
 So. Burlington, Vermont

ENGINEERING DISCIPLINES
 Civil
 Electrical
 Environmental
 Industrial
 Mechanical
 Solid Waste
 Structural
 Transportation
 Wastewater
 Water

ASSOCIATED DISCIPLINES
 Construction Management
 Site Assessments
 Surveying
 APPLIED SCIENCES
 Geologic
 Hydrologic
 Water Quality



AIRPORT DATA	EXISTING
AIRPORT ELEVATION	578.3'
AIRPORT REFERENCE POINT	N 43°20' 35" W 72°31' 05"
MEAN MAX. TEMP. (HOTTEST MO.)	80° F
TAXIWAY LIGHTING	--
TAXIWAY MARKING	--
AIRPORT/TERMINAL NAVAIDS	GPS/VOR
AIRPORT REFERENCE CODE (ARC)	B-II
ACREAGE OWNED IN FEE SIMPLE	353 Acres
ACREAGE OWNED IN EASEMENT	--
USE/OWNERSHIP	General Aviation/State

EXISTING	BUILDINGS
①	Maintenance Hangar / Springfield Aviation
②	48' x 48' Hangar Under Construction
③	Hangar 3 Units
④	T-Hangar
⑤	T-Hangar
⑥	GA Hangar
⑦	Hangar 3 Units
⑧	Prestige Paint Shop Hangar
EXISTING TERMINAL AREA PAVEMENT	
Ⓐ	Main Apron
Ⓑ	Fuel Apron

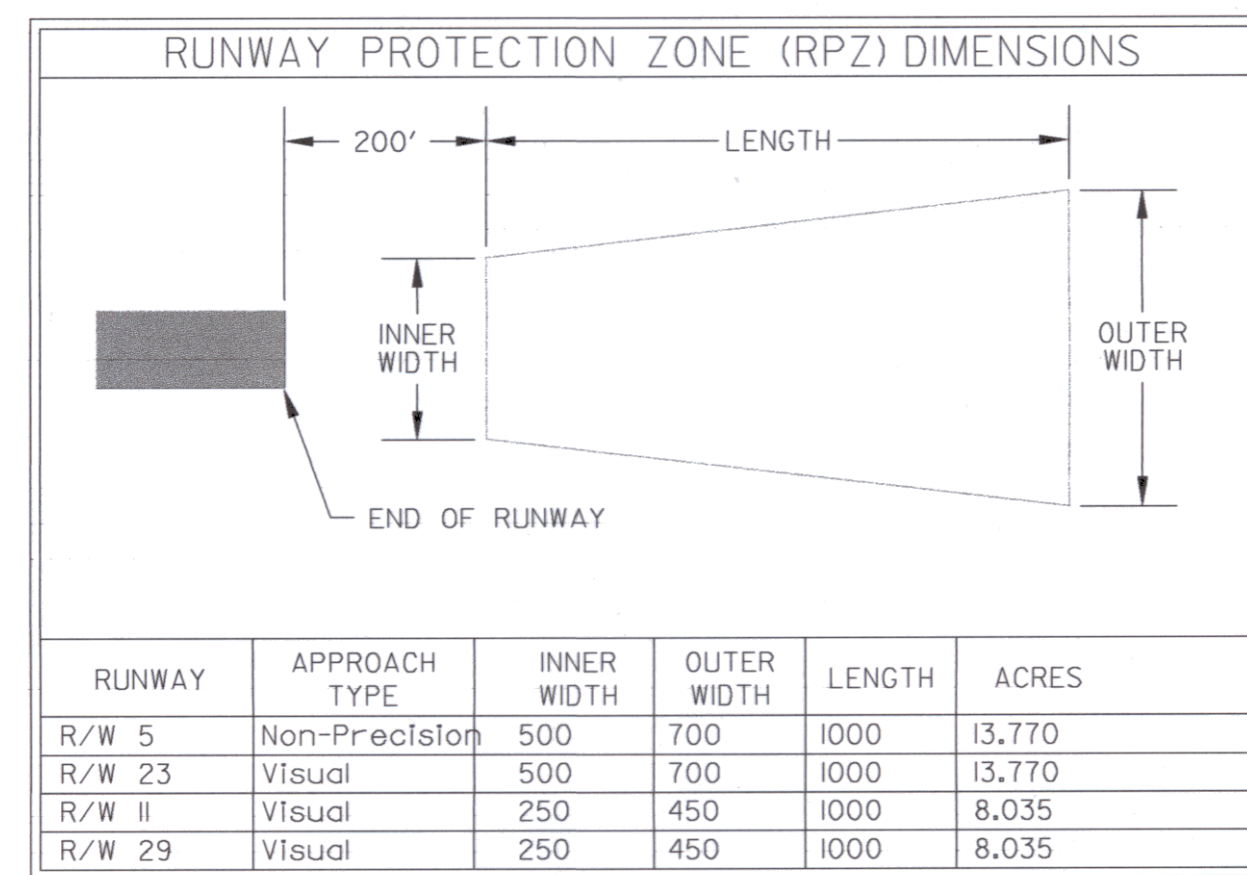

RUNWAY DATA	EXISTING		EXISTING	
	5	23	II	29
PAVEMENT STRENGTH	I2,500 SW	I2,500 SW	I2,500 SW	I2,500 SW
APPROACH SURFACES	Non-Precision 20d	Visual 20d	Visual 20d	Visual 20d
RUNWAY MARKINGS	Non-Precision	Visual	Visual	Visual
RUNWAY LIGHTING	MIRL	MIRL	MIRL	MIRL
RUNWAY NAVAIDS	REIL LOC/DME	None	None	None
EFFECTIVE GRADIENT	0.3%		0.2%	
RUNWAY END ELEVATIONS	571.1	554.4	576.2	569.0
RUNWAY END COORDINATES	N 43°20' 20" W 72°31' 16"	N 43°21' 05" W 72°30' 34"	N 43°20' 30" W 72°31' 35"	N 43°20' 26" W 72°30' 55"
RUNWAY LENGTH	5498'	5498'	3000'	3000'
RUNWAY WIDTH	100'	100'	75'	75'
EXTENDED RSA COMPLIANCE	NO	NO	NO	YES

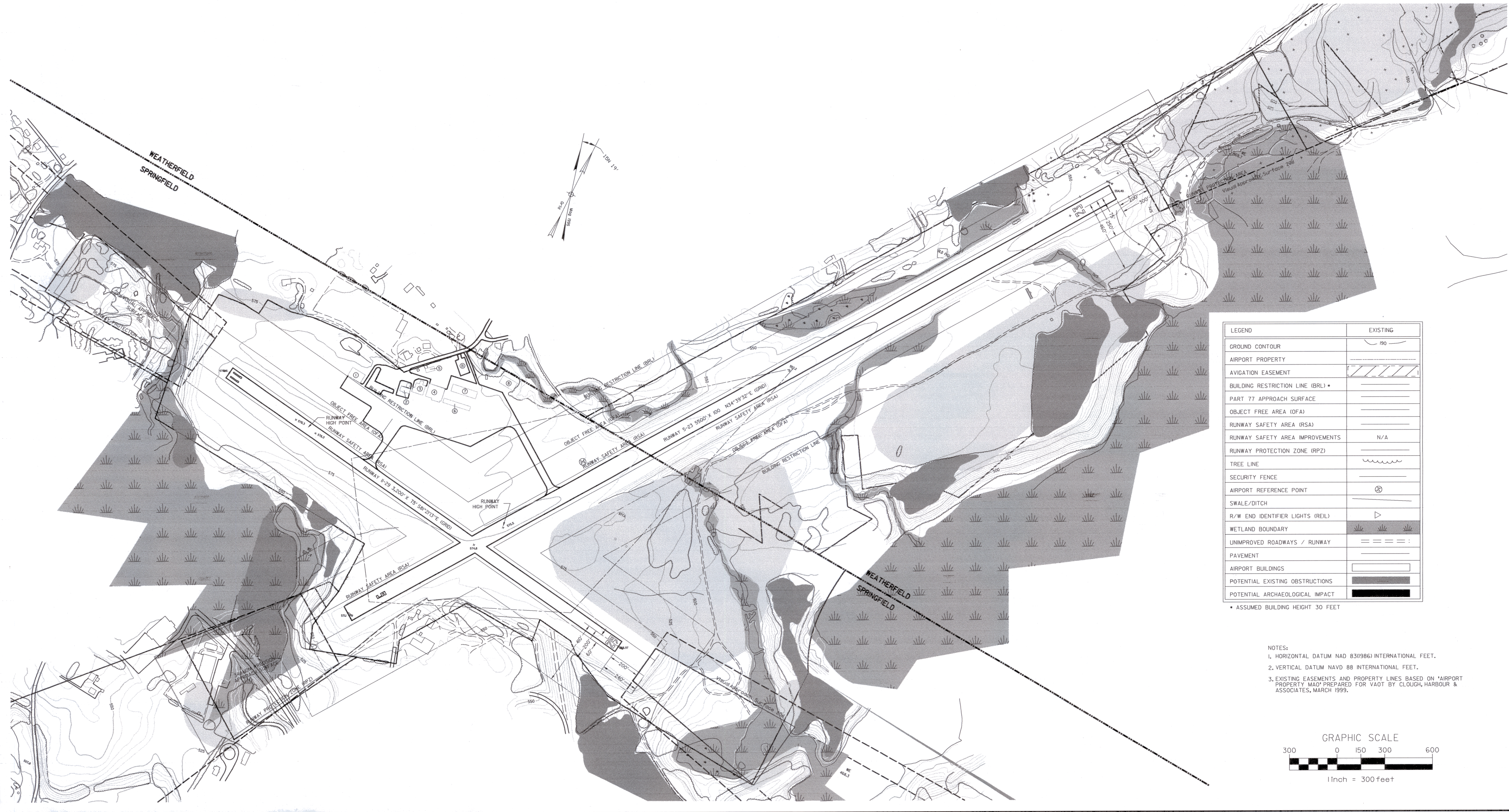

LEGEND	EXISTING
GROUND CONTOUR	190
AIRPORT PROPERTY	[Symbol]
AVIGATION EASEMENT	[Symbol]
BUILDING RESTRICTION LINE (BRL)	[Symbol]
PART 77 APPROACH SURFACE	[Symbol]
OBJECT FREE AREA (OFA)	[Symbol]
RUNWAY SAFETY AREA (RSA)	[Symbol]
RUNWAY SAFETY AREA IMPROVEMENTS	N/A
RUNWAY PROTECTION ZONE (RPZ)	[Symbol]
TREE LINE	[Symbol]
SECURITY FENCE	[Symbol]
AIRPORT REFERENCE POINT	[Symbol]
SWALE/DITCH	[Symbol]
R/W END IDENTIFIER LIGHTS (REIL)	[Symbol]
WETLAND BOUNDARY	[Symbol]
UNIMPROVED ROADWAYS / RUNWAY	[Symbol]
PAVEMENT	[Symbol]
AIRPORT BUILDINGS	[Symbol]
POTENTIAL EXISTING OBSTRUCTIONS	[Symbol]
POTENTIAL ARCHAEOLOGICAL IMPACT	[Symbol]

• ASSUMED BUILDING HEIGHT 30 FEET

NOTES:
 1. HORIZONTAL DATUM NAD 83(986) INTERNATIONAL FEET.
 2. VERTICAL DATUM NAVD 88 INTERNATIONAL FEET.
 3. EXISTING EASEMENTS AND PROPERTY LINES BASED ON AIRPORT PROPERTY MAP PREPARED FOR VAOT BY CLOUGH, HARBOR & ASSOCIATES, MARCH 1999.



Rev.	Description	By	Date

VERMONT

HARTNESS STATE AIRPORT
 EXISTING AIRPORT LAYOUT PLAN

SPRINGFIELD

Project No.	8130014
Project Manager	MC
Project Designer	JMW
Drawn By	GPR
Checked By	MS
Scale	1" = 300'
Approved	[Signature]
Date	11-9-99

AIRPORT DATA	EXISTING	ULTIMATE
AIRPORT ELEVATION	578.3'	
AIRPORT REFERENCE POINT	N 43°20'35" W 72°3'05"	
MEAN MAX. TEMP. (HOTTEST MO.)	80° F	
TAXIWAY LIGHTING	--	
TAXIWAY MARKING	--	
AIRPORT/TERMINAL NAVAIDS	GPS/VOR	
AIRPORT REFERENCE CODE (ARC)	B-II	
ACREAGE OWNED IN FEE SIMPLE	353 Acres	
ACREAGE OWNED IN EASEMENT	--	
USE/OWNERSHIP	General Aviation/State	

EXISTING	ULTIMATE	BUILDINGS
①		Maintenance Hangar / Springfield Aviation
②		48' x 48' Hangar Under Construction
③		Hangar 3 Units
④		T-Hangar
⑤		T-Hangar
⑥		GA Hangar
⑦		Hangar 3 Units
⑧		Prestige Paint Shop Hangar
	⑨	10 Unit T-Hangar
	⑩	Corporate / FBO Hangar
EXISTING	ULTIMATE	TERMINAL AREA PAVEMENT
Ⓐ		Main Apron
Ⓑ		Fuel Apron
	Ⓒ	Hangar Apron / Stub T/W
	Ⓓ	Auto Parking & Access

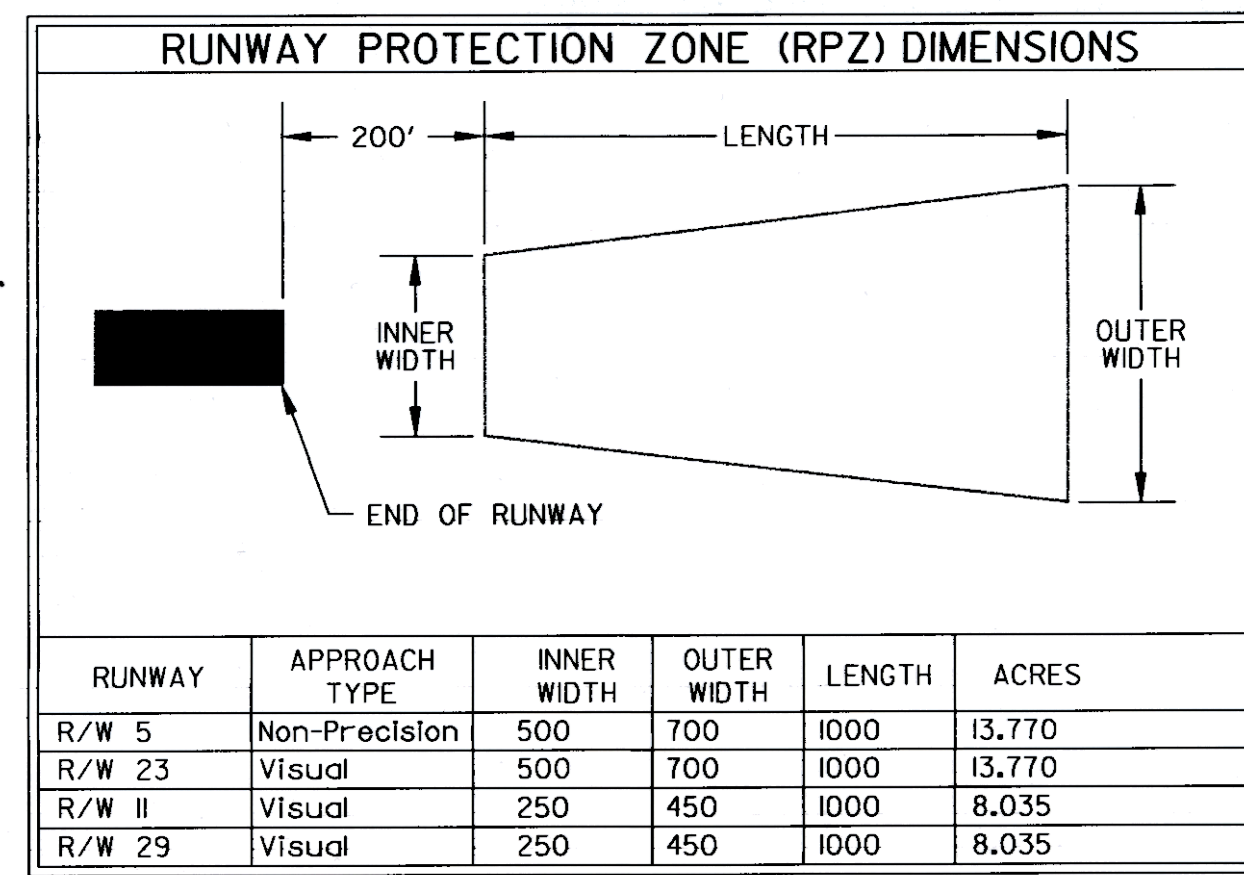

RUNWAY DATA	EXISTING		EXISTING	
	5	23	II	29
PAVEMENT STRENGTH	12,500 SW	12,500 SW	12,500 SW	12,500 SW
APPROACH SURFACES	Non Precision 20ft	Visual 20ft	Visual 20ft	Visual 20ft
RUNWAY MARKINGS	Non Precision	Visual	Visual	Visual
RUNWAY LIGHTING	MIRL	MIRL	MIRL	MIRL
RUNWAY NAVAIDS	REIL LOC/DME	None	None	None
EFFECTIVE GRADIENT	0.32*		0.22*	
RUNWAY END ELEVATIONS	571.1	554.4	576.2	569.0
RUNWAY END COORDINATES	N 43°20'20" W 72°3'16"	N 43°21'05" W 72°30'34"	N 43°20'30" W 72°3'35"	N 43°20'26" W 72°30'55"
RUNWAY LENGTH	5498'	5498'	3000'	3000'
RUNWAY WIDTH	100'	100'	75'	75'
EXTENDED RSA COMPLIANCE	NO	NO	NO	YES

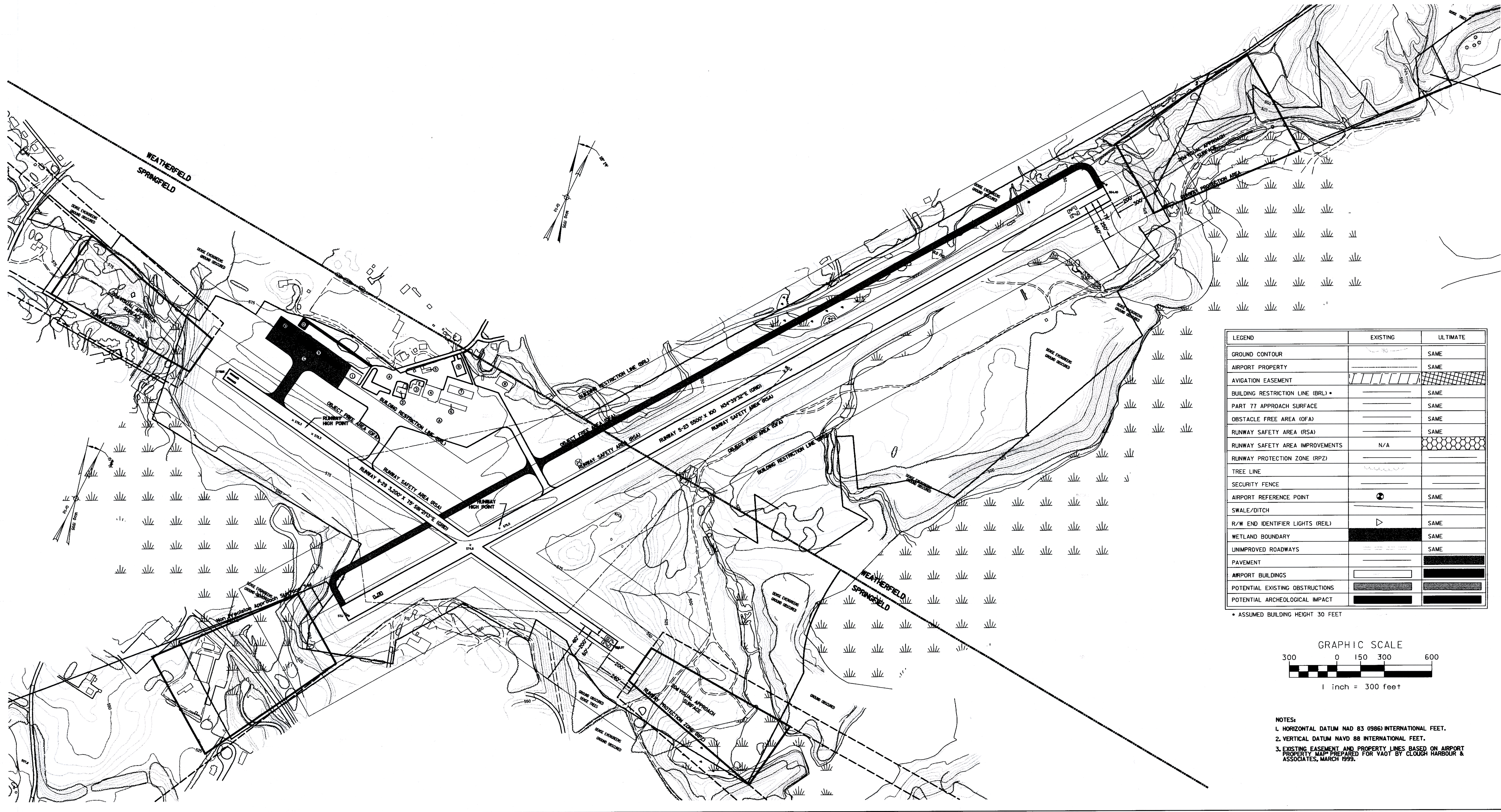

LEGEND	EXISTING	ULTIMATE
GROUND CONTOUR		SAME
AIRPORT PROPERTY		SAME
AVIGATION EASEMENT		
BUILDING RESTRICTION LINE (BRL)		SAME
PART 77 APPROACH SURFACE		SAME
OBSTACLE FREE AREA (OFA)		SAME
RUNWAY SAFETY AREA (RSA)		SAME
RUNWAY SAFETY AREA IMPROVEMENTS	N/A	
RUNWAY PROTECTION ZONE (RPZ)		
TREE LINE		
SECURITY FENCE		
AIRPORT REFERENCE POINT		SAME
SWALE/DITCH		
R/W END IDENTIFIER LIGHTS (REIL)		SAME
WETLAND BOUNDARY		SAME
UNIMPROVED ROADWAYS		SAME
PAVEMENT		
AIRPORT BUILDINGS		
POTENTIAL EXISTING OBSTRUCTIONS		
POTENTIAL ARCHEOLOGICAL IMPACT		

* ASSUMED BUILDING HEIGHT 30 FEET

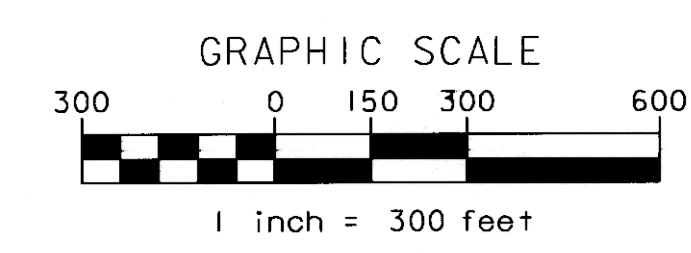

NOTES:
 1. HORIZONTAL DATUM NAD 83 (1986) INTERNATIONAL FEET.
 2. VERTICAL DATUM NAVD 88 INTERNATIONAL FEET.
 3. EXISTING EASEMENT AND PROPERTY LINES BASED ON AIRPORT PROPERTY MAP PREPARED FOR VAOT BY CLOUGH HARBOUR & ASSOCIATES, MARCH 1999.

HARTNESS STATE AIRPORT
 ULTIMATE AIRPORT LAYOUT PLAN

Dufresne-Henry

Project No. 8190014	Project Manager: MC	Project Designer: JMW	Drawn By: GPR	Checked By: MS	Scale: 1"=300'	Approved: [Signature]	Date: 11-9-99
Sheet 3 of 7							Date
							By
							Description
							Rev.
							VERMONT

EXISTING	ULTIMATE	BUILDINGS
①		Maintenance Hangar / Springfield Aviation
②		48' x 48' Hangar Under Construction
③		Hangar 3 Units
④		T-Hangar
⑤		T-Hangar
⑥		GA Hangar
⑦		Hangar 3 Units
⑧		Prestige Paint Shop Hangar
	⑨	10 Unit T-Hangar
	⑩	Corporate / FBO Hangar
EXISTING	ULTIMATE	TERMINAL AREA PAVEMENT
Ⓐ		Main Apron
Ⓑ		Fuel Apron
	Ⓒ	Hangar Apron / Stub T/W
	Ⓓ	Auto Parking & Access

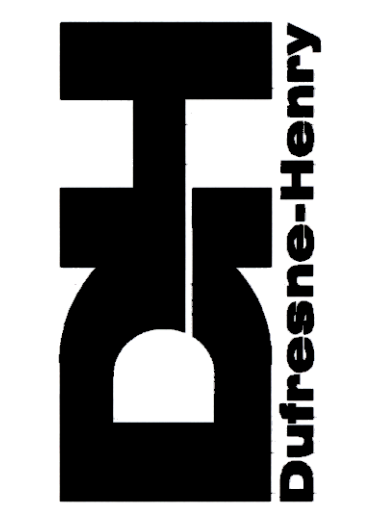
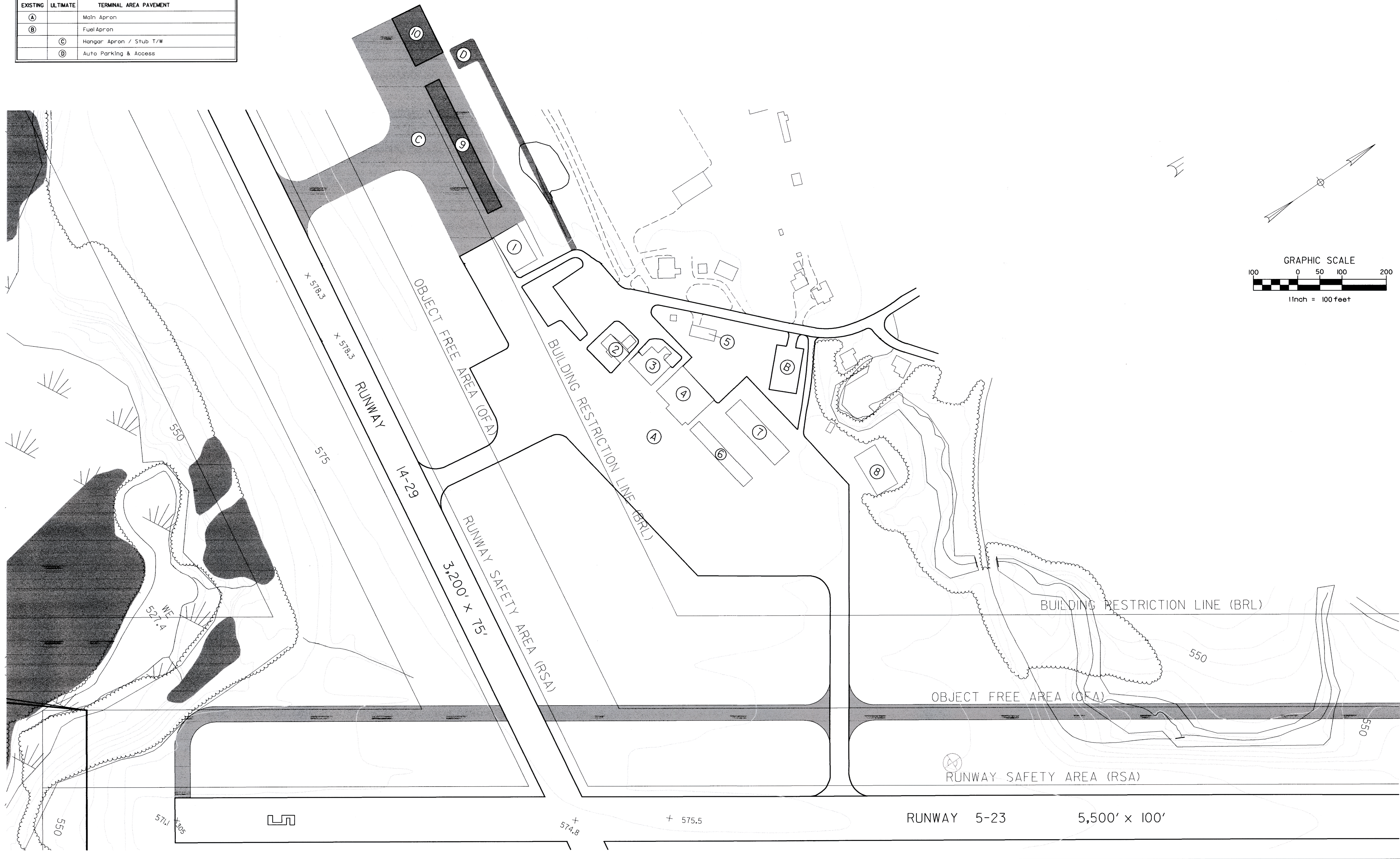

Rev.	Descr	By	Date

VERMONT

HARTNESS STATE AIRPORT
TERMINAL AREA PLAN

SPRINGFIELD

Project No.	8180014
Proj. Manager	MC
Proj. Designer	JW
Drawn By	GPR
Checked By	MS
Scale	1" = 100'
Approved	
Date	9-7-99

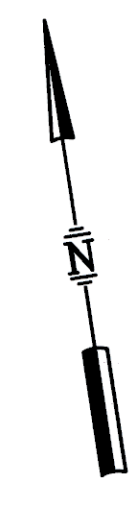
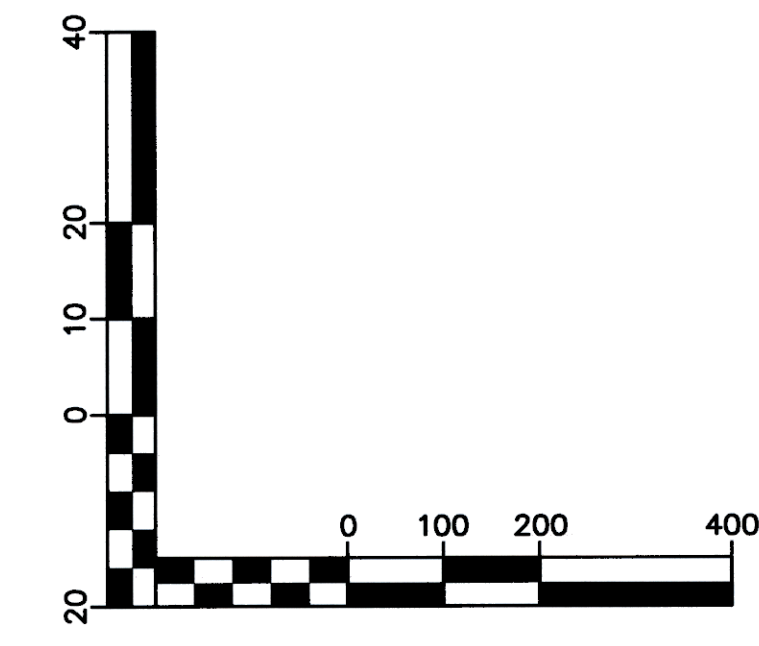
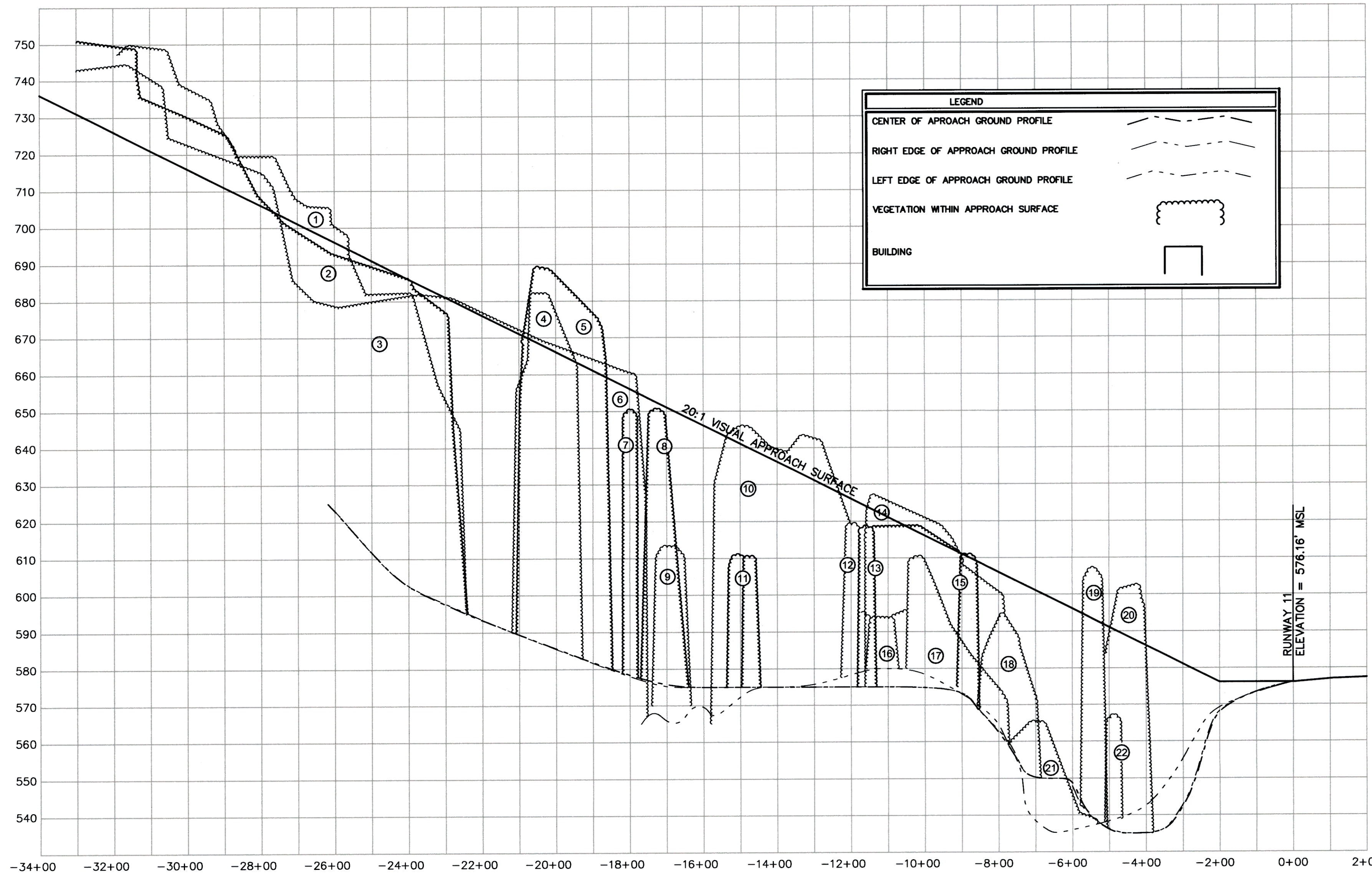
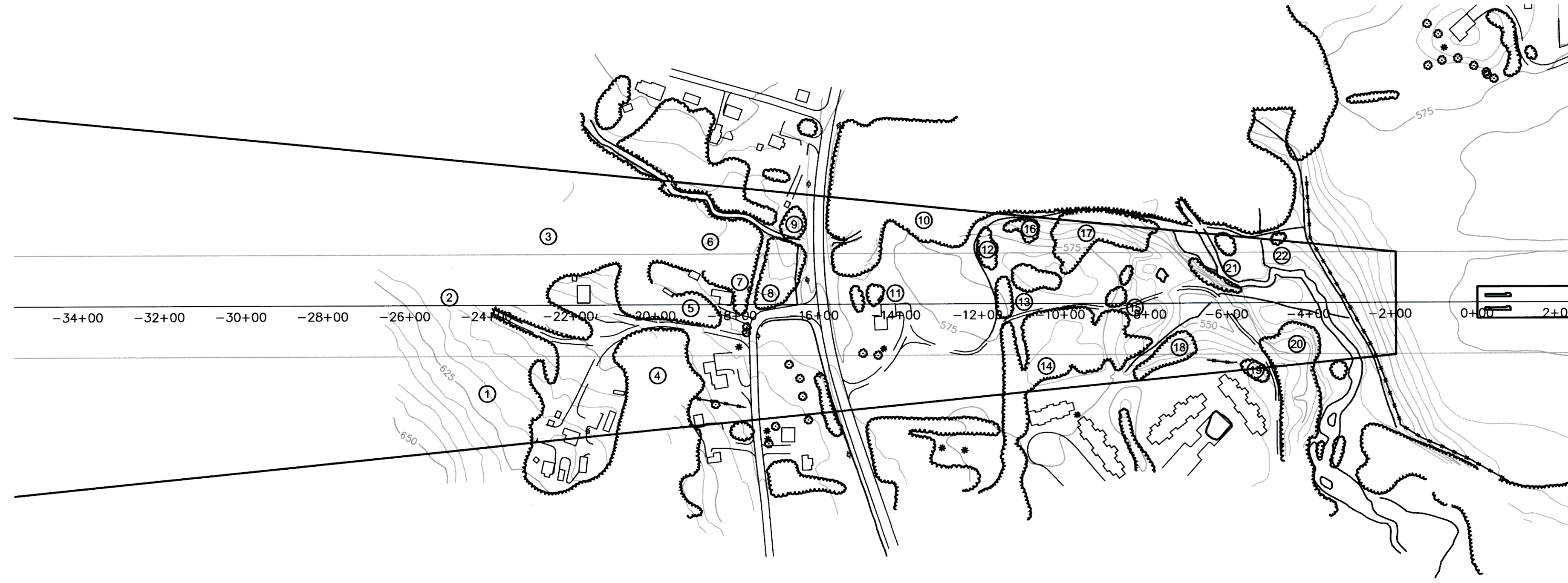

Rev.	Description	By	Date

HARTNESS STATE AIRPORT
RUNWAY 11
F.A.R. PART 77 PLAN AND PROFILE
 VERMONT
 SPRINGFIELD

Project No.	8180014
Proj. Manager	JW
Proj. Designer	JW
Drawn By	MRS
Checked By	JW
Scale	1" = 200'
Approved	
Date	05/00

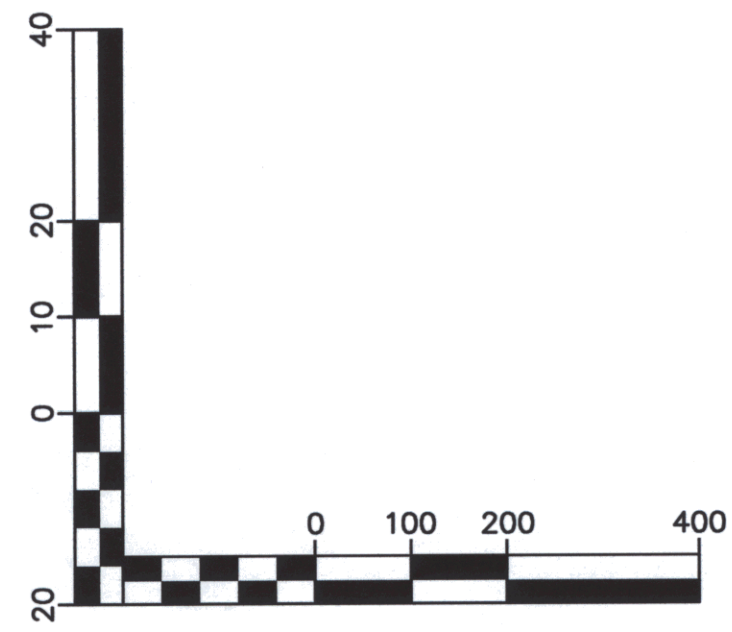
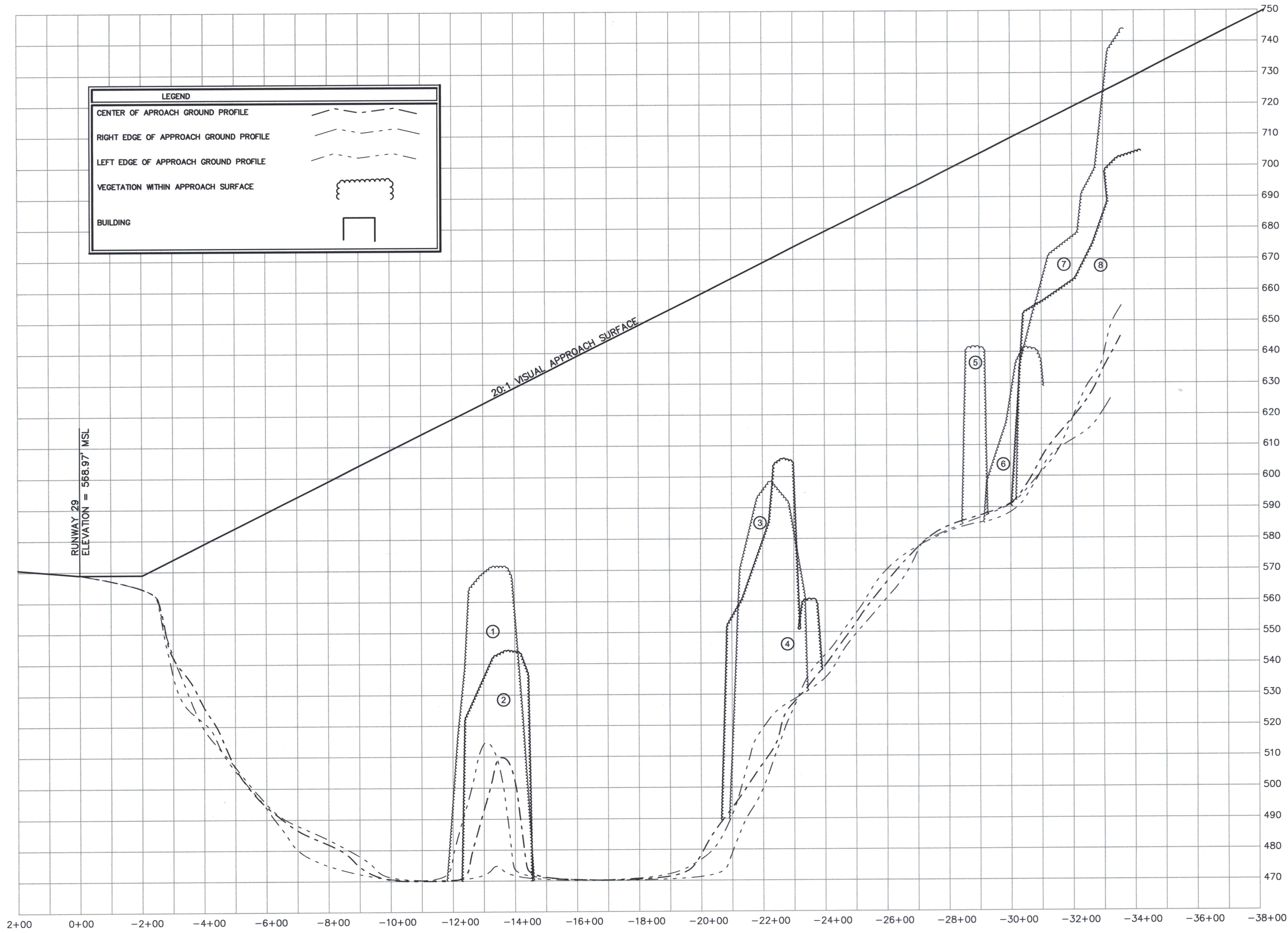
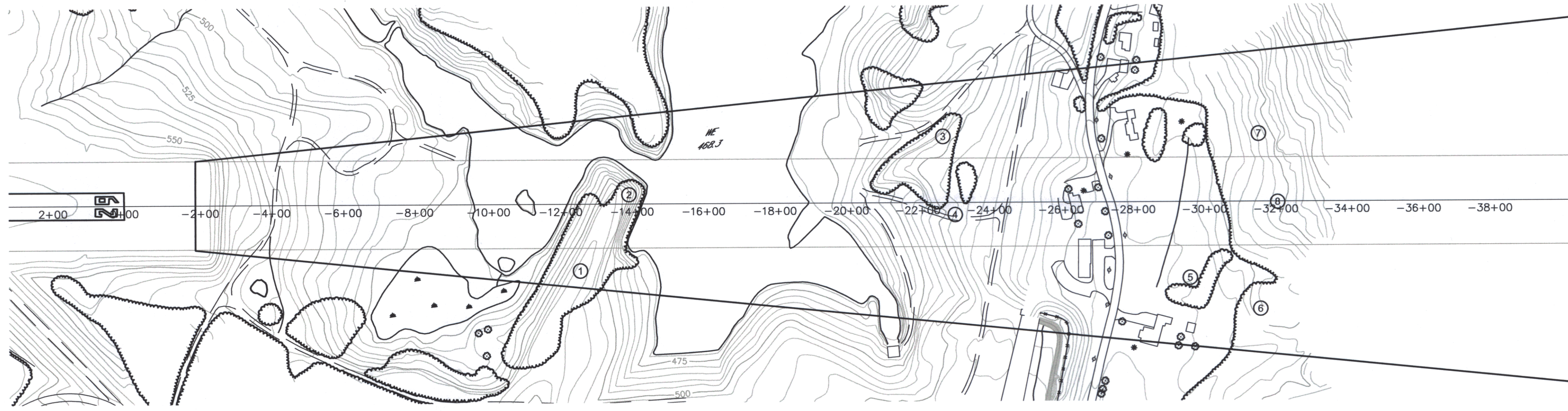

Rev.	Description	By	Date

HARTNESS STATE AIRPORT
RUNWAY 29
F.A.R. PART 77 PLAN AND PROFILE

VERMONT
SPRINGFIELD

Project No.	8190014
Proj. Manager	JW
Proj. Designer	JW
Drawn By	MRS
Checked By	JW
Scale	1" = 200'
Approved	
Date	06/00

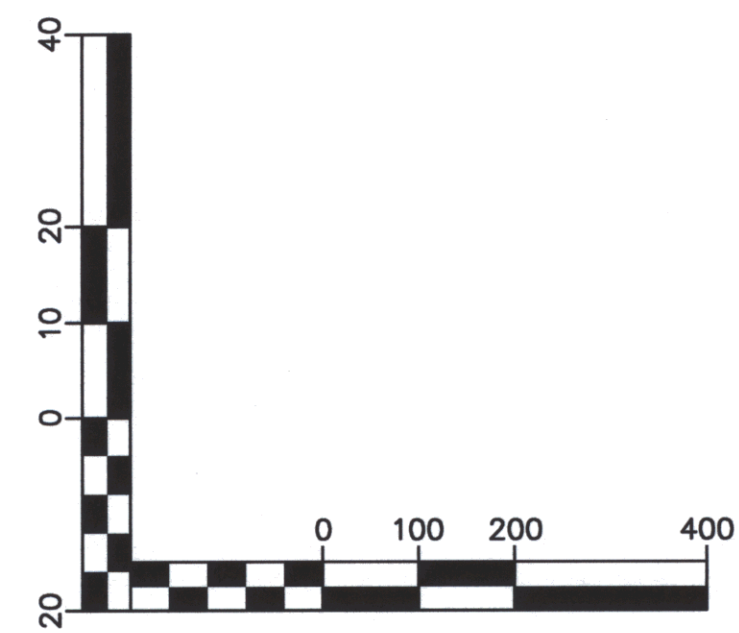
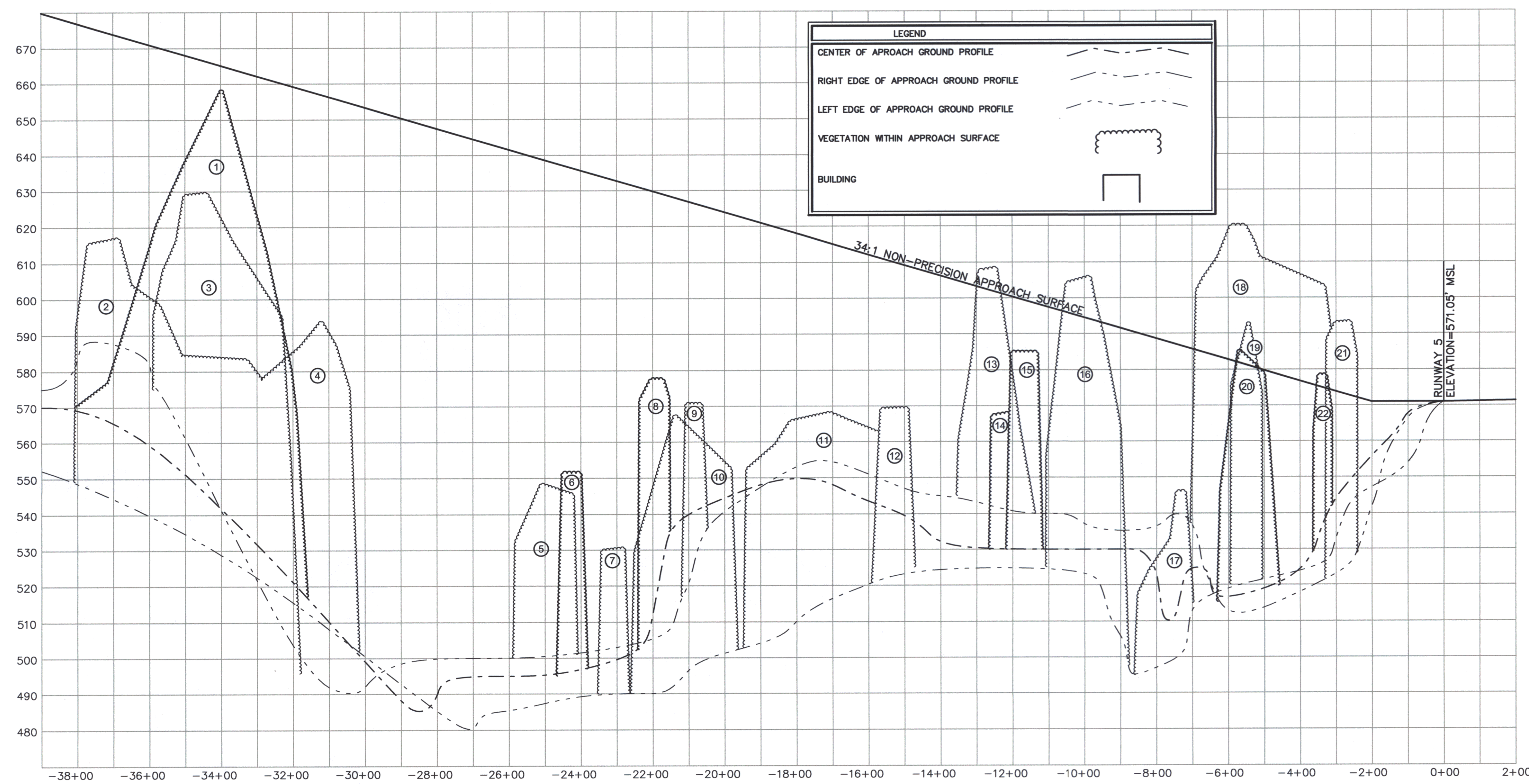
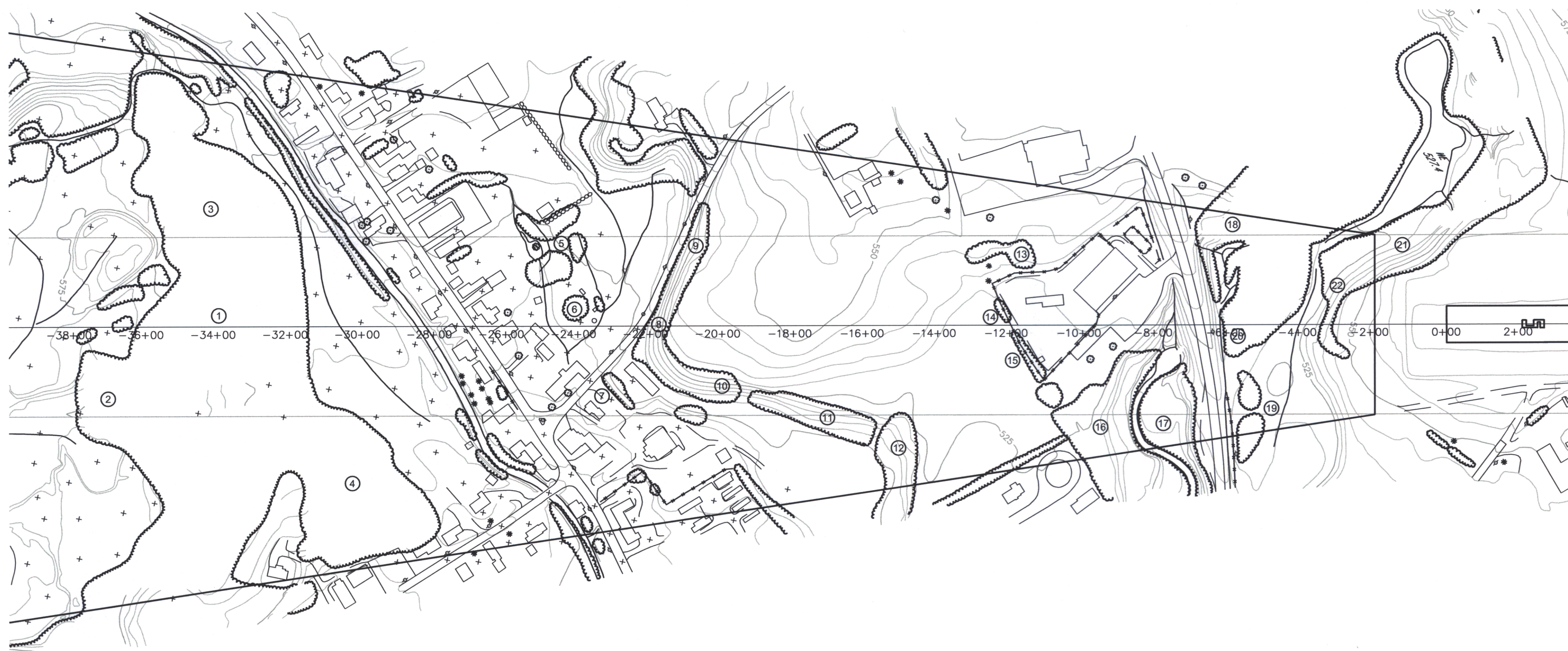

Dufresne-Henry
Consulting Engineers
SOUTH BURLINGTON, VT 05407
Tel: (802) 864-0223 • Fax: (802) 864-0188 • www.dhinc.com

Rev.	Description	By	Date

VERMONT

HARTNESS STATE AIRPORT
RUNWAY 5
F.A.R. PART 77 PLAN AND PROFILE

SPRINGFIELD

Project No.	8190014
Proj. Manager	JW
Proj. Designer	JW
Drawn By	MRS
Checked By	JW
Scale	1" = 200'
Approved	
Date	0800

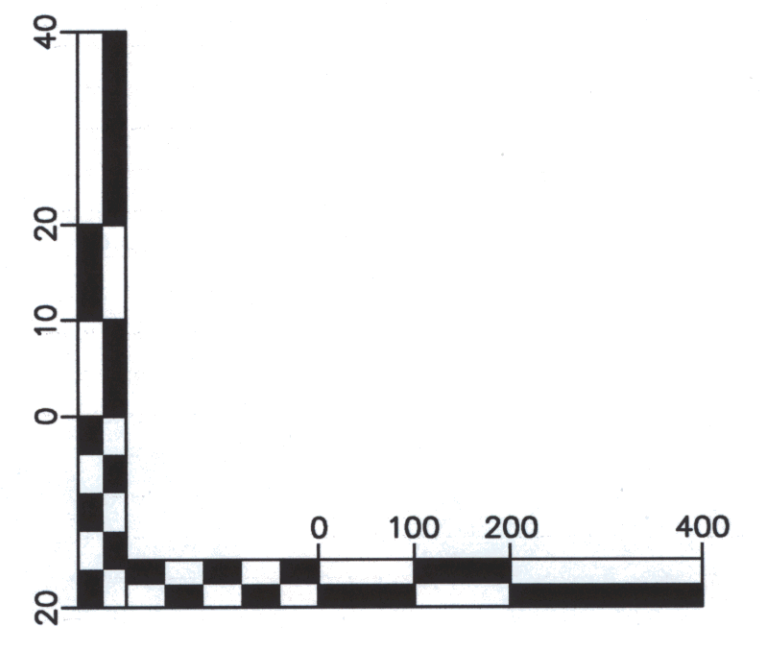
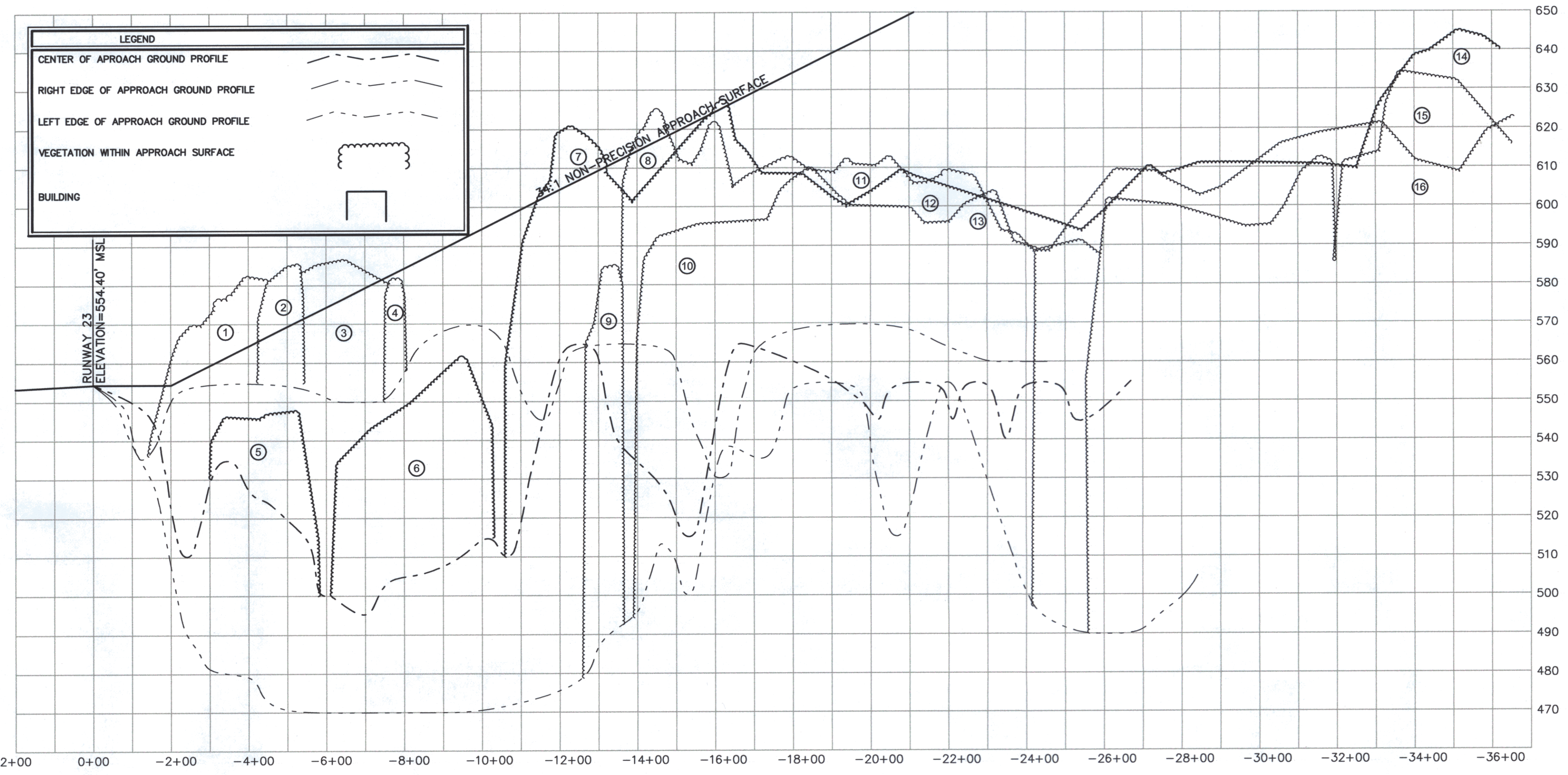
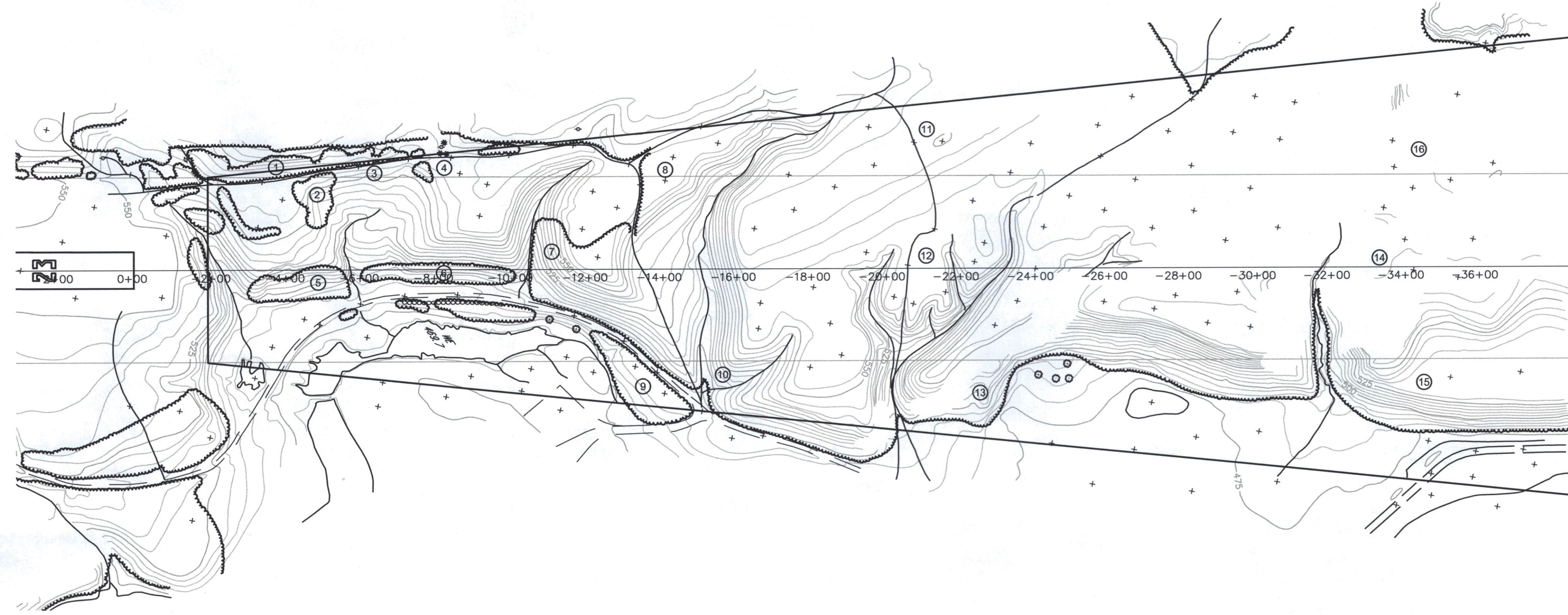



Rev.	Description	By	Date

VERMONT
 HARTNESS STATE AIRPORT
RUNWAY 23
F.A.R. PART 77 PLAN AND PROFILE
 SPRINGFIELD

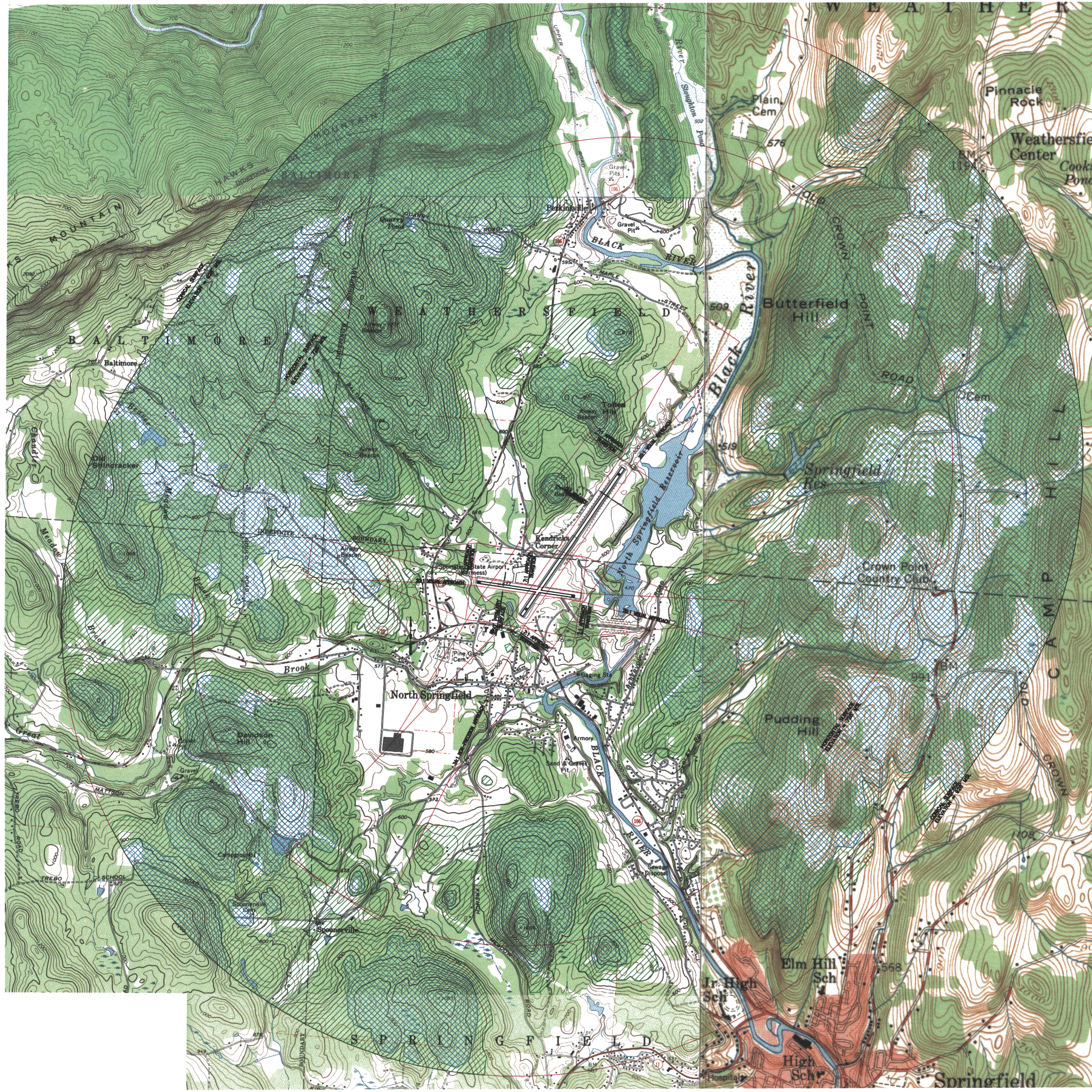
Project No.	8190014
Proj. Manager	JW
Proj. Designer	JW
Drawn By	MRS
Checked By	JW
Scale	1" = 200'
Approved	
Date	05/00



LEGEND

	TREE PENETRATION AREA
	GROUND PENETRATION AREA
	F.A.R. PART 77 SURFACES

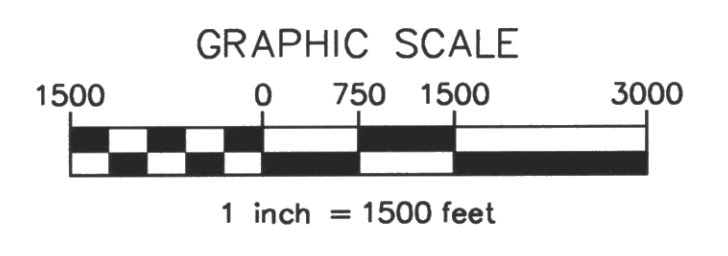

Rev.	Description	By	Date





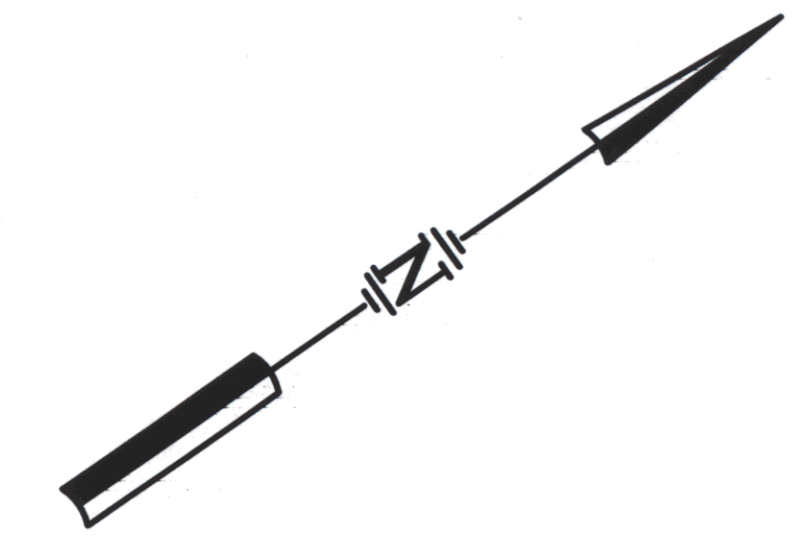
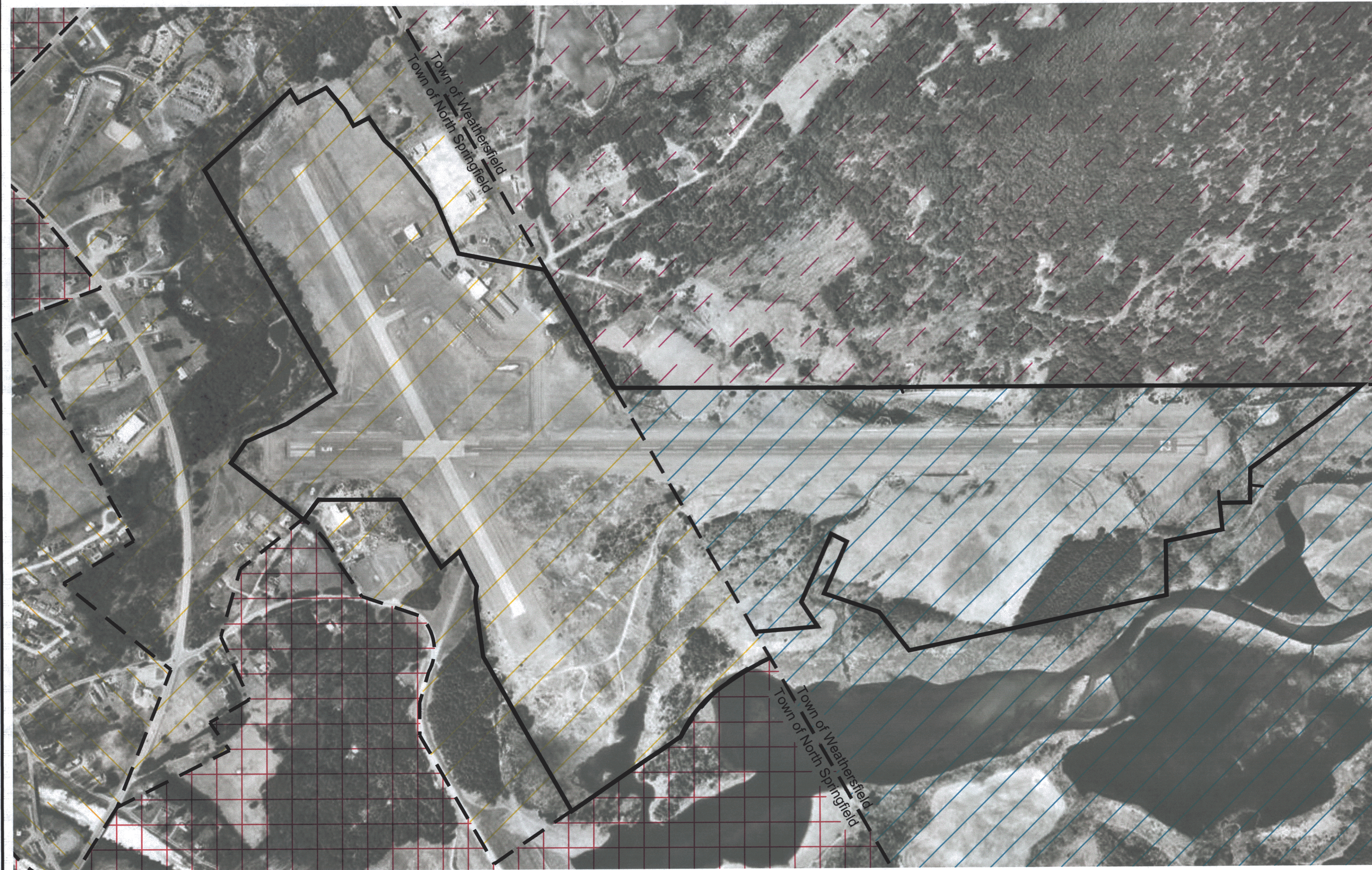

VERMONT
SPRINGFIELD

FAR PART 77 IMAGINARY SURFACES PLAN

HARTNESS STATE AIRPORT

Project No.	8190014
Proj. Manager	JW
Proj. Designer	JW
Drawn By	MRS
Checked By	JW
Scale	1" = 1500'
Approved	
Date	01/00

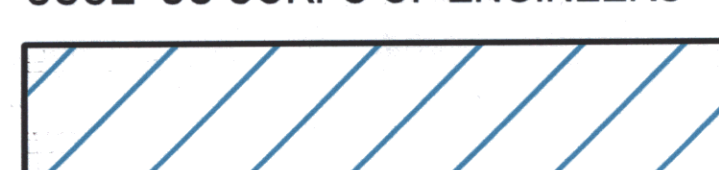

- LEGEND**
- MDR MEDIUM DENSITY RESIDENTIAL

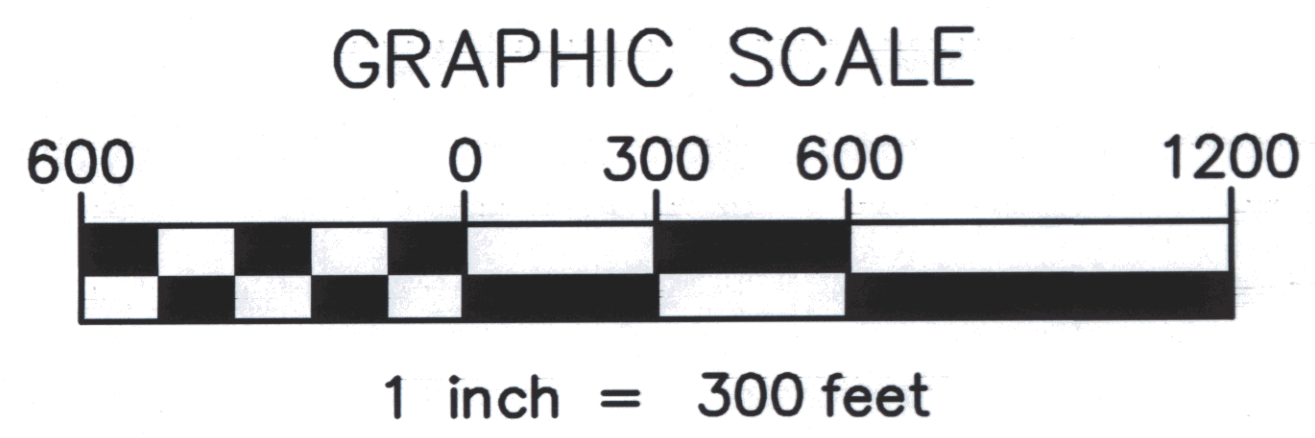
 - RC RESIDENTIAL COMMERCIAL

 - GB GENERAL BUSINESS

 - RR1 RURAL RESIDENTIAL

 - USCE US CORPS OF ENGINEERS

 - ZONING BOUNDARY

 - AIRPORT PROPERTY LINE



HARTNESS STATE AIRPORT

FIGURE 6-1
ZONING MAP

SPRINGFIELD VERMONT

Project No.	8190014
Proj. Mgr.	MLC
Scale	1"=300'
Date	04/13/00
B	10