

AIRPORT DATA	EXISTING
AIRPORT ELEVATION	827
AIRPORT REFERENCE POINT	42° 53' 29" N 73° 14' 47" W
MEAN MAX. TEMP. (HOTTEST MO.)	80° F
TAXIWAY LIGHTING	--
TAXIWAY MARKING	--
AIRPORT/TERMINAL NAVAIDS	GPS/VOR
AIRPORT REFERENCE CODE (ARC)	B-II
ACREAGE OWNED IN FEE SIMPLE	207
ACREAGE OWNED IN EASEMENT	84
USE/OWNERSHIP	General Aviation/State

EXISTING	BUILDINGS
①	Alr New Hangar
②	Alr New Hangar
③	Willar Van Warfmer Hangar
④	Condo Hangars (5 Aircraft)
⑤	Condo Hangars (7 Aircraft)
⑥	Abacus Automation Hangar (3 Aircraft)
⑦	Bennington Iron Works Hangar
⑧	Green Hangar - Storage (2 Aircraft)
⑨	Ground School Trailer
EXISTING TERMINAL AREA PAVEMENT	
Ⓐ	Main Apron
Ⓑ	Fuel Apron
Ⓒ	Main Auto Parking
Ⓓ	Long Term Auto Parking
Ⓔ	Access Road

LEGEND	EXISTING
GROUND CONTOUR	— 80 —
AIRPORT PROPERTY	—
AVIGATION EASEMENT	▨
BUILDING RESTRICTION LINE (BRL) *	—
PART 77 APPROACH SURFACE	—
OBJECT FREE AREA (OFA)	—
RUNWAY SAFETY AREA (RSA)	—
RUNWAY SAFETY AREA IMPROVEMENTS	N/A
RUNWAY PROTECTION ZONE (RPZ)	—
TREE LINE	—
SECURITY FENCE	—
AIRPORT REFERENCE POINT	⊙
SWALE/DITCH	—
R/W END IDENTIFIER LIGHTS (REIL)	▶
WETLAND BOUNDARY	—
UNIMPROVED ROADWAYS	—
PAVEMENT	—
AIRPORT BUILDINGS	—
POTENTIAL EXISTING OBSTRUCTIONS	—
POTENTIAL ARCHEOLOGICAL IMPACT	—

* ASSUMED BUILDING HEIGHT 30 FEET

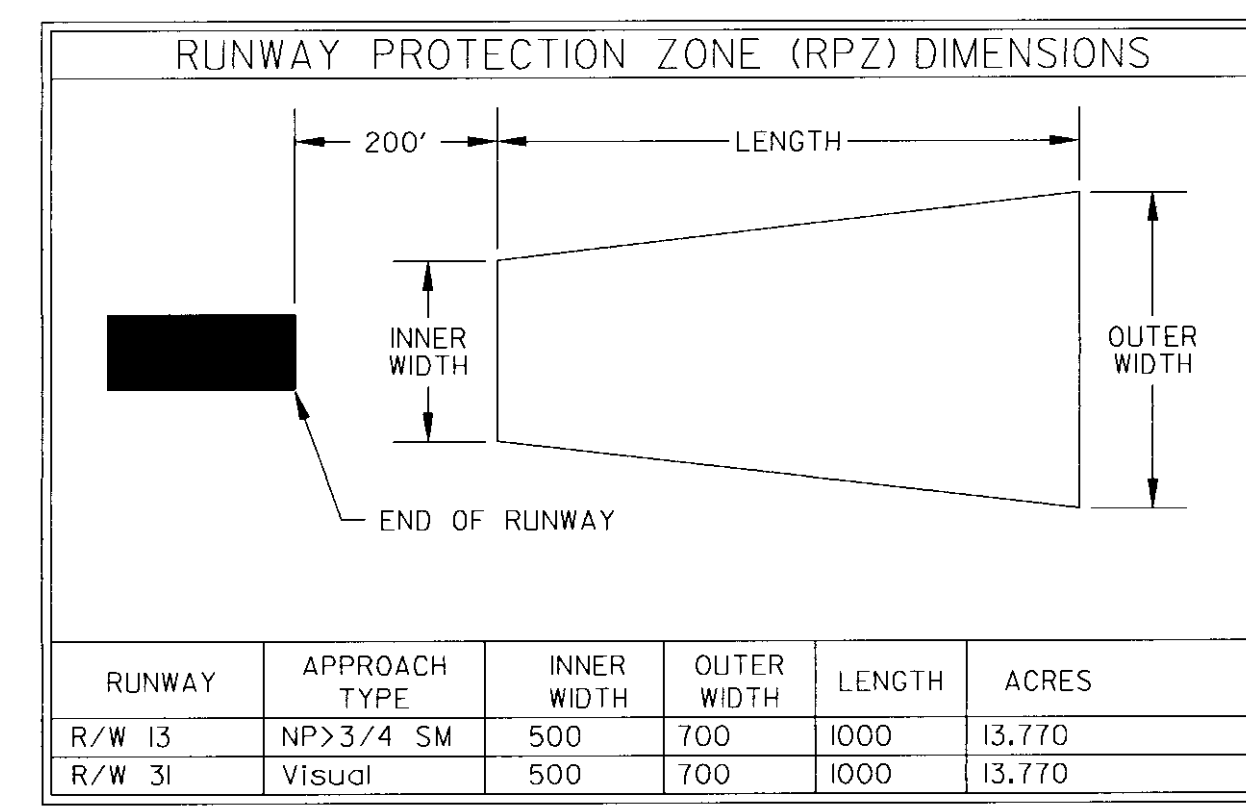

RUNWAY DATA	EXISTING
PAVEMENT STRENGTH	I3 12,500 SW I31 12,500 SW
APPROACH SURFACES	Non-Precision 34ft Visual 20ft
RUNWAY MARKINGS	Visual Visual
RUNWAY LIGHTING	MIRL MIRL
RUNWAY NAVAIDS	GPS VOR/GPS-A VOR/GPS-A
EFFECTIVE GRADIENT	0.9%
RUNWAY END ELEVATIONS	793.34 826.62
RUNWAY END COORDINATES	N 42° 53' 37" W 73° 18' 09" N 42° 53' 20" W 73° 14' 25"
RUNWAY LENGTH	3704' 3704'
RUNWAY WIDTH	75' 75'
EXTENDED RSA COMPLIANCE	NO YES

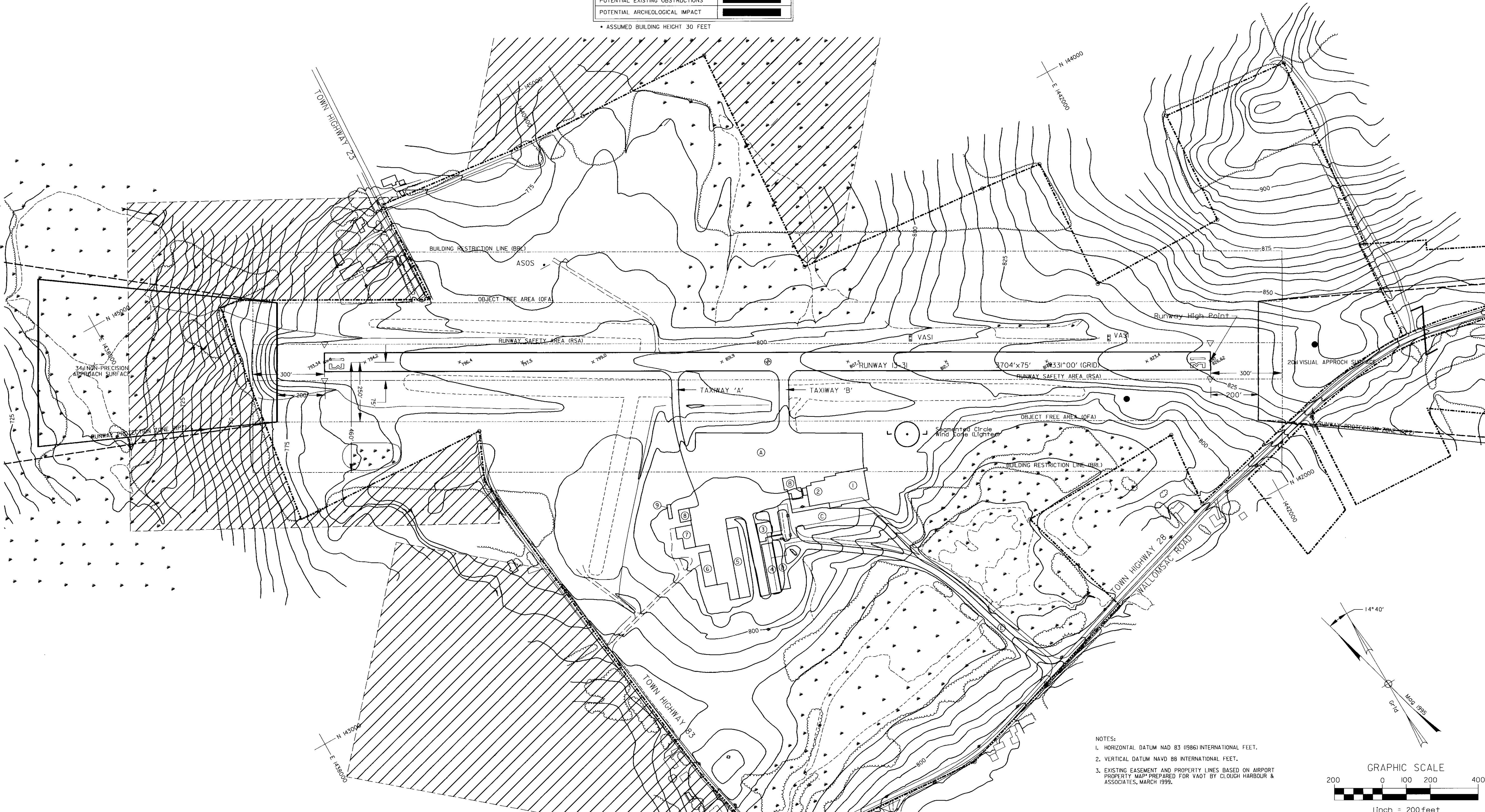

NOTES:
 1. HORIZONTAL DATUM NAD 83 (1986) INTERNATIONAL FEET.
 2. VERTICAL DATUM NAVD 88 INTERNATIONAL FEET.
 3. EXISTING EASEMENT AND PROPERTY LINES BASED ON AIRPORT PROPERTY MAP PREPARED FOR VAOT BY CLOUGH HARBOUR & ASSOCIATES, MARCH 1999.

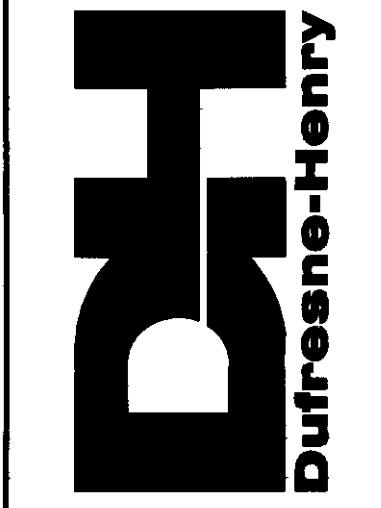
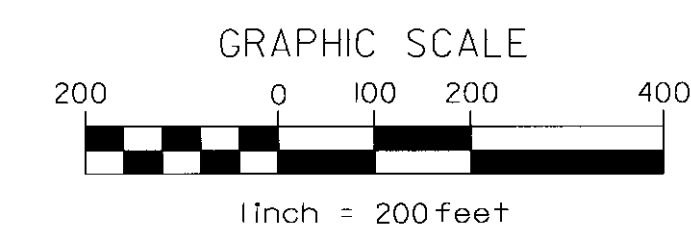

Rev.	Description	By	Date

WILLIAM H. MORSE STATE AIRPORT
 EXISTING AIRPORT LAYOUT PLAN
 VERMONT
 BENNINGTON

Project No.	8190014
Proj. Manager	MC
Proj. Designer	JMW
Drawn By	GPR
Checked By	MS
Scale	1"=200'
Approved	
Date	11-5-99

Sheet 2 of 7