

**DURABLE 4" WHITE LINE**  
 STA. BL1 2+13.00 TO 2+94.00, SOLID RT.  
 (HANDICAPPED PARKING SPACES & DIAGONALS)  
 STA. BL1 1+10.00 TO 3+26.00, SOLID RT. & LT.  
 (PARKING SPACES, BUS STOP & DIAGONALS)  
 STA. BL2 6+17.50 TO 7+78.00, SOLID RT.  
 (PARKING SPACES & DIAGONALS)  
 STA. BL2 5+34.00 TO 6+14.00, SOLID LT  
 (DIAGNOLS)

**DURABLE 4" YELLOW LINE (DOUBLE)**  
 STA. BL2 5+18.00 TO 6+50.00, SOLID LT. & RT.

**DURABLE 24" STOP BAR**  
 STA. BL2 5+18.50, 0.50' LT. TO 5+29.00, 23.20' LT.  
 (PARKING LOT EXIT APPROACH TO LINCOLN STREET)

**DURABLE LETTER OR SYMBOL**  
 STA. BL1 2+20.00, 46.50' RT. "C"  
 STA. BL1 2+36.00, 46.50' RT. "C"  
 STA. BL1 2+52.50, 46.50' RT. "C"  
 STA. BL1 2+72.00, 46.50' RT. "C"  
 STA. BL2 6+20.44, 17.62' LT. "BUS"  
 STA. BL2 6+28.18, 17.12' LT. "STOP"  
 STA. BL1 1+42.83, 46.30' LT. "C"  
 STA. BL1 1+42.30, 17.21' RT. "C"  
 STA. BL1 1+61.05, 64.40' LT. "C"  
 STA. BL1 1+62.82, 30.20' RT. "C"  
 STA. BL1 1+78.30, 25.50' LT. "C"  
 STA. BL1 2+31.56, 64.40' LT. "C"  
 STA. BL1 2+45.17, 25.50' LT. "C"  
 STA. BL1 2+77.58, 30.20' RT. "C"  
 STA. BL2 6+28.65, 4.20' RT. "C"

**REMOVING SIGNS**  
 AS SHOWN - 4

**ERECTING SALVAGED SIGN**  
 AS SHOWN - 1

- NOTES:**
- ALL EXISTING SIGNS NOT SHOWN SHALL BE RETAINED AS DIRECTED BY THE ENGINEER.
  - FOR PAVEMENT MARKING DETAILS SEE VTRANS STANDARD SHEETS E-191, E-192, E-193.
  - FOR SIGN DETAILS SEE SIGN DETAIL SHEETS.

**SIGN LEGEND**

N = NEW  
 R = REMOVE  
 R&S = REMOVE & SALVAGE  
 S = SALVAGE SIGN  
 RET = RETAIN  
 B-B = BACK TO BACK  
 --- = EXISTING  
 — = PROPOSED

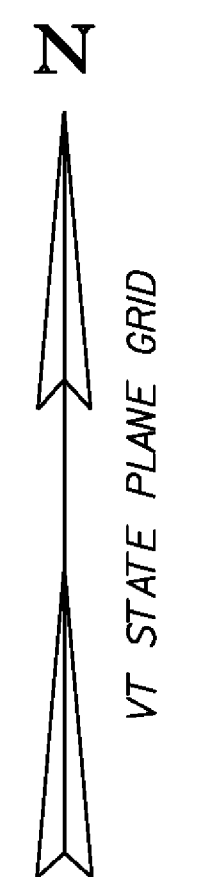
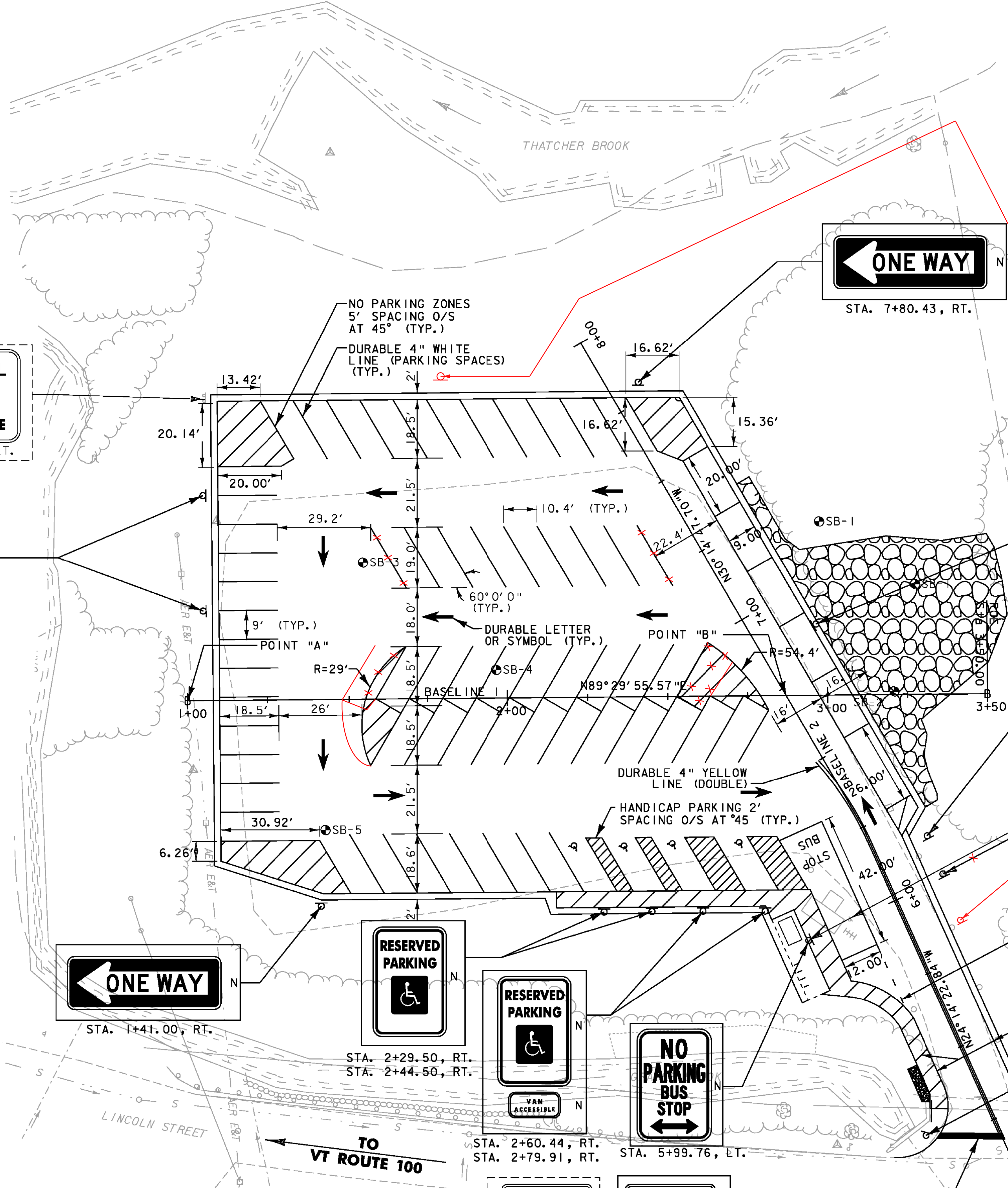

**VAN POOL INFO**  
 1-800-685-RIDE  
 STA. 1+06.38, LT.

**ONE WAY**  
 STA. 1+05.00, LT.  
 STA. 1+05.00, LT.

**\$500 FINE FOR THROWING TRASH ON HIGHWAYS AND STREAMS**  
 STA. 6+87.21, RT.

**NO LEFT TURN**  
 STA. 6+15.00, RT.

**BUS STOP**  
 STA. 5+99.76, LT.

**PROHIBITED**  
 OVERNIGHT CAMPING  
 ABANDONED VEHICLES  
 COMMERCIAL ENTERPRISES  
 STA. 6+01.45, RT.

**COMMUTER PARKING**  
 POLICE TAKE NOTICE  
 STA. 6+01.45, RT.

**ONE WAY**  
 STA. 1+41.00, RT.

**RESERVED PARKING**  
 STA. 2+29.50, RT.  
 STA. 2+44.50, RT.

**RESERVED PARKING**  
 VAN ACCESSIBLE  
 STA. 2+60.44, RT.  
 STA. 2+79.91, RT.

**NO PARKING BUS STOP**  
 STA. 5+99.76, LT.

**STOP**  
 STA. 5+32.00, LT.

**PARK & RIDE**  
 STA. 5+02.50, LT.

**PARK & RIDE**  
 1-800-685-RIDE  
 STA. 5+02.50, LT.



PROJECT NAME: WATERBURY  
 PROJECT NUMBER: CMG PARK(I)S RE-ADVERTISED  
 FILE NAME: zk002bdr.dgn  
 PROJECT LEADER: WLD  
 DESIGNED BY: BEM  
 SIGNING & PAVEMENT MARKING PLAN

PLOT DATE: 19-NOV-2009  
 DRAWN BY: BEM  
 CHECKED BY: AJB  
 SHEET II OF 32