

**GENERAL NOTES:**

- SEE SHEETS 1, 2, & 3 FOR PLANS AND DETAILS.
- ALL BEAMS ARE LABELED AS FOLLOWS:  
PRODUCT TYPE - IDENTIFICATION NUMBER - SEQUENCE NUMBER
- MARK ALL BEAM ENDS "NORTH END" FOLLOWED BY THE CORRESPONDING BEAM LABEL

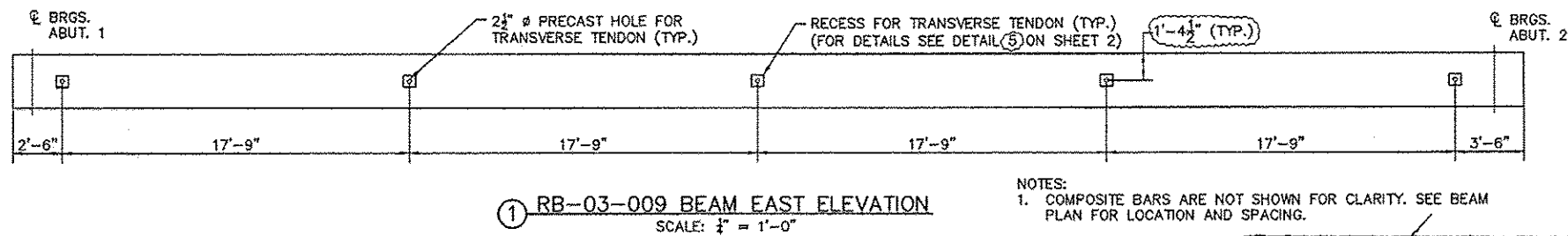
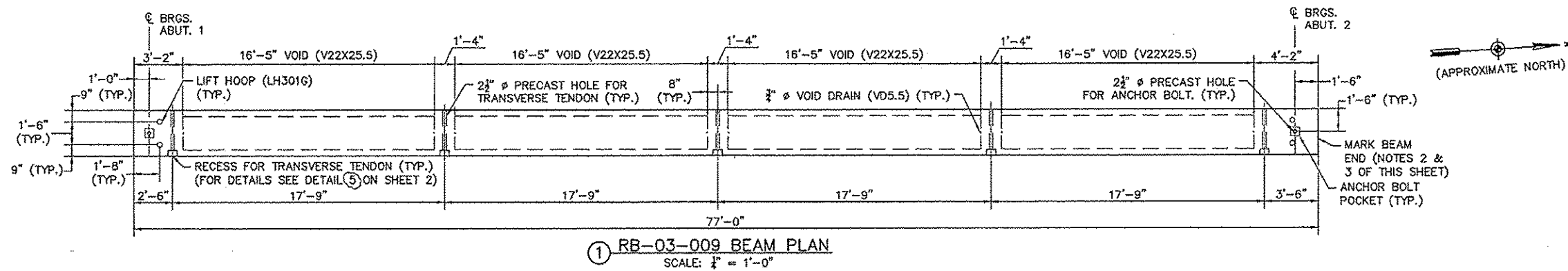

NOTES:  
1. COMPOSITE BARS ARE NOT SHOWN FOR CLARITY. SEE BEAM PLAN FOR LOCATION AND SPACING.

Accepted ✓
Accepted as Noted
Accepted Noted Resubmit
Rejected, Revise Resubmit
Rejected - Unacceptable
Checking is only for conformance with the design concept of the Project and compliance with the information given in the Contract Documents. The Engineer assumes no liability for errors or omissions that may be contained herein. The Contractor, by approving and submitting these documents, verifies their accuracy as stipulated on the Contractor's Shop Drawing Stamp.
Date <u>7/2/10</u> By <u>DuBois and King</u>

PART NO.	DESCRIPTION	QTY.
VD5.5	3/4" Ø VOID DRAIN 5 1/2" LONG	8
LH301G	LIFT HOOP (3) 1/2" STRANDS	4
V22X25.5	22"X25.5" VOID, 16'-5"	4
	LONG	
	VERMONT STATE MIX DESIGN	
B400E	#4 BENT	52
B401E	#4 BENT	(63)
B402E	#4 BENT	6
B403E	#4 BENT	(8)
S404E	#4 STRAIGHT	6
S405E	#4 STRAIGHT	12
B406E	#4 BENT	40
B407E	#4 BENT	(8)
S408E	#4 STRAIGHT	24
B409E	#4 BENT	(8)

NOTE:  
ALL ITEMS LISTED ABOVE ARE SUGGESTED PRODUCTS. FABRICATOR MAY SUBSTITUTE APPROVED EQUALS AS NECESSARY.

**Hoyle, Tanner & Associates, Inc.**  
125 College Street, 4th Floor Burlington, VT 05401  
Tel (802)860-1331 Fax (802)860-6499 www.hoyletanner.com  
© Copyright 2010 Hoyle, Tanner & Associates, Inc.

DRAWN BY: NAK DATE: JUNE 2010  
CHECKED BY: DRS PROJECT NO: 122420.75

PRECAST CONCRETE PRODUCTS  
TEL: (802) 442-4418 FAX: (802) 442-4719

STATE OF VERMONT AGENCY OF TRANSPORTATION  
**STOWE, VT**  
MOSCOW ROAD (T.H. NO. 1) OVER MILLER BROOK BRIDGE #3  
PROJECT NO. BHO 1446(30)

**SHEET 5 OF 5**