

SECTION A-A
SCALE 1" = 1'-0"

SECTION B-B
SCALE 1" = 1'-0"

- NOTES:**
- I INDICATES LOCATION OF A VERTICAL PILE
 - PREFABRICATED PILE SPLICE MAY BE USED WITH THE APPROVAL OF THE ENGINEER
 - WELD PROCEDURES SHALL BE APPROVED BEFORE WELDING
 - EACH PILE SHALL HAVE A 1" THICK STEEL PLATE USING MATERIAL IN ACCORDANCE WITH GRADE 50 AASHTO M270M/M270, WELDED TO THE BOTTOM.
 - APPROXIMATE LENGTH OF PILE UNDER ABUTMENT NO. 2 IS 93.37' (EL. 322.37 - 229.00.)
 - SEE SHEET 27 FOR DETAILS ON PARTIAL REMOVAL OF EXISTING ABUTMENT NO. 2.
 - OC = ON CENTER
NF = NEAR FACE
FF = FAR FACE
EF = EACH FACE
▲ = CUT TO FIT IN FIELD

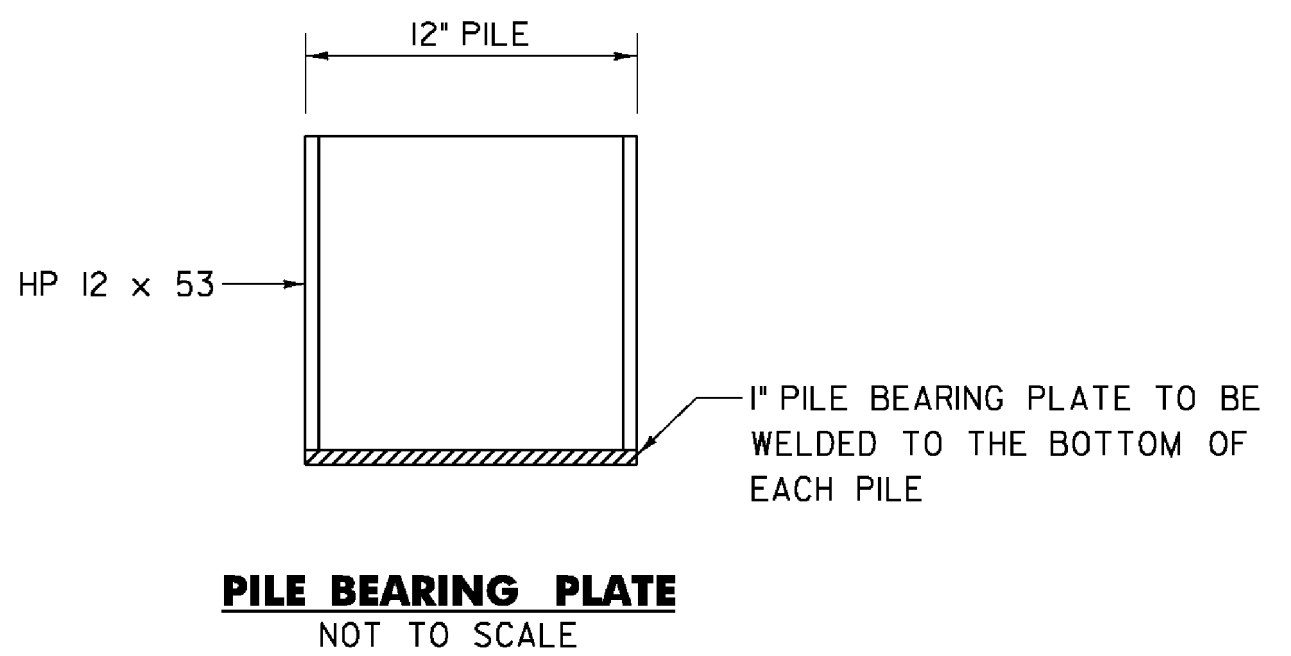
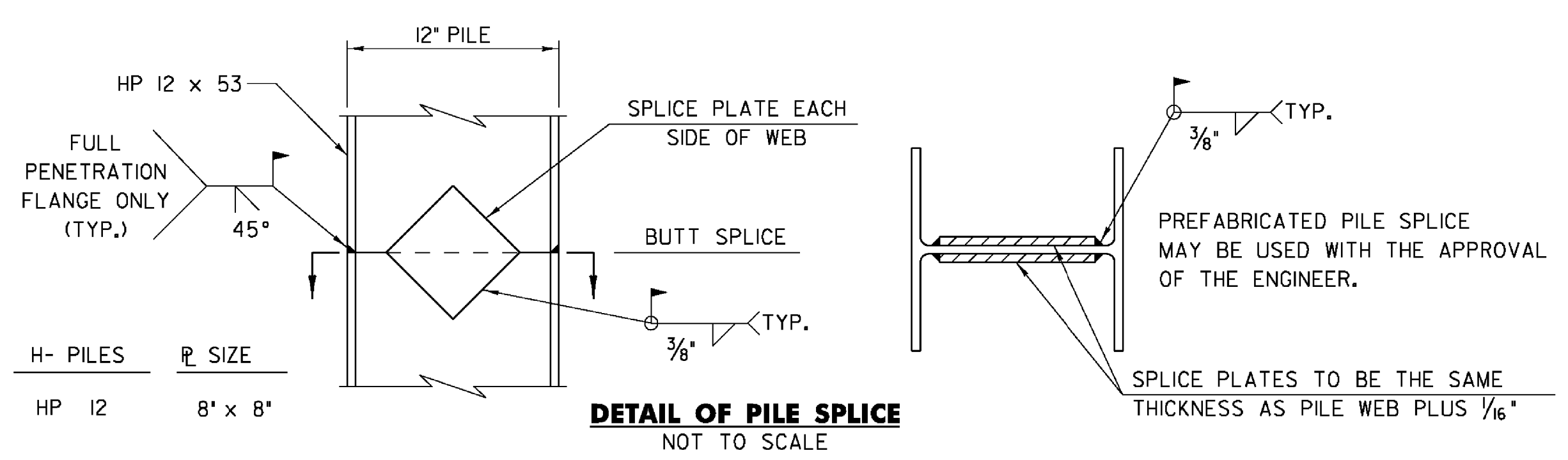

STATE OF VERMONT AGENCY OF TRANSPORTATION			
Town Of	STOWE	Bridge No.	3
Highway No.	T.H. 1	Log Sta.	
		Surv. Sta.	
MOSCOW ROAD OVER MILLER BROOK ABUTMENT NO. 2 DETAILS			
Designed By	R.H. BARNES	Drawn By	S.J. BIJOLLE
Checked By	E.P. DETRICK	Date	5/09
		Bridge Design Supervisor	J.W. TUCKER
PROJECT	STOWE	PROJECT NO.	BHO 1446 (30)
I.G.C. Info. ... \DGN\z99J244dt12.dgn			
D & K DWG NO.		Sheet	28 of 37

