

CURVE DATA

CURVE NO.1	CURVE NO.2	CURVE NO.3	CURVE NO.4
Δ = 24°58'35"	Δ = 65°03'22"	Δ = 4°22'30"	Δ = 26°57'22"
D = 23°07'32"	D = 52°05'13"	D = 16°22'13"	D = 9°23'34"
R = 247.76'	R = 110.00'	R = 350.00'	R = 610.00'
T = 54.87'	T = 70.15'	T = 13.37'	T = 146.20'
L = 108.00'	L = 124.90'	L = 26.73'	L = 286.99'
E = 6.00	E = 20.47	E = 0.26	E = 17.28
2T-L = 1.74	2T-L = 15.40	2T-L = 0.02	2T-L = 5.41

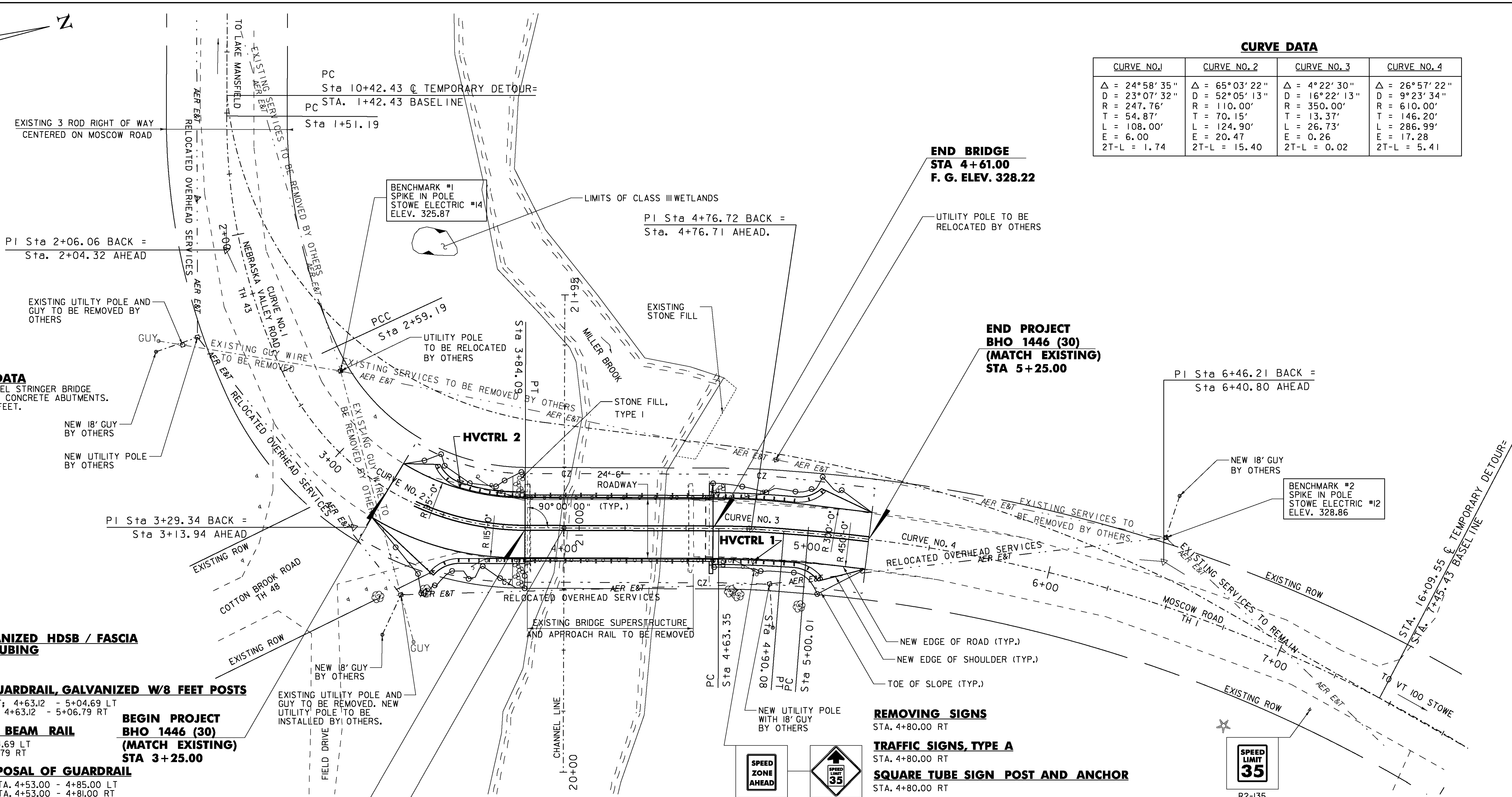

EXISTING BRIDGE DATA
69 FOOT SINGLE SPAN STEEL STRINGER BRIDGE WITH CONCRETE DECK AND CONCRETE ABUTMENTS. RAIL TO RAIL WIDTH = 24 FEET.

BRIDGE RAIL, GALVANIZED HDSB / FASCIA MOUNTED / STEEL TUBING
STA. 3+81.87 - 4+63.12 LT
STA. 3+81.87 - 4+63.12 RT

HD STEEL BEAM GUARDRAIL, GALVANIZED W/8 FEET POSTS
STA. 3+40.06 - 3+81.87 LT; 4+63.12 - 5+04.69 LT
STA. 3+51.89 - 3+81.87 RT; 4+63.12 - 5+06.79 RT

ANCHOR FOR STEEL BEAM RAIL
STA. 3+40.06 LT, STA. 5+04.69 LT
STA. 3+51.89 RT, STA. 5+06.79 RT

REMOVAL AND DISPOSAL OF GUARDRAIL
STA. 3+59.00 - 3+84.00; STA. 4+53.00 - 4+85.00 LT
STA. 3+65.00 - 3+84.00; STA. 4+53.00 - 4+81.00 RT

4" YELLOW LINE
STA. 3+37.50 - 5+25.00 (DOUBLE CENTER)

STONE FILL, TYPE 1
STA. 3+79.00 - 3+84.00 LT & RT
STA. 4+61.00 - 4+66.00 LT & RT

BEGIN PROJECT BHO 1446 (30) (MATCH EXISTING) STA 3+25.00

BEGIN BRIDGE STA 3+84.00 F. G. ELEV. 327.48

END BRIDGE STA 4+61.00 F. G. ELEV. 328.22

END PROJECT BHO 1446 (30) (MATCH EXISTING) STA 5+25.00

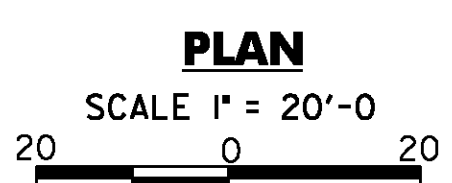

EXISTING SIGN R2-5C "SPEED ZONE AHEAD" STA. 4+80.00 RT TO BE REMOVED
NEW SIGN W3-5 "SPEED LIMIT 35" STA. 4+80.00 RT

EXISTING LEGEND

EDGE OF RIVER	---
EDGE OF ROAD	----
ROW	-----
GUARD RAIL	o-o-o-o-o
TREE LINE	~~~~~
UTILITY POLE	⊕
SIGN	⊕
TREES	⊗
OVERHEAD UTILITIES	--- AER E&T ---
CENTERLINE OF ROAD	-----

DuBois & King
engineering planning management development

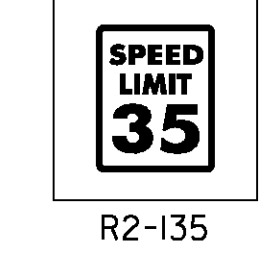

R2-135

STATE OF VERMONT AGENCY OF TRANSPORTATION	
Town Of	STOWE
Highway No.	T.H.1
MOSCOW ROAD OVER MILLER BROOK	
PLAN SHEET	
Designed By	R.H. BARNES
Checked By	E.P. DETRICK
PROJECT	STOWE
I.G.C. Info.	... \DGN\z99J24bdr.dgn
Bridge No.	3
Log Sta.	
Surv. Sta.	
Drawn By	S.J. BIJOLLE
Bridge Design Supervisor	J.W. TUCKER
PROJECT NO.	BHO 1446 (30)
Date	5/09
Date	5/09
D & K DWG NO. Sheet 8 of 37	

DATUM

VERTICAL	ASSUMED
HORIZONTAL	ASSUMED

- NOTES:**
- THE EXISTING R.O.W. ON MOSCOW ROAD AND COTTON BROOK ROAD ARE ASSUMED TO BE 3 ROD (49.5 FEET), CENTERED ON THE EXISTING ROADWAY, AS DIRECTED BY THE TOWN OF STOWE.
 - ALL EXISTING TREES OVER 3" DIA. SHALL REMAIN, UNLESS OTHERWISE DIRECTED BY THE TOWN OR ENGINEER.
 - SEE SHEET 14 FOR APPROACH RAIL AND BRIDGE RAIL LAYOUT.