

**THIS SHEET IS FOR  
ROW PURPOSES ONLY**

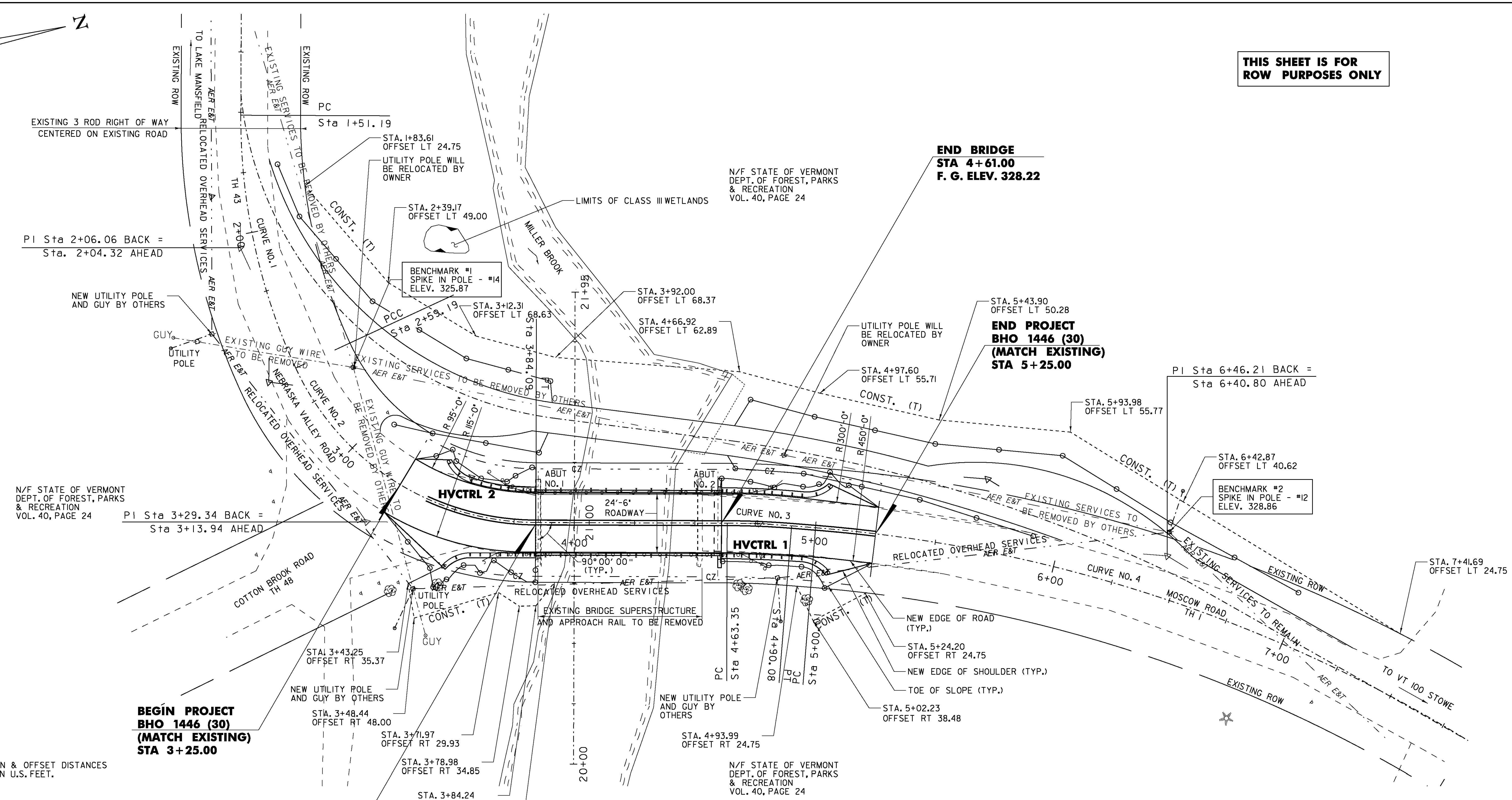

**NOTES:**  
ALL STATION & OFFSET DISTANCES  
RECORDED IN U.S. FEET.

**BEGIN PROJECT  
BHO 1446 (30)  
(MATCH EXISTING)  
STA 3+25.00**

**BEGIN BRIDGE  
STA 3+84.00  
F. G. ELEV. 327.48**

**END BRIDGE  
STA 4+61.00  
F. G. ELEV. 328.22**

**END PROJECT  
BHO 1446 (30)  
(MATCH EXISTING)  
STA 5+25.00**

**RIGHT OF WAY  
SCALE 1" = 20'-0"**

LEGEND	
EDGE OF RIVER	---
EDGE OF ROAD	----
ROW	-----
GUARD RAIL	o-o-o-o
TREE LINE	~~~~~
UTILITY POLE	o
SIGN	+
TREES	* * *
CONST. EASEMENT TEMP.	--- CONST. (T) ---
CENTERLINE OF ROAD	----



PLOTTED 12/21/2009

DATUM	
VERTICAL	ASSUMED
HORIZONTAL	ASSUMED

STATE OF VERMONT AGENCY OF TRANSPORTATION			
Town Of	STOWE	Bridge No.	3
Highway No.	T.H. 1	Log Sta.	
		Surv. Sta.	
T.H. NO. 1 OVER MILLER BROOK			
RIGHT OF WAY SHEET			
Designed By	B.C. AUSTIN	Drawn By	A. SANZ
Checked By	R.E. GAUTHIER	Date	07/02
		Bridge Design Supervisor	J. W. TUCKER
		Date	07/02
PROJECT	STOWE	PROJECT NO.	BHO 1446 (30)
I.G.C. Info.	... \DGN\z99J244row.dgn		
D & K DWG NO.		Sheet	5 of 37