

INDEX OF SHEETS			
1	TITLE SHEET	18	EPSC FINAL CONDITIONS SITE PLAN
2	PRELIMINARY INFORMATION SHEET	19-20	EPSC DETAILS
3-4	QUANTITY SHEET	21	GENERAL NOTES
5	RIGHT OF WAY SHEET	22	DECK REINFORCING PLAN AND DETAILS
6	RIGHT OF WAY DETAIL SHEET	23	BRIDGE END DETAILS
7	TIE SHEET	24-25	PRESTRESSED UNIT DETAILS
8	PLAN SHEET	26	BEARING DETAILS
9	PROFILE	27	ABUTMENT NO. 1 DETAILS
10	TRAFFIC CONTROL SHEET	28	ABUTMENT NO. 2 DETAILS
11	BORING INFORMATION SHEET	29	CURB AND BRIDGE RAIL DETAILS
12-13	BORING LOG SHEETS	30	REINFORCING STEEL SCHEDULE
14	PLAN AND ELEVATION	31-35	ROADWAY CROSS SECTIONS
15	EPSC NARRATIVE	36	ROADWAY AND DETOUR DETAILS
16	EPSC EXISTING CONDITIONS SITE PLAN	37	CHANNEL CROSS SECTIONS
17	EPSC CONSTRUCTION SITE PLAN		

STANDARDS		
B-5	EMBANKMENT ON EARTH SLOPE, EMBANKMENT ON ROCK SLOPE	06-01-94
B-11	METHODS OF SLOPE STABILIZATION	06-01-94
E-100	CONSTRUCTION APPROACH SIGNS	01-02-04
E-100A	SIDE ROAD CONSTRUCTION APPROACH SIGNS	01-02-04
E-101	CONSTRUCTION SIGN DETAILS	05-30-03
E-102	CONSTRUCTION SIGN DETAILS	06-30-03
E-102A	CONSTRUCTION SIGN DETAILS	05-01-04
E-106	TRAFFIC CONTROL MISCELLANEOUS DETAILS	03-01-04
E-107	DELINEATION, BARRICADES AND DETOURS FOR CONSTRUCTION AREAS	06-30-03
E-107A	BREAKAWAY BARRICADE DETAILS	06-08-09
E-108	CONSTRUCTION ZONE LONGITUDINAL DROP OFFS	06-08-09
E-110	MAJOR MAINTENANCE OPERATION LANE CLOSURE	08-08-95
E-121	STANDARD SIGN PLACEMENT CONVENTIONAL ROAD	08-08-95
E-193	PAVEMENT MARKING DETAILS	08-18-95
G-1	STEEL BEAM GUARDRAIL WITH STEEL POSTS	01-03-00
G-1D	STEEL BEAM GUARDRAIL WITH WOOD POSTS	01-03-00
G-18	STEEL BEAM GUARDRAIL APPROACH END TERMINAL, STEEL BEAM GUARDRAIL TRAILING END TERMINAL, ANCHOR FOR STEEL BEAM GUARD RAIL, STEEL BEAM MEDIAN BARRIER	06-01-94
G-18	PRECAST CONCRETE TEMPORARY TRAFFIC BARRIER	06-01-94
SB-R6-82	BRIDGE RAILING, HEAVY DUTY STEEL BEAM (TYPE A, TYPE B, TYPE C, AND TYPE D)	01-06-95
SB-R7-90	BRIDGE RAILING HEAVY DUTY STEEL BEAM WITH BOX HAND RAIL (TYPE E)	01-11-95
SB-R7-90	BRIDGE RAILING, HEAVY DUTY STEEL BEAM /FASCIA MOUNTED/STEEL TUBING	01-11-95

# STATE OF VERMONT AGENCY OF TRANSPORTATION

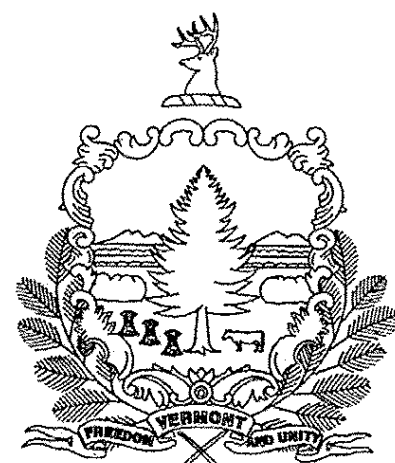

## PROPOSED IMPROVEMENT BRIDGE PROJECT TOWN OF STOWE COUNTY OF LAMOILLE ROUTE NO.: TH 1 (CLASS 2), BRIDGE NO. 3

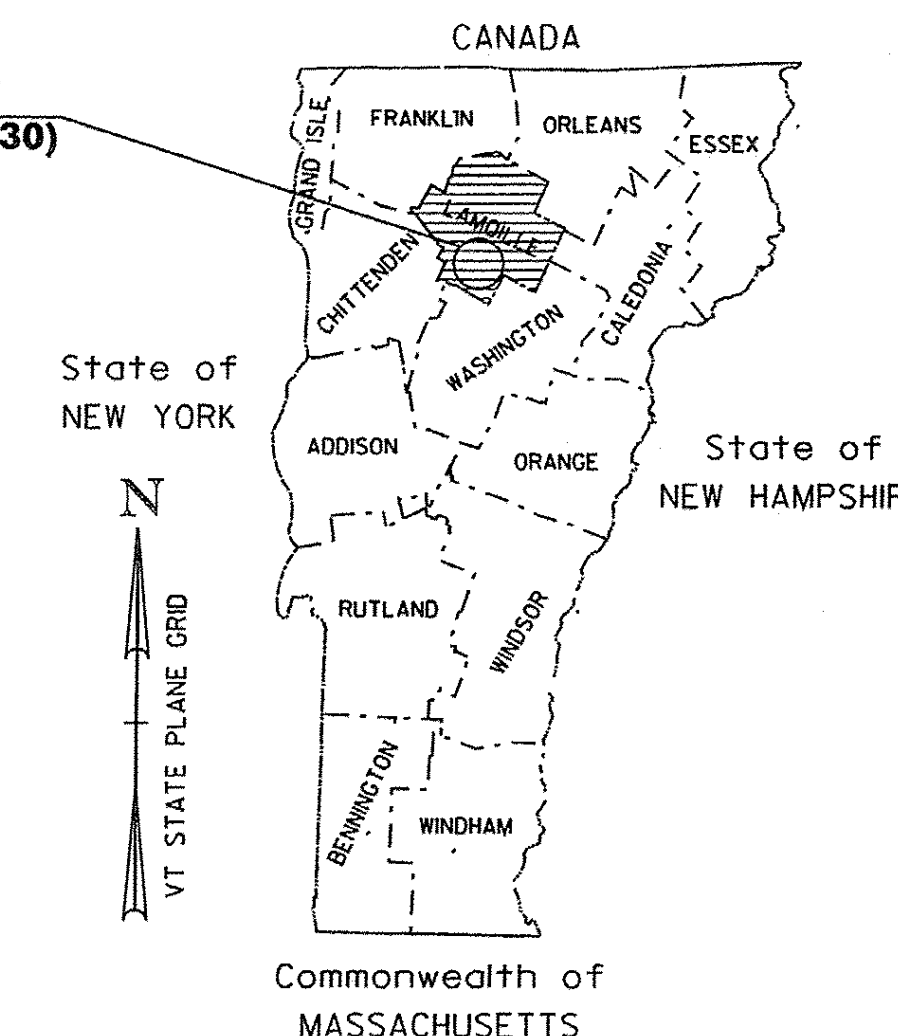
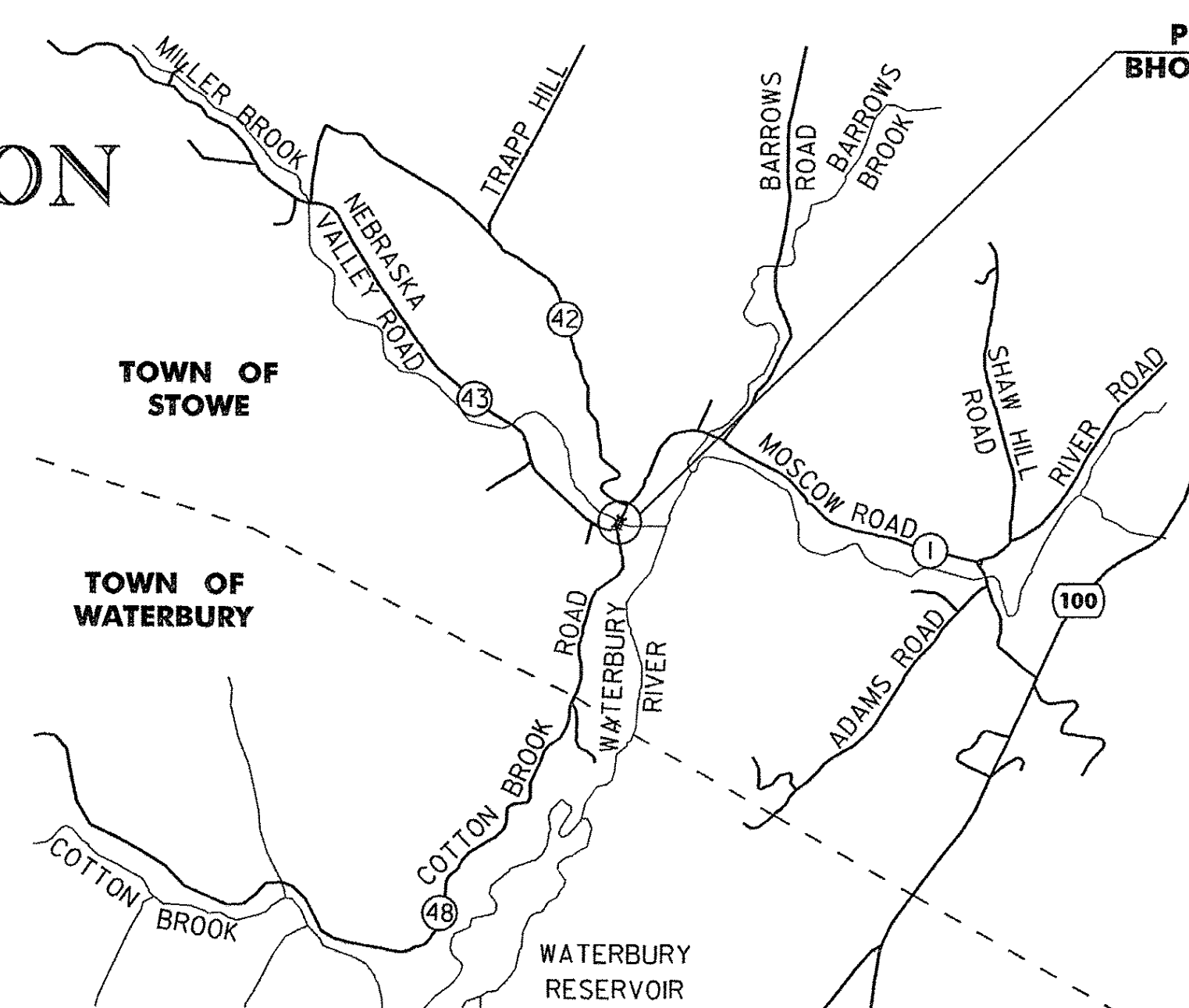

PROJECT LOCATION: BEGINNING AT A POINT APPROXIMATELY 1.89 MILES WEST OF THE JUNCTION OF VT ROUTE 100 AND TH NO. 1 AND EXTENDING NORTHEASTERLY ALONG TH NO. 1 FOR 0.038 MILES.

PROJECT DESCRIPTION: REMOVAL OF EXISTING CONCRETE DECK AND STEEL BEAMS, PARTIAL REMOVAL OF EXISTING ABUTMENT, CONSTRUCTION OF A NEW NORTHERN ABUTMENT, NEW PRESTRESSED CONCRETE BOX BEAM SUPERSTRUCTURE AND RELATED APPROACH WORK.

LENGTH OF STRUCTURE = 77 FEET = 0.015 MILES  
 LENGTH OF ROADWAY = 123 FEET = 0.023 MILES  
 LENGTH OF PROJECT = 200 FEET = 0.038 MILES

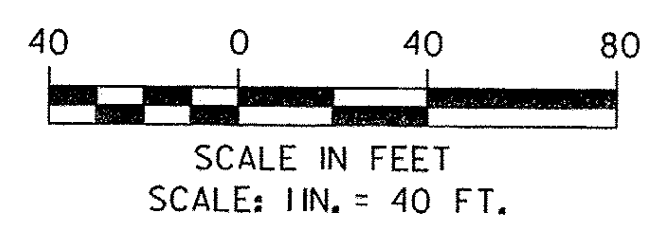
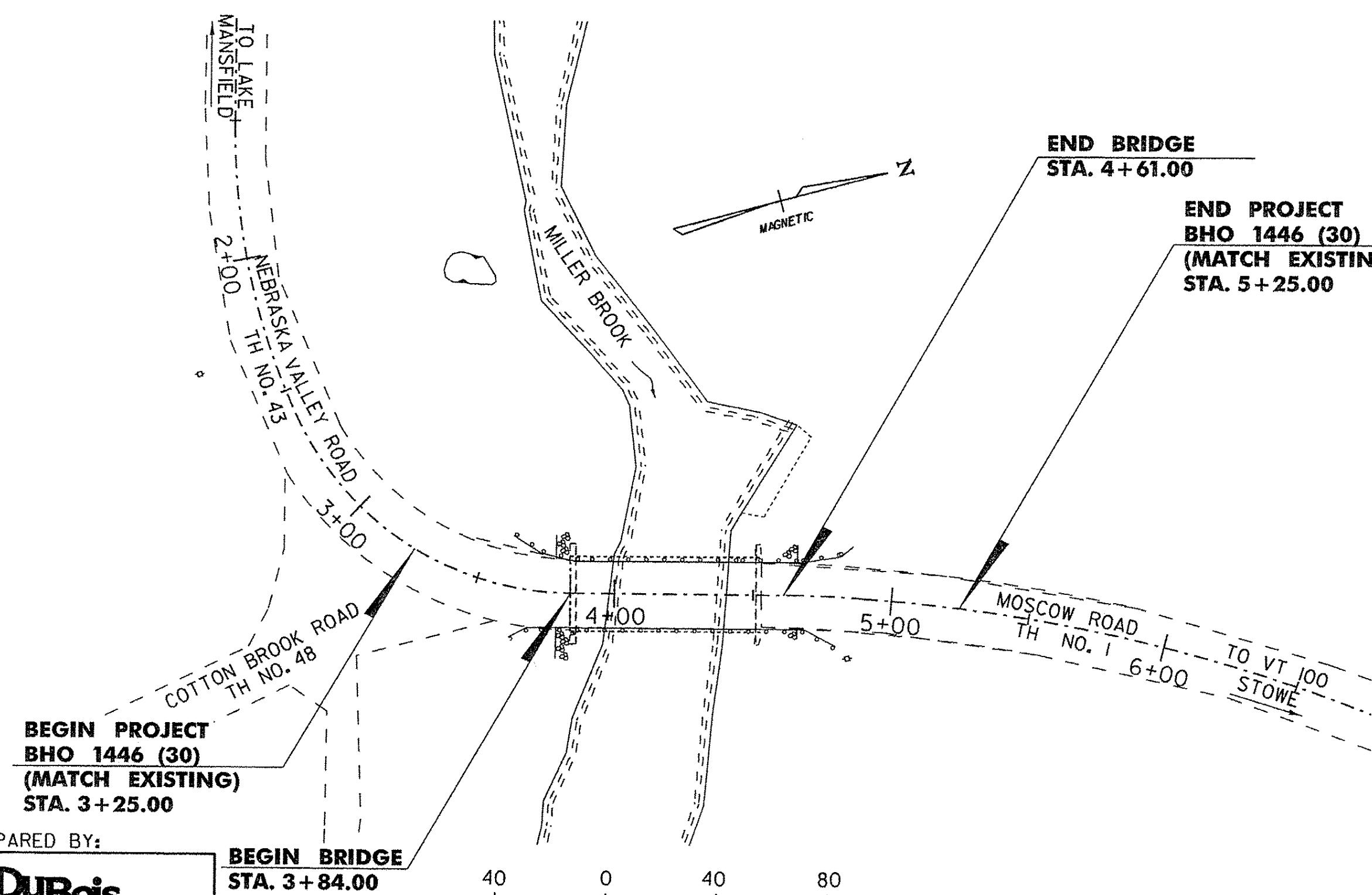

PLANS PREPARED BY:  
**DuBois & King**  
 engineering planning management development

DATUM  
 VERTICAL ASSUMED  
 HORIZONTAL ASSUMED

CONVENTIONAL SIGNS	
COUNTY LINE	---
TOWN LINE	- - - - -
LIMITS OF ACCESS	○—○—○
POINT OF ACCESS	X
FENCE LINE	—x—x—
STONE WALL	○○○○○○○○○○
TRAVELED WAY	- - - - -
GUARD RAIL	○—○—○—○
RAILROAD	
SURVEY LINE	—+—+—+—
CULVERT	—+—+—+—
POWER POLE	⊕
FIRE HYDRANT	⊙
TELEPHONE POLE	⊙
TREES	⊗ ⊛
CONTROL OF ACCESS	///
PROPERTY LINE	---
R.O.W. TAKING LINE	—SR—
SLOPE RIGHTS	○—△
TOP OF CUT	—△—△—
TOE OF SLOPE	○—○—○

RECORD PLANS	
CONTRACTOR:	AUSTIN CONSTRUCTION, INC. - CONCORD, VT
RESIDENT ENGINEER:	VIC DWIRE
CONSTRUCTION BEGAN:	MAY 10, 2010
CONSTRUCTION COMPLETE:	OCTOBER 25, 2010
RECORD PLANS BY:	VIC DWIRE & C. PIERCE
I HEREBY CERTIFY THAT ALL THE CONSTRUCTION REQUIRED BY THIS SET OF DRAWINGS HAS BEEN ACCOMPLISHED AS INDICATED HEREIN.	
BY:	<i>Victor R. Dwire</i> RESIDENT ENGINEER
DATE:	May 15, 2012
NOTE: Any further information concerning final quantities, amounts or other details relative to this project may be found at Central Files in the electronic archives.	

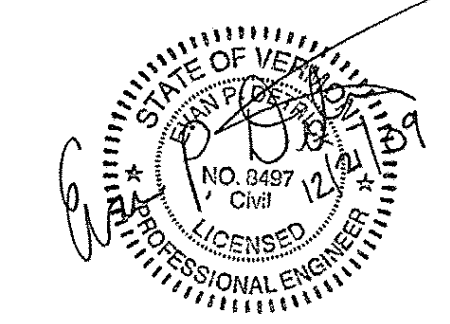

THESE PLANS ARE SUBJECT TO SUCH ENGINEERING CHANGES AS MAY BE REQUIRED BY THE FEDERAL HIGHWAY ADMINISTRATION OR THE DIRECTOR OF PROGRAM DEVELOPMENT.  
 CONSTRUCTION IS TO BE CARRIED ON IN ACCORDANCE WITH THESE PLANS AND THE STANDARD SPECIFICATIONS FOR CONSTRUCTION DATED 2006, AS APPROVED BY THE FEDERAL HIGHWAY ADMINISTRATION ON JUNE 15, 2006 FOR USE ON THIS PROJECT, INCLUDING ALL SUBSEQUENT REVISIONS AND SUCH REVISED SPECIFICATIONS AND SPECIAL PROVISIONS AS ARE INCORPORATED IN THESE PLANS.

DIRECTOR OF PROGRAM DEVELOPMENT  
 APPROVED: *Rubén Jarama* DATE 12-22-09  
 PROJECT MANAGER:  
 CHRISTOPHER WILLIAMS, P.E.  
 PROJECT NAME: STOWE  
 PROJECT NUMBER: BHO 1446 (30)  
 SHEET 1 OF 37 SHEETS

PLOTTED 12/21/2009