

ABM INFO		SHOP BILL				JOB NO.	DRG. NO.
PAGE	LINE	NO.	DESCRIPTION	FT	IN	REMARKS	WEIGHT
	8		BRACING	30	01	LBI	-
	32		L5x3 1/2x2	13	9	a1	
	8		1 1/2 x 10 3/4	2	0	gp1	
	16		1 1/2 x 12	1	11	gp2	
	16		DO	1	11	gp3	
	16		L4x3 1/2x3/8	1	11	aa1R	
	16		DO	1	11	aa1L	
	8		1 1/2 x 7	10		cp1	
	8		T5 1/4x4x3/8	2 1/2		f1	
	288		1/2" A325-TC BOLTS	2 1/2		SHOP	1/4" NEW GALV.
FIELD BOLTS (A325-TC-GALV.)							
	124		2" BOLTS	2 1/2		1/4" NEW GALV.	
	98		DO	3		DO	
PAY ITEM 506.50							

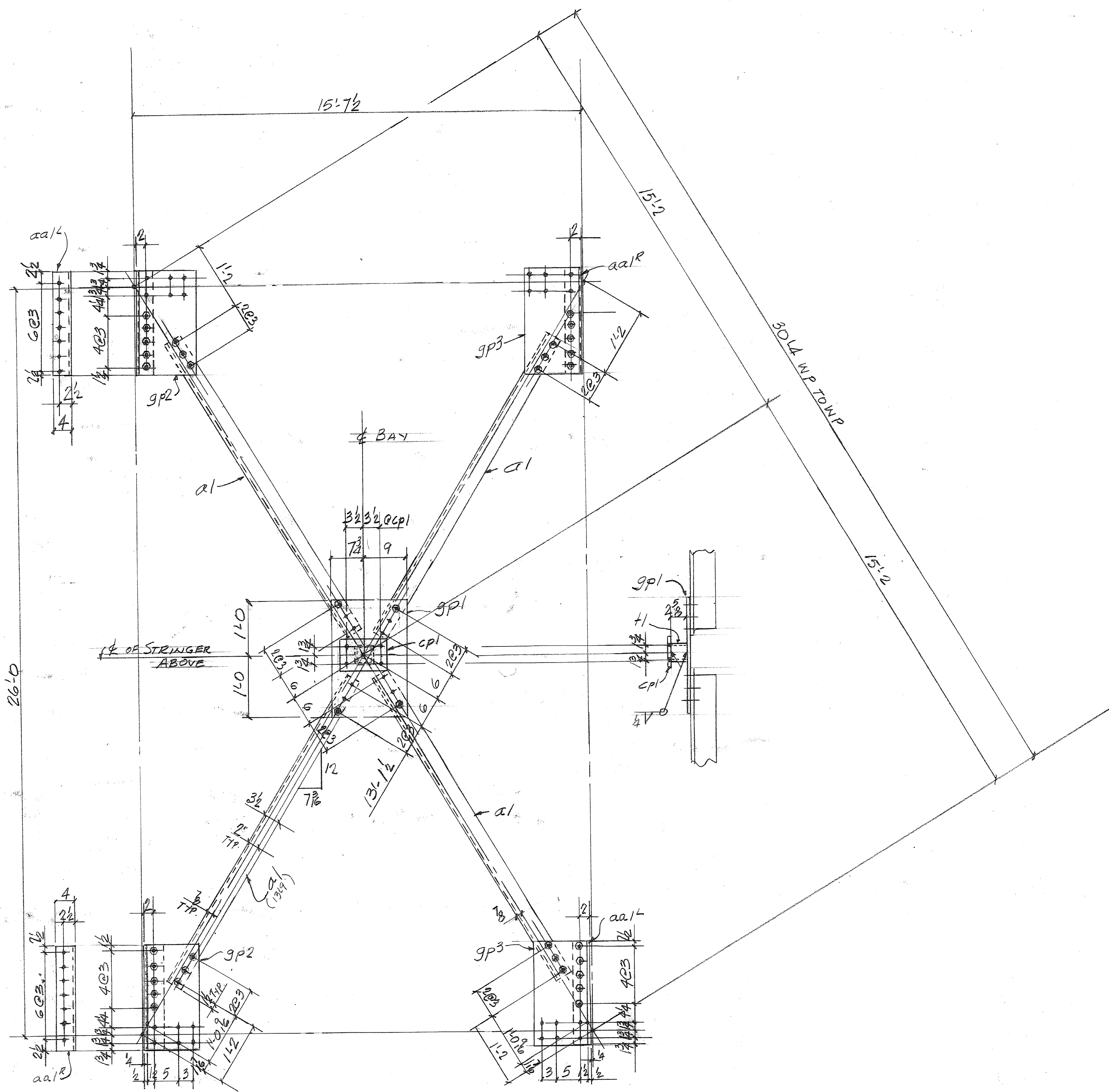

Per Blow & Cote, Inc., all circled dimensions have been verified and they have released to fabricate using these dimensions. If all verification of existing holes for W27 and existing plates and angles can be verified prior to fabrication Casco Bay Steel Structures will shop drill. If not, Blow & Cote will field drill these holes.

SHOP DRAWINGS ARE REVIEWED UNLESS NOTED OTHERWISE

NO EXCEPTION TAKEN	<input checked="" type="checkbox"/>
REVISE AS NOTED	<input type="checkbox"/>
RESUBMISSION NOT REQUIRED	<input type="checkbox"/>
REVISE AS NOTED	<input type="checkbox"/>
RESUBMISSION	<input type="checkbox"/>
REJECTED	<input type="checkbox"/>

DATE: 4/25/08

SIGNATURE: *Mickael Chant*

REVIEW BY: [Signature] TITLE: [Blank]

REVISIONS: [Blank]

OUT FOR APPROVAL	3/19/08
OUT FOR APPROVAL	4/17/08
ISSUED TO SHOP	
FIELD & OFFICE	
App's Comments	4/17/08
REV. REMARKS	DATE DWN CHK APP Q.A. NO. DIA. LGT TYPE WASHER
PROJECT NO.	BHF-0302 (3)5 STATE PROJECT NO.
MATERIAL:	A572-50 ELECTRODES: 505 PROC HOLES: 1/8" HP SHOP BOLTS: 1/2" A325 TC-GALV.
SURFACE PREP. & PAINT:	SHERWIN WILLIAMS-COROTHANE 1 GALVAPAC ONE PACK ZINC PRIMER 3.5 TO 4 MILS DFT
DESCRIPTION:	LATERAL BRACING
JOB:	IMPROVEMENTS BRIDGE No. 41 ON TH No. 2 RICHFORD, VT.
CUSTOMER:	BLOW & COTE INC.
CASCO BAY STEEL STRUCTURES, INC.	JOB NO. 361 DRG. NO. 55
75 SPRING HILL ROAD SACO, MAINE 04072	PHONE (207) 282-7360 FAX (207) 282-1179