

CONSTRUCTION NOTES:

CAST IN PLACE
PRECAST REINFORCED CONCRETE CURB, TYPE B
 STA. 14+00 - 14+23, RT.

YIELDING MARKER POST
 STA. 30+16, RT.
 STA. 15+01, RT.
 STA. 15+12, LT.

CONSTRUCT DRIVE APRON
 STA. 28+40, LT. (17' WIDTH)
 STA. 31+70, LT. (20' WIDTH)

COLD PLANING-BITUMINOUS PAVEMENT
 STA. 28+00 - 28+25.50

REMOVAL OF EXISTING FENCE
 STA. 14+59, LT. 40 - 14+70, RT. 60
 STA. 14+21, RT. 50 - 14+23, LT. 30

VT 2A CURVE #1

$\Delta = 10^{\circ}00'02.80''$ LT.
 $D = 1^{\circ}59'59.47''$
 $R = 2865'$
 $T = 250.67'$
 $L = 500.80'$
 $E = 10.95'$

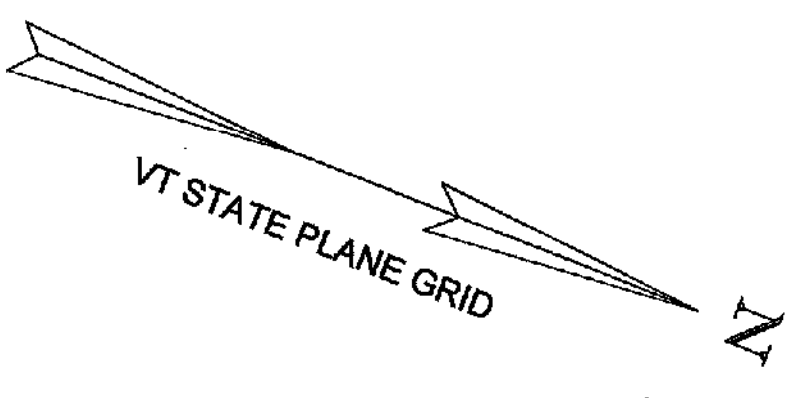

Matchline Sta. 26+50

Matchline Sta. 32+75

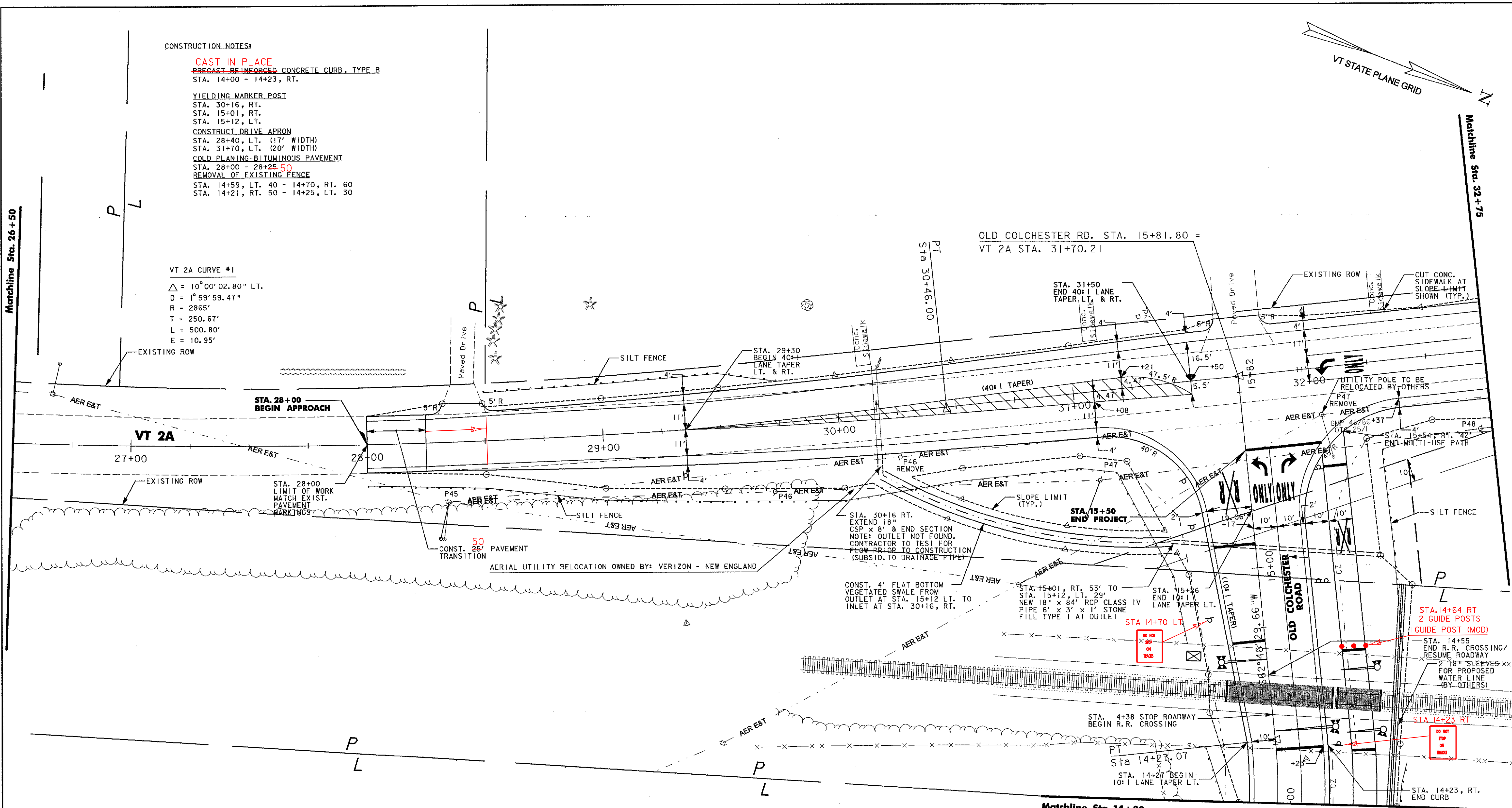

GENERAL NOTES:

- 1) ALL CULVERTS (TYP.) WITH SLOPES OF 1% OR LESS SHALL BE SMOOTH-LINED WITH PAVED INVERTS.
- 2) EDGE OF ROADWAY SHALL BE CLEARED TO R.O.W. LIMIT FROM STA. 10+75, LT. TO RR CROSSING, LT.
- 3) RAIL CROSSING WORK TO BE COMPLETED BY OTHERS. SEE RAIL CROSSING PLANS, PROFILE, & TYPICAL FOR DETAILS.

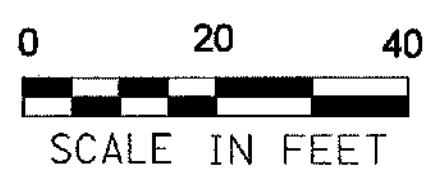

VT. 2A

GENERAL PLAN

DATUM	
VERTICAL	NAVD 88
HORIZONTAL	NAD 83 (96)

PROJECT: ESSEX	PROJECT NO.: STP2035(14)S
DESIGN FILE NAME: NH-BED\PROJECTS\CAD\TE\51070BDR-2.DGN	PLOT DATE: 06/14/2002
IPARM FILE NAME:	SURVEY DATE: 18Sep199
SURVEYED BY:	DRAWN BY: RBN
SQUAD LEADER: GLB	SHEET: 21 OF 50

VHB Vanasse Hangen Brustlin, Inc.