

NOTES:

1. INDICATES AREA ALONG DECK AND UP FACE OF CURB FOR PLACEMENT OF TWO COATS OF POLYURETHANE MEMBRANE.
2. POLYURETHANE MEMBRANE AND BLAST CLEANING SHALL BE INCLUDED IN THE UNIT PRICE BID FOR SHEET MEMBRANE WATERPROOFING, TORCH APPLIED
3. SHEET MEMBRANE WATERPROOFING, TORCH APPLIED SHALL EXTEND TO FACE OF CURB AS SHOWN ABOVE.
4. ALL CONCRETE IN CURBS SHALL BE CONCRETE, HIGH PERFORMANCE CLASS A.

CURB & RAIL DETAIL

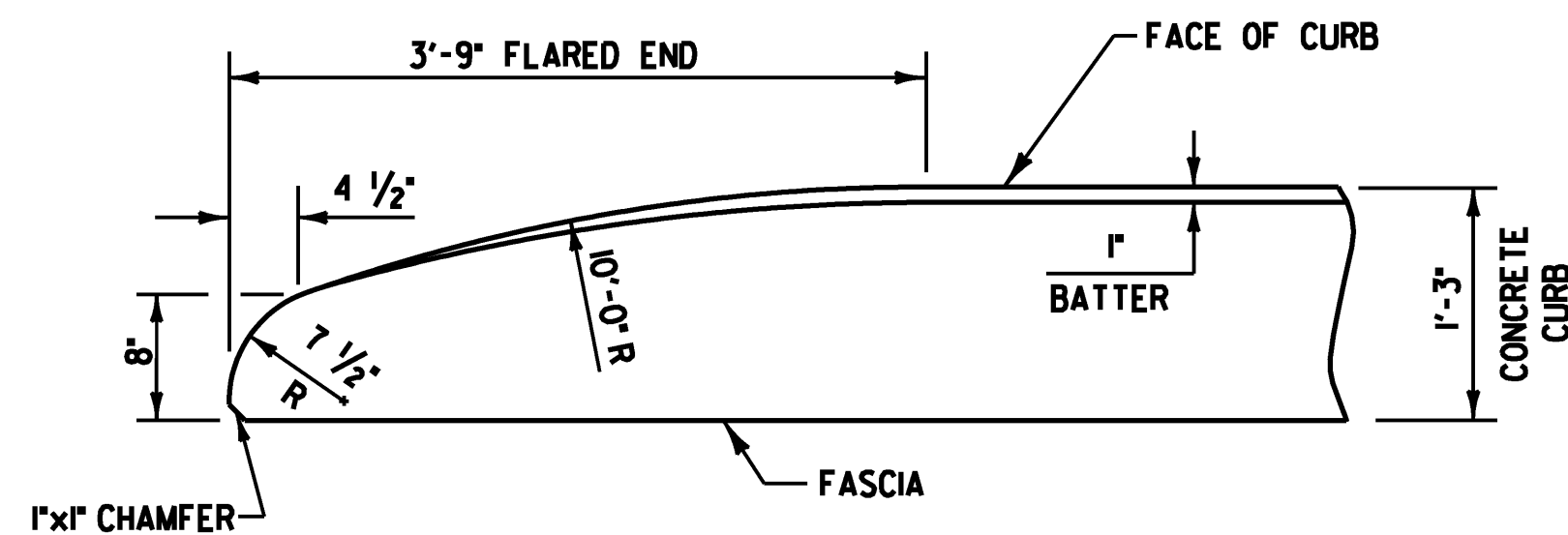
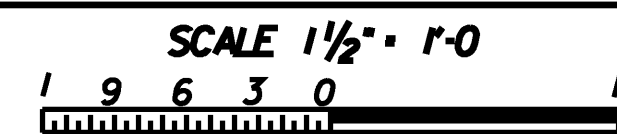

FLARED END DETAIL FOR CURB

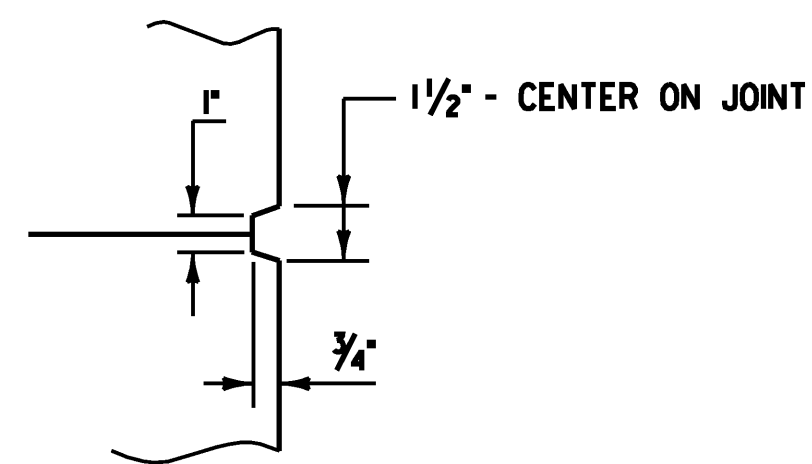

SCORE MARK DETAIL

NOT TO SCALE

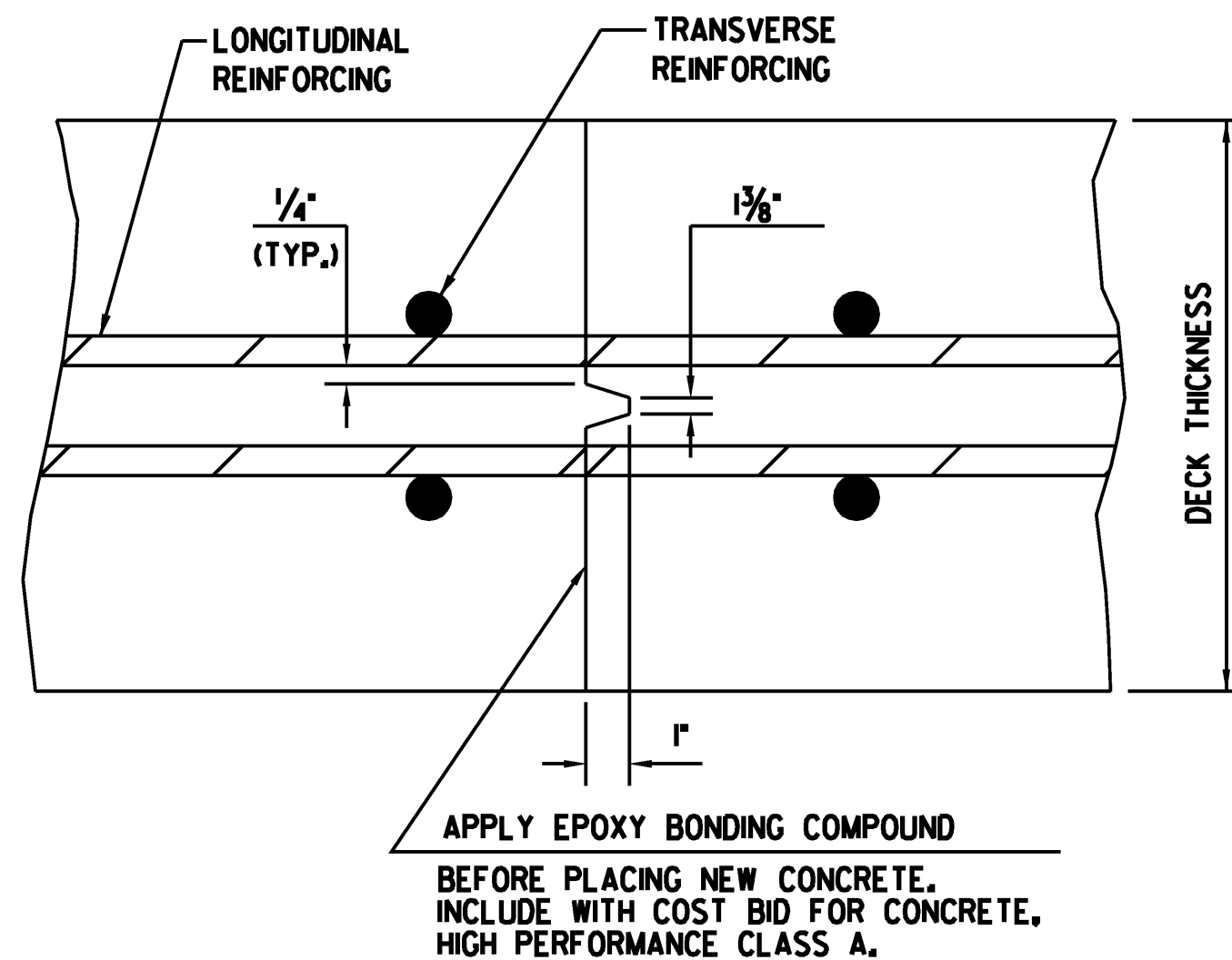

TRANSVERSE BRIDGE SLAB CONSTRUCTION JOINT DETAILS

NOT TO SCALE

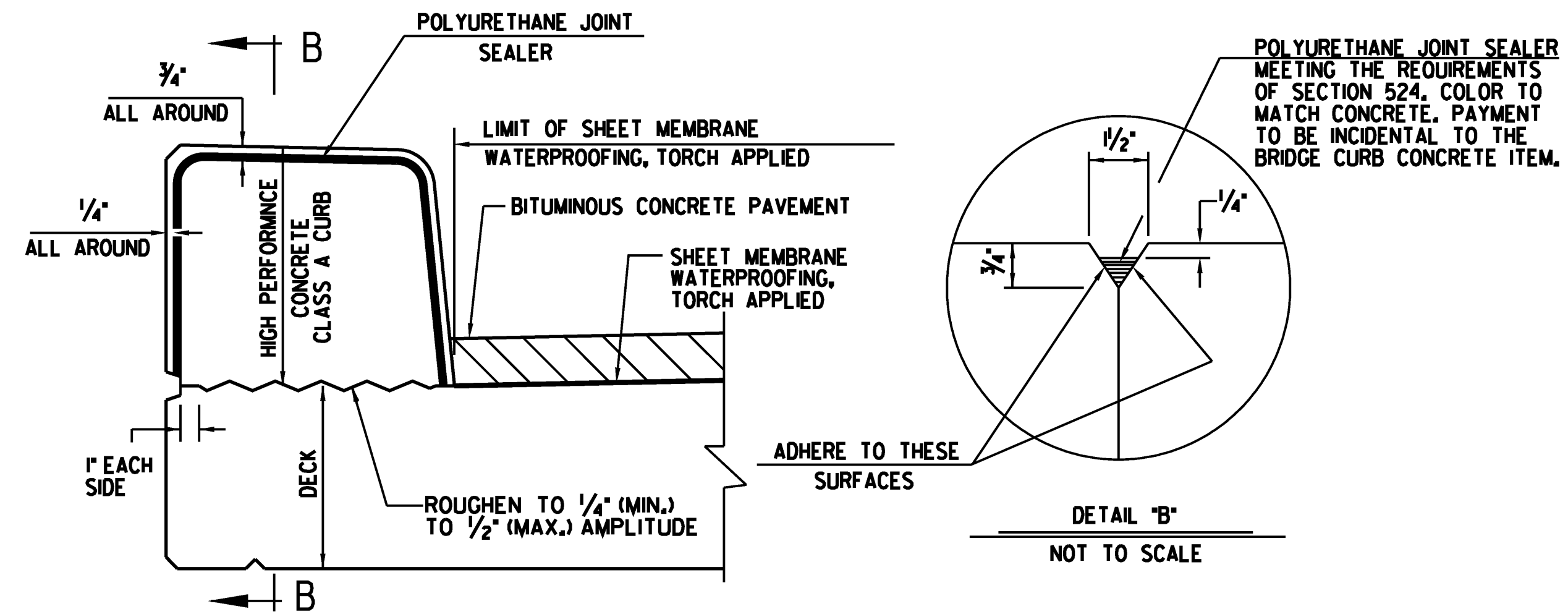

TYPICAL SECTION THROUGH CONCRETE CURB CONSTRUCTION JOINT

NOT TO SCALE

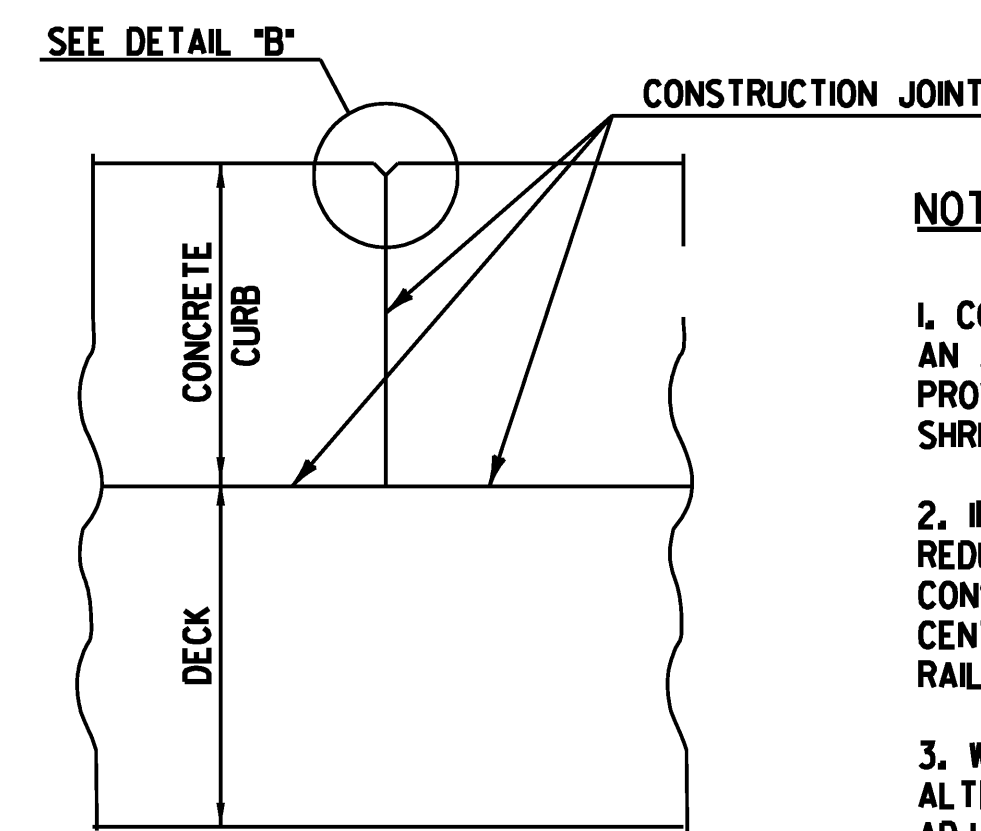

SECTION B-B

NOT TO SCALE

NOTES:

1. CONCRETE CURBS MAY BE PLACED IN ONE CONTINUOUS OPERATION IF AN APPROVED SHRINKAGE REDUCING ADMIXTURE LISTED IN THE SPECIAL PROVISIONS IS USED WITH THE CONCRETE MIX DESIGN. PAYMENT FOR THE SHRINKAGE REDUCING ADMIXTURE WILL BE INCIDENTAL TO ITEM 501.33.
2. IF THE CONTRACTOR CHOOSES NOT TO USE AN APPROVED SHRINKAGE REDUCING ADMIXTURE, THE CURBS SHALL BE CONSTRUCTED WITH CONSTRUCTION JOINTS SPACED AT AT A MAXIMUM OF 15'-0" CENTER TO CENTER AND 2'-0" MINIMUM FROM THE CENTER OF NEAREST BRIDGE RAILING POST.
3. WHEN CURB JOINTS ARE USED THE CURBS SHALL BE PLACED IN ALTERNATE SECTIONS WITH A MINIMUM OF 48 HOUR DELAY BETWEEN ADJACENT PLACEMENTS.
4. LONGITUDINAL REINFORCING SHALL BE CONTINUOUS THROUGH CURB CONSTRUCTION JOINTS. CURB STIRRUP BARS SHALL BE TURNED AS NECESSARY TO MAINTAIN COVER IN THE FLARED CURB ENDS.

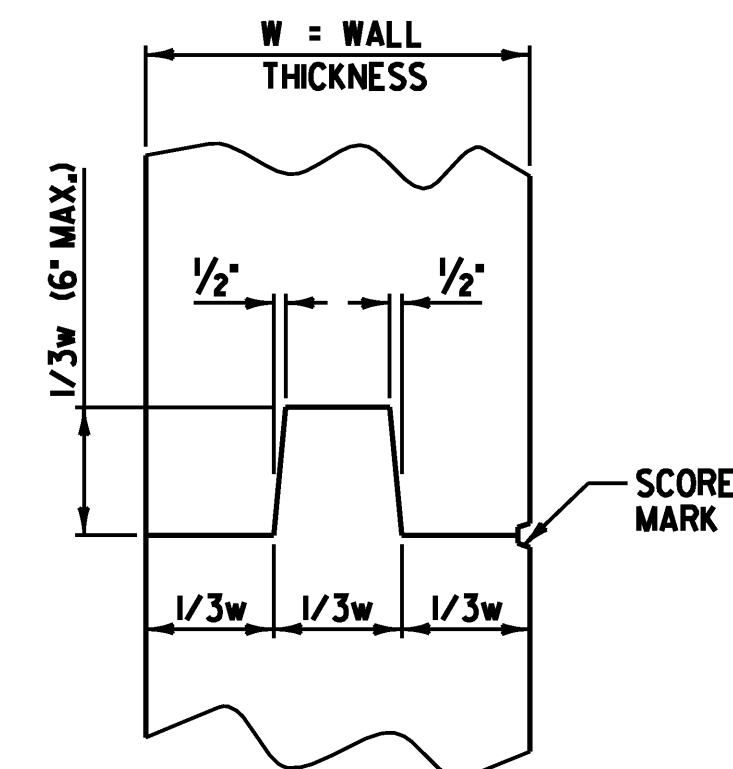

TYPICAL CONCRETE CONSTRUCTION JOINT

NOT TO SCALE

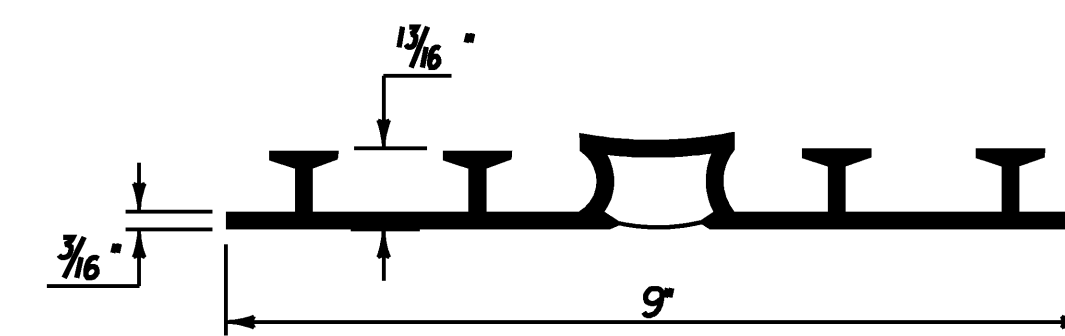

P.V.C. WATERSTOP FOR EXPANSION JOINTS

THE COSTS FOR P.V.C. WATERSTOP SHALL BE INCLUDED IN THE UNIT PRICE BID FOR CONCRETE, HIGH PERFORMANCE CLASS B. OTHER CONFIGURATIONS MAY BE USED UPON APPROVAL OF THE STRUCTURES ENGINEER.



PROJECT NAME: CLARENDON
PROJECT NUMBER: BHO 1443 (39)

FILE NAME: ...Drawing\20-clar-miscdets2.dgn
PROJECT LEADER: MJC
DESIGNED BY: SEB
MISCELLANEOUS DETAILS II

DATE: 7/2/2009
DRAWN BY: AET
CHECKED BY: MJC
SHEET 20 OF 24